

Kim KN#4 11/8/82

842538

Rodney Creek - Reg.

KNZTI-27 %c

silicified, brecciated,
fine - med gr. gk,
possibly a gk vein
w white clay alteration
fractured w 0.5%
dissem py + stringers

KNZTI-28 subrep

highly altered. bx
gk vein? or silicified
gk fsp porphyry,
fsp clay altered.

KNZTI-29 %c

bx, silicified -
gk bx w gk fsp
& possible gk fsp.

11/8/82.

KNZT1-29 cont'd

porphyry frags
w alk - Fe carb
alteration w at
least 2 generations
silicification
w green FUCHSITE?
+ minor PY $< 0.5\%$
dumort ± neodesite

KNZT1-30 %

highly silicified
alk - Fe - carb
altered alk w
alk veins, up to
3 generations of
silicification +
PY min along veins
 $< 1\%$, greenish
mineral?

11/8/82

KNZT1-31 %c

silicified qtz-
top porphyry,
white + med
grey, fine gr. w
up to 1% py
stringers + minor
black sulphide
stringers.
same location as KZT2-676

KNZT1-32 %c

qtz carb alteration
silicified bx,
qtz white + med
grey, w up to 2
generation silicification
py up to 2%
dissem + stringers

11/8/82.

KNZT1-33 %c

qtz - Fe carb altered
bt, silicified,
several generations
silicification,
fractured extensively
to malachite stages
+ sulphide min
< 1% as stringers.

WSP 02699108
ATTITUDES
(100/40 N)

Project <i>M504</i>	NTS <i>104K</i>	Scale <i>1:30,000</i>	Page <i>1</i> of <i>1</i>	Traverse <i>4</i>
Sampler <i>KN+RL</i>	Location, Target (words) <i>RODNEY CK - REG.</i>		Sample Nos <i>KNZTI-27-33</i>	
Date <i>11/8/82</i>	photo no. <i>A11580-334 (T-10)</i>		Cert. Nos	

- GOSSAN, MINERALS
- INTRUSIVE
- LIMESTONE DOLOMITE
- SHALE
- CHERT
- WATER
- ROCK
- PAN
- SILT
- SOIL
- CONGLOMERATE
- VOLCANIC
- SANDSTONE SILTSTONE

DON'T FORGET CONTOURS, DRAINAGE, NORTH ARROW, LAT/LONG, SAMPLE SITES, WORKINGS, TRAILS, GOSSANS, OBSERVED GEOLOGY: DEFINED --- INFERRED --- ASSUMED.....

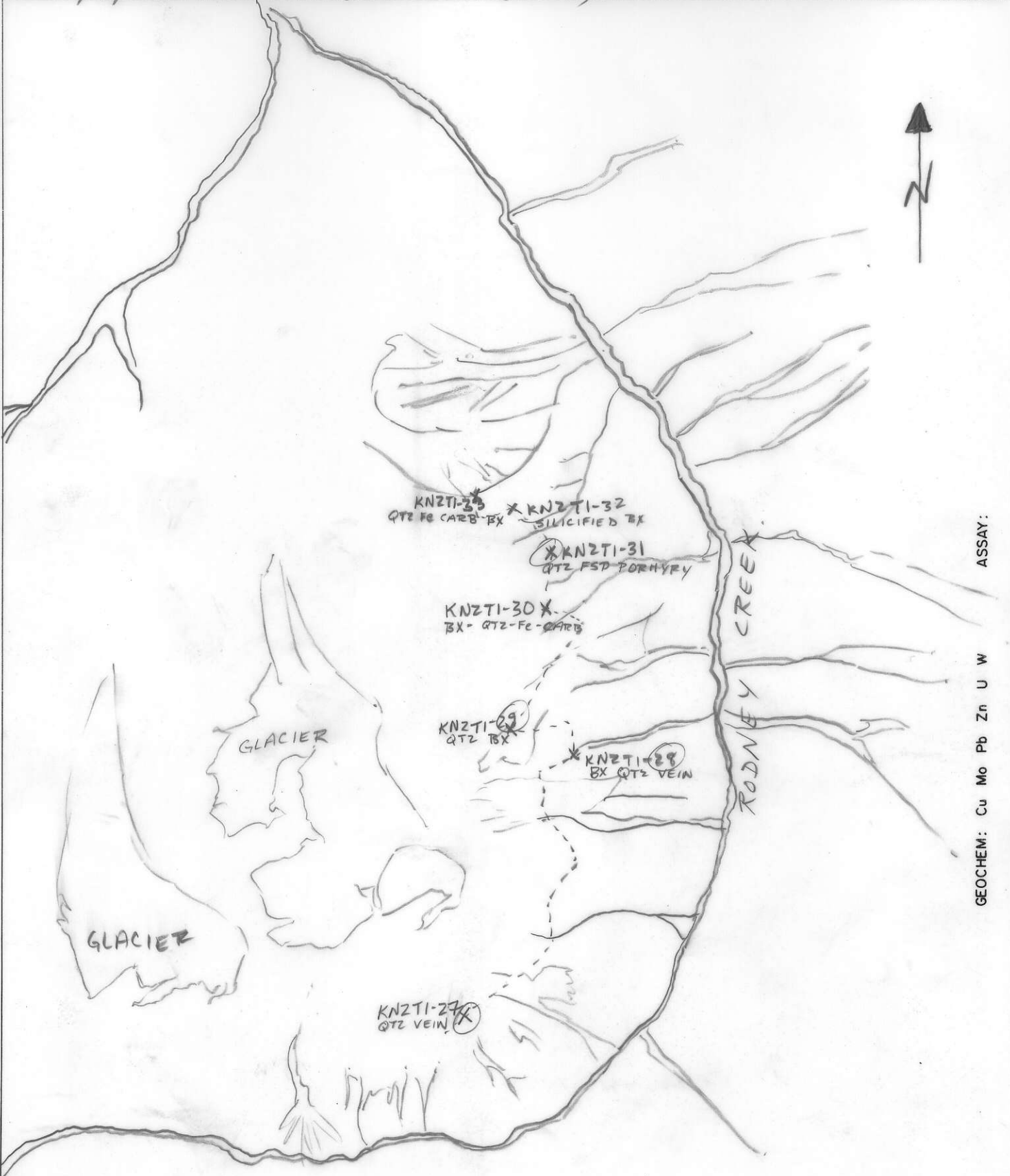

GEOCHEM: Cu Mo Pb Zn U W ASSAY:

Wed Aug 11/82 Rodney Creek - Log # 4

R.S. + I spent the day prospecting along the ridge above Rodney Ck. 7 rock samples from KN271-A-33 were taken in predominantly silicified breccias that have been Qtz-Fe-carb altered with minor pyrite mineralization. R.S. took soil samples from RL272-667-677.