

Project M504	NTS 104 K	Scale 1:30,000	Page 1 of 1	Traverse 14
Sampler ROB LAZENDY STEVE GOFERTZ	Location, Target (words) RIDGE BETWEEN TRAPPER LK & OUTLOW CLAIMS		Sample Nos RL272 - 393, 394, 396, 397, 400-406, 410-412 RL273 - 395, 398, 399, 407-409	
Date JULY 1 / 82	photo no. BC5618 166		Cert. Nos 0-2-412	

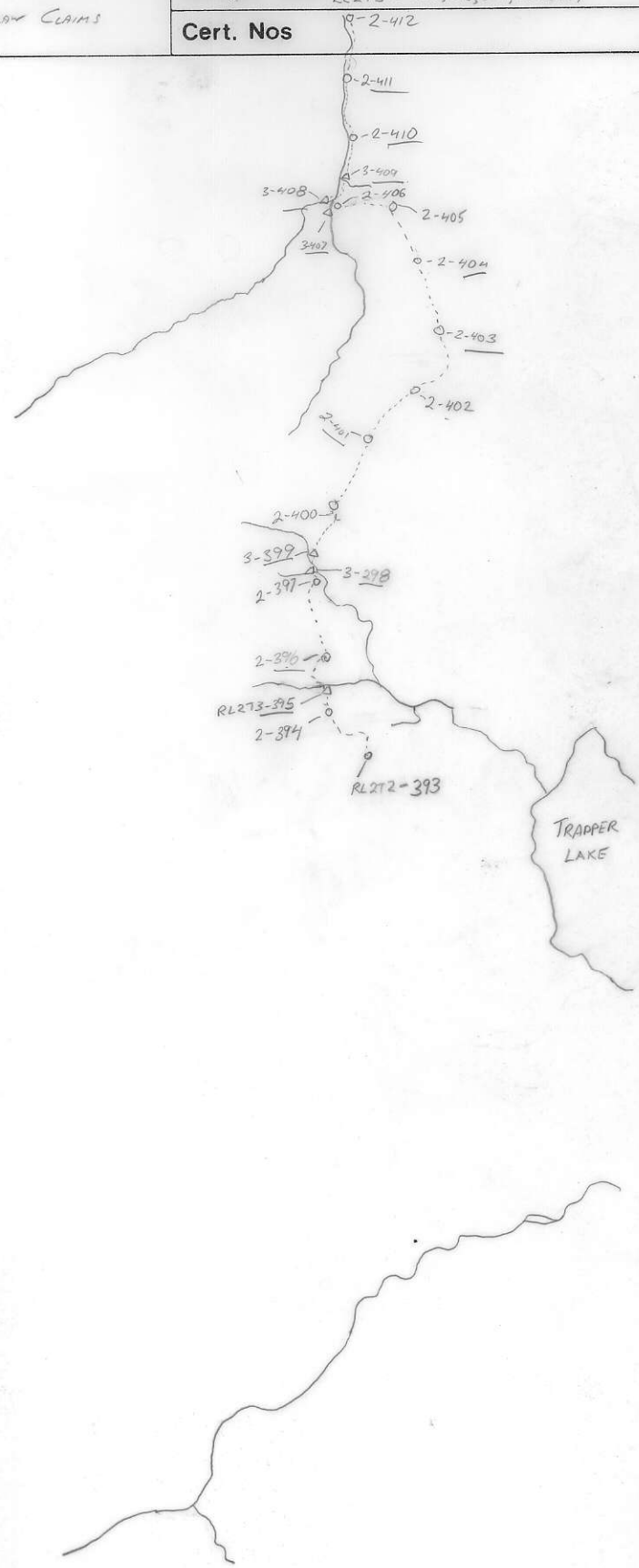

SPECIMEN SITE A.B...; DO NOT WRITE ON OTHER SIDE OR USE COLOURS

DON'T FORGET CONTOURS, DRAINAGE, NORTH ARROW, LAT/LONG, SAMPLE SITES, WORKINGS, TRAILS, GOSSANS, OBSERVED GEOLOGY: DEFINED --- INFERRED --- ASSUMED.....



ASSAY:
GEOCHEM: Cu Mo Pb Zn U W

July 1

TRAVERSE - 14

STEVE GOERTZ & MYSELF today did a regional traverse on the ridge N.W. of Trepper Lake, between Trepper Lake and the OUTCRAW claim block. We started at the grey cliffs, and moved through the cirque to the ridge, then down the ridge to the creek, and finally down the creek. Since it was a regional, we sampled every 300m, and silted the creeks that seemed to warrant it. We looked at the outcrop, but it all seemed to be highly vented sandstones, at least until we hit the creek. In the creek, some other rock types were evident. Some of the float had mineralization, but not the O.C.

14 soils

6 silts.