

**DEREK**

842132  
Nimpkish

April 1983

DEREK BROWN

APRIL 7/83

LOCATION: NIMPKISH GROUP, VAN. IS.

WEATHER: SNOW !! + WINDY

AHNSB3-1:

- relatively unaltered volc.
- weather - pale green
- fresh - dark green
- fog to mg
- abundant ch
- minor ch + ep veinlets

vein attitude:

350/70 NE



△ HNB3-1:

- at 2+20 m

- ep-gtz veins up to 5 cm wide cutting fgn greenstone

HNB3-1

- grab sample across 1 m of veins + country rock
- pale green veins
- dark green, fgn get host

△ HNB3-5: (BASALTIC?)

- andesitic amygdaloidal flow pr (PP)
- massive dark grey rock with pale green (ep?) and white (gtz ± zeolites?) crystals throughout
- trace py ± chalc
- green crystals - radiating masses

HNSB3-10:

- Fs PORPHYRY
- white fs megacrysts up to 8 mm long
- altered dark grey, mafic phenocrysts up to 3 mm long
- weathers - light grey
- andesitic composition
- ch + ep veins or fractures

APRIL 8/83

LOCATION: NIMPKISH GROUP

WEATHER: AM → SUNNY !!

PM → CLOUDY, SNOW or RAIN

on Road 7:

4+50 m (Δ HNSB3-28):

- basalt with abundant pale green ~~knob~~ spots of ep
- ep is more weather resistant & forms a knobby weathered surface
- ep + qtz + zedites fill vesicles

= amygduloidal basalt

- small, isolated %'s

fractures: 270/70 N



3+80 m:

- // fractures in f  $\phi$
- ep alteration along fractures
- f altered to white "clayey mins."
- abundant ep + ch in groundmass
- % weathers pale grey
- fresh - dark green
- ep altered fractures < 3 cm wide

2+50 m:

- AMG. BASALT

- green + white mins. filling vesicles (ep + zeolites?)
- 10-15% amygdules
- relatively unaltered groundmass
- unaltered fractures



2+10 m to 1+75 m:

- rough weathering amy. basalt with white, altered f. phenocrysts < 2 mm long
- fractures are ep altered
- continuous %

1+50 m:

- 15 m long %
- completely epidotized %
  - pale green with colourless, pale green & white mins. filling vesicles
  - weathers - pale green

HNBB-2

- grab sample

1+20m to 0480:

- basalt and amy. bas
- variable amounts of ep alteration
- more ep towards 1+50m

0+65 to 0+25:

- continuous %
- basalt
  - mafic phenocrysts
    - altered to dark green ch(?)
  - ep along some fractures
  - relatively unaltered

"ROAD 8" (southeast end)

8+20 m from junction with Road 3:

- amygduloidal basalt with altered mafic phenocrysts
- ep fills vesicles
- 10% amygdules
- isolated %'s

7+00 m:

- fgs, dark green basalt
- no amygdules
- "sand paper" weathered surface
- dark greenish grey weathering

5+60 m:

- white zeolite altered basalt
- highly fractured zone ~ 15m wide
- fgs basalt on both sides

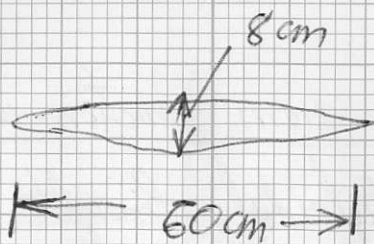

flow layering (?);

180/15W 15-

5+50 m.

- lense shaped pocket of sulfides within amygdaloidal basalt

HNB3-3

- sample of sulfides
- malachite staining
- minor py <sup>metallic</sup>
- dull grey min - MT.
- ept + ch<sub>v</sub> in pocket  
+ qtz crystals

- large % from 5+25 m to 5+80 m

4+00 m.

- possible flow layering

dyke attitude

~ 050/90

~~40~~

2+10 m:

HNB3-4

- grab sample along the pyritic contact of a granitic dyke that intrudes the basalt
- dyke is ~5 m wide
- weathers rusty brown
- hb phenocrysts → ch
- fgs to mgs
- malachite staining locally
- rare chalc (?)

- % from 2+00 to 2+30 m

# "ROAD 10"

## △ HNSB3-44:

- ~~sampled~~ 9/16 60 m long
- ~~the~~ basaltic f φ
  - fgs
  - massive
  - dark green

1

2+00 m:

- amy. basalt

3+00 m:

- 20 m long 9/16
- fgs dark green basaltic
- some epidote amygdules



bedding:

105/40

↖  
40

100/35

↖  
35

4+00 m ( $\Delta$ HNSB3-50):

- dark green amygduloidal basalt
- vesicles filled with ep + white & pink (zeolites  $\pm$  qtz)
- fgs groundmass
- massive
  
- % is 15 m long

5+35 m (end of Road 10):

- well layered amygduloidal basalt flows
- some fgs, bedded material between flows
- amygdules vary in size & are concentrated near the top of individual flows
  - beds are "right-side-up"
  
- % weathers greenish brown

"ROAD 12"

0+75 to 1+00 mi:

- amygduloidal basalt

end of Road 12:

- fgr. basalt
- weathers - light grey to brownish
- fresh - dark green

1+50 to 1+75:

- amy. basalt

APRIL 9/83

LOCATION: NIMPKISH GROUP

WEATHER: CLOUDY & COOL

on Road 21 ; 19+30m.

- Karmutsen volc.
  - fs phenocrysts in dark green basalt
    - fs is altered
    - fs up to 4 mm long
- locally fractured
- pale green ep patches
- % is 75 m long

1555  
930  

---

2485

\* shear zone:  
~ 290 / ~ 45  
(\* strike & dip vary)

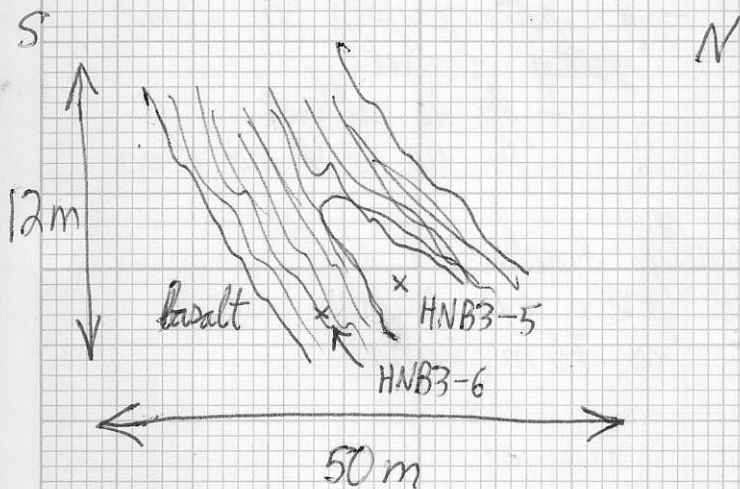
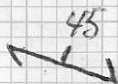

24+85 m:

- sheared Karmutsen volc.
- highly fractured
- locally pyritic (disseminated & along fractures)
- fractured zone ~ 8 m wide

HNB3-5

- resistant lens in shear zone
- pyritic, altered volc (?)

HNB3-6

- sheared volc.
- highly fractured
- dark green

- some unshaped basalt on footwall

April 10/83

Road 25

2+00 m:

- Karmutsen amy. basalt
  - ep filled vesicles
  - dark green
  - massive
- 9c is 8 m wide & continuous up the hillside

3+50 m to 4+00 m:

- dark green, fgs basalt
- some amygduloidal
- dark green mafic phenocrysts < 2 mm long
- massive

HNB3-8 FLOAT  
- malachite & azurite stained gtz-ep veins

4+50 to 5+75 m:

- continuous % of massive amy. basalt
  - trace disseminated py
  - pitted weathered surface
- rusty, pyritic fractures
- altered fs phenocrysts

5+60 m:

HNB3-7

FLOAT

- massive py in basalt boulder
- trace chalcocite (?)
- euhedral py.

HAQAMM



DISTANCE

ROAD 25

end of Road 25 → 0+00

0+50

1+00

1+50

2+00

2+50

3+00

junction with Road 26 → 3+50

4+00

4+50

5+00

5+50

junction at 6+00

ROAD 26

end of Road 26 → 0+00

\* 0+80

junction with Road 25  
at 1+25m

STATION	ELEVATION	TEXTURE	COLOUR	DEPTH	HCR.	ORG.
HNSRB-32	038	silty	ln	12	B	L
-133	41	silty	ln	8	B	L
-134	44	silty	ln	12	B	L
-135	46	silty	ln	14	B	L
-136	47	silty/bandy	ln	10	B	L
-137	49	silty	ln	14	B	L
-138	51	silty	brick red	12	B	L
-139	55	silty	ln	18	B	L
-140	54	silty	ln	12	B	L
-141	52	silty	yellow ln	14	B	L
-142	49	silty	ln	16	B	L
-143	48	silty	ln	14	B	L
-144	49	silty	ln	4	B	L
-145	52	silty	ln	10	B	L

APRIL 10/83

end of Road 23 →

DISTANCE

0+00  
0+50  
1+00  
1+50  
2+00  
2+50  
3+00  
3+50  
4+00  
4+50  
5+00  
5+50  
6+00  
6+50  
7+00

on corner →

Road 21 junction at 7+50

ROAD 24

end of road 24 →

junction with 21 at 1+50

0+00  
0+50  
1+00

STATION	ELEVATION	TEXTURE	COLOUR	DEPTH	HOR.	ORG.
HNSB3-114	157	silty/sandy	ln	8 cm	B	L
115	158	silty	ln	12	B	L
116	160	silty/sandy	ln	10	B	L
117	154	silty	ln	12	B	L
118	146	silty/sandy	ln	10	B	L
119	138	silty/sandy	ln	12	B/sandy	L
120	132	silty	ln	12	B	L
121	128	silty	ln	10	B	L
122	122	silty	ln	10	B	L
123	110	silty	dark ln	12	B	L
124	106	silty	brick red	10	B	L
125	106	silty	yellow ln	12	B	L
126	106	silty	ln	14	B	L
127	110	silty	ln	16	B	L
128	117	silty	ln	12	B	L
129	58	silty	ln	14	B	L
130	53	silty	ln	12	B	L
131	55	silty	ln	12	B	L

DISTANCE

STATION

ELEVATION

TEXTURE

COLOUR

DEPTH

HOR.

ORG.

junction of Road 14 and 21 → 0+00

1+00

2+00

ROAD 21

3+00

4+00

5+00

6+00

\* 7+35

8+00

(9+30 ⇒ HNS65-105)

HNSB3-105

100

silty

bn

18

B

L

-106

100

silty

bn

16

B

L

-107

100

silty

bn

20

B

L

-108

100

silty

bn

14

B

L

-109

103

silty

bn

12

B

L

-110

104

silty

bn

22

B

L

-111

102

silty

bn

18

B

L

-112

102

silty

bn

12

B

L

-113

103

silty

bn

14

B

L

~~114~~~~115~~



DISTANCE

STATION

ELEVATION

TEXTURE

COLOUR

DEPTH

HOR.

ORG.

road 17 junction →

road 16 junction →

10 m long monzonite % →

junction →

bridge →

18+95 junction with Road 13 →

22+00 junction with Road 20

6+50

7+00

7+50

8+00

8+50

9+00

9+50

10+00

10+50

11+00

11+50

12+00

\* 13+40

\* 14+40

\* 15+90

16+50

17+00

18+00

\* 18+75

\* 20+00

HNSB3-85

-86

-87

-88

-89

-90

-91

-92

-93

-94

-95

-96

-97

-98

-99

-100

-101

-102

-103

-104

-105

-106

-107

110

94

92

88

85

80

73

70

68

68

70

72

74

79

82

85

95

98

99

95

silty

silty

silty

silty

silty

silty/sandy

silty

silty

silty

silty

silty

silty

silty

silty

silty

silty

silty

silty

silty

silty

silty

ln

ln

ln

ln

ln

ln

ln

yellowish ln

ln

ln

ln

ln

ln

ln

ln

ln

ln

ln

ln

ln

ln

18

2-6

14

12

14

0-6

12

16

14

6

10

12

10

8

12

16

12

14

16

14

B

B

B

B

B

B

B

B

B

B

B

B

B

B

B

B

B

B

B

B

B

L

L

L

L

L

L

L

L

L

L

L

L

L

L

L

L

L

L

L

L

L

APRIL 9/83

	DISTANCE	STATION	ELEVATION	TEXTURE	COLOR	DEPTH	HOR.	ORG.	
"ROAD 13"	0+00	HNSB3-65	170	silty	bn	14	B	L	
	0+50	-66	165	silty	bn	10	B	L	
	1+50	-67	146	silty	bn	16	B	L	
	2+00	-68	142	silty	bn	10	B	L	
	2+50	-69	120	silty	bn	14	B	L	
	3+00	-70	108	silty	bn	10	B	L	
	* 3+65	-71	100	silty	bn	5-14	B	L	
	road 14 at 4+45 m →	4+00	-72	98	silty	bn	10	B	L
	junction of road 14 & road 15 →	0+00	-73	148	silty	bn	14	B	L
		* 0+65	-74	140	silty	bn	8	B	L
* 1+50		-75	132	silty	bn	12	B	L	
2+00		-76	130	silty	bn	14	B	L	
* 2+65		-77	125	silty	bn	18	B	L	
3+00		-78	130	silty	bn	16	B	L	
3+50		-79	128	silty	bn	14	B	L	
4+00		-80	127	silty	bn	16	B	L	
4+50		-81	122	silty	bn	20	B	L	
5+00		-82	120	silty	bn	12	B	L	
5+50		-83	119	silty	bn	16	B	L	
6+00		-84	115	silty	bn	12	B	L	

"ROAD 15"

TRAV 1 across the gully  
adjacent to the spring

AMY. BAS

Road

DISTANCE	STATION	ELEVATION	TEXTURE	COLOUR	DEPTH	HOR.	ORG.
0+00	HNSB3-59		SILTY	BN	8cm	B	L
0+50	-60		SILTY	GREY	14cm	B	L
1+00	-61		SILTY	BN	12	B	L
→ 1+50	-62		SILTY	GREY	14	B	L
2+00	-63		SILTY/SANDY	BN	10	B	L
→ 2+50	-64		SILTY	BN	14	B	L

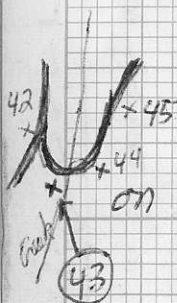

	DISTANCE	STATION	ELEVATION	TEXTURE	COLOR	DEPTH	HCR.	ORG.	
Road 10 at junction with Road E →	0+00	HNSB3-38	352	SILTY	BN	12	B	L	
	0+50	-39	350	SILTY	BN	8	B	L	
	1+00	-40	347	SILTY	BN	10	B	L	
	1+50	-41	334	SILTY	BN	12	B	L	
	* 2+25	-42	327	SILTY	BN	10	B	L	
		<del>-43</del>							
NW side of Creek → 	0+00	-43	323	SILTY	BN	12	B	L	
	* 0+60	-44	319	SILTY	RED BN	10	B	L	
	* 1+20	-45	325	SILTY	BN	10	B	L	
	* 1+75	-46	330	SILTY	BN	12	B	L	
	* 2+25	-47	327	SILTY	BN	8	B	L	
	3+00	-48	329	SILTY	BN	10	B	L	
	3+50	-49	328	SILTY	BN	12	B	L	
	4+00	-50	327	SILTY	BN	10	B	L	
	4+50	-51	328	SILTY	BN	14	B	L	
	end of Road 10 →	* 5+35	-52	330	SILTY	BN	10	B	L
	junction of Road 11 & Road 12 →	0+00	-53	299	SILTY	BN	12	B	L
0+50		-54	294	SILTY	BN	14	B	L	
1+00		-55	297	SILTY	BN	10	B	L	
1+50		-56	304	SILTY	BN	12	B	L	
* 2+10		-57	301	SILTY	BN	14	B	L	
end of Road 12 →		* 2+60	-58	300	SILTY	BN	8	B	L

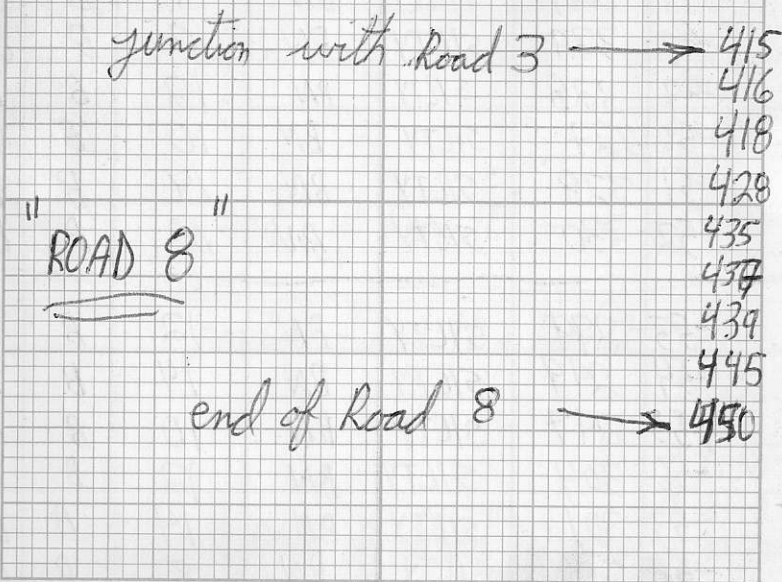
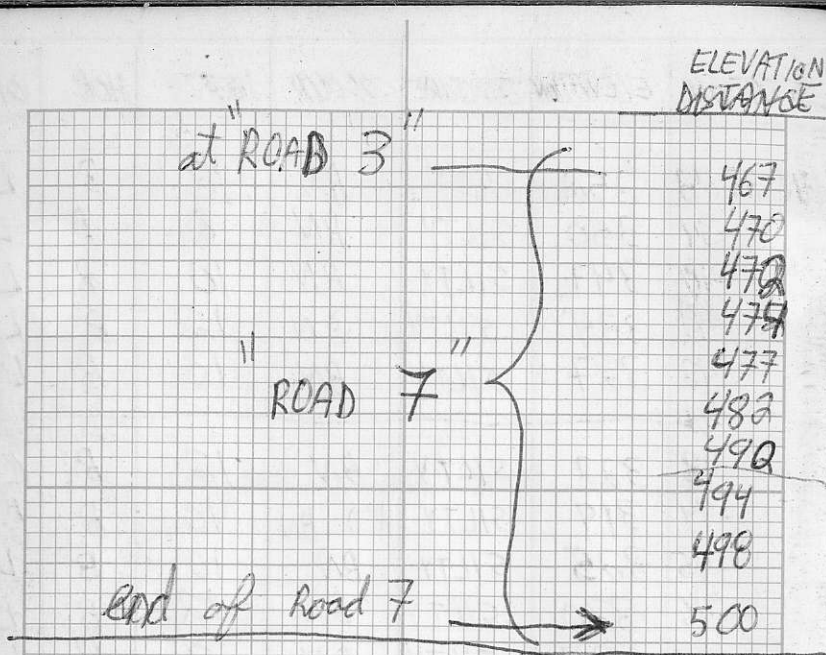

APRIL 8/83

STATION	DISTANCE ELEVATION	TEXTURE	COLOUR	DEPTH	HOR.	ORE
MNSB-19	0+00	SILTY	BN	12	B	L
-20	0+50	SILTY	BN	6	B	L
-21	1+00	SILTY	BN	8	B	L
-22	1+50	SILTY	BN	8	B	L
-23	2+00*	SILTY	BN	10	B	L
-24	2+50	SILTY	BN	8	B	L
-25	3+00	SILTY	BN	8	B	L
-26	3+50	SILTY	BN	6	B	L
-27	4+00	SANDY	BN	4	B/c	L
-28	4+50	SANDY	LIGHT BN	2-4cm	B/c	L
-29	0+00	SILTY	BN	4	B/c	L
-30	1+00	SILTY	BN	6	B	L
-31	2+00	SILTY	BN	8	B	L
-32	3+00	SILTY	BN	10	B	L
-33	4+00	SILTY/SANDY	BN	8	B	L
-34	5+00	SILTY	BN	10	B	L
-35	6+00	SILTY	BN	12	B	L
-36	7+00	SILTY	brick red	10	B	L
-37	8+20*	SILTY	BN	8	B	L



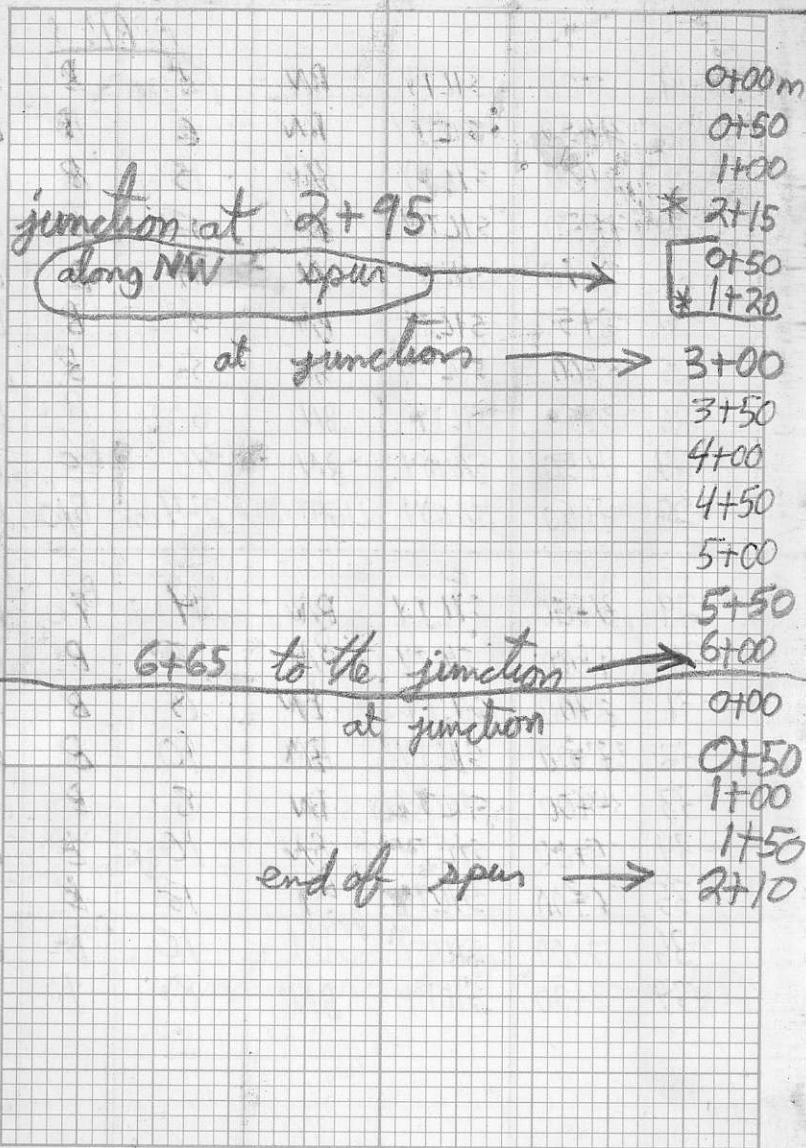

DISTANCE

STATION	ELEVATION	TEXTURE	COLOUR	DEPTH	HORIZON	ORG.
APRIL 7/83						
HNSB3-1	—	SILTY	BN	5 cm	B	LOW
-2	480 m	SILTY	BN	6	B	LOW
-3	477	SILTY	BN	8	B	L
-4	465	SILTY	BN	12	B	L
-5	445	SILTY	BN	14	B	L
-6	437	SILTY	BN	10	B	L
-7	450	SILTY	BN	8	B	L
-8	453	SILTY	BN	10	B	L
-9	452	SILTY	BN	6	B	L
-10	448	SILTY	BN	8	B	L
-11	450	SILTY	BN	12	B	L
-12	435	SILTY	BN	14	B	L
-13	430	SILTY	BN	12	B	L
-14	440	SILTY	BN	14	B	L
-15	442	SILTY	BN	10	B	L
-16	442	SILTY	BN	6	B	L
-17	448	SILTY	BN	8	B	MED
-18	452	SILTY	BN	8	B	L
-19						
-20						