

CONSOLIDATED CINOLA MINES LTD.

SKETCH SHOWING LOCATION OF DRILL HOLES IN CURRENT DRILL PROGRAM

SPECOGNA PROPERTY, QUEEN CHARLOTTE ISLANDS

~~APRIL 18, 1979~~
MAY 24

○ 79-7 *done* → 900' (now 800')

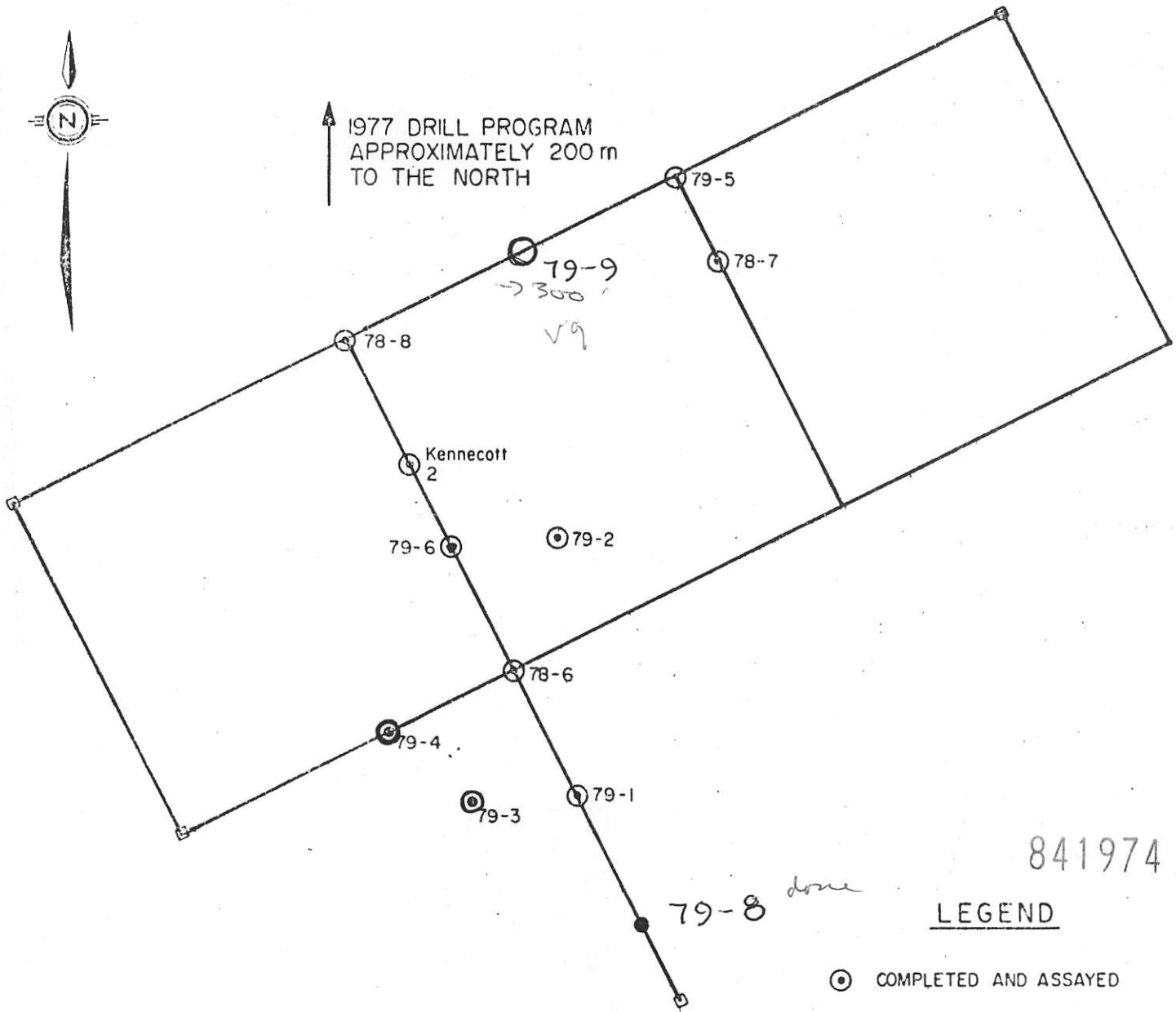

- LEGEND**
- COMPLETED AND ASSAYED
 - COMPLETED AND IN FOR ASSAY
 - DRILLING IN PROGRESS
 - PLANNED FOR DRILLING

SCALE APPROXIMATE

0 5 10 20 30 40 m

SUMMARY OF DRILLING

<u>HOLE</u>	<u>DEPTH AND GRADE</u>	<u>BEST SECTION(S)</u>
77-1	140' of 0.056 7.870	40' of 0.086
77-2	192' of 0.032 6.144	25' of 0.062
77-3	185' of 0.066 12.210	65' of 0.103
77-4	175' of 0.051 8.925	25' of 0.090
77-5	70' of 0.080 5.600	30' of 0.149
77-6	90' of 0.033 2.970	5' of 0.080
77-7	95' of 0.061 5.735	35' of 0.080
77-8	40' of 0.061 2.440	10' of 0.120
77-9	135' of 0.083 11.205	55' of 0.148
77-10	120' of 0.082 9.840	80' of 0.101
77-11	200' of 0.069 13.800	25' of 0.102
		25' of 0.104
77-12	200' of 0.092 18.400 /	95' of 0.122
77-13	185' of 0.080 14.600	75' of 0.111
	<u>1827'</u>	
78-1	400' of 0.060 24.000	47' of 0.100
78-2	400' of 0.060 24.000	153' of 0.100
78-3	420' of 0.062 26.040	80' of 0.144
78-4	347' of 0.060 20.820	67' of 0.100
78-5	506' of 0.040 20.240	60' of 0.100
78-6	586' of 0.148 86.728	79' of 0.860
78-7	600' of 0.070 42.000	200' of 0.10
		73' of 0.10
78-8	513' of 0.070 35.910	27' of 0.255
		282' of 0.101
	<u>3772</u>	
	5599	
79-1	545' of 0.051 27.795	26' of 0.230
79-2	591' of 0.102 60.282	66' of 0.456
		131' of 0.240

6735

487.784

= 18.10

SUMMARY OF DRILLING
(In feet)

HOLE

79-3	Upper Zone	0-52 ,	52 feet of 0.058
	Lower Zone	367-472,	105 feet of 0.080
	Best Zone	367-400,	33 feet of 0.184
	Total	0-472,	472 feet of 0.033
79-4	Upper Zone	6.5-85,	78 feet of 0.056
	Lower Zone	347-386,	39 feet of 0.053
	Best Zone	72-85,	13 feet of 0.114
	Total	6.5-465,	458 feet of 0.030
79-5	Upper and Lower Zones } Best Zones	0-354, 0-196, 0-85 , 59-85, 328-347,	354 feet of 0.082 196 feet of 0.101 85 feet of 0.189 26 feet of 0.461 19 feet of 0.256
	Total	0-550	550 feet of 0.061
79-6	Best Zones	0-46, 0-6.5, 268-281,	46 feet of 0.089 6.5 feet of 0.235 13 feet of 0.108
	Total	0-341,	341 feet of 0.045
	or	0-570,	570 feet of 0.037