

June 28/81 counts Traverse w/ Dave Anscott
S. McAllister

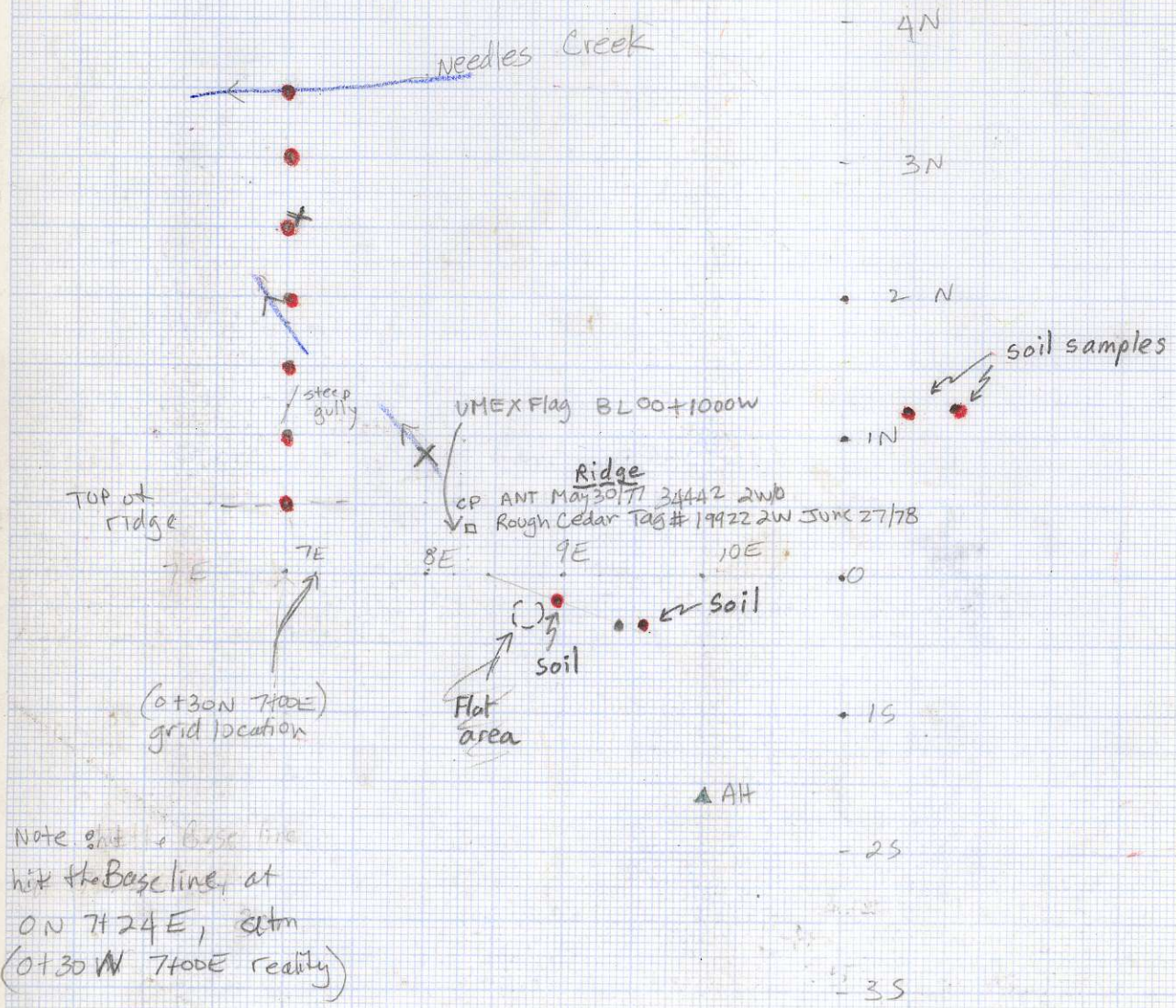

Courte Claim

June 28, 1981

PF+DH

Scale 1:5,000

Samples C-PF-(30) to C-PF-(33)

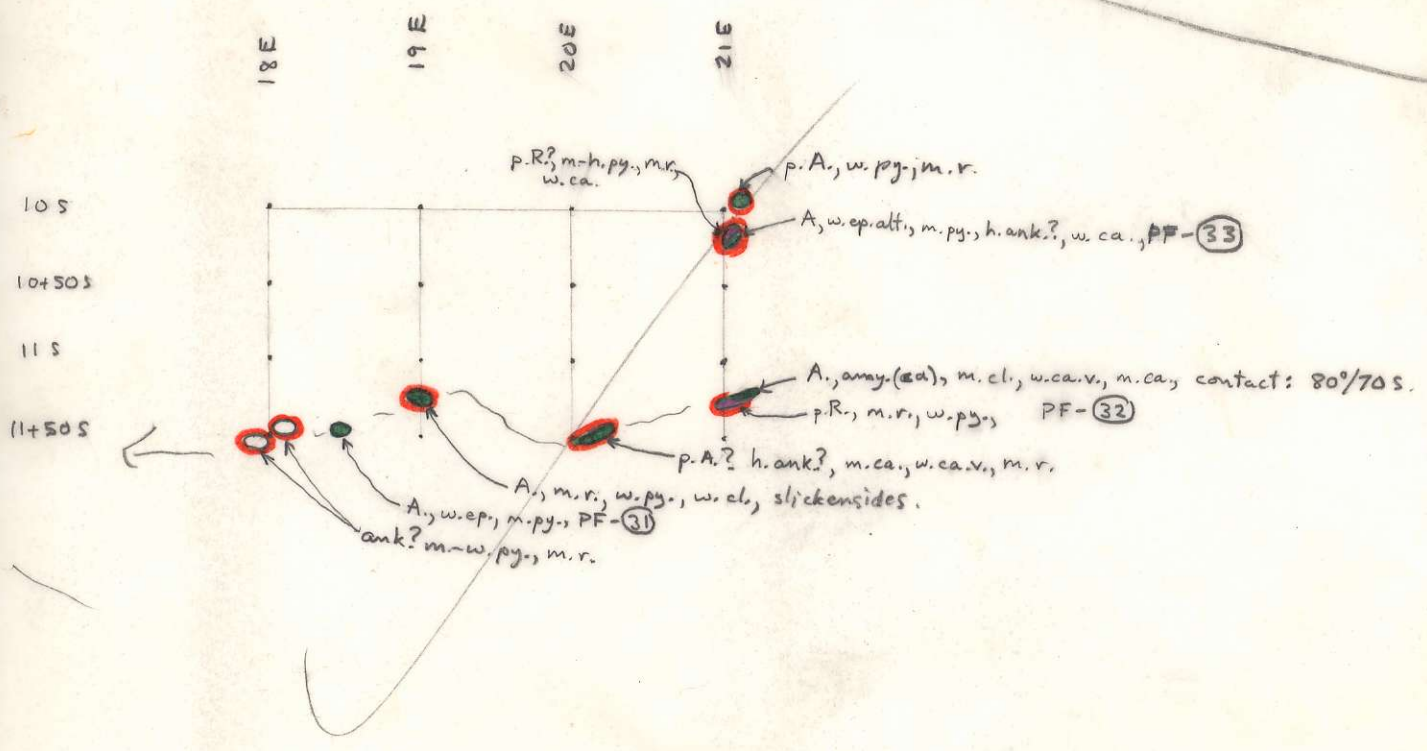
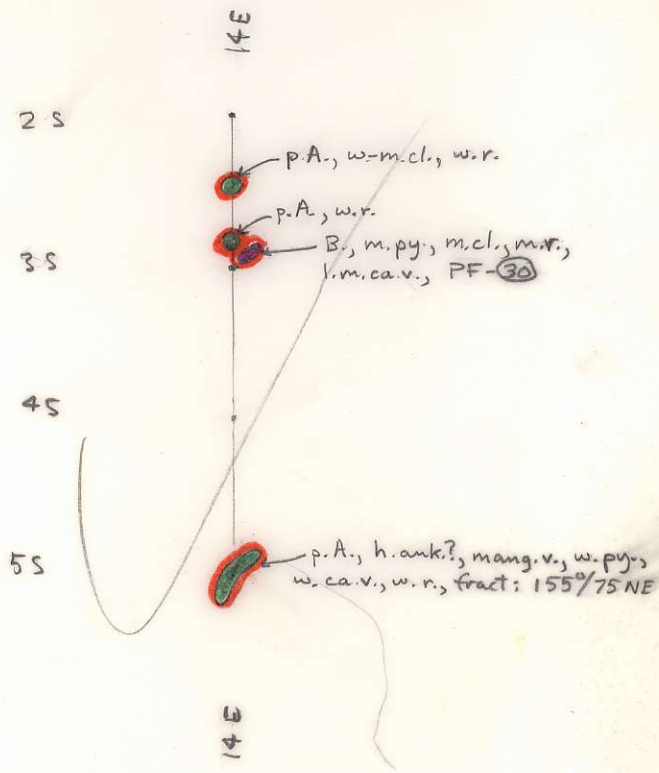

WCS-02999 T11
ATTITUDES
(100/40 N)

Project	NTS	Scale 1:5000	Page of	Traverse
Sampler SM/DA	Location, Target (words) COURTE FILL-IN		Sample Nos	
Date 20 Jun 81	photo no.		Cert. Nos	

- GOSSAN, MINERALS
- INTRUSIVE
- LIMESTONE DOLOMITE
- SHALE
- CHERT
- WATER
- ROCK
- SOIL
- SILT
- CONGLOMERATE
- VOLCANIC
- CONGLOMERATE
- SANDSTONE SILTSTONE

SPECIMEN SITE A,B,...; DO NOT WRITE ON OTHER SIDE OR USE COLOURS
 DON'T FORGET CONTOURS, DRAINAGE, NORTH ARROW, LAT/LONG, SAMPLE SITES, WORKINGS, TRAILS, GOSSANS, OBSERVED GEOLOGY: DEFINED — INFERRED --- ASSUMED.....

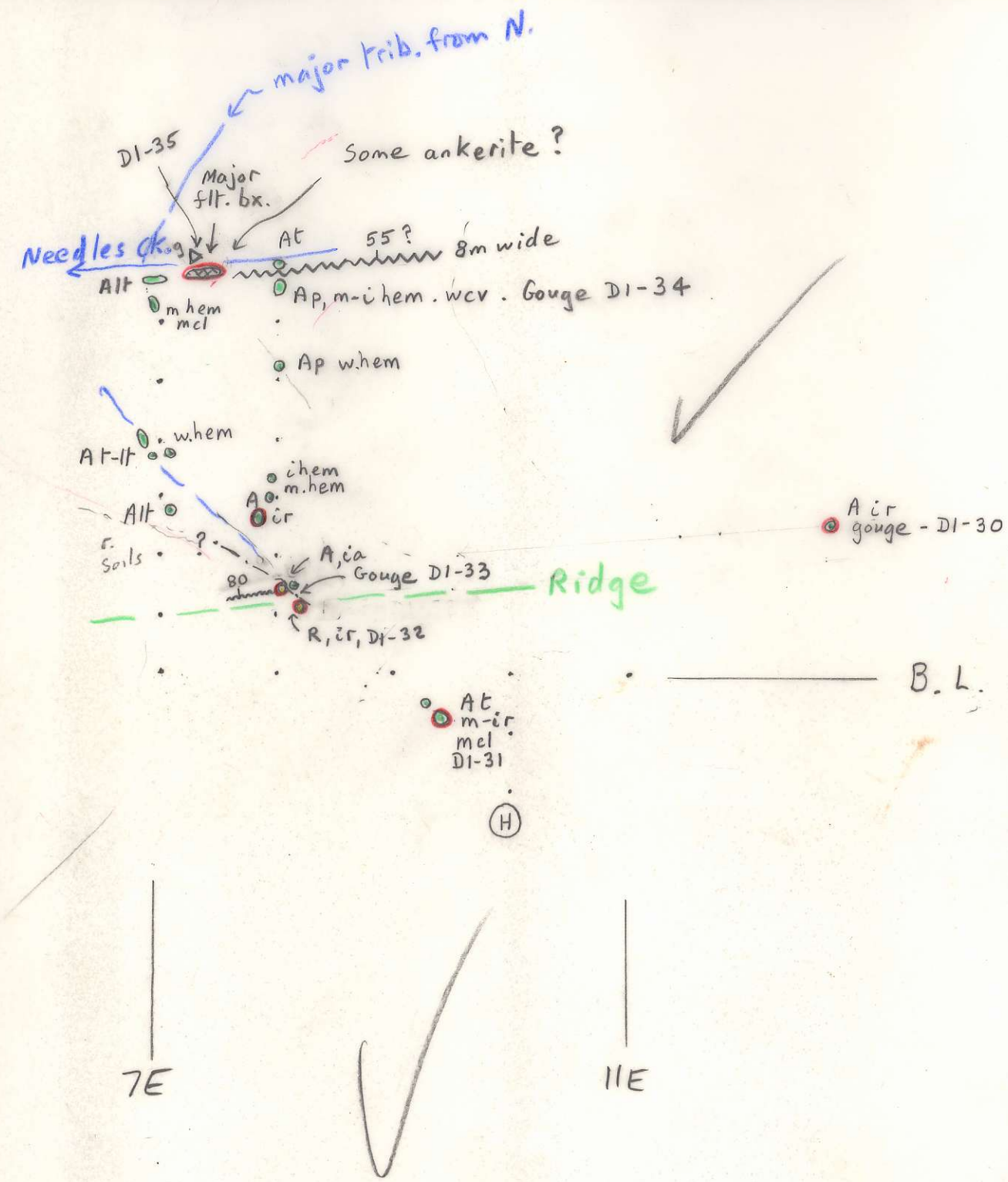

ASSAY: Cu Mo Pb Zn U W

DA COURTE

ZONE

RECCE

13 June

1 case beer → J.M.V

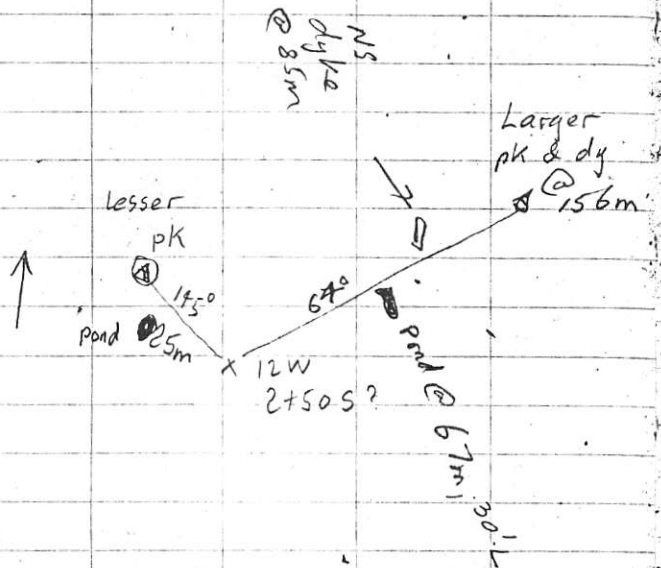

COURTE FILL-IN 29 Jun 81

st. @ (H) just S. of ridge ~19? E

0m. old 5x5 gy. A, sl.p, i.r & as rounded frags in grey gouge
SPEC of gouge C-D1-30

From 0m, head W, 86°

94m brn clay soil w/ hi. r patches
sample "A" 11+80E
0+20N

130m " " " " in st. sm gull
sample "B" 11+40E
0+20N

158m Turn L onto 42° → 0m

64m on ridge

96m on B.L. → 0m

Turn E on B.L.

115m to 10E

o/c 0m 5x5 A, m-i.r, mcl, sl.p | Head 110

C-D1-31

Also soil 5m to E "C" (or) brn clay

This pt. also edge grassy "beach" to S.

20m old on R, 5x5, as last, clearly Yakoun (frags?) Beach now vanished

50m, 5m to L., soil "D" or brn silt

85m D (Ab) A, rithg 20m to L. 9E 0+20S

Nice flat site just below

100m BL @ 8+47m

8E LINE

0+55N, 8+25E Top sm-gull
o/c 5x5 R? (cherty) pale gn, cr
✓ C-D1-32

0+78N, 8+13E gy. clay gouge,
looks like fit. / gull
Gouge C-D1-33
R siltols imm. below
A? gy, ia other side &
20 further down in
o/c. Sm? fit 80/80N

0+86N line hits gull, silt @
grid # pt.

1+30N o/c 5x10 A, gy, soft; cr with
7+80E

1+50N o/c ~~4x10~~ Ap, mf, o-w.r. m hem
7+92m E to line 8E

1+90N, 7+90E Ap, chem 5x5

2+58N

5x5 Ap, ~~dy?~~ Mn on frags.
in sm. gull ~150° w hem

→ 10x10 Ap, m-hem w cv. (both sides
of fault, 94/60N, hor. slicks
gy gouge C-D1-34
↑ l. r. ↓

gy. slide & sm. ck
20m S. of Needles ck & @
or possibly 112/50S
seems to become A frag
across fit.

7+34E } & 5m s. of ck.
3+50N } 5x10 A, agg. w/more
pytc shng & 50N
dipping face
Ank? L in this area.
Bx in ck S wall, 10m L, dip
alm. to 7E.
D in ck. Tourn? C-D1-35

7+85E ck. is @ 3+55S

7E

3+50N, S side ck, 6+80E, 10x30

Alt, sheared // ck & 50S?

v.l.r.

- ① Bx, ggy, gongy.
Upper end A, mhem, mcl
- ② A, t? ltly sh^{ltd} or bddd?
40-90 / 40-60N
- ③ Alt, w.hem (in few frags)
- ④ Alt, abund Δ. r w/hg, angular
w.cl.

C-D 1-36

- ⑤ Ap, Δ, angul. w-mr
- ⑥ Alt atm in place

hvy clay soils & w.r. Δ begins
again @ 0+80N

Line 30m too long; 24m E of BLZE

From B.L. / 7E (line done) SE 135

226m to maj. ck.

Turn down it. Om

13m	R	5x5	r	wh
50m	R	1120	r	wh w/cv. w/bk min if

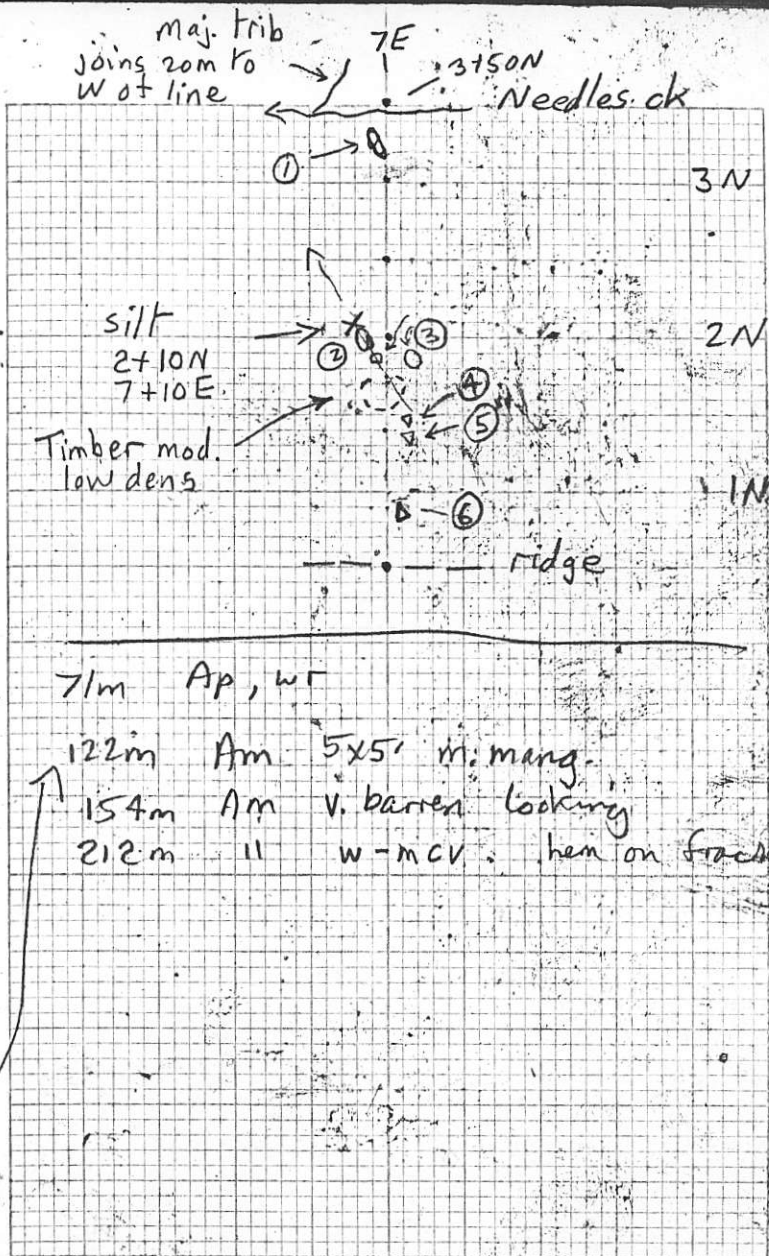

*

JUNE 28th BC-1M

Little BC, and since already defined
ON COURT FOR various

FILLING IN PICK UPS samples
taken at every

C-BC-52 interesting except one
changes gradient
intense calcite veining
and local rust, or ank!

C-BC-53 mod rust Andesite
not much alt. and only
weak fracturing

C-BC-54 silt from alt. some silt
in abundance 70% 30% sand
great silt!

C-BC-56 Rhy, very intense weathering
very intense rust!



C-BC-55 Andesite w/ in hem m py
w ep and thin fine chert
(hazy) w/Rhy. some and py.

R. D. PRINHAL LTD. MADE IN MANITOUBA CANADA
SASKIAWA WATERPROOF

METRIC
FIELD (S)