

M 921/2E

5

4

3

2

1

50°15'

50°00'



MINERAL RESERVE
O/C 432 81-02-20
SUBJECT TO CONDITIONS

C.A.S.
979(12)
PAR 1 PAR 2
1207(12) 1208(12)
PAR 3 PAR 4
1207(12) 1208(12)
PAR 5 PAR 6
1209(12) 1210(12)
PAR 7 PAR 8
1211(12) 1212(12)

STAR 100
1099(7)
SUE 1
85(4)

MIKE 7	MIKE 8
858(4)	859(4)
MIKE 5	MIKE 6
856(4)	857(4)
MIKE 3	MIKE 4
854(4)	855(4)
MIKE 1	MIKE 2
852(4)	853(4)

COQUIHALLA HIGHWAY (PROPOSED)
MINERAL RESERVE
O/C 568, 9-3-78
SUBJECT TO CONDITIONS

MINERAL RESERVE
O/C 2788 79-10-25
SUBJECT TO CONDITIONS

S.S.
1238(1)
15 UNITS

COURTNEY CR 2
1251(5)

S.S. M.S. PLAGER
1/2 WILD EACH SIDE
O/C 1242 14 APR 70
SUBJECT TO CONDITIONS

LEGEND
GROWN-GRANTED MINERAL CLAIM
REVERTED C.G. MINERAL CLAIM
FORFEITED MINERAL CLAIM
LEGITIMATE MINERAL CLAIM
LEGAL CORNER POST & TAC NUMBER 0348

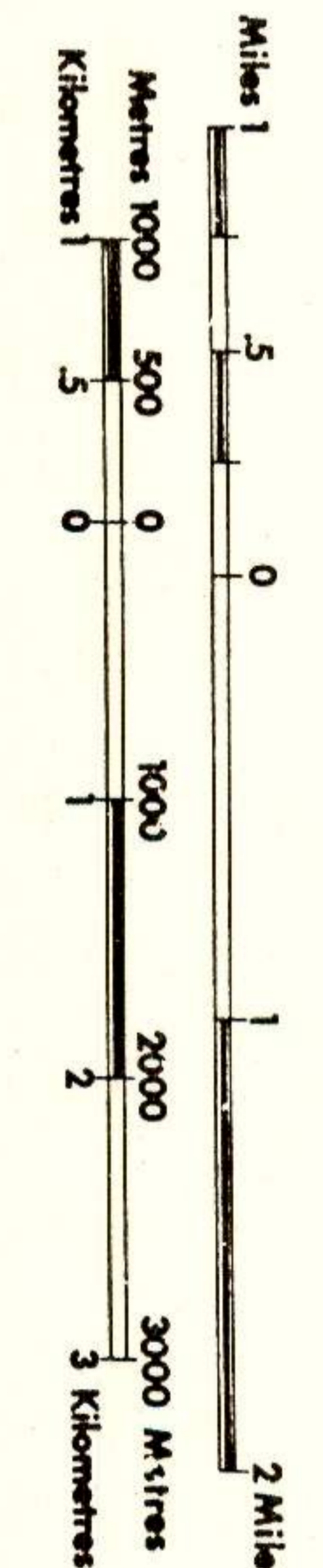

UNLESS VERIFIED OR SURVEYED, THE MAP POSITION OF A LEGAL CORNER POST APPLY TO THE OFFICE OF THE MINING DIVISION CONCERNED.
DATE OF MICROFILM: 82-02-11

NICOLA MINING DIVISION

10 SOUTH SEE MAP 92 1/2 E

DEPARTMENT OF MINES AND PETROLEUM RESOURCES
VICTORIA, B.C.

Hector 841887

This map is prepared to serve as a guide to the positions of located mineral claims and to show mine locations only.

For up-to-date information on claims in any area, consult the Mining Division.

