

COMMODORE  
 DDH 87-005  
 SECTION: 281°  
 -46°  
 1:500

Do At: 1:500  
 Collar: 5635694N  
 511904E  
 705.0m Elev.

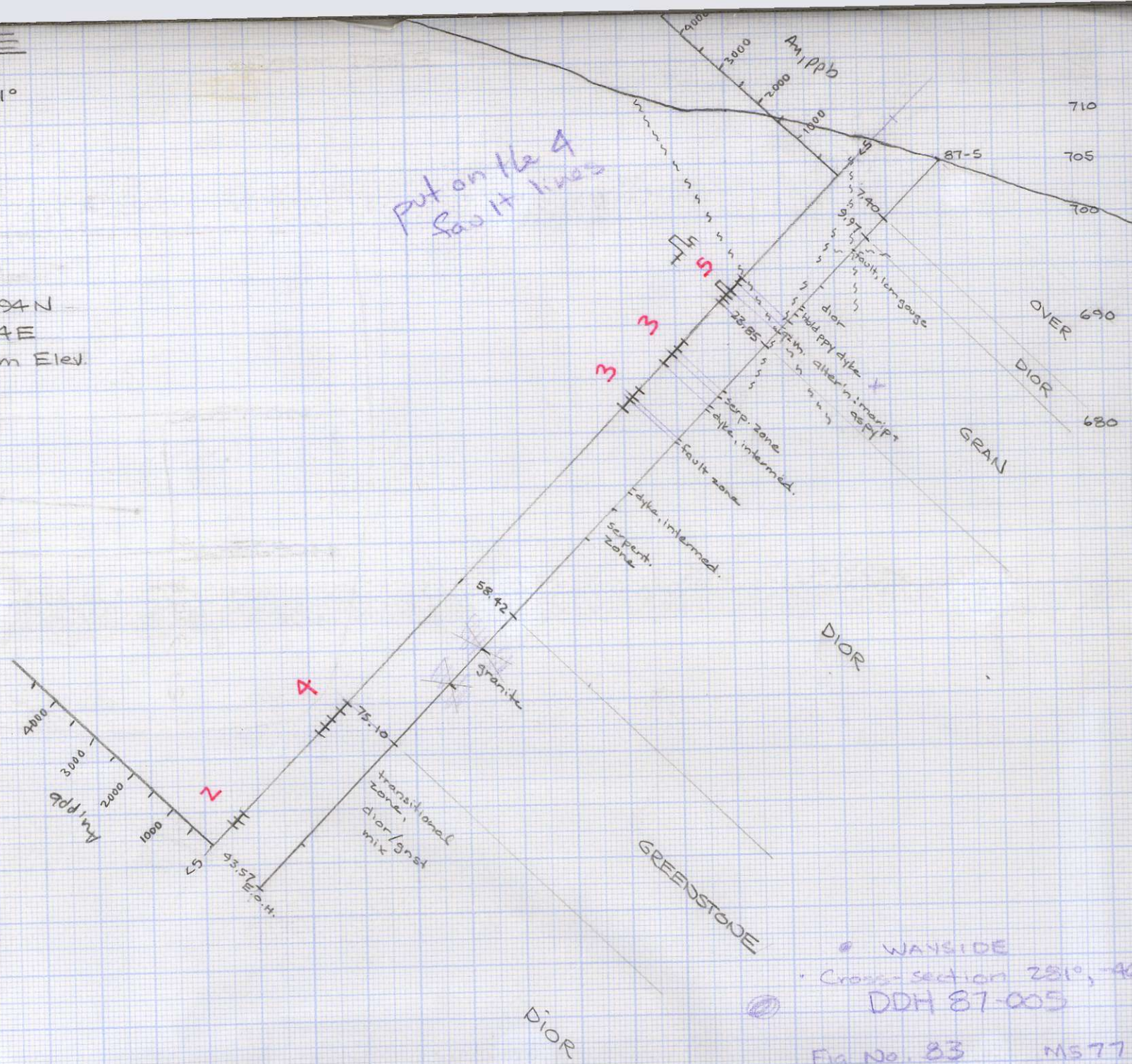

• WAYSIDE  
 Cross-section 281°, -46°  
 DDH 87-005

Fig No. 83 MS77  
 1:500

841454  
 Wayside

S-8

\* ADD TO CROSS-SECTION \*

87-5

FROM-TO(m)	LENGTH(m)/REC(%)	A <sub>u</sub> PPB	A <sub>s</sub> PPM	SAMPLE NUMBER
20.68-21.39	0.71/88	35	245	113367H
21.39-22.16	0.77/88	20	120	113368H
22.16-22.60	0.44/88	295	390	113369H
22.60-23.23	0.63/88	45	15	113370H
23.23-23.85	0.62/88	45	45	113371H
28.64-29.64	1.00/94	45	45	113372H
29.64-30.39	0.75/94	45	45	113373H
30.39-31.52	1.13/94	45	45	113374H
34.82-35.82	1.00/70	45	45	113375H
35.82-36.05	0.23/97	45	45	113376H
36.05-37.05	1.00/97	45	45	113383H
75.10-76.10	1.00/97	45	10	113377H
76.10-77.10	1.00/97	45	45	113378H
77.10-78.10	1.00/97	45	45	113379H
78.10-78.90	0.80/98	45	45	113380H
89.25-90.25	1.00/100	45	45	113381H
90.25-90.68	0.43/100	45	45	113382H

17