

McLEOD ZINC

PROJECT M472

LOCATION

The area of interest is situated some 40 km west and southwest of the town of Mackenzie in central British Columbia.

CONCEPT OF EXPLORATION

Adjacent to a limestone unit of the slide mountain group(?) there are known occurrences of pyrometasomatic(?) mineralization containing sphalerite, molybdenite, galena and chalcopyrite associated with magnetite. The unexplored portions of the slide mountain group(?) in the area could well host similar mineralization or possibly sediment hosted Pb-Zn deposits.

HISTORY OF WORK

Iron, zinc mineralization, .6 m thick by 60 m, in length, sandwiched between an overlying marble unit and an underlying highly altered garnetiferous zone was discovered and staked (12 unit claim) in June 1977 by Chevron. Earlier in 1977 and in 1976 we conducted geochemical soil and stream silt surveys in this area in a search for uranium. Some of these samples were analyzed for base metals and five anomalous zones outside the claim boundaries were indicated. These are indicated on the attached map in purple.

PLANNED WORK

Field check all presently known geochemical anomalies. Prospect and map the mining claim. Prospect all mapped outcrop areas of the Slide Mountain group.

BUDGET ESTIMATE Detail attached - Can. \$16,000.

MAPS ENCLOSED

1. Location Map
2. Geological Map

D. ARSCOTT
February 7, 1978.

BUDGET

McLEOD ZINC - U472

Wages	-	14 days	
		G. W. Laforme	1,200.00
		2 Assistants - @ 1,250.00 mo.	820.00
		- @ 1,150.00 mo.	786.00
Food	-	14 x \$15. x 3	630.00
Accommodation			820.00
Truck			140.00
Gas			150.00
Power caps, fuse			100.00
Assays			700.00
Helicopter	\$315. + fuel	x 25 hrs.	8,500.00
Report, drafting, etc.			700.00
			<hr/>
			\$14,546.00
		Cont. 10%	1,454.00
			<hr/>
		Can.	\$16,000.00
			<hr/>

CHEVRON STANDARD, LIMITED
MINERALS STAFF

GENERAL LOCATION BRITISH COLUMBIA

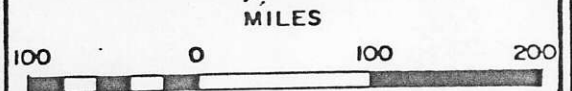
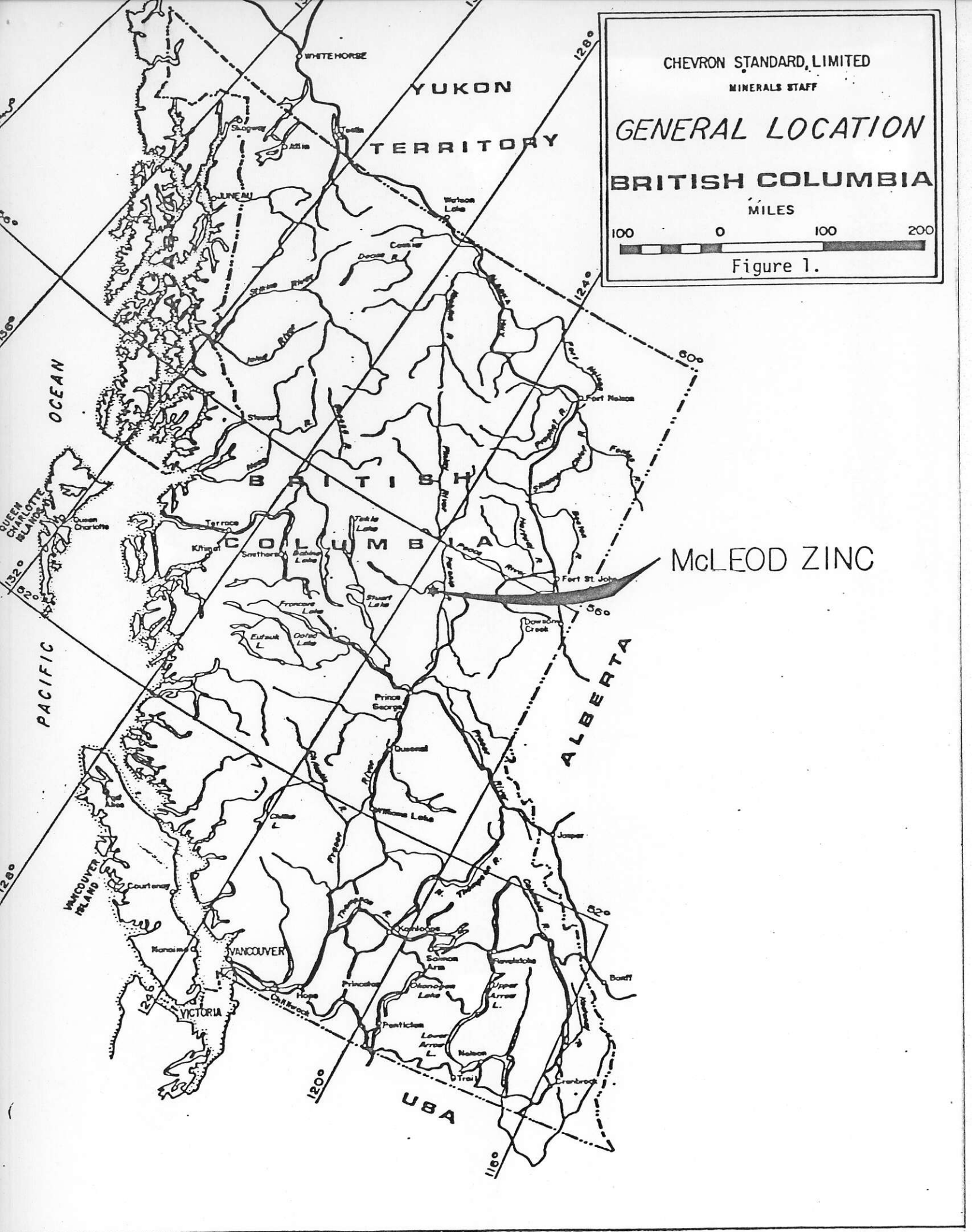
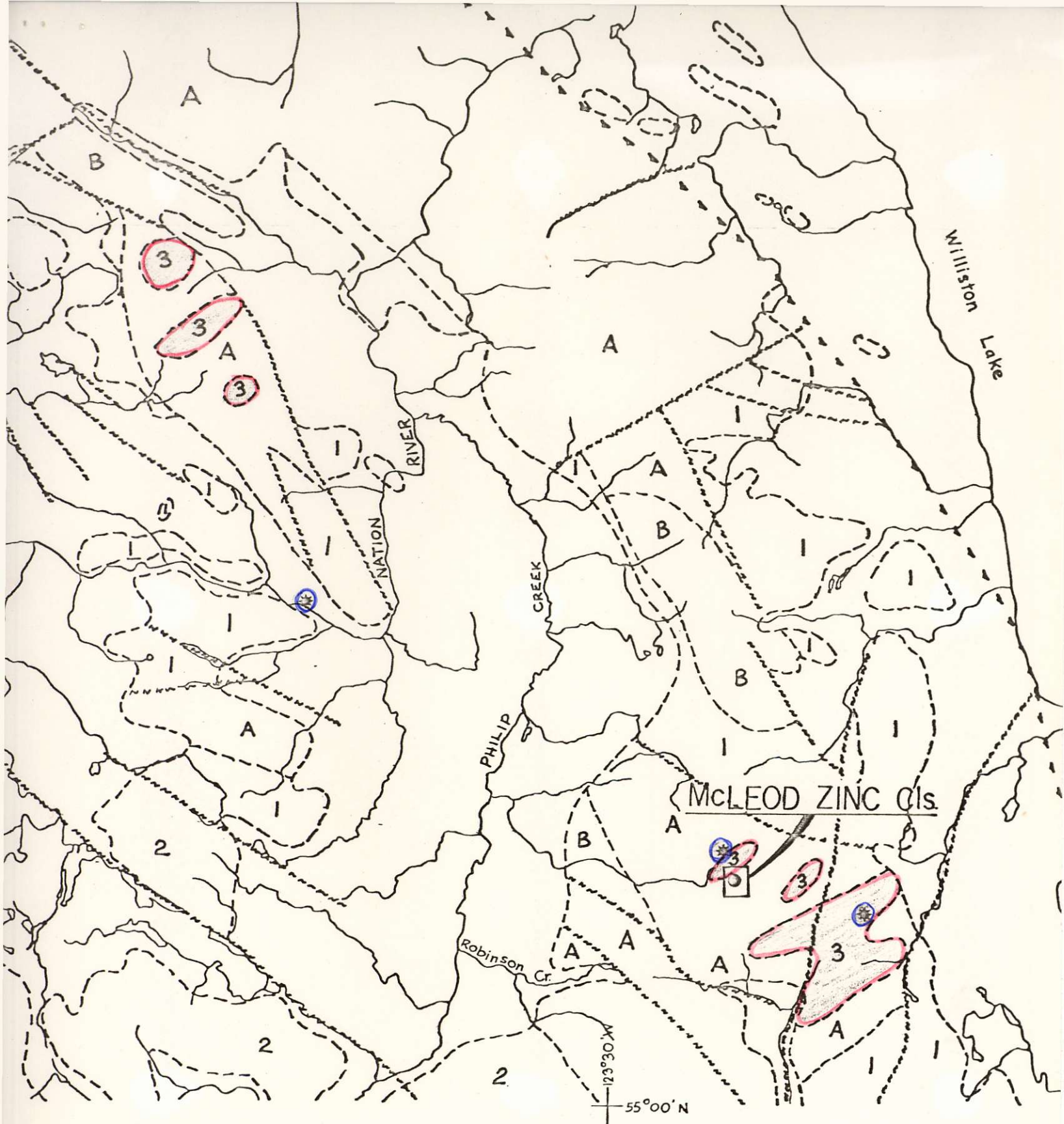



Figure 1.



McLEOD ZINC



-  Zn/Pb Geochem. anomalies
 -  Zinc showing
 - 3** Granite, Granodiorite
 - 2** Takla Group (Basic tuffs, agglomerates, flows)
 - 1** Slide Mt. Group or Cache Creek Group (greenstone argillite, limestone, slate, banded quartzite)
- WOLVERINE COMPLEX**
- A** Quartz-mica schist gneiss
 - B** Amphibolite, pseudodiorite

McLEOD ZINC 1977

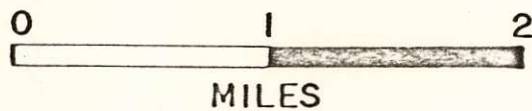

MCLEOD ZINC

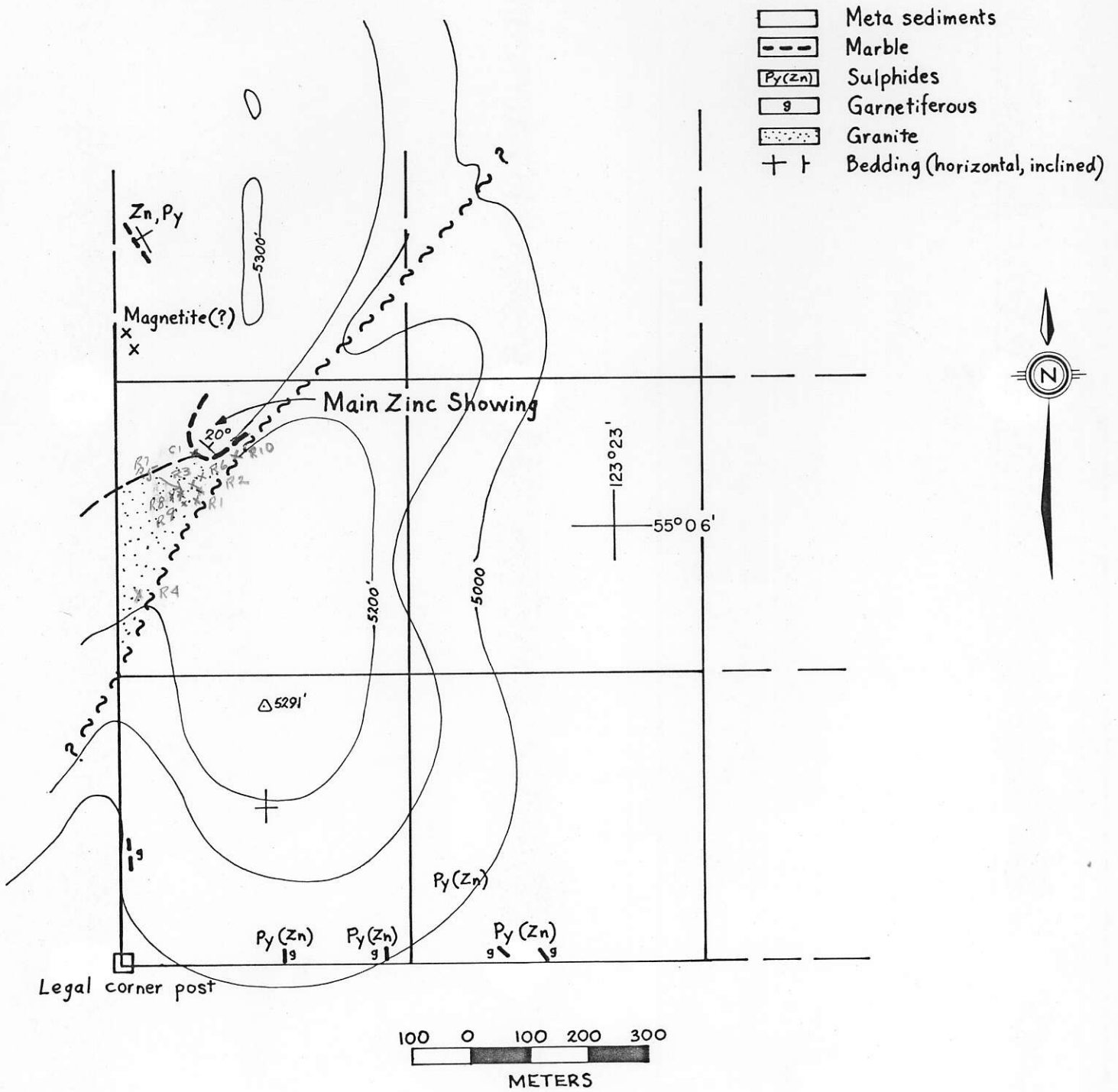

CLAIM LOCATION MAP

McLEOD ZINC 1977

SCALE IN MILES

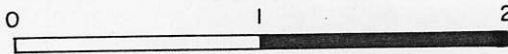

A AREAS OF 1977
B NATION RIVER
C URANIUM
D EXPLORATION

