

30

KC

KC

stream

841023
King-Courte

1981

J.H. - SOILS

K-C REGIONALS

JH SOILS ^{322° NW}

11 MAY

20-2500 South

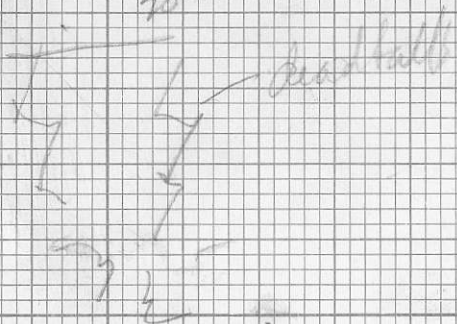

10

Station

Soil

J.H.
May, '11

1. grassy mountain meadow
spongy with water; sample
mostly organic; clay content.

- samples 1-5 reading 322°
at landing site H

2. 4-5" organic b d grey
smooth clay material

filled with shattered rocks.

- 110 m NW. from 2, cross

2° stream (width), no

worthwhile silt.

- am going downhill about
25°, scattered deadfall

open undergrowth, mossy
hillsides, extremely wet.

3. on hillside moss covered
small shrub growth, scattered
massive trees, nothing
and weed.

A. about 1' moss organic
and rotted wood.

B. grey clay with fl. br
and grey-white spots (looks
like ash.)

- 100 m small stream on
left running downhill
with me.

05

on now
following
N.W. bearing
290°

04

cliff 55°

03

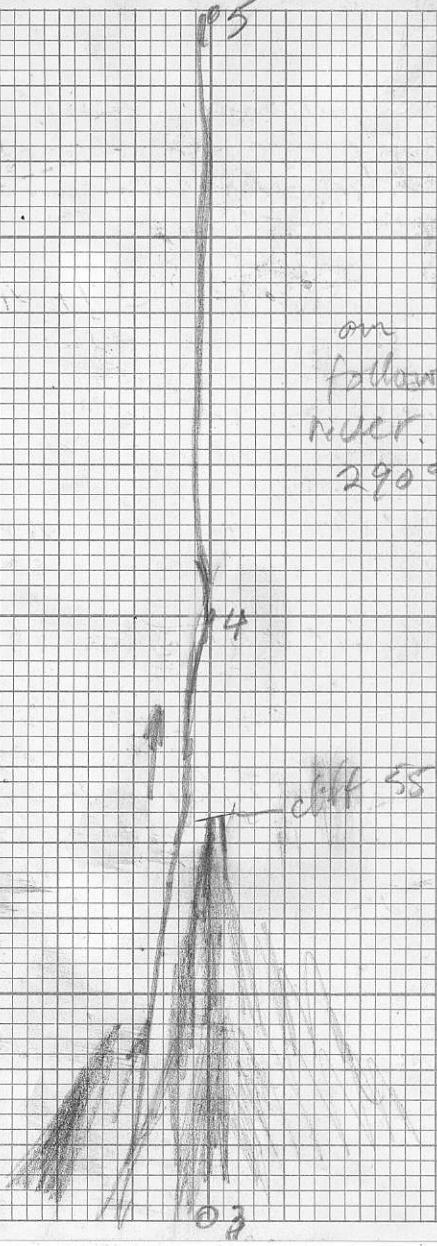

Station

JH May 11

- 4
- a 2" organic (moss)
 - b grey-brown material with a green-grey clay with rust spots

Silt sample # K-C J.H. 4a
SILT.

5. "a 4-5" organic
- b. clay "rock" red brown earth, rock fragments
- 30' above c. river on bank.
- hillside (down) about 30°

6. almost flat, about 10° grade.
- a 4" moss organic
 - b coffee coloured earth 15% clay
- came to intersection of two stream, dangerous cliff between of loose rock

7. in river bank just below intersection.
- a moss organic
 - b fractured rocks some lt brown material



80°
cliff

deadfalls

57.

J.H.
May 11

8

steep hillside, heavily
wooded, much decay.

a. 1' organic

b. ~~lt. grey~~ lt. br 40% clay
~~grey~~ silty sh

9. b. lt. grey, silty + clay

a. 2" organic layer
on top

- 50 yds from main stream

- downhill, bad falls trees

10.

steep banks, many
trees fallen across streama. 3" moss + tree rot
organicb. silty material, above orange
with 20% clay, in between
numerous 6" rocks, about
same size as main one
I following

11.

a. organic

b. silt + clay lt. br.

- with black spots

- 5 m from stream, fairly
level, terribly rotten

Confluence 10
Stream

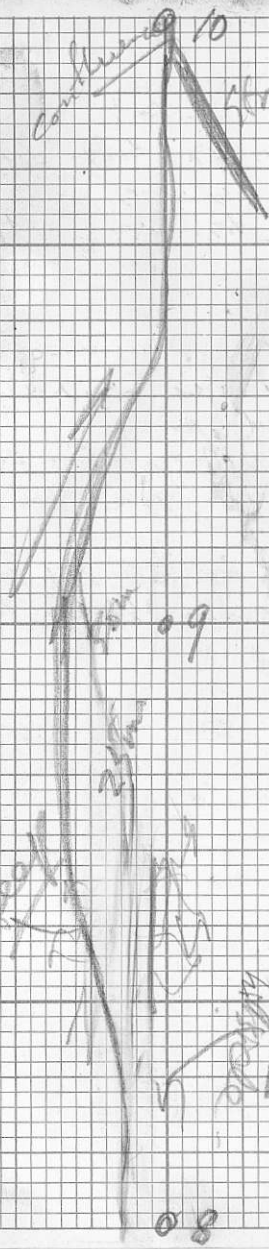

60

80

Station

J.A. May 11

12

a 2nd organic (mostly
rocks)
b silty non-org. interval
brown to lt br.
Fragmented rocks throughout

13

a 2nd bl organic
b 1st red-brown +
hardened earth
c lt br brown, silty
clay 15%

14

from under fallen (root system)
tree, mined lt br. to black.

Old
bank



in

Handwritten scribbles or symbols on the left side of the page.

Handwritten scribbles or symbols on the right side of the page.

J. H.
May 11

R. D. PENHALL LTD. MADE IN VANCOUVER CANADA
DUKSBARK WATERPROOF

METRIC
FIELD (S)

14

13

fairly
flat
land

highest

19



May 11
J. H.

R. D. PENHALL LTD. MADE IN VANCOUVER, CANADA
DISKSAK WATERPROOF

0851
- 0547

0304
29

METRIC
FIELD (S)

KC

JH

14 May

3/10

~~Sleep~~

15° NE

Sample

J.H. May 14

7. KC-JM-440 - bl. organic

0

- 2040 bearing 15°

- 25° downhill, scattered cedar

8. between 10-15° usries

gr. br. under high alt. grass
and moss, smooth, loam,
with clay.

1840 1 alt.

- hit creek at 318m

- join Bruce + Colin and
take a jog at 310°

9. 100 m from deviation along
✓ ~~from~~ 310° at 1820'

gr wood rot + organic

bl. br. soil with clay
spots.

- 130m into jog turn due N
separate from Colin + Bruce

- location is H with pools

- 580 m from start 30° hill

10. 4. a. 3" bl. org

bl. br. with rust spots.

alt. 1720'

380° N.W.

head 360°

27

stopped
only
in between

24

meadow
and
pond

23

Station

J. 14 May 74

#11 1000 m from beginning
1460 elev

b. reddish-brown organic
clay

- change heading to 20°

- 1100 bearing now 60°

#12 1280 m

elev. 1240'

b. gr. wh. clay subsoil
with rust spots

1300 m heading 20°

#13 1400 m lt. br. with organic
content

elev 1260'
head N

#14 1600 heading now 350°

a. 3" organic

b. chalky grey volcanic
clay with brown
substrate

#15 elev 840

b. rusty red sand
50+ slope

R. D. PENHALL LTD. MADE IN VANCOUVER, CANADA
DUKSBAR WATERPROOF

METRIC
FIELD (S)

rolling
high meadow

06

05

Sahara

J. A. King 12

209 Des. 440 head 350

ca. 1.5 lb.

to cool black, smooth
& clay

- 2040 Int Stream

KC

JH May 15/81

1/0

↑
10.4
DOWN

Station.

J.H. May 15

Landing Site - in bowl behind peaks, snow on peaks

0 - heading 80° down into stream at 1° downhill.

- at 162 m 80° encounter small stream flowing right to left at \approx 30° downhill. We are moving at about 20° across hillside.

- at 187 m cross another small stream same as above.

1. dk. bl. organic with some (faint brown) interminably. \approx elev. 1860'

- at 260 m change bearing to 360° hit bigger stream raw rock bed, same as previous orientations. \approx elev. 1840'

2 a. organic
b. lt. grey ashy substance with pale bit of clay
- about 8 m from down hill stream
Elev. 1600'

3 elev. 1300' a. silt-organic
b. red brown made up of silt + clay.

R. D. PENHALL LTD. MADE IN VANCOUVER, CANADA
DUKSBAR WATERPROOF

METRIC
FIELD (S)

diff. lit

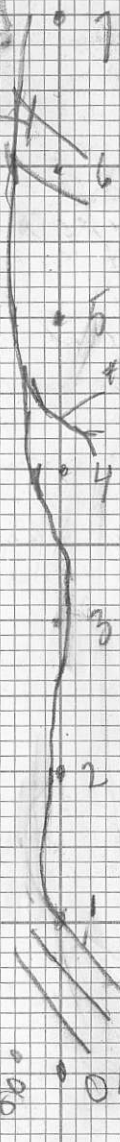

4.19 Silt

change bend
to 360

6-00
OH

Station

JH May 1-5

- crossed creek about 550 m.
- crossed stream 700 m

4. lt. br. with wh. gr. clay
+ rust spots + silt.
elev. 11200
- 862 m silt #19.

5. elev. 11001
a. 3" organic
b. lt brown + grey clay
with silt + rust + spots

- 1150 m hit small creek
take silt #21
elev. 850.

6. elev. 800
gr. br. composition with silt
and lot of clay
- at 1200 hit creek

7. elev. 650
dk + lt brown earth
- heading 340°
- hit intersecting stream
1450 m

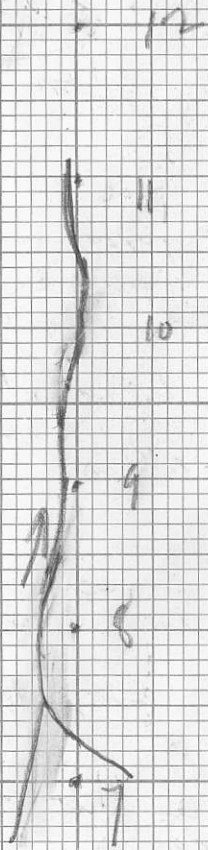

Station

J.H. May 15.

8. elev. 500'
change bearing to 320°
to meet stream
— lt. brown with grey clay
& rust spots mixed
with rock fragments.

9. elev. 400'
bearing 340°
a. reddish-brown
with pebbles + clay
b. grey clay with silt.

10 elev. 275'
bearing 320°
— red brown stream bank
soil with rock fragments.

11 elev. 200'
bearing 320°
— orange-red sandy
soil with organic
content, light & loamy.
— 2300 m hit stream
intersection

200 m interval



18 MAY

JH

• 5

KC

SOILS

• 4

• 3

• 2

• 1

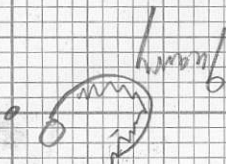

Station

May 18, J.H.

0 quarry, lt. br. topsoil
KC-J.H.-28 mix with some organic
heading 70°

1. 0.3" organic & roots
b. lt. br. to red br. composite
(29) c. grey sludge filled with small rocks
bearing roots 360°

2. 4" bl. organic
(30) b. grey-white mixed red
with many small rocks.

3 a 3" organic
(31) b. grey sludge, small stones
c grey → red brown banding
- turn to 240° on
secondary road

4 a. mixed up, lt. br.
(32) b. grey clay with rust
c. white clay with
spots of other colours

5. lt. reddish brown slash mix
(33) with rock & organic content

10

9

8

7

6

5

Station.

May 18, J.H.

- back on main road at 3 (31)
heading 20°
- 70 m / change to 260°

6.

- (34)
- a. 3" organic
 - b. mixed homogenous gr. br.
with much small voids
- 100 m from #6, go new road
at 10° NW.

7. on sec. road 100 m. from
(35) turn-off.

- a 6" organic
- b white clay. (some soil)

- travelling 220° from fork in
road + sec road above.

8. a. 5" b. organic

- (36) b. lt. br clay + soil with
rock fragments

a

9. heading now 260°

- (37) - mixture over outcrop
much rock fragments

- 9+80 - road going right-up hill

15

14

13

12

11

10

Station

May 18 J.H.

10. lt. br. + rock frag. mix
over rock outcrop (argillite)
— change heading to 240°

11
(39) br. with lighter soil under
with rock frag over outcrop.
120m heading 320°

12. lt. br. soil with dk spots
and rock fragments
(20)
120 to main road

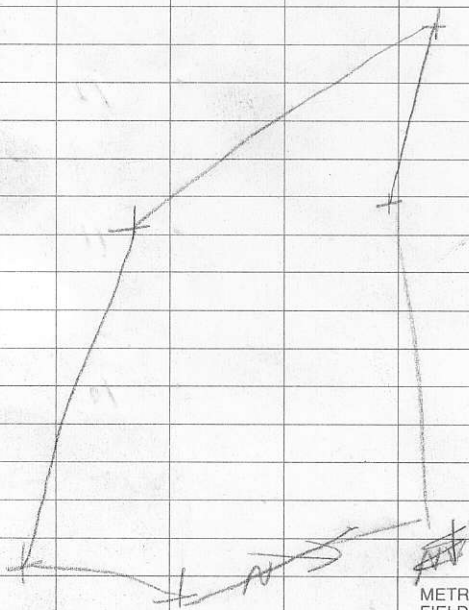

KC.

JH May 21 / 81

Station

R.T. J.H. May 21.

3 Lt. br. slash mix with rock
(46) and organic parts.
elev. 440'

- change b. at 3+30 to 190°

- change b. at 3+160 to 240°

4 Lt. br. slash mix
(47) elev. 360'

- claim post. at 47180

CHRIS #5 P.N. 35 + #2 P.N. 4E

April 26, 1940

Union Miniere + Exploration
Mining Corp. Ltd.

5 heading 200°
(48) Lt. br. + white soil + clay
with rusty anthracite.

6 elev. 220'
(49) - br. rocky slash soil

- hit road at 100'
elev. 180'

end of traverse

May 22

King

21

Ret.

20

~~Ret.~~ King

19

Court.

- sample nos. KC-J.H. 43 → ?

Road Tr.

Station

J.H. May 21

Start of traverse, road end cul-de-sac
heading 50° from 0 point

O. samp. # 43. - dk. br. slash road mix.
(43) elev. 600'

- at 115 m hit road from higher
up the mount. heading 90°
join it and change heading

- at 185 m hit another road
coming down ~~at~~ towards me
at $\approx 30^\circ$, hits present
road and changes to 90°

1. just below intersection of
(44) 2nd road.

a. 1' organic

b. 3' H. br. reddish hard clay

c. grey rock clay
elev. 640'

(45) 2. bl. + gr. clay mix with
rust spots.
elev. 570'

- at 20 m bearing now 70°

- at 170 m change to 220°