

841013
King-Courte
1981

KC

PF

12 May

PF King-Courte Regional May 12, 81

- ① andesite-basalt (dark grey) dyke
strike 0° dip $\sim 30^\circ$ E.
amigdaloidal
cutting massive calcitized
→ altered rock on either side
KC-PF-⑧ med. fract.
- ② dacite-andesite dyke with calcite
in vesicles. strike 160° dip 30° E.
- ③ Rhyolite dyke st. 140° d. 30° E
Blocky fract, 2 m. wide
200 m up river → Dacite eggs
- ④ Very large massive blue rock
with large inclusions throughout
KC-PF-⑨
- ⑤ Andesite with calcite in vesicles
- ⑥ ~~Very altered calcite rich rock~~
med. fract orange on fract.
- ⑦ Very hard And. dyke
st. 170° dip near vertical 80° E
- ⑧ And. Dykes striking 150° d. 70° E
Dacite also also st. 100° d. 20° N
- ⑨ Solid hematite float.
- ⑩ Large bed of altered calcite
rich rock cut by rhyolite dyke
→ rich in pyrite, st. 90° d. 20° N
which in turn is cut by dark
andesite to basalt dyke, st. 20° d. 40°

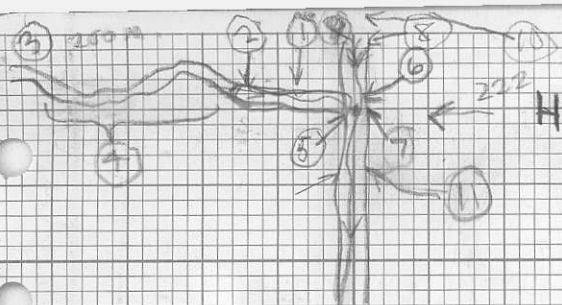

PF King - Courte Regional May 12, 81

(11) cut by andesite dyke
st. 160° d. 80° E

(12) massive bed of calcite rich altered rock cut by rhyolite dyke
st. 90° dip 45° S
KC-PF (11)

(13) Faults & fractures striking 30°

(14) change in rock type to inclusion rich blue rock

(15) cut by rhyolite dyke
st. 30° , vertical

0/65 m,

(16) cut by and. dyke st. 140° d. 30° E

0/200 m,

(17) 0.250 m cut by narrow green dyke
dacite?

(18) Cut by pyrite rich and. dyke
st. 100° d. 20° N

inclusion rich blue rock seems to have bedding planes with
st. 70° d. 15° N

(19) KC-PF (13)
conglomerate looking blue rock,
probably inclusion rich volcanics

(20) Bed's Str. $\sim 100^\circ$ d. $10-15^\circ$ N

(21) Rhyolite cut by some
Andesite dykes.

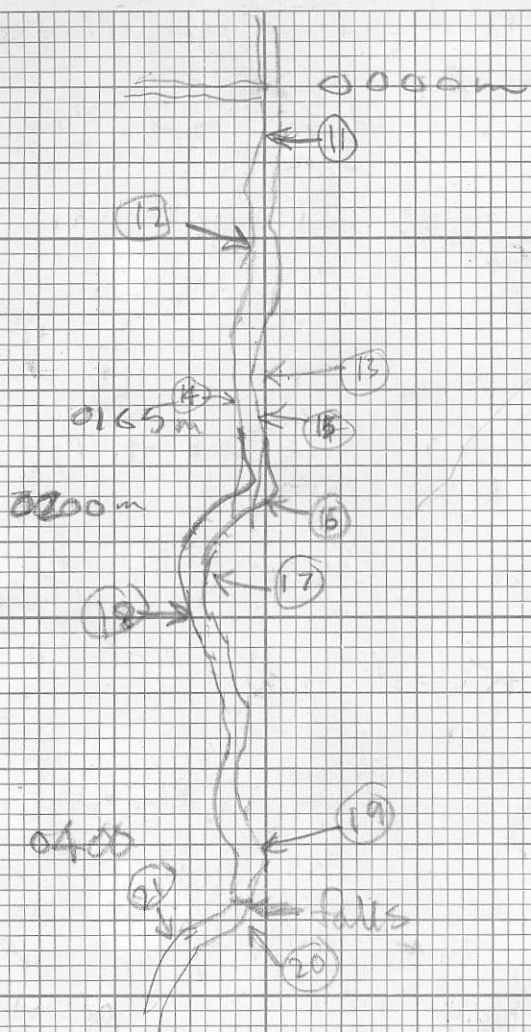

PF King-Courte Regional May 12, '81

(21)

(22) Back to intrusion rich rock
cut by pyrite & calcite
rich rhyolite dike st. 140° d 45° E

(23) cut by many Rhyolite dykes

(24) Andesite KC-PF-(14)

(25) Pyrite rich fault st. 130° d 20° SW
KC-PF-(15)

(26) 1000m Intense fract
intense calcite veining
light blue-grey rock
KC-PF-(16)

(27) Andesite

(28) Altered and calcite rich rock
rusty fractures

(29) Dacite outcrop

(30) Basalt ^{Andesite} outcrop pyrite rich
very rusty fract. KC-PF-(17)

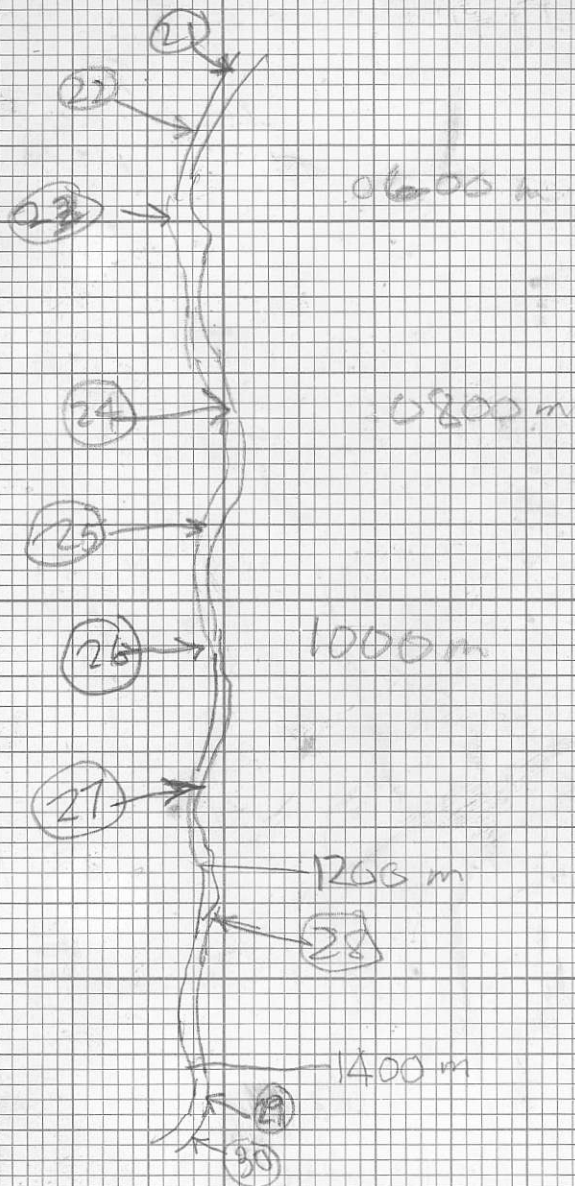

PF King-Courte Regional May 12, '81

R. D. PENHALL LTD., MADE IN VANCOUVER, CANADA
DUNSBRAK WATERPROOF

METRIC
FIELD (S)

KC

DH

12 May

MAY 12, 81

KC-DH 12-27

DEC NO.

DESCRIPTION

28°	12	GREY BROWN SILT		
3°	13	MED-LT BR. STREAM SILT		
2°	14	LIGHT BR		
3°	15	MED-LT BR		
2°	16	MED BROWN-ORANGE SILT		
3°	17	MED BRNBY SILT		
7°	18	MED BRNBY SILT		
1°	19	GREY BROWN SILT		
2°	20	MED BROWN SILT		
3°	21			
3°	22			
2°	23			
2°	24			
2°	25			
1°	26			
2°	27			o

R. D. PENHALL LTD. MADE IN VANCOUVER, CANADA
DUKESAK WATERPROOFMETRIC
FIELD (S)

MAY 12/81 KC-DH

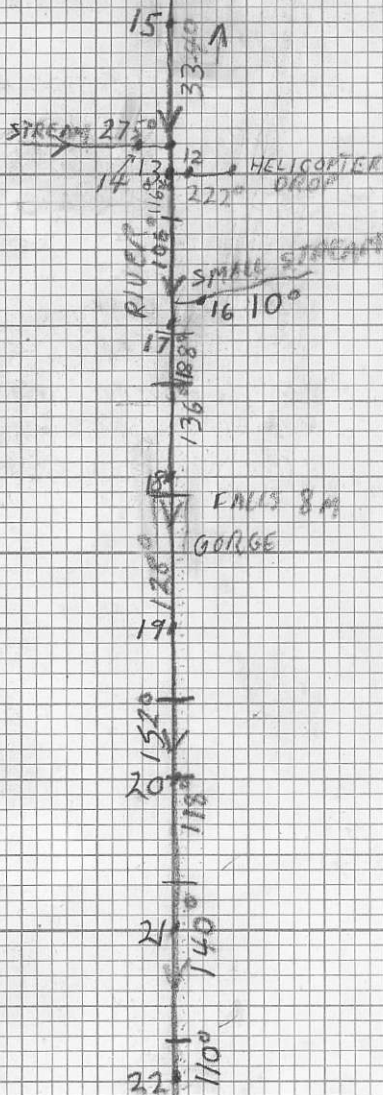

MAY 12/81

KC - DH

23 78°

1560

STREAM

25 24

1560

26

27

1320

FINIS

Project P. Fagerlund	NTS	Scale 1:10,000	Page 1 of 1	Traverse
Sampler D. Hodge	Location, Target (words) King-Courte Regional		Sample Nos PF-8, 10, 17	
Date May 12, 1981	photo no.	Cert. Nos		

W.S. 6662-0-CM ATTITUDES 100/40 N
 SANDSTONE SILTSTONE
 CONGLOMERATE
 VOLCANIC
 SPECIMEN SITE A.B...: DO NOT WRITE ON OTHER SIDE OR USE COLOURS
 CHERT
 SHALE
 LIMESTONE DOLOMITE
 SILT X SOIL
 INTRUSIVE
 GOSSAN, MINERALS

DON'T FORGET CONTOURS, DRAINAGE, NORTH ARROW, LAT/LONG, SAMPLE SITES, WORKINGS, TRAILS, GOSSANS, OBSERVED GEOLOGY: DEFINED --- INFERRED --- ASSUMED.....

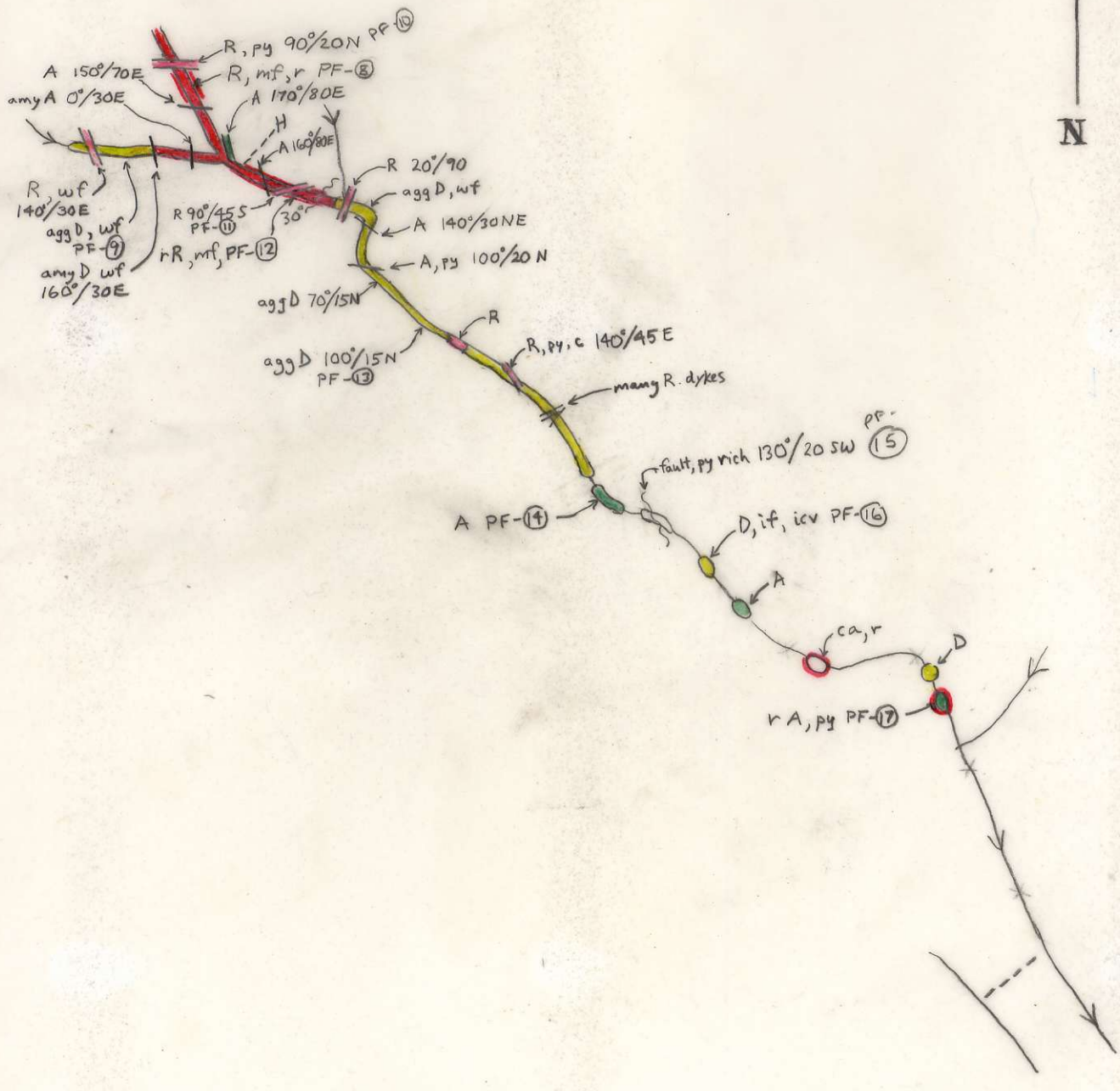

ASSAY: GEOCHEM: Cu Mo Pb Zn U W

KC AREA - KC-DH 12-27

N ←

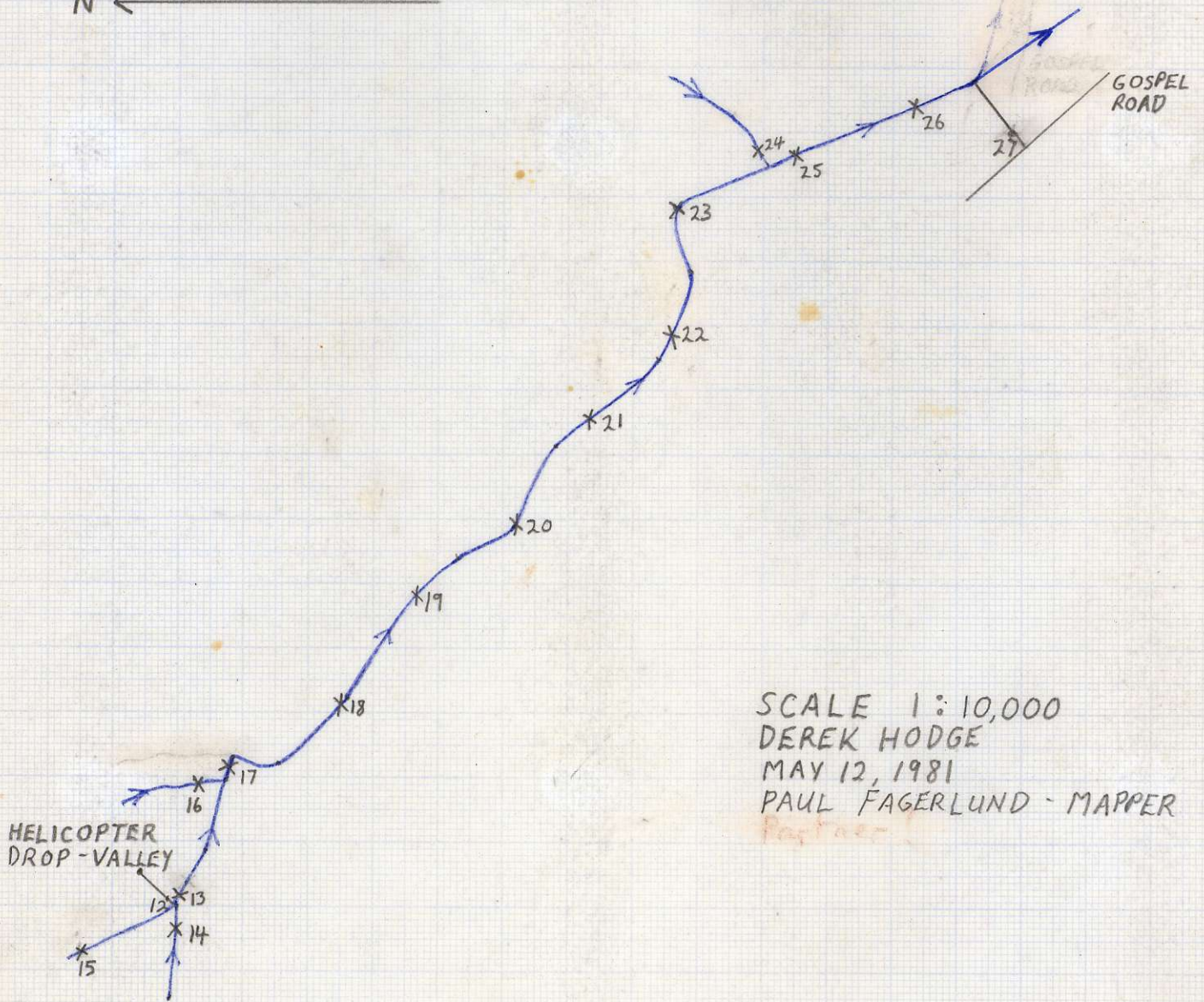

SCALE 1:10,000
DEREK HODGE
MAY 12, 1981
PAUL FAGERLUND - MAPPER