

May 13/81 STA

1

229°	for	550 m
190°	for	190 m
160°	for	507 m
046°	for	45 m
210°	for	750 m
250°	for	1650 m

Regional traverse

kc

kc

SM

13 May

GEOL

840993  
 King-Courte  
 1981

10m - 100m

229  
↑



SM- 22  
↓  
R O  
A

000  
005

3 R 0

204  
010

↑ 229

SM

May 13

KC (2)

229° for 550 m

1. top of saddle (2100' el) - nr. mt  
lt. gm. dacite? (glossy-looking)  
fragmental, - 160° V - most of  
prominent jointing (subparallel sets)

2 float - porphyritic dacite + <sup>alt<sup>n</sup></sup> v.  
angular blocky fragments.

3 rhyolite - tuff? - w/ spherical  
internal structures - surrounded by chl  
rim, chl alt<sup>n</sup> m → i. ep. alt<sup>n</sup>  
mt, lr. irr. vesicles, - flow

4 100 m 190 from top at 2000  
up hill to cliff on N side ridge  
bordered rhyolite tuff (flow) chl alt<sup>n</sup>  
+ massive rhyolite & vesicles + spherical  
internal structures. pale grey in colour.  
r. slicken side present i. f. massive  
o/c 120°/20 SW - jointing SM-22

5 dacite, mt. & r pyr. porphyritic

6 v. glossy, lt brown massive rock  
m → if, chl alt<sup>n</sup>, - dacite? flow

during 190° for 190 m

7 - rhyolite tuff float. 80 m  
# purple

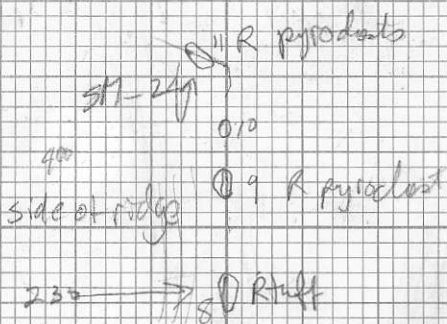
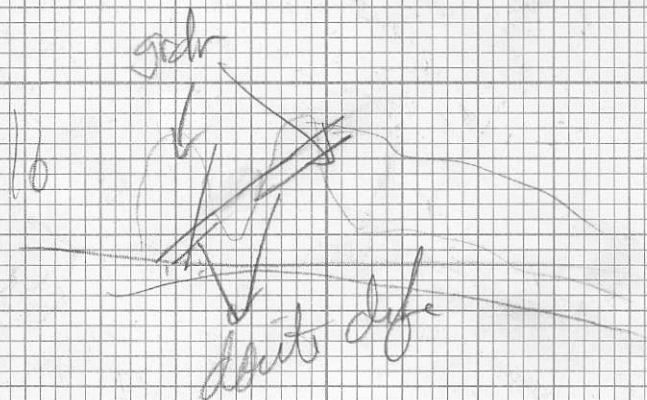

0 160°

KC SM May 13 (9)

160° for 507 m

8 O 24/68° NW - thin (1mm) banded  
truff - purple-pink in color  
diff. lith. exposure 15-20 m thick  
rhyolite? ✓ SM-23

230m at 160°  
✓ uniformly thin beds

9 360m at 160°

massive o/c - ism f. i. oth<sup>n</sup>  
pyroclastic rhyolite, (lapilli + tuft)

10 168°/20° NE

irregularly fragmented regularly  
bedded m. dark siltstone  
445 m at 160°

046° for 45 m  
along deep stream c

11 Rhyolite pyroclast - lot of  
m. r. SM-24 45m

0

210° for 750 m

0.5

12 250 m 210° - ~~flow~~ flow  
underlying pyroclastic fragments  
ditch. ~~250~~

13 450 m - pyroclastic, somewhat  
fragmental debris, large round  
(15 - 20 cm) basalt fragments,  
+ small subangular (1-3 cm)  
shy fragments - R.H. w/ O bombs?

250° for 1950 m

5:33 - 150 m

14) 50 - ~~of~~ massive i.a.H.  
evidence of intrusion ~~at~~ ~~about~~?

15) 1450 m - ~~of~~ intrusion  
a granodiorite ± quartz diorite  
in ~~at~~ ~~of~~ ~~qtz~~, ~~plag~~.  
m.f., m.r.

16) at slope granodiorite w/ mafic  
and xenoliths m.f., but by  
1.5 m w dip of about 95°/V  
m.f. & many vesicles



WSC 1166920-0-00 (100/40 N)  
 ATTITUDES  
 SANDSTONE SILTSTONE  
 CONGLOMERATE  
 VOLCANIC  
 SPECIMEN SITE A.B...: DO NOT WRITE ON OTHER SIDE OR USE COLOURS  
 CHERT  
 SHALE  
 PAN Δ WATER O  
 ROCK ■  
 SILT X SOIL ●  
 LIMESTONE DOLOMITE  
 INTRUSIVE  
 GOSSAN, MINERALS

DON'T FORGET CONTOURS, DRAINAGE, NORTH ARROW, LAT/LONG, SAMPLE SITES, WORKINGS, TRAILS, GOSSANS, OBSERVED GEOLOGY: DEFINED — INFERRED --- ASSUMED.....

Project (C.B)	NTS	Scale 1:10,000	Page 1 of 1	Traverse
Sampler B. Cantos Site Allister	Location, Target (words) K C Area		Sample Nos Kc-SM-22 to 24	
Date wed. May 13/81	photo no.	Cert. Nos		

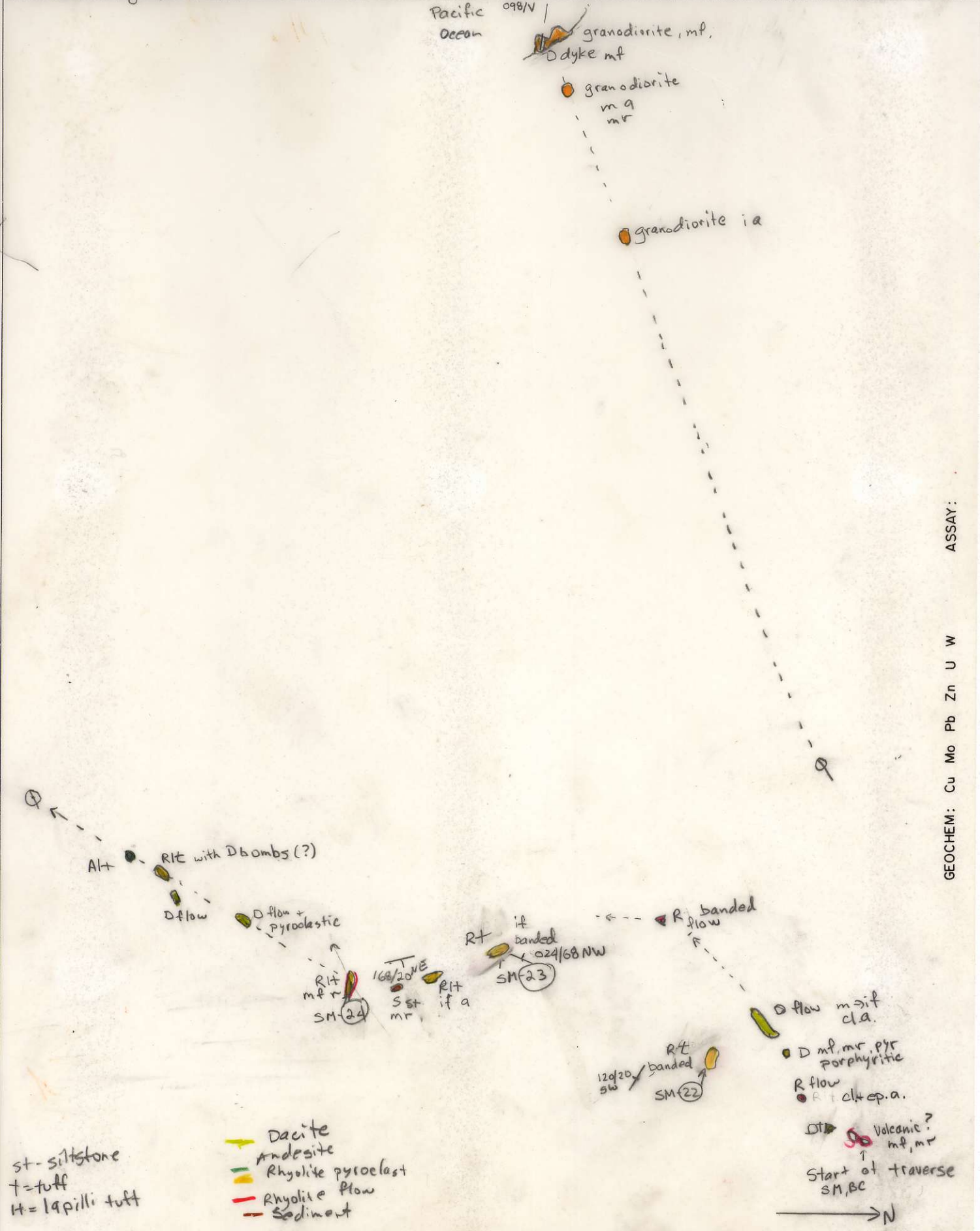



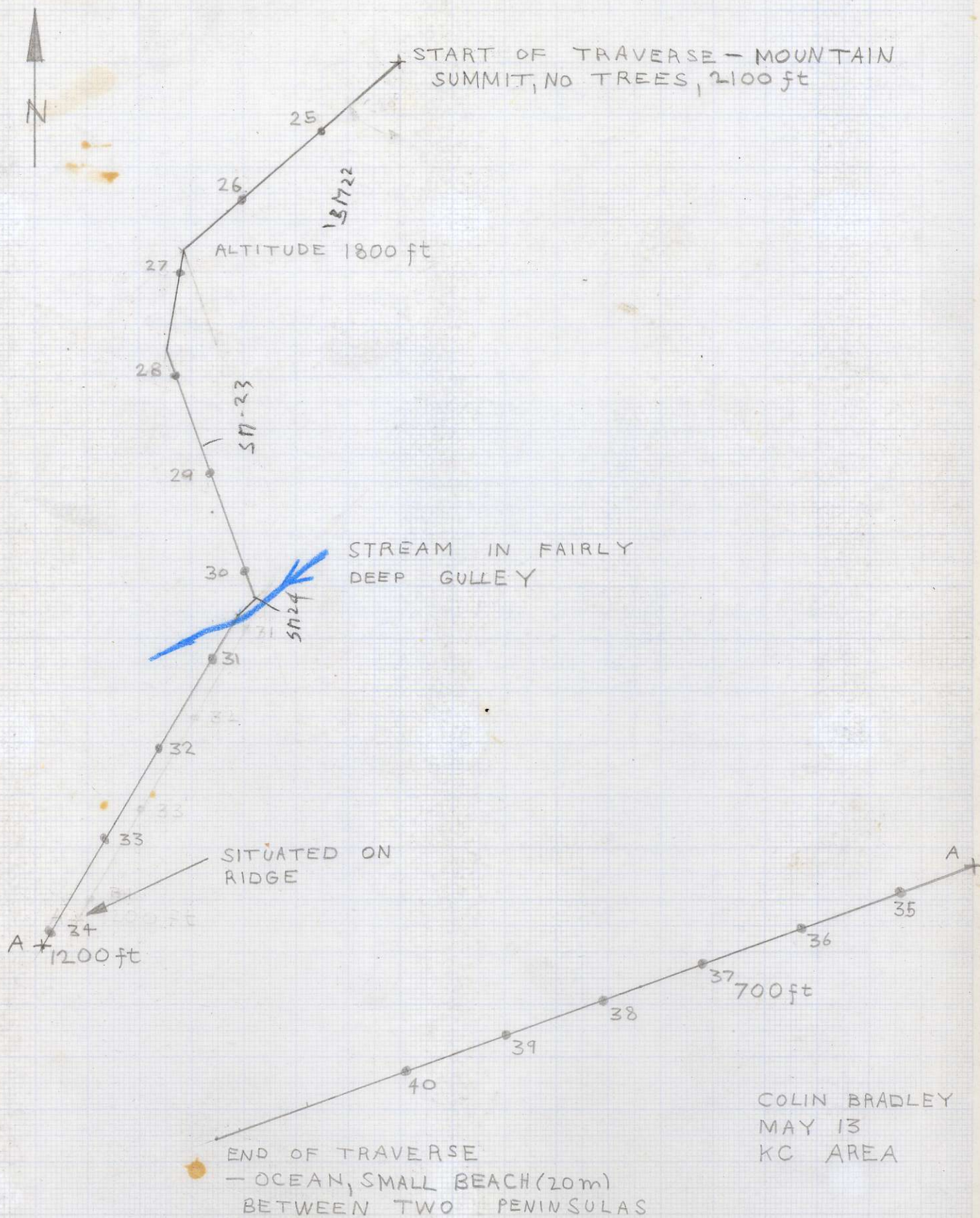

COLIN BRADLEY  
 MAY 13  
 KC AREA