

July 10/76 - Sunny

Swansea Mtn (82J/NW, SW)

- Access via lookout road east from Windermere.

Road leads from old highway & clearly shown on 1" = 2 mi maps

- Old adit & strippings on west side of east shoulder where old road ends at cabin (saddle between the two shoulders)

- trail swings north around east shoulder to adit

- old strippings about 200 feet from lookout road in saddle.

- Breccia zone in dolomite, hematite stain, qtz matrix & veins, lots mal, some azurite, traces bornite &

840807

a bluish sulfide  
- Qtz brecciated with hematite.  
cement

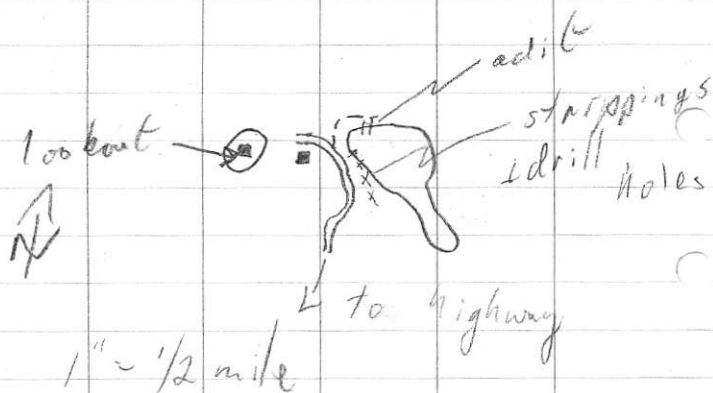

July 14/76 - Sunday

Topo:

Lomenda & Sargent

- Drove to top Swansea Mtn  
to sample showing;  
grab chip sample from  
largest p.t. in stripped  
area just east of parking  
area at lookout. 5400'

L-14/7/76-1 - ~~4050'~~

- grab chip sample gtz  
veins & dolomite; mal. & ag.

L-14/7/76-2 - 4050' drove down  
lookout road fill at stripping along  
road; // to low shoulder west side  
mountain

- gtz vein 225/40° N

- mineralized zone ~ 5-8' wide

L-14/7/76-3 - 4050' - overlooking

Windermere, fault zone, breccia,  
red stain & cement; along ridge  
can be followed 150 feet to dry gully  
(fault?)

\* Soil, brown, looks chips, 3-5"  
down, talus finer

(3)  
Note for #2 - by road, ~~traced~~ & stripped areas about 200' apart in a shallow gully next to a cliff to west

- About 300 feet southerly along pon road, is trench & qtz vein described as #2.

- topographic trend for the trenches is ~ 340°

- qtz vein 225/25 N

- further down road 1/4 mile, elevation 3905', trench into mineralized qtz veins 6" thick & dolomite

Drove Windermere Creek road east & traversed along eastern side of broad gully joining north into a ridge east of Swan sea

- E. dolomite topped by EOM shales
- about 1/2 mile up is reddish dolomite breccias where outcrop crosses gully near top.
- near fork in gully

L-14/7/76-4 - qtz vein  
 3 1/2' thick along crest or hinge of ridge  
 - 340/60° E ← apparent

- has patches of malachite
- dolomite breccia, stained with hematite
- 4470'

\* - channel sample across 3'

~~exposed on other side of ridge hinge → 275° steep~~

- climbed west side of wide gully → 4600';  
 dolomite, red stained  
L-14/7/76-5 4700';

just south of small gully mouth on west side

Soil, light brown, clayey,  
low slope area, full of  
rock fragments, 2-6" down

July 15/76 - sunny, hot, Mass:

- Lonsdale - Sargent

○ Traverse ridge east of Swansea Mtn  
barite?

- Began at Swansea lookout, walked  
down east shoulder of mountain

○ knob of E<sub>1</sub>(?) at bottom  
of shoulder between Swansea & ridge  
crossed gully & over 2nd knob of  
dolomite then gully before going up hill

L-15/7/76-1 - soil, brown, clayey

\* full of rock fragments, 1 to  
5" down, on top of outcrop,  
light grey weathering dolomite  
- elevation: 5300; Swansea lookout  
visible

L-15/7/76-2 5400', south facing

point of shoulder; overlooking steep  
draw to Redwall (?) fault.

- outcrops nearby are pinkish  
weathering & soil is more  
reddish

\* Soil, reddish brown, rock frags,  
2-5" down, not & loose

- Rock on ~~east~~<sup>west</sup> side draw generally  
light grey weathering but some is  
buff - pink - reddish grey; lots of

breccia, some qtz veining, wuggy  
L-15/7/76-2B - rock sample,  
\* pink dolomite

- ex. nearby with veins lined with qtz xls  
L-15/7/76-3 - 5550'

- soil, brown, 2-5" down, mod  
\* s. bore, (talus fines), full rock  
chips, near outcrops light grey  
dolomite

L-15/7/76-4

- bed 335/65, east side, 5725'  
- a few barite veinlets, max.  
3" thick  
- mottled appearance with light &  
dark layers -> soft sed?

L-15/7/76-5 - 5920', steep,  
around corner to east from Redwall  
gully, barite & red breccia  
fragments

\* - soil, brown, full rock chips,  
(talus fines)

- outcrops 6000-6100', brecciated,  
red stained dol.

- At 6150', going around corner  
& over Western Gypsum,



Aug 22/76 - Clear, warm  
no T.S.

Traverse of ridge east  
of Ewancea Pt.

Homestead

L- 22/8/76-1 - 5180'

north side ridge

Soils Med. reddish brown,  
full of pebbles & tiny  
chips, talus fines, 2-5",  
under 1" of needles  
& organic, mod slope  
n.w., area 056 dolomite  
but near contact  
with 60m limestone  
- close to Redwall fault.

L- 22/8/76-2 5180'

Soil - reddish brown full  
of chips, talus fines,  
3-5", under 1" of  
organic & moss, in  
deep draw, steep to

mod. with slope, close to  
outcrop

L-22/8/76-3 - 5980'

- up outcrop ridge  
Soil: orangey brown, some  
chips 1-3" near  
outcrop, mod slope  
northwest.

L-22/8/76-4A - 5990'

Soil: med reddish brown  
full of chips, talus fines,  
1-3" steep slope south

- About 100' east along contour,  
thin veins of brite for outcrop  
& talus (mineral) → to 7<sub>n</sub>

- thin fractures + veinlets of a  
discolored, anhyd colored  
carbonate (?) strongly to 7<sub>n</sub>

- Sample 4B

~~thin colored  
veinlets~~

- veins cover only 3" of  
dolomite across strike

→ tiny blebs discolored cells

- from there to 6050' (base of cliff) are scattered rubble (mainly) of brites; some chunks suggest veins up to 5" thick; rare pieces have weak trace Zn

- cliff above has no brite; weathers purplish grey but is tinted tan to purplish red; brecciated in places.

L-22/8/76-5 5900'

- soil: reddish brown, some chips 0-2", on outcrop, near to brite float, low slope east

- close to 4B, more thin veins 0/35-40° E across 6-7', max 1" thick, traces of Zn but minor

~~- bed 400/650 N~~

L- 22/8/76-6

5480'

- rubble & rubble outcrop dolomite with brown barite
- light brown fracture fill barite or dolomite  $\rightarrow$  trace Zn
- cracks & holes in barite to some barite boundaries trace Zn

-7-550+

- numerous thin barite veins across ~ 15', 5' roughly trace Zn, barite-dolomite breccia in places; one thin vein ~ 6" of barite is full of brownish blebs (Sample)
- trend ~ 160-180°  $\pm$  near vertical
- nearby dolomite to float shows Zn
- further up hill on strike is 1' barite vein to smaller ones
- bed 90°/65° N

50 m → 1. S. of gty  
5400', near  
bed 115/95' N

• some small barite veins; in  
L-15/7/76-6 - 6270'

- low slope, lightly wooded  
area east side of ridge

\* Soil - bright reddish brown,  
clayey, 1-4" down

- blocks of dolomite nearby

- walked around ridge at  
6200' level & when back  
walking west climbed to top

- At top 6480', brecciated,  
red dolomite (qtz veins); some  
minor barite

- walked on top ridge to west

unbrecciated grey dol.

- bed ~~210/25 W~~ 340/70 E  
L-15/7/76-7 - 6200'

- Redwell Breccia

Soil - reddish brown at  
surface, along crest ridge

L-15/7/76-8 - 4970'

- saddle between Swensen &  
ridge to east; flat area between

two lumpy outcrops  
\*Soil, brown, 2-4" down,  
full of rock fragments &  
rootlets

5140'

- bed east side Swan sea  
Z45°/60°W

Aug 12/76 - Clear

Homenda - Sargent

2 miles south of Indian  
Head Mtn on Redwall  
Fault (in Beaverfoot Fr.)  
Mo. T.S.

- B.G. BGS 15L 700 ps  
on 1st saddle north  
where fault exposed

---

- bed 140/805W

- med grey l.s. + dolomites  
with some black shale

---

L- 12/8/76-1 - soil over  
Redwall Fault - 7400'

- 6-8", dark reddish brown,  
flat, under grass, clayey

- Grey dolomite just east of



breccia → 35% open vugs  
due to solution. Aligned to  
bedding.

Fault breccia - reddish brown  
to cream colored rock,

Fe ~~content~~ cement, dolomite  
chunks up to 2' across

Soil B.G. 80 compressed  
to 60 over dolomite

L-12/8/76-2 - 7150'

Soil, med. brown, gravelly,  
mod slope west, tussocks

B.G. 40 cps

- near outcrop grey dolomite

L-12/8/76-3 - 7100'

\* Soil (over red zone), med  
brown, clayey, 2-12" under  
grass + herbais, organic (?),  
on rock chips at 12"; mod  
slope south

Much of Redwall Fault  
Zone is oxidized, unbrecciated  
dolomite. Calcite veins common

Zone is tiny.

B.G. over fault is  
60-90

Fault zone has a  
reddish part and a tan  
colored zone. Often fragments  
are grey & uncolored

2-12/8/76-4 - 7280

Soil - med. brown, gravelly, 2-8"  
under grass, organic (?), hinge  
of saddle

- over fault

bed 325/45° E - 7900'