

Page 1

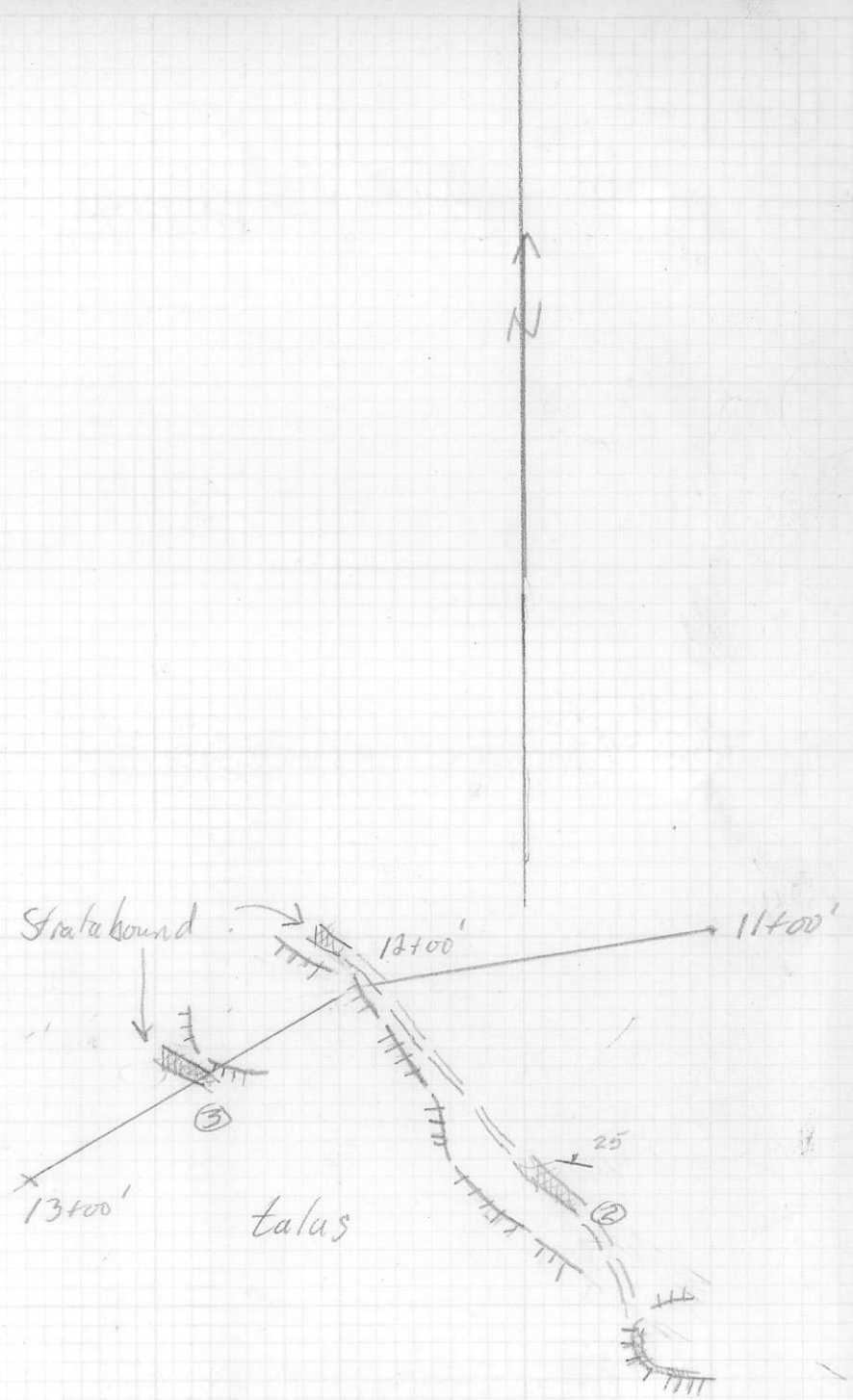

Pedley Pass
840778

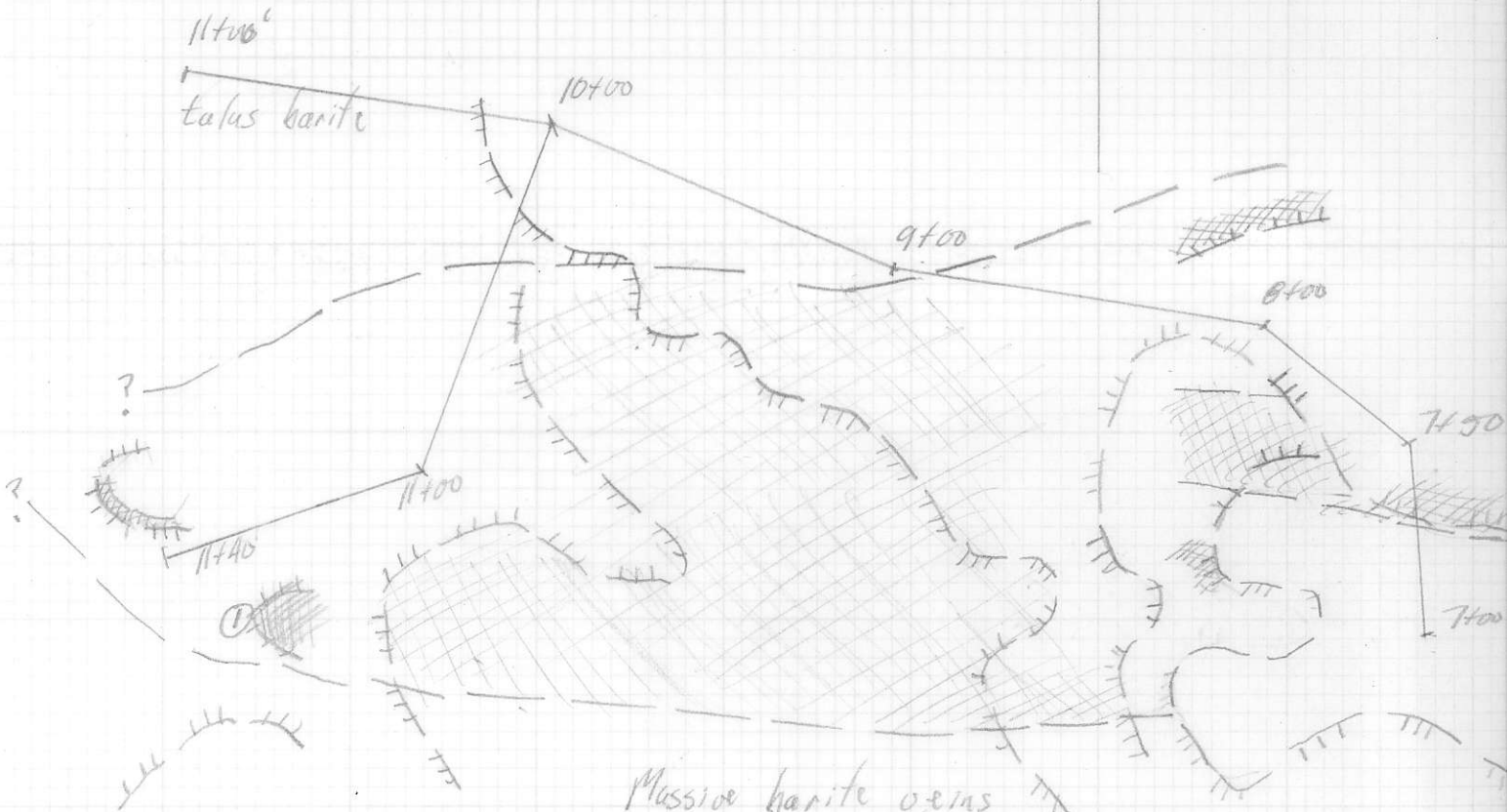

Massive barite veins
with dolomite breccia
fragments with Pb/Zn



massive banded veins

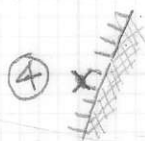

(minor bx)
7+00

rubble
cover.

6+00

5+00
(4360')

minor bx
Zn

good x fracture
brecciation
mineralizat

moderate
Zn breccia - considerable
cover.

4+00

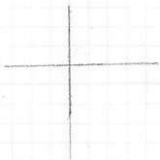

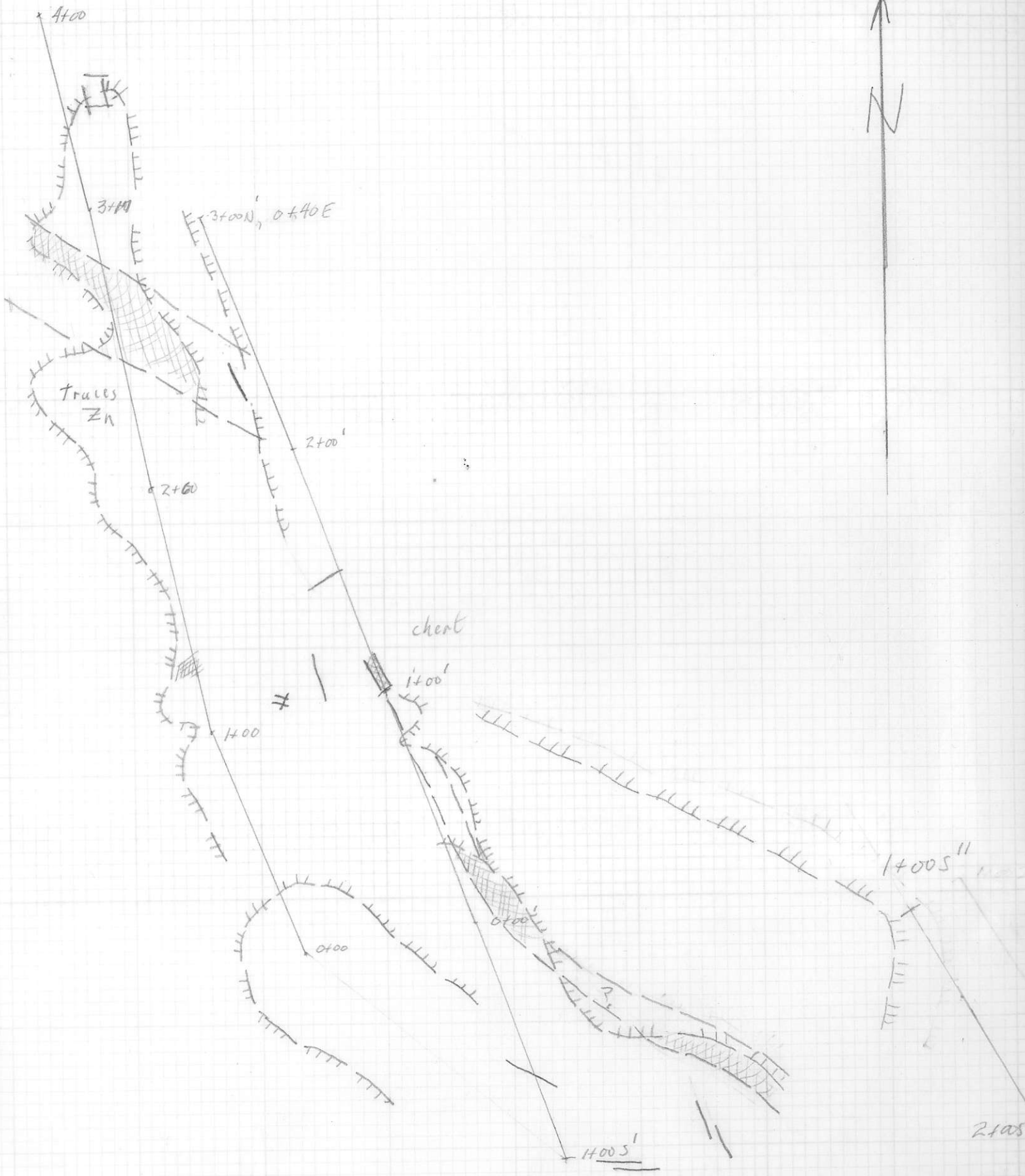

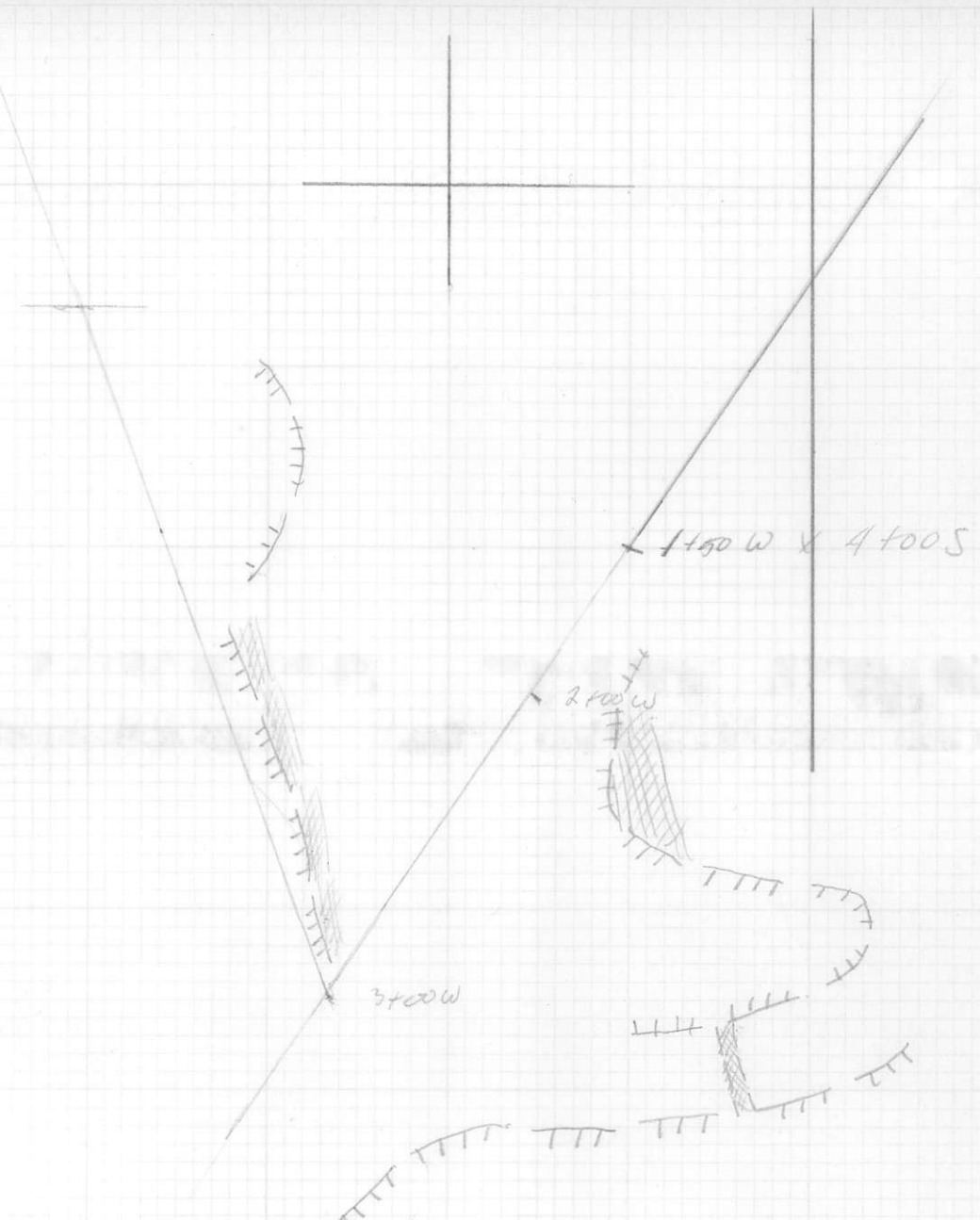

100-200' cliffs
Barite and Pb/Zn in
talus are rare.

