

Project	TULSEQUAH	NTS	104K	Scale	1" = 1/2 MILE	Page	1 of 1	Traverse	KS-42
Sampler	KEN SHANNON M. THICKE	Location, Target (words)	SAMPLING GOSSANS ADJACENT TO GOAT CLAIMS			Sample Nos	KST1-418 TO 421		
Date	AUG 7/81	photo no.	BC-5615-236			Cert. Nos	840617		

-  GOSSAN MINERALS
  -  INTRUSIVE
  -  LIMESTONE DOLOMITE
  -  ROCK
  -  SHALE
  -  CHERT
  -  WATER
  -  VOLCANIC SITE
  -  CONGLOMERATE
  -  SANDSTONE SILTSTONE
- SPECIMEN SITE A.B...; DO NOT WRITE ON OTHER SIDE OR USE COLOURS

DON'T FORGET CONTOURS, DRAINAGE, NORTH ARROW, LAT/LONG, SAMPLE SITES, WORKINGS, TRAILS, GOSSANS, OBSERVED GEOLOGY: DEFINED — INFERRED - - - ASSUMED.....

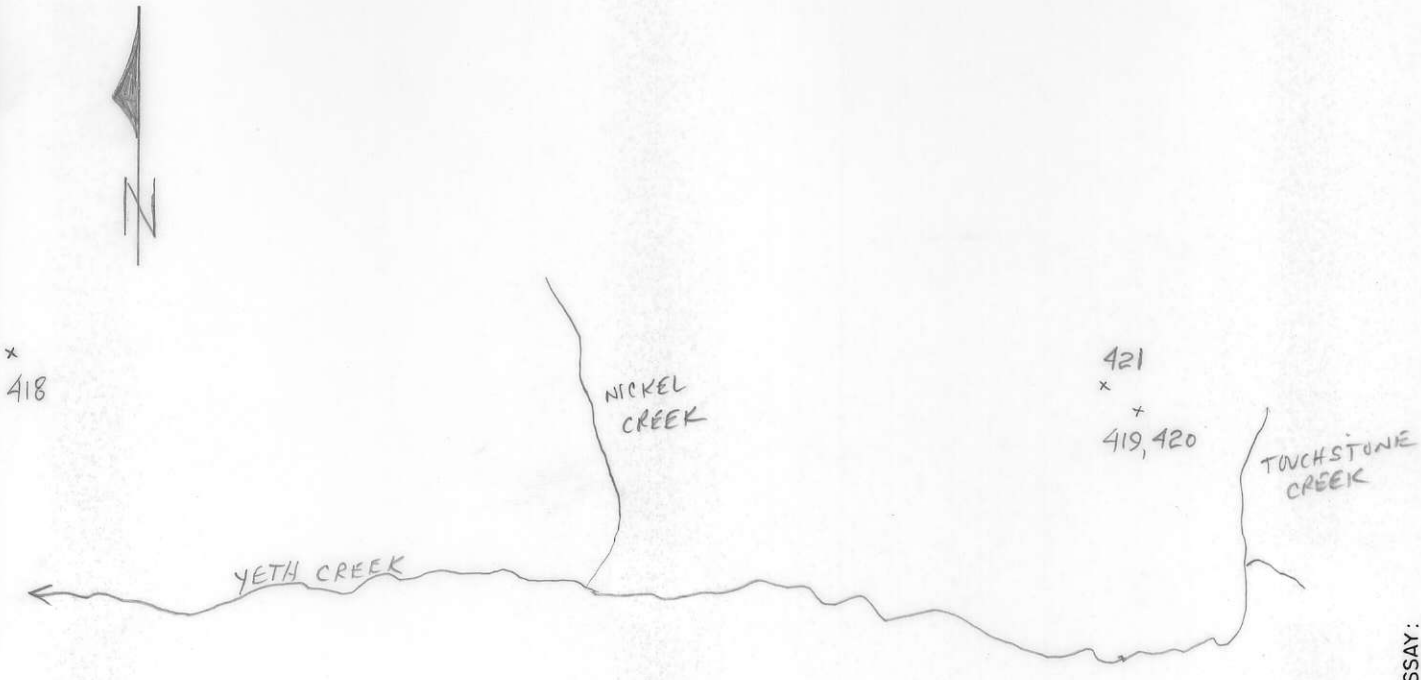

GEOCHEM: Cu Mo Pb Zn U W  
ASSAY:

TRAV SUMMARY AUG 7/81

K5-42

AS PART OF PREPARATION FOR STAKING IN YETH CREEK AREA, M. THICKE AND MYSELF TOOK A FEW GRAB SAMPLES OF RUSTY ROCK ALONG THE CREEK. NEITHER OF THE THREE SAMPLE SITES LOOKED VERY GOOD ALTHOUGH SOME SILICIFIED INKLIN SILTSTONES WITH PYRITE AT KSTI-419 ~~DO~~<sup>DO</sup> HAVE POTENTIAL. THE ALTERATION OF THE INKLIN SEDIMENTS SEEMS TO BE MOST INTENSE IN NICKEL CREEK AND ELSEWHERE IS MINIMAL. PROBABLY THE BEST GROUND IS COVERED BY THE ORIGINAL GOAT CLAIMS.