

Aug 2

840610

RL-39

GOAT CLAMS

KEN SHANNON - PARTNER

RLT1-607 to RLT1-608

RLT-607 SOIL

1/2
yel

RLT-608 SOIL

med yel
red

I SPENT THE DAY WITH KEN
SHANNON ON GOAT CLAIMS EXAMINING
THE AREA BELOW THE WATERFALLS
ON MICKEL CO. TWO SOILS WERE
TAKEN FROM DYKES.

C

10cm steep Jasper dyke

C

5cm steep

Project <i>TULSEQUAH</i>	NTS <i>104 K</i>	Scale <i>1" : 1/2 mile</i>	Page <i>1</i> of <i>1</i>	Traverse <i>RL-39</i>
Sampler <i>ROB GREENWALD KEN SHANNON</i>	Location, Target (words) <i>GOAT CLAIMS</i>		Sample Nos <i>RLT1-607 & RLT1-608</i>	
Date <i>AUG 2 1981</i>	photo no. <i>BC5615 236</i>		Cert. Nos	

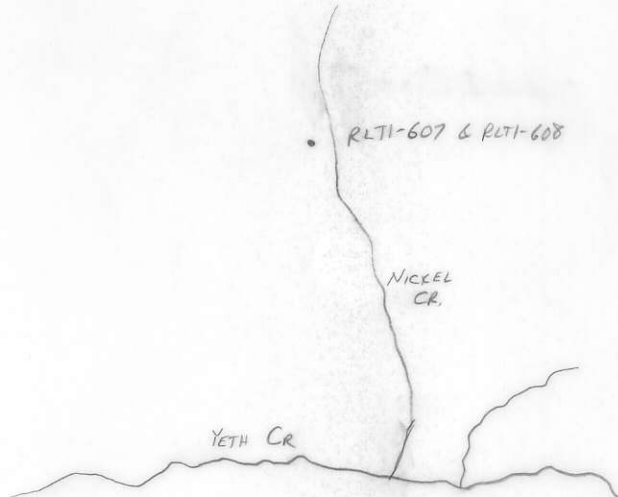

-  SANDSTONE SILTSTONE
-  CONGLOMERATE
-  VOLCANIC
-  CHERT
-  SHALE
-  LIMESTONE DOLOMITE
-  INTRUSIVE
-  GOSSAN MINERALS

SPECIMEN SITE A, B, ...; DO NOT WRITE ON OTHER SIDE OR USE COLOURS
 DON'T FORGET CONTOURS, DRAINAGE, NORTH ARROW, LAT/LONG, SAMPLE SITES, WORKINGS, TRAILS, GOSSANS, OBSERVED GEOLOGY: DEFINED ——— INFERRED - - - ASSUMED.....

GEOCHEM: Cu Mo Pb Zn U W
 ASSAY: