

1988

840475

WARREN

NCI

NEVILLE CROSSBY INC.

300 AVENUE VANCOUVER, VANCOUVER, B.C. V5Y 1L1

TELEPHONE (604) 683-7333 TELEFAX (604) 683-7334

MAILING LIST DEPARTMENT

GRID

VLF-EM.

Waterproof Level Book  
NCI #342

CHEVRON - 1988 - M 584

VLF-EM - WARREN - GRID

Thursdays Seattle

Shuts Down 4:00 PM

STIRROP CIG M584 - WARREN GR10

M584

P. MACKENZIE

July 23 '88

①

Line	5+00SE		Turning to left		
STATION	Seattle - 1		Hawaii - 2		comments
	IP	Quad	IP	Quad	
0100 NE	+18	+13	-19	0	Turning to left is
0125 NE	+9	+12	-19	-1	To ① East
0150 NE	+8	+12	-15	-2	② South East
0175 NE	-2	+6	-8	+4	
1100 NE	-21	0	+1	+10	
1125 NE	-29	-4	+6	+9	
1150 NE	-35	-6	+7	+10	
1175 NE	-37	-4	+9	+13	
2100 NE	-40	-6	+12	+12	
2125 NE	-47	-8	+14	+12	
2150 NE	-47	-8	+14	+13	
2175 NE	-48	-7	+15	+12	
3100 NE	-50	-3	+13	+12	
3125 NE	-43	-3	+16	+14	
3150 NE	-47	0	+15	+14	
3175 NE	-47	-2	+10	+14	
4100 NE	-45	-1	+8	+12	
4125 NE	-44	-2	+11	+14	
4150 NE	-43	-1	+7	+12	
4175 NE	-39	-3	+6	+13	✓
5100 NE	-36	-1	+5	+10	

## STIRROCK CK.

Line 5+00 SE

Station	IP Seattle-1 QUAD	IP Hawaii-2 Quad	Common	
5+25 NE	-43	-2	+8	+10
5+50 NE	-44	-4	+11	+10
5+75 NE	-38	-4	+8	+9
6+00 NE	-35	-3	+7	+10
6+25 NE	-39	-2	-2	+6
6+50 NE	-35	0	-9	+4
6+75 NE	-37	-2	-12	-1
7+00 NE <sup>Beside cabin</sup>	-44	-4	-25	-6
7+25 NE	-43	-1	-24	-9
7+50 NE	-40	+1	-24	-18
7+75 NE	-47	+2	-14	-16
8+00 NE	-72	-8	+2	-11

one side of  
valley  
in small  
valley  
other side  
spring?

Line 4+00 SE

8+00 NE	-46	-2	0	-3
7+75 NE	-38	-3	-9	-5
7+50 NE	-36	-4	-20	-10
7+25 NE	-34	-5	-18	-6
7+00 NE	-32	-7	-25	-6
6+75 NE	-36	-7	-23	-6
6+50 NE	-43	-8	-27	-8
6+25 NE	-46	-8	-27	-10



JULY 23/88

(2)

LINE  
 400SE IP SEATTLE QUAD IP Hawaii Quad

6100 NE	-47	-7	-23	-9
5475 NE	-47	-6	-21	-8
5450 NE	-49	-6	-22	-9
5425 NE	-57	-7	-14	-7
5400 NE	-57	-9	-13	-7
4475 NE	-58	-9	-13	-4
4450 NE	-58	-8	-16	-4
4425 NE	-62	-7	-14	-3
4400 NE	-60	-7	-9	0
3475 NE	-56	-6	-8	+3
3450 NE	-55	-9	-7	0
3425 NE	-56	-8	-3	+2
3400 NE	-59	-9	0	+4
2475 NE	-59	-9	+3	+6
2450 NE	-58	-10	+1	+6
2425 NE	-48	-8	+5	+7
2400 NE	-48	-9	-1	+10
1475 NE	-39	-6	+2	+7
1450 NE	-34	-4	-2	+6
1425 NE	-21	-1	-2	+6
1400 NE	-3	+8	-5	+3
0475 NE	+1	+9	-4	+4
0450 NE	+8	+11	-11	+3
0425 NE	+9	+11	-13	+1
0400 BL	+14	+12	-16	0

} crest of range



Line 7100 SE	Seattle	Hawaii	Common		
$\Delta$	IP	QUAD	IP	QUAD	
0+00 NE	+11	+10	-25	-12	
0+25 NE	+7	+10	-25	-8	
0+50 NE	+2	+10	-22	-6	
0+75 NE	0	+10	-20	-6	
1+00 NE	-6	+6	-14	-2	crest of range
1+25 NE	-20	-4	-4	+5	
1+50 NE	-24	-4	-1	+5	
1+75 NE	-30	-6	+4	+8	
2+00 NE	-33	-7	+8	+8	
2+25 NE	-38	-8	+9	+8	
2+50 NE	-41	-8	+10	+5	
2+75 NE	-40	-7	+10	+6	
3+00 NE	-41	-7	+12	+4	
3+25 NE	-43	-8	+14	+5	
3+50 NE	-42	-8	+15	+4	
3+75 NE	-42	-8	+13	+5	
4+00 NE	-42	-6	+14	+5	
4+25 NE	-39	-6	+15	+5	
4+50 NE	-43	-8	+16	+8	✓
4+75 NE	-38	-8	+20	+8	
5+00 NE	-33	-6	+18	+11	
5+25 NE	-32	-3	+22	+10	one side
5+50 NE	-26	+1	+22	+12	mirror gully off center - other side.

700 SE SEATTLE		HAWAII		COMMENTS	
②, IP	QUAD	IP	QUAD		
5+75 NE	-22	+5	+23	+14	baths 550+ 600 switched around.
6+00 NE	-18	+8	+22	+14	
5+25 NE	-14	+10	+23	+14	
6+50 NE	-12	+10	+21	+14	
5+75 NE	-15	+8	+27	+12	
7+00 NE	-13	+7	+25	+13	

LINE 6+00 SE

8+00 NE	-7	+3	+29	+14	
7+75 NE	-6	+2	+31	+13	
7+50 NE	-10	+4	+33	+14	
7+25 NE	-14	+4	+28	+14	
7+00 NE	-16	+4	+30	+13	
6+75 NE	-24	+2	+27	+8	in small gulley
6+50 NE	-32	-3	+22	+8	
6+25 NE	-32	-4	+22	+8	
6+00 NE	-36	-5	+17	+6	
5+75 NE	-37	-4	+10	+5	
5+50 NE	-34	-4	+11	+8	
5+25 NE	-34	-4	+11	+7	
5+00 NE	-39	-5	+12	+10	✓

Line A	600 SE	SEATTLE IP	QUAD	HAWAII IP	QUAD	Comment
	4+75 NE	-44	-5	+15	+9	
	4+50 NE	-39	-4	+17	+10	
	4+25 NE	-40	-3	+17	+9	
	4+00 NE	-46	-5	+17	+7	
	3+75 NE	-40	-3	+15	+7	
	3+50 NE	-43	-2	+12	+8	
	3+25 NE	-46	-3	+15	+11	
	3+00 NE	-45	-5	+16	+11	
	2+75 NE	-47	-5	+13	+9	
	2+50 NE	-43	-5	+13	+8	
	2+25 NE	-43	-6	+12	+10	
	2+00 NE	-40	-6	+10	+12	
	1+75 NE	-34	-5	+6	+11	
	1+50 NE	-29	-1	+2	+8	
	1+25 NE	-25	-2	0	+5	
	1+00 NE	-15	+1	-5	+4	crest of range
	0+75 NE	+1	+10	-17	+1	
	0+50 NE	+13	+16	-22	-5	
	0+25 NE	+12	+13	-23	-2	
	0+00 NE	+14	+13	-23	0	✓

July 23 all readings taken facing  
 for Seattle - NE EAST.  
 for Hawaii - SSE



July 24/58

M584 WARREN BRID Pierre Mack.

Line	3100 <sup>SE</sup> TP	Seattle Qual	IP Hawaii Qual	Comments	
△					
0+00 NE	+7	+10	-10	-2	
0+25 NE	+4	+11	-6	+1	
0+50 NE	+3	+12	-8	0	
0+75 NE	0	+12	-8	-2	
1+00 NE	-5	+9	-7	0	crest of terrain
1+25 NE	-23	0	+1	0	
1+50 NE	-33	-2	0	-1	
1+75 NE	-38	-4	0	0	
2+00 NE	-41	-6	+1	0	
2+25 NE	-46	-8	-2	-2	
2+50 NE	-46	-9	-2	-2	
2+75 NE	-46	-9	-1	-3	
3+00 NE	-48	-10	-1	0	
3+25 NE	-47	-10	-2	-2	
3+50 NE	-46	-10	-6	0	
3+75 NE	-44	-8	-3	0	
4+00 NE	-44	-7	-6	0	
4+25 NE	-42	-5	-7	-1	
4+50 NE	-52	-6	-7	-1	
4+75 NE	-54	-7	-5	+2	
5+00 NE	-55	-5	-5	+4	
5+25 NE	-56	-6	-5	+3	✓

Line 3+00 SE

IP

QUAD

Hawaii

IP

QUAD

	IP	QUAD	Hawaii IP	QUAD
5+50 NE	-39	-2	-4	+4
5+75 NE	-37	0	-4	+4
6+00 NE	-29	0	-3	+3
6+25 NE	-28	0	+3	+6
6+50 NE	-28	0	+4	+2
6+75 NE	-25	-3	+27	+10
7+00 NE	-23	-3	+28	+11
7+25 NE	-19	+2	+22	+8
7+50 NE	-22	+4	+20	+8
7+75 NE	-31	+2	+13	+10
8+00 NE	-35	+4	+8	+10

LINE 2+00 SE

△

8+00 NE	-37	+6	-12	+9
7+75 NE	-37	+4	-12	+7
7+50 NE	-28	+5	-2	+7
7+25 NE	-19	+5	+7	+9
7+00 NE	-20	+4	+6	+9
6+75 NE	-24	-2	+9	+9
6+50 NE	-30	-3	+11	+7
6+25 NE	-29	-1	+16	+10
6+00 NE	-36	-2	+16	+10
5+75 NE	-29	+1	+21	+11

Line 2+00 SE cont.

Δ	SEATTLE		HAWAII		Comments
	IP	QUAD	IP	QUAD	
5+50NE	-32	0	+15	+10	
5+25NE	-33	+1	+6	+6	
5+00NE	-35	0	+7	+10	
4+75NE	-36	-2	+9	+11	
4+50NE	-40	-3	+17	+13	
4+25NE	-45	-4	+9	+10	
4+00NE	-51	-6	+10	+12	
3+75NE	-39	-2	+1	+6	
3+50NE	-37	-3	+3	+8	
3+25NE	-36	-2	+7	+11	
3+00NE	-35	-2	+9	+12	
2+75NE	-38	-3	+9	+10	
2+50NE	-38	-4	+12	+12	
2+25NE	-34	0	+16	+12	
2+00NE	-30	+2	+13	+13	
1+75NE	-36	+2	+11	+12	
1+50NE	-25	+2	+9	+15	
1+25NE	-20	+7	+7	+10	} crest of ridge
1+00NE	-11	+10	+1	+5	
0+75NE	-8	+13	-5	+1	
0+50NE	-6	+12	-10	+1	
0+25NE	0	+12	-14	-1	
0+00BL	+3	+11	-17	0	

✓

## Line 1 to 5E

## WARREN GRID

Job 724  
Comments

Δ	SEATTLE		HAWAII		
	IP	QUAD	IP	QUAD	
0+00 BL	-14	+6	-18	-1	intrench
0+25 NE	-16	+8	-11	-1	
0+50 NE	-20	+10	-1	+3	intrench
0+75 NE	-25	+5	+7	+9	drill hole 25m to SE - crest of ridge.
1+00 NE	-31	+2	+12	+12	
1+25 NE	-36	-2	+17	+14	
1+50 NE	-33	-2	+22	+18	
1+75 NE	-30	-1	+26	+19	
2+00 NE	-24	+3	+21	+21	
2+25 NE	-25	+2	+18	+17	
2+50 NE	-27	+2	+15	+16	
2+75 NE	-29	+1	+11	+14	
3+00 NE	-27	0	+13	+14	
3+25 NE	-30	+1	+8	+11	
3+50 NE	-34	-2	+12	+14	
3+75 NE	-43	-4	+15	+13	
4+00 NE	-35	0	+11	+12	
4+25 NE	-33	0	+9	+12	
4+50 NE	-37	+3	+3	+8	
4+75 NE	-36	+2	+3	+5	
5+00 NE	-35	+3	+8	+10	
5+25 NE	-49	-2	+6	+10	
5+50 NE	-45	0	+2	+8	

(6)

Line 1405E cont. Warren Grid					comments
$\Delta$	SEATTLE		HAWAII		
	IP	QUAD	IP	QUAD	
5+75NE	-40	+3	-2	+5	
6+00NE	-40	+1	-16	+4	
6+25NE	-37	0	-12	+3	
6+50NE	-37	-4	-18	-8	taken in gully over stream
6+75NE	-33	-5	-18	-8	
7+00NE	-25	-1	-21	-7	
7+25NE	-23	+2	-20	-6	
7+50NE	-26	+2	-24	-4	
7+75NE	-35	+1	-28	-3	
8+00NE	-38	+1	-36	0	✓

<u>Line 0+00NW</u>					
8+00NE	-34	-3	-40	-2	Draw at 8+03NE
7+75NE	-40	-5	-40	+2	
7+50NE	-40	-1	-39	+2	✓
7+25NE	-38	+3	-42	0	
7+00NE	-42	+6	-43	+1	
6+75NE	-43	+5	-46	-4	✓
6+50NE	-43	+9	-48	-7	
6+25NE	-46	+8	-50	-6	
6+00NE	-49	+4	-51	-7	
5+75NE	-56	+6	-47	-5	
5+50NE	-50	+9	-38	0	

SEATTLE

HAWAII

July 24/88

Line 0100 + 100	IP	QUAD	IP	QUAD	Comments
Δ					
5+25 NE	-44	+8	-26	+7	indraw
5+00 NE	-42	+6	-16	+12	
4+75 NE	-36	+6	-7	+12	
4+50 NE	-33	+3	+1	+13	
4+25 NE	-27	0	+6	+11	line follows shallow draw?
4+00 NE	-30	-6	+5	+3	
3+75 NE	-26	-3	+4	+5	
3+50 NE	-38	-11	+6	+5	
3+25 NE	-41	-11	+8	+5	
3+00 NE	-45	-10	+10	+8	
2+75 NE	-48	-9	+11	+8	
2+50 NE	-39	-5	+5	+8	
2+25 NE	-43	-4	+1	+8	
2+00 NE	-40	-3	0	+7	
1+75 NE	-42	-4	0	+6	
1+50 NE	-48	-7	+2	+6	
1+25 NE	-52	-6	+3	+9	
1+00 NE	-54	-8	+4	+9	
0+75 NE	-49	-9	+6	+10	
0+50 NE	-48	-4	0	+5	
0+25 NE	-43	-2	-8	0	
0+00 BL	-35	0	-15	-4	cut of terrain

cut of terrain  
✓

Line	1400NW	Warren grid			7
$\Delta$	IP	SEATTLE QUAD	HAWAII IP	QUAD	Comments
0400BL	-50	-10	-4	+4	
0425NE	-51	-8	-4	+1	
0450NE	-54	-6	-7	+1	
0475NE	-56	-6	-10	+3	
1400NE	-54	-6	-12	+2	
1425 NE	-50	-5	-11	0	
1450 NE	-49	-5	-12	+2	
1475 NE	-51	-6	-13	+3	
2400 NE	-54	-5	-8	+1	
2425 NE	-59	-6	-6	+4	
2450 NE	-54	-7	-8	0	
2475 NE	-58	-9	-10	+2	
3400 NE	-48	-7	-12	-1	
3425 NE	-44	-8	-19	-4	
3450 NE	-38	-9	-25	-9	at middle of small valley
3475 NE	-32	-4	-33	-11	
4400 NE	-31	-4	-32	-12	
4425 NE	-34	-3	-36	-10	
4450 NE	-42	-5	-43	-11	
4475 NE	-41	-6	-45	-9	
5400 NE	-42	-3	-44	-8	
5425 NE	-45	-4	-50	-8	
5450 NE	-35	+4	-50	-6	mill gully in side slope at 5435 NE

Line △	Hoonw <sup>cont.</sup> SEATTLE		HAWAII		Comment
	IP	QUAD	IP	QUAD	
5+75 NE	-36	+9	-51	-7	
6+00 NE	-42	+8	-56	-6	
6+25 NE	-51	+5	-55	-5	
6+50 NE	-55	+4	-51	-3	
6+75 NE	-59	+5	-47	+3	
7+00 NE	-46	+2	-42	+4	
7+25 NE	-40	+5	-43	+4	small gully
7+50 NE	-38	+6	-50	0	Side slope a 7+30 NE
7+75 NE	-39	+3	-55	-1	
8+00 NE	-41	+4	-58	-3	

Line 4+00 NW

△

8+00 NE	-38	-2	-39	-6	
7+75 NE	-37	-4	-40	-8	
7+50 NE	-35	-4	-36	-8	
7+25 NE	-35	0	-47	-11	
7+00 NE	-40	-2	-60	-14	
6+75 NE	-46	-7	-63	-14	
6+50 NE	-51	-8	-65	-12	
6+25 NE	-54	-6	-62	-10	
6+00 NE	-58	-4	-56	-9	
5+75 NE	-45	-6	-57	-10	✓



Line	400 Mu Cont	IP Quad SEATTLE	IP Quad HAWAII	WARRENGLID	Comments
△					
5750 NE	-44	-4	-52	-9	
5725 NE	-43	-3	-47	-10	
5700 NE	-42	-3	-46	-10	
4475 NE	-47	-3	-43	-10	
4450 NE	-44	-4	-42	-9	
4425 NE	-47	-8	-44	-10	
4400 NE	-44	-3	-42	-6	
3775 NE	-41	-4	-38	-8	
3750 NE	-35	-2	-36	-9	
3725 NE	-32	-2	-34	-9	
3700 NE	-29	-1	-30	-9	
2775 NE	-28	-2	-30	-9	
2750 NE	-33	-2	-29	-9	
2725 NE	-33	-3	-31	-9	
2700 NE	-32	-2	-26	-6	
1775 NE	-40	-5	-30	-6	
1750 NE	-47	-7	-34	-10	
1725 NE	-51	-7	-37	-12	
1700 NE	-56	-9	-36	-12	
0775 NE	-53	-10	-34	-12	
0750 NE	-64	-10	-34	-12	
0725 NE	<del>45</del> 45	-7	-24	-10	
0700 BL	-36	-2	-18	-7	✓

SEATTLE HAWAII

△	IP	QUAD	IP	QUAD	comment
Line 13	HOOSE				
0400BL	+4	+1	-37	0	
0425 NE	+5	+2	-43	+1	
0450 NE	+4	+3	-44	<del>4</del>	
0475 NE	+5	+3	-43	-5	
1400 NE	0	0	-40	-6	
1425 NE	0	+2	-40	-7	
1450 NE	-2	+2	-42	-9	
1475 NE	-5	+2	-36	-8	
2400 NE	-5	+3	-33	-8	
2425 NE	-6	+2	-28	-8	✓
2450 NE	-4	+5	-26	-10	
2475 NE	-7	+4	-22	-8	
3400 NE	-10	+3	-17	-4	Ridge top 3475 NE ↓

LINE	12+00 SE				
4400 NE	-27	-6	+14	+7	↓
3475 NE	-27	-6	+12	+8	✓
3450 NE	-25	-5	+8	+5	
3425 NE	-24	-5	-1	+4	
2400 NE	-23	-4	-6	+2	
2475 NE	-19	-2	-14	-2	
2450 NE	-15	+2	-21	-6	Ridge top

A	SEATTLE		HAWAII		9 COMMENTS
	IP	QUAD	IP	QUAD	
Line	12+00	SE	continued		
2+25 NE	-13	+2	-27	-8	
2+00 NE	-12	+2	-36	-11	
1+75 NE	-11	+1	-37	-10	
1+50 NE	-7	+2	-41	-11	
1+25 NE	-5	+2	-47	-10	
1+00 NE	-2	0	-43	-9	
0+75 NE	-2	0	-42	-6	
0+50 NE	0	0	-45	-6	
0+25 NE	+4	+2	-44	-6	
0+00 NE	+5	+2	-43	-5	



Line 2+00 NW

0+00 SE	-44	+2	+4	+10	
0+25 NE	-54	-5	0	+9	
0+50 NE	-48	-2	0	+9	
0+75 NE	-52	0	-4	+6	
1+00 NE	-47	0	-6	+5	
1+25 NE	-45	-1	-4	+8	
1+50 NE	-48	0	-9	+4	
1+75 NE	-57	-3	-12	+2	
2+00 NE	-59	-3	-15	+2	
2+25 NE	-53	-2	-21	0	
2+50 NE	-52	-4	-36	-10	

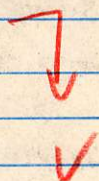

DRAW AT  
2+40  
← on other  
side hill

△	SEATTLE		HAWAII		COMMENT
	IP	QUAD	IP	QUAD	
line 2+00 NW cont.					
2+75 NE	-47	-3	-40	-11	
3+00 NE	-44	-2	-45	-10	
3+25 NE	-42	-2	-47	-11	
3+50 NE	-43	-2	-47	-12	
3+75 NE	-42	-3	-47	-10	
4+00 NE	-40	-2	-45	-10	
4+25 NE	-41	-4	-46	-10	
4+50 NE	-41	-4	-44	-8	
4+75 NE	-43	-8	-50	-11	
5+00 NE	-39	-6	-53	-10	
5+25 NE	-35	-2	-52	-10	
5+50 NE	-33	0	-54	-12	
5+75 NE	-34	+2	-49	-9	
6+00 NE	-39	+2	-48	-7	
6+25 NE	-41	-2	-40	-1	
6+50 NE	-44	-2	-38	+1	
6+75 NE	-54	-1	-52	+1	
7+00 NE	-65	-3	-66	-1	in slight draw on sid. hill
7+25 NE	-49	+3	-51	-3	
7+50 NE	-39	+6	-53	0	
7+75 NE	-34	+6	-48	0	
8+00 NE	-30	+7	-47	0	

✓

SEATTLE

HAWAII

10  
Comments

$\Delta$	IP	QUAD	IP	QUAD	10 Comments
Line	3+00	NW			
8+00 NE	-39	+7	-47	-5	
7+15 NE	-34	+8	-48	-3	
7+50 NE	-30	+4	-50	-4	
7+25 NE	-33	+2	-52	-7	
7+00 NE	-35	0	-50	-8	
6+75 NE	-33	-2	-47	-6	
6+50 NE	-30	-5	-45	-5	
6+25 NE	-41	-10	-47	-9	out top of bluff outcrop
6+00 NE	-43	-9	-44	-6	
5+75 NE	-45	-10	-45	-8	
5+50 NE	-43	-6	-43	-8	
5+25 NE	-43	-5	-43	-10	
5+00 NE	-45	-5	-42	-11	
4+75 NE	-48	-6	-44	-10	
4+50 NE	-51	-7	-44	-10	
4+25 NE	-47	-5	-41	-9	
4+00 NE	-51	-2	-40	-10	
3+75 NE	-47	-2	-44	-9	
3+50 NE	-46	-1	-48	-12	
3+25 NE	-47	-2	-52	-13	
3+00 NE	-40	0	-48	-10	
2+75 NE	-43	0	-49	-10	
2+50 NE	-43	-1	-50	-11	✓

△	SEATTLE		HAWAII		COMMENT
	IP	QUAD	IP	QUAD	
Line 3+00 NW cont.					
2+25 NE	-48	0	-47	-12	
2+00 NE	-53	-2	-43	-11	
1+75 NE	-55	-2	-41	-13	
1+50 NE	-62	-1	-36	-9	
1+25 NE	-66	-1	-27	-5	
1+00 NE	-66	0	-21	-1	in drainage created by 2 slopes
0+75 NE	-53	-2	-18	-3	
0+50 NE	-53	-3	-16	0	
0+25 NE	-55	-7	-12	+1	
0+00 BL	-63	-8	-8	+2	

### LINE 5+00 SE

0+00 BL	+20	+7	-21	0	
0+25 SW	+25	+6	-20	+1	
0+50 SW	+26	+14	-20	+3	
0+75 SW	+23	+10	-19	+4	
1+00 SW	+27	+13	-18	+4	
1+25 SW	+21	+8	-19	+1	
1+50 SW	+20	+8	-23	0	
1+75 SW	+20	+10	-21	+2	
2+00 SW	+17	+7	-19	+3	
2+25 SW	+20	+12	-18	+2	✓
2+50 SW	+16	+11	-18	+2	

Δ	SEATTLE		HAWAII		Comments <sup>(11)</sup>
	IP	QUAD	IP	QUAD	
LINE	STOOSE cont.				
2+75 SW	+14	+14	-17	+3	
3+0 SW	+14	+12	-18	+3	
3+25 SW	+11	+11	-22	+2	
3+50 SW	+3	+5	-22	+2	
3+75 SW	-1	+2	-21	+4	creek at 3+90 SW
4+0 SW	-9	-3	-26	0	
4+25 SW	-15	-5	-28	-2	
4+50 SW	-18	-6	-31	-2	
4+75 SW	-23	-5	-31	-2	
5+0 SW	-41	-13	-24	0	
5+25 SW	-27	-4	-32	-1	
5+50 SW	-30	-6	-32	0	
5+75 SW	-28	-4	-29	-2	
6+0 SW	-27	-2	-28	-2	
6+25 SW	-23	+1	-21	+2	
6+50 SW	-23	+2	-14	+3	
6+75 SW	-23	+3	-13	0	
7+0 SW	-29	+2	-12	-3	
7+25 SW	-31	+3	-16	-6	
7+50 SW	-35	+3	-17	-6	
7+75 SW	-40	+2	-18	-6	
8+0 SW	-37	+1	-17	-7	



SEATTLE HAWAII

Δ	IP	QUAD	IP	QUAD	comments
Line 4+00 SE					
8+00 SW	-31	+2	-12	-4	
7+75 SW	-39	-1	-24	-10	
7+50 SW	-49	-5	-36	-12	
7+25 SW	-51	-7	-40	-12	
7+00 SW	-43	-5	-41	-11	
6+75 SW	-42	-5	-42	-10	
6+50 SW	-39	-5	-40	-7	
6+25 SW	-35	-3	-39	-6	
6+00 SW	-35	-4	-38	-4	
5+75 SW	-38	-6	-33	0	
5+50 SW	-37	-4	-31	+3	
5+25 SW	-40	-7	-31	+4	
5+00 SW	-35	-4	-40	-3	change in slope dir.
4+75 SW	-31	-4	-37	0	
4+50 SW	-26	-4	-38	0	
4+25 SW	-23	-4	-41	0	
4+00 SW	-17	0	-38	+2	creek at 3+85
3+75 SW	-14	0	-36	+1	
3+50 SW	-12	-1	-40	-2	creek at 3+50 SW
3+25 SW	-3	+4	-38	-1	
3+00 SW	-3	+5	-36	0	
2+75 SW	0	+8	-32	+1	
2+50 SW	0	+8	-32	+7	✓



▲	SEATTLE		HAWAII		⑫ comments
	IP	QUAD	IP	QUAD	
LINE	4400 SE cont.				
2425 SW	+5	+10	-32	+2	
2400 SW	+6	+9	-32	+2	
1475 SW	+7	+8	-30	+5	
1450 SW	+11	+8	-30	+3	
1425 SW	+14	+10	-32	+2	
1400 SW	+19	+10	-34	0	
0475 SW	+21	+12	-34	-2	
0450 SW	+20	+11	-31	0	
0425 SW	+18	+12	-23	+1	
					✓
LINE	3400 SE				
0425 SW	+21	+11	-14	0	
0450 SW	+29	+14	-15	0	
0475 SW	+28	+12	-12	+4	
1400 SW	+25	+12	-11	+4	
1425 SW	+22	+13	-15	+3	
1450 SW	+17	+10	-22	+2	
1475 SW	+14	+10	-28	+1	
2400 SW	+8	+11	-33	0	
2425 SW	-2	+4	-35	-1	slight drainage
2450 SW	-10	-2	-38	-4	
2475 SW	-5	-1	-31	-2	
3400 SW	-2	+1	-28	-3	

SEATTLE

HAWAII

△

IP QUAD IP QUAD

Comments

Line 3400 SE cont

3+25 SW -10 -4 -31 -4

3+50 SW -17 -6 -31 -3

3+75 SW -16 -4 -33 -5'

4+00 SW -16 -4 -32 -3

4+25 SW -28 -10 -26 -2

drainage +  
change in  
slope direction  
at 4+20

4+50 SW -22 -6 -29 -2

4+75 SW -21 -5 -29 -1

5+00 SW -21 -4 -32 -2

5+25 SW -26 -4 -33 -3

5+50 SW -31 -5 -34 -1

5+75 SW -36 -8 -35 -2

6+00 SW -37 -8 -35 -1

6+25 SW -32 -6 -34 -3

6+50 SW -38 -8 -34 -2

6+75 SW -36 -7 -35 -3

7+00 SW -44 -9 -38 -6

7+25 SW -38 -6 -38 -6

7+50 SW -39 -4 -37 -5

7+75 SW -42 -3 -38 -6

8+00 SW -45 -4 -40 -6

✓

## SEATTLE

## HAWAII

(13)

△ Line	SEATTLE		HAWAII		COMMENTS
	IP	QUAD	IP	QUAD	
	2+00SE				
8+00SW	-11	-3	-15	-3	
7+75SW	-13	-3	-18	-2	
7+50SW	-16	-3	-21	0	
7+25SW	-19	-2	-23	+2	
7+00SW	-24	-1	-25	+2	
6+75SW	-30	-4	-27	+4	
6+50SW	-34	-4	-31	+2	
6+25SW	-41	-7	-34	0	
6+00SW	-43	-6	-33	0	
5+75SW	-36	-2	-28	+2	
5+50SW	-31	0	-25	+1	
5+25SW	-30	0	-29	+1	
5+00SW	-28	-1	-29	-1	
4+75SW	-25	-2	-29	0	
4+50SW	-24	-3	-32	0	
4+25SW	-23	-4	-33	0	
4+00SW	-22	-3	-37	-1	
3+75SW	-20	-3	-40	-2	
3+50SW	-19	-2	-40	-2	
3+25SW	-17	-2	-42	-3	
3+00SW	-14	-1	-41	-1	✓
2+75SW	-12	0	-40	0	
2+50SW	-15	-1	-42	-3	

## SEATTLE

## HAWAII

△	IP	QUAD	IP	QUAD	COMMENTS
Line 2+005E continued.					
2+25 SW	-13	-1	-41	-4	
2+00 SW	-8	0	-41	-6	
1+75 SW	-4	+3	-39	-7	
1+50 SW	-6	0	-25	-3	
1+25 SW	+6	+6	-25	-4	
1+00 SW	+15	+10	-28	-2	
0+75 SW	+18	+9	-26	-2	
0+50 SW	+17	+11	-25	-1	
0+25 SW	+12	+12	-21	0	
Line 1+005E					
0+25 SW	-6	+7	-31	-5	
0+50 SW	-7	+6	-38	-6	
0+75 SW	-13	+3	-39	-3	
1+00 SW	-14	+4	-45	-3	
1+25 SW	-19	+4	-47	-6	
1+50 SW	-19	+4	-46	-2	
1+75 SW	-18	+4	-44	0	
2+00 SW	-9	+6	-45	-1	
2+25 SW	-10	+4	-43	-1	
2+50 SW	-13	+3	-42	0	
2+75 SW	-14	+3	-36	0	

△	SEATTLE		HAWAII		COMMENTS
	IP	QUAD	IP	QUAD	
Line	1400 SE		continued		
3+00SW	-13	+3	-35	0	
3+25SW	-15	+2	-37	-2	
3+50SW	-18	0	-37	0	
3+75SW	-21	-1	-37	-2	
4+00SW	-22	-2	-38	-1	
4+25SW	-28	-3	-39	-2	
4+50SW	-30	-3	-39	-1	
4+75SW	-36	-5	-41	-2	
5+00SW	-38	-4	-39	-2	
5+25SW	-38	-1	-34	-2	
5+50SW	-36	-4	-31	-2	
5+75SW	-34	-4	-28	-3	
6+00SW	-23	-3	-22	-1	
6+25SW	-20	-5	-17	+1	
6+50SW	-23	-6	-26	-2	
6+75SW	-25	-8	-30	-4	
7+00SW	-22	-7	-29	-1	
7+25SW	-19	-6	-27	-1	
7+50SW	-15	-5	-25	-1	
7+75SW	-13	+2	-20	+4	top of ridge
8+00SW	-9	+4	-21	+3	
					✓

SEATTLE

HAWAII

△ Line	SEATTLE		HAWAII		COMMENTS
	IP	QUAD	IP	QUAD	
	7400 SE				
0425 SW	+15	+12	-25	-4	
0450 SW	+18	+14	-23	-1	
0475 SW	+22	+14	-24	-1	
1400 SW	+16	+10	-26	-2	
1425 SW	+19	+11	-22	0	
1450 SW	+20	+9	-23	+2	
1475 SW	+24	+11	-26	+2	
2400 SW	+22	+9	-23	0	
2425 SW	+17	+6	-19	+1	
2450 SW	+19	+5	-20	-2	
2475 SW	+21	+5	-19	0	
3400 SW	+24	+6	-18	0	
3425 SW	+25	+8	-16	+2	
3450 SW	+23	+9	-17	+1	
3475 SW	+17	+8	-14	+1	
4400 SW	+9	+6	-10	+3	
4425 SW	-5	-4	-14	+2	creek
4450 SW	-15	-10	-18	0	
4475 SW	-22	-14	-24	-3	
5400 SW	-26	-10	-25	-4	
5425 SW	-23	-5	-27	-4	
5450 SW	-32	-6	-27	-3	slight drainage
5475 SW	-37	-4	-26	-4	✓

△	SEATTLE		HAWAII		⑮ COMMENTS
	IP	QUAD	IP	QUAD	
Line	7+00SE		Continued.		
6+00SW	-37	+1	-30	-4	
6+25SW	-44	+2	-34	-6	
6+50SW	-56	+4	-32	-4	
6+75SW	-55	+5	-28	-3	
7+00SW	-60	+5	-25	-2	
7+25SW	-51	+5	-21	+1	
7+50SW	-37	+1	-21	0	
7+75SW	-39	-5	-23	-1	
8+00SW	-37	-7	-25	0	✓
Line	6+00SE				
8+00SW	-37	-1	-12	-6	
7+75SW	-35	-1	-14	-8	
7+50SW	-36	0	-14	-6	
7+25SW	-33	+1	-17	-6	
7+00SW	-31	+2	-21	-6	
6+75SW	-31	+3	-23	-5	
6+50SW	-38	+1	-23	-5	
6+25SW	-39	-2	-19	-2	
6+00SW	-35	-3	-21	-2	
5+75SW	-34	-4	-22	-2	
5+50SW	-27	-4	-21	-1	
5+25SW	-25	-4	-24	-1	✓

$\Delta$	IP	QUAD	IP	QUAD	COMMENTS
Line	6+00SE continued				
5+00 SW	-26	-28	-25	0	
4+75 SW	-24	-6	-22	+3	
4+50 SW	-29	-11	-24	+1	
4+25 SW	-22	-9	-23	+1	creek at 4+20
4+00 SW	-14	-5	-30	-1	
3+75 SW	+2	0	-31	0	
3+50 SW	+8	+2	-29	+1	
3+25 SW	+13	+3	-28	+1	
3+00 SW	+12	+3	-28	-2	
2+75 SW	+17	+4	-28	-1	
2+50 SW	+17	+3	-27	-2	
2+25 SW	+18	+3	-29	-5	
2+00 SW	+23	+4	-33	-6	
1+75 SW	+22	+5	-26	-2	
1+50 SW	+20	+6	-24	-1	
1+25 SW	+19	+7	-22	+1	
1+00 SW	+23	+10	-24	0	
0+75 SW	+20	+10	-26	-3	
0+50 SW	+21	+11	-25	-1	
0+25 SW	+21	+13	-23	0	✓



$\Delta$	IP	QUAD	IP	QUAD	COMMENTS
<u>Line 8400 SE</u>					
0+25 SW	+15	+8	-27	-7	
0+50 SW	+16	+8	-24	-3	
0+75 SW	+18	+6	-24	0	
1+00 SW	+21	+7	-24	-1	
1+25 SW	+18	+5	-23	-1	
1+50 SW	+19	+6	-23	0	
1+75 SW	+18	+5	-20	+1	
2+00 SW	+20	+6	-19	+4	
2+25 SW	+19	+6	-17	+4	
2+50 SW	+18	+5	-18	+5	
2+75 SW	+25	+10	-21	+6	
3+00 SW	+18	+7	-22	+5	
3+25 SW	+8	+2	-32	+2	
3+50 SW	0	-6	-42	-2	
3+75 SW	-4	-2	-35	-1	
4+00 SW	-9	-2	-31	-1	
4+25 SW	-16	-7	-31	-1	
4+50 SW	-20	-8	-28	-1	creek at 4+48
4+75 SW	-23	-10	-28	-1	
5+00 SW	-28	-10	-28	-1	
5+25 SW	-27	-7	-27	-2	
5+50 SW	-32	-7	-27	-3	

△	SEATTLE		HAWAII		COMMENTS
	IP	QUAD	IP	QUAD	
Line 8+00 SE cont.					
5+75 SW	-32	-4	-25	-4	
6+00 SW	-40	0	-21	-1	
6+25 SW	-43	+2	-15	0	
6+50 SW	-43	+5	-13	-1	
6+75 SW	-49	+4	-11	-2	
7+00 SW	-42	+1	-13	-4	
7+25 SW	-29	-2	-13	+1	
7+50 SW	-30	-6	-13	0	
7+75 SW	-36	-9	-8	+2	
8+00 SW	-35	-5	-4	+4	

Line 9+00 SE

8+00 SW	-36	-11	-3	-3	↓
7+75 SW	-31	-8	-5	-3	
7+50 SW	-28	-5	-6	-1	✓
7+25 SW	-31	-4	-8	+1	
7+00 SW	-31	0	-13	-2	
6+75 SW	-37	+1	-12	-3	
6+50 SW	-54	0	-17	-2	
6+25 SW	-53	+2	-19	0	
6+00 SW	-63	0	-26	+1	

△	SEATTLE		HAWAII		17 COMMENTS
	IP	QUAD	IP	QUAD	
Line	9.100SE cont.				
5+75 SW	-57	0	-30	+1	
5+50 SW	-47	+1	-32	+3	
5+25 SW	-48	0	-33	+3	
5+0 SW	-39	0	-38	+5	
4+75 SW	-36	0	-39	+4	
4+50 SW	-35	-3	-39	+6	check ✓
4+25 SW	-14	+1	-37	+4	↑
4+0 SW					
3+75 SW					
3+50 SW					
3+25 SW					
3+0 SW					
2+75 SW					
2+50 SW					
2+25 SW					
2+0 SW					
1+75 SW					
1+50 SW					
1+25 SW					
1+0 SW					
0+75 SW					
0+50 SW					
0+25 SW					

SEATTLE

HAWAII

△

IP

QUAD

IP

QUAD

comments

Line 10 + 00 SF

0+25 SW +18 +10

0+50 SW +14 +7

0+75 SW +10 +3

1+00 SW +6 0

1+25 SW +5 +1

1+50 SW +12 +5

1+75 SW +7 +2

2+00 SW +10 +4

2+25 SW

2+50 SW

2+75 SW

3+00 SW

3+25 SW

3+50 SW

3+75 SW

4+00 SW

4+25 SW

4+50 SW

4+75 SW

5+00 SW

5+25 SW

5+50 SW

△	SEATTLE		HAWAII		18 COMMENTS
	IP	QUAD	IP	QUAD	
Line	10+00	SE	cont.		
5+75 SW					
6+00 SW					
6+25 SW	-55	+2	-5	+3	
6+50 SW	-40	+2	-11	+1	
6+75 SW	-41	+1	-12	+5	
7+00 SW	-47	+1	-7	+6	
7+25 SW	-36	+5	-4	+7	
7+50 SW	-44	+1	+1	+8	
7+75 SW	-44	-1	-3	+5	
8+00 SW	-42	-1	-2	+8	
Line	11+00	SE			
0+25 SW	+14	+6	-40	+1	
0+50 SW	+14	+6	-38	-2	
0+75 SW	+13	+6	-34	+2	
1+00 SW	+13	+5	-32	+2	
1+25 SW	+7	+6	-31	+4	
1+50 SW	+19	+6	-32	+2	
1+75 SW	+15	+5	-30	+3	
2+00 SW	+14	+4	-28	+2	
2+25 SW	+12	+4	-27	+3	
2+50 SW	+15	+6	-26	+4	

△	SEATTLE		HAWAII		Comments
	IP	QUAD	IP	QUAD	
Line 11400SE		Continued			
2+75 SW	+14	+5	-25	+4	
3+00 SW	+12	+3	-25	+1	
3+25 SW	+14	+3	-22	+2	
3+50 SW	+18	+4	-18	+4	
3+75 SW	+18	+2	-15	+1	
4+00 SW	+8	-1	-12	0	
4+25 SW	+7	-2	-7	0	
4+50 SW	+6	-1	0	+1	Creek at 4+45
4+75 SW	-5	-4	+2	+2	
5+00 SW	-4	+1	+7	+1	
5+25 SW	-19	-3	+2	-1	
5+50 SW	-39	-4	-1	-1	
5+75 SW	-42	-5	-3	-2	
6+00 SW	-34	-1	-9	0	
6+25 SW	-35	-1	-11	0	
6+50 SW	-41	-2	-10	+3	
6+75 SW	-43	-3	-9	+3	
7+00 SW	-42	-3	-12	+2	
7+25 SW	-51	-7	-8	+3	
7+50 SW	-48	-6	-8	+2	
7+75 SW	-47	-5	-3	+5	
8+00 SW	-45	-6	+2	+10	

$\Delta$	IP	QUAD	IP	QUAD	COMMENTS
Line 12400 SE					
8400 SW	-38	-5	+12	+5	
7475 SW	-42	-3	+4	+3	
7450 SW	-52	-4	-3	+2	
7425 SW	-47	-4	-9	+1	
7400 SW	-53	-3	-10	+4	
6475	-50	-4	-15	+1	
6450	-64	-6	-10	+3	
6425	-72	-7	-13	+4	
6400	-50	-4	-18	+1	slight drainage
5475	-51	-9	-22	-4	
5450	-51	-10	-17	-3	
5425	-34	-6	-20	-3	
5400	-38	-10	-18	-1	
4475	-26	-6	-20	0	crack at 465
4450	-21	-6	-24	-2	
4425	-16	-5	-29	-3	
4400	-7	-2	-29	-1	
3475	-4	-1	-27	-1	
3450	+2	0	-28	-1	
3425	+4	+1	-26	+3	
3400	+6	+1	-27	+2	
2475	+4	-3	-29	-2	
2450	+4	-2	-32	0	





Δ	SEATTLE		HAWAII		COMMENTS
	IP	QUAD	IP	QUAD	
Line 3+00 NW					
0+25 SW	-47	-14	-7	+1	
0+50 SW	-39	-11	-11	-1	
0+75 SW	-38	-9	-6	+7	
1+00 SW	-21	+1	-1	+11	crest of ridge
1+25 SW	-12	+5	+1	+13	
1+50 SW	-4	+9	+1	+13	
1+75 SW	-6	+4	-7	+7	
2+00 SW	-10	0	-22	-2	
2+25 SW	-11	-2	-24	-2	
2+50 SW	-12	-3	-23	-1	
2+75 SW	-8	0	-17	+2	
3+00 SW	-5	+2	-12	+4	
3+25 SW	-2	+2	-12	+2	
3+50 SW	<del>2</del>	<del>+4</del>	-10	+2	
3+75 SW	-3	-1	-6	0	
4+00 SW	0	0	-6	-2	
4+25 SW	+1	+2	-4	-1	
4+50 SW	0	+1	-4	-2	top of hill
4+75 SW	+4	+2	-4	+1	
5+00 SW	+6	+1	-2	-1	
5+25 SW	+10	-1	+2	-2	
5+50 SW	+14	-2	+3	+1	
5+75 SW	+22	0	+5	+3	✓

A

SEATTLE

HAWAII

IP

QUAD

IP

QUAD

Comment

Line 3+00 NW continued

6+00 SW	+28	+2	+3	+3	
6+25 SW	+27	+4	-5	-2	
6+50 SW	+24	+3	-3	0	
6+75 SW	+26	+4	-1	+5	
7+00 SW	+25	+4	+1	+3	
7+25 SW	+24	+5	-2	+3	
7+50 SW	+22	+5	-2	+4	
7+75 SW	+24	+5	+3	+1	
8+00 SW	+24	+5	+5	+3	

Line 4+00 NW

8+00 SW	+37	+7	+9	+1	
7+75 SW	+35	+6	+12	+2	
7+50 SW	+34	+7	+13	+2	
7+25 SW	+26	+2	+12	0	
7+00 SW	+19	0	+7	-1	
6+75 SW	+22	+2	+10	+3	
6+50 SW	+25	+2	+11	+4	
6+25 SW	+26	+2	+13	+2	
6+00 SW	+27	+2	+14	+4	
5+75 SW	+27	+3	+18	+6	
5+50 SW	+29	+4	+20	+5	J

Line	SEATTLE		HAWAII		COMMENTS
	IP	QUAD	IP	QUAD	
Line 4400 NW	continued				
5+25 SW	+25	+5	+24	+10	
5+00 SW	+27	+7	+26	+10	
4+25 SW	+23	+6	+28	+10	
4+50 SW	+25	+6	+27	+12	
4+25 SW	+26	+6	+26	+12	
4+00 SW	+31	+8	+22	+10	
3+25 SW	+28	+8	+21	+13	
3+50 SW	+27	+8	+16	+12	
3+25 SW	+27	+6	+15	+12	
3+00 SW	+19	+4	+12	+10	
2+25 SW	+15	+3	+7	+5	
2+50 SW	+13	+5	+7	+5	
2+25 SW	+9	+4	+12	+7	
2+00 SW	+7	+5	+14	+7	
1+25 SW	+2	+5	+11	+6	
1+50 SW	-4	+3	+7	+5	
1+25 SW	-9	+2	+5	+4	
1+00 SW	-9	+6	+2	+4	
0+25 SW	-18	+2	+2	+5	
0+50 SW	-23	0	+1	+5	
0+25 SW	-28	0	-12	-2	
					✓

A	SEATTLE		HAWAII		COMMENTS
	IP	QUAD	IP	QUAD	
Line 0400					
0425 SW	-26	+2	-14	-3	
0450 SW	-17	+6	-14	-2	
0475 SW	-11	+3	-14	-4	
1400 SW	-8	+3	-15	-2	
1425 SW	-4	+6	-16	-4	
1450 SW	-3	+6	-17	0	
1475 SW	-8	+3	-18	0	
2400 SW	-11	+2	-22	0	
2425 SW	-12	+2	-26	-2	
2450 SW	-5	+4	-53	-7	
2475 SW	-8	+3	-55	-3	
3400 SW	-16	+1	-52	-2	
3425 SW	-19	-1	-53	-3	
3450 SW	-16	0	-37	+1	
3475 SW	-13	0	-34	0	
4400 SW	-14	-3	-34	-1	
4425 SW	-17	-6	-34	-4	
4450 SW	-20	-7	-31	-5	
4475 SW	-19	-8	-31	-5	
5400 SW	-19	-5	-27	-2	
5425 SW	-19	-5	-24	-1	
5450 SW	-17	-5	-22	-2	
5475 SW	-18	-4	-22	-3	



A	SEATTLE		HAWAII		COMMENTS
	IP	QUAD	IP	QUAD	
Line 0400 Continued					
6400SW	-21	-6	-21	-3	
6425SW	-26	-10	-22	-5	
6450SW	-30	-13	-24	-8	
6475SW	-34	-16	-25	-9	
6400SW	-32	-15	-19	-2	
6425SW	-24	-9	-22	-4	
6450SW	-14	-1	-23	-3	crest of hill
6475SW	-11	+3	-24	+1	
6400SW	-6	+3	-20	+2	
Line 1400 NW					
8400SW	+20	0	+5	-3	
7425SW	+18	+1	+1	-4	
7450SW	+8	-3	-7	-7	
7425SW	+5	-2	-10	-8	
7400SW	+1	-3	-8	-5	
6475SW	-9	-8	-17	-10	
6450SW	-16	-11	-25	-11	crest of hill
6425SW	-20	-12	-26	-10	
6400SW	-23	-13	-32	-12	
5475SW	-31	-16	-46	-15	
5450SW	-37	-14	-52	-15	

(22)

✓

△	SEATTLE		HAWAII		COMMENTS
	IP	QUAD	IP	QUAD	
Line 1400 N.W. continued					
5+25 SW	-33	-10	-58	-12	
5+00 SW	-32	-8	-56	-9	
4+75 SW	-29	-8	-50	-9	
4+50 SW	-26	-7	-47	-6	
4+25 SW	-24	-7	-43	-6	
4+00 SW	-19	-6	-44	-8	
3+75 SW	-14	-3	-53	-12	
3+50 SW	-9	0	-46	-11	
3+25 SW	-16	-1	-26	-5	spring
3+00 SW	-22	-2	-22	-8	at 3+25 SW 0+85 NW
2+75 SW	-22	-5	-26	-12	
2+50 SW	-20	-3	-25	-9	
2+25 SW	-23	-7	-33	-12	
2+00 SW	-23	-4	-37	-14	
1+75 SW	-21	-4	-35	-14	
1+50 SW	-19	0	-33	-15	
1+25 SW	-15	+1	-35	-13	
1+00 SW	-16	+1	-34	-12	
0+75 SW	-16	+1	-27	-10	
0+50 SW	-22	0	-19	-6	crest of ridge
0+25 SW	-26	0	-14	-3	
					✓

LA	SEATTLE		HAWAII		(22)
	IP	QUAD	IP	QUAD	
Line	2400 NW				
0425 SW	-29	-2	+1	+12	
0450 SW	-33	-8	-2	+14	
0475 SW	-37	-14	+2	+13	
1400 SW	-25	-4	-5	+7	
1425 SW	-3	+8	-16	+1	Ridge top
1450 SW	+4	+10	-19	+1	
1475 SW	+5	+7	-17	+3	
2400 SW	+4	+5	-15	+1	
2425 SW	+1	+3	-15	+1	
2450 SW	-2	+3	-13	0	
2475 SW	-5	+2	-12	0	
3400 SW	-12	-1	-13	-2	
3425 SW	-15	-4	-14	-4	
3450 SW	-17	-4	-15	-6	
3475 SW	-17	-5	-17	-8	
4400 SW	-16	-4	-17	-8	
4425 SW	-12	-2	-14	-6	
4450 SW	-10	-3	-13	-2	
4475 SW	-8	-4	-14	0	
5400 SW	-6	-8	-22	-6	
5425 SW	-2	-6	-12	-6	
5450 SW	+10	-4	-12	+4	
5475 SW	+5	-2	-5	0	✓

△

SEATTLE

HAWAII

IP

QUAD

IP

QUAD

COMMENTS

Line 2 +00 NW continued

6+00 SW	+25	-1	-2	0	
6+25 SW	+21	0	+2	+3	
6+50 SW	+26	+2	+6	+4	
6+75 SW	+28	+4	+11	+5	
7+00 SW	+29	+4	+12	+4	
7+25 SW	+27	+5	+16	+4	
7+50 SW	+31	+8	+17	+3	
7+75 SW	+33	+9	+20	+3	
8+00 SW	+38	+9	+21	+3	

✓



- CHEVRON CANADA RESOURCES
- VLF-EM SURVEY. - JULY, 1988.
- PROJECT M584
- WARREN GRID.
- GRID LINE ORIENTATION  $045^{\circ}$
- STATIONS: NPG SEATTLE 18.6 KHZ.
- : NPM HAWAII 23.4 KHZ.

11 x 1600m.	17600	}	20,600
2 x 1500m	3000m		
2 x 1300m	2600m	}	8300
2 x 1200m	2400m		
3 x 1100m	3300m		
1 x 800	800m		800

29,700

2,000

31,700 M.

B.L.

31.7K.

~ 18 to do.

Total line Flagged & plotted.  
24.7 Km. - Slope Corrected.

WARREN GRID

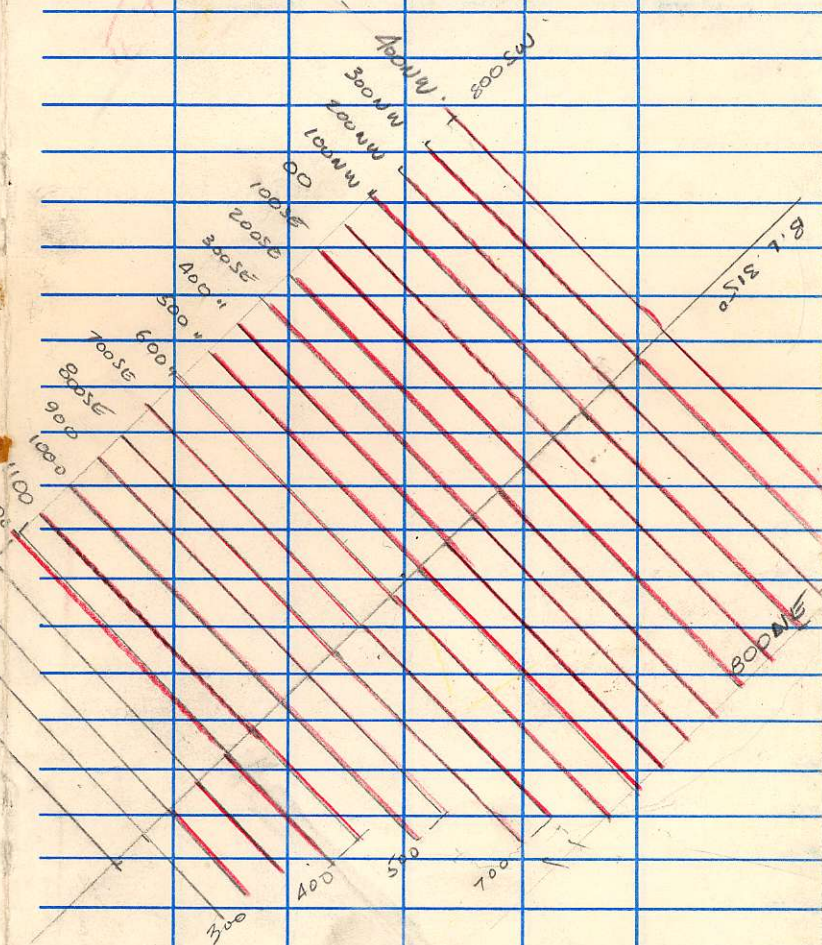

D	SEATTLE		HAWAII		24
	IP	QUAD	IP	QUAD	COMMENTS
Line	8+00SE				
0100	+11	+11	-27	-8	
0125 NE	+9	+12	-21	-6	
0150 NE	+5	+11	-18	-6	
0175 NE	+4	+9	-17	-7	
1100 NE	-2	+8	-15	-6	
1125 NE	-7	+6	-10	-1	
1150 NE	-14	+2	-5	+2	crest of ridge
1175 NE	-22	-3	0	+5	
2100 NE	-26	-4	+2	+8	
2125 NE	-32	-7	+6	+10	
2150 NE	-39	-10	+10	+9	
2175 NE	-37	-8	+13	+8	
3100 NE	-38	-7	+14	+8	
3125 NE	-43	-7	+13	+10	
3150 NE	-38	-6	+13	+9	
3175 NE	-42	-7	+14	+11	
4100 NE	-34	-3	+14	+7	
4125 NE	-30	-1	+16	+8	
4150 NE	-31	-3	+15	+9	
4175 NE	-31	-1	+18	+10	
5100 NE	-31	-1	+19	+10	
5125 NE	-26	+1	+18	+10	
5150 NE	-24	+4	+18	+11	

A	SEATTLE		HAWAII		Comments
	IP	QUAD	IP	QUAD	
Line 8	100 SE continued				
5475 NE	-23	+8	+17	+11	
6400 NE	-22	+8	+17	+10	
6425 NE	-22	+8	+12	+12	
6450 NE	-22	+7	+11	+9	
6475 NE	-22	+5	+13	+10	
7400 NE	-22	+4	+7	+9	
Line 9	100 SE				
5100 NE	-33	-3	+8	+6	↓ ↓ ↓ ↓ ↓ ↓ ↓ ↓ ↓ ↓
4475 NE	-31	-2	+8	+6	
4450 NE	-31	-2	+6	+4	
4425 NE	-36	-5	+7	+5	
4400 NE	-37	-6	+9	+6	
3475 NE	-39	-6	+10	+6	
3450 NE	-38	-6	+9	+6	
3425 NE	-38	-7	+8	+6	
3400 NE	-34	-6	+7	+6	
2475 NE	-31	-6	+6	+6	
2450 NE	-29	-6	+5	+6	
2425 NE	-26	-5	+2	+6	
2400 NE	-21	-2	-3	+2	
1475 NE	-16	0	-5	0	

△	SEATTLE		HAWAII		25 COMMENTS
	IP	QUAD	IP	QUAD	
Line 9	100 SE continued				
1450 NE	-9	+4	-10	-4	crest of ridge
1475 NE	-4	+7	-14	-4	
1400 NE	+2	+10	-12	-7	
0475 NE	+6	+11	-22	-8	
0450 NE	+11	+12	-25	-8	✓
0425 NE	+10	+10	-26	-6	
0400	+13	+10	-26	-5	∧ J

Line 10 100 SE				
0425 SW	+15	+10	-36	0
0450 SW	+13	+8	-41	-2
0475 SW	+8	+4	-48	-2
1400 SW	+5	+2	-54	-3
1425 SW	+4	+2	-46	0
1450 SW	+9	+3	-47	+3
1475 SW	+4	+4	-43	+2
2400 SW	+5	+4	-41	+5
2425 SW	+5	+3	-37	+4
2450 SW	+3	+1	-38	+3
2475 SW	+4	+1	-34	+4
3400 SW	+4	+1	-33	+3
3425 SW	+1	0	-32	+2
3450 SW	+6	+2	-28	+4

△	SEATTLE		HAWAII		Comments
	IP	QUAD	IP	QUAD	
Line	10+00 SE continued				
3+75 SW	+1	+1	-31	+4	
4+00 SW	+2	+3	-28	+2	
4+25 SW	-3	+2	-23	+3	
4+50 SW	-13	-1	-26	+2	creek at 4+55
4+75 SW	-17	-2	-24	+1	
5+00 SW	-25	-2	-20	+2	
5+25 SW	-32	-2	-17	0	
5+50 SW	-42	0	-13	+1	
5+75 SW	-41	+2	-7	+1	
6+00 SW	-45	+3	-5	+2	
6+25 SW	-46	+4	-5	+2	
6+50 SW	-39	+3	-10	+3	<del>scribble</del>

Line 9+00 SE

4+75 SW					
4+50 SW	-32	0	-42	+5	↓
4+25 SW	-20	+3	-40	+2	
4+00 SW	-12	-2	-38	0	✓
3+75 SW	-1	+3	-28	+4	
3+50 SW	+3	+5	-25	+7	
3+25 SW	+8	+7	-24	+7	
3+00 SW	+16	+8	-25	+6	

SEATTLE

HAWAII

26.

$\Delta$	IP	QUAD	IP	QUAD	Comments
Line	9+00 SE		continued		
2+75 SW	+17	+6	-29	+6	
2+50 SW	+14	+3	-35	+4	
2+25 SW	+13	+2	-41	+1	
2+00 SW	+13	0	-45	-3	
1+75 SW	+16	+2	-39	-1	
1+50 SW	+18	+4	-30	+2	
1+25 SW	+17	+4	-30	-1	
1+00 SW	+17	+5	-27	-2	
0+75 SW	+15	+6	-28	-3	✓
0+50 SW	+15	+2	-28	-2	
0+25 SW	+13	+8	-27	-2	↑

Line	10+00 SE				
0+00	+14	+9	-32	-4	
0+25 NE	+13	+9	-31	-3	
0+50 NE	+10	+9	-28	-4	
0+75 NE	+5	+7	-28	-5	
1+00 NE	+2	+8	-26	-8	
1+25 NE	-1	+7	-21	-7	
1+50 NE	-9	+4	-13	-3	
1+75 NE	-16	0	-11	-1	crest of ridge
2+00 NE	-24	-4	-7	-1	
2+25 NE	-31	-7	-4	-2	

## SEATTLE HAWAII

$\Delta$	IP	QUAD	IP	QUAD	Comments
Line 10400		SE	continued		
2450 NE	-36	-10	-3	-1	
2475 NE	-36	-8	-2	0	
3400 NE	-38	-9	+1	+2	
3425 NE	-40	-9	0	+2	
3450 NE	-42	-9	+3	+2	
3475 NE	-42	-11	+5	+2	
4400 NE	-41	-7	+3	+1	
4425 NE	-44	-8	+4	+2	
4450 NE	-44	-9	+2	+3	
4475 NE	-46	-9	+1	0	
5400 NE	-47	-9	-2	-2	

Line	11400 SE				
4400 NE	-41	-9	+8	+4	
3475 NE	-39	-8	+5	+3	
3450 NE	-38	-8	+5	+5	
3425 NE	-37	-6	+3	+3	
3400 NE	-36	-6	+2	+3	
2475 NE	-36	-6	+3	+4	
2450 NE	-33	-5	0	+4	
2425 NE	-27	-3	-5	+2	
2400 NE	-20	-1	-19	-5	in trench and at crest of ridge
1475 NE	-16	+1	-22	-8	



△	SEATTLE		HAWAII		Comments	
	IP	QUAD	IP	QUAD		
	Line 11 + 00SE		continued			
	1+50NE	-10	+2	-29	-9	
	1+25NE	-8	+1	-34	-10	
	1+00NE	-7	+1	-42	-10	
	0+75NE	-6	0	-43	-10	
	0+50NE	-1	+2	-43	-7	
	0+25NE	0	+2	-42	-4	
	0+00	+5	+2	-43	-2	
	Line 14 + 00SE					
	3+00NE	+1	+6	-31	-10	
	2+75NE	-1	+4	-33	-10	
	2+50NE	0	+2	-37	-9	
	2+25NE	+1	+1	-41	-10	
	2+00NE	-2	0	-44	-10	
	1+75NE	-6	-2	-44	-9	
	1+50NE	-5	-3	-47	-10	
	1+25NE	-6	-5	-46	-7	
	1+00NE	-6	-5	-47	-6	
	0+75NE	-8	-6	-47	-5	
	0+50NE	-7	-5	-47	-5	
	0+25NE	-5	-6	-55	-9	
	0+00	-6	-6	-50	-5	

SEATTLE

HAWAII

28

	IP	QUAD	IP	QUAD	Comments
Line	16+00 SE				
0+00	-7	-6	-41	-7	
0+25 SW	-5	-6	-40	-6	
0+50 SW	-5	-4	-34	-3	
0+75 SW	-2	-3	-31	-2	
1+00 SW	-2	0	-28	-3	
1+25 SW	-1	0	-27	-2	
1+50 SW	0	+1	-28	-4	
1+75 SW	-2	0	-27	0	
2+00 SW	-2	0	-36	-4	
2+25 SW	-6	-1	-40	-5	
2+50 SW	-4	+1	-37	-5	
2+75 SW	-4	+2	-35	-2	
3+00 SW	-12	0	-34	-4	
3+25 SW	-12	0	-29	0	
3+50 SW	-19	-2	-22	0	creek
3+75 SW	-30	-5	-13	+4	
4+00 SW	-29	-5	-9	+3	
4+25 SW	-28	-5	-2	+8	
4+50 SW	-23	0	+3	+7	
4+75 SW	-22	+4	+9	+10	
5+00 SW	-20	+3	+17	+12	
5+25 SW	-17	+4	+20	+14	
5+50 SW	-14	+6	+20	+12	

SEATTLE

HAWAII

△

IP

QUAD

IP

QUAD

Comments

Line 16 to 00SE continued

5+75 SW	-16	+3	+20	+11	
6+00 SW	-14	+1	+24	+11	
6+25 SW	-25	-2	+25	+10	
6+50 SW	-32	-4	+22	+5	slight drainage.
6+75 SW	-27	-3	+17	+3	
7+00 SW	-28	-4	+7	-1	
7+25 SW	-26	-4	+10	+1	
7+50 SW	-18	0	+13	+3	
7+75 SW	-15	0	+6	+2	
8+00 SW	-13	-1	0	+1	

Line 15 to 00SE

8+00 SW	-29	-4	-5	+1	
7+75 SW	-31	-4	-2	+4	
7+50 SW	-35	-5	+1	+3	
7+25 SW	-34	-4	+3	+2	
7+00 SW	-35	-4	+5	+2	
6+75 SW	-34	-4	+5	+4	
6+50 SW	-34	-5	+5	+3	
6+25 SW	-31	-5	+5	+1	
6+00 SW	-32	-6	+5	+2	
5+75 SW	-31	-7	+5	+3	

△	SEATTLE		HAWAII		29 Comments
	IP	QUAD	IP	QUAD	
line	15+00	SE	continued		
5+50 SW	-26	-6	+3	+2	
5+25 SW	-29	-7	+2	+2	
5+00 SW	-27	-8	-1	+2	
4+75 SW	-26	-8	-4	+4	
4+50 SW	-26	-7	-7	+3	
4+25	-21	-5	-8	+2	
4+00	-14	0	-9	+3	creek
3+75	-14	-2	-17	+1	disturbed placer ground
3+50	-9	-2	-23	0	
3+25	-2	+1	-21	-1	
3+00	-3	+2	-25	-1	
2+75	-1	+1	-26	-4	
2+50	+2	+2	-26	-2	
2+25	0	0	-26	-3	
2+00	-1	-1	-28	-3	
1+75	-2	-2	-29	-2	
1+50	-4	-2	-32	-5	
1+25	-1	-3	-34	-4	
1+00	+1	-4	-37	-2	
0+75	+1	-4	-42	-6	
0+50 SW	-3	-6	-37	-3	
0+25 SW	-3	-7	-39	-4	
0+00 SW	-2	-7	-41	-5	

①	SEATTLE		HAWAII		Comments
	IP	QUAD	IP	QUAD	
Line 15	100	SE			
0+25 NE	-1	-5	-41	-4	
0+50 NE	0	-7	-42	-5	
0+75 NE	-1	-7	-42	-4	
1+00 NE	0	-6	-42	-4	
1+25 NE	-1	-4	-46	-7	
1+50 NE	+2	-3	-46	-8	
1+75 NE	+2	-2	-49	-9	
2+00 NE	+5	+2	-45	-8	
2+25 NE	+7	+5	-44	-7	
2+50 NE	+8	+6	-43	-6	
2+75 NE	+7	+6	-46	-8	
3+00 NE	+3	+6	-37	-6	
LINE 14	100	SE			
0+00	-4	-7	-51	-5	
0+25 SW	0	-3	-54	-6	
0+50 SW	+3	-3	-55	-7	
0+75 SW	+1	-4	-53	-7	
1+00 SW	-4	-5	-49	-7	
1+25 SW	-4	-5	-45	-7	

SEATTLE

HAWAII

30

$\Delta$	IP	QUAD	IP	QUAD	Comments
Line 14+00 SE continued					
1450 SW	-8	-4	-42	-6	
1475 SW	-4	-1	-42	-6	
2+00 SW	-5	0	-36	-5	
2+25 SW	-5	0	-35	-4	
2+50 SW	-2	+1	-37	-4	
2+75 SW	-3	+1	-32	-3	
3+00 SW	+2	+2	-28	-2	
3+25 SW	-1	+1	-26	-1	
3+50 SW	-3	+1	-24	-2	
3+75 SW	-6	0	-20	-1	
4+00 SW	-11	-1	-21	-2	creek at 4+07 channelled
4+25 SW	-18	-3	-13	0	often channel at 4+20
4+50 SW	-25	-4	-8	+2	
4+75 SW	-24	-3	-2	+5	
5+00 SW	-26	-2	0	+8	
5+25 SW	-31	-4	-7	+4	
5+50 SW	-30	-2	-5	+6	
5+75 SW	-34	0	-2	+8	
6+00 SW	-36	0	+1	+9	
6+25 SW	-38	0	-2	+7	
6+50 SW	-39	0	-2	+7	
6+75 SW	-44	+1	-3	+6	✓

Line	SEATTLE		HAWAII		Comments
	IP	QUAD	IP	QUAD	
Line 14+00 SE	continued				
7+00 SW	-46	0	-4	+7	
7+25 SW	-57	-4	-5	+7	
7+50 SW	-61	-7	-7	+4	
7+75 SW	-60	-6	-12	+4	
8+00 SW	-56	-5	-13	+5	
Line 13+00 SE					
8+00 SW	-26	+4	+6	+6	
7+75 SW	-31	+5	+6	+7	
7+50 SW	-45	0	+4	+7	small spring or drainage
7+25 SW	-43	+3	+4	+8	
7+00 SW	-44	+2	-1	+3	drainage at 13+05
6+75 SW	-45	0	-7	+5	
6+50 SW	-47	+1	-10	+6	in drainage area
6+25 SW	-48	0	-11	+5	
6+00 SW	-44	+1	-10	+6	
5+75 SW	-42	0	-8	+8	
5+50 SW	-37	0	-10	+5	drainage at 12+90
5+25 SW	-31	-2	-13	+3	drainage at 12+95
5+00 SW	-33	-6	-12	0	in drainage
4+75 SW	-27	-6	-11	+1	drainage at 13+05

SEATTLE

HAWAII

31

$\Delta$	IP	QUAD	IP	QUAD	Comments
Line BOOSTER continued					
4450 SW	-23	-4	-8	+1	
4425 SW	-19	-3	-23	-1	in creek
4400 SW	-10	0	-22	+1	
3475 SW	-6	0	-28	0	
3450 SW	-6	-1	-31	-1	
3425 SW	-5	-2	-34	-1	
3400 SW	-4	-1	-32	-2	
2475 SW	-4	-2	-38	-4	
2450 SW	-3	-1	-39	-3	
2425 SW	-1	-2	-36	0	
2400 SW	+2	0	-35	0	
1475 SW	-1	0	-38	-1	
1450 SW	-4	-2	-43	-2	
1425 SW	-3	-3	-47	-3	
1400 SW	-1	-4	-50	-3	
0475 SW	+1	-4	-52	-4	
0450 SW	-3	-4	-43	-2	
0425 SW	-1	-4	-40	-3	
0400	+2	-3	-39	-3	



line 14 is 100 from line 13  
and ~~70~~ 21 m short

line 15 is 100 m from 14  
and 20 m long