

1974

840446

Misc Field Notes

Sturrop Creek Project.

## Geology -

Dr. Tipper - suggests porphyry intrusion may be Tertiary - possibly related to volcanism to the east.

- Property sits in highly fractured area between Tallacorn and Ward Creek faults - where E-W fault component is prominent - some block faulting
- No gold has been found related to conglomerate of that period -



NB

ST. ~~110~~ BE 10-2W Sandstone  
N15°E -42°SE Bedding?

1" = 40'

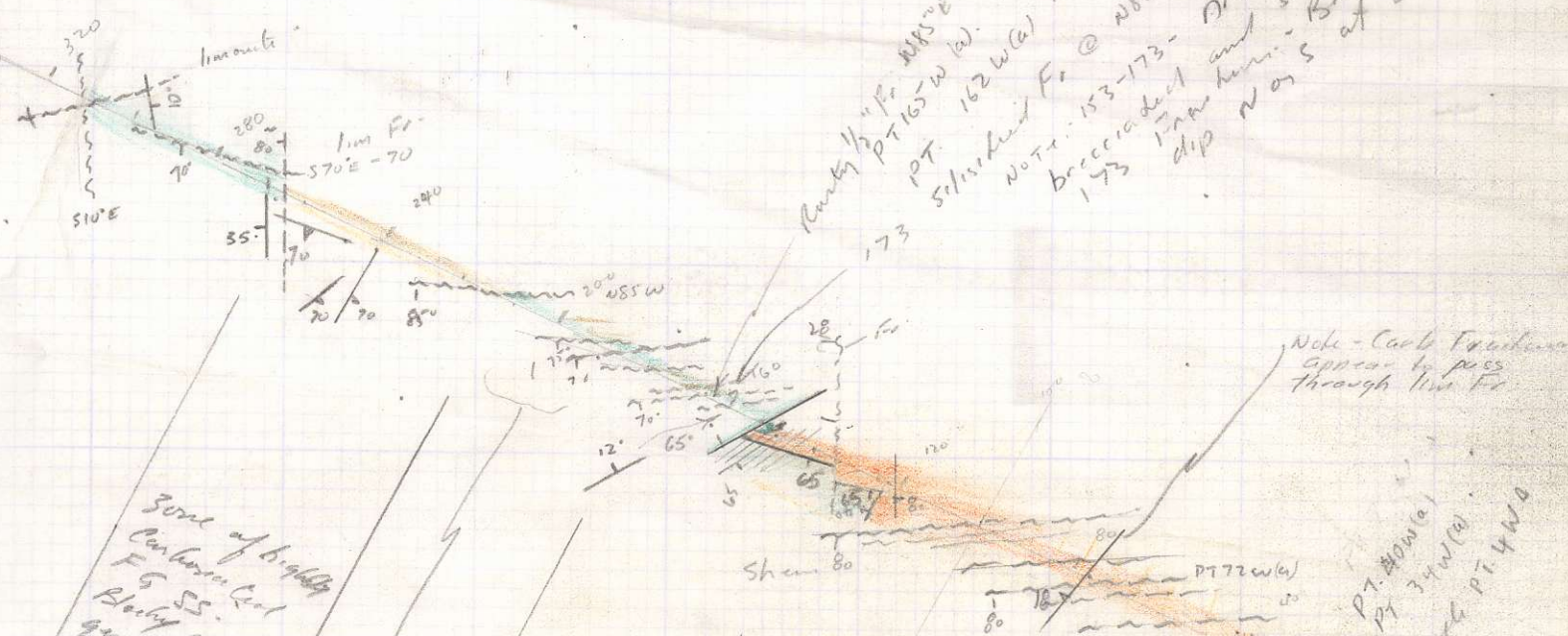

Zone of highly  
carbonated  
Fg. SS.  
Blocky and  
gen weld  
Shallow

Zone of  
imbricated  
Arg. & SS.  
Spray  
carbonated  
& locally  
some silic

Major Fract @ 575°E

150-173  
Manganese  
T.B. Arg.  
Some spray  
lim Fract.  
Gen weld  
Shallow

Prevailing N85°E limonite  
Fractures

Note - Carb Fractures  
appear to pass  
through lim Fr

PT 173W(a)  
PT 162W(a)  
PT 173W(a)  
PT 172W(a)  
PT 174W(a)  
PT 174W(b)  
Rocky limonite  
Fracture

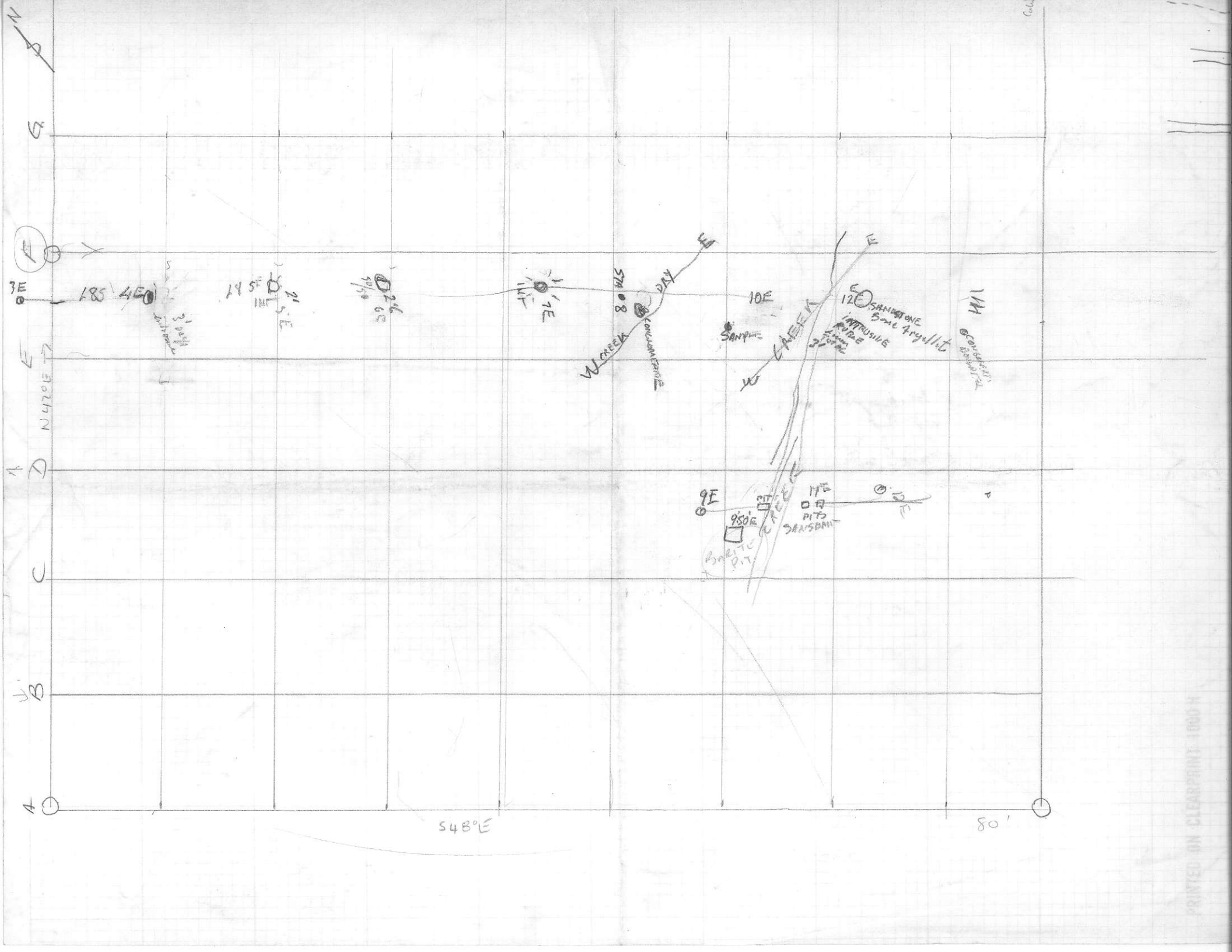



Rock Chips in WH

- 1 - Red bed. Tr 1100
- 2 - U. Rd. 1900 SE
- 3 - Sh - TR 1
- 4 - U. Rd. 2900 SE
- 5 - " " 2700 "
- 6 - " " " 960 SE
- 7 - " " " 2750 "
- 8 - " " " 3100 "
- 9 - Cut 2000 + 200 S
- 10 - " " + 220 S
- 11 - TR 5 (CH) 115 S
- 12 - Cut 2200 - E. PK Hy Zone Q<sub>3</sub> Veins
- 13 - U. Rd. 3215 SE

- TR 1
- 14 NE Wall 70' SE
- 15 " " 95' SE (S<sub>6</sub>)
- 16 " " 170' SE Rusty Fr.
- 17 Tr. Floor 35' SE (Sample 20 a)
- ~~18 R 64 Argillite~~
- 18 SW wall 65' SE 1 in Fr.
- 19 " " 80' SE Rusty Fr. 3:4' up from floor
- 20 R 64 - Argillite - Tr 3 area
- 21 long Tr. 50 - 75' from S.E. END.
- 22 " " Specimen over " 25' " "
- 23 - Tremble Int. Cldkt. - All Ints with O<sub>3</sub> 0.05g <sup>All</sup>







1-28  
1/1  
12/17  
SW



11

15 clay  
1 each <sup>AD 10</sup> maly  
Crown Fly

23372 P W <sub>3</sub>	23373 P W <sub>4</sub>
23370 P W <sub>1</sub>	23371 P W <sub>2</sub>

W - closure

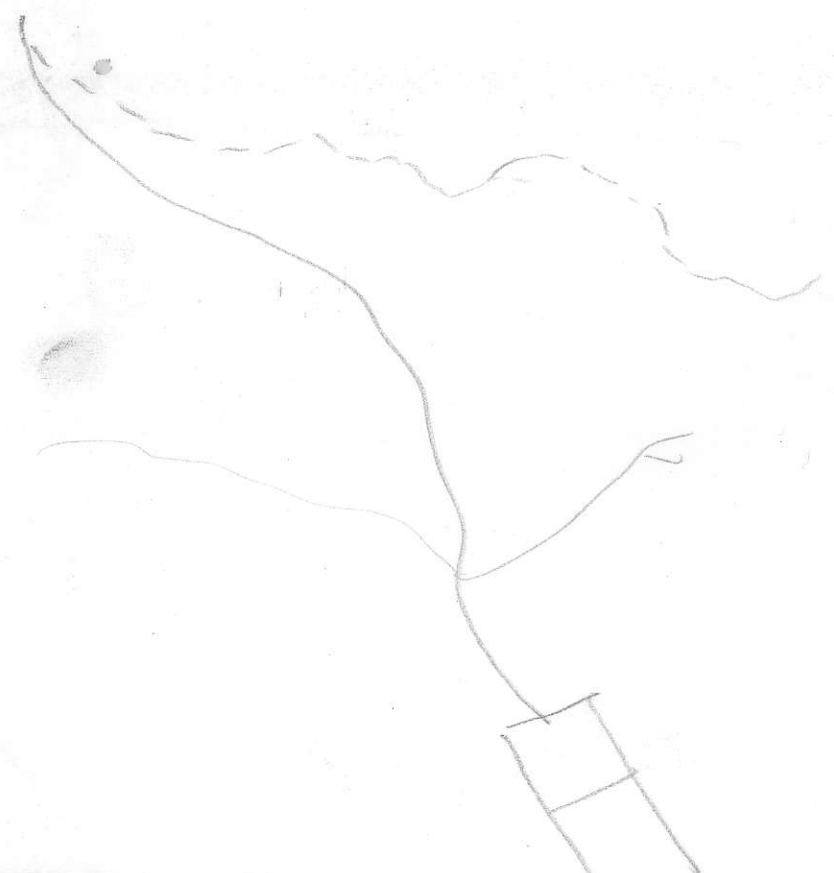
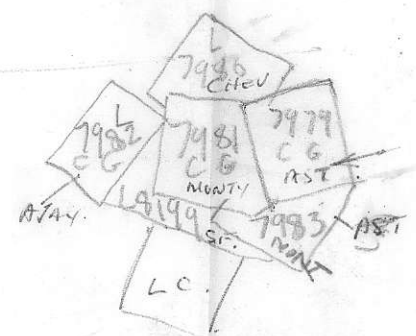



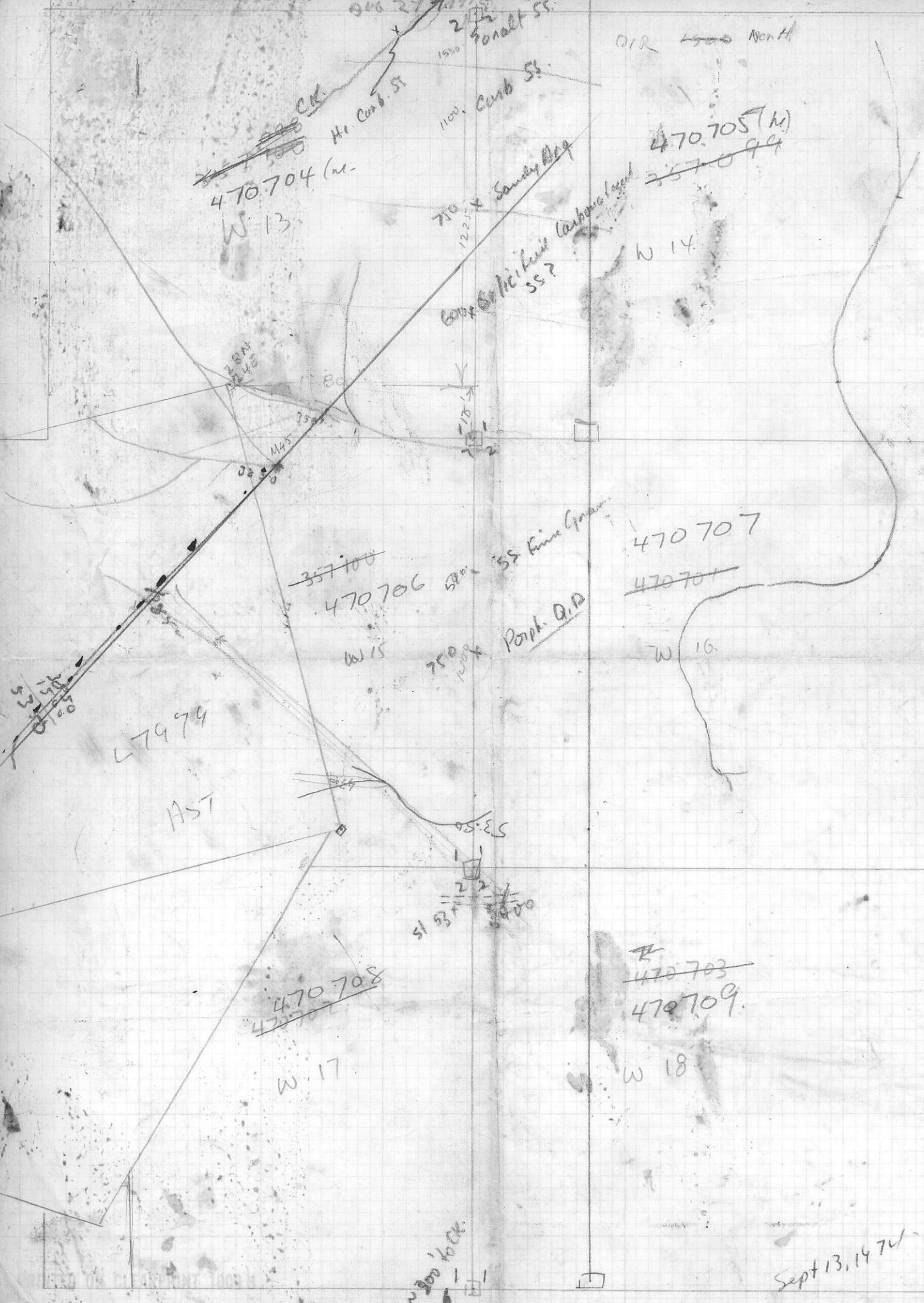

910 27 1175  
 2 1/2  
 1500  
 Hi. Comb St.  
 1100 Comb St.  
 470704 (u.)  
 W 13

DIR 1900 Non A.  
 470705 (M)  
 357099  
 710  
 1225  
 Sandy Blg  
 Carbonaceous  
 600  
 557  
 W 14

357100  
 470706  
 W 15  
 750  
 1400  
 SS fine grain  
 Park D.R.  
 470707  
 470701  
 W 16

L 7999  
 AST  
 05-85  
 1  
 2  
 3  
 4  
 5  
 6  
 7  
 8  
 9  
 10  
 11  
 12  
 13  
 14  
 15  
 16  
 17  
 18  
 19  
 20  
 21  
 22  
 23  
 24  
 25  
 26  
 27  
 28  
 29  
 30  
 31  
 32  
 33  
 34  
 35  
 36  
 37  
 38  
 39  
 40  
 41  
 42  
 43  
 44  
 45  
 46  
 47  
 48  
 49  
 50  
 51  
 52  
 53  
 54  
 55  
 56  
 57  
 58  
 59  
 60  
 61  
 62  
 63  
 64  
 65  
 66  
 67  
 68  
 69  
 70  
 71  
 72  
 73  
 74  
 75  
 76  
 77  
 78  
 79  
 80  
 81  
 82  
 83  
 84  
 85  
 86  
 87  
 88  
 89  
 90  
 91  
 92  
 93  
 94  
 95  
 96  
 97  
 98  
 99  
 100

470708  
 470709  
 W 17  
 W 18

200 to CK

Sep 13, 1974

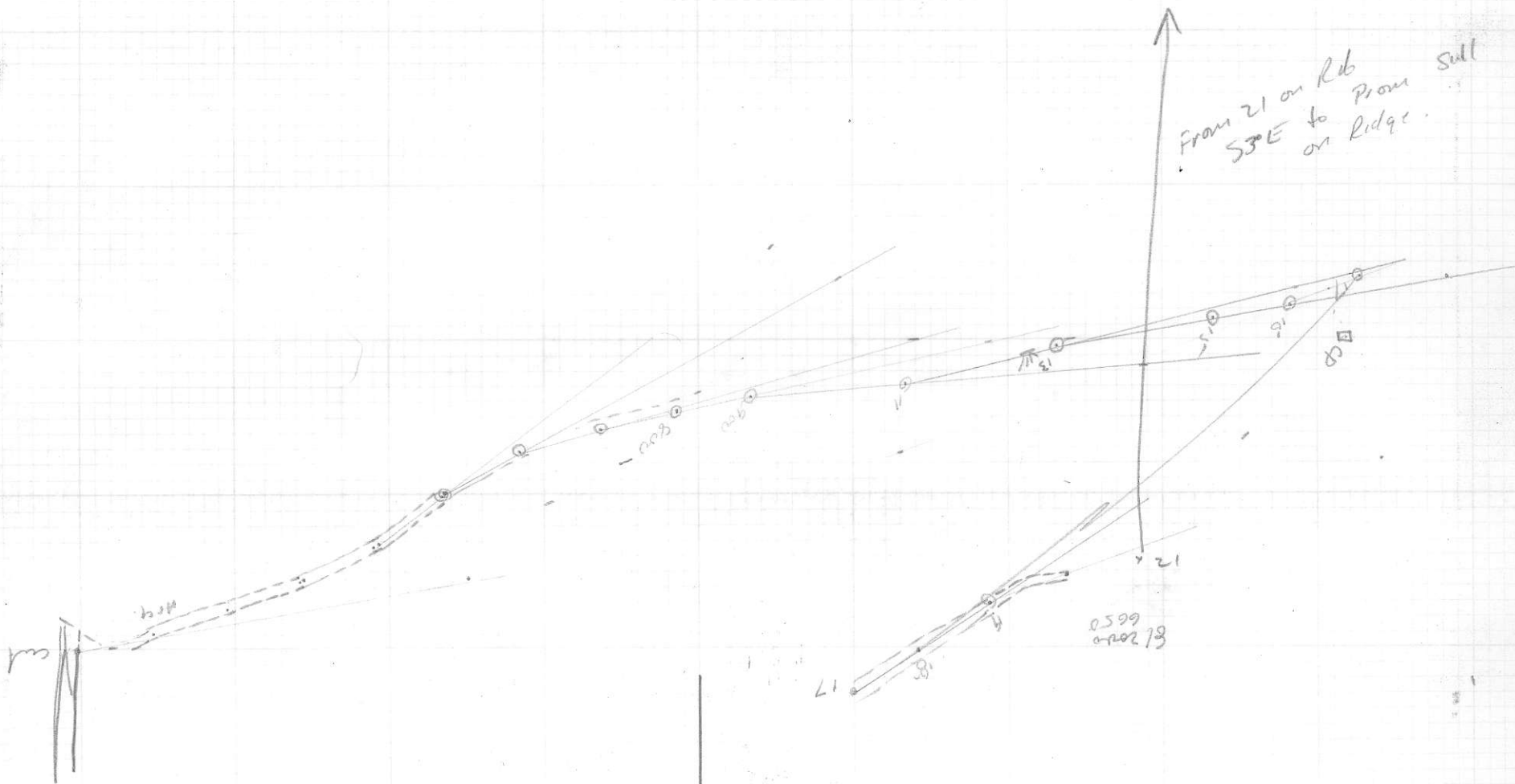



INVERARITY CUT  
Alt. Arg. Section

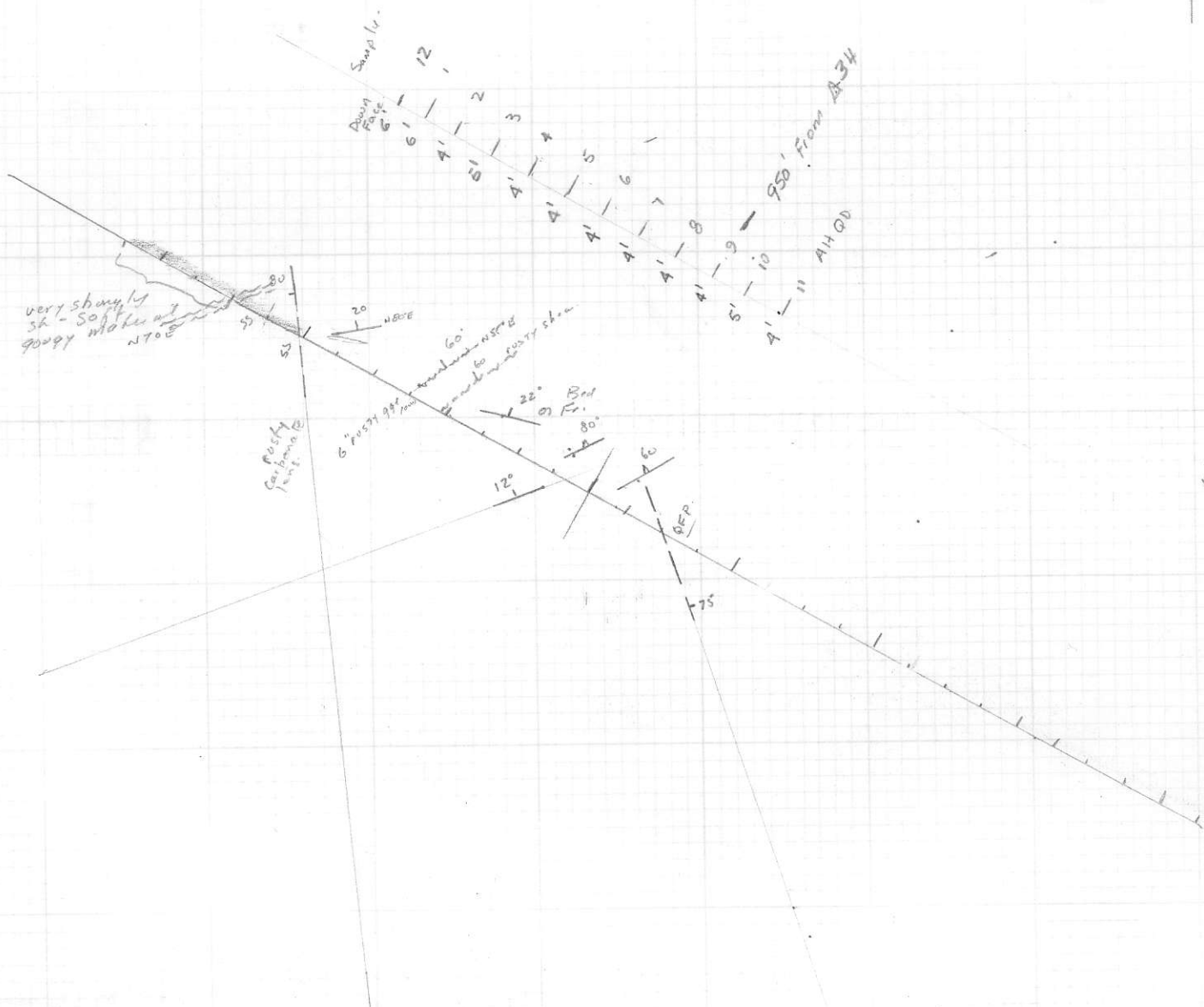

No 13 - 3' ↓  
375' from A34  
No 14 - 250' from  
A34 3' Ag

Stampok Arseni

B

70	<			90
180	<			280
140	>		Arseni	130
35	<			550 ✓
35 ✓	<		24 Sample	80 ✓
180 ✓	>			90 ✓
70 ✓	<		Hydraulic	350
180 ✓	<			210 ✓
180 ✓	>	45	Trench	160
50 ✓	<	40	Astonisher	140
45 ✓	<	15		100
15 ✓	<	20	20	100
25 ✓	<	5		180 ✓
70	<	30		180
140	<	500		360
90		8		400 ✓
55 ✓		25		250
55		100		200
90 ✓		50		400 ✓
70		200		110
70		55		400
110		100		1000 ✓
100 ✓		400		720
280 ✓		35		1150
<u>2335</u>		300		
		35		<u>7630</u>
		20		
		45		
		55		
		35		
		140		
		45		
		35		
		15	1973 ~ 37	
		20		
		300	~ 3 fold	± 12" below surface
		30		
		25	~ 8 fold	~ 6" above bedrock
		30		
		35		
		110		
		900		
		70		
		70		
		15		
		80		
		70		
		39		

317.91

Ans 97.29

- 21
- 19
- 17
- 33
- 12
- 38
- 16
- 30
- 40
- 140
- 27
- 31
- 50
- 59
- 37
- 42
- 37
- 29
- 24
- 25
- 43
- 60
- 53
- 8/89

24 nearest samples  
Planned samples

37.12





well bedded.  
at N15°W - 26°SW  
alternating beds  
of Congl and SS.  
3-10' thick

Congl - Essentially  
granite boulders  
range Oplike to Coarse Gr.  
Commonly med gr  
size to 2' Com ± 6"  
Comp Coarse gran - gden QD  
Some dark - Minor  
gneiss & schistose Rk.

Matrix gritty SS occ  
grad to Fragmented zone

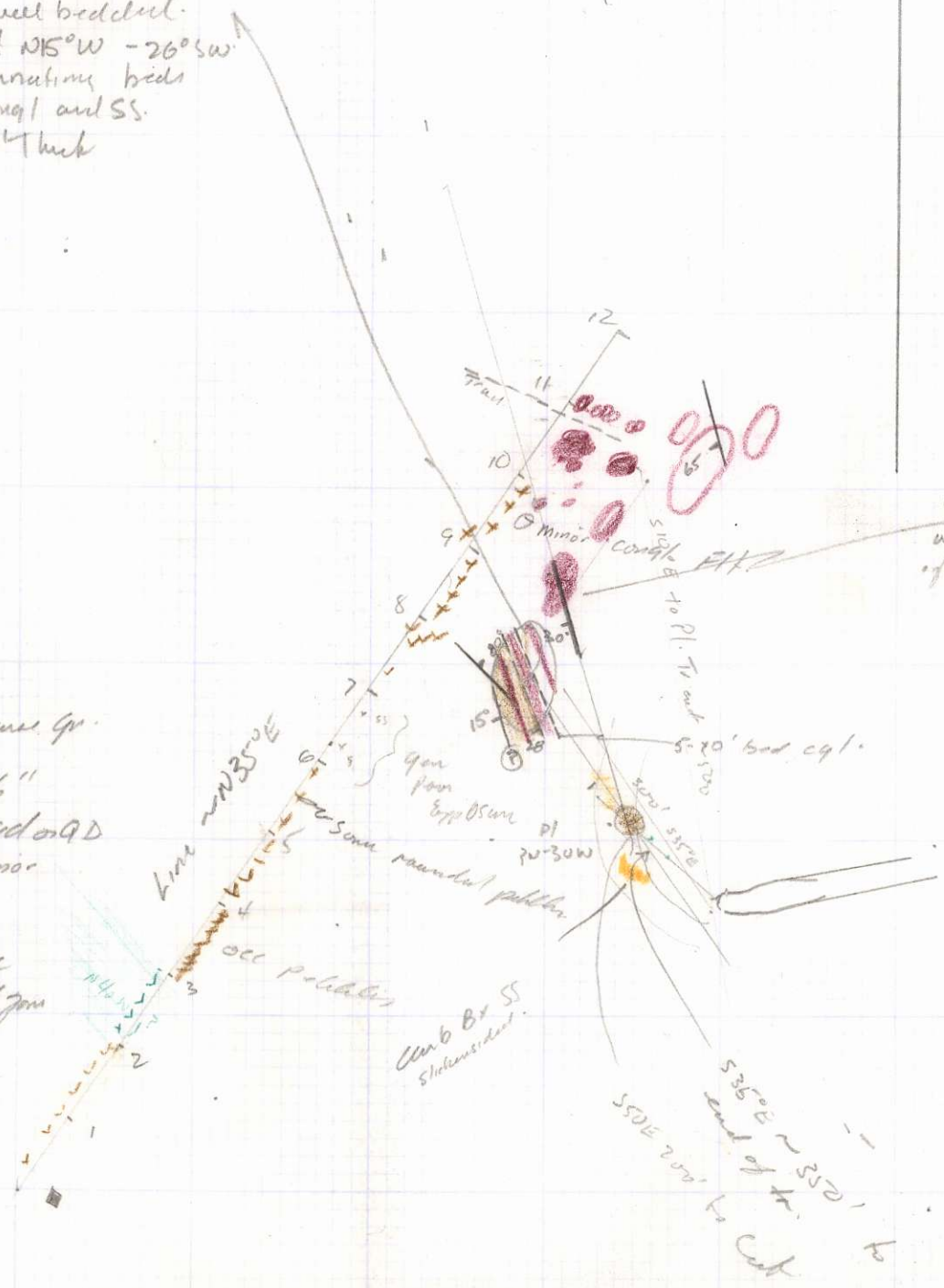

Note SS  
with layers  
of boulders

535°E ~ 550' to  
SSDE 200' to  
Comb







TR 4 - Lauer Road  
 Well Creek Sub  
 1" = 100'

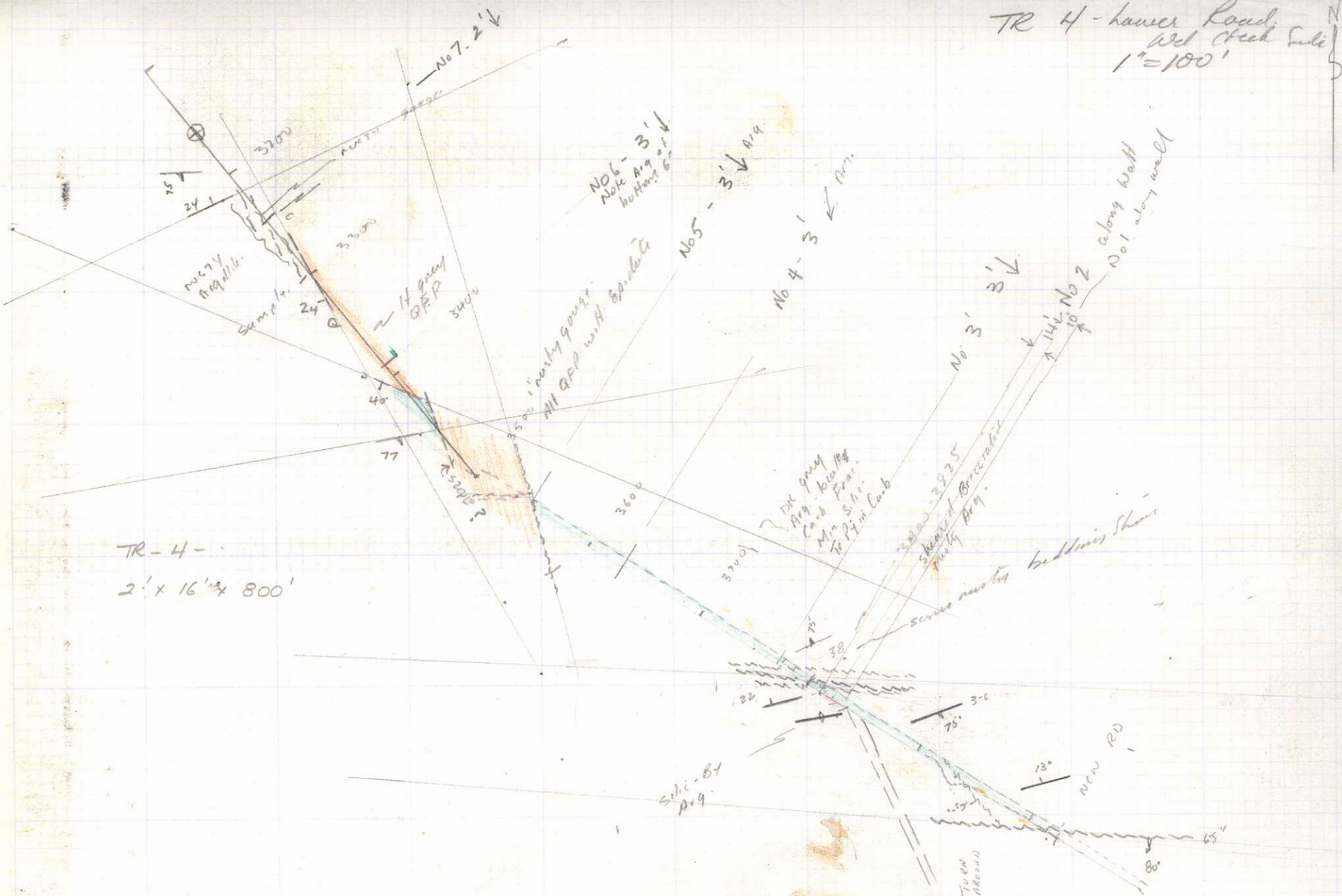

TR-4-  
 2' x 16' x 800'

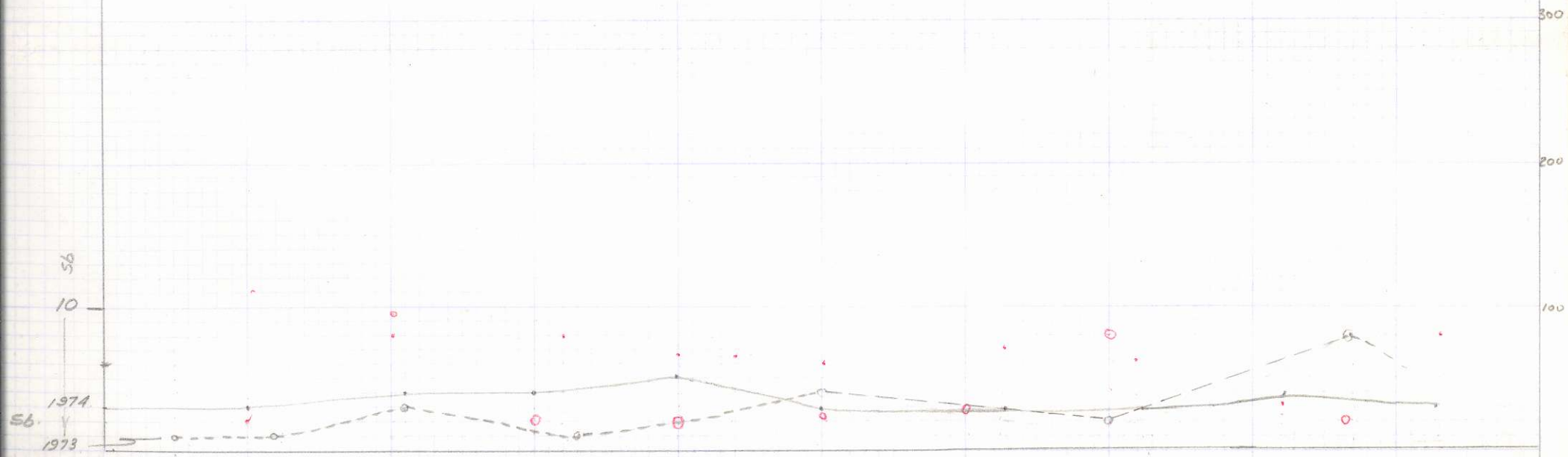

LINE 10 W.





24

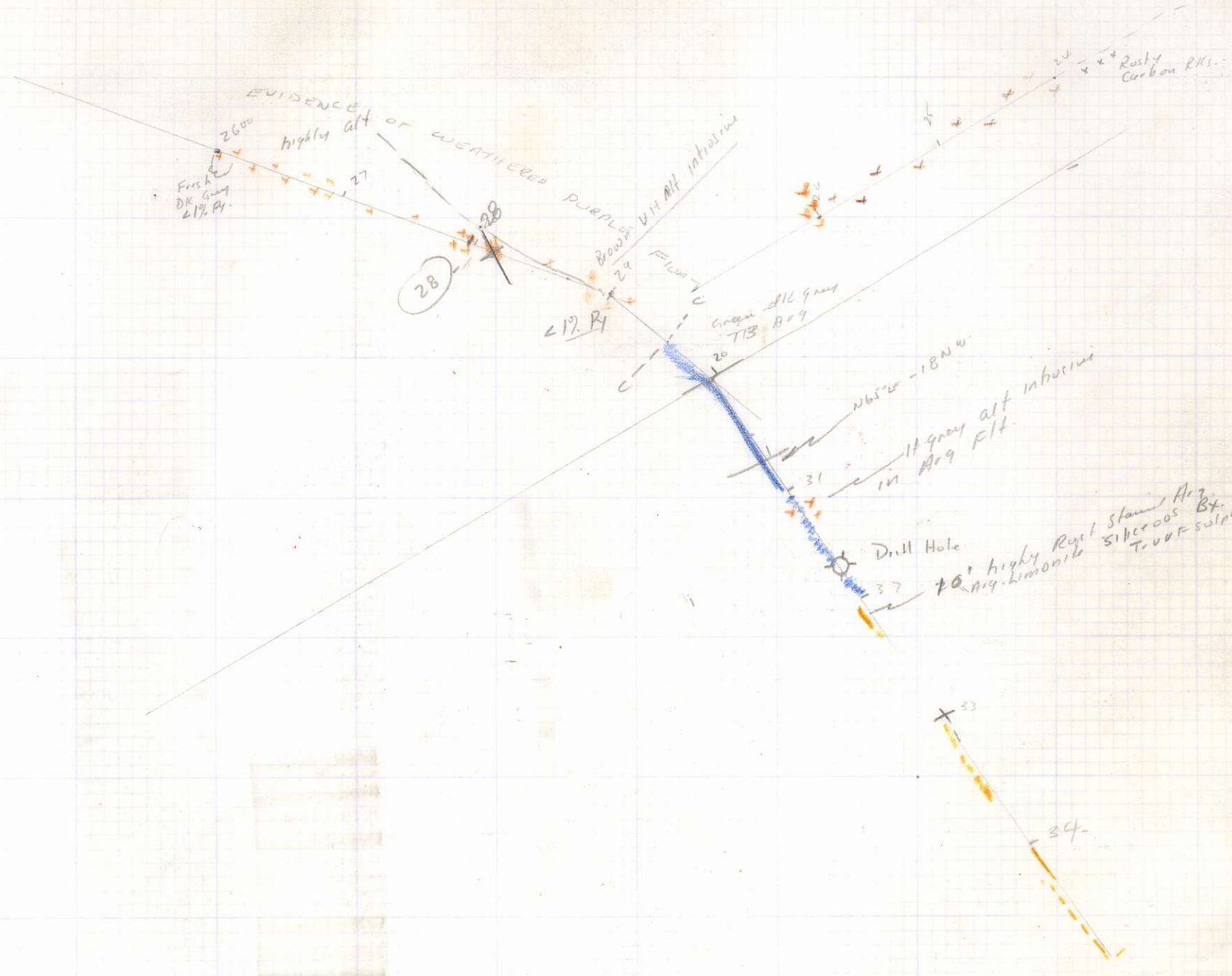



E/ 700 Top 6690

E1-6625

800

(R5) Fl.

Geol Survey Ridge west of Cut

(R4) Sulphide

dark silts?

2A 2000 W

S.P.I.

505 Bluffs  
Cone S

local Fray  
to 1 1/2

rusty zone

(R3)

Silic. Bulph  
in any part  
rusty zone

(R2)

2000  
Sulphide  
any part

Cut NB -  
Direction N5°E Not 14°E as on P. Lane Map



2% V.P.  
Sulphide  
Silicified  
any







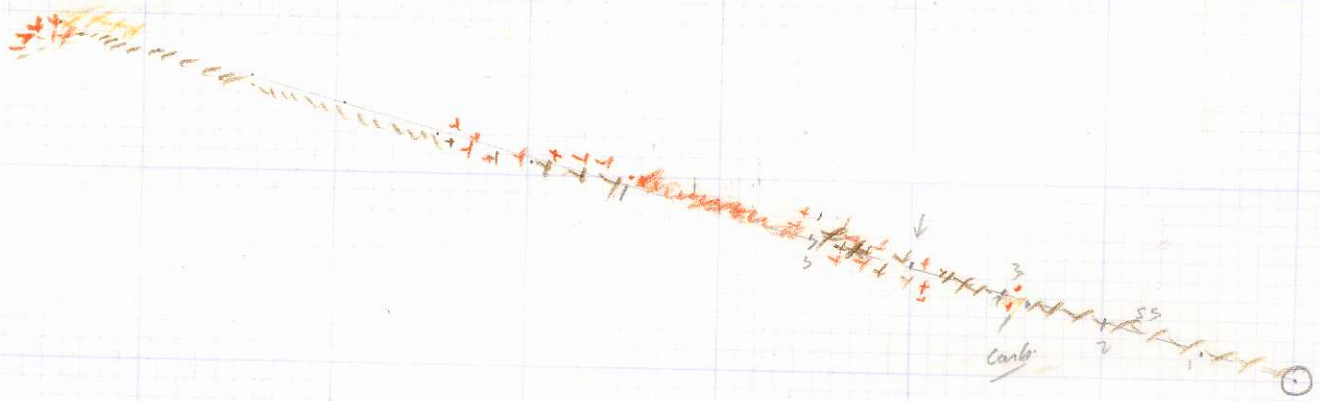

Road to Brent Shavers  
Lower Rd.

NW Map area



3800

Some 80 ft  
Manganese Argy

shadows 45 ft

Evidence of  
Pit Argy  
Rocky - locally siliceous  
gray Argy

R28

From broken Pit  
to 1" or 2"  
Note Chalcopyrite in higher  
Fr Argy

Ex Sil-Rocky Argy  
in Pit - Some minor  
Purple discolored

26E 22

3800 E

F14  
R29

Note yellow colour in  
the area reflect oxidized  
Sulphide?

E 6210

D1  
26W  
21E

Evidence of  
Purple Sil Argy

3700

diminished

3600

3500

26E

Tr 13  
R30

H gray PD  
34

33

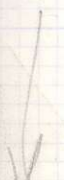





3/4" Blacky Rusty Fe  
 well streaked  
 Zone of  
 Sharp bleaching  
 Min Silica  
 Sample C

6-12" Soil humus  
 old Br. rusty Fe  
 12/9/22

Highly fractured  
 sand  
 fine  
 silty  
 W.A.  
 1/20/20

Finest carb Fe  
 to 12/ft

150-200 HIGHLY fractured  
 and  
 altered sands and  
 sil. (carbonate type)

ASH streaks at 325

6" Humus  
 12" Ash - 15"  
 3-12" dk Br. Soil with ~10% Fe  
 24" grey gravel sized material

Ash Polers and  
 ~500 + 12" humus  
 overlain by zone to  
 5' with either dk brown  
 soil with ~20% Fe  
 or grey granular  
 broken rock with  
 very little Fe

4' sample: 4' highly siliceous  
 zone (Fe 11% - Fe  
 V.F. S. Sulph.

Strong Rusty Zone  
 Sample

strongly bleached zone  
 rusty 1/2 of Fe

Partly Bedded  
 800 Carb. SS.

800 carb. silty  
 rusty bedding planes  
 narrow fault. 1/2  
 7.3 Fe  
 prevalent

Re Staff 950-1150  
 Possibility of thin highly Fe  
 sill on side.

Zone highly siliceous  
 and very altered (Fe)  
 Both to form iron ore  
 highly carb. SS  
 Bedding Plan  
 Faults?  
 More SS rim  
 high  
 Carb. Fe.



9-10  
Hard green  
Coalt ss.

1000

9m unalt  
ss  
local Carb. Green

Wetland  
No Carb

Rusty Carb  
1255

13

2' irregular  
zone highly  
bleached & alt  
Int. in rusty carb  
zone

R11

1600

Monument

Building?  
Junk

1500

El. Carb

20' Carb  
Unit

Co. d  
ss

1900

Ridge Survey EAST



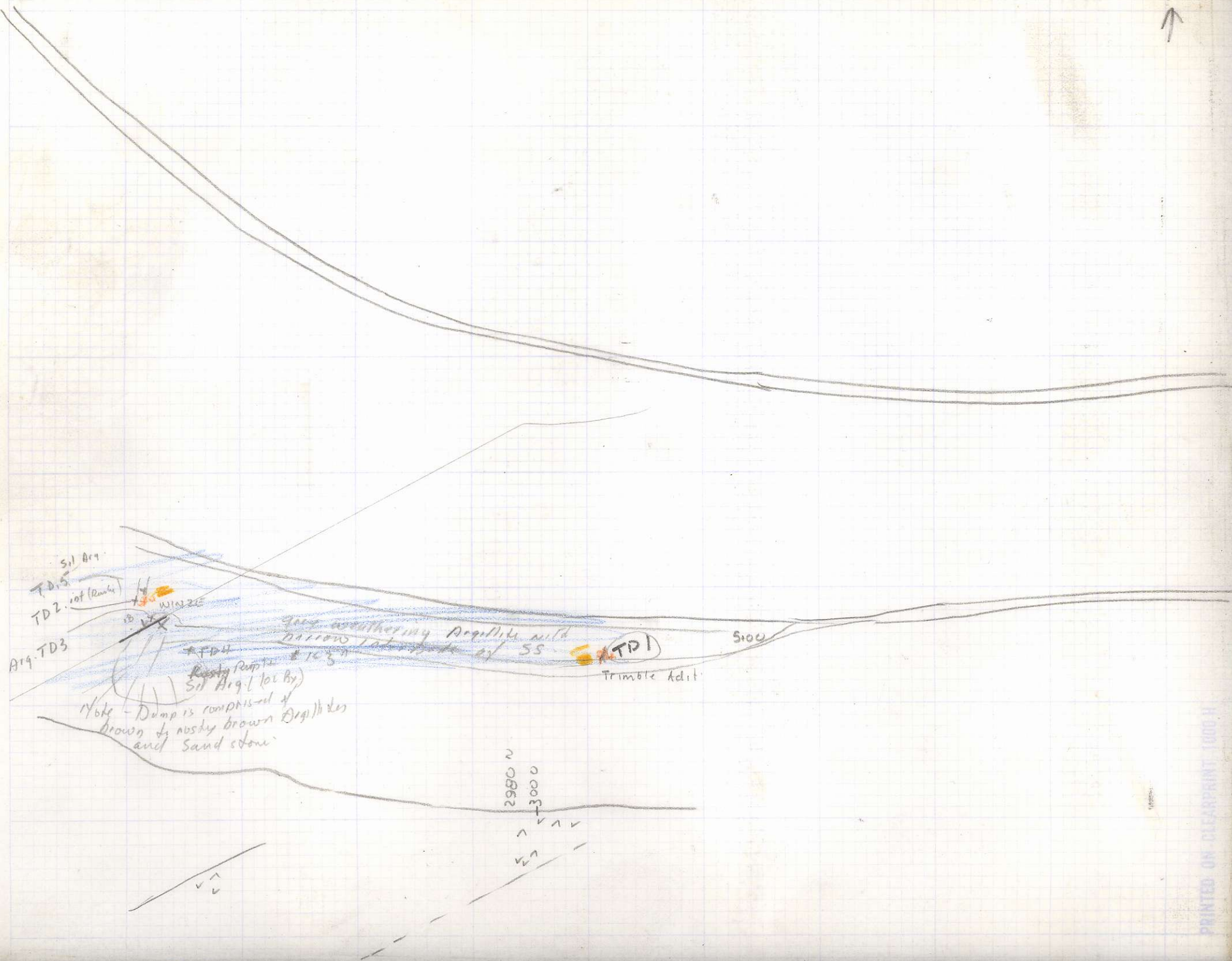

Silt Arg.  
TD1  
TD2 (rot (Rank))

A19-TD3

TD4  
Rusty Pyrite  
Silt Arg. (loc. by)

Note - Dump is comprised of  
brown & rusty brown Argillites  
and Sand stone.

fine weathering Argillite with  
narrow tabular ss

(TD1)

Trimble Adit

5100

2980 ±

3000



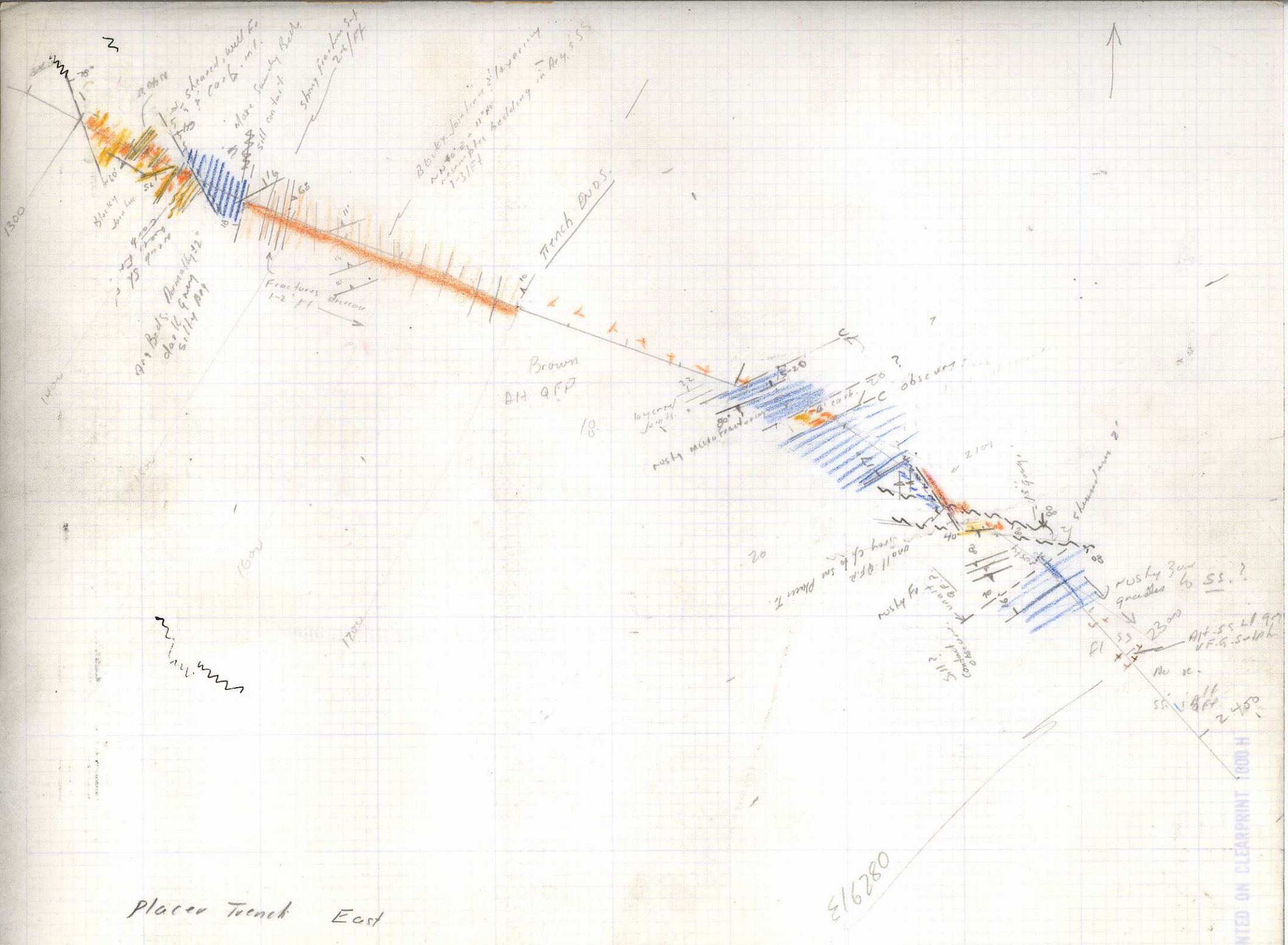

Placer Trench East

0829/3







T122800  
Sof Creek.



Note Po on Fe

900 m Fe

200

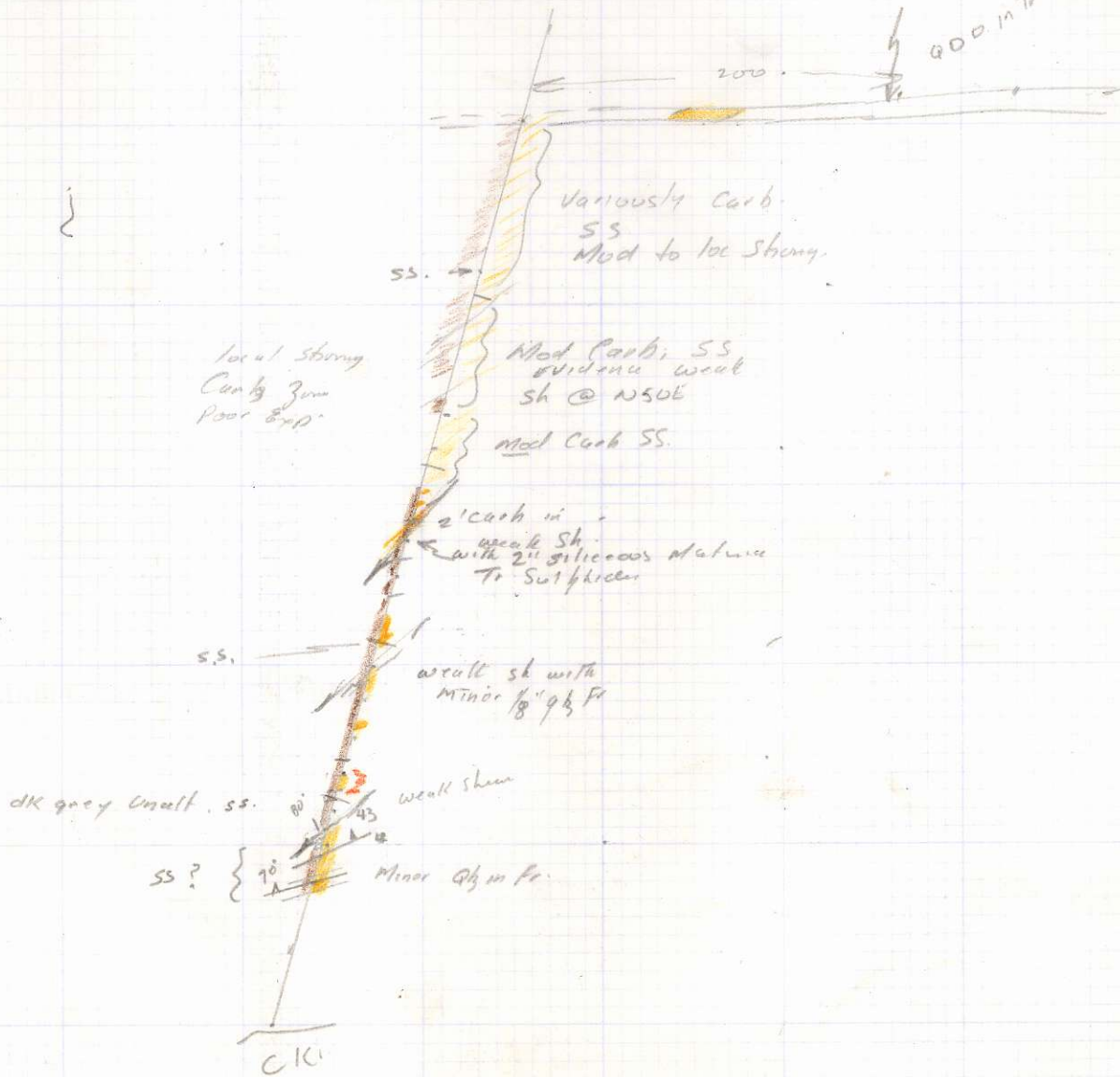







PRINTED ON RECYCLED PAPER

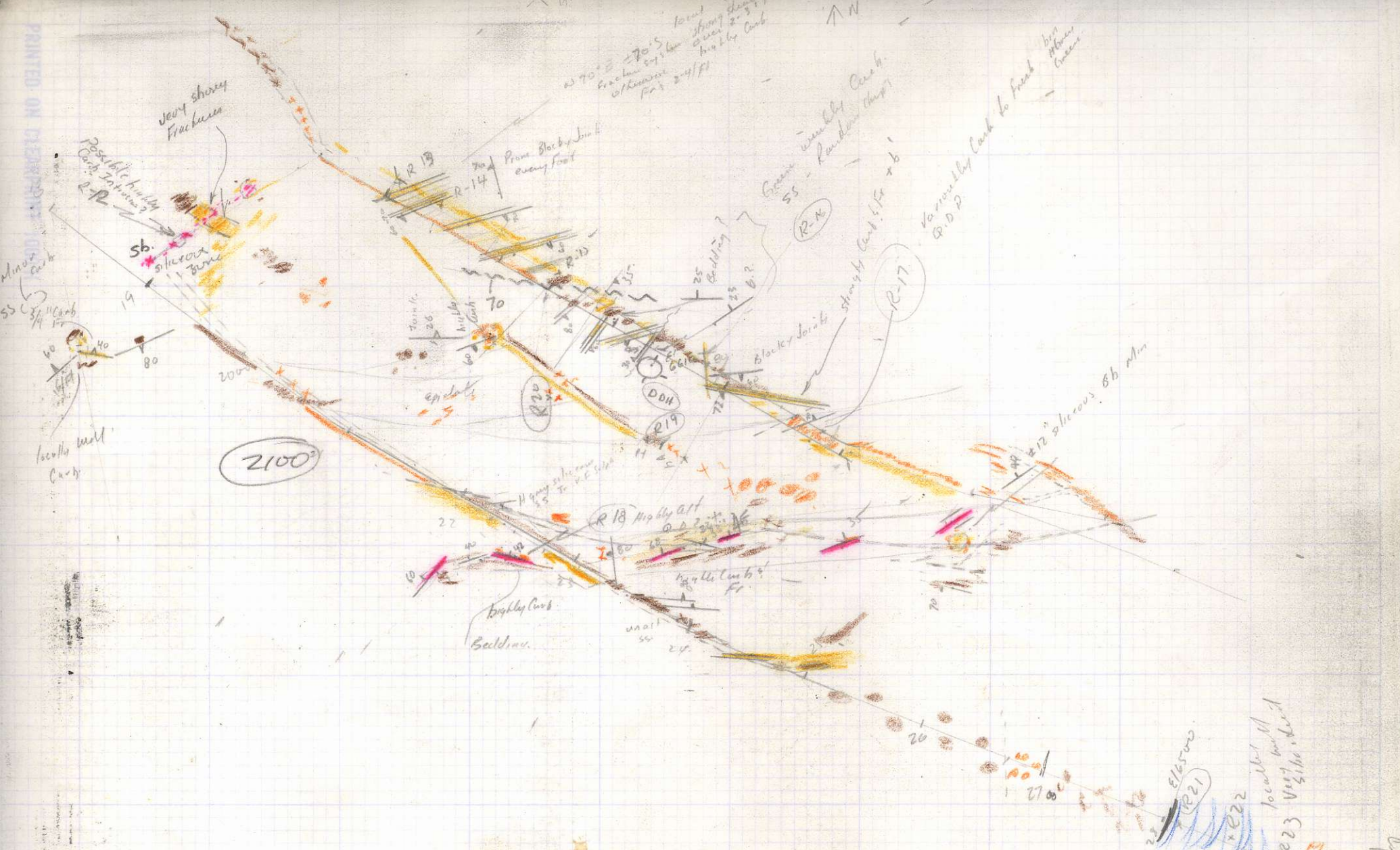

Ridge Survey East.  
 Note: A 2100E to N5°E  
 for 925' to A 2050  
 on Placer Truck Rd. Ext.

R-22 locally well carb.  
 R-23 very well carb.  
 R-24 locally well carb.  
 R-25 locally well carb.  
 R-26 locally well carb.  
 R-27 locally well carb.  
 R-28 locally well carb.  
 R-29 locally well carb.  
 R-30 locally well carb.  
 R-14  
 R-15  
 R-16  
 R-17  
 R-18  
 R-19  
 R-20  
 R-21  
 R-22  
 R-23  
 R-24  
 R-25  
 R-26  
 R-27  
 R-28  
 R-29  
 R-30  
 D04  
 D05  
 D06  
 D07  
 D08  
 D09  
 D10  
 D11  
 D12  
 D13  
 D14  
 D15  
 D16  
 D17  
 D18  
 D19  
 D20  
 D21  
 D22  
 D23  
 D24  
 D25  
 D26  
 D27  
 D28  
 D29  
 D30  
 D31  
 D32  
 D33  
 D34  
 D35  
 D36  
 D37  
 D38  
 D39  
 D40  
 D41  
 D42  
 D43  
 D44  
 D45  
 D46  
 D47  
 D48  
 D49  
 D50  
 D51  
 D52  
 D53  
 D54  
 D55  
 D56  
 D57  
 D58  
 D59  
 D60  
 D61  
 D62  
 D63  
 D64  
 D65  
 D66  
 D67  
 D68  
 D69  
 D70  
 D71  
 D72  
 D73  
 D74  
 D75  
 D76  
 D77  
 D78  
 D79  
 D80  
 D81  
 D82  
 D83  
 D84  
 D85  
 D86  
 D87  
 D88  
 D89  
 D90  
 D91  
 D92  
 D93  
 D94  
 D95  
 D96  
 D97  
 D98  
 D99  
 D100  
 49 & 12 siliceous ss Min.  
 2100  
 2050  
 1800  
 1600  
 1400  
 1200  
 1000  
 800  
 600  
 400  
 200  
 0











Aug 13/74

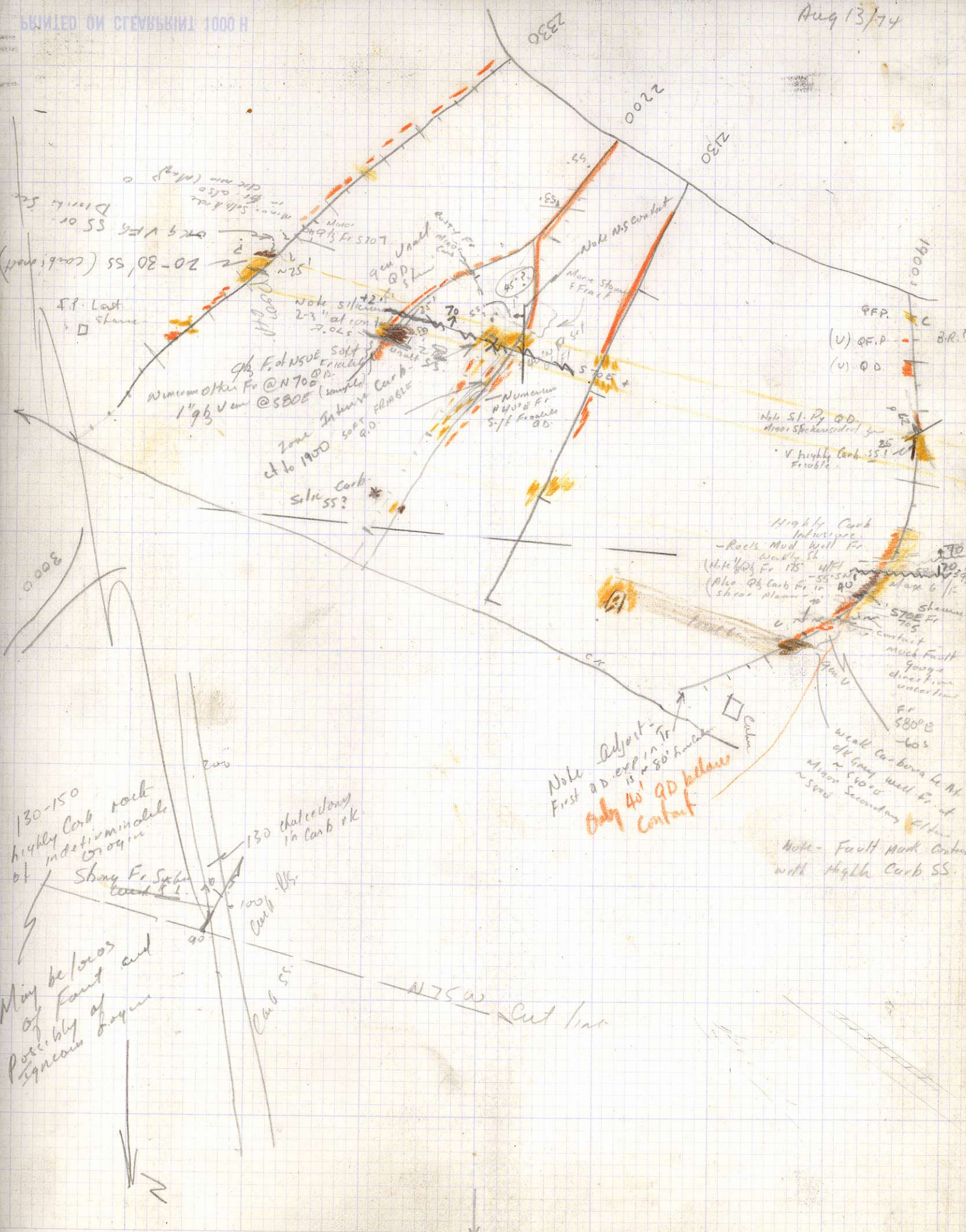

G.F.P. C  
 (U) Q.F.P. BR?  
 (U) Q.D.

130-150 highly Carb rock indeterminate origin at Shing Fr. S. side

May be locus of Fault and possibly of igneous dykes

130 that contains in Carb. pk

100 Carb. pk

Carb. ss.

N75W Cut line

Note Defect: First ad. exp. in Fr. is 80' below only 40' QD below contact

Note - Fault Mark Contact with Highly Carb. SS.

20-30' SS (carb. part)  
 20-30' V.F.G. SS or  
 D. or  
 Min. Sil. Carb.  
 Fr. 199.5 Fr. 210  
 Note siliceous  
 2-3" at con.  
 7.025  
 Zone Intense Carb.  
 et to 1900 soft  
 Q.D.  
 Silic Carb. SS?  
 Numerous N.W. Fr. S.F. Fracture Q.D.

Note N.S. contact  
 More Shale & Fract.  
 45°?  
 70  
 55  
 50

Note S.I. Py. Q.D.  
 Minor Shale contact  
 V. highly Carb. SS  
 Fracture

Highly Carb Intensive  
 - Rocks Mud well Fr. weakly sh.  
 (Note 175' Fr. 175' - 55-50' - 40' at max 6' 1/2)  
 (Also Q.D. Carb. Fr. in 40' shear plane)  
 Shale Fr. 175'  
 contact  
 much fault gouge direction uncertain  
 Fr. 580' B  
 160'  
 weak Carb. below L.M. off Gray well Fr. at minor Secondary E.H.

3000

2330

2200

2130

2000

3000

200

90

2

2



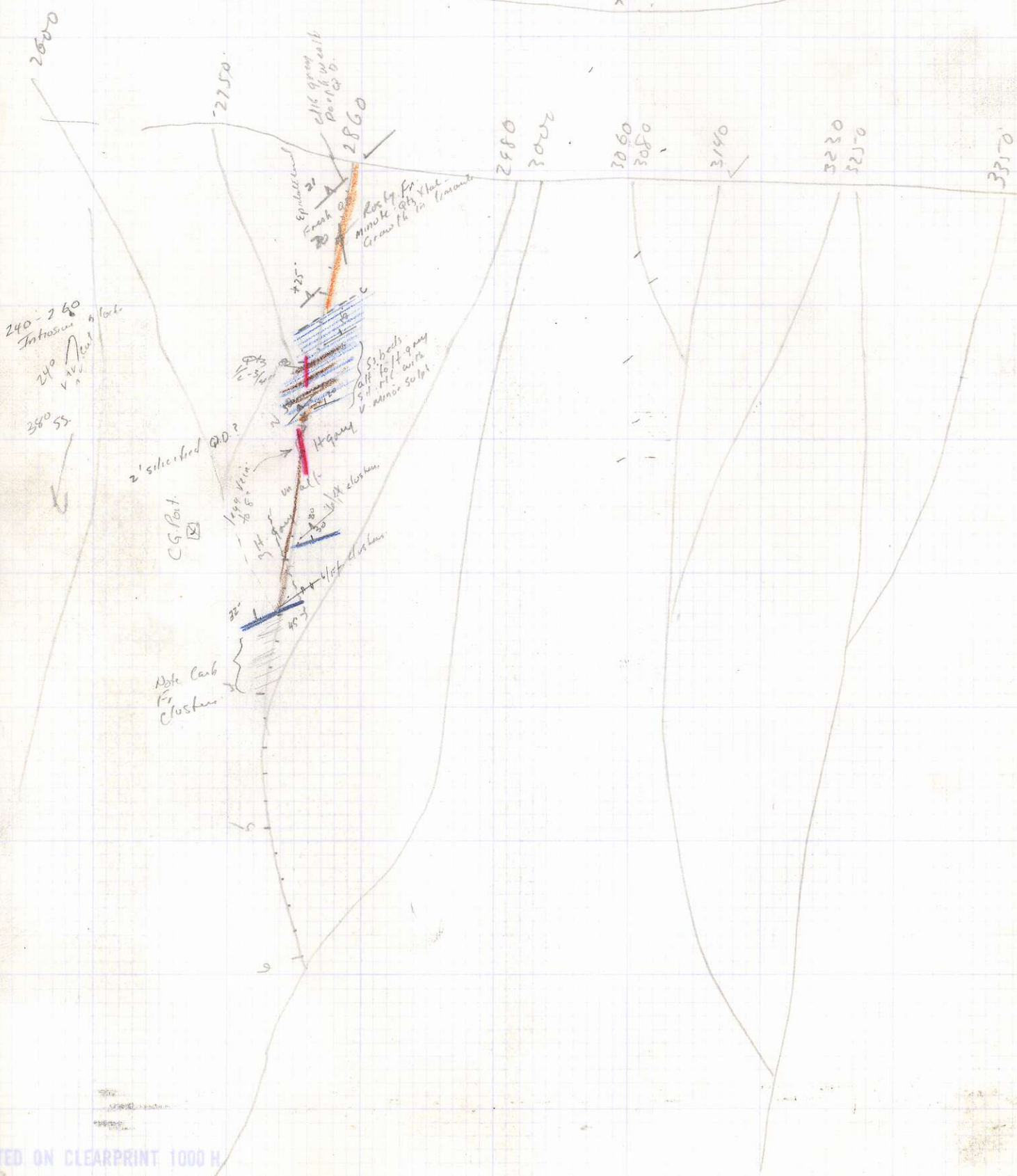



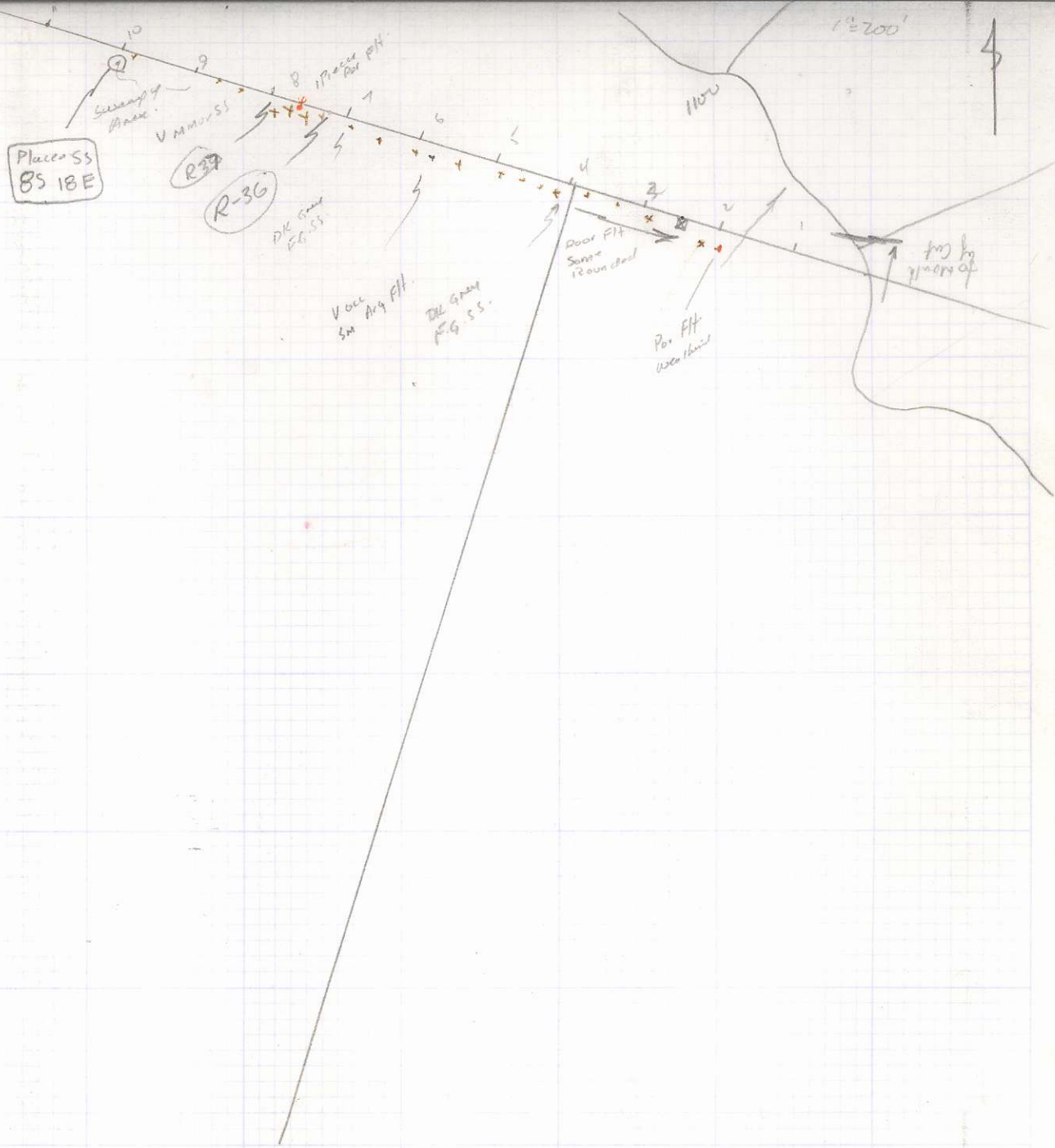







North

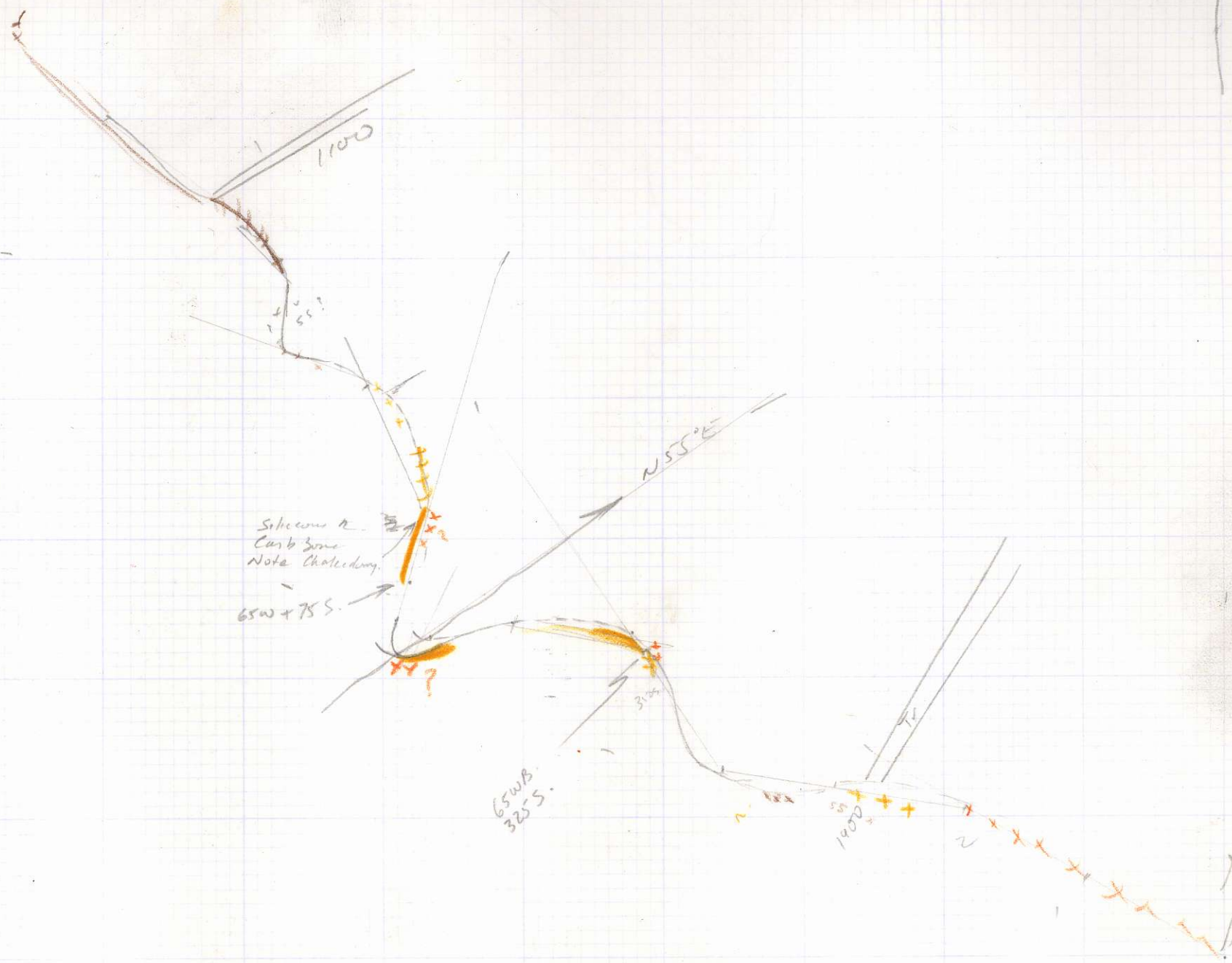



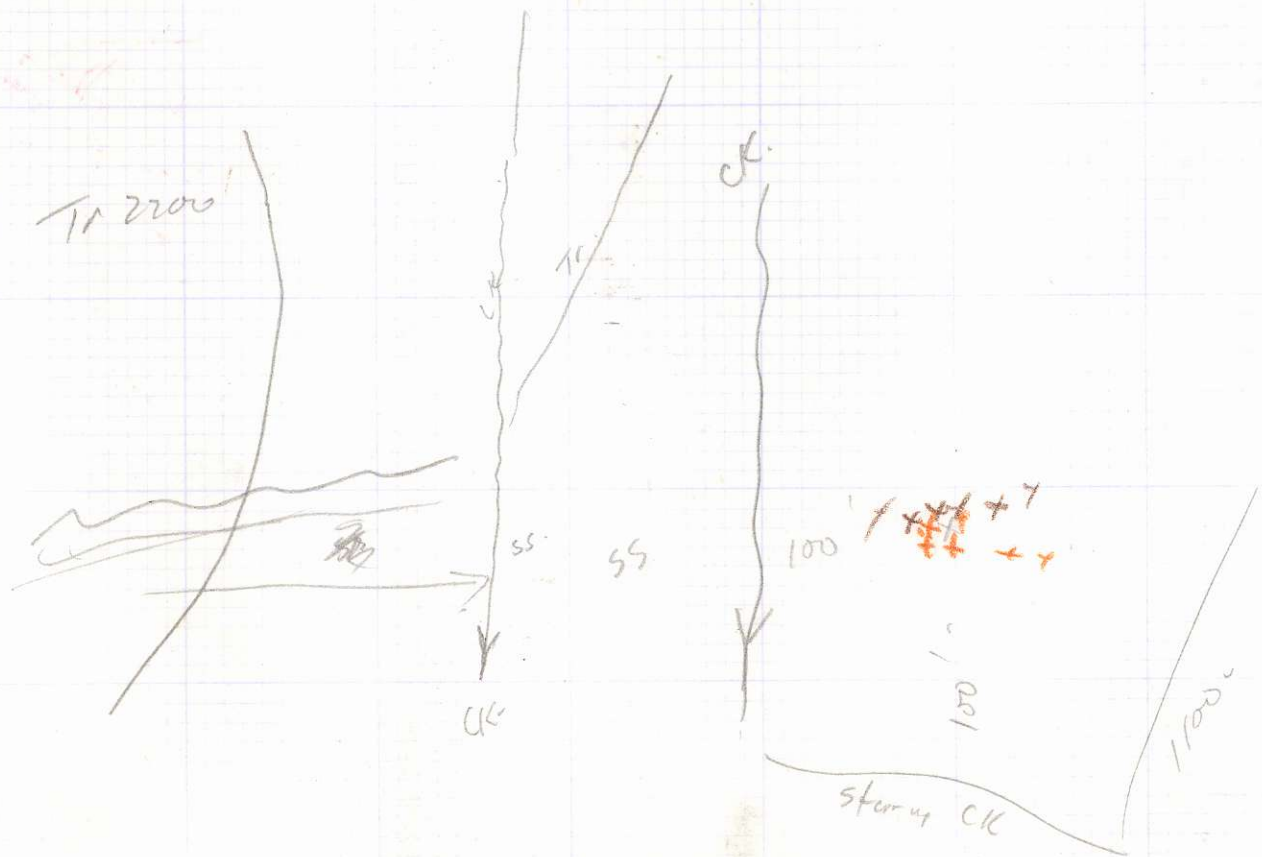

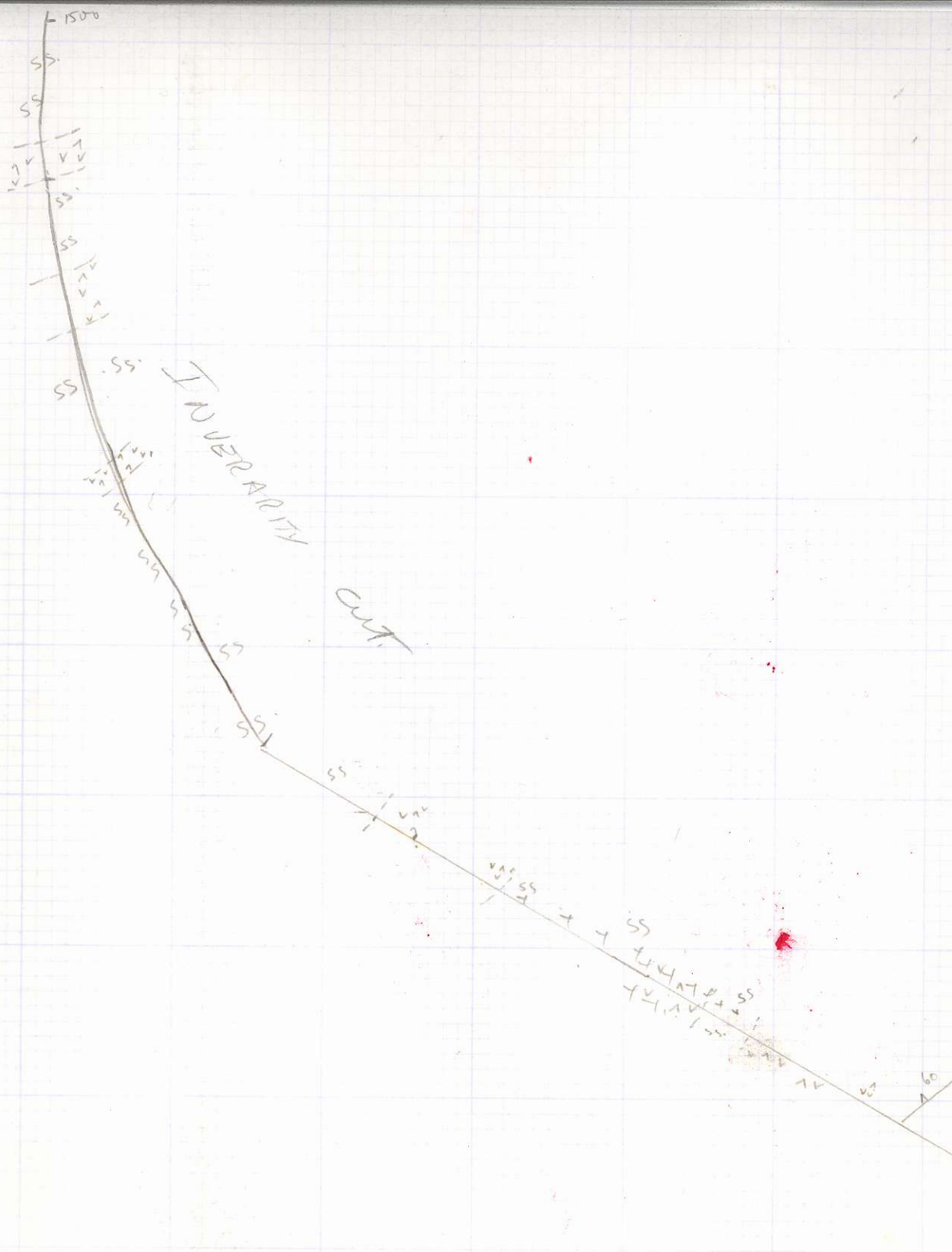

TUNERARITY  
CUT



90 88  
200

20

TR. 3

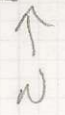
1" = 100' 

Overborden  
2' x 16' x 350





TRENCHES & CUTS N of Street CP

PRINTED ON RECYCLED PAPER

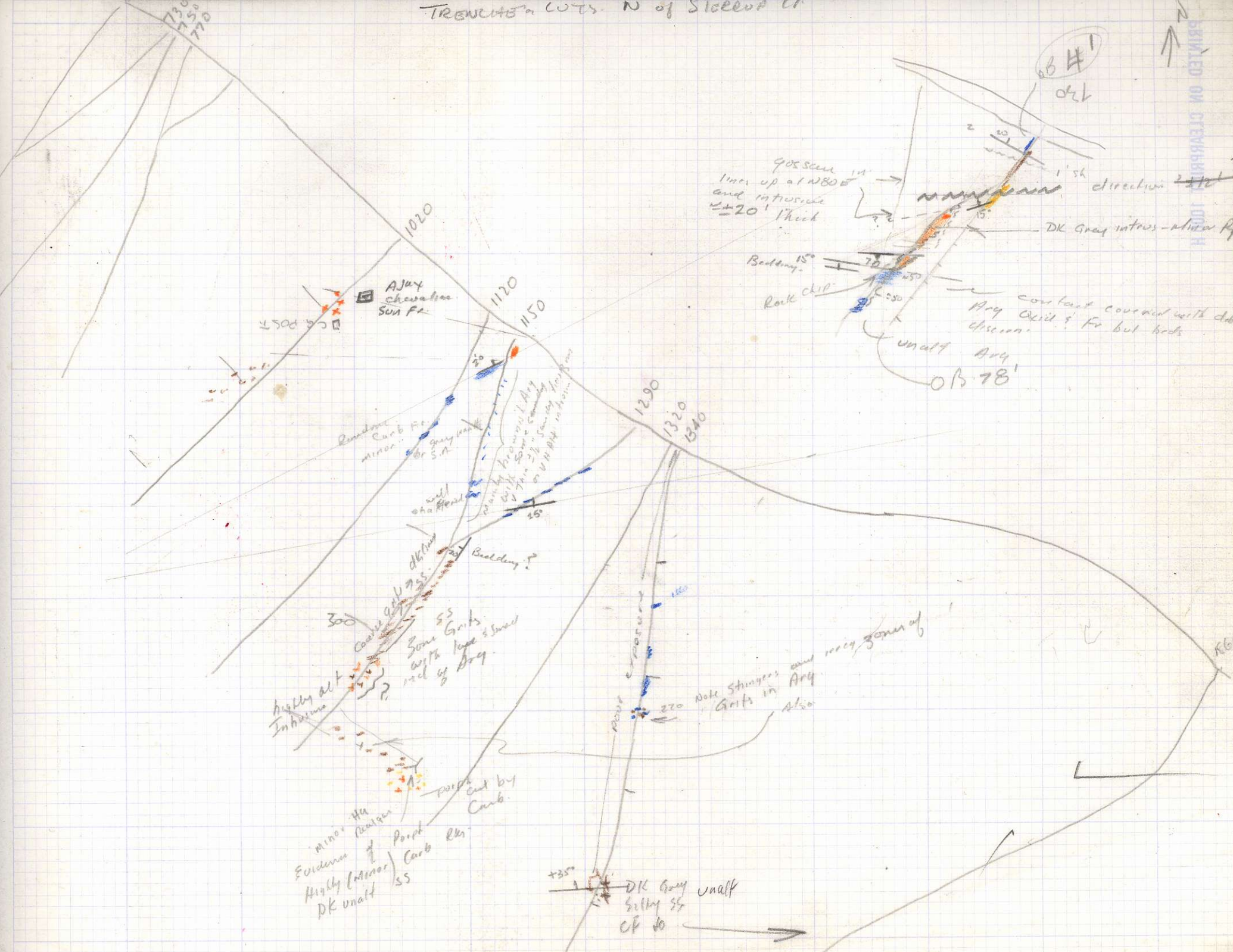

730  
750  
770

1020

1120

1150

1290

1320  
1340

Note exposure

1600

270

Note stringers and mica zones of Grits in Arg also

+35'

DK Gray unalt  
silty ss  
CP 40

OB #1  
delt

GOR ss 1/4  
inch up at N80°  
and intrusive  
±20' thick

direction 240°

DK Gray intrus-alter Arg

Bedding 15°

Rock chip

constant covered with debris  
Arg Oxid. Fe but beds  
unalt Arg

OB 78'

AJAX  
Chevalier  
SUN FA

±506 507

Bedding  
Curb FA  
minor  
or S.A.

well  
shattered

Bedding?

300

highly alt  
Intrusives

Coarse gully  
SS  
Some Grits  
with large  
nodules of Arg

Minor FA  
Evidence of  
Highly (minor)  
DK unalt  
SS

porph  
cut by  
Curb.

Porph  
Curb Rks

1800



PRINTED ON RECYCLED PAPER

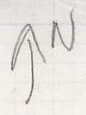

gritty SS or  
one 2-3' bed  
Congl with  
Arg Frag ± 1" occ  
large slabs to  
12"

SS  
nearly  
or thin  
interbed of  
Congl  
pebbles

N55°E  
Macedonia m.m.  
R57

S57°W  
200' to  
Rd.

10% fragments  
2-5mm

very strongly  
Argillite - Renss.  
of fault

locally Sil. congl.

Strongly  
Curb at 3m

W9-12

gritty SS  
or 15% Arg  
Frag.

gritty  
1/4" Frag congl.

N51W

Plat →  
No occ  
gravel  
Rise

Very  
slight  
Rise

N50E

Minor  
D.D.P.  
SS  
40%  
Plt

6660

6589

R57

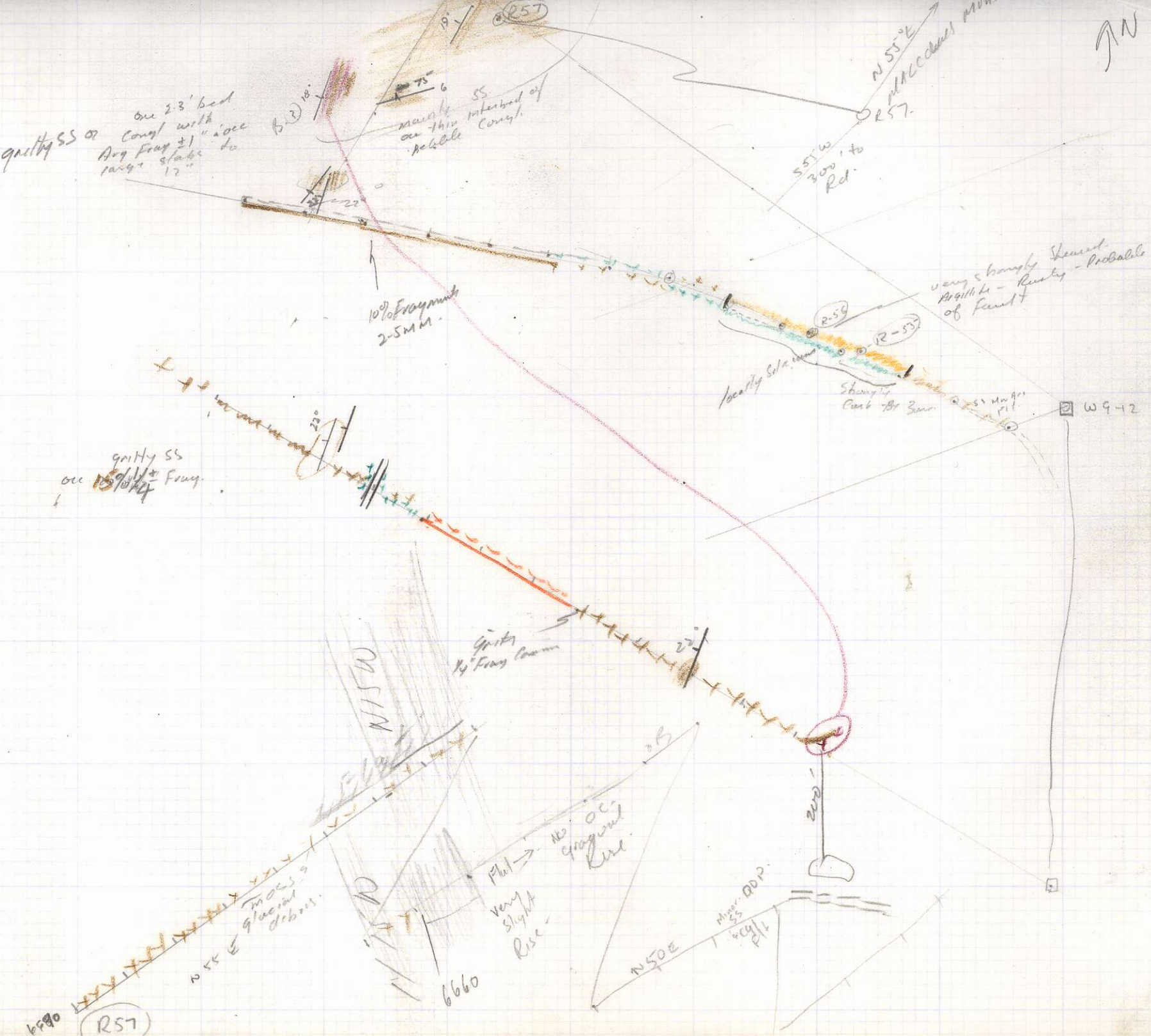



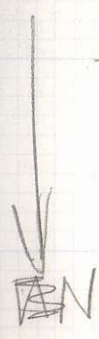
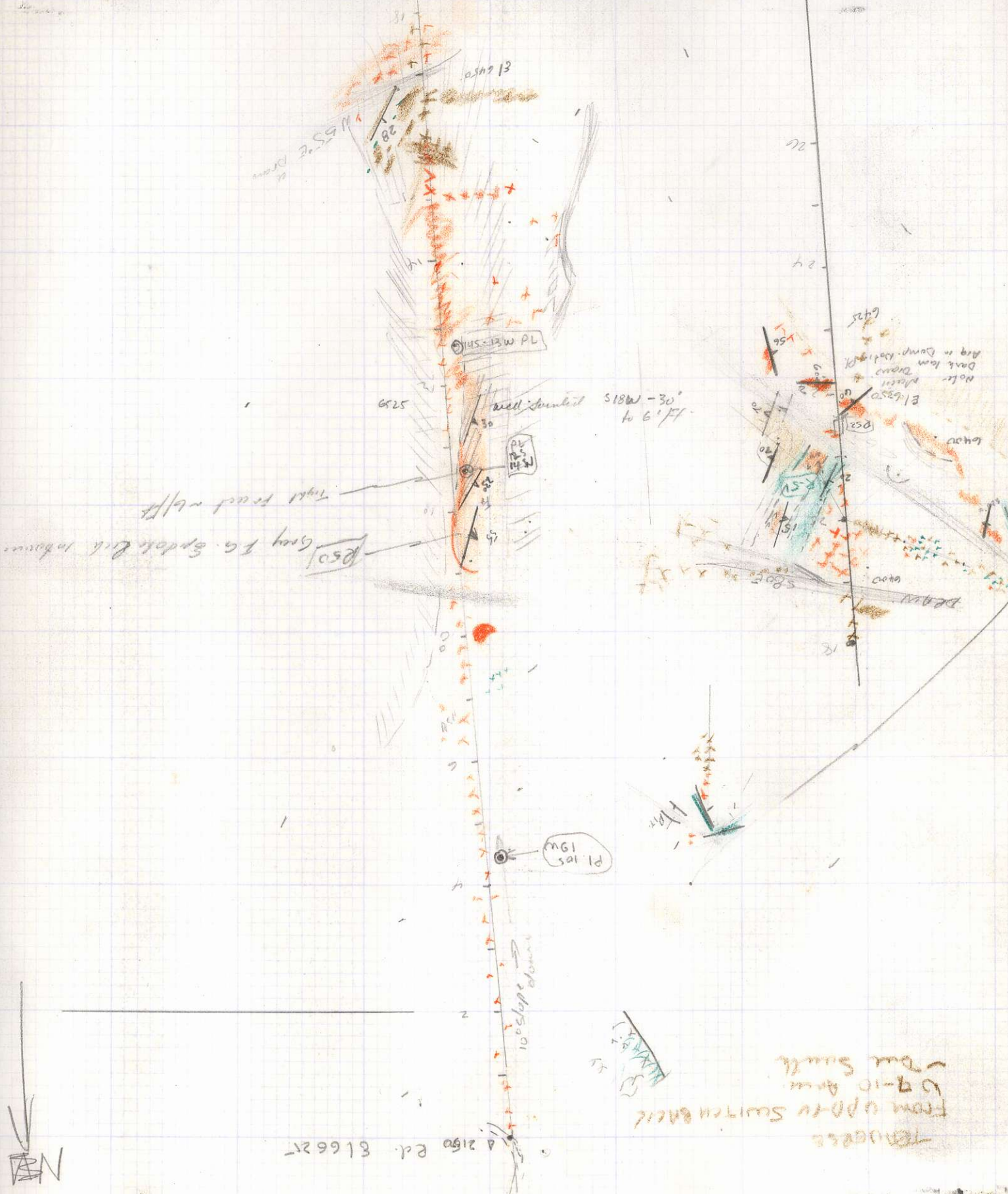

2150 Ed. 816627

P.L. 150

10° slope down

1.9 m

From upper switch bank  
to 9-10 Area  
our south

Gray f.c. Sp. dark. C. in horizon

Tight fold n/ff

S18W-30°

P.L. 150

Note: Dark brown  
Dip in Dump. Reddish

E16320

P521

P520

P519

P518

P517

P516

P515

P514

P513

P512

P511

P510

P509

P508

P507

P506

P505

P504

P503

P502

P501

P500

P499

P498

P497

P496

P495

P494

P493

P492

P491

P490

P489

P488

P487

P486

P485

P484

P483

P482

P481

P480

P479

P478

P477

P476

P475

P474

P473

P472

P471

P470

P469

P468

P467

P466

P465

P464

P463

P462

P461

P460

P459

P458

P457

P456

P455

P454

P453

P452

P451

P450

P449

P448

P447

P446

P445

P444

P443

P442

P441

P440

P439

P438

P437

P436

P435

P434

P433

P432

P431

P430

P429

P428

P427

P426

P425

P424

P423

P422

P421

P420

P419

P418

P417

P416

P415

P414

P413

P412

P411

P410

P409

P408

P407

P406

P405

P404

P403

P402

P401

P400

P399

P398

P397

P396

P395

P394

P393

P392

P391

P390

P389

P388

P387

P386

P385

P384

P383

P382

P381

P380

P379

P378

P377

P376

P375

P374

P373

P372

P371

P370

P369

P368

P367

P366

P365

P364

P363

P362

P361

P360

P359

P358

P357

P356

P355

P354

P353

P352

P351

P350

P349

P348

P347

P346

P345

P344

P343

P342

P341

P340

P339

P338

P337

P336

P335

P334

P333

P332

P331

P330

P329

P328

P327

P326

P325

P324

P323

P322

P321

P320

P319

P318

P317

P316

P315

P314

P313

P312

P311

P310

P309

P308

P307

P306

P305

P304

P303

P302

P301

P300

P299

P298

P297

P296

P295

P294

P293

P292

P291

P290

P289

P288

P287

P286

P285

P284

P283

P282

P281

P280

P279

P278

P277

P276

P275

P274

P273

P272

P271

P270

P269

P268

P267

P266

P265

P264

P263

P262

P261

P260

P259

P258

P257

P256

P255

P254

P253

P252

P251

P250

P249

P248

P247

P246

P245

P244

P243

P242

P241

P240

P239

P238

P237

P236

P235

P234

P233

P232

P231

P230

P229

P228

P227

P226

P225

P224

P223

P222

P221

P220

P219

P218

P217

P216

P215

P214

P213

P212



Start R-58

Lower Rd.

3420 cut

Cabin  
cut b 51

Red.  
Bx silic Arg.  
R-62

R61 FH.

canon

Area From  
Dump R-58  
V. Highy Carb zone in CK.  
May Bx sil. Carb  
4/19/11

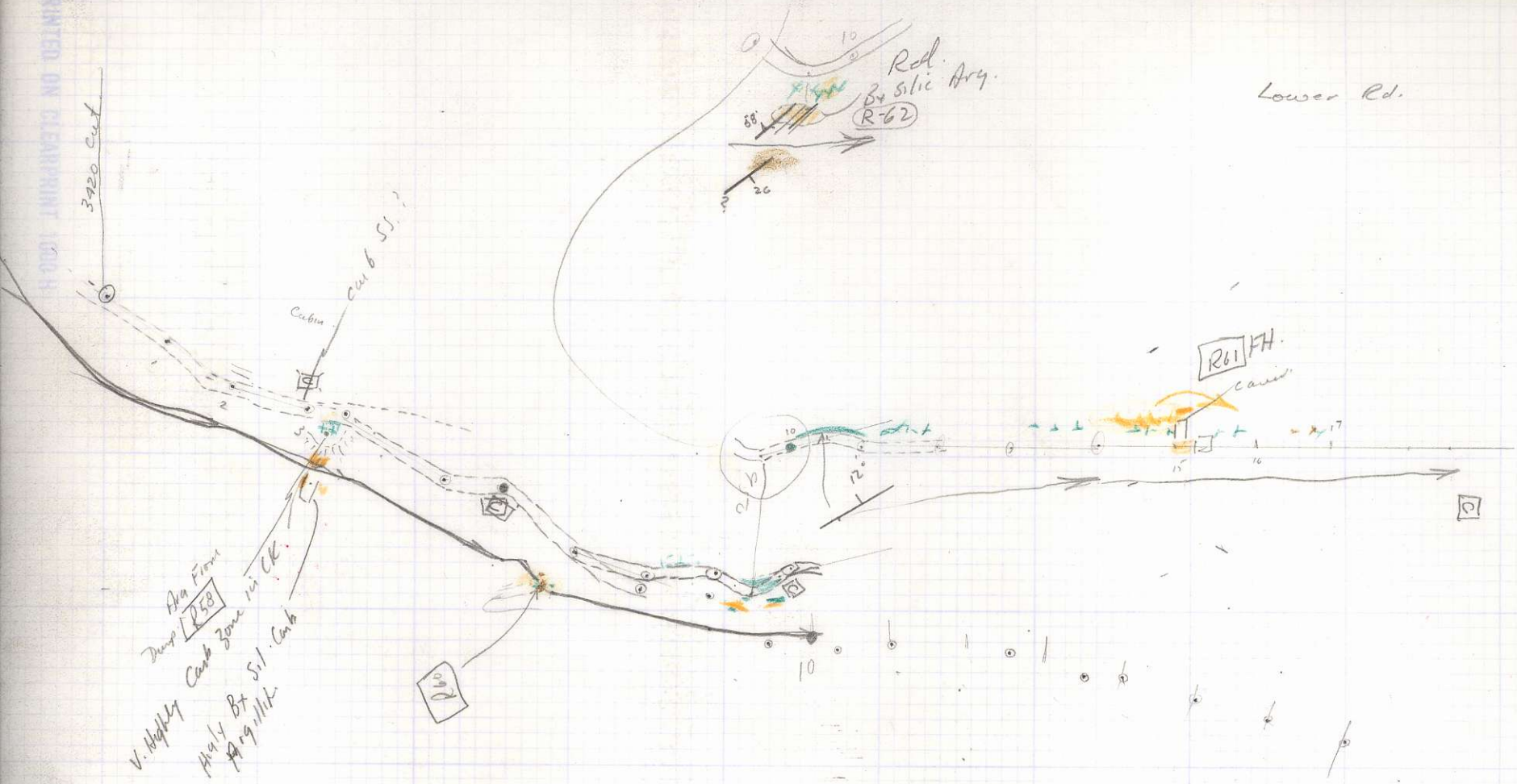

carb zone

Trench -  
2600  
Not Storrop CK.

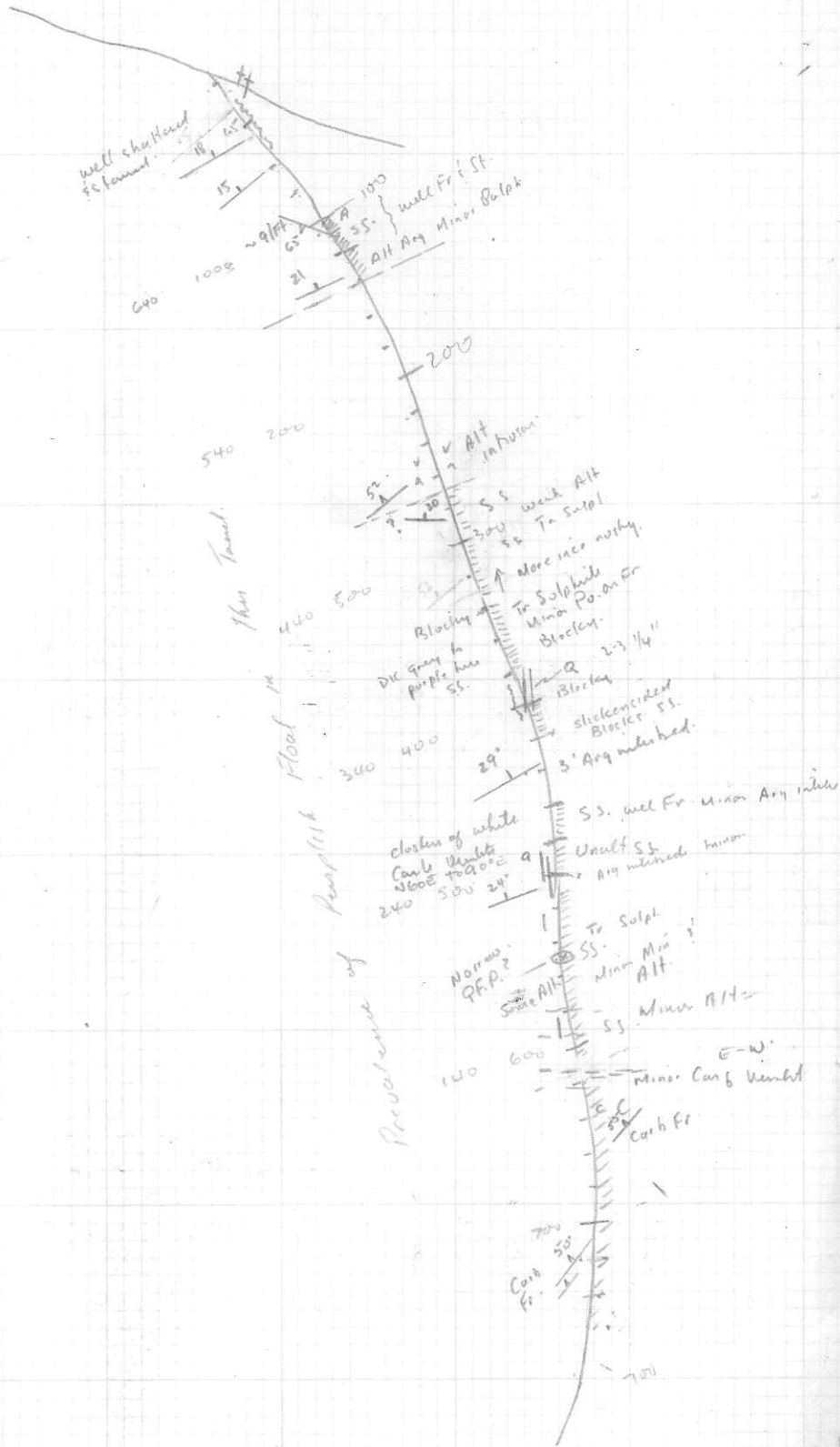



# Ridge Survey EAST



PLACER TRENCH EAST

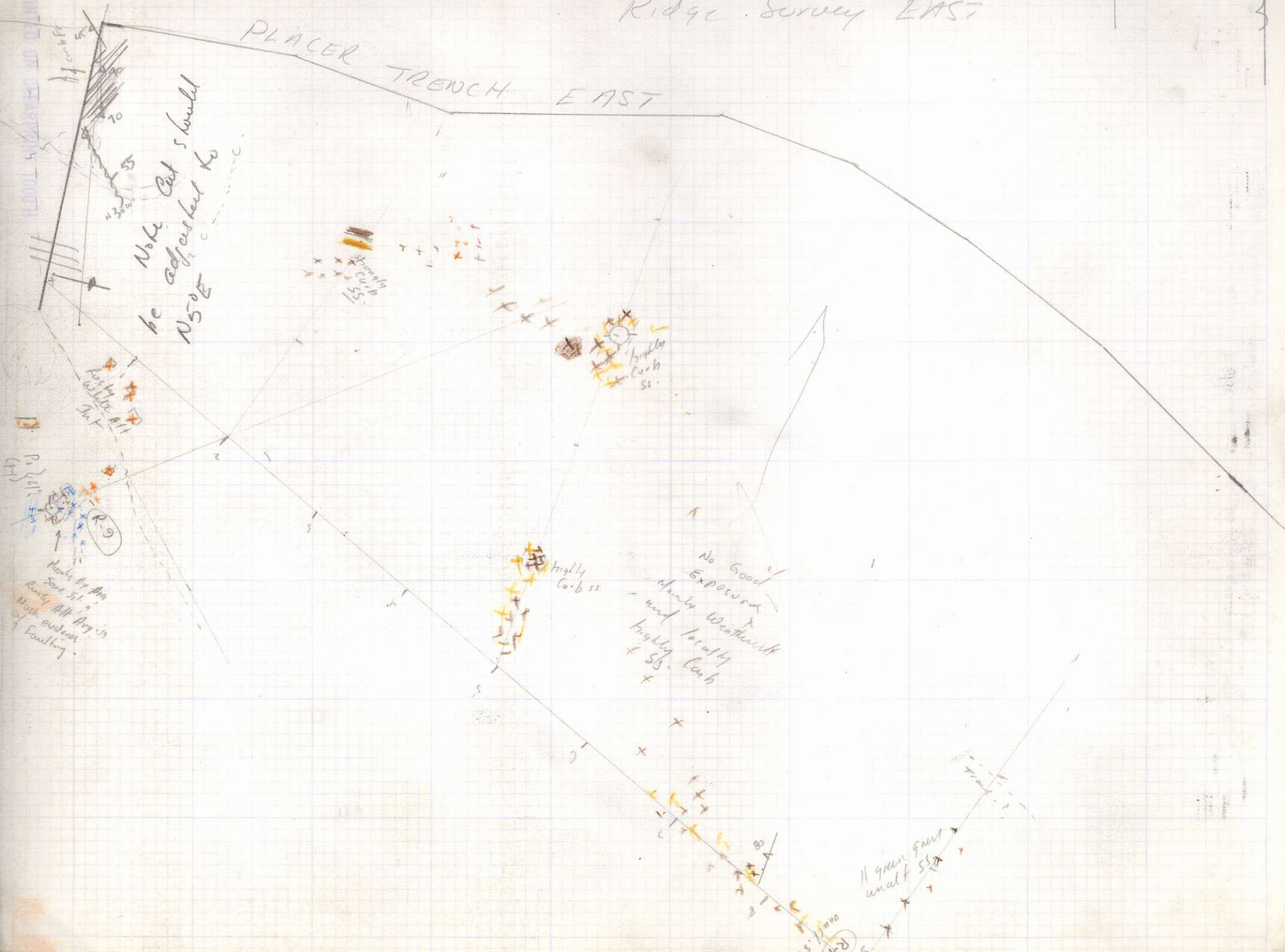



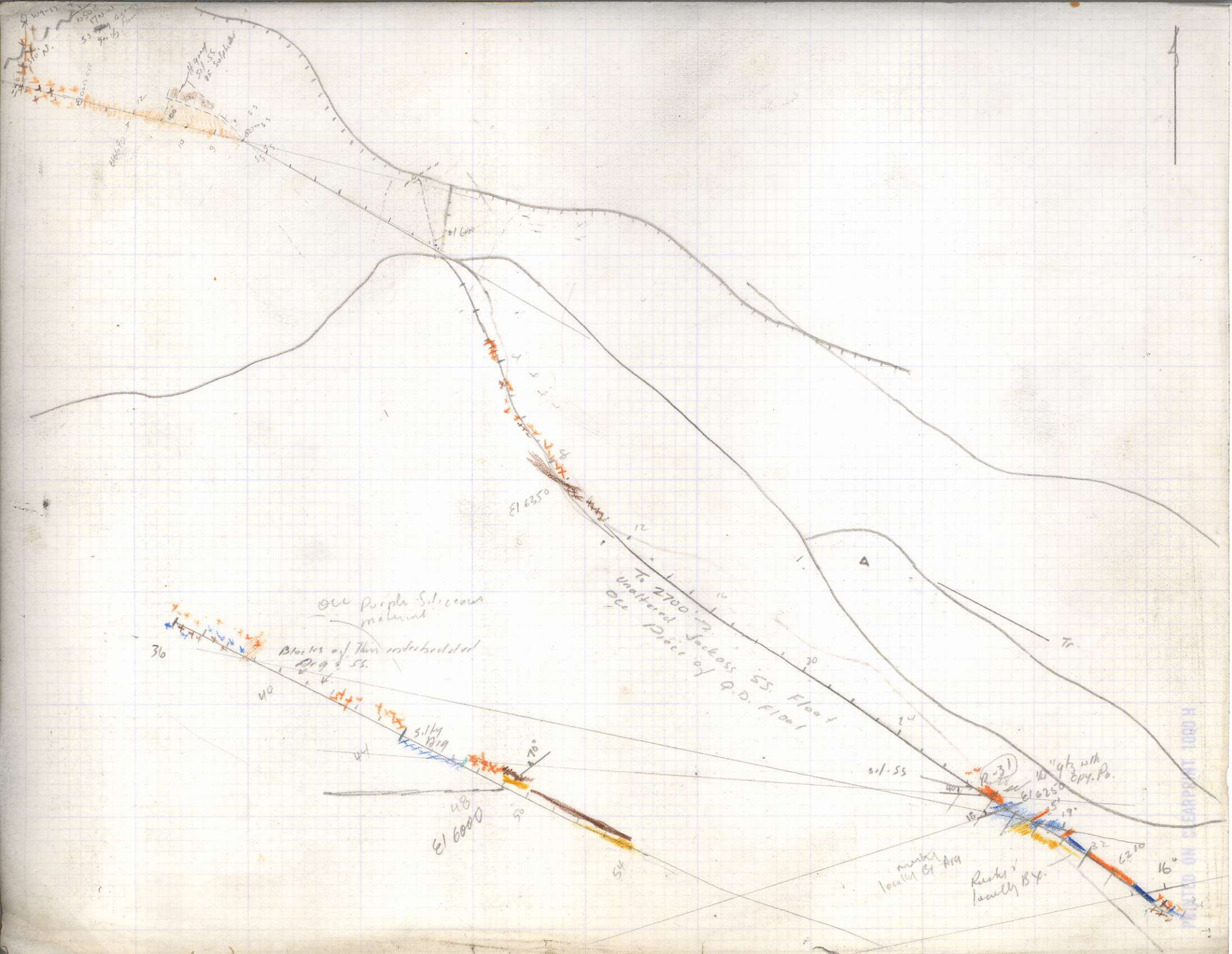

PRINTED ON REARPRINT 1000 A











TR. 2

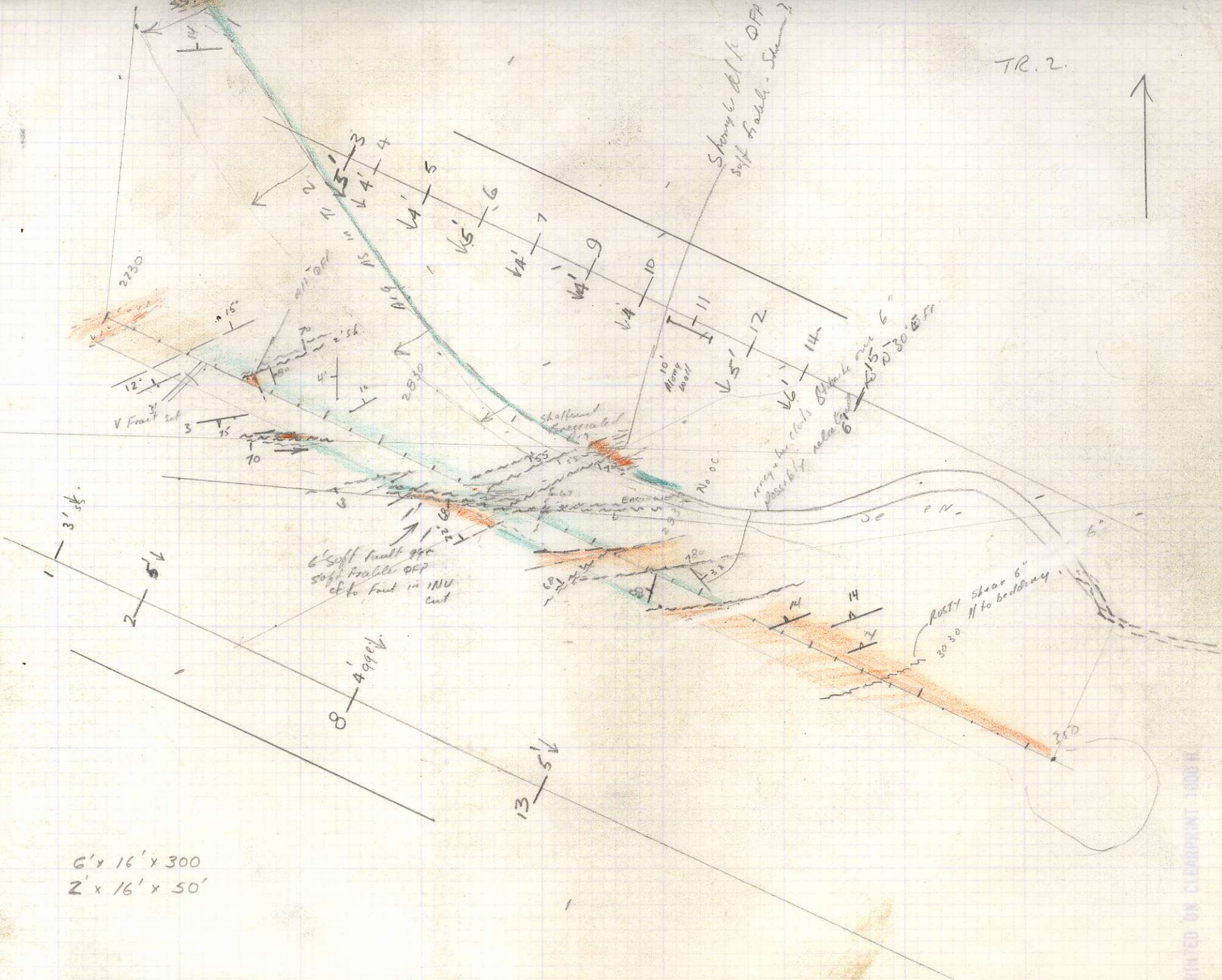
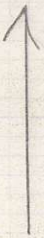

6' x 16' x 300  
 2' x 16' x 50'



2880 3000 3060 3080 3140 3230 3250 3350 3420









