

This reference scale bar has been added to the original image. It will scale at the same rate as the image, therefore it can be used as a reference for the original size.

LEGEND

- Cu Mineralization
- Andesite
- Ilmenite
- Limestone
- Trenches
- Faults
- Approximate Contact
- Lamprophyre Dike

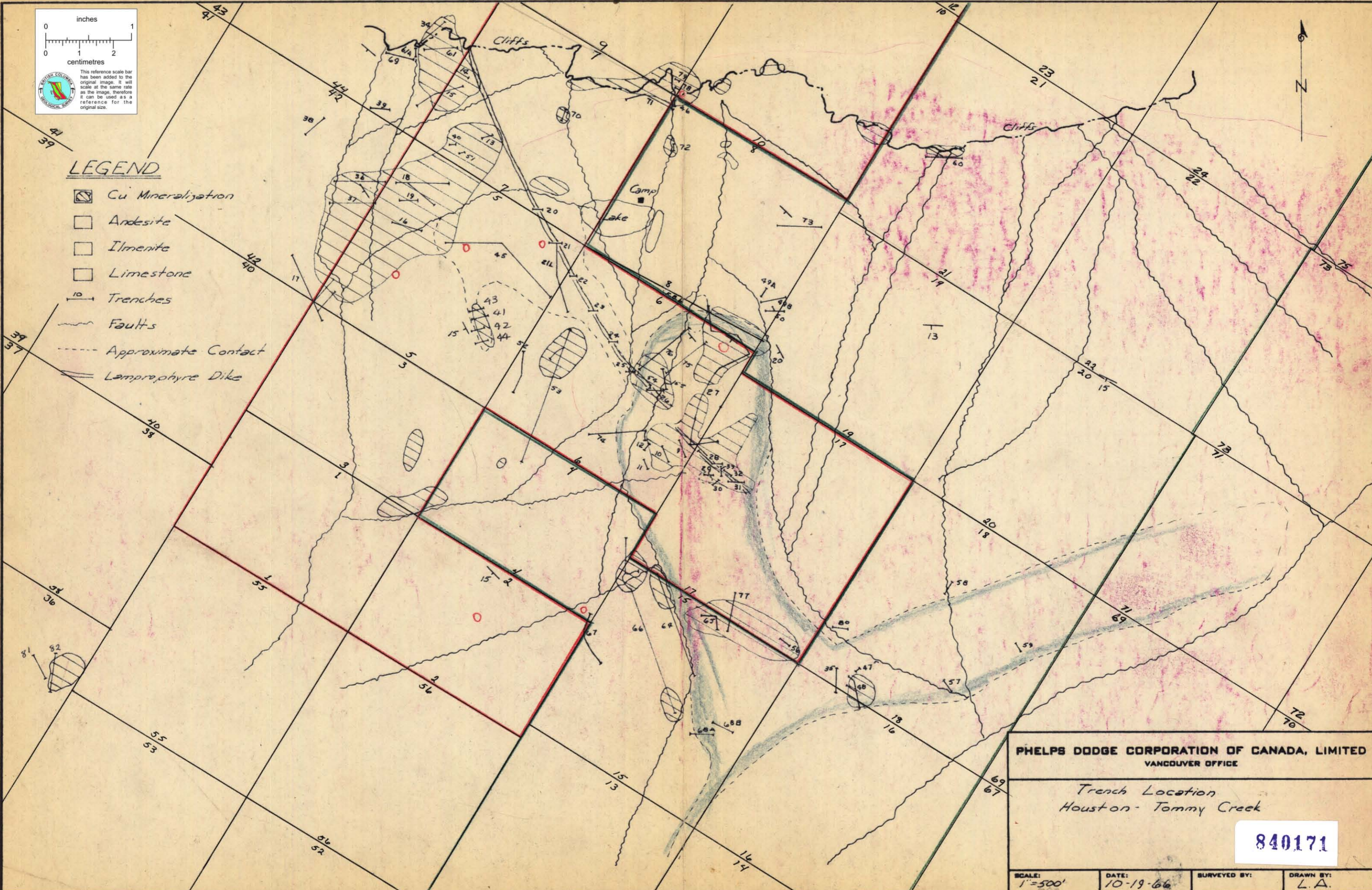

PHELPS DODGE CORPORATION OF CANADA, LIMITED
VANCOUVER OFFICE

Trench Location
Houston - Tommy Creek

840171

| | | | |
|-------------------|-------------------|--------------|-------------------|
| SCALE: 1"=500' | DATE: 10-19-66 | SURVEYED BY: | DRAWN BY: L.A. |
|-------------------|-------------------|--------------|-------------------|