

Preliminary Jean diagrams
ca. 1993-1994
93N/2W

830714

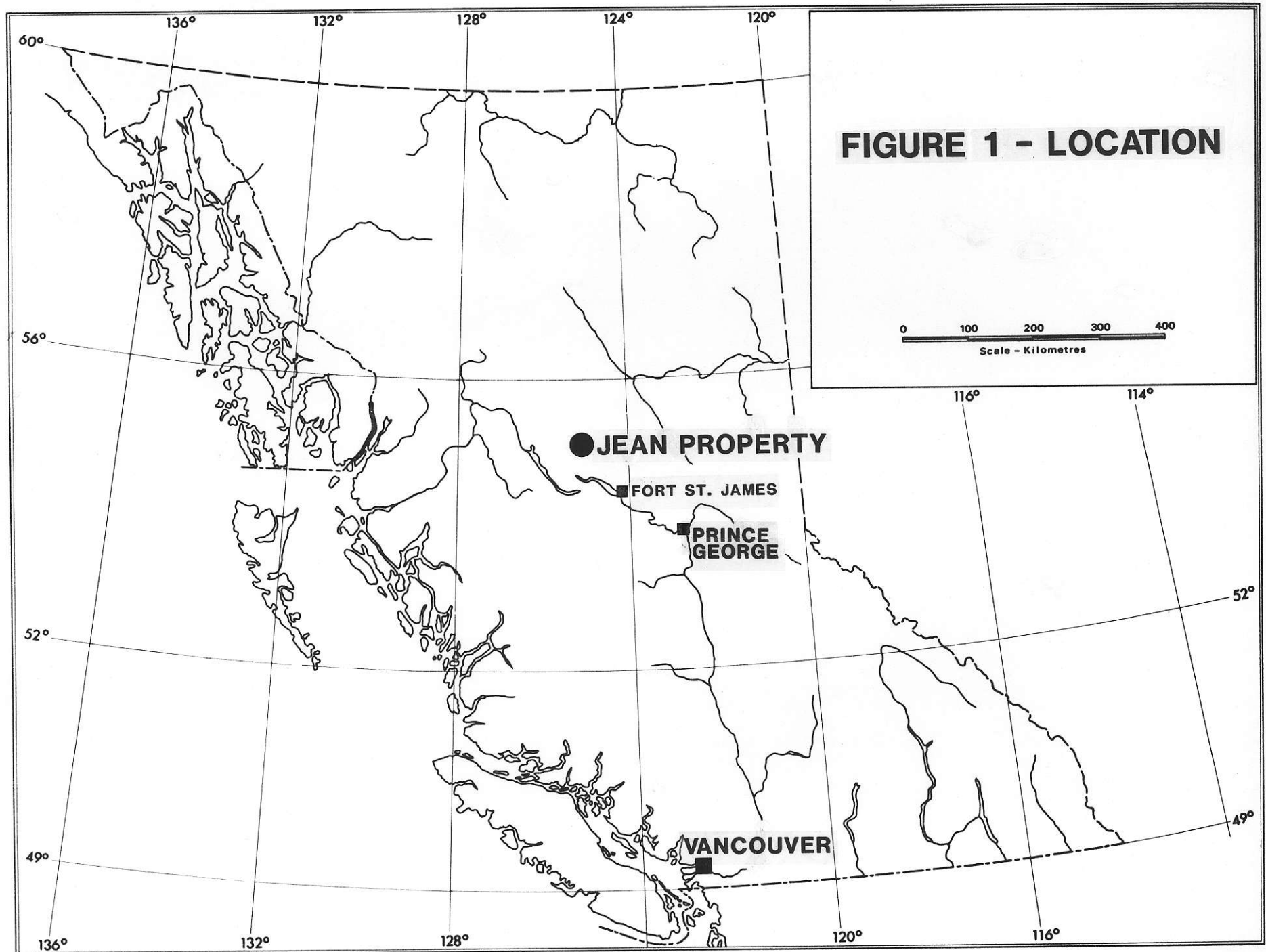

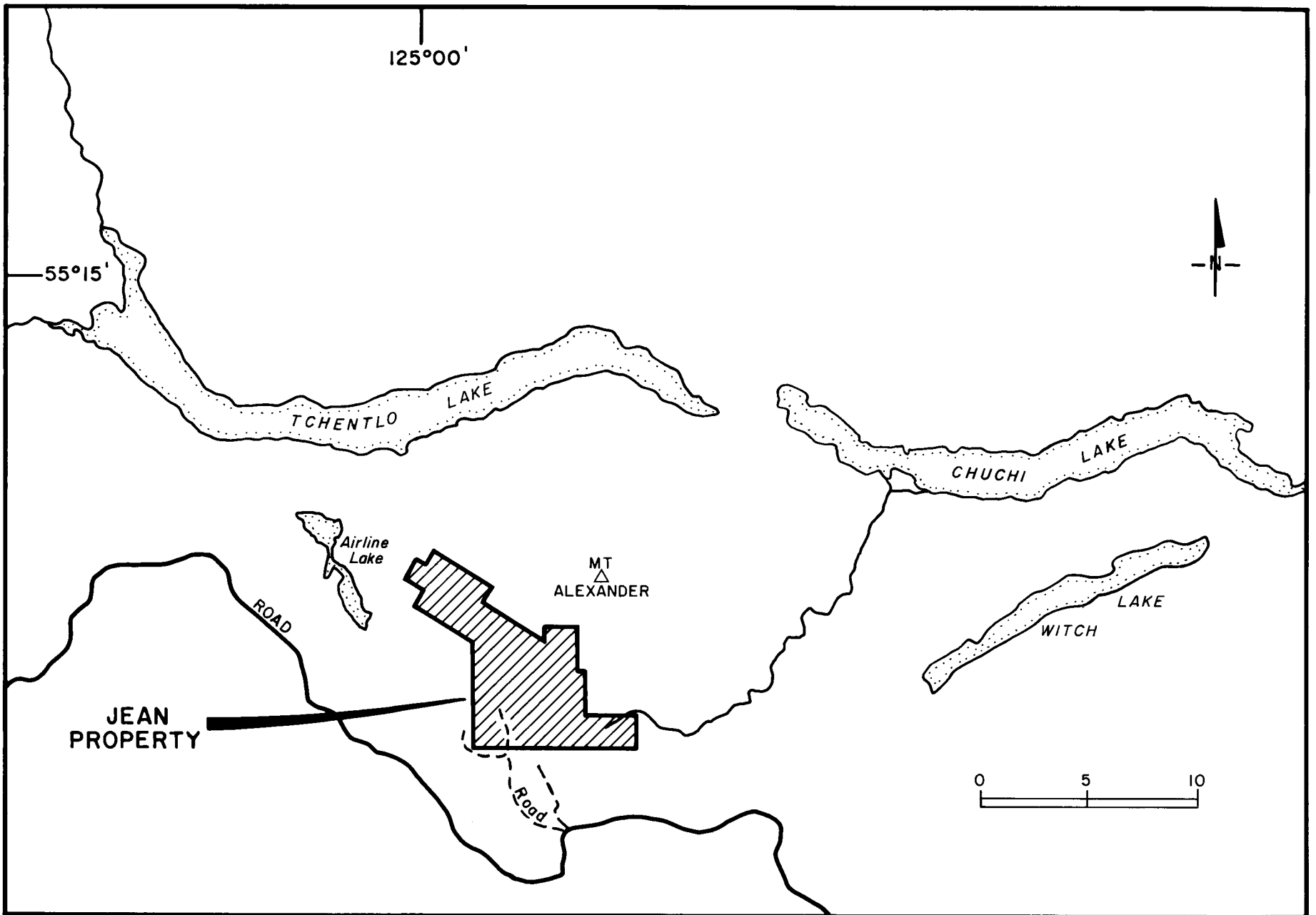

FIGURE 2 - LOCATION - JEAN PROPERTY

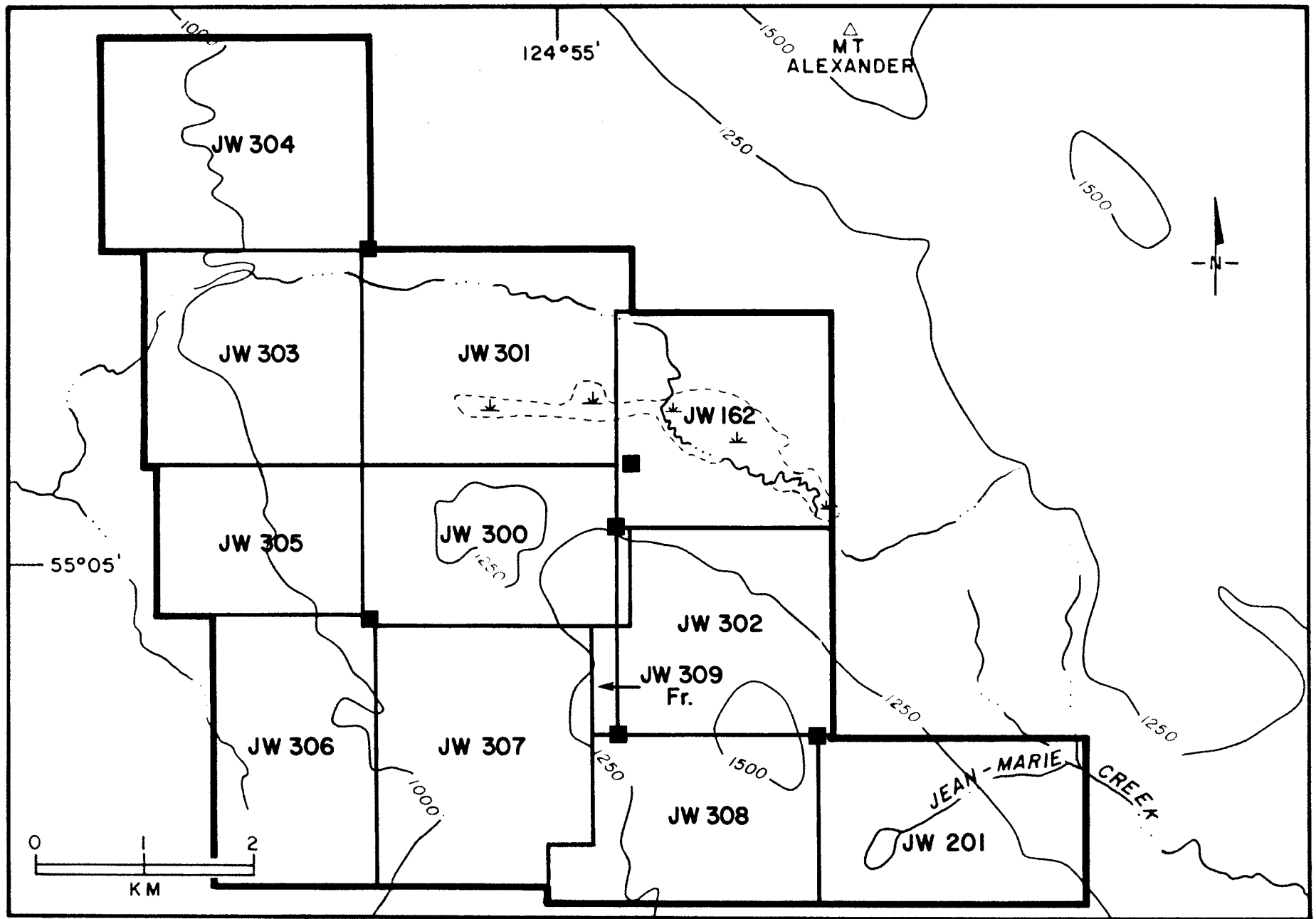
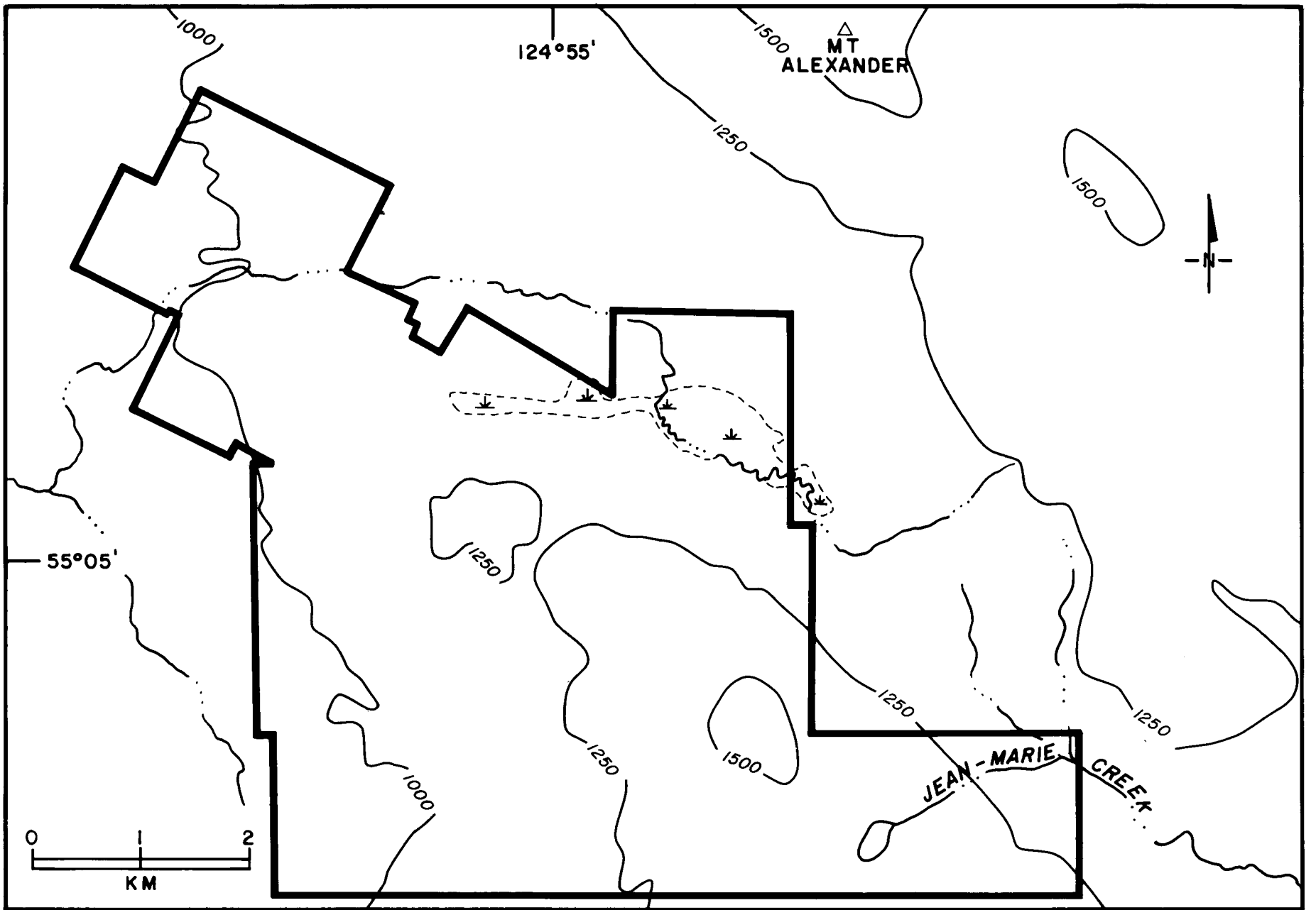
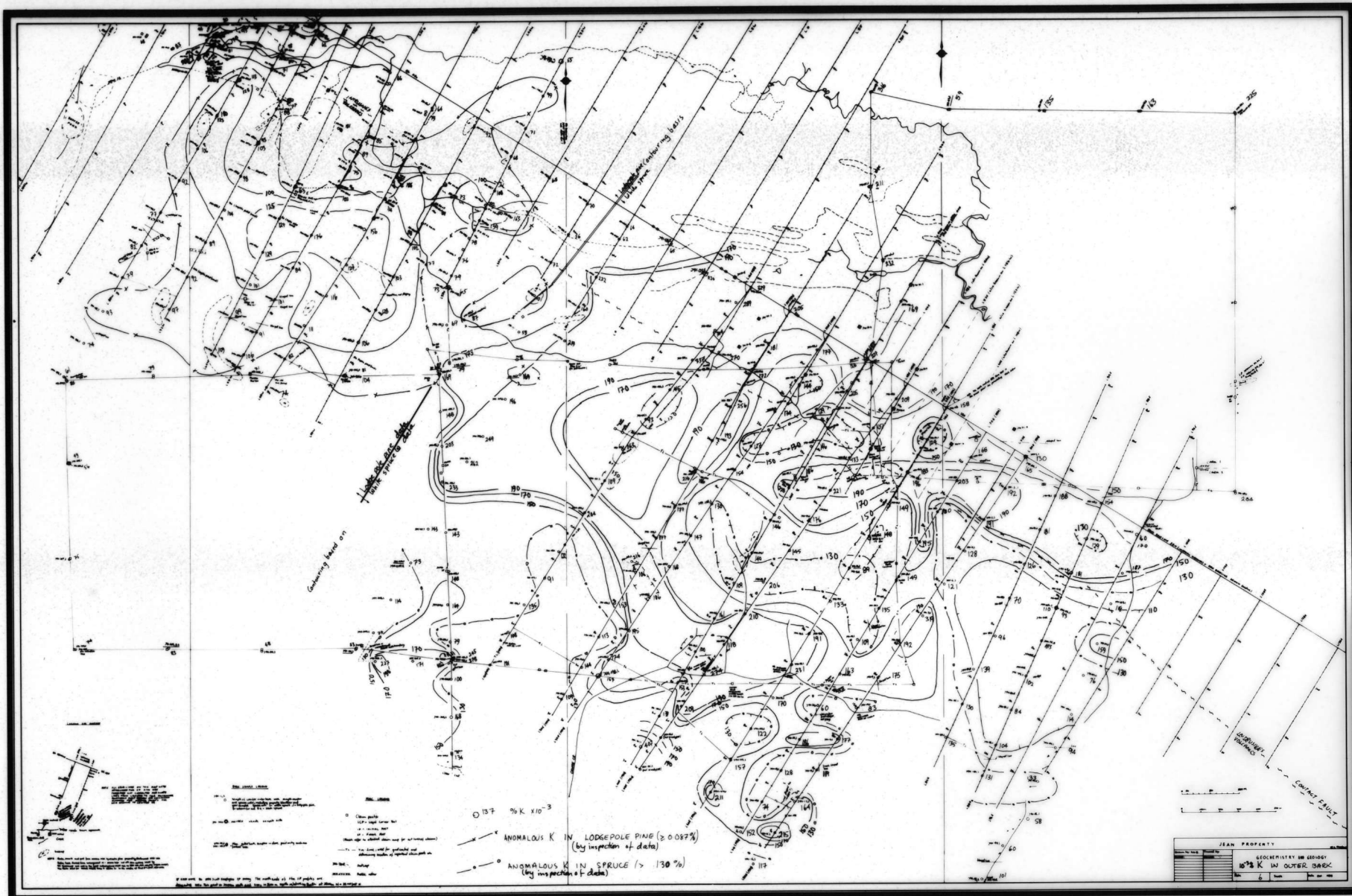
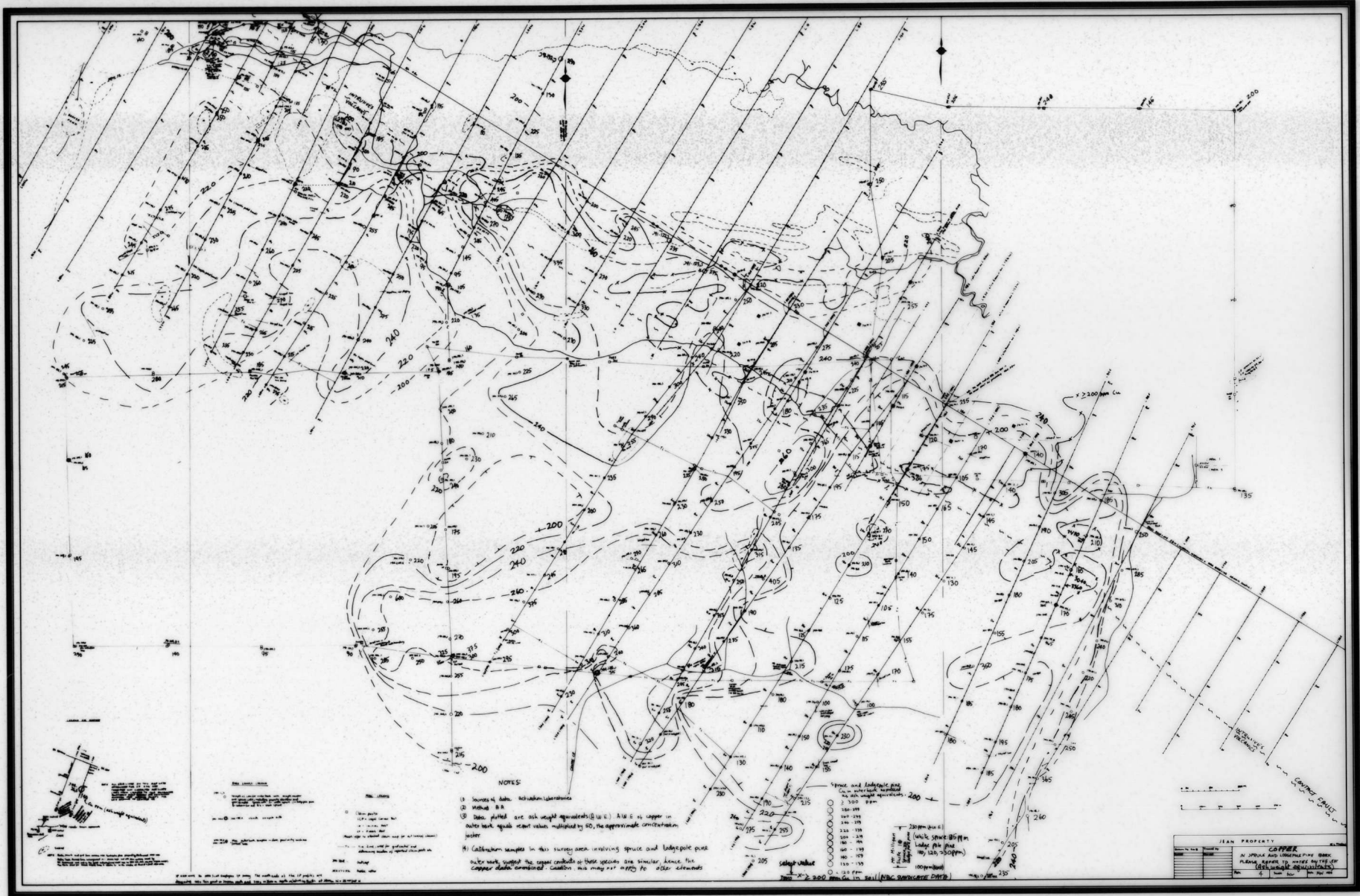

FIGURE 1 - JEAN PROPERTY - MINERAL CLAIMS





1:30,000



All these series dist to enforce

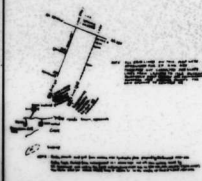
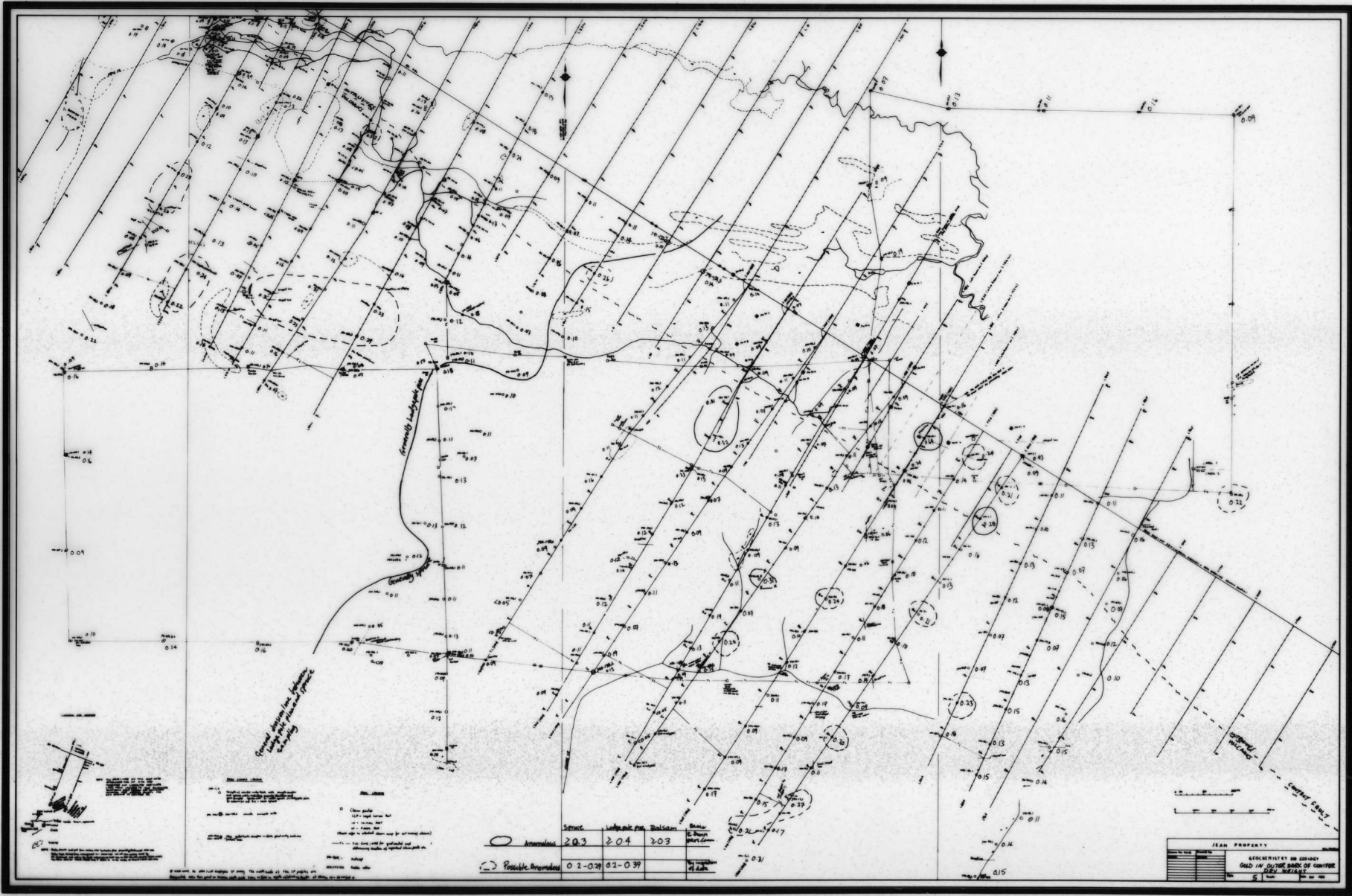

*Original section lines, including
changes made by subsequent
surveying*

SECTION LINES
 - - - - - Original section lines
 - - - - - Original section lines, including
 changes made by subsequent
 surveying

ROADS
 - - - - - Original road lines
 - - - - - Original road lines, including
 changes made by subsequent
 surveying

CONTOUR LINES
 - - - - - Original contour lines
 - - - - - Original contour lines, including
 changes made by subsequent
 surveying

SECTION NUMBERS
 - - - - - Original section numbers
 - - - - - Original section numbers, including
 changes made by subsequent
 surveying

Section	203	204	205
Possible boundaries	02-029	02-039	

JEAN PROPERTY

GEORGETOWN IN GEORGIA
 GED IN COUNTY MAPS OF GEORGIA
 1910

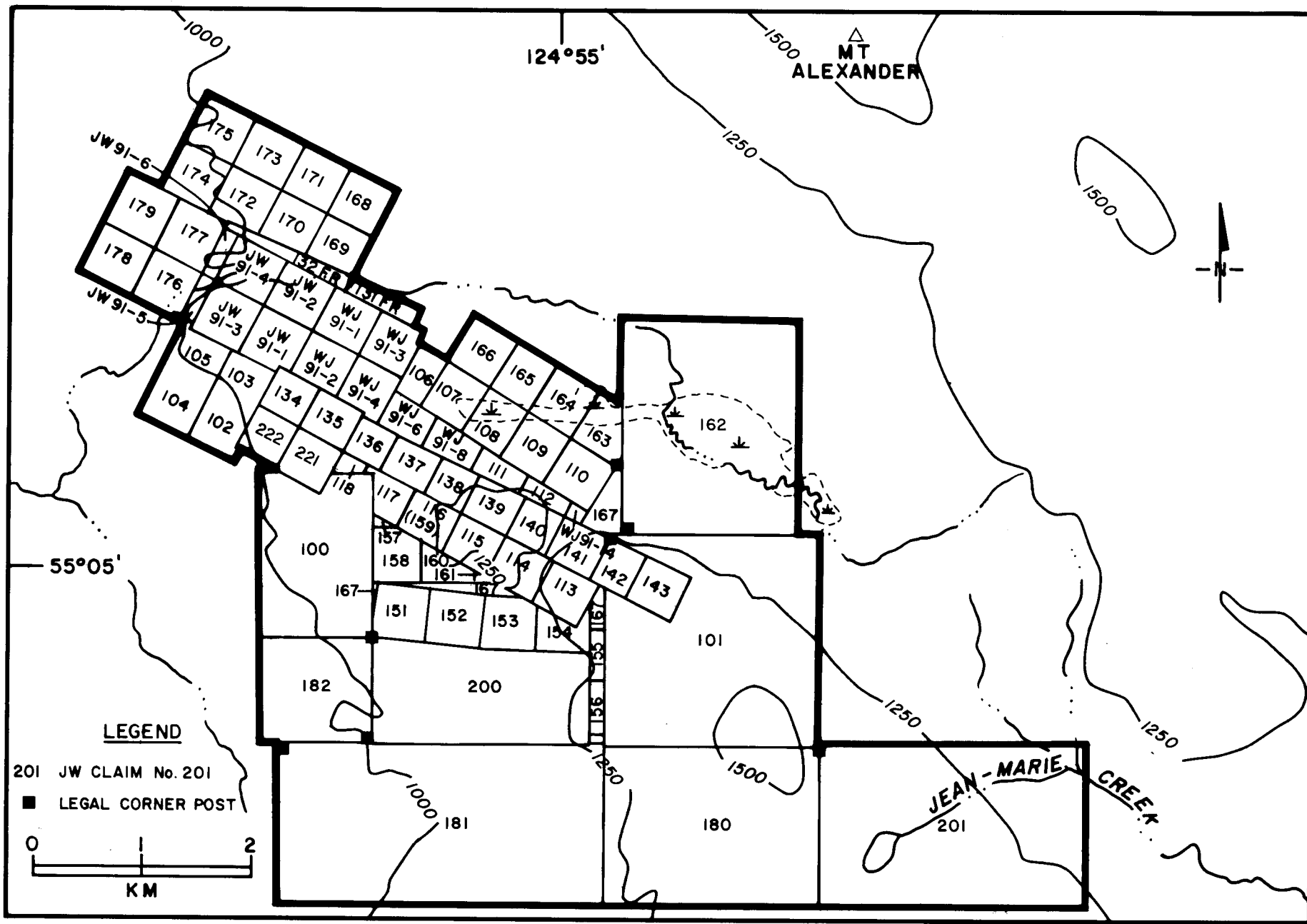

FIGURE 3 - CLAIM MAP - JEAN PROPERTY