

pale green silic volcs, px pheno, minor diss py

strongly sheared, nt att'd (carb?) serp.

volcs are px phyre (5% to 1mm) + ep alt'n (weak) fng, massive

Med grained, subvolc dior intrusive? 50% plag avg 2-3 mm, 20% mafics (px+?) avg 1mm in fng matrix. Massive, blocky weak ep, seric locally.

Coarse grained syenite dyke. v. massive, blocky

Med grained, 50% plag, 20% mafics to 3mm in fng matrix, pale green - sub volc as above

irregular porous structures



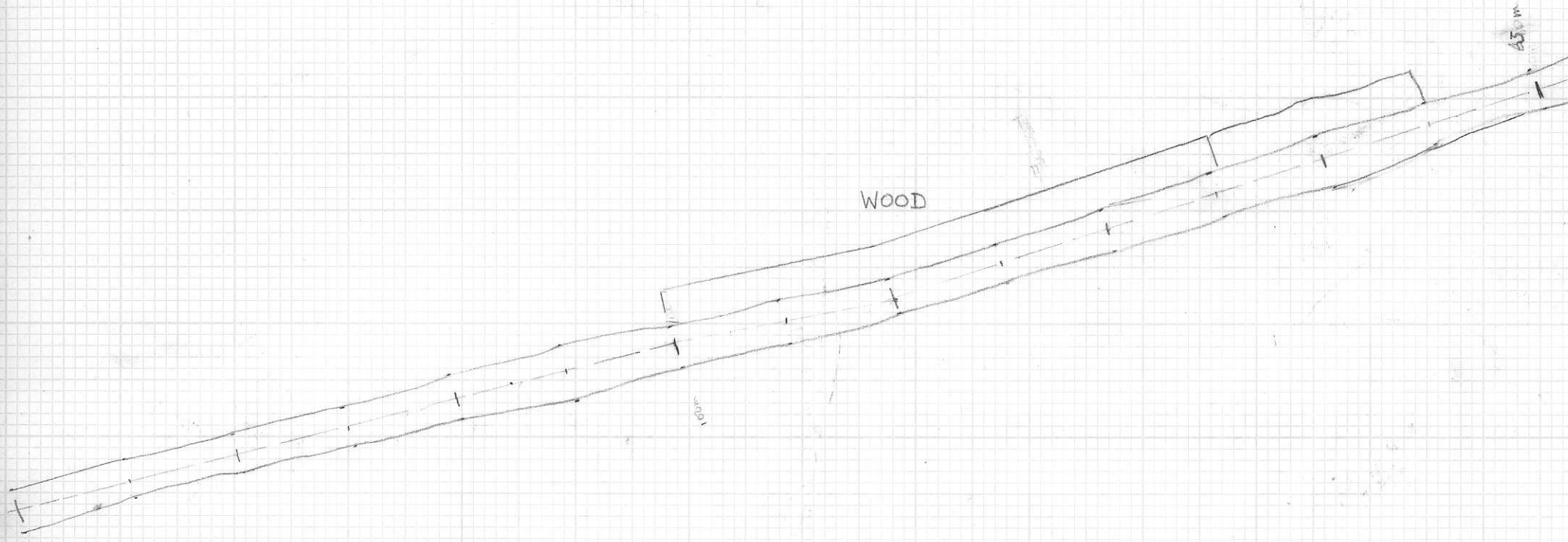

WOOD

100m

150m

450m

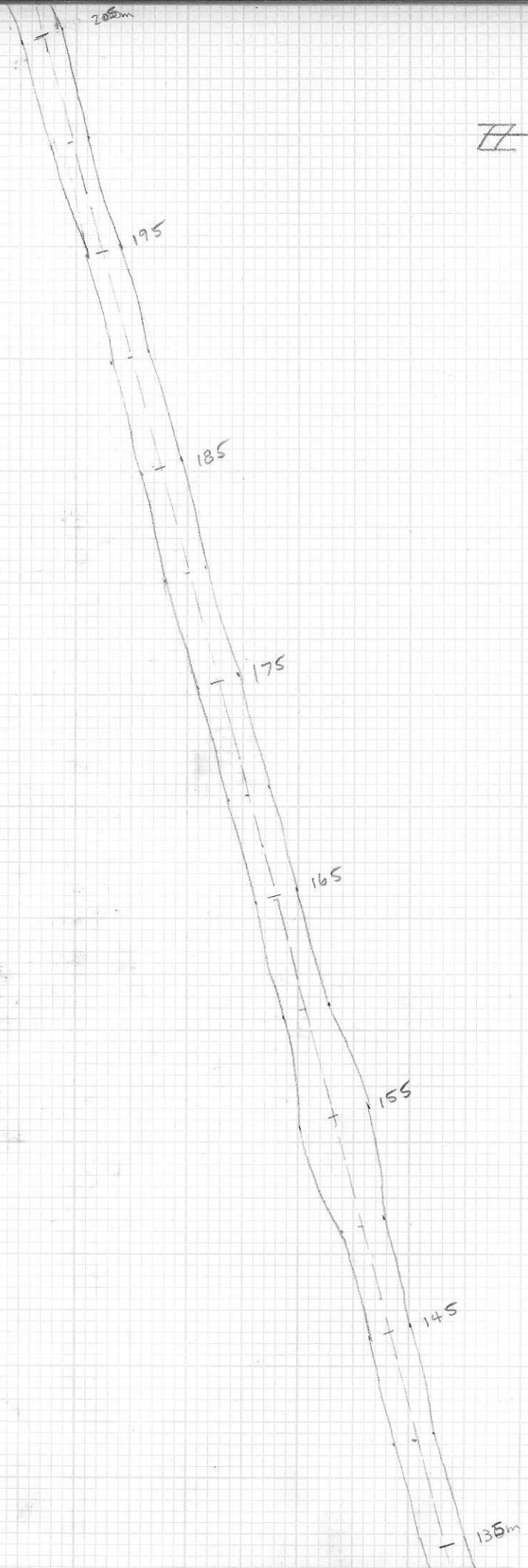



4002 syenite, v. well devel. jointing

Fig, px phynic volc, minor diss py & py stringers  
minor ep, massive; may coarsen to  
sub volc near syenite contact

major shear/gouge zone, strongly seric volcs, bx, gouge, minor carb clasts

strongly sheared.

Med. grained intrusive (subvolc?) Diorite with 50% plag, 20% mafes, in fig mass; locally grad to finer grained. 2% diss py, carb stringers common

→ intrusive looks much older than Tert. dykes, sheared & altered like volcs may be gradational with them.

irregular gossamy patches + minor py/ep stringers along shears

.5 m gouge/shear zone

well sheared, mod carb-sulfat'n

med grained intrusive - massive, blocky 50% feldsp, 30% mafes, minor py + ?? grades into coarse syenite = border phase

coarse grained syenite blocky, well jointed, massive

strong shearing, serp slickes

blocky

Irregular zone poor contacts of Dyke, med gr intrusive - looks dioritic could be product of volcs or border phase of syenite??

fine med gr. massive pink-brown syenite with 5% mafes px? to 2mm, 15% Ksp to 3mm in fig matrix

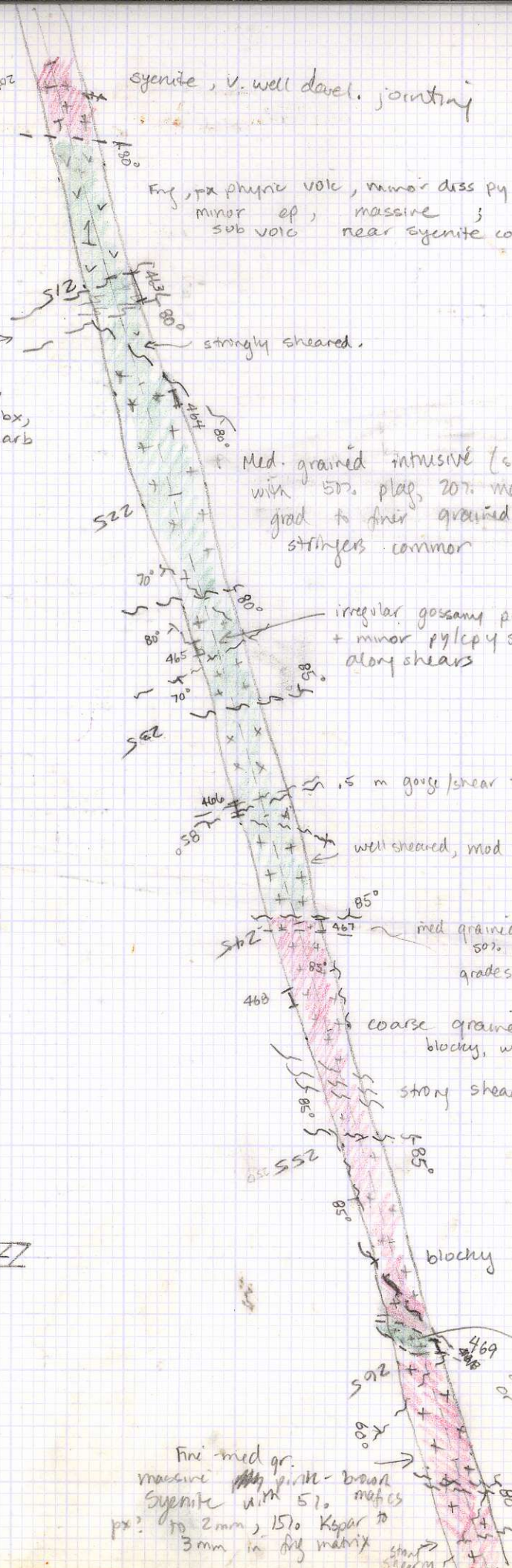



v. strong jointing  
335

Massive coarse pink syenite

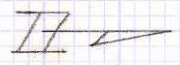

v. strong fault zone in syenite, strongly tilted, bx, gouge

325 timbered syenite

major shear zone

315 800

Coarse pink syenite Well jointed

305 rusty shear

Med grained grey, fresh looking monzonite? intrusive

well devel. jointing

295

Massive, blocky (much fresher than 12470) coarse grained syenite

strong shearing add to contact

285

grey med gr monzonite intrusive locally chl, seric well sheared, sharp contact one end, grad contact one end ?? ~~land of shear~~ intrusive?? phase of syenite?

275

grad contact

83

Pink fine syenite



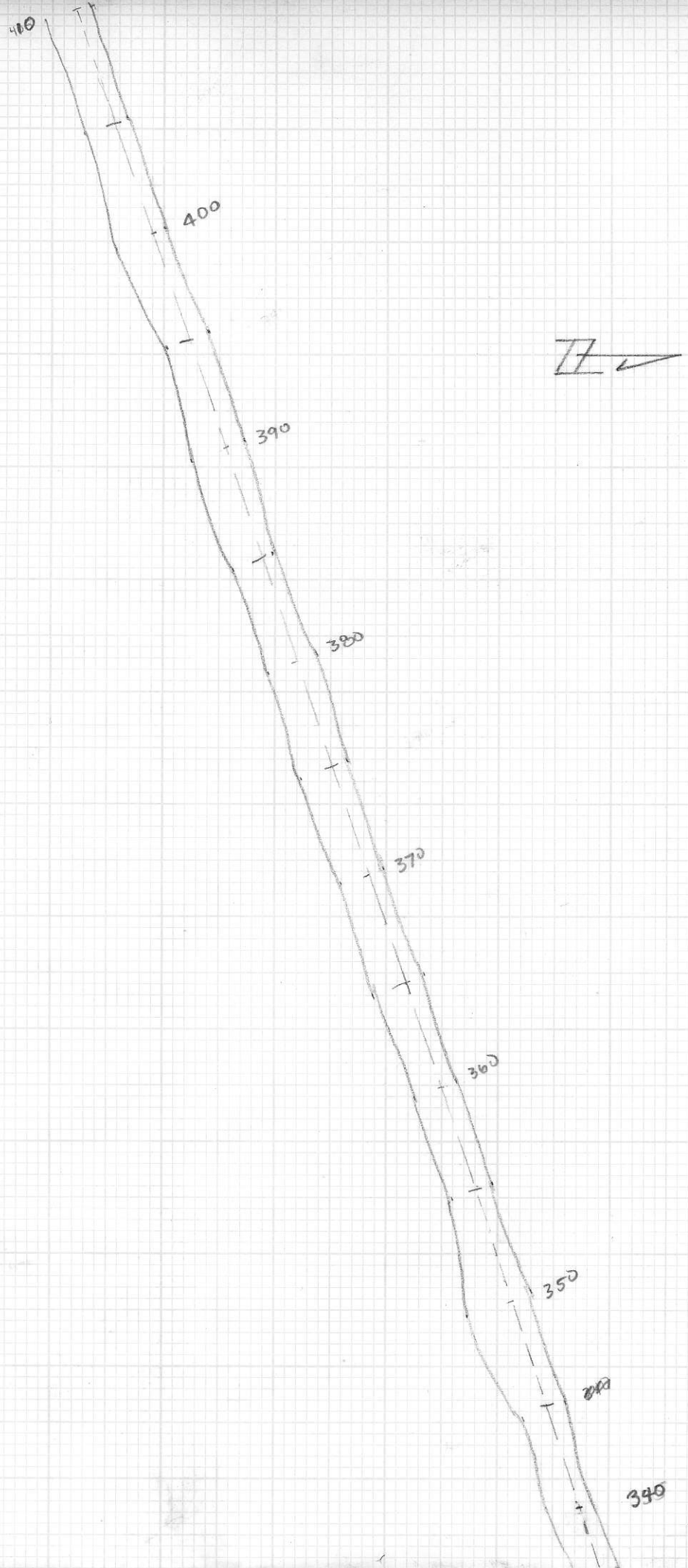

70

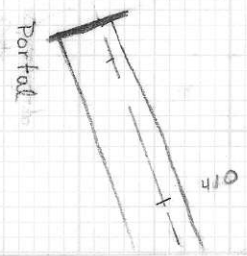





1:240

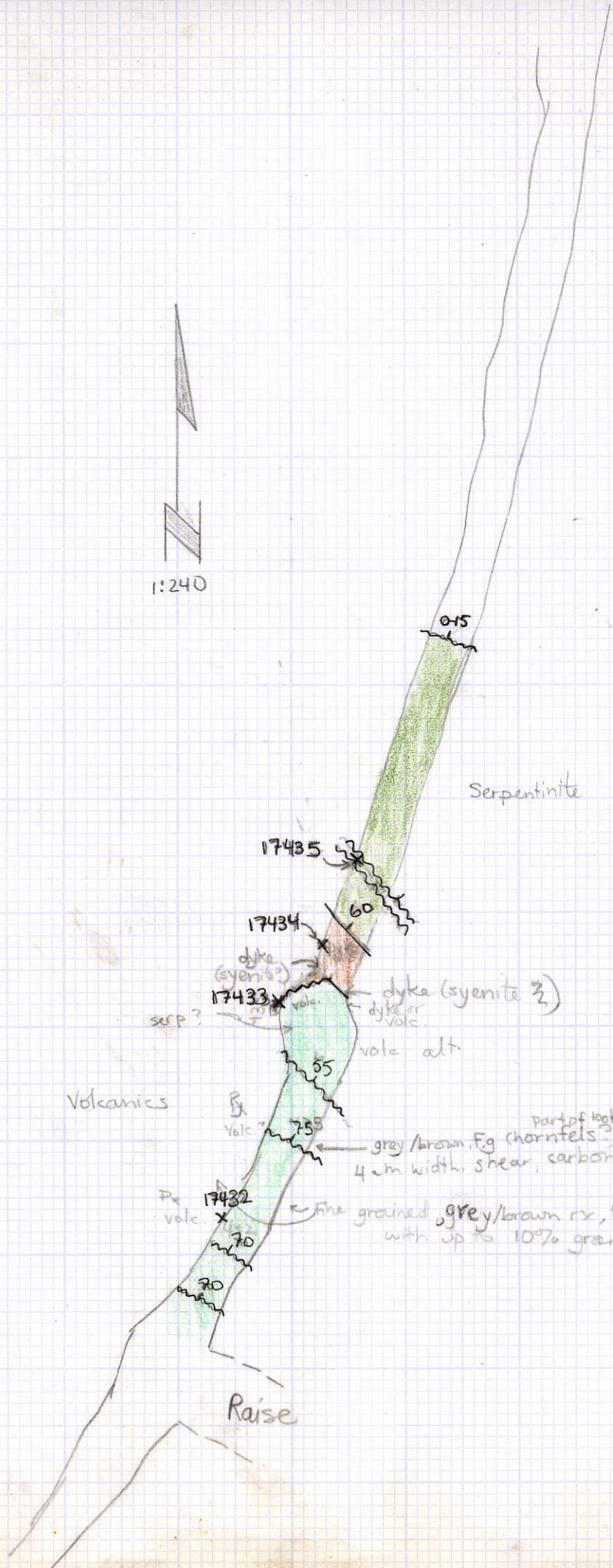

Serpentine

17435

17434

17433

dyke (syenite?)

dyke (syenite?)

serp?

volc alt.

Volcanics

Bx

Volc?

part of logs - part looks wkly serp. 4 cm width, shear, carbonate stringers.

Px

17432

volc

fine grained, grey/brown rx, fg. with up to 10% gran blks

Raise







Sheet 1

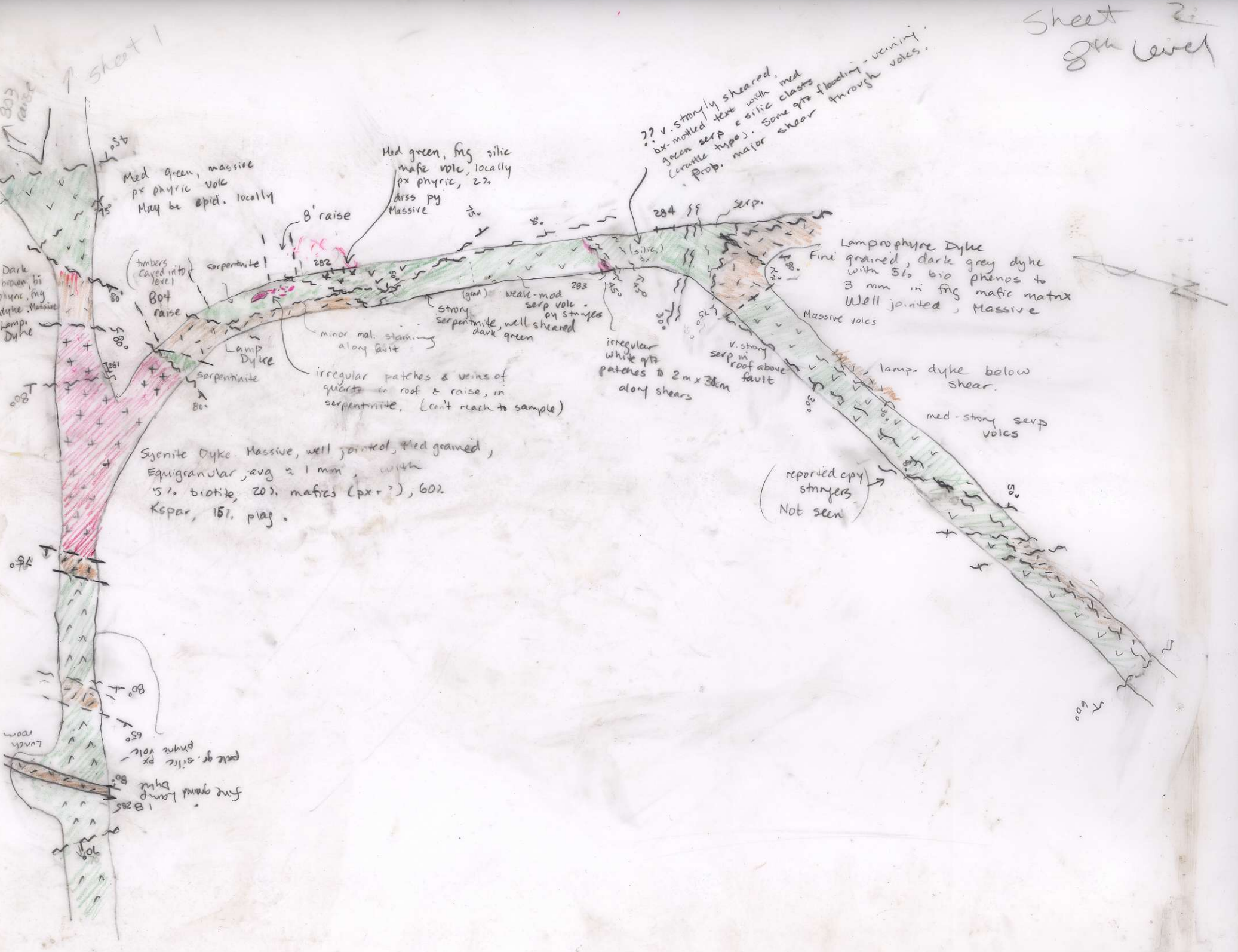



sheet 2

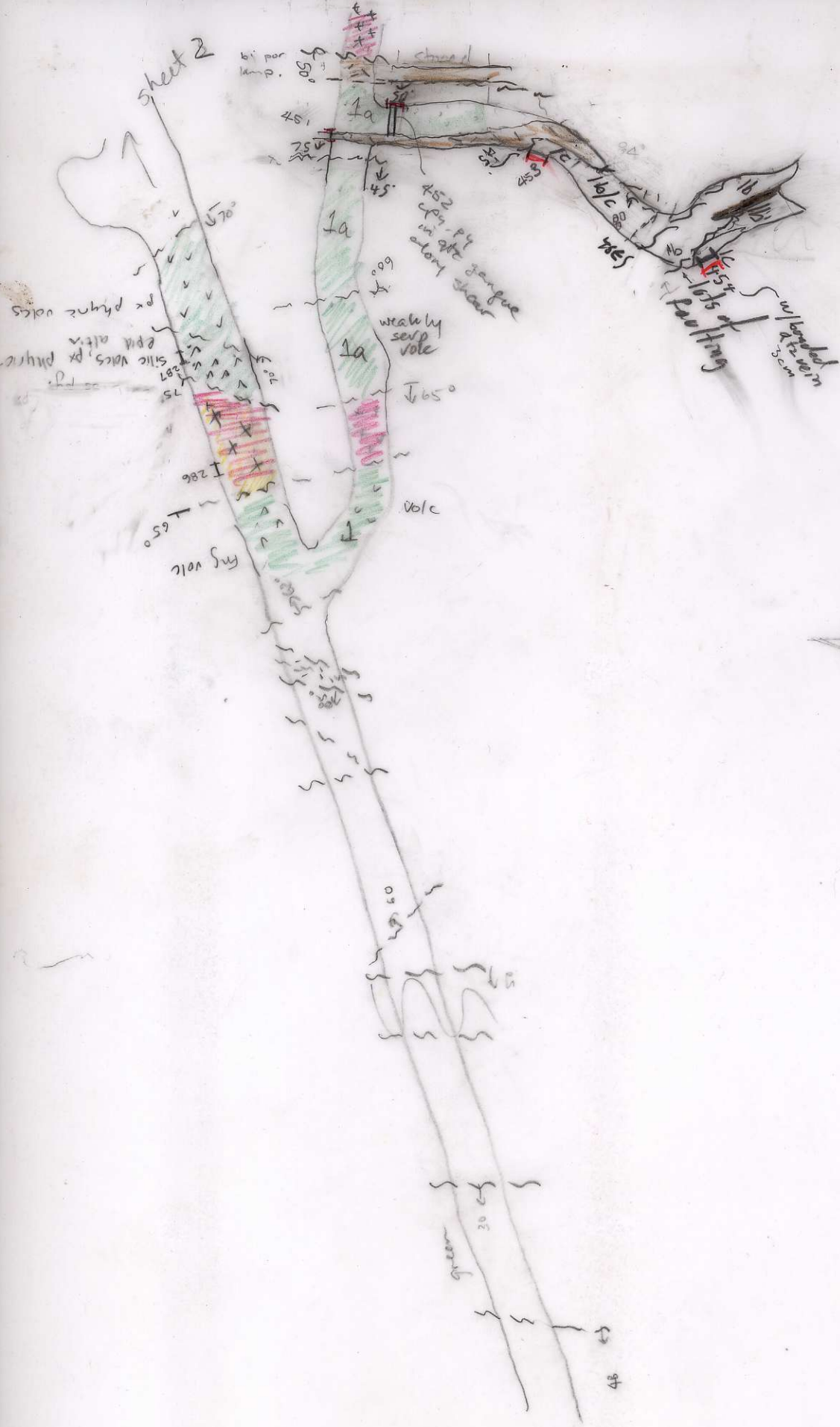







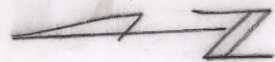

K.240

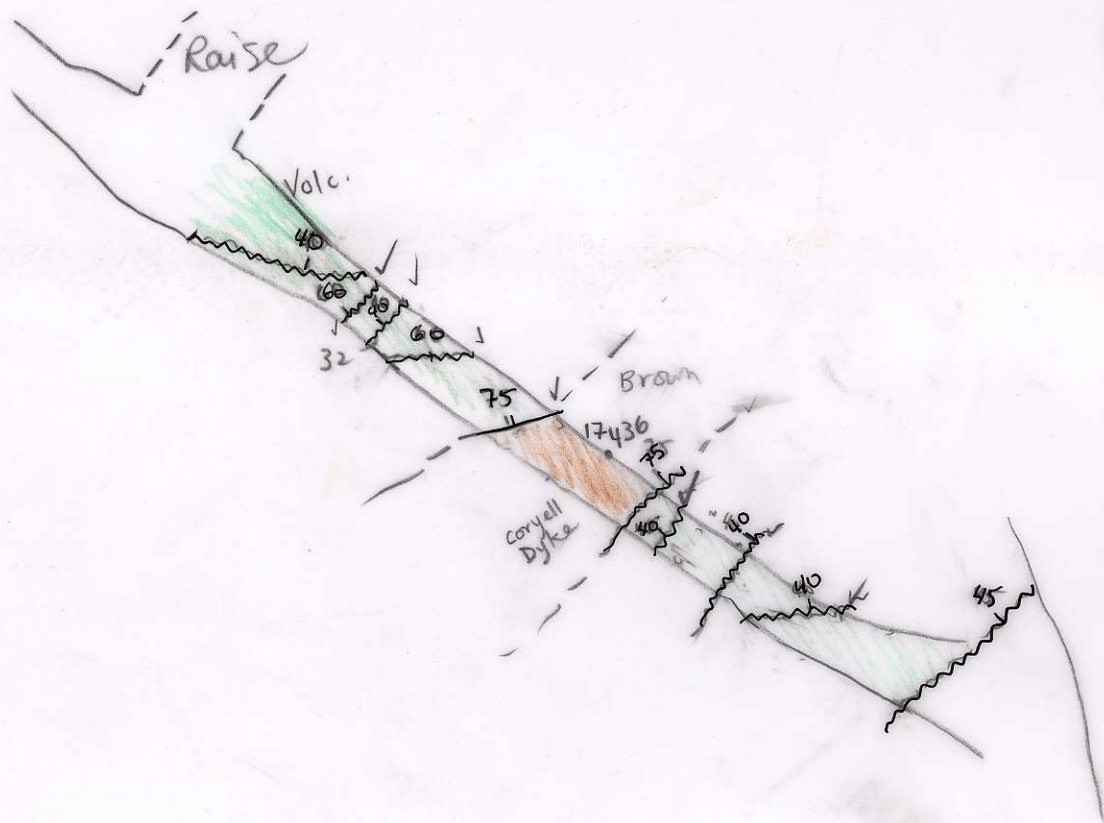



↑  
N  
1:2500

460m  
583m

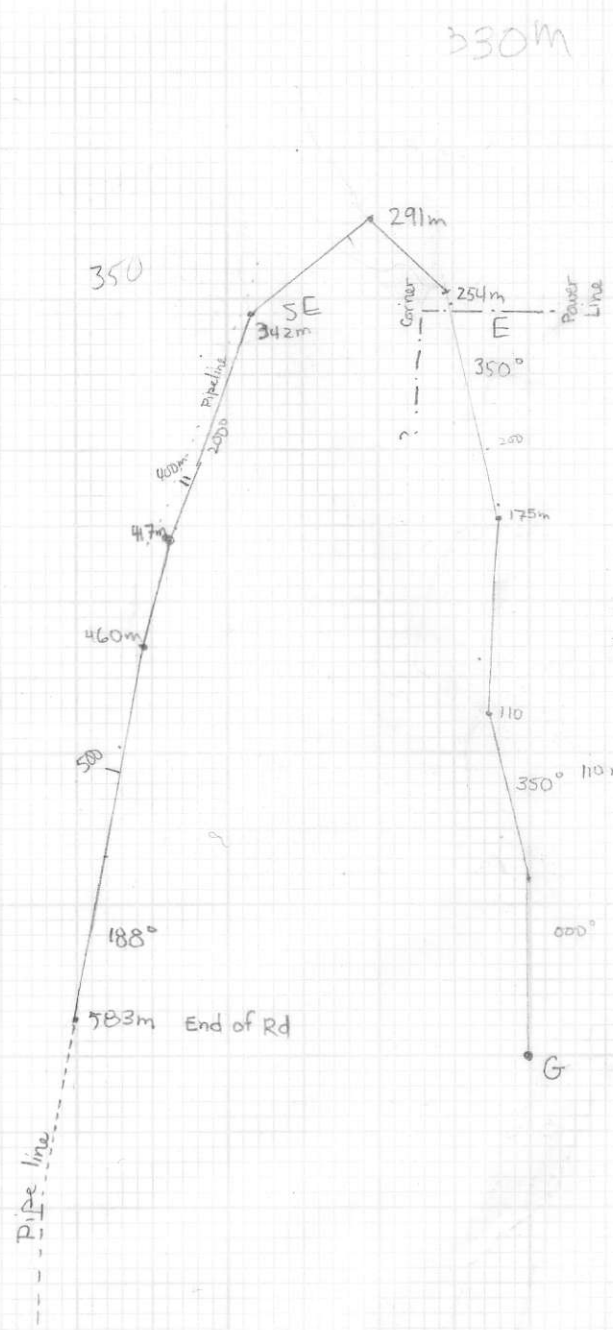

204

350

G



257°

137m From shaft to junction

~255°

406m from junction to portal

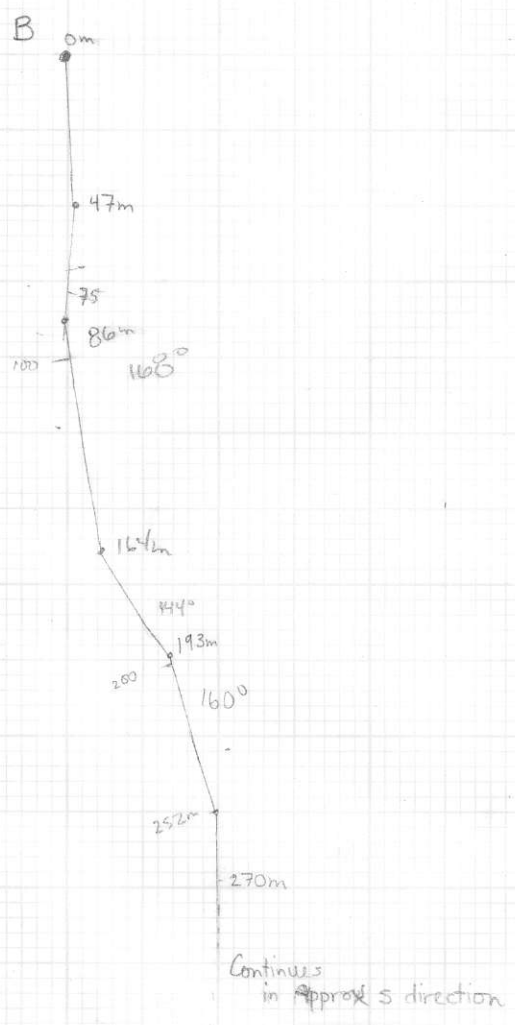

164m



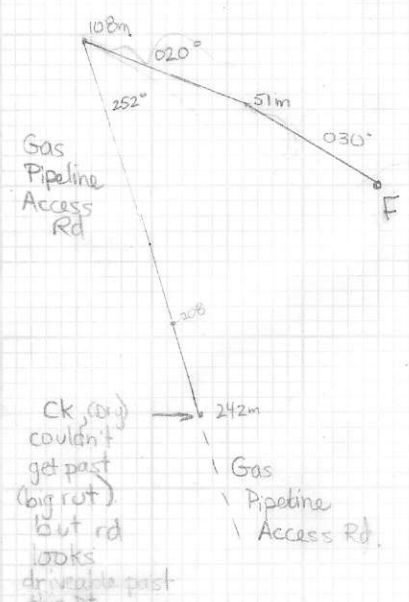

1:2500  
"Old Rd"

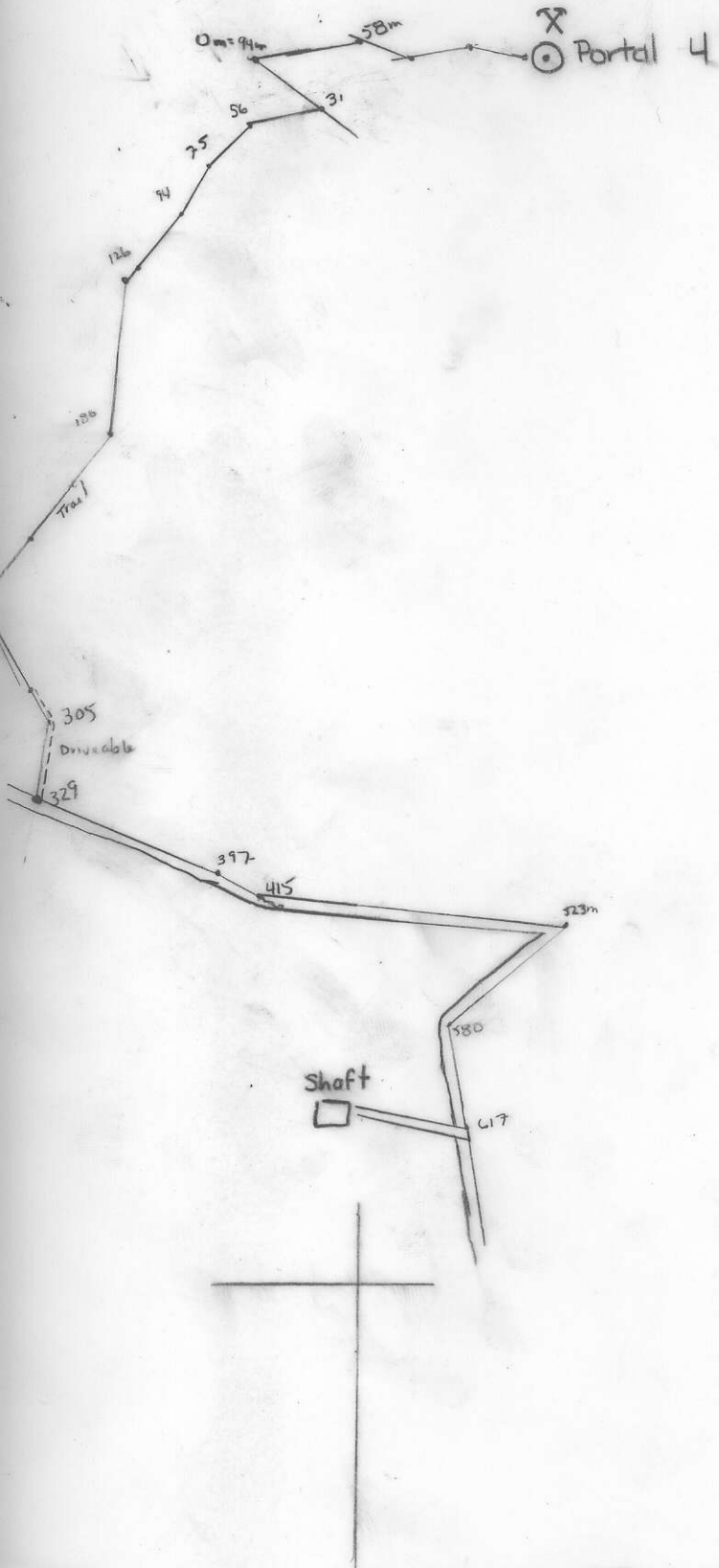
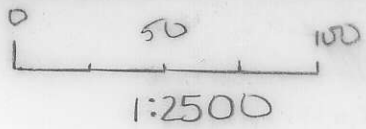





950  
 230  
 -----  
 720

1:6000

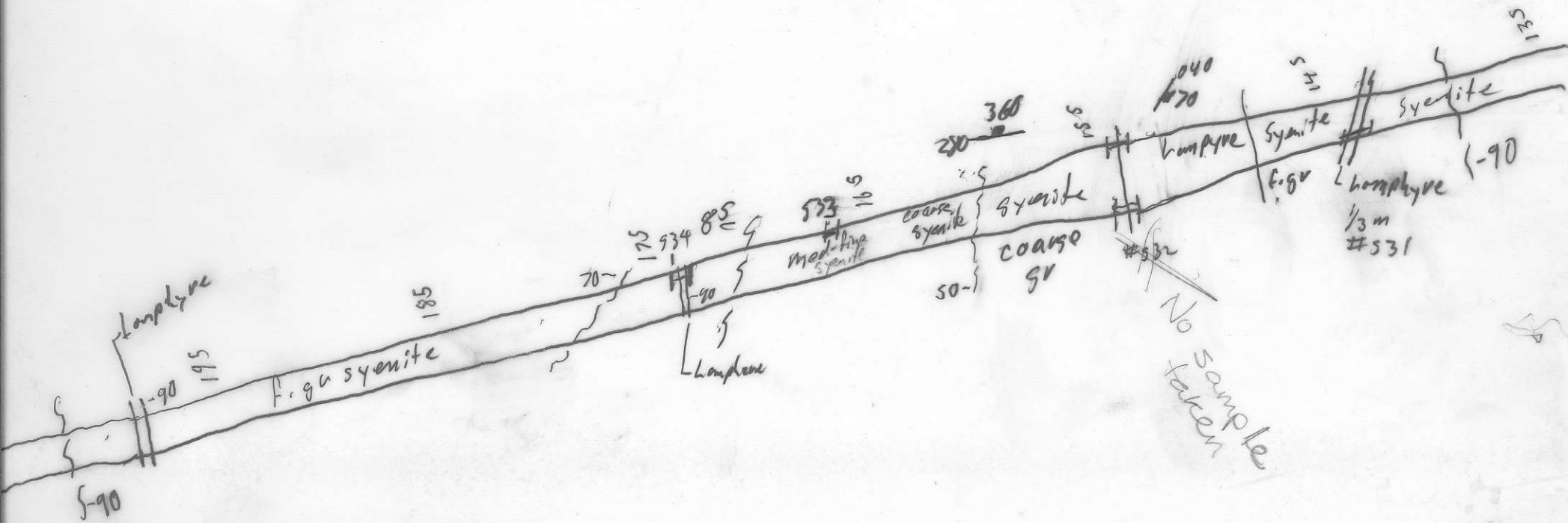



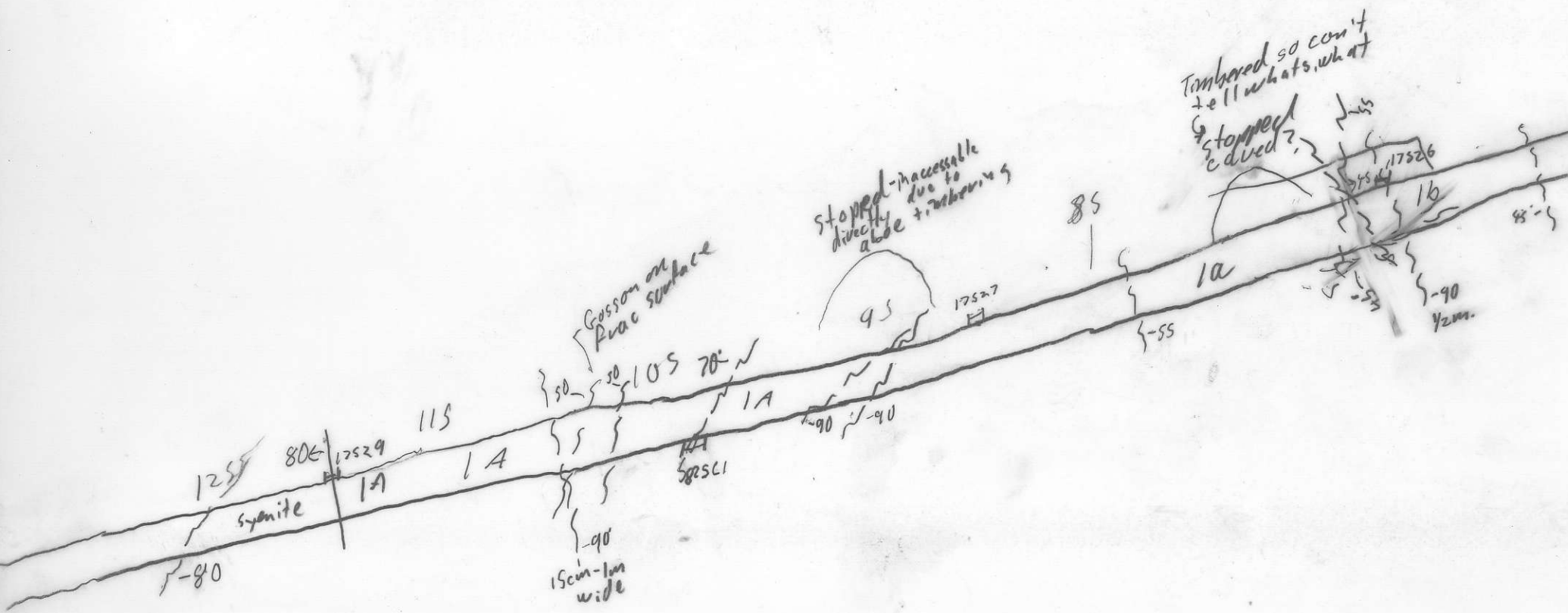

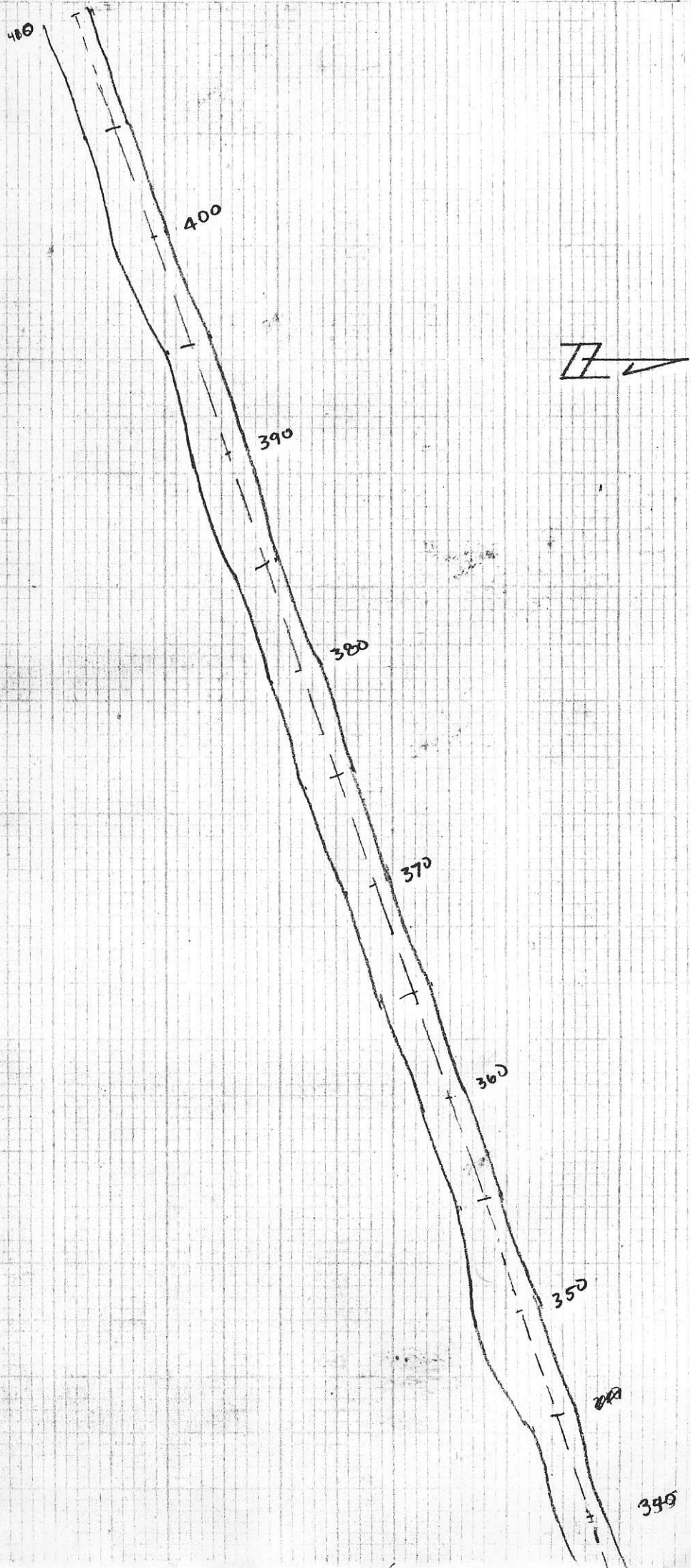

6/7



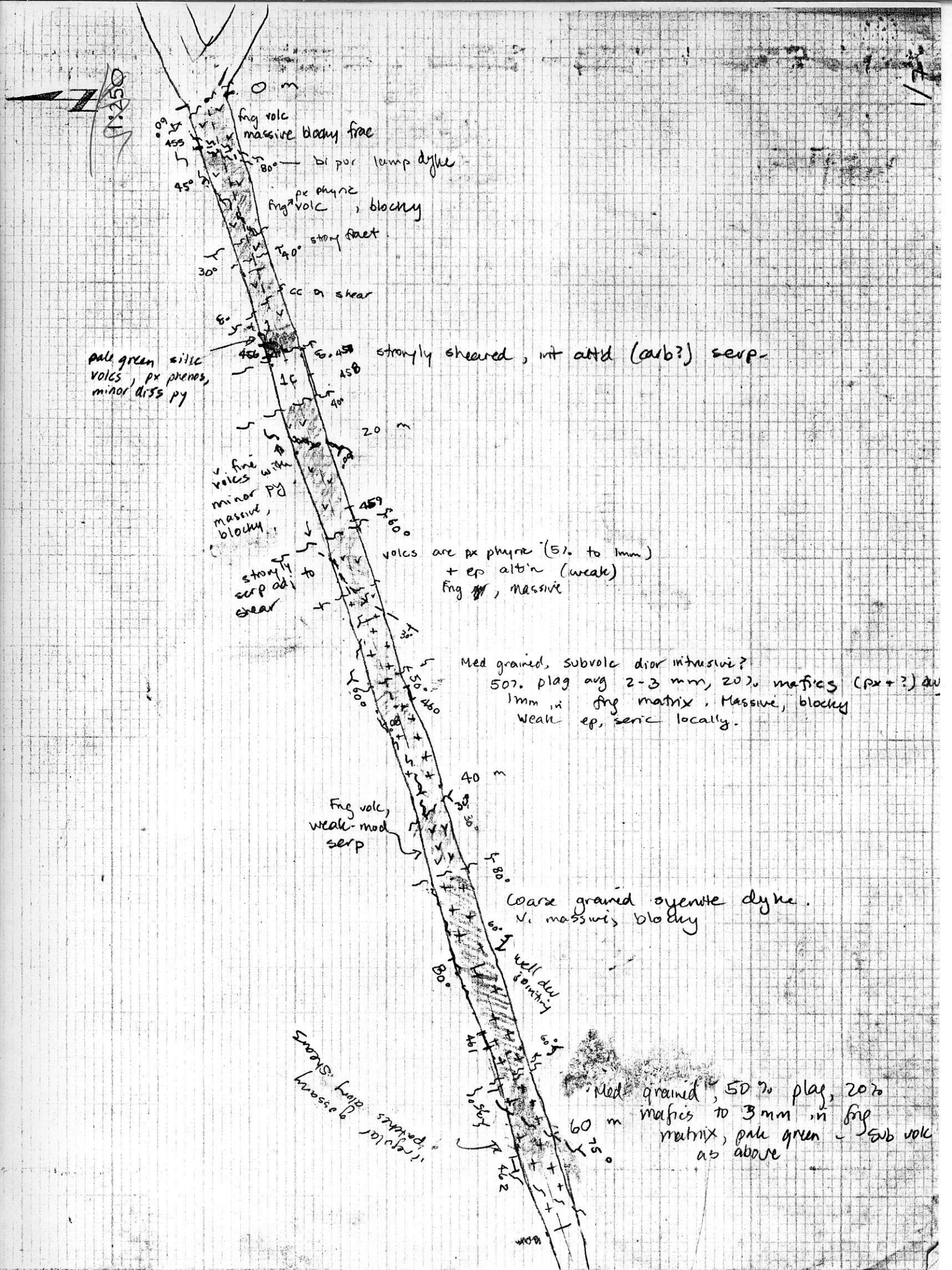

pale green silic volcs, px phenos, minor diss py

strongly sheared, int att'd (carb?) serp-

volcs are px phyre (5% to 1mm) + ep alb'n (weak) fmg, massive

Med grained, subvolc dior intrusive? 50% plag avg 2-3 mm, 20% mafics (px+?) and 1mm in fmg matrix, Massive, blocky Weak ep, seric locally.

Coarse grained oyenite dyke. v. massive blocky

Med grained, 50% plag, 20% mafics to 3mm in fmg matrix, pale green sub volc as above

1:240



v. stony jointing

335

Massive coarse pink syenite

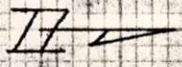

325 timbered syenite

v. stony fault zone in syenite, strongly tilted, bx, gouge

471

473

major shear zone

315 800

Coarse pink syenite well jointed

305

rusty shear

Med grained grey, fresh looking monzonite? intrusive

472

300

well devel. jointing

295

Massive, blocky (much fresher than 1217) coarse grained syenite

185

stony shearing adj to contact

285

Grey med gr monzonite intrusive, locally chrt, well sheared, sharp contact one end, grad contact other end  
?? ~~phase of syenite~~  
intrusive??  
phase of syenite

???

475

275

grad contact

180

Pink fine syenite

1/2



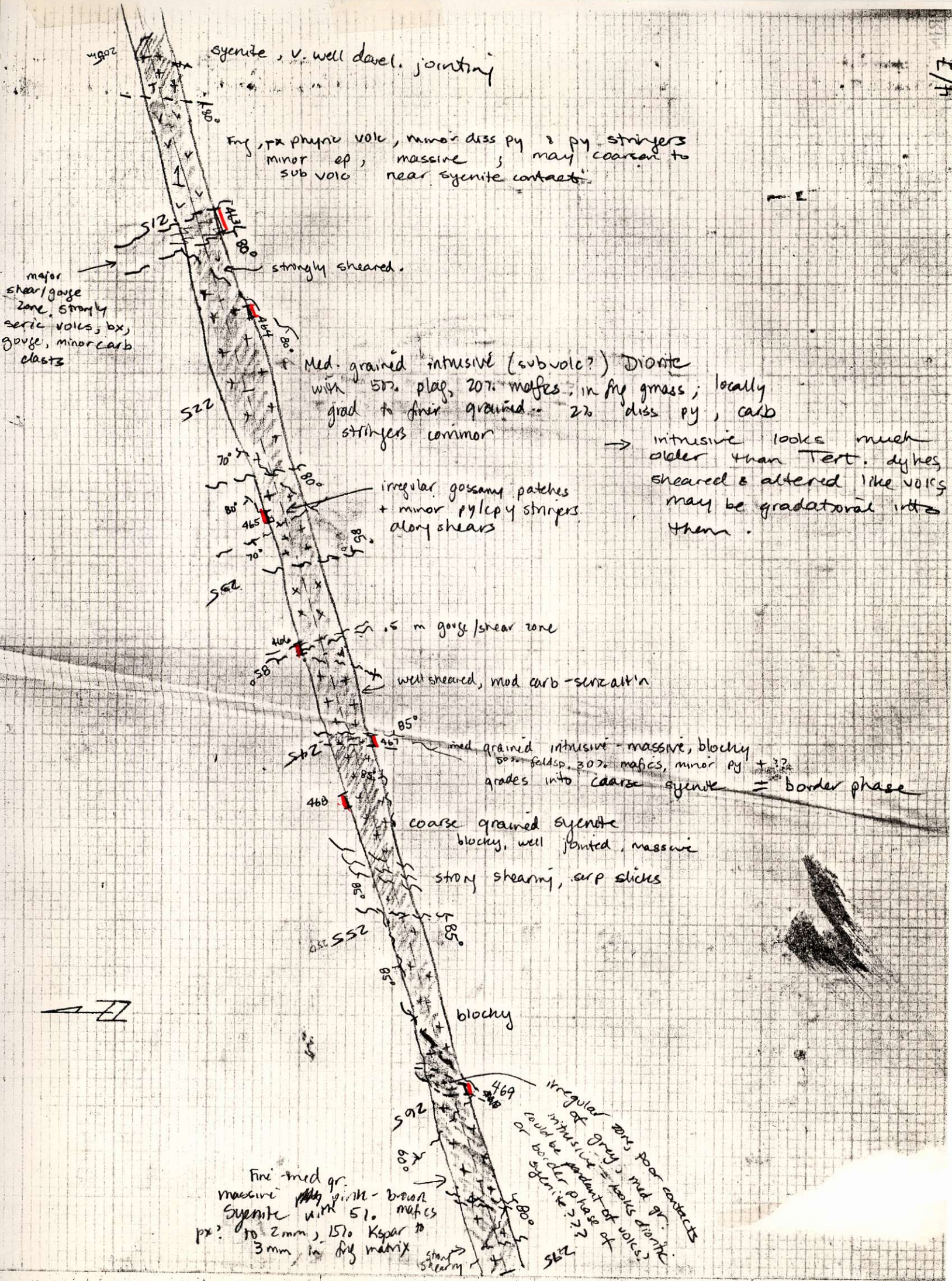

syenite, v. well devel. jointing

fgy, px phyrn volc, minor diss py & py stringers  
minor ep, massive; may coarsen to  
sub volc near syenite contact

major shear/gouge zone, strongly seric volcs, bx, gouge, minor carb clasts

strongly sheared.

Med. grained intrusive (subvolc?) Diorite  
with 50% plag, 20% mafes, in fgy mass; locally  
grad to finer grained - 2% diss py, carb  
stringers common

→ intrusive looks much older than Tert. dykes, sheared & altered like volcs, may be gradational into them.

irregular gossamy patches + minor pylepy stringers along shears

0.5 m gouge/shear zone

well sheared, mod carb-silizatt'n

med grained intrusive - massive, blocky  
50% feldsp, 30% mafes, minor py + 3%  
grades into coarse syenite = border phase

coarse grained syenite  
blocky, well jointed, massive  
strong shearing, arp slicks

blocky

irregular zone poor contacts  
intrusive - looks dioritic  
could be gradational into  
or border phase of  
syenite? 3%

fine med gr.  
massive syenite with 51% mafes  
px? to 2mm, 15 to 30 Kspar to 3mm in fgy matrix

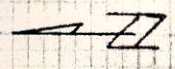







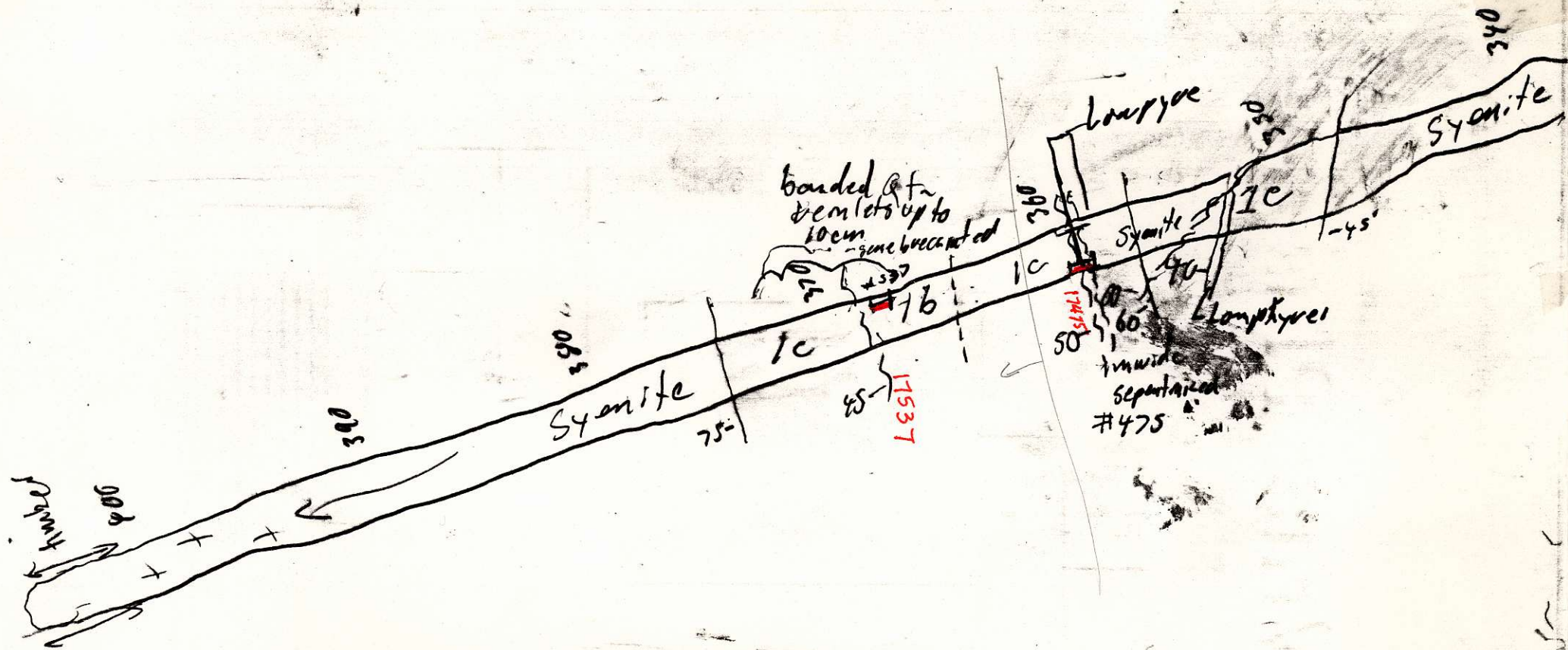



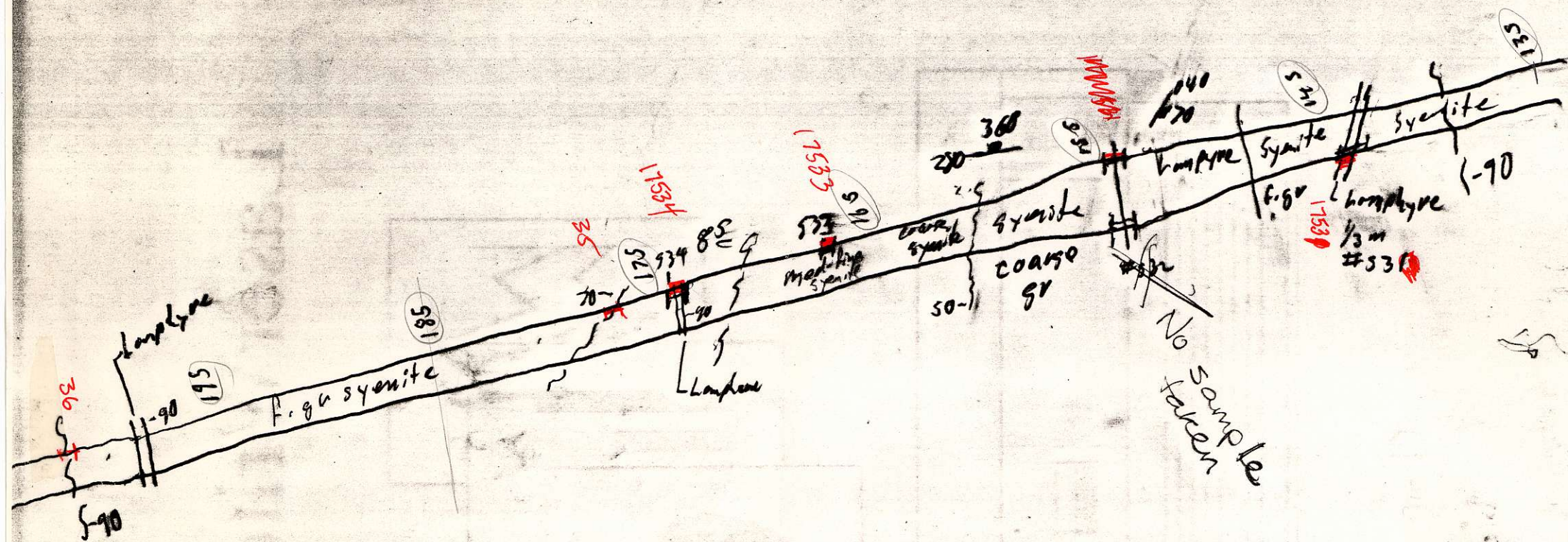

36

35

17534

17533

17532

17531

17530

195

191

175

171

165

160

155

150

145

140

135

130

125

120

115

110

105

100

95

90

85

80

75

70

65

60

55

50

45

40

35

30

25

20

15

10

5

0

-5

-10

-15

-20

-25

-30

-35

-40

-45

-50

-55

-60

-65

-70

-75

-80

-85

-90

-95

-100

No sample taken

5m

F. gr syenite

Lampyre

Med. gr syenite

COARSE gr

Syenite

COARSE gr

Lampyre

Syenite

Lampyre

Syenite

Lampyre

Syenite

Lampyre

Syenite

Lampyre

Syenite

Lampyre

Syenite

Lampyre

Syenite

Lampyre

Syenite

Lampyre

Syenite

135

130

125

120

115

110

105

100

95

90

85

80

75

70

65

60

55

50

45

40

35

30

25

20

15

10

5

0

-5

-10

-15

-20

-25

-30

-35

-40

-45

-50

-55

-60

-65

-70

-75

-80

-85

-90

-95

-100