

827842

14927

Grouse

Access: 22 km North of Westbridge, then 13 km along Grouse Creek

"Trenches" 1-4 sloughed in road cuts now obscured by talus

NNW trending, rhyodacite (?) dyke, occurs up the hill to the west + a qz-eye porphyry occurs to the SW.

underlain by highly fractured, Wallace Fm. volcanic containing diss py + po

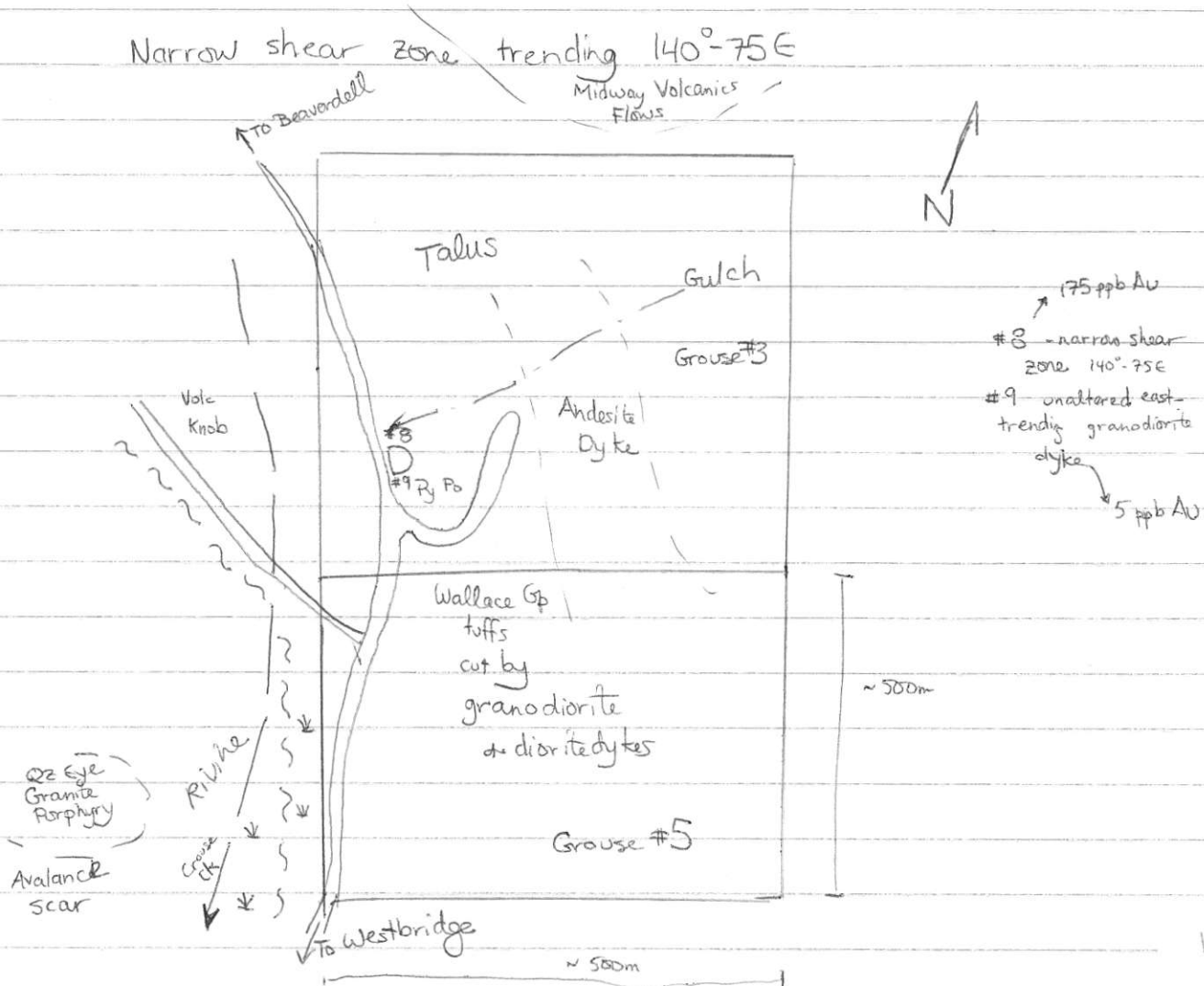

13496

BLUEJAY 1-4

access: 30 1/2 km from Westbridge, then west, 8 km from the paved rd.

network of old logging rds covers the east slope of the mountain (4x4 needed)

Previously recorded as the Rusty Claims 1-14

series of pits + shafts excavated along N30deg W strike up and down the hill from the old logging road.

fracture zone - less than a meter to not quite 2 meters wide; heavily oxidized. Dip varies between 45 degrees + 70 degrees to the southwest. Strike length ~200m

Au assays 0.02 - 1.08 oz/ton

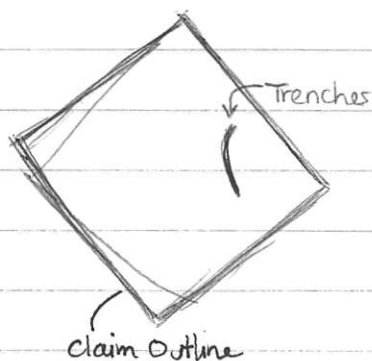

5805  
GUT (showing 9)

Geol, Geochem + Geophys 1975 (Teck)

5% o/c  
hand cut trenches

Trench T1 adjoining  
Crouse Creek

Greenstone - highly Fractured  
Grey med-grained diorite → dykes  
Tan to white rhyolite → Kettle River Fm or Lower Tertiary  
Dark grey-green Andesite } rust coloured o/c in NE of claim,  
Interbedded Black Tuffs } Phoenix Volcanic Group (Tertiary)

4 hand trenches (Map 3) adjoining Crouse Creek

Trench T1 13m 1.5 ppm Au (Granodiorite)  
Remainder → Anarchist Greenstone

Narrow Rusty Ven west of Crouse Creek ~~Hot~~ Grab samples  
→ 1.8 ppm Au, 2.5 ppm Ag

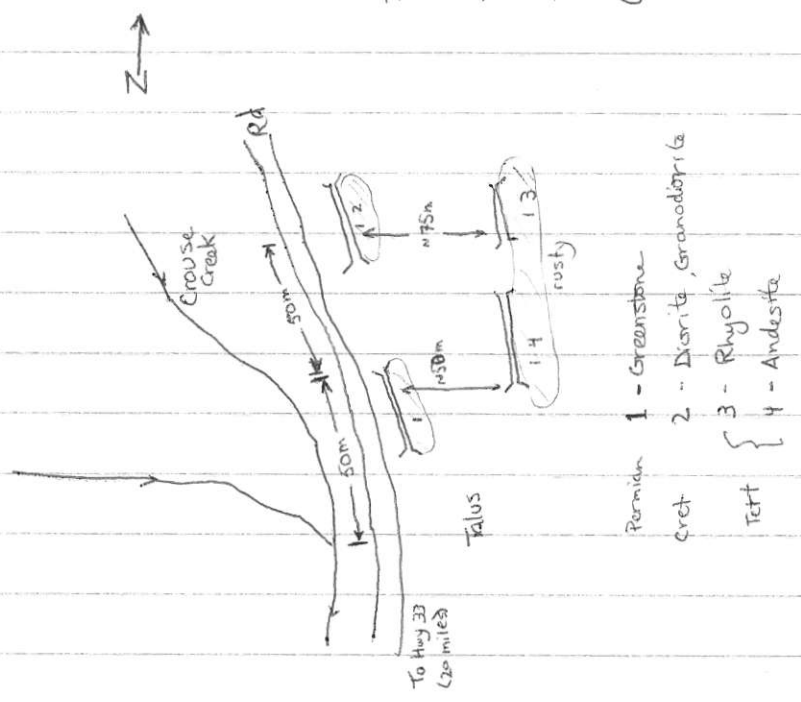

12 553  
CANN 1 CLAIM

does not mention 'Ket' or 'Lou' in report, yet Discoveries report references this assessment report.

12 558  
CANN 3

Anarchist Gp + Kettle River Fm

~~N-S trending unit of volcanic tuff-breccia underlies~~  
Anarchist andesites with tuffs  
N-S trending unit of volcanic tuff brx underlies eastern portion  
of Cann 3 claim (diss py + aspy)  
Kettle River Fm basal conglomerate

13883  
CANN 1

# Soil Geochem

Crick 1-30

1 mile south of Triple Lakes

Mineral Leases located within Crick: Houston, Superior, Jewel

Gut

~ 2 miles south of Triple Lakes

Mineral Leases fall partly on or within the Guts Claim Group:

Robin Hood, Mayflower, Lillie May, Fourth of July, Muldoon

Mineral Lease 7:30 located east of Guts claim

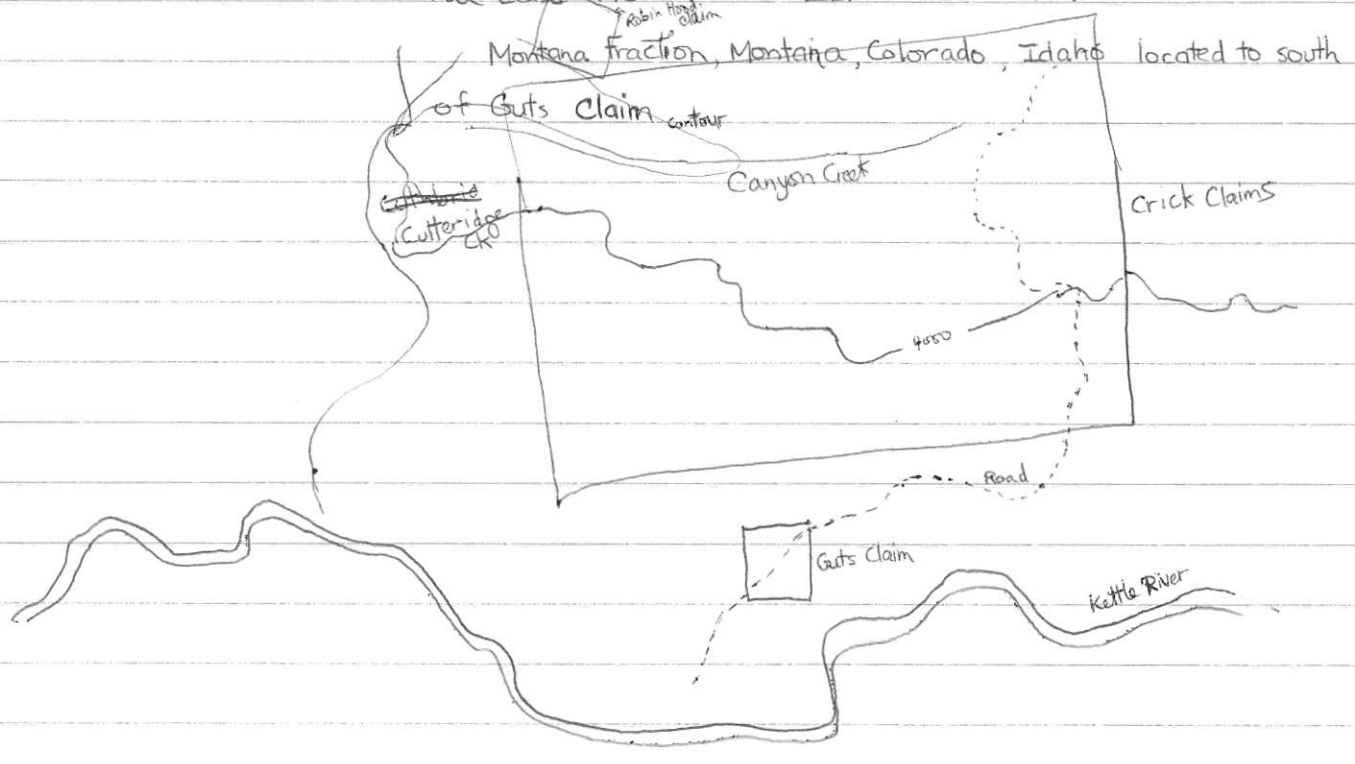

6751

Barnato Gp

Geochem, Geophys

Utopia, Hunter, Silver Dollar, Mogul, Anchor, Yorkshire Lass,  
Maine Lass, Hackla, Barnato, Silver Bell, Pambler, Champion,  
Denver, Moneter, Mountain View, Highland Mary.

15173

Montana Claim Gp

Claim Name	Lot No.	Record No	
Fourth of July	2638	4115	
Muldoon	2639	3842	Six reverted crown
Idaho	2642	3841	grants + one unit claim
Montana	2640	3840	of sixteen units
Colorado	2641	3839	
Assayer	991	3838	
Montana	16 units	4309	

Location + Access

32 km N. of Rx Creek

At km 32, Canyon Creek Rd. is taken to the claim gp. E. boundary of property ~ 1 km along this rd.

Claim location - drawn on map the 2 possibilities

Geology

Anarchist (Permian)  
 Kettle River Fm (Cenozoic)  
 Phoenix Volcanic Gp

Cret Nelson Plutonic rxs intrude Anarchist

Bluejay Claims

200m west of SW corner of Montana claims → pits + shafts, N 30° W along shear zone. Dips 45-70° to SW. 200m long shear zone. Au 0.02-1.08 g/tm Au

tunnel - black shaley fine material between two slip walks in a fine, igneous rx, mineralized with Fe Sx, irregularly distributed lenses of varying size quartz with Fe Sx, occasionally Cu-Py, Ga + Zinc-blende. (1906 Minister of Mines Report, p.1136)

⇒ on reverted Montana Crown Grant ~ 2.4 km W of Main Christian Valley - Rock Creek (Kettle River Road)

Workings located between Canyon Creek Rx + Canyon Creek  
(adits + open cuts)

From 1985:

No. 1 Tunnel: 87m N of Canyon Ck on a  
35-45° southwest slope is 2 m long in a 320° dir. 2m  
long.

Oxidized zone with malachite, azurite, pyrite, galena +  
zinc blende. Mineraliz. in 0.5m wide qz vein, striking  
310-320°, dipping 70° NE. Vein traced on surface of qz  
at 310°.

0.022 oz/ton Au, 11.73 oz/ton Ag, 1.76% Pb, 5.62% Cu;  
from dump

No. 2 Tunnel:

25m NW of Tunnel 1, at 360° crosscutting vein  
tunnel partially caved

vein at portal strikes 315°, dips 90°, up to 0.8m thick  
Qz, carbonate mineralized with py + malachite

Grab sample of vein: 5.08 oz/ton Ag, 0.34 oz/ton Au

Cut No. 1

15m at 310° from tunnel No. 2

0.3m qz vein brecciated, py, wk oxid.

Grab Sample 2.03% Cu, 1.26 oz/ton Ag, 0.004 oz/ton Au

Cut No. 2

25m at 25° from cut No. 1

heavily oxid. 1m wide qz veins with malachite stain

Rd cut NW of cut<sup>No.</sup> 2, fg. acid ig rx, contains lenses  
of highly oxid. material → 227 ppm Cu, 90 ppm Zn, 45 ppm Pb, + 39  
ppm Ag

Grab sample of Dacitic Float near cut No. 2 → 140 ppm Cu, 225  
ppm Zn, 0.4 ppm Ag



Adit Zone

dump estimated could have been extracted from a 70' tunnel  
 supposed to be 10m W of Cut No. 1

dump contains qz-carb with variable py-mineralization  
 Sample → 0.620 oz/ton Au

adit inaccessible due to sloughing

Pit 15m NE of adit → mineralized qz → 1310 ppb Au

Trend ?

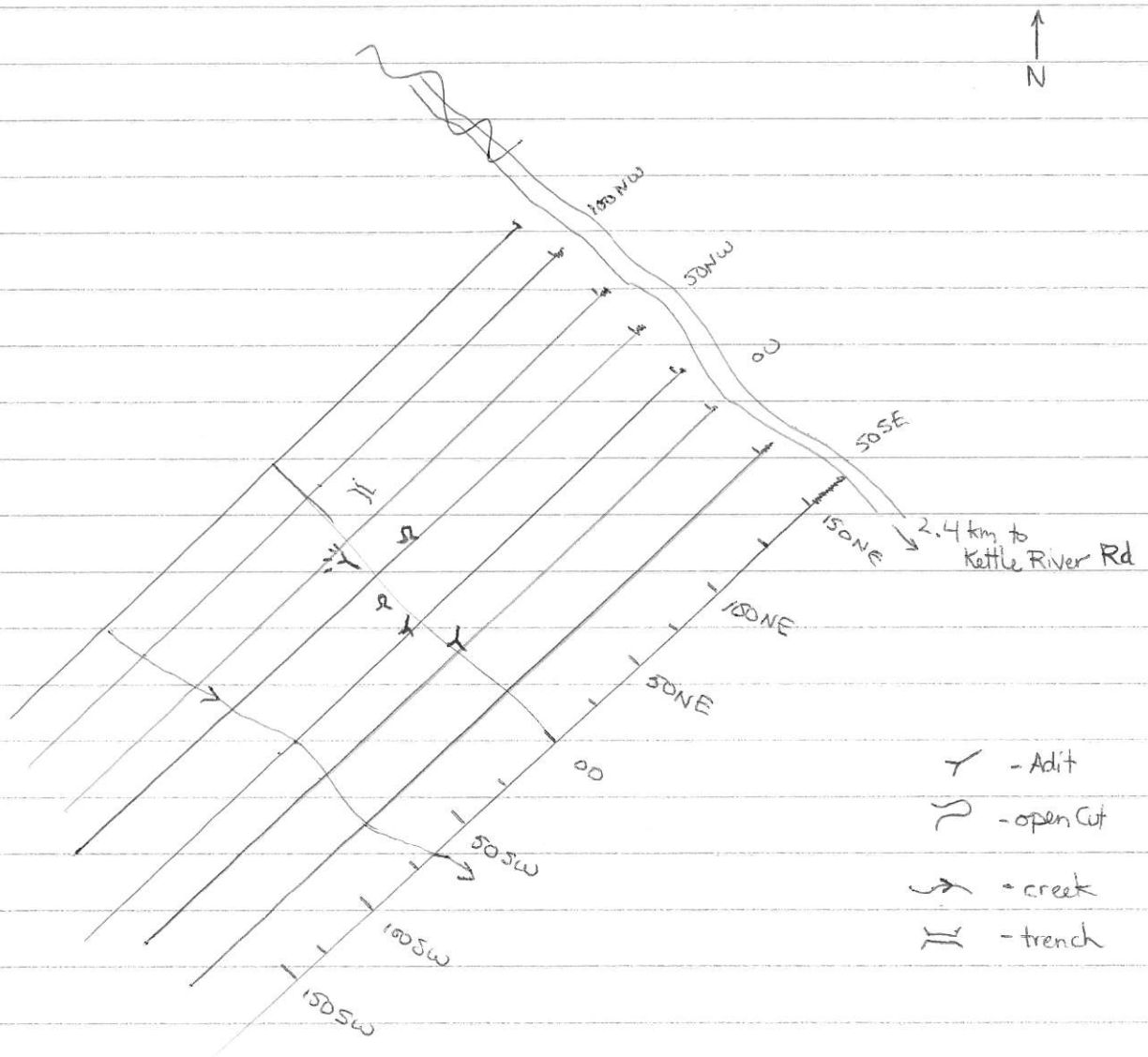

14952

BARNATO CLAIM GP

## Percussion Drilling

202.4m percussion drilling

Access steep logging rd which branches off main Kettle River Rd,  
 31 km North of Westbridge, then west on a logging rd for 8.4 km. Other  
 alternative logging rds can access property from various locations -  
 Creeks on property: Stewartson<sup>creek</sup>, Grick<sup>creek</sup> + Triple Lake

## Claims:

Name	Units	C.G. No.	Record No
Silver Dollar	1	2864	1582
Rambler	1	2842	3
Hunter	1	2861	4
Barnato Fr	1	2865	5
Hackla	1	2849	6
Anchor	1	2866	7
Denver	1	2862	1588
Champion	1	2863	9
Utopia	1	2860	8
Miner	1	2858	91
Yorkshire Lass	1	3024	92
Silver Bell	1	2644	93
Barnato	1	2848	1594
Kaffir King	1	2646	<del>15</del> 95
Coin Fr	1	6155	<del>2444</del>
OK	1	5735	<del>1596</del>
Kingston Fr	1	2839	<del>1822</del>
North Star	1	2837	1823
Caledonia	1	2836	1824

Houston	1	2302	1825
Boston	1	2845	1828
Ivanhoe	1	5745	1829
Mona	1	2841	1830
Kingston	1	2300	1831
Mexico	1	2867	1832
Boston	1	2301	1833
Highland Mary	1	1462	1835
Coin Fr	1	1459	1836
Montana Fr	1	2645	1837
Kettle #1	20		
Kettle #2	20		

1937-1938 - 5 cars of sorted ore

two cars avg 84.9 tons, grading 1.58 oz/ton Au,  
0.23 oz/ton Ag, 10.17% AS

1938 - Cominco drilling → 10 veins, continuous, narrow, low grade

1965 - minor surface trenching (Amcana Gold Mines)

21 tons shipped to Tacoma

1966 - 4 drill holes, trenching

1978 - soil sampling, VLF-EM Mag survey

1981 - soil sampling, trenching, recce mapping, prospecting

West Kettle Stock - qz diorite, granodiorite - mafic rich to poor, med to coarse grained, locally porphyritic (north part of grid)

Volcanic Unit - fine to massive, felsic to mafic rhyolite to andesite → mineralization disseminated within

Calcareous Unit - light grey, f.g. - m.g., fine, diss. py, found within the volcanic

Porphyritic Dyke unit - med - coarse grained, lt. to dark green,

porphyritic with 10-20% orthoclase phenocrysts + 15% f.g. mafic  
↳ few mm to 5mm

Mineralization in qz diorite + adjacent volcanic rx's along contact  
Diss. + vein structures of py, tr po, cpy in widely distributed  
zones within the above unit (qz dior + volc rx's).

Two types mineralization:

1. assoc. w Nelson intrusives, consists of py, tr po, magnetite + cpy in fracs or periphery to intrusive → probably similar to a porphyry-type mineralization
2. in volcanic unit, mainly within a more calcareous unit of the volcanic assemblages.

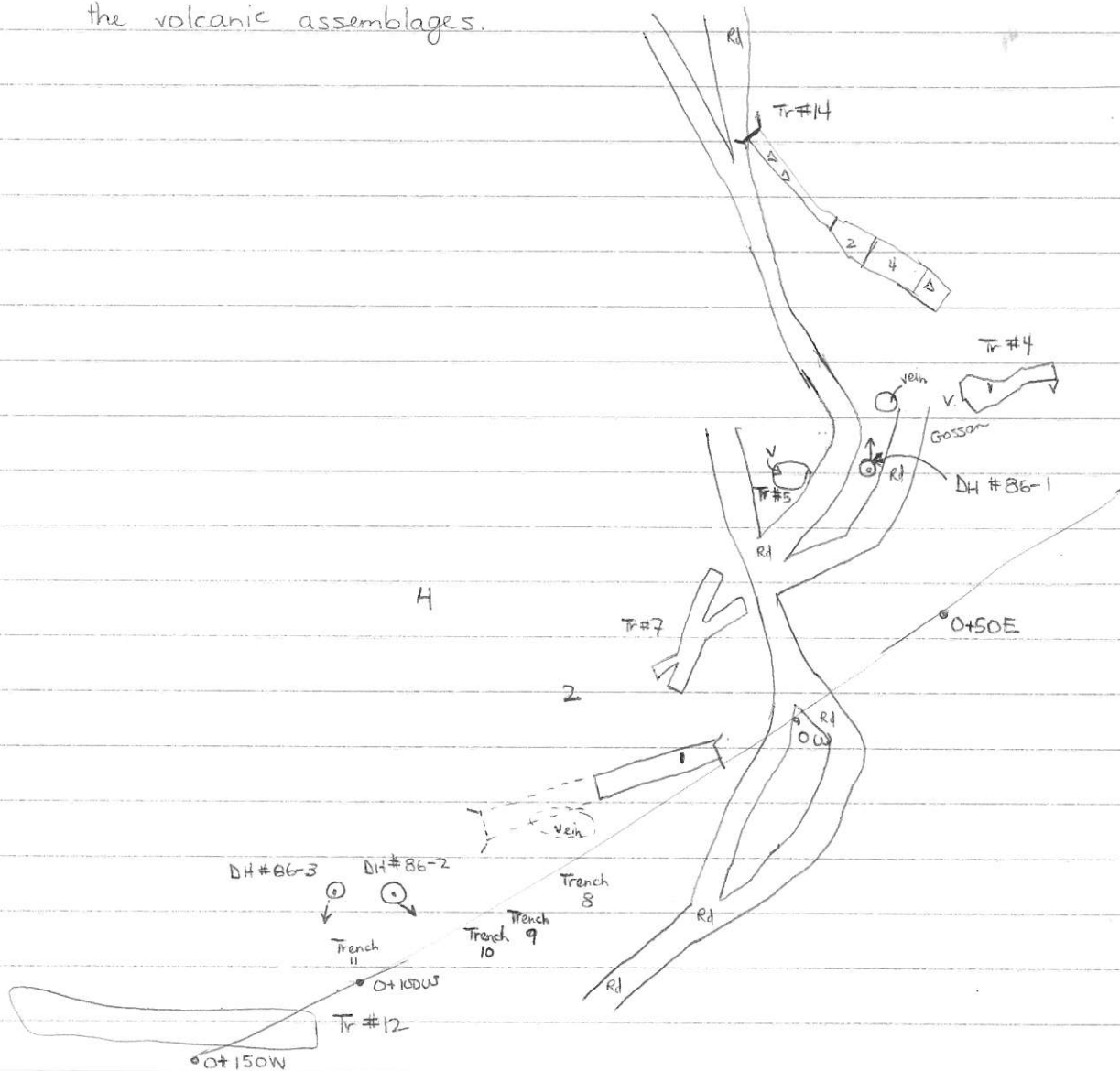

14952 cont cont  
cont

- 1 - Qz Dior
- 2 - Rhyolite
- 3 - Calcareous - Andesite
- 4 - Porphyritic Dykes

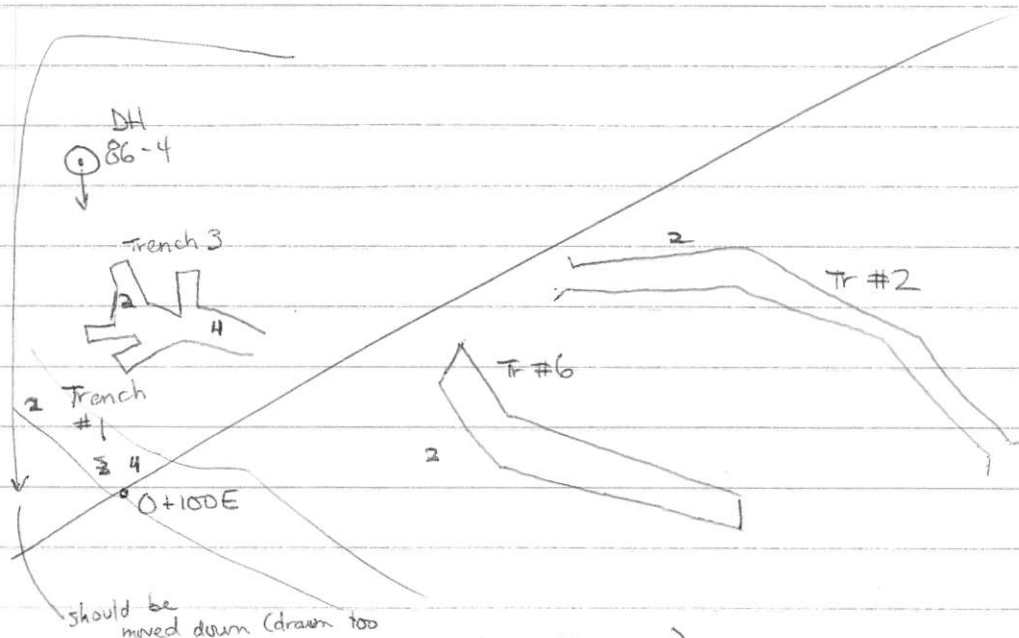

should be moved down (drawn too large compared to left page)

~~Page 3~~ Trench 3 should be at same level as trench 4