

plotted
 L115W, 114W
 Lara Property
 827447
 Field Sheets
 1989
 by: GSW

L116, 104+03.5 at Az of 308°
 48 m to L70W, = sample L893005.
 101 m to L115W, 103+90N.

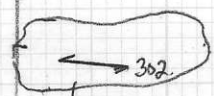

fg. FTuff.
 weak fol. - good lineation.

sub o/c.
 + rubble/
 frost heave.

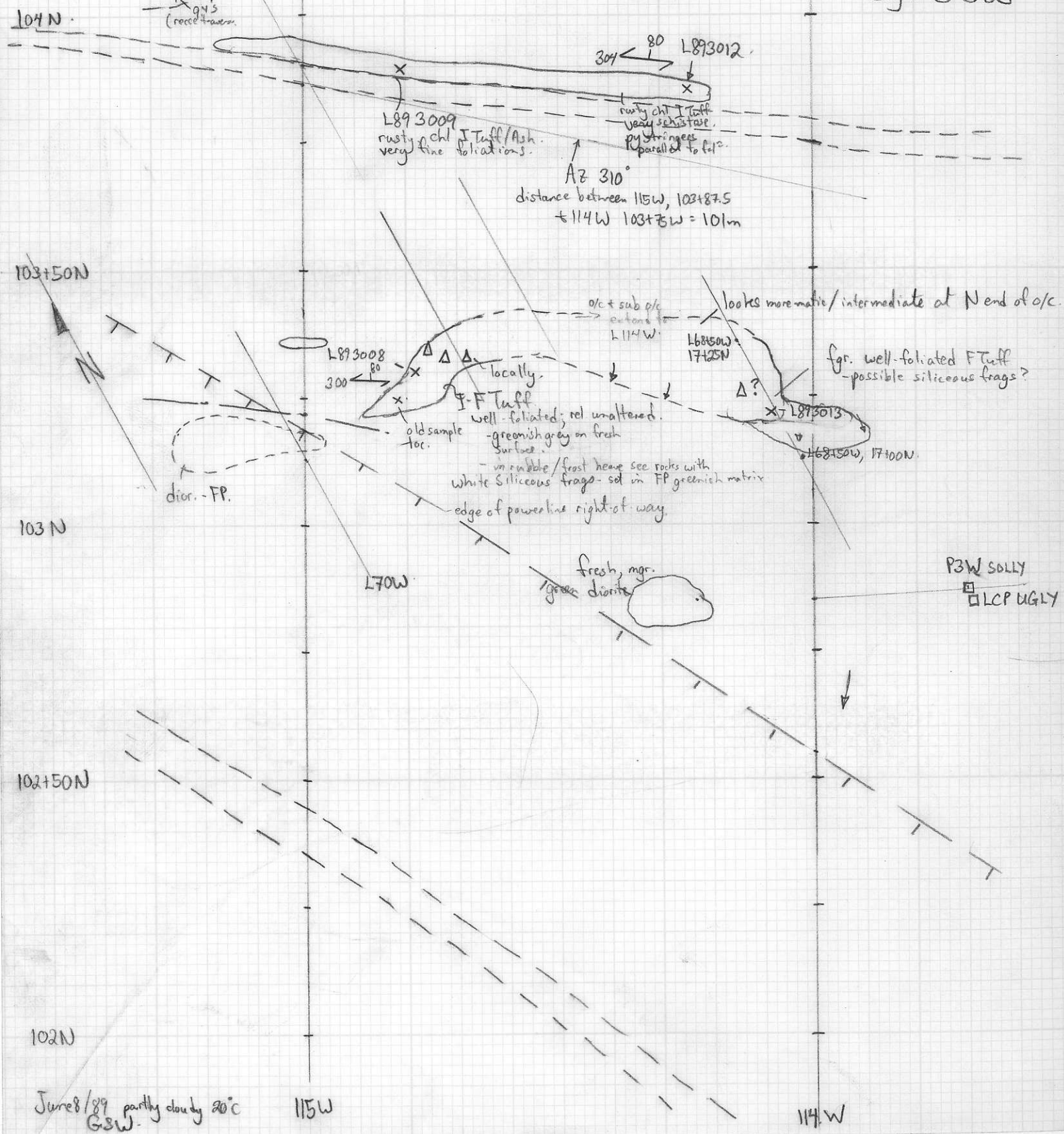

June 8/89 partly cloudy 20°C
 GSW.

plotted.

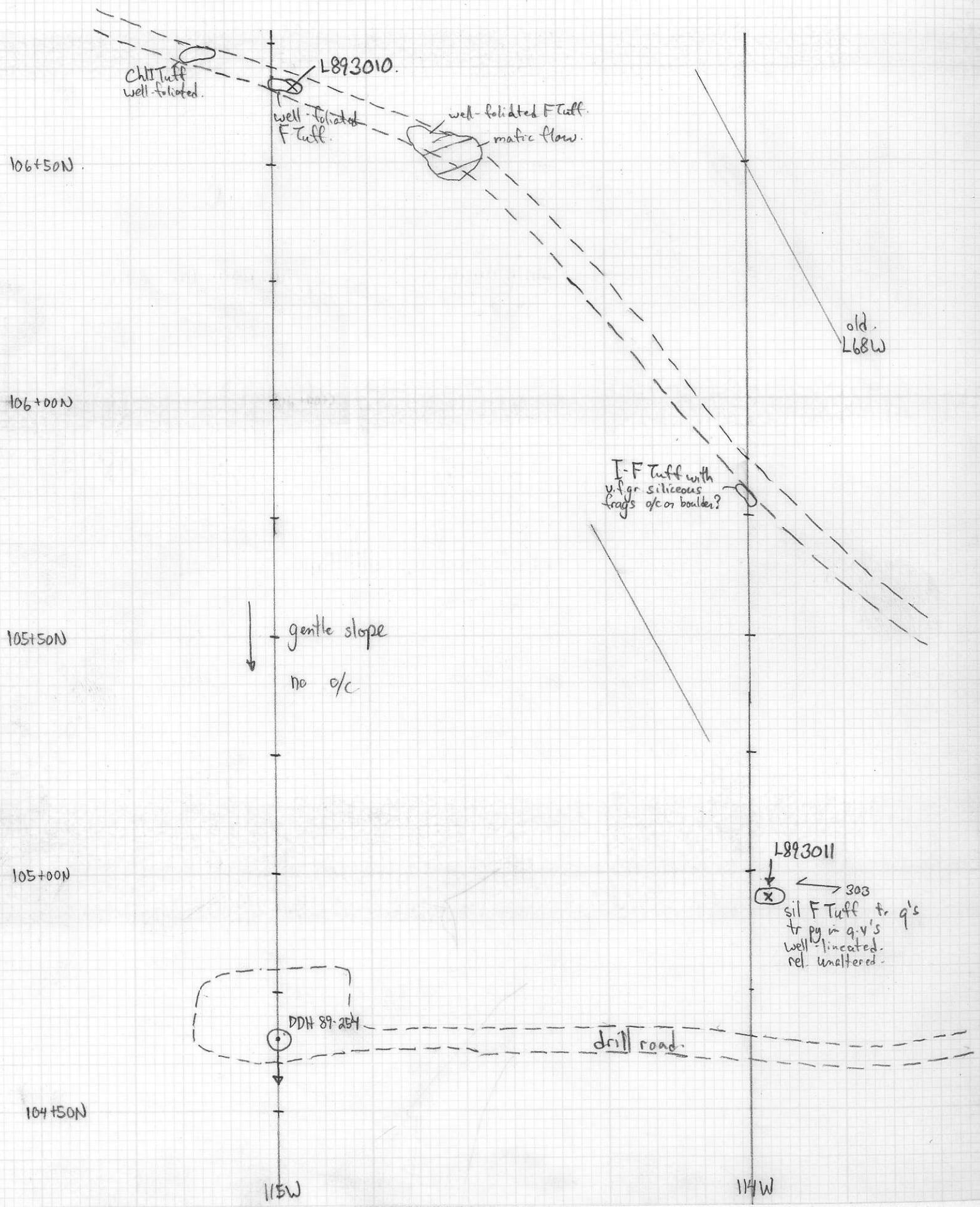

plotted

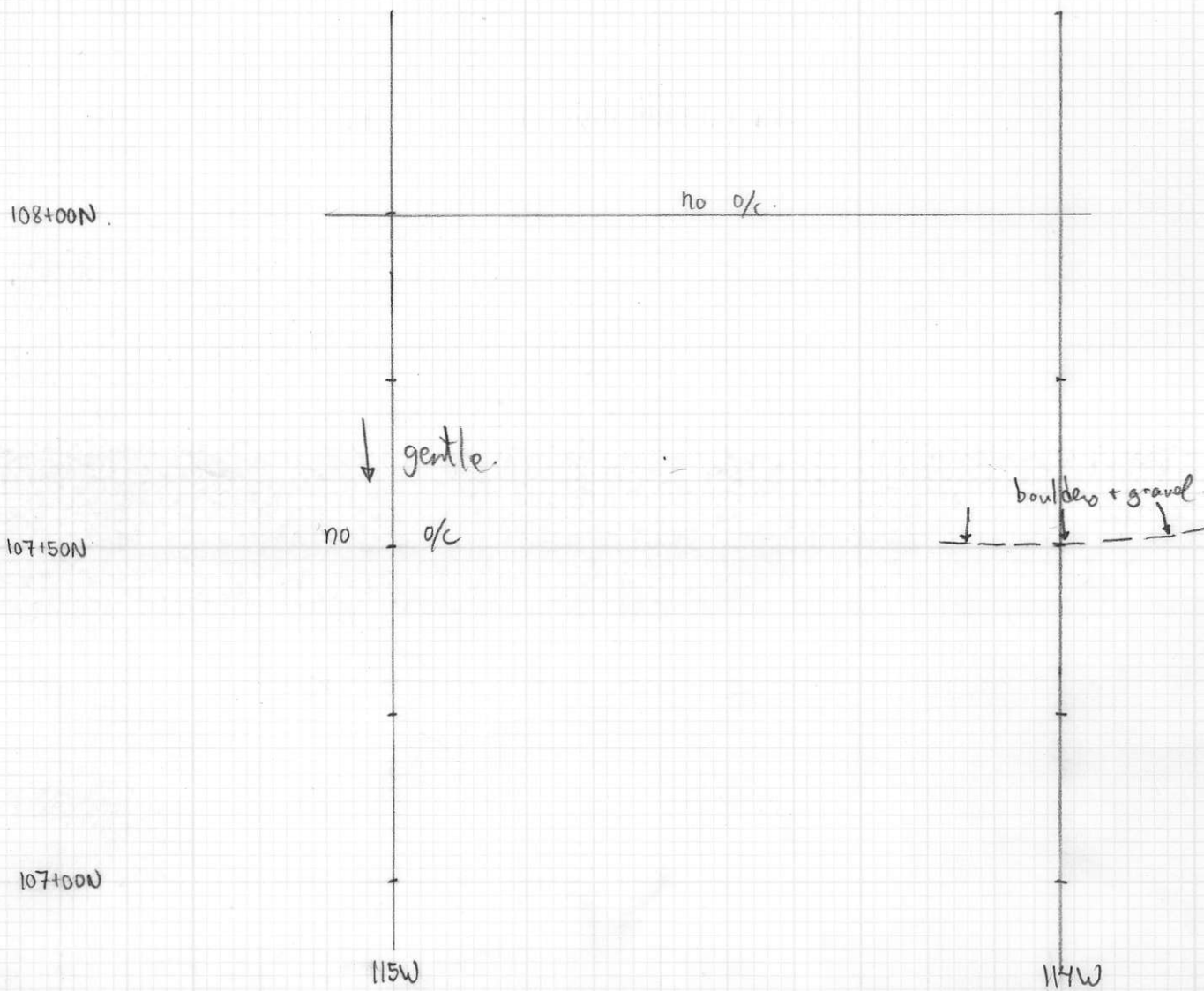

plotted
L117W, 116W

102 N

↓ moderate slope.

- Line parallel
to 117 ≈ 10m E
- no pickets.

no o/c
gentle ↓

no o/c.

101 N

open
gentle ↓
no o/c.

L117W

BL100N - no pickets
- put flags at 25 m intervals

116W

BL100N

GSW June 7/89
CAUL 20°C
1:1000. Lara property.

plotted.

no o/c.

100m to junction from
112m to L118W 104+39N.
from L117W 104+20N at Az of 312° to L116W 104N.
distance = 102m.

104 N
FP crystal tuff - rel
unattered
L893001.

65
284

L71W 20+00N.

on road L117W & 116W are 115m
apart by paving.

F Tuff/Ash
v. fol. foliated
W-Mse, rusty.

104N
L83005
x

v. fol. chltuff/Ash.
locally rusty - similar that
80 seen in 89-284

306

Main Rd.

Well foliated F Tuff
M-se, rusty & carb? no sulphid
L893006.

rubble
diarite, FP
fresh.
F Tuff W-Mse
well-foliated.

finely foliated F Tuff
with v. fine siliceous frags.

F Tuff - ser + rusty
with FP crystal
tuff beds/layers.

80
282

m-egr dia.

powerline
right of way.

BL 103N

good road.

Spaced

no o/c.

102+35N

102N

117W

116W

June 7/89 GSW

plotted

sub o/c - rubble -
W-M ser. F Tuff. well-foliated.
-tr. q's greenish gray
in color

old skidder road

106+50N

old skidder road

open

gently

dense bush

106+00N

106+00N

abundant old dead fall

105+50N

abundant old dead fall

gentle
dense bush

gentle

no visible o/c

70W
20750W

L89300W - W ser.
f's not as noticeable
at this end of o/c.

FP lap Tuff
white + greenish
white streaked
frags in FP
matrix 10% mm
sized fr.
-well foliated.

moderate slope

105+00N

105+00N



moderate to steep slope

170W

104+50N

June 7/89 CAU4
GSW

117W

116W

230
 5840
 460
 150

1:1000
 to
 1:2500



~~Twice~~ Twice @ 35°
 once @ 5°

East Field
 Grid.

Need to plot web to 250

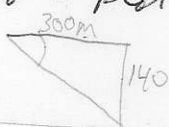

$\tan \alpha = \frac{140}{300}$

580
 440
 140

plotted.

108N

see greyed Tuff well plotted.

truck rd.

M-S ser OP Tuff
2-3' q's
white carbalt

80

304

288

L893003.

greenish look due to ser? on chl.

well fol F Tuff see K. Glover's recec traverse.

66'

308

107150N

L893002

fg. F Tuff / Ash
+ 12' q's
M-S ser
strong fol 308/66

old line 70W, 23N.
approx pos

old skidder rd.

skidder rd.

107N

117W

116W

plotted

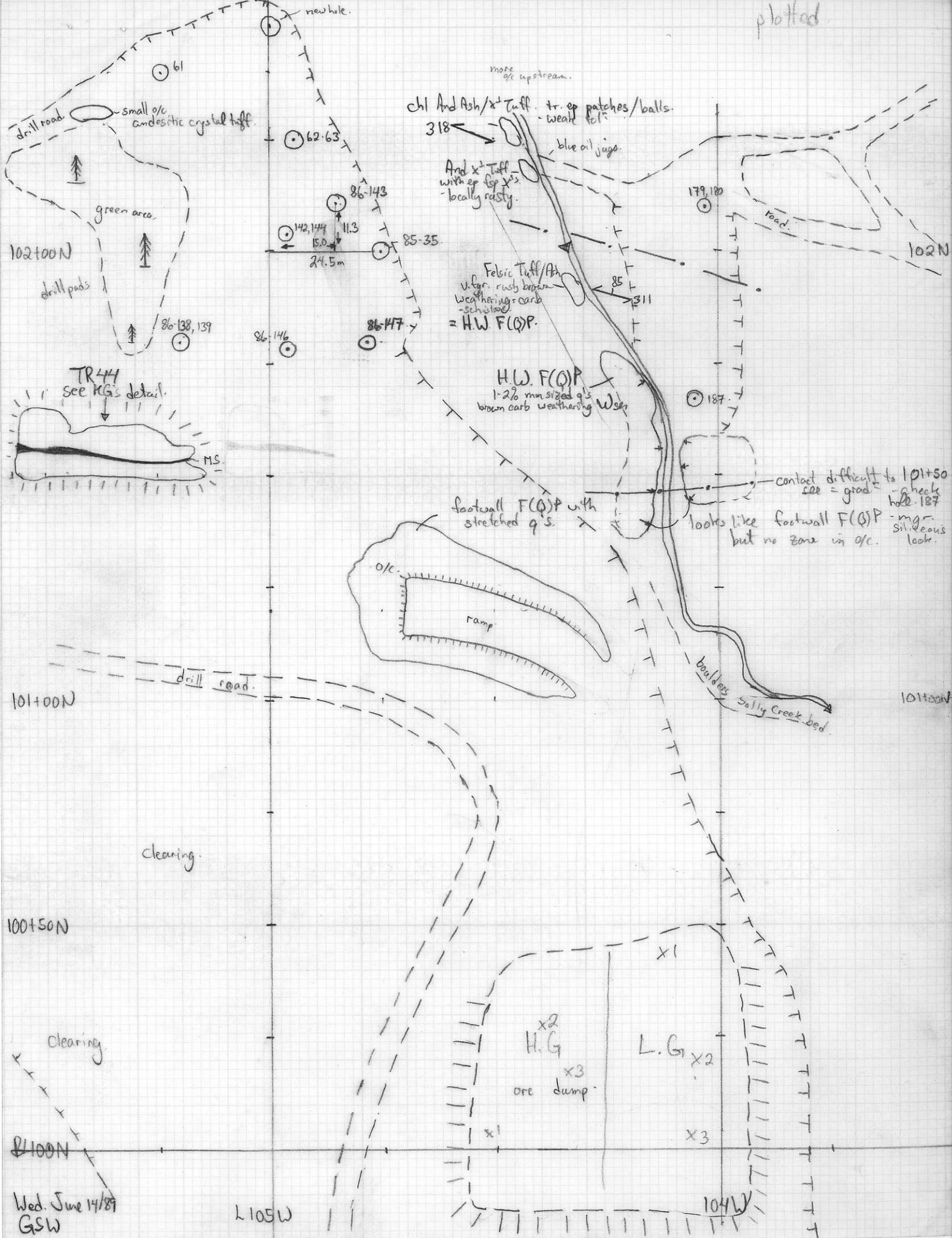

Wed. June 14/89
GSW

L105W

104W

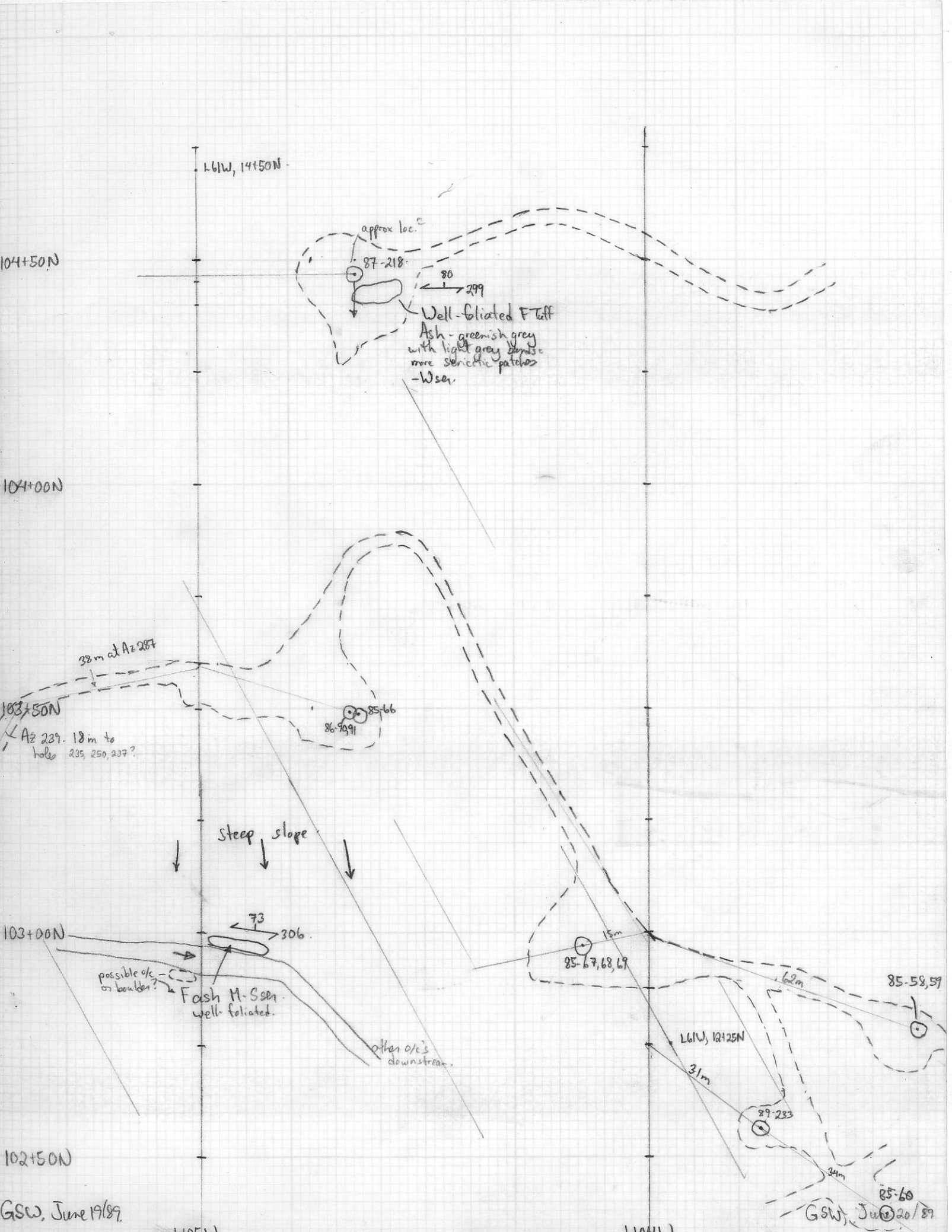

GSW, June 19/89

GSW, Jun 20/89

107 N
 sample of rusty deg. in float.
 L893020 - rusty Ftuff 5% py. weakly foliated And.
 - hard to define contacts check hole 219. on L104W
 L893019 andesite x Ftuff o/c + sub o/c.
 L893017 - fgr. Ftuff Wep. very siliceous.
 locally have rusty patches with 5% v. gr. disc. py.
 proposed drill site.

106+50N

L60W, 1600N.

gentle.

no o/c

L60W

106N

gentle slope
no o/c

105+50N

105N

GSW June 19/89

105W

104W.

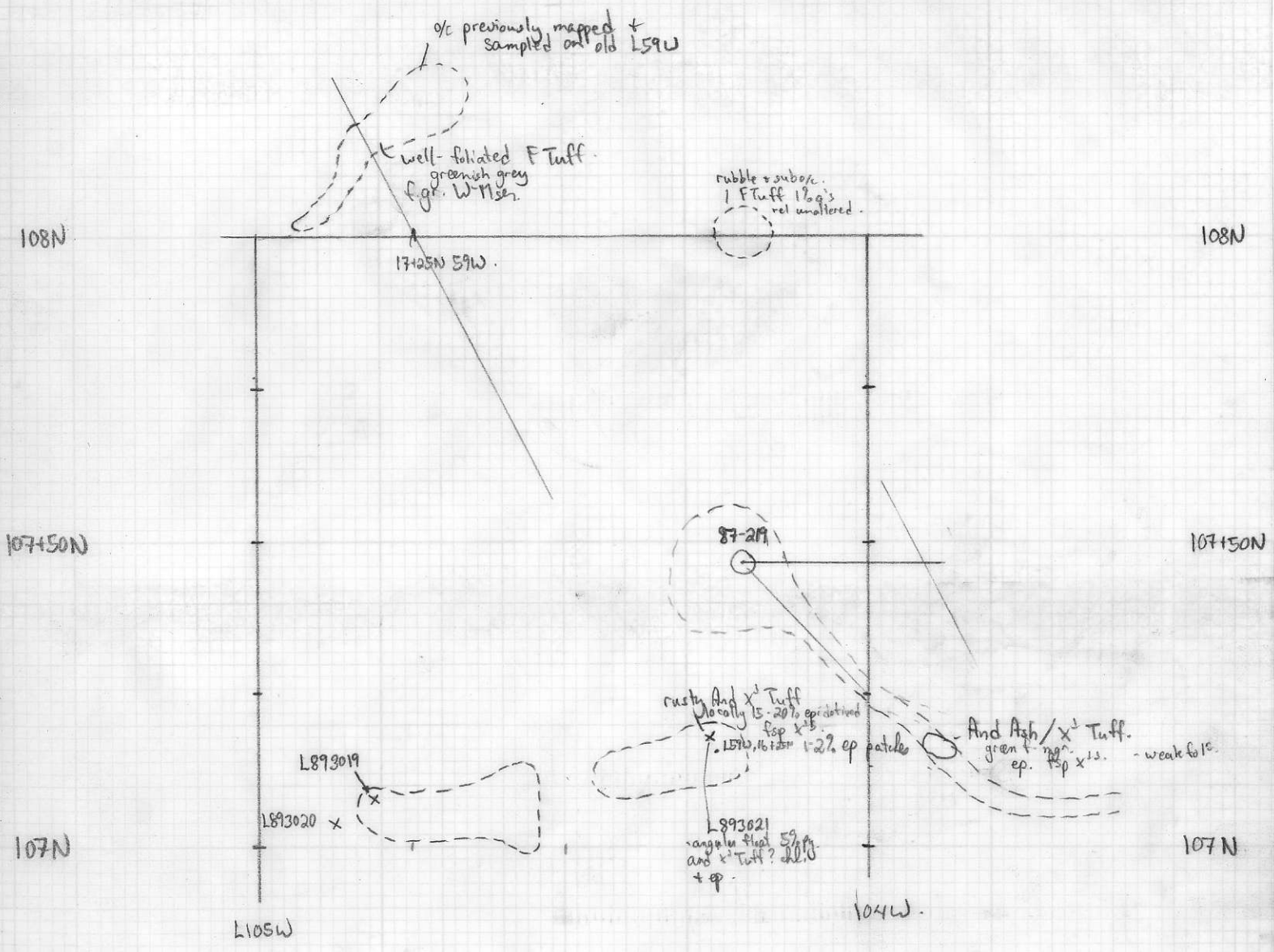

L113, 112W.
plotted.

106N.

105+50N

105N

105N

104+50N

104N

104N

June 9/89

113W

112W

June 14/89

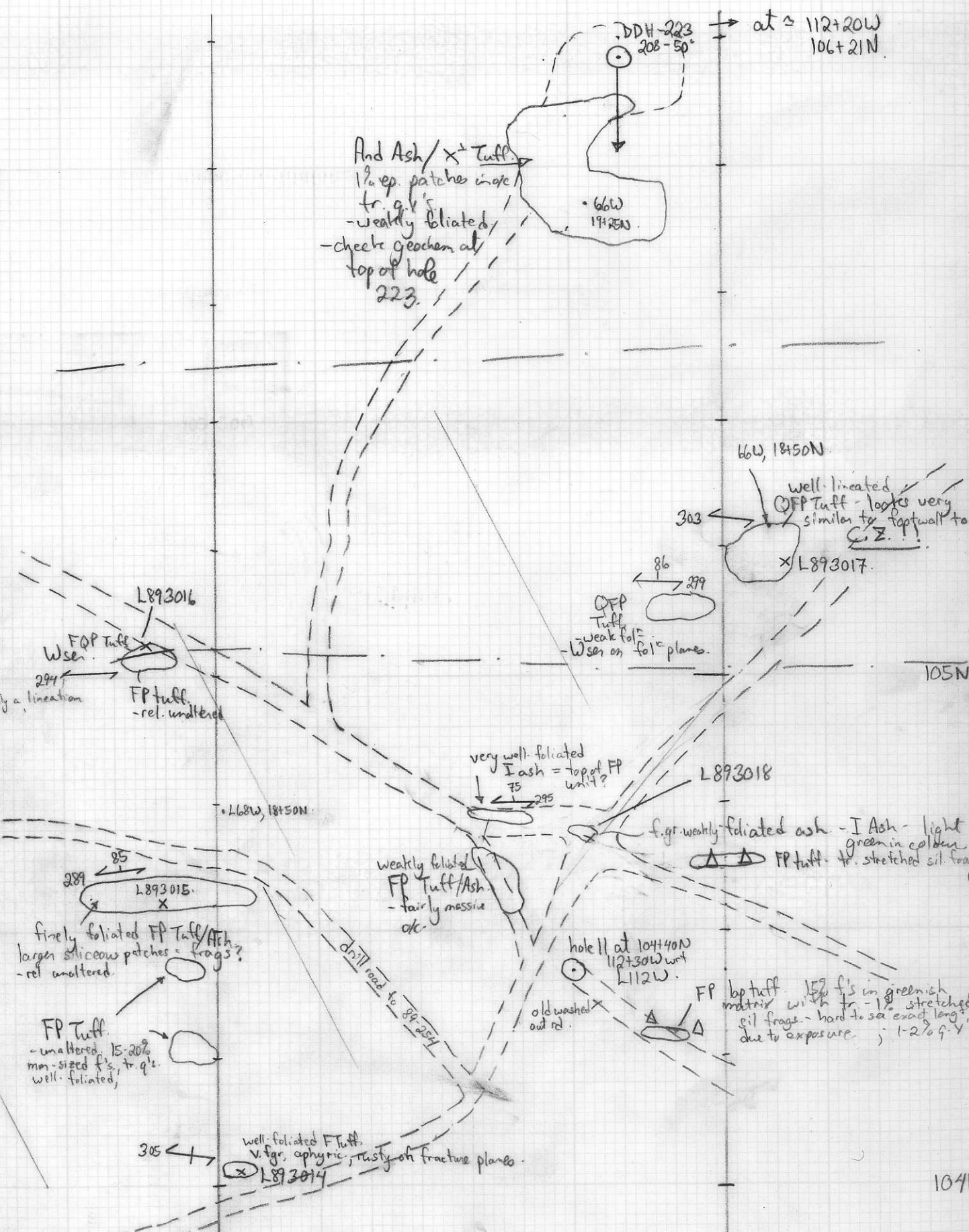

plotted

BDH 232
Pt. 96 at 99W 102+37.5m

57W 9425N.

102 N.

old line.

101+50N

101+00N

100+50N

B1100W

GSW JUNE 20/89 CAUV 18°C

L99W

L98W

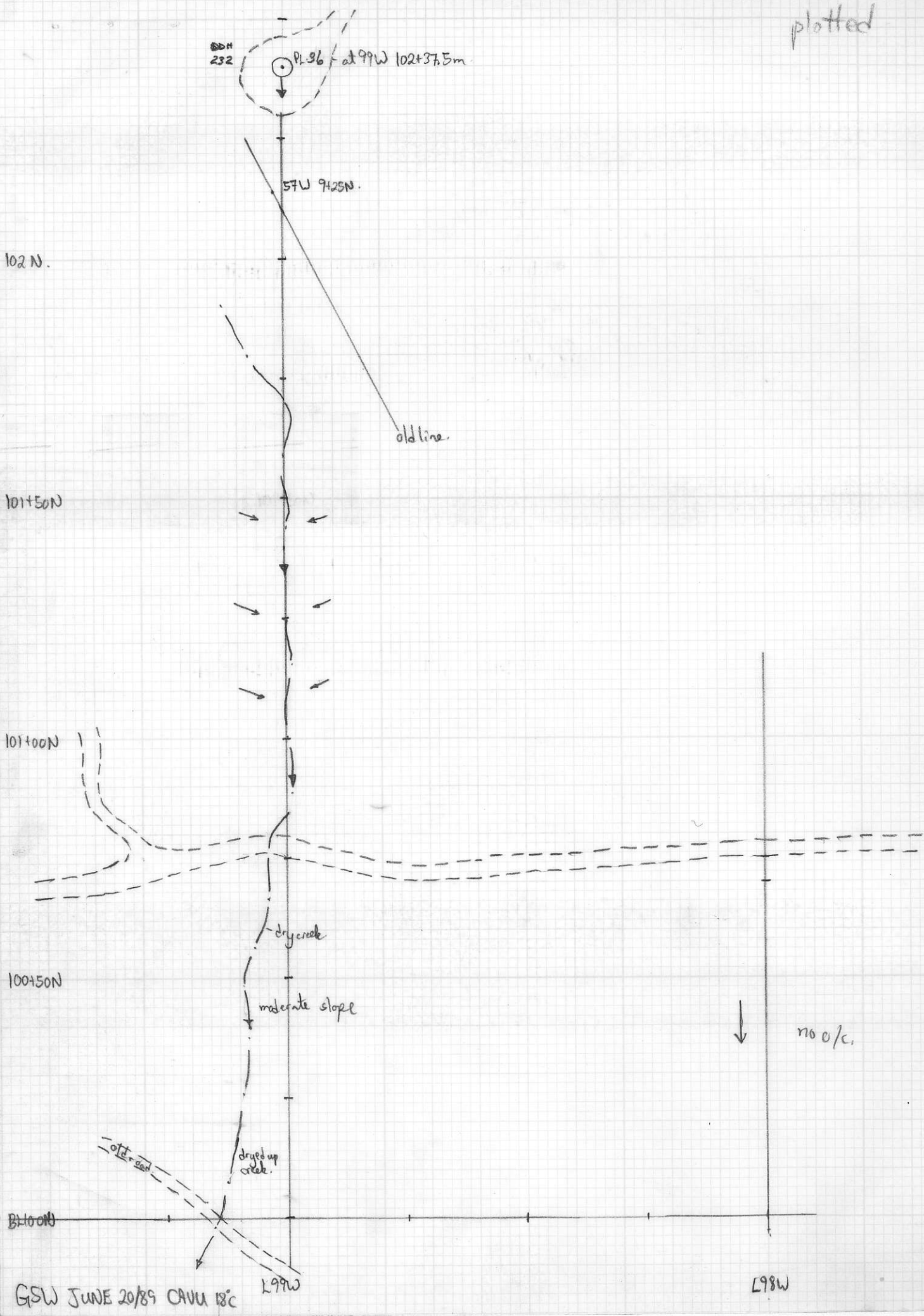

10m to E of 108N, 99N have
L99W N-S line = L54? = CL.

* L98W does not go
to 108N!
+ BL 108N ends at 99N.

• FL line 50, 2+20S.

no o/c.

107N

106+50N

L55U, 13+00N.

106N

-old line.

angular float
for Flash - rel. unaltered
to W ser.

105+50N

L55 11+50N.

105N

GSW JUNE 20/89

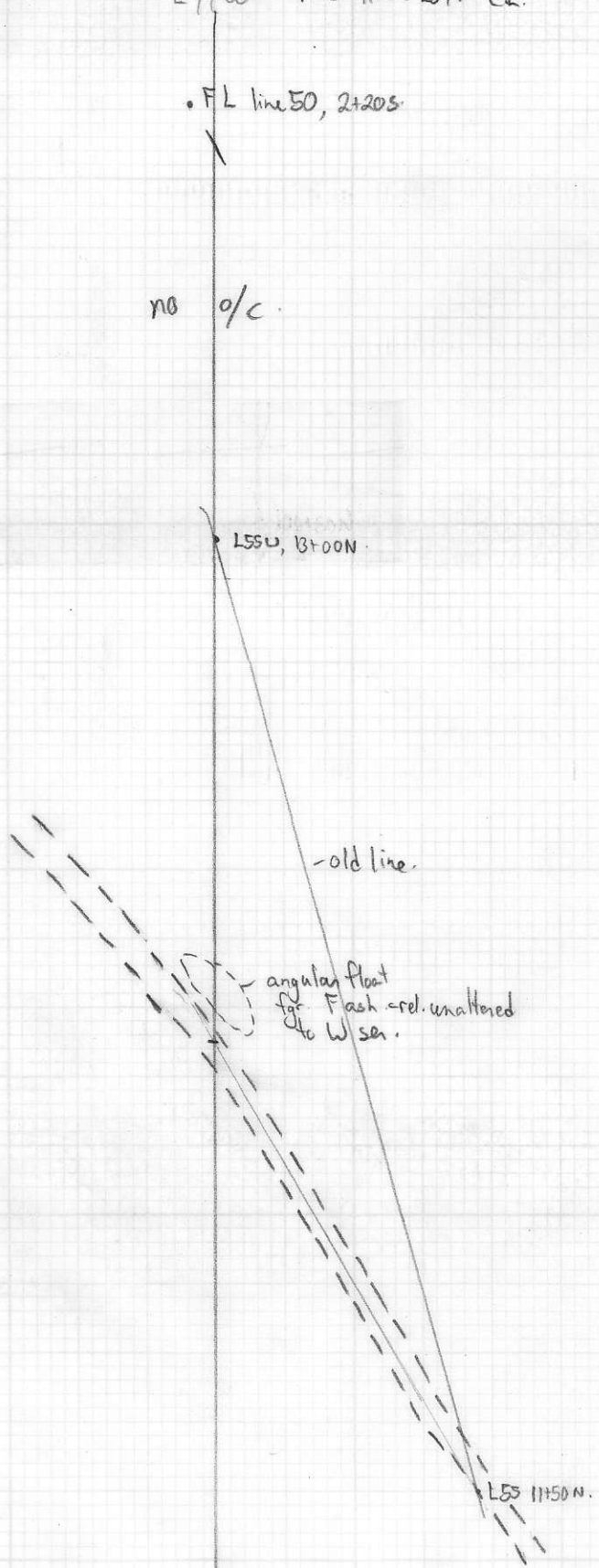

L99W

104+50N

156W, 1100N = mega line.

104N

old line.

LCP JENNIE

f. Ash, fgr, siliceous, ophyric.
W sr, weakly foliated, qs
rusty o/c.
o/c behind 78-79, at junction
of 3 roads

53m = 86-78
103+50N

dir. 11

103N

86-117

102+50N

PK 26

