

RJB



LEBEL GEOPHYSICS

Consulting & Contracting

404 - 595 Howe St., Vancouver, B.C. V6C 2T5
Telephone (604) 682-8232

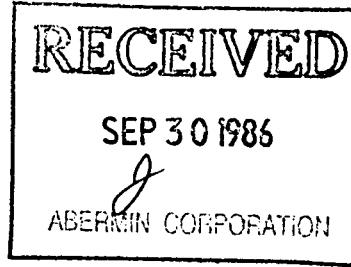

September 26, 1986

J. McKinney
Abermin Corp.

827224
LARA

Jim:

Enclosed please find summary results of SMOC airborne EM (Dighem) survey I promised.

There are 4 anomalies, namely 121A, 131A, 190AX and 210AX as shown by shaded circles. The locations (of the anomalies) were transferred from the flight path airphoto using triangulation from known features.

The principal anomalies are 121A and 131A. Dighem's interpretation of these is as follows.

LINE & ANOMALY	COAXIAL COIL		COPLANAR COIL		VERTICAL DIKE		HORIZONTAL SHEET		CONDUCTIVE EARTH	
	REAL PPM	QUAD PPM	REAL PPM	QUAD PPM	COND MHOS	DEPTH* M	COND MHOS	DEPTH M	RESIS OHM-M	DEPTH M
121A	6	8	0	0	5	0	1	130	1035	0
131A	3	9	0	1	13	0	1	102	1035	0

Anomalies 190AX and 210AX are questionable responses of very low amplitude that would not receive a formal interpretation.

I believe the complete survey results are in the possession of Aher Resources.

Larry

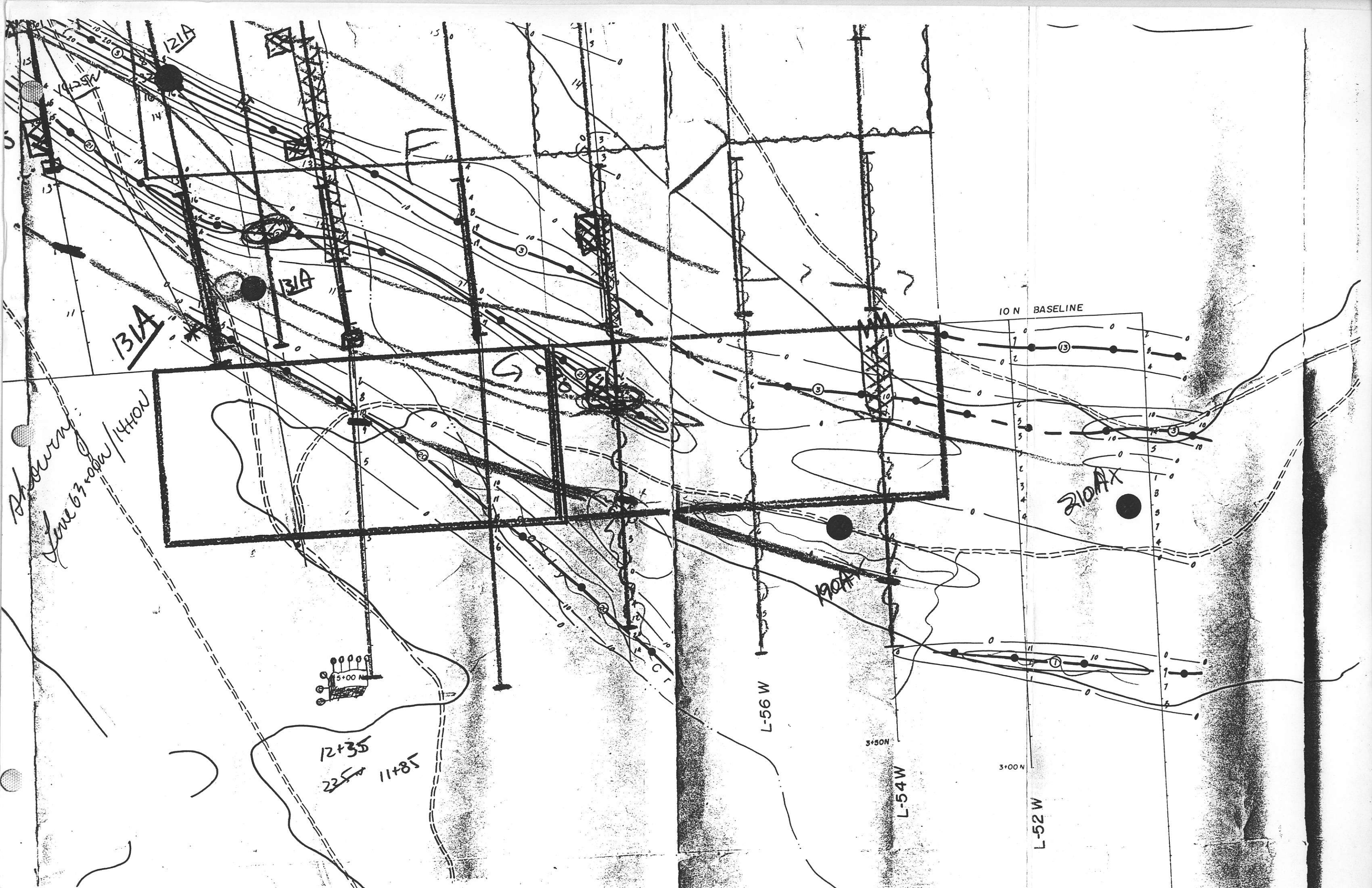

Shown:
Line 63+00W/1440W

131A

121A

131A

190A

210AX

L-56 W

L-54 W

L-52 W

