

STUMP LAKE GRID

827093

B/L starts at stn 2+00N on the old baseline (Orientation 160°)
 starts at 0+00S and goes to 45+00S (old 43+00S)

Lines At 070 / 250°

B/L

— 4.5 Km

to

L 0+00S	B/L	10+00E	- 1.0 Km
L 1+00S	B/L	10+00E	- 1.0
L 2+00S	B/L	10+00E	- 1.0
L 3+00S	B/L	10+00E	- 1.0
L 4+00S	8+00W	10+00E	- 1.8
L 5+00S	"	10+00E	- 1.8
L 6+00S	"	"	- 1.8
L 7+00S	"	"	- 1.8
L 8+00S	"	"	- 1.8
L 9+00S	"	"	- 1.8
L 10+00	8+00W	6+00E	- 1.4
L 11+00	"	"	- 1.4
L 12+00	"	"	- 1.4
L 13+00	"	"	- 1.4
L 14+00	"	"	- 1.4
L 15+00	"	"	- 1.4
L 16+00	"	"	- 1.4
L 17+00	"	"	- 1.4
L 24+00	B/L	10+00E	- 1.0
L 25+00	B/L	"	- 1.0
L 26+00	B/L	"	- 1.0
L 27+00	B/L	"	- 1.0
L 28+00	B/L	"	- 1.0
L 29+00			
L 40+00	B/L	7+50E	- .75
L 41+00	"	"	- .75
L 42+00	"	"	- .75
L 43+00	"	"	- .75
L 44+00	"	"	- .75
L 45+00	"	"	- .75

40.0 Km's

GRID LAYOUT FOR STUMP LAKE

N 340° ↔ 160° B/L

W 250° ↔ 70° E LINES

B/L 4.5 Km's Long

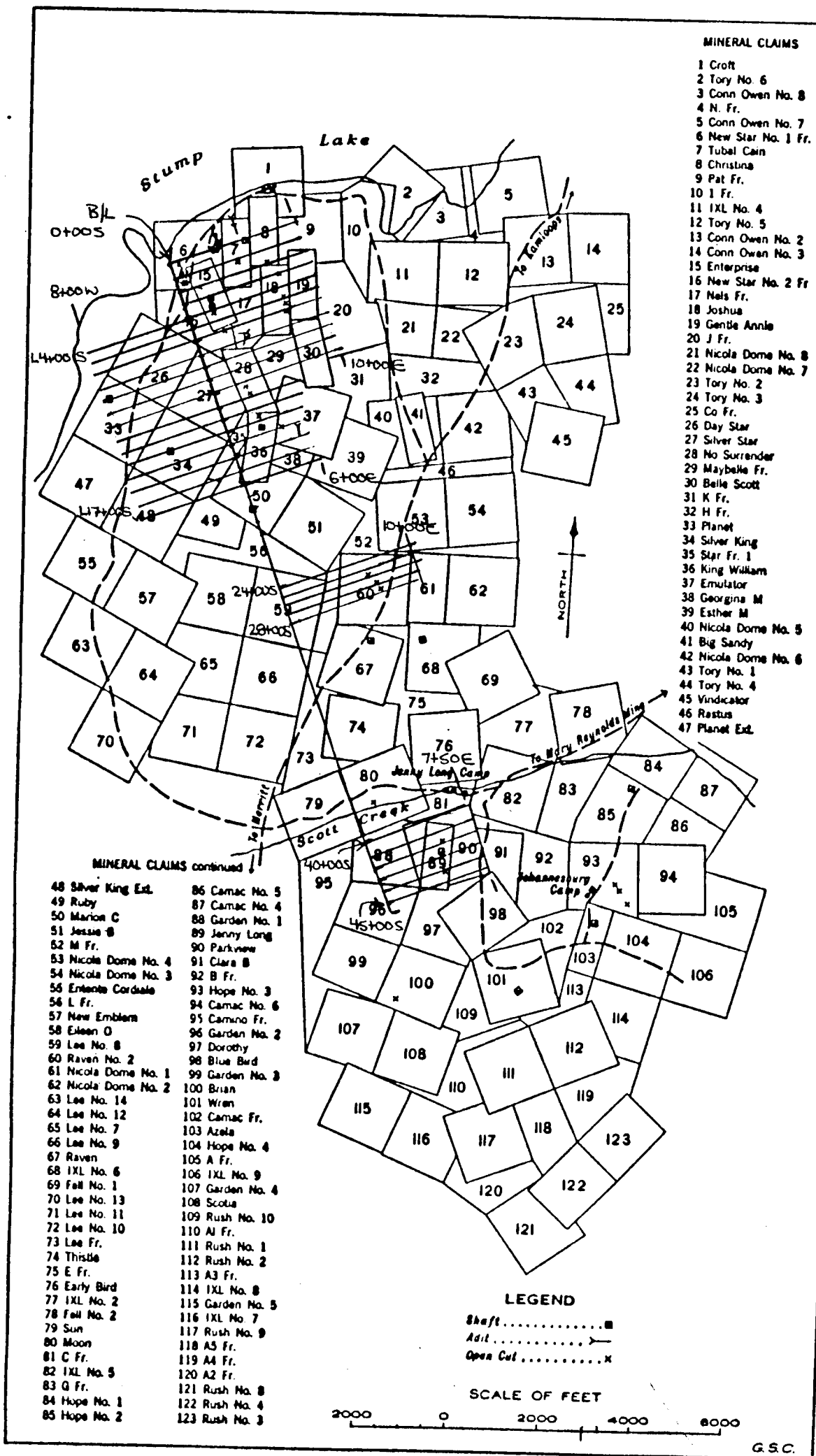

Figure 1. Mineral claims of Consolidated Nicola Goldfields, Limited, at Stump Lake

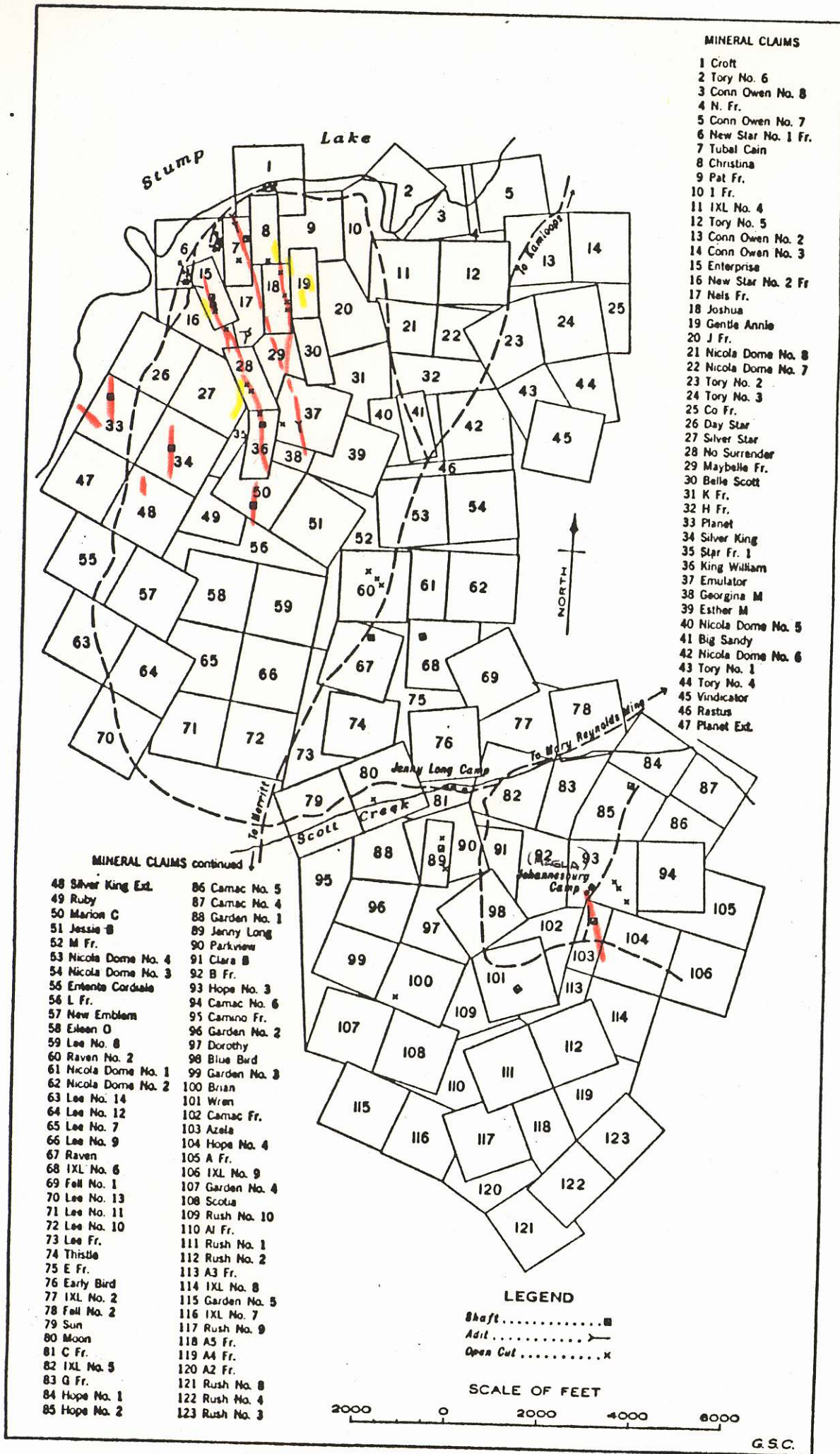
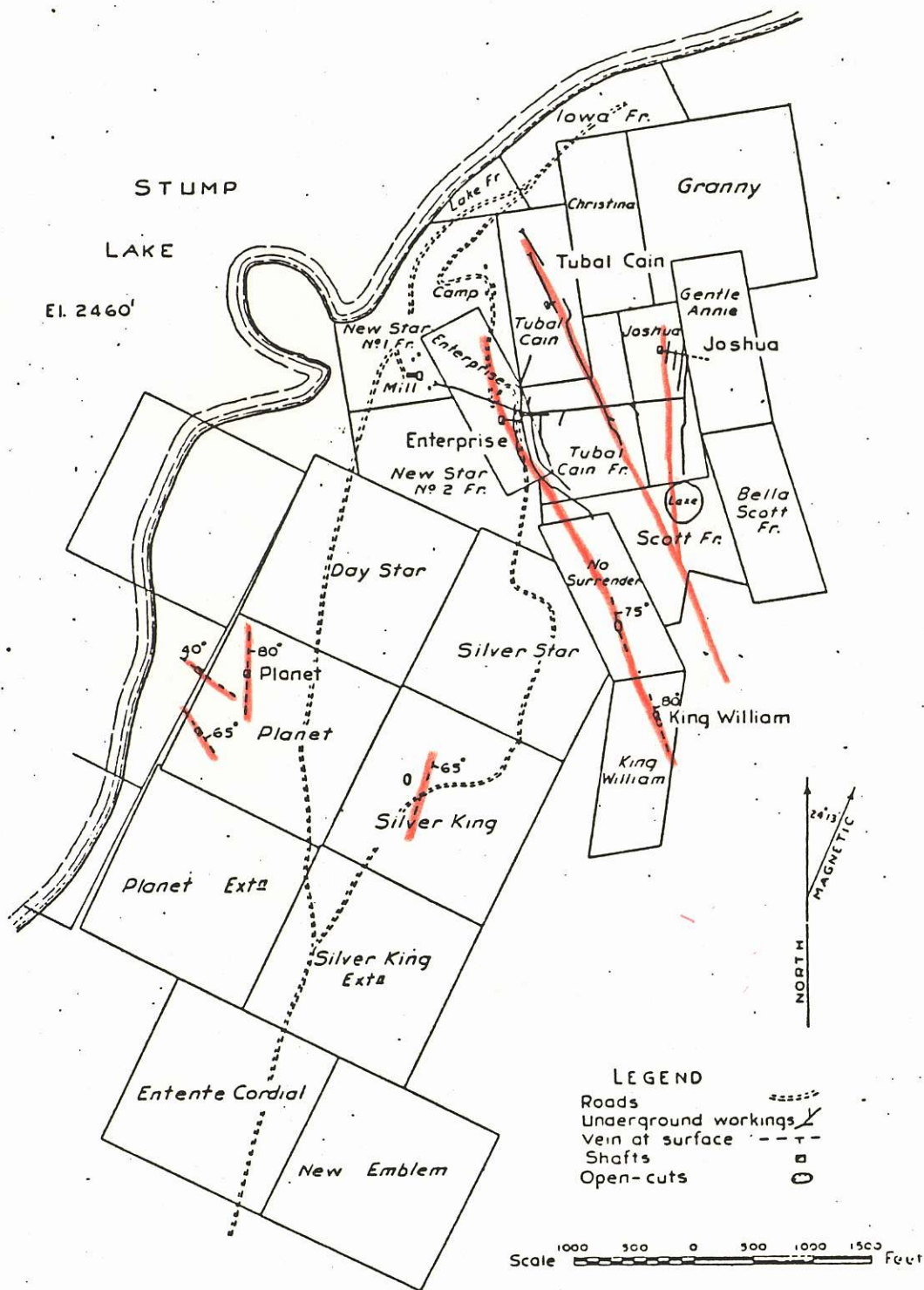

Figure 1. Mineral claims of Consolidated Nicola Goldfields, Limited, at Stump Lake

APPENDIX II (cont'd)
M. of M., 1936

D 16

REPORT OF THE MINISTER OF MINES, 1936.



Nicola Mines and Metals, Ltd. Plan of Property showing Principal Veins and Underground Workings, adapted from Company's Surveys.

— VEINS

5565

Use arsenic in sampling

Jenny Long Info

Strike N10°W

DDH#1 258' NE of shaft
65° SW to 273' 30' Higher

two veins 203-205' <.003 oz Au .04 oz Ag
230-235' .022 oz Au 1.03 oz Ag
shear zone 240-245' .03 Au 2.43 oz Ag
abandoned the hole early @ 273' in shear

DDH#2 on no surrender, d
45° SW to 351'
124-126' QV w/ ~~A~~.003 Au, <.01 Ag
146-148 shear .016 Au, .76 oz Ag

DDH#3 King William
SW 55° 161'

122-123½	.04 Au	.005 Ag
140 142	.024 Au	.54 Ag
142 145	.048 Au	1.63 Ag
145 151	.014 Au	.35 Ag

S 1/2

DRILL TARGETS

1/ JENNY LONG *

- open at depth + strike

NB depends on path locⁿ

1-2 Holes

Check Assess

4.9 Kms Mag

5565, 6348, 6856

4 percussion holes Assess
5565, 6348

2/ Azela (Johannesburg)
to S of shaft Jctⁿ of two veins?
mod priority

1 Hole

Midd Portion

4146

4165

4412

5152

5565

6165

6348

6608