

1 Copy Please



826929 92 I
Mills-Dadswell
Iron Prospect
Date April 29th, 1959

PROPERTY INFORMATION FORM

Name of Property Mills - Dadswell iron prospect

Presented by (with address) Gordon Mills, Lillooet B.C. Date April 23rd, 1959

Location Kamloops M.D. 121-45 50-30

Access via allweather highway, via trail for two miles.

Claims 8 located claims Copper King, Green Gold, Black Jack

Ownership Gordon Mills, V.R. Dadswell

A		N
	W.S.R.	✓
	G.A.C.	
	E.O.C.	
	H.A.P.	
	R.D.S.	
	B.C.B.	
	G.P.R.	
	E.L.D.	
	I.B.	
	E.C.E.	

Summary of Outstanding Features Zone of alteration in a granodiorite, width 60 feet tracable for 200 ft on slope, containing excessive amounts of Magnetite, (approx 20%)

Opinions, Suggestions or Recommendations of Present Holder That it is a source of iron

Option Terms N/A

Information is Based on examination Apr 23rd

Nature of Deposit basic phase of an intrusive rich in iron

Mineralization Magnetite, some minor Copper

Widths and Values 60 ft width of 19% Fe

Strike and Dip North 10 East; dip near vertical

Country Rock acidic granite

Present Known Extent and Possible Extensions visible for 50 ft, float indication of 200 ft length. visible for 60 ft width one place

Limiting Features low iron content

Workings, Kind, Amount, Location and/or Diamond Drilling

three trenches blasted out across the zone

Lengths and Frequency of Exposures

Known Commercial Sections Nil

Known Non-Commercial Sections Nil

Number, Dimensions and Grade of Ore Shoots Indicated

Possibilities of Developing Ore Nil

Past Production, If Any

Dividends, If Any

Other Significant Features in History of Property

associated with the victory copper prospect and other showings of copper in vicinity

Previous Examinations Nil

Reports, Plans or Other Sources of Information

Memoir 262

Reasons for Property Lying Idle

N/A

Relation to or Comparison with Other Properties in the District

None

New Development (Since Last Examination)

N/A

Other Remarks

Owner secured a spectro-graphic assay of a selected sample from Neelands-Van Nuys Calif. Assay showed 59% Fe. Check sampling showed 19.06% Fe from samples taken by writer

[Signature]
Examining Engineer

April 23/09
Date of Examination

921

TO 17 MILES
HULLOCK
2 NORTH

MILLS - DODSWELL
8 CLAIM IDON
PROSPECT

SPENCES
BRIDGE

LILLOOET ARGILLITE MOUNT LYTTON GRANODIORITE ANDELITE

ALBES
HORSEBLENDITE
60' WIDTH (MAGNETITE Rcks)

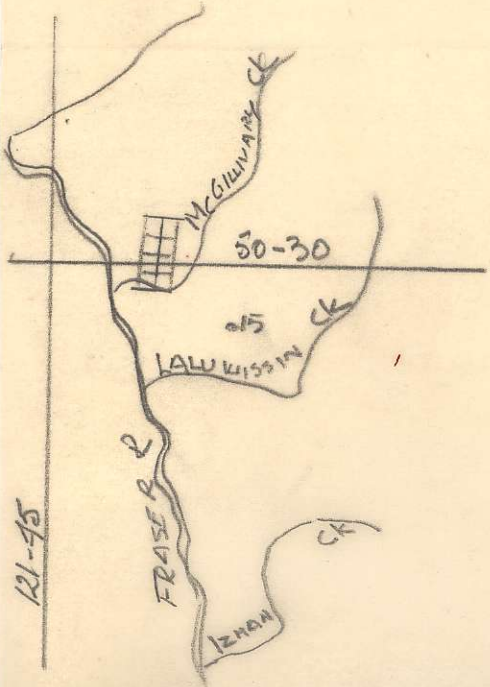

121-95