

Memo.

1

From: S. Finlay, J. Hardy, I. Price
To: D. Watkins, A. Davidson

Subject: Property Exam, Feld Claims - Mt. Woodside

826804
92H/4

This property consists of five units in two blocks (Feld —, Feld —), along the west side of Mt. Woodside, between Harrison Mills and Agassiz.

The owner, Mr. J. Newfield of Abbotsford stated ^{that} the claims were staked to cover a "theorized" sulphide-hosted precious metals deposit ^{blindly} situated thirty to forty feet beneath alluvium. Just within the eastern margin of the claim group, old workings of as yet unknown origin, consist of two adits driven ^{eastward} into the hillside, one of which was located by CFC geologists. Work conducted by the present ~~own~~ owner consists of ~~to~~ 18

rock chip samples from ~~the~~ within
 the adits and general vicinity. ~~(See~~
 (See attachment ~~but~~) . Of note are silver
 assays of 275.00, 17.90, and 11.50 oz/ton
 silver. An attempt was made by
 CFC personnell to duplicate this ~~previous~~
 sampling in the adit vicinity, and to
 conduct fill-in geochemical sampling in
 accordance with previous CFC work on
 Mt. Woodside. As such 10 samples
 were taken for assay and geochemical
 analysis.

Rocks Examined in the adit vicinity
 consisted of dacite quartz (+ felds?) porphyries,
 with disseminated and fracture fill pyrite
 averaging 5%. Shallow ~~to~~ eastward
 dipping shears with associated quartz-
 carbonate veining ^{and} and 10% pyrite, appear
 to be the *raison d'être* for the
 adit and probable source for some,
 if not all, of the high silver assays.
 (sample # 12 definitely). Rocks within
 the ~~majority~~ $\frac{1}{2}$ m of this zone are
 preferentially selected & sampled.

3

Outcroppings within 200 metres of
the adit are definite ~~large~~ intermediate
to felsic fragmental rocks (Lynell's size),
carrying +5% pyrite and similar in
appearance to rocks previously found
outcropping to the east on Mt. Woodside.

Attached is a list of samples
taken ~~for~~ by CFC personnel with
an accompanying sketch of the property and
sample locations.

Although the rocks in the area
of the adit appear interesting and show
some potential for massive sulphide +/or
precious metals exploration, for the
most part they outcrop outside Newfields

4

claims to the east. ^{Pending} ~~On that~~
spectacular assay results,
basis it is not recommended that
CFC conduct any further work
on the Feld claims, ~~also~~ apart from
any followup as part of a larger
exploration program conducted on Mt.
Woodside proper.

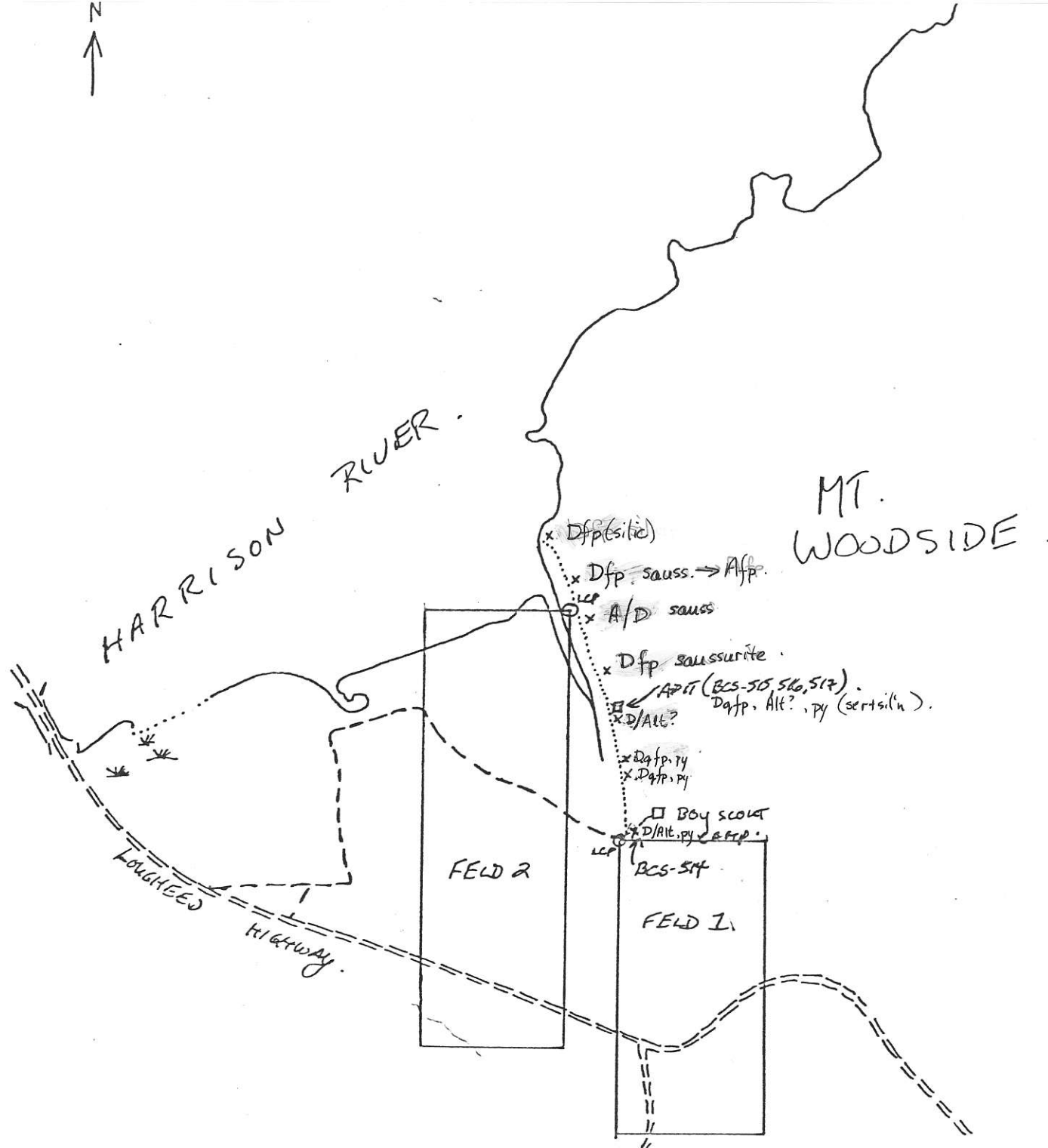

GEOLOGY

FELD CLAIMS.
 MT. WOODSIDE 1:20,000

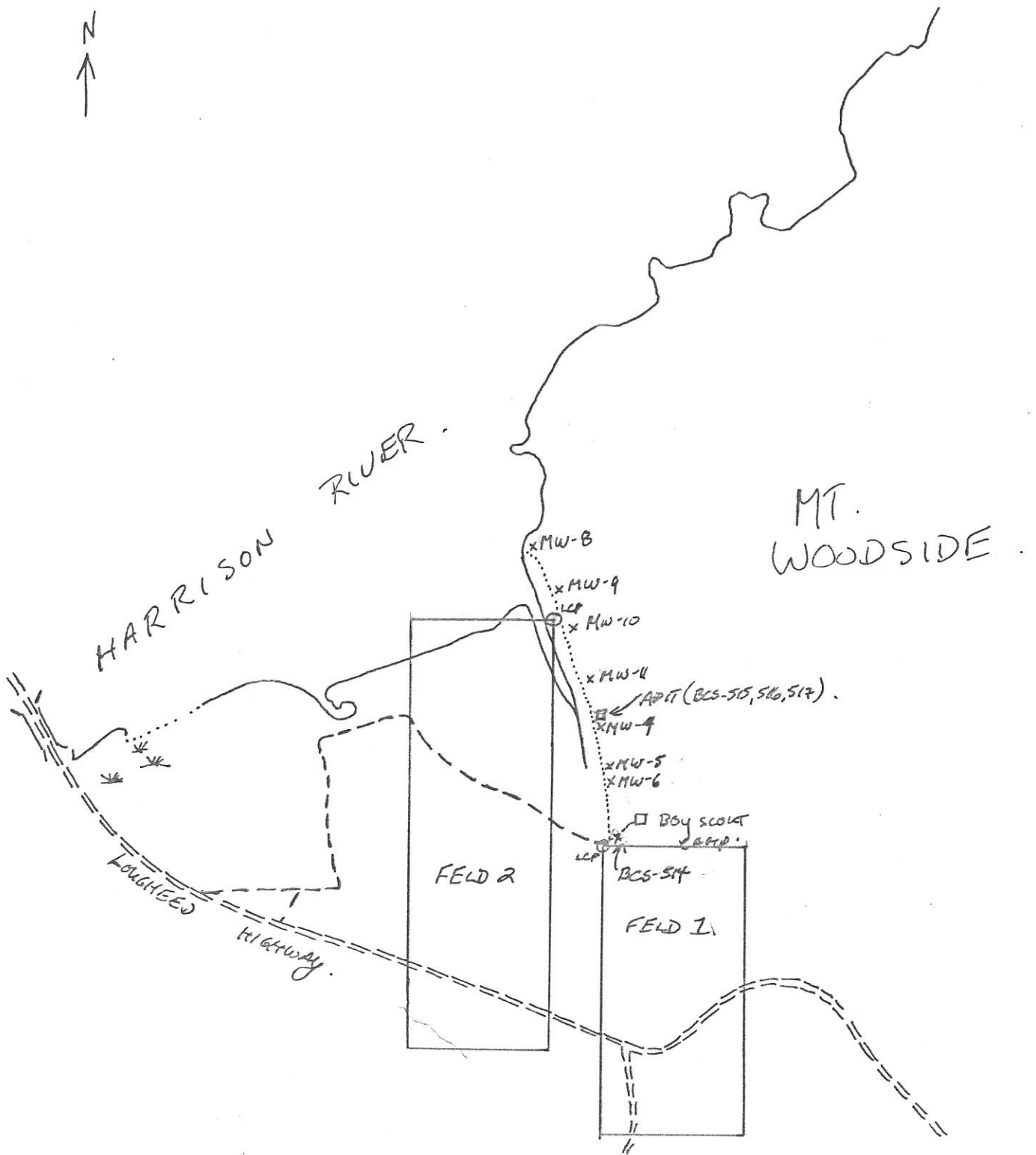

FELD CLAIMS.
 MT. WOODSIDE 1:20,000

HAN

11-10-2016 1:30:00

100 1000

Alex.
 Please drop
 this off onto
 I can tomorrow.
 Steve

