

KERR ADDISON MINES LIMITED

(FOR INTER-OFFICE USE ONLY)

826752

To A. D. Clendenan From T. Bruland

Subject Blue Chip - Laidlaw 92 H 5E Date July 19/Nov. 12/85.

Location: The Blue Chip Claims cover showings referred to in the Min.Dep. File 92H/SW 17 and 103 located south of Laidlaw. The 4 adits are located 34 km from Harrison Hot Springs Post Office by Provincial Highway, Trans Canada and gravel road between Wahleach Creek and Lorenzetta Creek in the Skagit Range, latitude 49°18'50' and longitude 121°36'40".

Access: Access is via Provincial highway 9 south from Harrison Hot Springs to Trans Canada and east to Laidlaw and then south to the northwest slope of the Skagit Range. Harrison Hot Springs Post Office is 0 km. Turn east on Trans Canada at 14.8 km and right at Laidlaw at 31.9 km and right past Jones Creek (Wahleach Creek on map) toward Jones Lake (Wahleach Lake on map) at 32.7 km. Left at 33.3 km and leave truck after 100m, follow road to clearing with adits. 4 wheel drive is recommended from 32.7 km to 33.4 km.

History: An adit was located south of Laidlaw during regional reconnaissance on May 24/85 along southern extension of the Harrison Lake Fault. This is believed to be the showing referred to in the Min.Dep. File as 92H/SW 17. A grab sample to the south of the adit of quartz vein in quartz diorite ran 12.3 g/tonne Ag. (Figure 3). Two attempts were made to locate the showing from the Min.Dep. File 92H/SW 103, but the showing has not been located.

The ground covering the adit was found to be open for staking and two claims, BLUE (3NGE) and CHIP (3S1W) were located June 11 to June 13/85. (Figure 1 & 2).

Mapping and sampling on the property revealed 4 adits. From the Ministry of Mines Reports it seems that these adits were driven in in the period 1968 to 1970 by Almaza Mining Co. of Burnaby, B.C. It is not known if these adits were development or test adits or if they were from a high grade operation of the quartz veins in the quartz diorite.

KERR ADDISON MINES LIMITED

(FOR INTER-OFFICE USE ONLY)

To A.D.C. From T. Bruland

Subject Blue Chip - Laidlaw Date July 19/Nov 12/85

- 2 -

Prior to the adits the Min.Dep. File indicates that a 3280 pound sample was shipped in 1957 from this showing but no results are shown.

Three adits are located towards the centre of the quartz diorite stock while the fourth is along the eastern contact of the stock. (Figure 4).

Geology:

Sampling and mapping of the Blue Chip property was completed by June 30, 1985. The quartz diorite stock is emplaced in argillite of the Chilliwack Group of Carboniferous or later age (Fig 4). No age is available for the quartz diorite stock. It is believed to be of similar age to the quartz diorite stocks at ABO, about 24 m.y. The quartz diorite is medium grained, grey, equigranular with between 10 and 50% mafics, but usually 35% mafics. Mafics are mainly hornblende with minor amounts of biotite. In parts of the stock, biotite is the major mafic mineral. The quartz diorite contains from 1-15% pyrrh diss and in veins up to 10mm, and traces of pyrite and chalcopyrite locally. The stock is intruded by quartz, quartz-pyrrhotite and pyrrhotite veins from 5mm to 450mm. Thin hairlike quartz veins similar to the ones found in the ABO stock were not found. Generally the quartz veins are barren or contain minor amounts of pyrrhotite ± pyrite.

The mapping located the east and west contact to the argillite, while the north and south contact could not be located accurately. The stock could be in the order of 250 by 250m. The quartz diorite stock contact to the argillite is a hornfels halo of 5-10 M with secondary biotite up to 50%.

KERR ADDISON MINES LIMITED

(FOR INTER-OFFICE USE ONLY)

To..... A.D. Clendenan From..... T. Bruland

Subject..... Blue Chip - Laidlaw Date..... July 19/Nov.12/85

- 3 -

Sampling: All four adits were sampled on a 5m spacing, with a few high high grade samples from quartz-pyrrhotite and quartz veins. (Figure 5 and 6). The same was done on the surface where it was possible. Most samples are grab samples with a few channel samples across larger quartz veins. Sampling was done with emphasis on the quartz diorite, to check the potential for a bulk tonnage deposit similar to ABO.

Conclusion and Recommendation: The low values from assays from the collected samples (Figure 6 Table) indicate that this quartz diorite stock does not have the potential either for a high grade vein or a low grade bulk tonnage deposit. It is not recommended that any follow up work be done or assessment work filed for the claims.

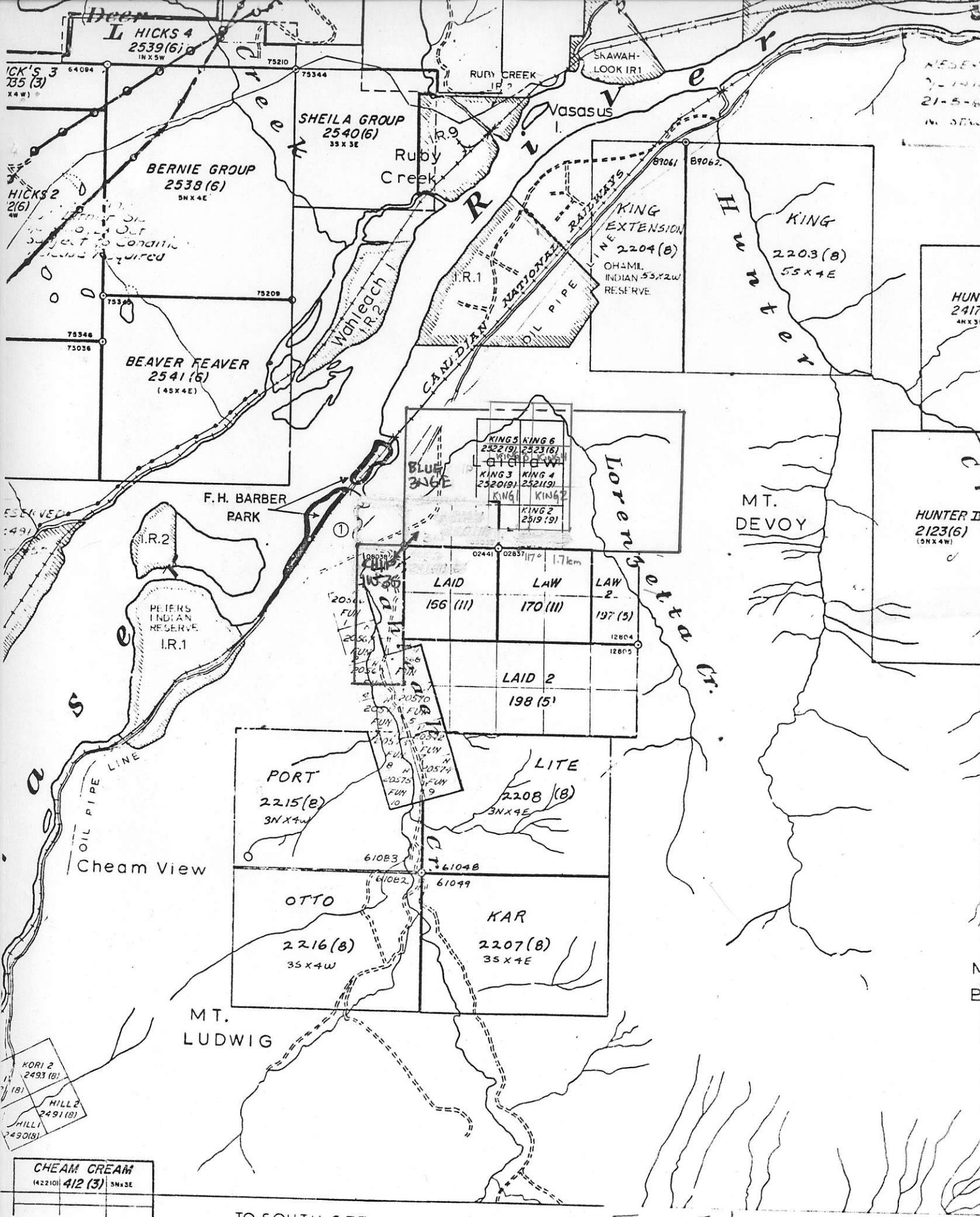

TO SOUTH SEE MAP 92H/4E

FIGURE 1; CLAIM MAP OVERVIEW 92H/5E

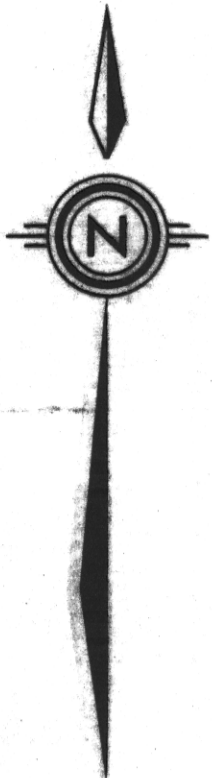

121° 35'

49° 18'

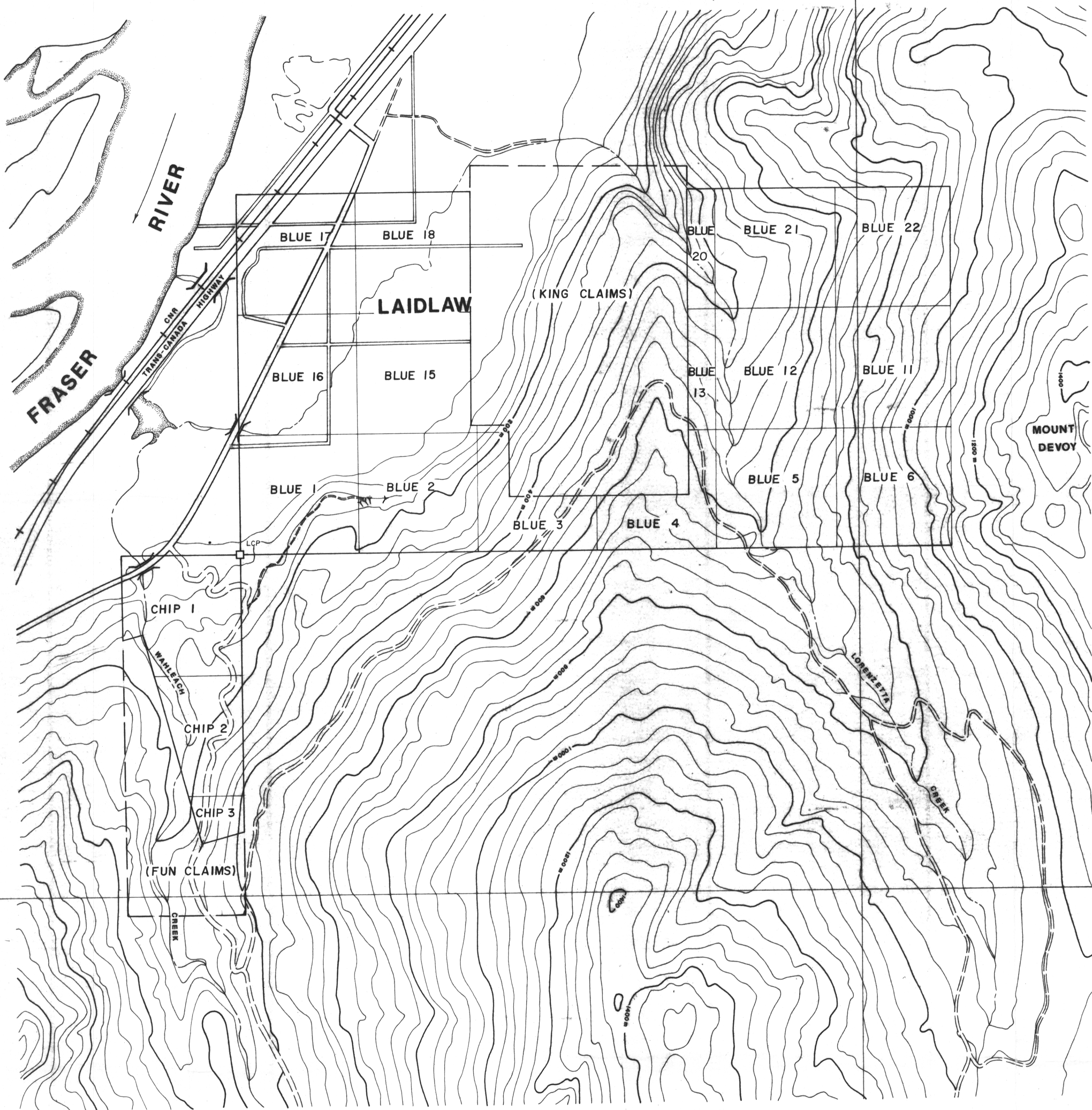
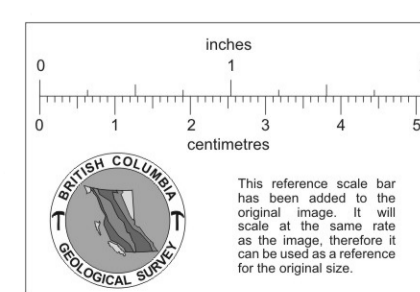
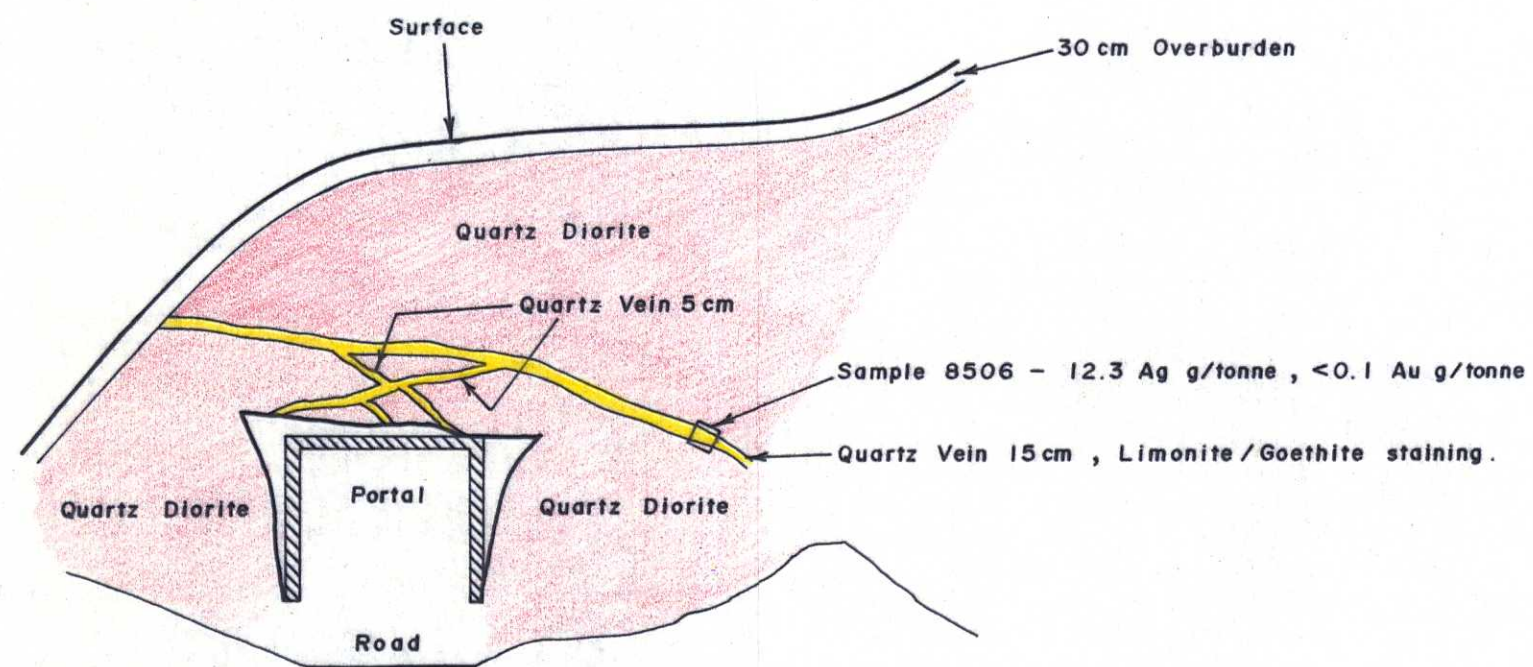

FIG. 2



KERR ADDISON MINES LTD	
BLUE CHIP CLAIMS	
CLAIMS MAP	
SCALE - 1:10 000	DATE - JUNE, 1985
DRAWN BY - P.H.	DATA - T.B.
NTS - 92 H 5	REVISED -





Section Looking 135°

FIG. 3

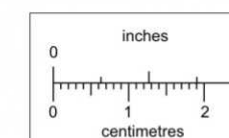

This reference scale bar has been added to the original image. It will scale at the same rate as the image, therefore it can be used as a reference for the original size.

KERR ADDISON MINES LTD	
BLUE CLAIMS	
SECTION AT CENTRAL ADIT PORTAL	
SCALE - 1:100	DATE - AUGUST, 1985
DRAWN BY - P.H.	DATA - T.B.
NTS - 92 H 5	REVISED -

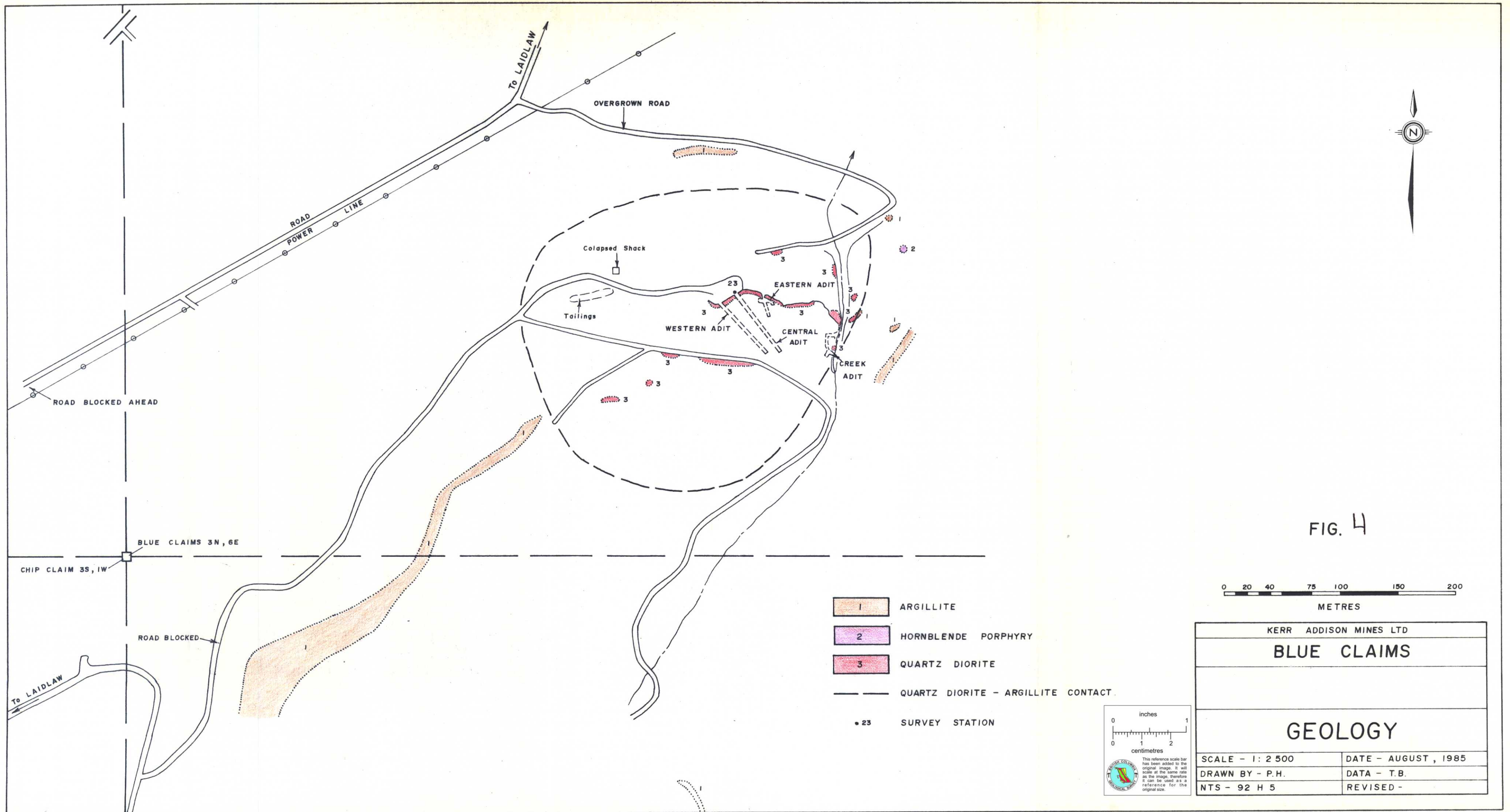
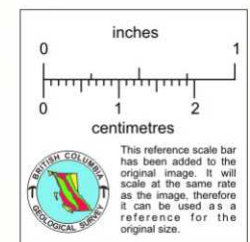

FIG. 4



- 1 ARGILLITE
- 2 HORNBLENDE PORPHYRY
- 3 QUARTZ DIORITE
- QUARTZ DIORITE - ARGILLITE CONTACT.
- 23 SURVEY STATION



KERR ADDISON MINES LTD	
BLUE CLAIMS	
GEOLOGY	
SCALE - 1 : 2 500	DATE - AUGUST , 1985
DRAWN BY - P.H.	DATA - T.B.
NTS - 92 H 5	REVISED -

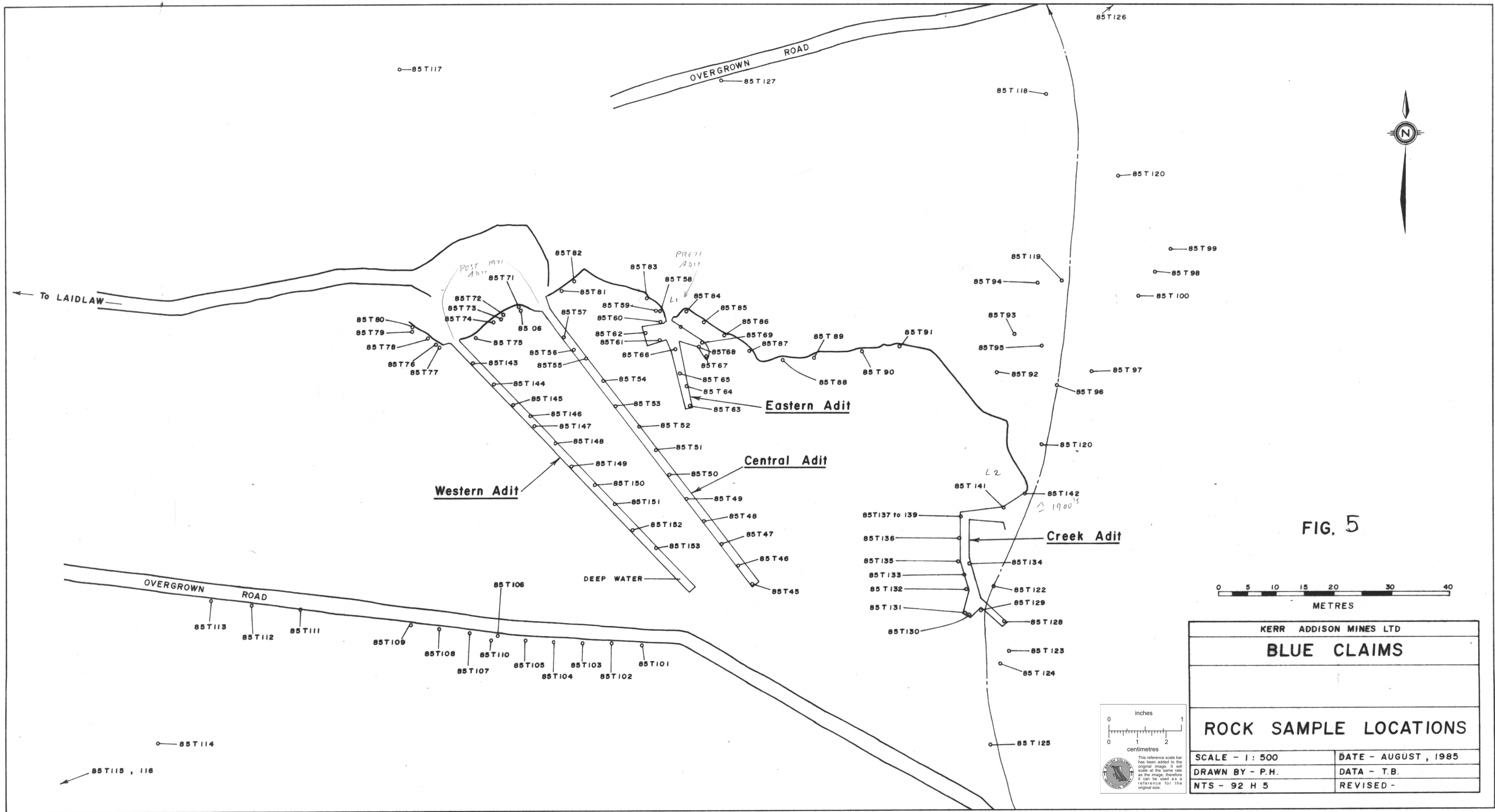

FIG. 5

KERR ADDISON MINES LTD	
BLUE CLAIMS	
ROCK SAMPLE LOCATIONS	
SCALE - 1 : 500	DATE - AUGUST , 1985
DRAWN BY - P.H.	DATA - T.B.
NTS - 92 H 5	REVISED -

This reference scale bar has been added to the original image. It will scale at the same rate as the image, therefore it can be used as a reference for the original size.

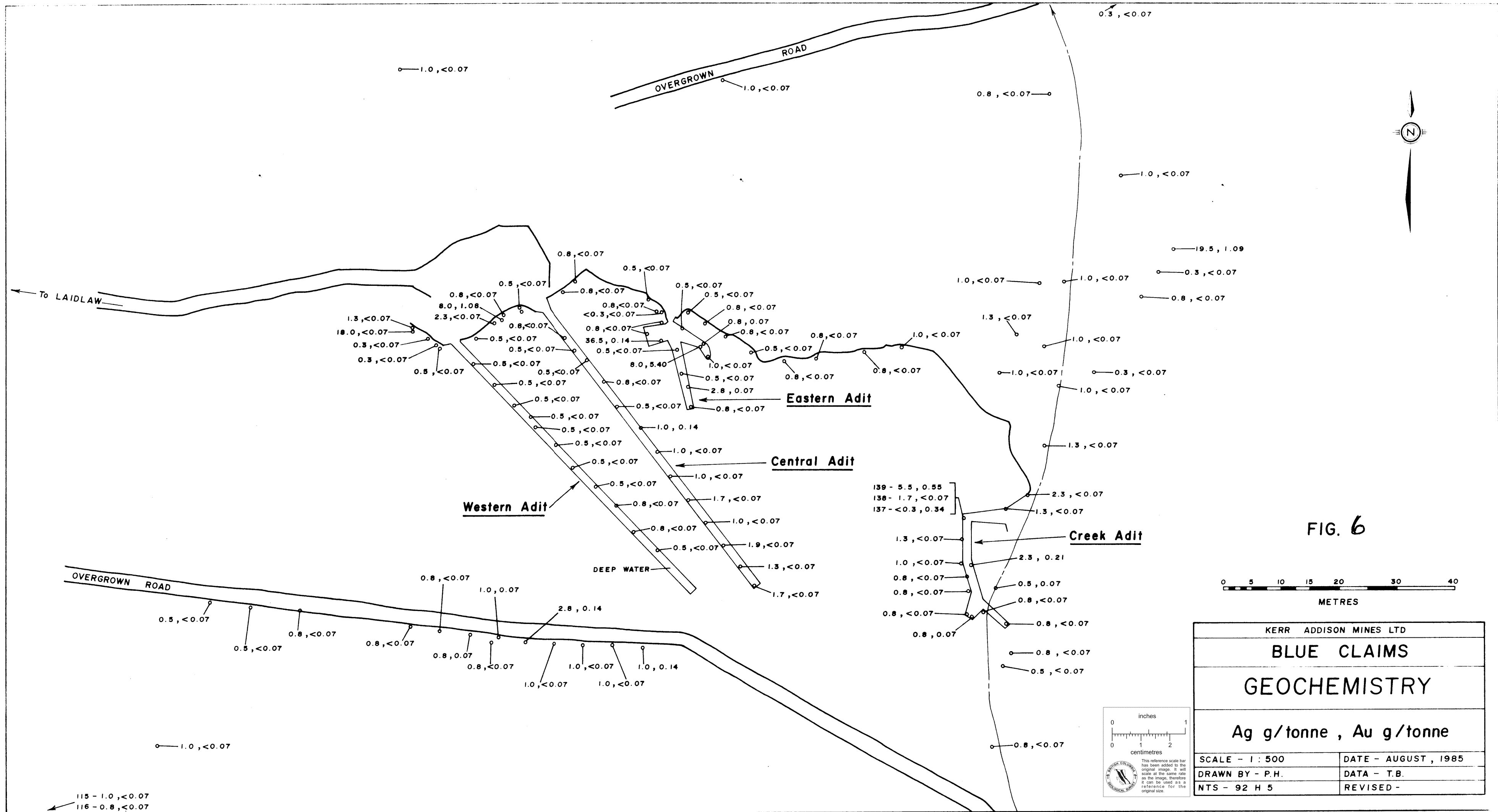
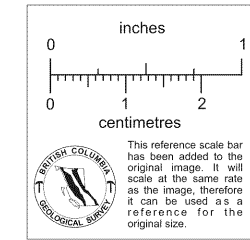

FIG. 6

KERR ADDISON MINES LTD	
BLUE CLAIMS	
GEOCHEMISTRY	
Ag g/tonne , Au g/tonne	
SCALE - 1 : 500	DATE - AUGUST , 1985
DRAWN BY - P.H.	DATA - T.B.
NTS - 92 H 5	REVISED -



115 - 1.0, <0.07
 116 - 0.8, <0.07