

**Inmet Mining Corporation**

3rd Floor - 311 Water Street  
Vancouver, B.C.  
Canada V6B 1B8

Tel: (604) 681-3771  
Fax: (604) 681-3360

August 13, 1997

Chris Baldys  
Foreland Geoscience Inc.  
#10, 20110 Stewart Crescent  
Maple Meadows Industrial Park  
Maple Ridge, B.C.  
V2X 0T4

Dear Mr. Baldys:

Thank you for the information on the LD property, Harrison Lake area. Unfortunately, Inmet is not prepared to pursue this opportunity at this time. As you suggested, we have copied portions of the material for future reference and will notify you if our requirements change. The originals are being returned to you herewith.

Thank you again for your property submission and good luck with your projects.

Sincerely,



Ian Morrison  
District Geologist

IM/h

Encl.

# Foreland Geoscience Inc.

---

Telephone (604) 460-1576  
Fax (604) 460-1577

#10 20110 Stewart Crescent  
Maple Meadows Industrial Park  
MAPLE RIDGE, B.C. V2X 0T4

July 2, 1997

I. Morrison  
Inmet Mining Corporation  
3rd Floor - 311 Water Street  
Vancouver, B.C.  
V6B 1B8

Dear Mr. Morrison

**Re: LD Claims – Property Submittal**

Please review the attached materials with respect to the LD property.

I will be travelling from July 2<sup>nd</sup> until August 8<sup>th</sup>. However, any technical questions that you may have with regard to the property will be answered immediately, if directed to my e-mail address [cbaldys@pro.net](mailto:cbaldys@pro.net) or by fax to (604) 466-1577.

The owner of the LD Claims, Estrella Demczuk, can be reached by telephone to answer any questions with regard to ownership status, at (604) 874-5409.

The assay cross-sections compiled in 1997, are the account of all past diamond drilling performed in 1975 and 1996. Please note that some significant footage of altered core from 1996 has not been assayed. (ie. DDH96-5 115'-142'.) However, all core is safely stored and available for further evaluation.

Foreland Geoscience Inc. is a geological consulting firm acting as agent for Estrella Demczuk, the claim owner.

Yours truly,

FORELAND GEOSCIENCE INC.

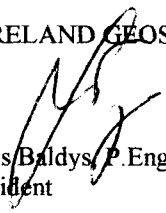
  
Chris Baldys, P. Eng.,  
President

CB:flr  
Encl.

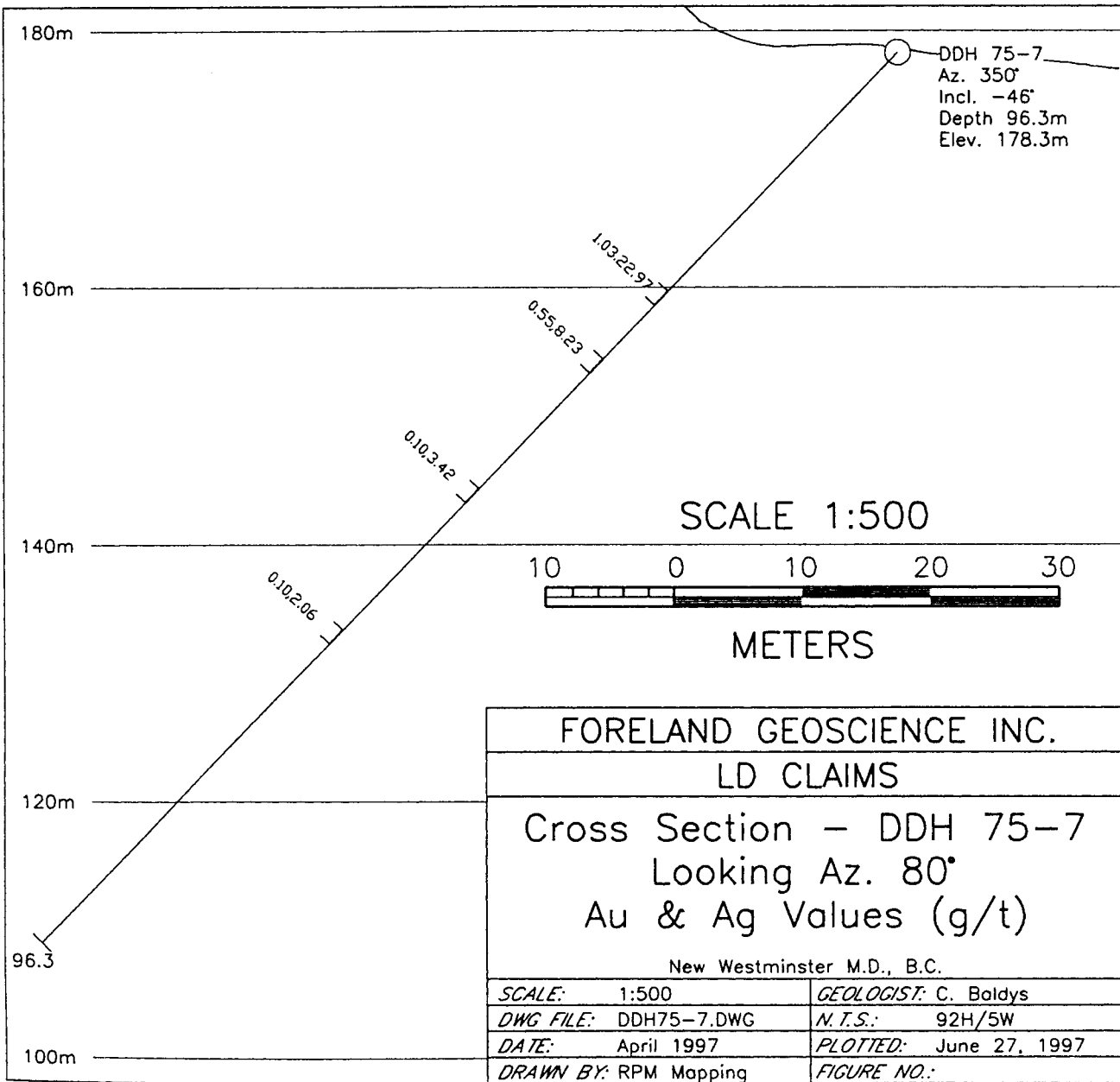
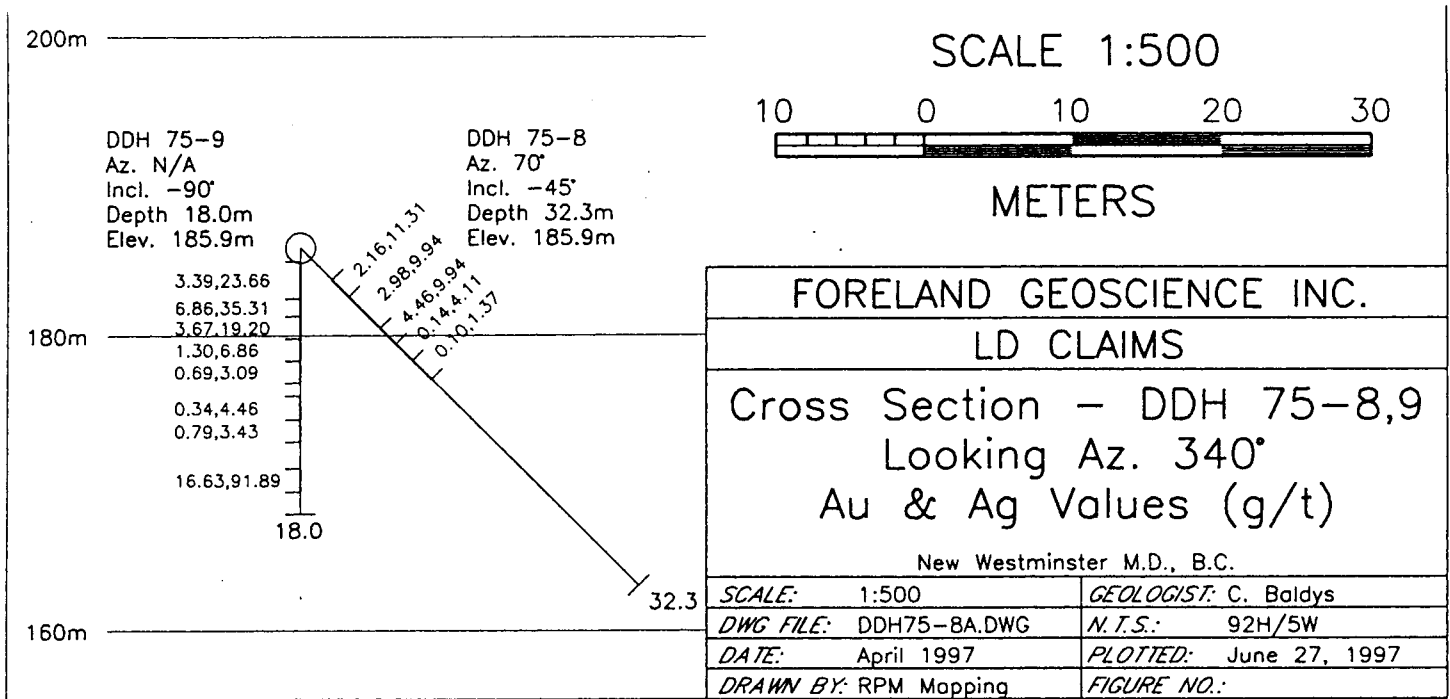

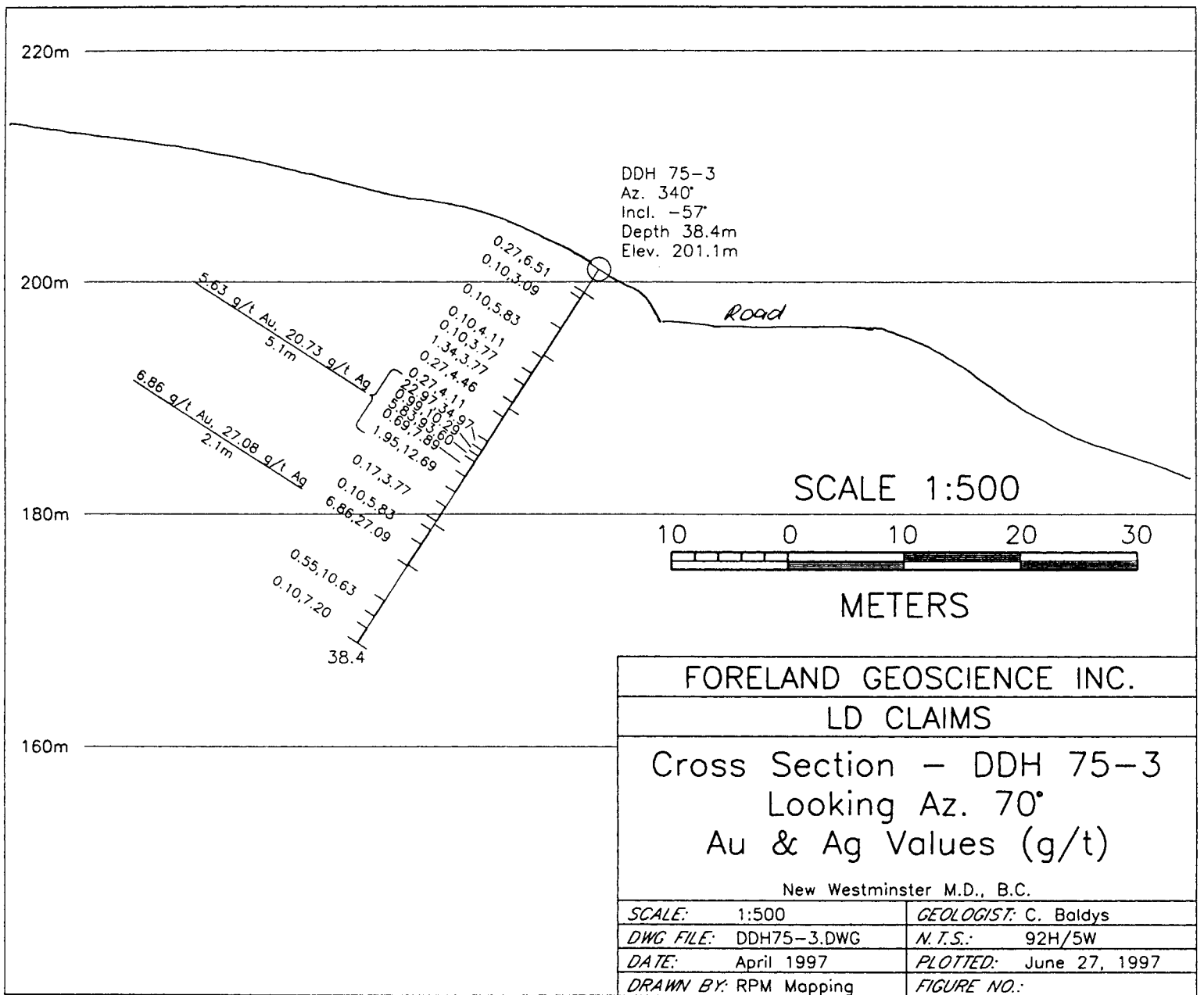

FORELAND GEOSCIENCE INC.	
LD CLAIMS	
Cross Section - DDH 75-3 Looking Az. 70° Au & Ag Values (g/t)	
New Westminster M.D., B.C.	
SCALE: 1:500	GEOLOGIST: C. Baldys
DWG FILE: DDH75-3.DWG	N.T.S.: 92H/5W
DATE: April 1997	PLOTTED: June 27, 1997
DRAWN BY: RPM Mapping	FIGURE NO.:

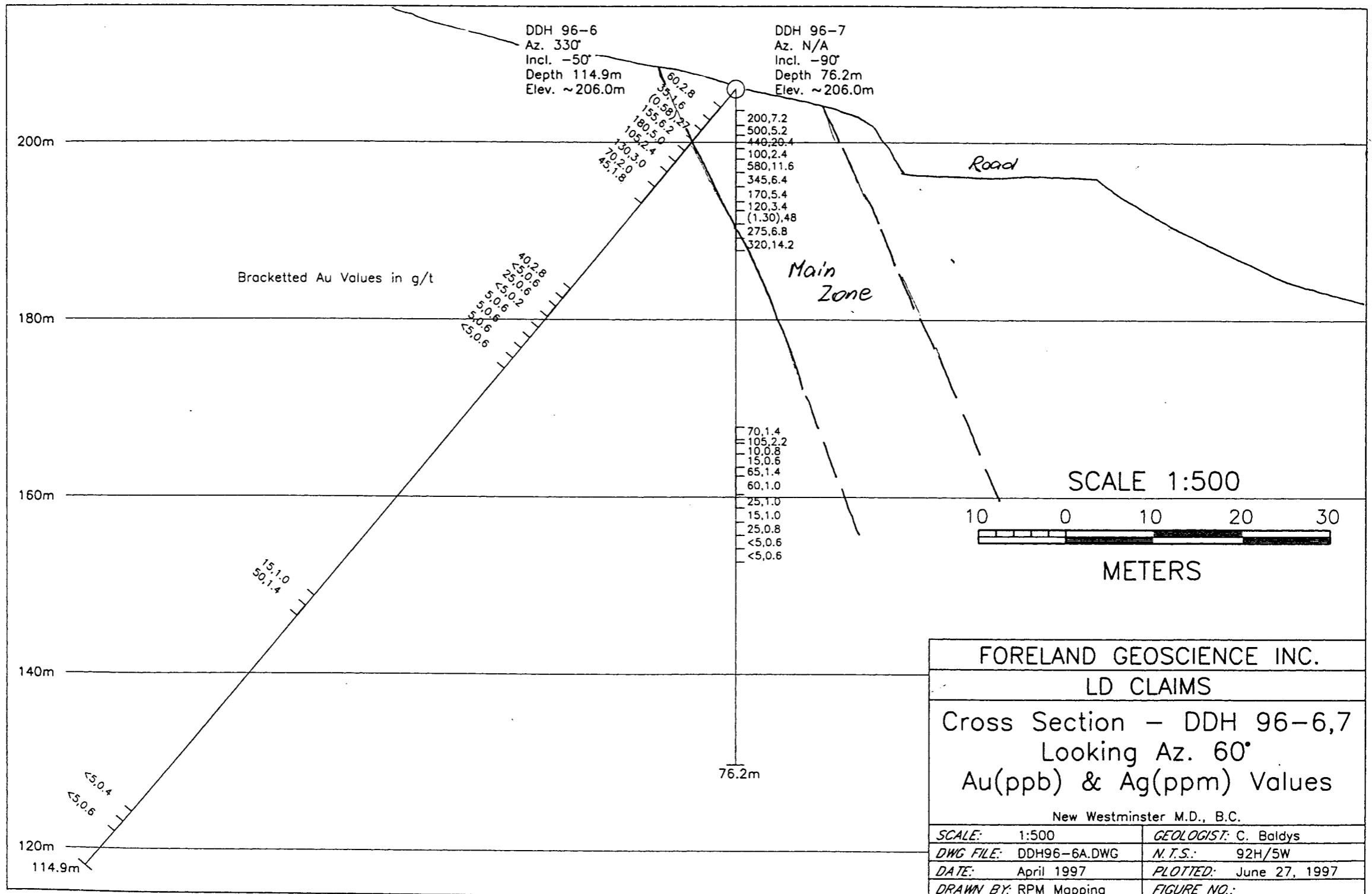

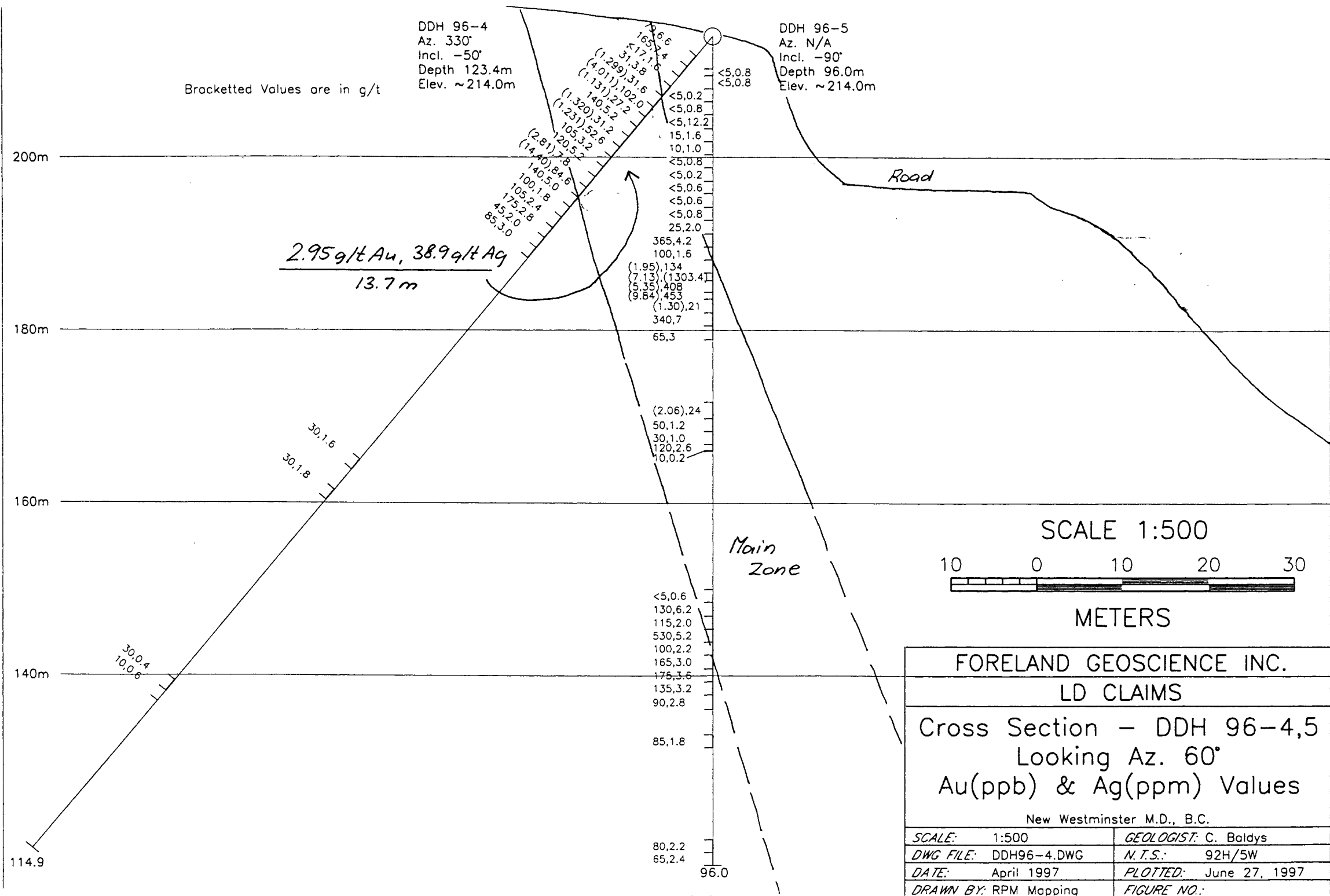

DDH 96-4  
Az. 330°  
Incl. -50°  
Depth 123.4m  
Elev. ~214.0m

DDH 96-5  
Az. N/A  
Incl. -90°  
Depth 96.0m  
Elev. ~214.0m

Bracketted Values are in g/t

2.95 g/t Au, 38.9 g/t Ag  
13.7 m

SCALE 1:500

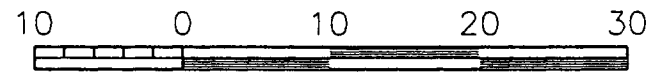

METERS

FORELAND GEOSCIENCE INC.

LD CLAIMS

Cross Section - DDH 96-4,5  
Looking Az. 60°  
Au(ppb) & Ag(ppm) Values

New Westminster M.D., B.C.

SCALE: 1:500	GEOLOGIST: C. Baldys
DWG FILE: DDH96-4.DWG	N.T.S.: 92H/5W
DATE: April 1997	PLOTTED: June 27, 1997
DRAWN BY: RPM Mapping	FIGURE NO.:

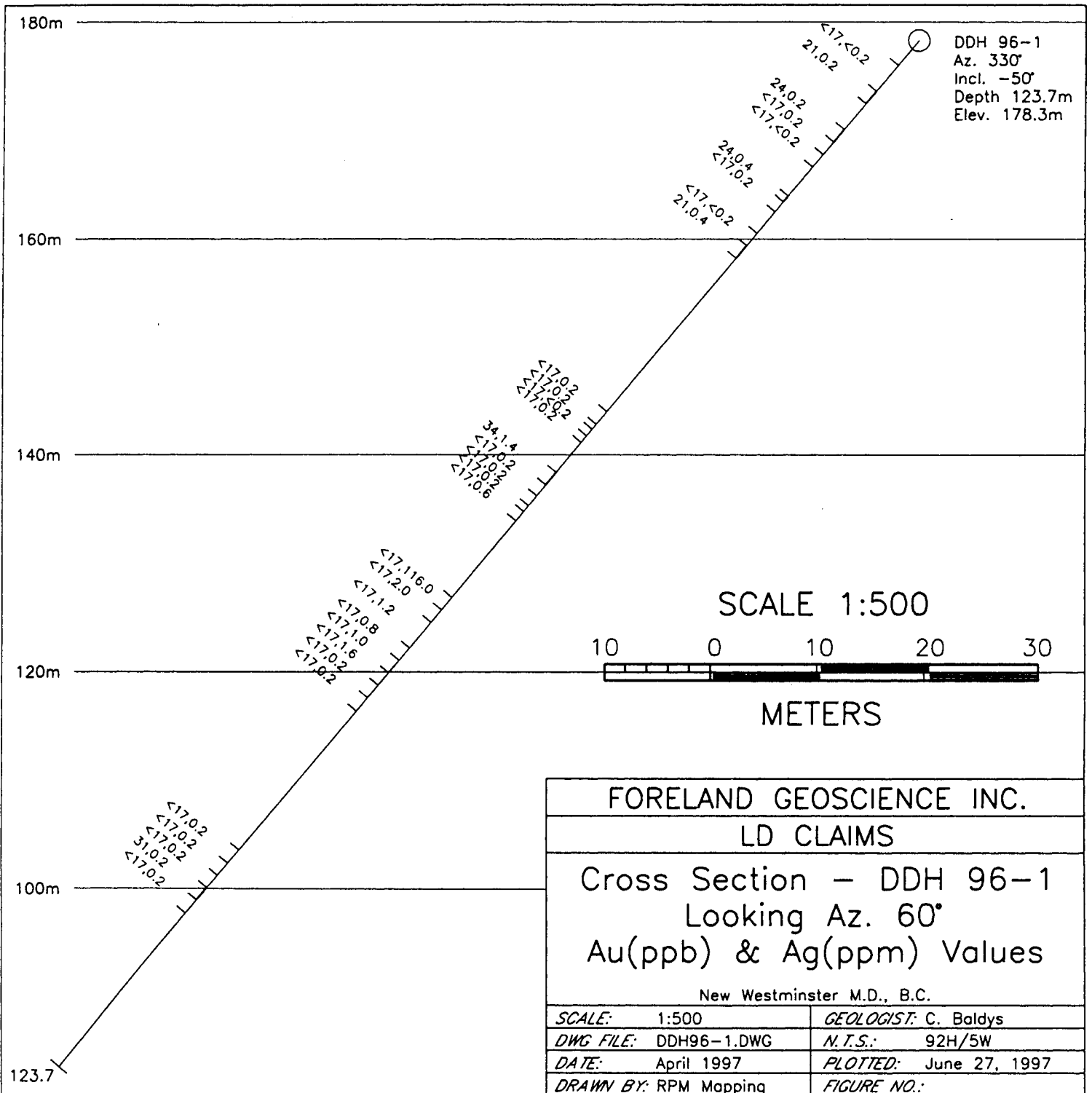

180m

160m

140m

120m

100m

123.7

<17.0.2  
<17.0.2  
<17.0.2  
31.0.2  
<17.0.2

<17.116.0  
<17.2.0  
<17.1.2  
<17.0.8  
<17.1.0  
<17.1.6  
<17.0.2  
<17.0.2

34.1.4  
<17.0.2  
<17.0.2  
<17.0.2  
<17.0.6

<17.<0.2  
21.0.2  
24.0.2  
<17.0.2  
<17.<0.2  
24.0.4  
<17.0.2  
<17.<0.2  
21.0.4





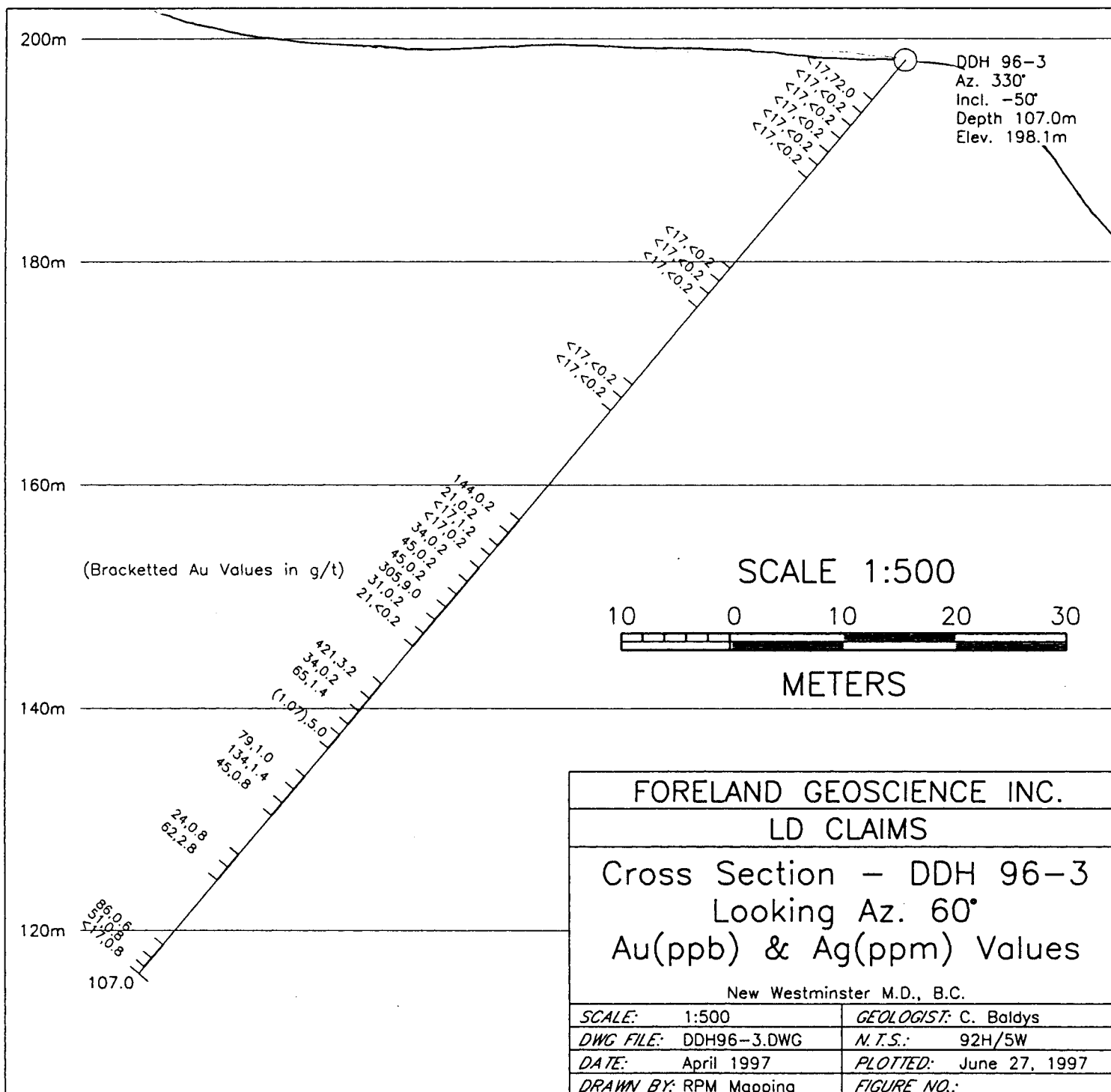

200m

180m

160m

140m

120m

(Bracketted Au Values in g/t)

SCALE 1:500

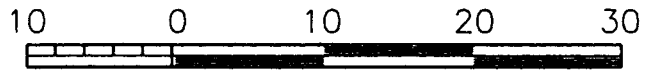

METERS

FORELAND GEOSCIENCE INC.

LD CLAIMS

Cross Section - DDH 96-3  
Looking Az. 60°  
Au(ppb) & Ag(ppm) Values

New Westminister M.D., B.C.

SCALE:	1:500	GEOLOGIST:	C. Baldys
DWG FILE:	DDH96-3.DWG	N.T.S.:	92H/5W
DATE:	April 1997	PLOTTED:	June 27, 1997
DRAWN BY:	RPM Mapping	FIGURE NO.:	

107.0

57.0.8

86.0.8

24.0.8

62.2.8

79.1.0

134.1.4

45.0.8

(1.07).5.0

65.1.4

34.0.2

421.3.2

21.0.2

310.2

305.9.0

45.0.2

45.0.2

34.0.2

144.0.2

21.0.2

21.0.2

17.0.2

17.0.2

17.0.2

17.0.2

17.0.2

17.0.2

17.0.2

17.0.2

17.0.2

17.0.2

17.0.2

17.0.2

17.0.2

17.0.2

17.0.2

17.0.2

17.0.2

17.0.2

17.0.2

17.0.2

17.0.2

17.0.2

17.0.2

17.0.2

17.0.2

17.0.2

17.0.2

17.0.2

17.0.2

17.0.2

17.0.2

17.0.2

17.0.2

17.0.2

17.0.2

17.0.2

17.0.2

17.0.2

17.0.2

17.0.2

17.0.2

17.0.2

17.0.2

17.0.2

17.0.2

17.0.2

17.0.2

17.0.2

17.0.2

17.0.2

17.0.2

17.0.2

17.0.2

17.0.2

17.0.2

17.0.2

17.0.2

17.0.2

17.0.2

17.0.2

17.0.2

17.0.2

17.0.2

17.0.2

17.0.2

17.0.2

17.0.2

17.0.2

17.0.2

17.0.2

17.0.2

17.0.2

17.0.2

17.0.2

17.0.2

17.0.2

17.0.2

17.0.2

17.0.2

17.0.2

17.0.2

17.0.2

17.0.2

17.0.2

17.0.2

17.0.2

17.0.2

17.0.2