

FILE



CORPORATION FALCONBRIDGE COPPER

6415 - 64th Street  
Delta, B.C., Canada V4K 4E2  
Telephone (604) 946-5451

April 3, 1986

826281  
Property Submission  
Spark claim  
92C/16

Mr. Dan Brett  
Baseline Resources Ltd.  
510 - 700 W. Pender Street  
Vancouver, B. C.  
V6C 1G8

Dear Dan:

Sorry for taking so long to get back to you but I only just recently had the opportunity to visit in the vicinity of your Spark claim north of Lake Cowichan. Although we still didn't get onto the claim itself we did get the opportunity to look at the rocks immediately south of the Spark claim.

Unfortunately at this time we are not in a position to be able to make you an offer on your claim. Part of the problem is that it only consists of 20 units and we usually need more ground than that in order to mount an effective exploration program. Also no work has been done on the claim to date. Hopefully I will be able to get a geologist onto the claim itself sometime this summer. I will contact you after that.

Thanks for bringing the claim to our attention. Please contact me if you do any new work on the claim.

Yours truly,

A. J. Davidson  
Senior Exploration Geologist

AJD/ik

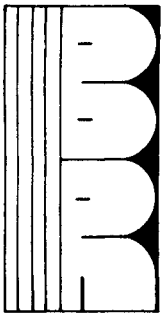

**Baseline Resources Ltd.**

*File NTS  
92 c16*

#510 700 [redacted] W. Pender Street, Vancouver, B.C. [redacted] V6C 1G8  
Office 669-0216 or 273-5635 (Home)

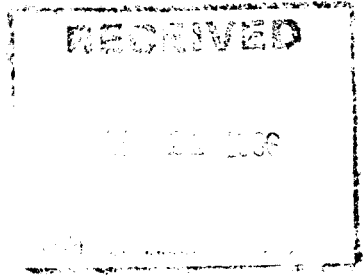

February 19, 1986

Corporation Falconbridge  
6415 64th St.  
Delta, B.C.  
V4K 4E2

Attn: Mr. Alex Davidson

As per our telephone conversation of February 18, 1986, please find enclosed information regarding the Spark Claims, Sicker Volcanics in the Naniamo Lakes Region.

If there are any further questions please don't hesitate to call.

Yours truly

Dan Brett  
Enclosures

DB/lb

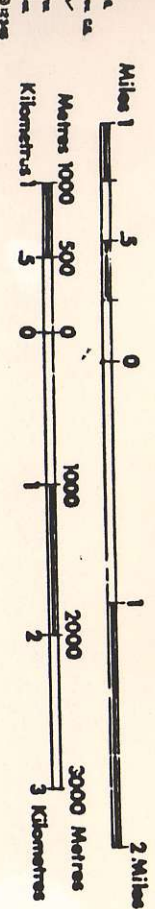

Province of British Columbia  
 Ministry of Energy, Mines and Petroleum Resources

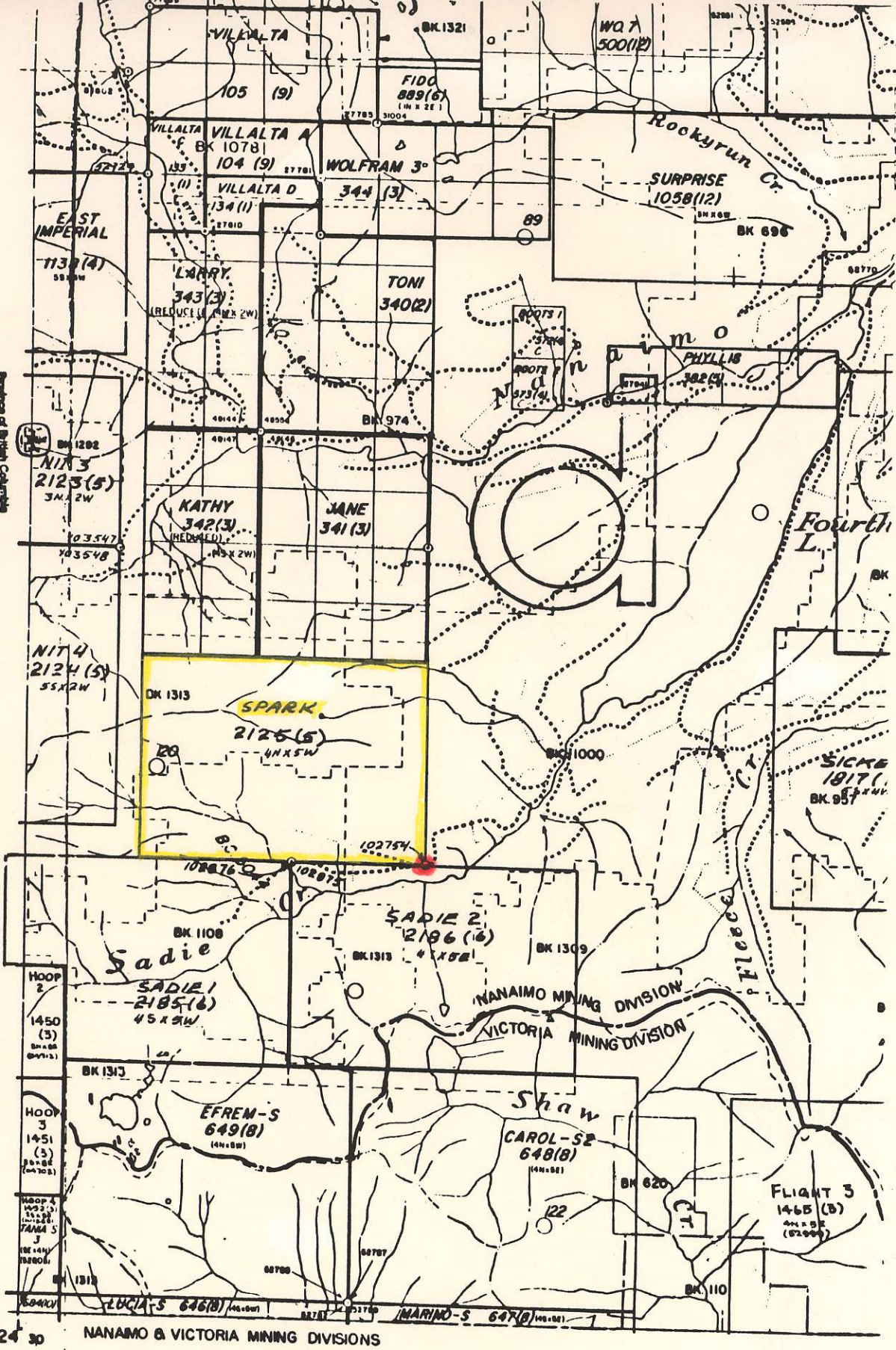

UNLESS VERIFIED ON SURVEYED, THE MAP POSITION OF A LEGAL CORNER POST IS BASED ON THE LOCATOR'S SKETCH. FOR FURTHER INFORMATION, APPLY TO THE OFFICE OF THE MINING DIVISION CONCERNED.

DATE OF MICROFILM: *86.01.16* *ML*

**MS**

- International Boundary
- Provincial Boundary
- Mining Division Boundary
- City or Municipal Boundary
- Bridge
- Tunnel
- Power Transmission Line
- Line

DEPARTMENT

# THISTLE GOLD CAMP

VANCOUVER ISLAND  
B.C.



HIGHWAY 4

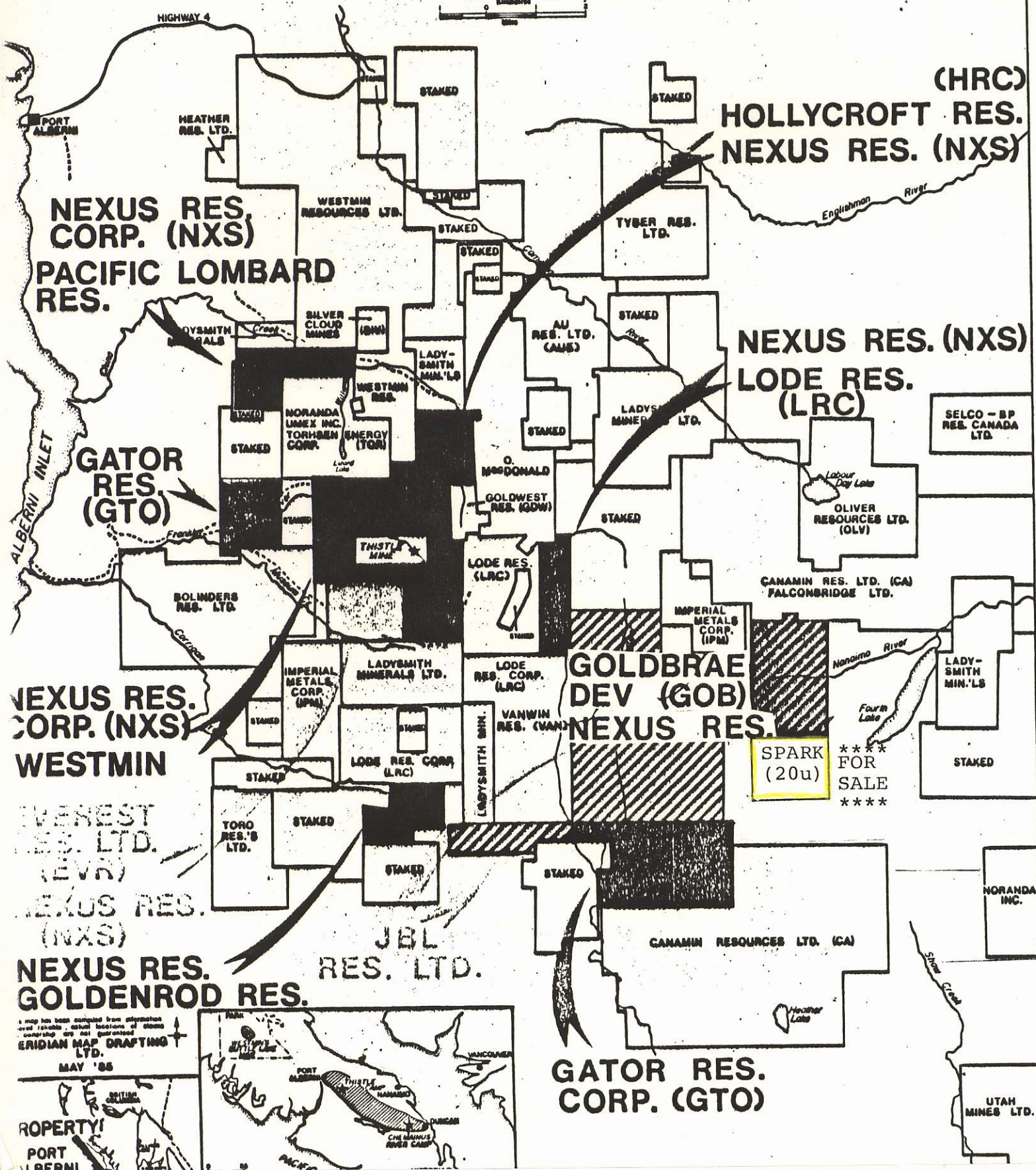

This map has been compiled from information and reliable actual locations of claims. No warranty is made or guaranteed. ERIDIAN MAP DRAFTING LTD. MAY '85



PROPERTY!  
PORT ALBERNI



MAP NO. 92F/1W

FORM G

RECORD NO. 2125 (5)

MINING RECEIPT NO. 166429 B

RECORDED AT Nanaimo

B.C. THIS 8th

DAY OF May

19 85

DO NOT WRITE IN SHADED AREAS

Deputy

GOLD COMMISSIONER

Nanaimo

MINING DIVISION

APPLICATION TO RECORD A MINERAL CLAIM.

NAME DAVID H. BREIT

AGENT FOR

ADDRESS 9311 BRIDGEPORT RD

RICHMOND, B.C. V6X 1S2

VALID SUBSISTING F.M.C. NO. 275190

VALID SUBSISTING F.M.C. NO.

STATE THAT: I COMMENCED LOCATING THE

SPARK

MINERAL CLAIM

ON THE 6<sup>th</sup> DAY OF MAY, 1985 AT 10:15 AM

AND COMPLETED THE LOCATION

ON THE 7<sup>th</sup> DAY OF MAY, 1985 AT 1:30 PM

CONSISTING OF

4 UNIT LENGTHS N AND 5 UNIT LENGTHS W

AND I HAVE IMPRESSED ALL THE REQUIRED INFORMATION

ON METAL TAGS NO. 102754, WHICH HAS BEEN SECURELY FASTENED TO THE POSTS AS REQUIRED UNDER THE REGULATIONS.

IDENTIFICATION POST(S) NOT PLACED WERE 5W1N, 5W2N, 5W3N, 5W4N, 4W4N, 3W4N, 2W4N, 1W4N, 0W3N, 0W2N

CHECK "✓" APPLICABLE SQUARE



THE LEGAL CORNER POST



THE WITNESS POST FOR THE LEGAL CORNER POST

IS SITUATED: AT A POINT

WHICH IS 1.9 Km 47° WEST OF SOUTH FROM THE POINT WHERE SADIE CREEK JOINS FOURTH LAKE ON MAP # 92F/1W IN THE NANAIMO MINING DIV.

† BEARING AND DISTANCE TO TRUE POSITION OF LEGAL CORNER POST FROM THE WITNESS POST

BEARING AND DISTANCE FROM IDENTIFICATION POST TO WITNESS POST

I HAVE COMPLIED WITH ALL THE TERMS OF THE MINERAL ACT AND REGULATIONS PERTAINING TO THE STAKING OF MINERAL CLAIMS AND HAVE ATTACHED A PLAN, ACCEPTABLE TO THE GOLD COMMISSIONER OF THE LOCATION.

GOLD COMMISSIONER

MAY 8 1985 \$100.00

M.R. 1116429E  
NANAIMO, B.C.

OFFICE STAMP

David Breit  
SIGNATURE

NO. OF UNITS 20

WORK NUMBERS	C/L IN \$	MINING RECEIPT AND DATE RECORDED	TYPE OF WORK	DATE OF EXPIRY	CREDIT		TRANSFERS (B/S'S, ASSIGNMENTS, CONVEYANCES)
					WORK IN \$		

OWNER