



CORPORATION FALCONBRIDGE COPPER

6415 - 64th Street
Delta, B.C., Canada V4K 4E2
Telephone (604) 946-5451

FILE
Property Submission
826280
Wabana

November 27, 1986

92c/16

Ms. L. Plimley
Diversified Properties Ltd.
204 - 1551 Cedar Hill X Road
Victoria, B. C.
V8P 2P3

Dear Ms. Plimley;

Thank you for forwarding your data on the Wabana I/II claims to us for our perusal.

At the present time we are not interested to becoming involved with the property. However, our work in the area is ongoing and if our priorities change we may consider it again at a later date.

Yours truly,

Harold Gibson
Senior Exploration Geologist

HG/ik



LINDA PLIMLEY

**DIVERSIFIED
PROPERTIES LTD**

204-1551 Cedar Hill X Rd.,
Victoria, B.C. V8P 2P3
(604) 477-9591 (24 hrs.)

DIVERSIFIED PROPERTIES LTD.

204-1551 Cedar Hill X Rd., Victoria, B.C. V8P 2P3
(604) 477-9591 (24 hrs.)

REAL ESTATE SALES PROPERTY MANAGEMENT



October 9, 1986

Harold Gibson
Corporation Falconbridge Copper
6415-64th Street
Delta, B.C.
V4K 4E2

Dear Mr. Gibson:

I am writing with regard to some staked mining property I recently acquired. It is situated in the Sicker belt just north-northwest of Cowichan Lake.

I have enclosed a map for your reference. The property is registered in my name only, as Wabana 1 and Wabana 2.

A few years back Cedric Steele of International Cherokee Ltd. was prepared to negotiate on this property with the previous owner. Also, Shelly Lier, a Vancouver geologist, did a preliminary investigation of this property and was very favourably impressed.

I wish to dispose of this property. At present I have one offer under consideration but will entertain all other offers for a reasonable period of time.

Due to the recent activity in the area I thought your company might be interested.

Sincerely,

Linda Plimley

Linda Plimley

Home Telephone 385-9854

LP: sb

*Called Oct 27
- will forward
map data?*

New Map
92058

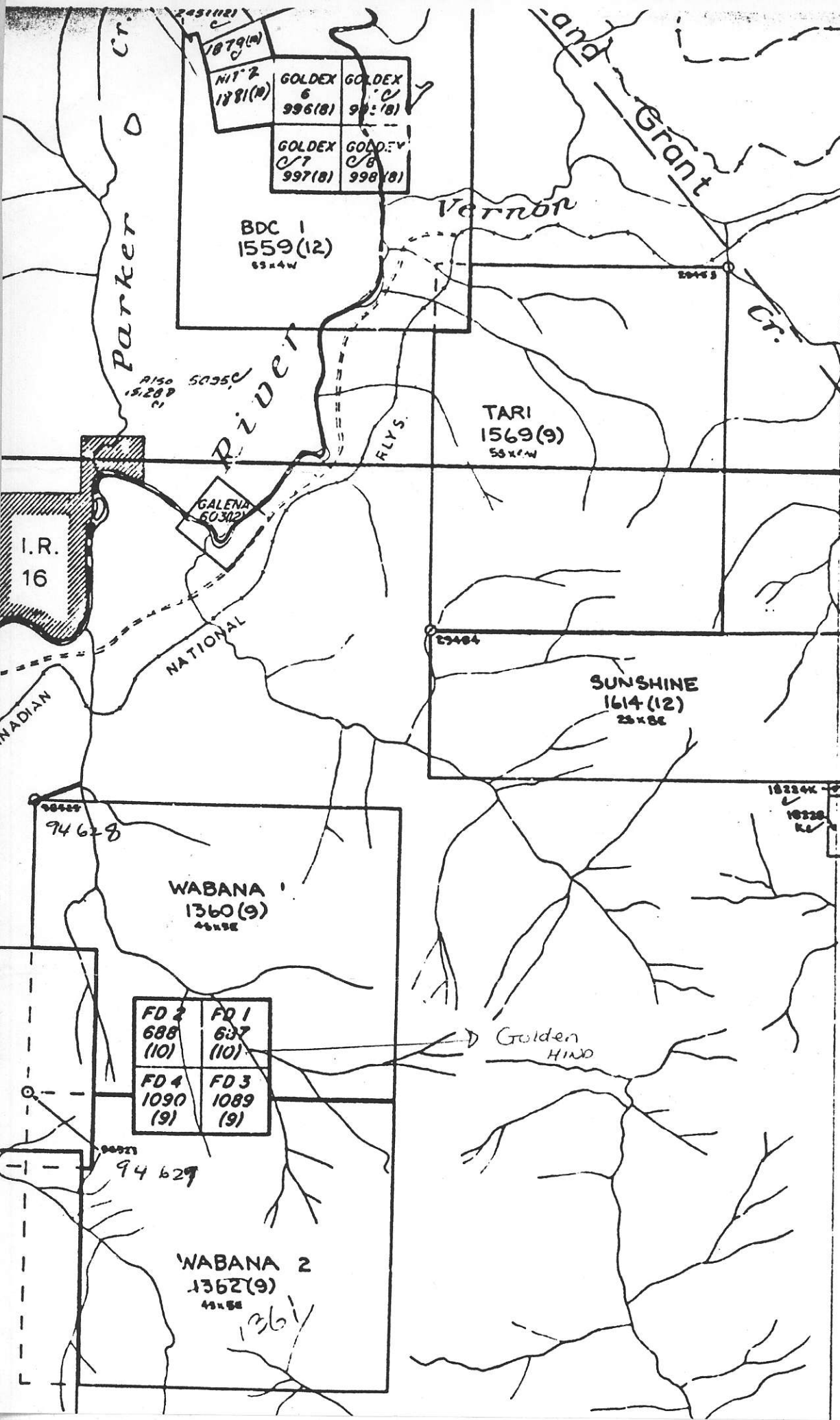

- LEGEND
- CRWM-GRANTED MINERAL CLAIM
 - REVERTED C.G. MINERAL CLAIM
 - FORFEITED MINERAL CLAIM
 - VERIFIED LEGAL CORNER POST
 - LEGAL SURVEY
 - LEGAL CORNER POST & TAG NUMBER

MAP SHEET 1564

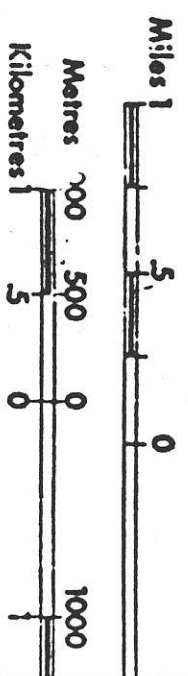

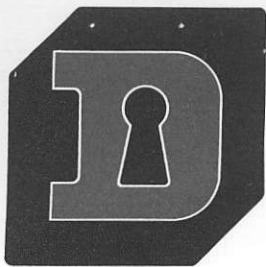

DIVERSIFIED PROPERTIES LTD.

204-1551 Cedar Hill X Rd., Victoria, B.C. V8P 2P3

(604) 477-9591 (24 hrs.)

REAL ESTATE SALES

PROPERTY MANAGEMENT

October 28, 1986

Harold Gibson
Corporation Falconbridge Copper
6415-64th Street
Delta, B.C.
V4K 4E2

Dear Mr. Gibson:

Further to our telephone conversation I am enclosing a map with a rough indication of the samples taken from the property. I have also enclosed the initial assay reports.

I would like to emphasize that the samples were surface samples only as funding prohibited drilling. However, there was very good gold samples taken by dredging from the river crossing through the property.

Sincerely,

DIVERSIFIED PROPERTIES LTD.

Linda Plimley

Linda Plimley

Enclosure

LP:sb

*(pure gold
rough flake
white gold)* *which one*

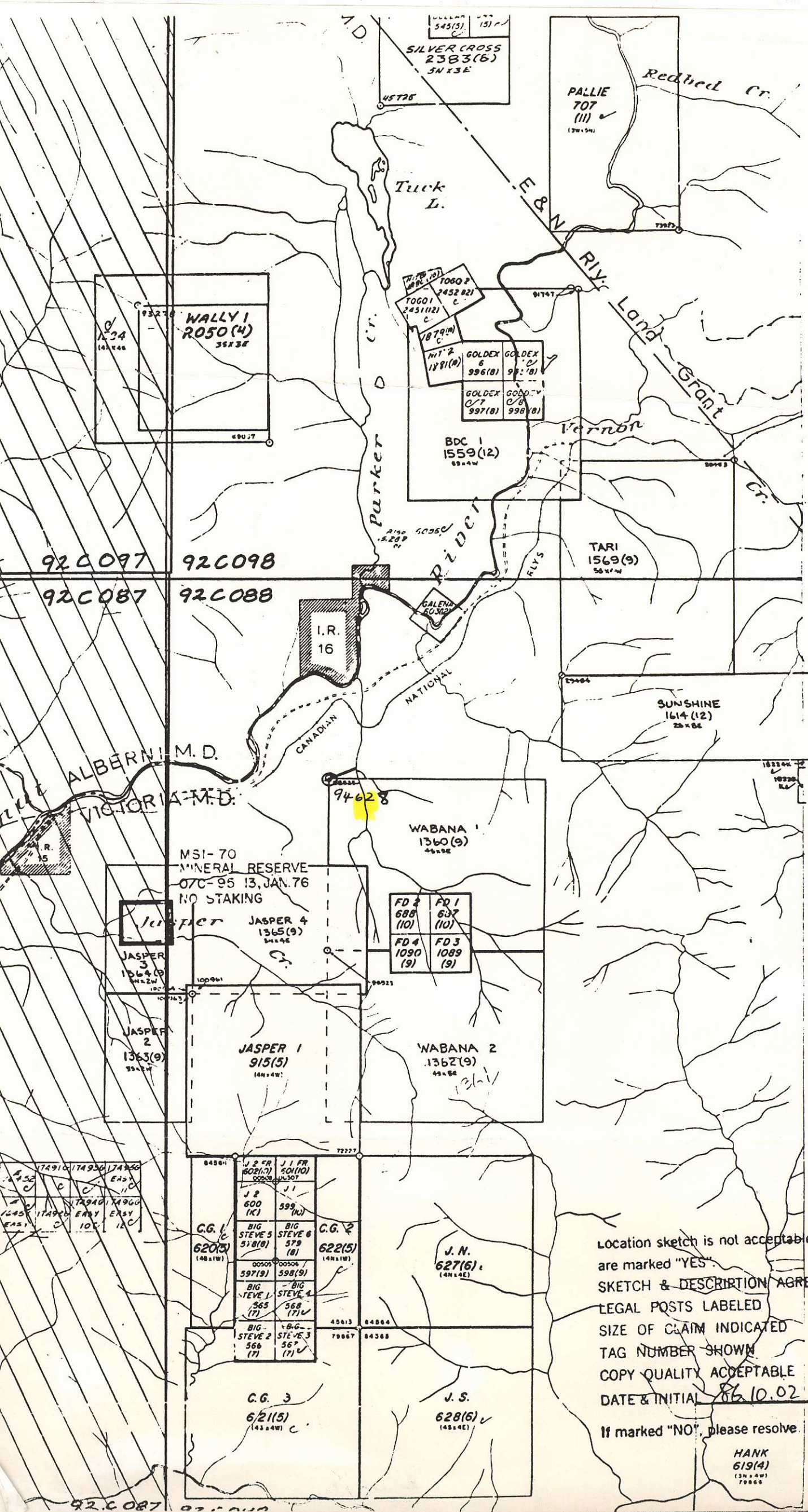

REVERTED C.G. MINERAL CLAIM
 FORFEITED MINERAL CLAIM
 VERIFIED LEGAL CORNER POST
 LEGAL SURVEY
 LEGAL CORNER POST & TAG NUMBER SHOWN

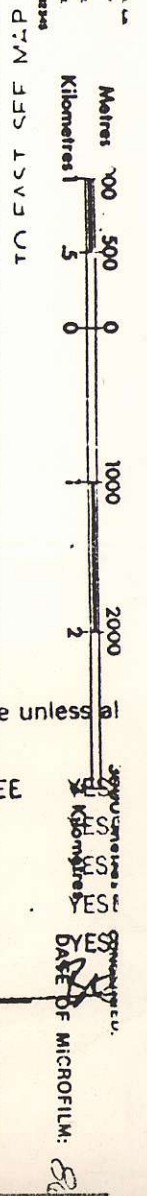

Location sketch is not acceptable unless all
 are marked "YES".
 SKETCH & DESCRIPTION AGREE
 LEGAL POSTS LABELED
 SIZE OF CLAIM INDICATED
 TAG NUMBER SHOWN
 COPY QUALITY ACCEPTABLE
 DATE & INITIAL 86.10.02
 If marked "NO", please resolve

HANK
 619(4)
 (130 x 400)
 79800

MSI-70
 MINERAL RESERVE
 07C-95 13, JAN. 76
 NO STAKING

JASPER
 3
 1564(9)
 (148 x 40)
 100961
 100962

JASPER
 2
 1363(9)
 (148 x 40)
 100963
 100964

JASPER 1
 915(5)
 (148 x 40)
 72277

FD 2
 688
 (10)
 FD 1
 637
 (10)
 FD 4
 1090
 (9)
 FD 3
 1089
 (9)

WABANA 2
 1362(9)
 (148 x 40)
 72277

C.G. 1
 620(5)
 (148 x 110)
 00505
 597(9)
 598(9)
 BIG STEVE 1
 565
 (7)
 BIG STEVE 2
 566
 (7)

C.G. 2
 622(5)
 (148 x 110)
 00506
 599(9)
 579
 (8)
 BIG STEVE 3
 579
 (8)
 BIG STEVE 4
 568
 (7)
 BIG STEVE 5
 567
 (7)

C.G. 3
 621(5)
 (142 x 40)
 C

J.S.
 628(6)
 (148 x 40)

92C097 92C098
 92C087 92C088

TARI
 1569(9)
 (130 x 40)

SUNSHINE
 1614(12)
 (25 x 80)

WABANA 1
 1360(9)
 (148 x 40)

J.N.
 627(6)
 (148 x 40)

ALBERNI M.D.
 VICTORIA M.D.

I.R.
 16

BDC 1
 1559(12)
 (89 x 40)

WALLY 1
 2050(4)
 (55 x 30)

GOLDEN
 6
 996(8)
 GOLDEN
 7
 997(8)
 GOLDEN
 8
 998(8)
 GOLDEN
 9
 999(8)

TOGO 1
 2431(12)
 C
 TOGO 2
 2452(12)
 C
 TOGO 3
 2453(12)
 C

SILVER CROSS
 2383(6)
 (51 x 30)

PALLIE
 707
 (11)
 (130 x 50)

CERTIFICATE OF ASSAY

Date: April 25, 1985

File: 8504-2254



SGS SUPERVISION SERVICES INC.
 General Testing Laboratories Division
 1001 East Pender Street,
 Vancouver, B.C., Canada. V6A 1W2
 Telephone: (604) 254-1647
 Telex: 04-507514

TO: **WABANA GOLD LTD.**
 1308 Gladstone Ave.,
 Victoria, B.C.

We hereby certify that the following are the results of ~~assays~~ ICP analysis on submitted ore samples

MARKED	GOLD		SILVER		Mo (ppm)	Cu (ppm)	Pb (ppm)	Zn (ppm)	Ni (ppm)	Co (ppm)
	Au(ppm)	Ag(ppm)	Mo (ppm)	Cu (ppm)						
WABANA I										
2 x 2	ND	1	16.9	17.8	10	20	5	12		
2 x 3	ND	5	0.6	250	10	79	66	61		
2 x 4	ND	6	6.2	282	10	108	97	84		
	Mn (ppm)	Fe (%)	As (ppm)	U (ppm)	Th (ppm)	Sr (ppm)	Cd (ppm)	Sb (ppm)		
2 x 2	212	2.95	70	ND	ND	221	ND	46		
2 x 3	884	10.3	130	ND	ND	326	ND	51		
2 x 4	1145	8.85	120	ND	ND	221	ND	52		
	Bi (ppm)	V (ppm)	Ca (%)	P (ppm)	La (ppm)	Cr (ppm)	Mg (ppm)	Ba (ppm)		
2 x 2	10	51	1.2	678	ND	173	6617	1445		
2 x 3	10	443	8.1	1416	ND	151	2191	213		
2 x 4	10	416	8.3	1109	ND	129	2426	329		
	Ti (%)	B (ppm)	Al (%)	Na (%)	K (%)	W (ppm)				
2 x 2	0.23	1175	6.80	3.26	1.56	10				
2 x 3	1.66	372	6.93	0.28	2.12	10				
2 x 4	1.44	1657	6.20	0.32	1.80	10				

NOTE: REJECTS RETAINED ONE MONTH. PULPS RETAINED THREE MONTHS ON REQUEST PULPS AND AND REJECTS WILL BE STORE FOR A MAXIMUM OF ONE YEAR.

ALL REPORTS ARE THE CONFIDENTIAL PROPERTY OF CLIENTS. PUBLICATION OF STATEMENTS, CONCLUSION OR EXTRACTS FROM OR REGARDING OUR REPORTS IN NOT PERMITTED WITHOUT OUR WRITTEN APPROVAL ANY LIABILITY ATTACHED THERETO IS LIMITED TO THE FEE CHARGED.

P. Buschlen, Chemist

PRINTED ON RECYCLED PAPER

Analytical and Consulting Chemists, Bulk Cargo Specialists, Surveyors, Inspectors, Samplers, Weighers

= Not detected.

MEMBER: American Society For Testing Materials • The American Oil Chemists Society • Canadian Testing Association

ASSAY CERTIFICATE

1.00 GRAM SAMPLE IS DIGESTED WITH 50ML OF 3-1-3 OF HCL-HNO₃-H₂O AT 95 DEG. C FOR ONE HOUR,
AND IS DILUTED TO 100ML WITH WATER. DETECTION FOR BASE METAL IS .01%.

- SAMPLE TYPE: ROCK CHIPS AU: 10 GRAM REGULAR ASSAY

DATE RECEIVED: APR 22 1985 DATE REPORT MAILED: *April 25/85* ASSAYER: *J. Saundry* DEAN TOYE OR TOM SAUNDY, CERTIFIED B.C. ASSAYER

WABANA GOLD LTD FILE # 85-0430

PAGE 1

SAMPLE#	Mo %	Cu %	Pb %	Zn %	Ag oz/t	Ni %	Co %	Mn %	Fe %	As %	U %	Th %	Cd %	Sb %	Bi %	Au oz/t
2X5	.001	.03	.01	.01	.02	.01	.001	.08	8.64	.01	.002	.01	.001	.001	.001	.001
2X6	.001	.06	.01	.01	.07	.01	.010	.10	9.05	.01	.002	.01	.001	.001	.001	.001
2X7	.001	.03	.01	.02	.01	.01	.010	.09	8.14	.01	.002	.01	.001	.001	.002	.001