

To: Peter Daubney
From: Colin Burge
Copies: IM
Date: Nov. 26,/96

Subject: **TEXADA FOLLOW-UP**

A compilation of copper-gold deposits in SE Asia has resulted in the development of an exploration model (see attached) whereby copper-gold porphyries are surrounded by magnetite-rich copper/gold skarns. Many of the world's best deposits of this type are in PNG and Irian Jaya. They are hosted in limestones and developed in a tectonic setting which is similar to the Western Cordillera during the Mesozoic. Several a iron skarn camps are present in BC's Insular belt with the most prolific being TEXADA ISLAND

Last summer sampling of the TEXADA Island skarns camp confirmed a metallogenic copper-gold signature. As well, several samples collected from the intrusive rocks returned anomalous copper-gold. NO PREVIOUS WORKERS IN THE CAMP HAVE EVALUATED THE INTRUSIVE-HOSTED DEPOSIT POTENTIAL.

Target

- Bulk mineable copper-gold porphyry deposit: +100Mt, 0.6% Cu, 0.5 g/t Au.

RECOMMENDED FOLLOW-UP

- Rock sampling to cover anomalous stocks on 50-100meter centers. (Volunteer)
- Reconnaissance and recce sampling to cover other stocks associated with mag anomalies.

Obtain samples of the PRIESTLY LAKE STOCK for thin section. (Myrmekitic cavities)

Estimated time 2 days, 50 samples. Please charge time and expenses to **683-503**

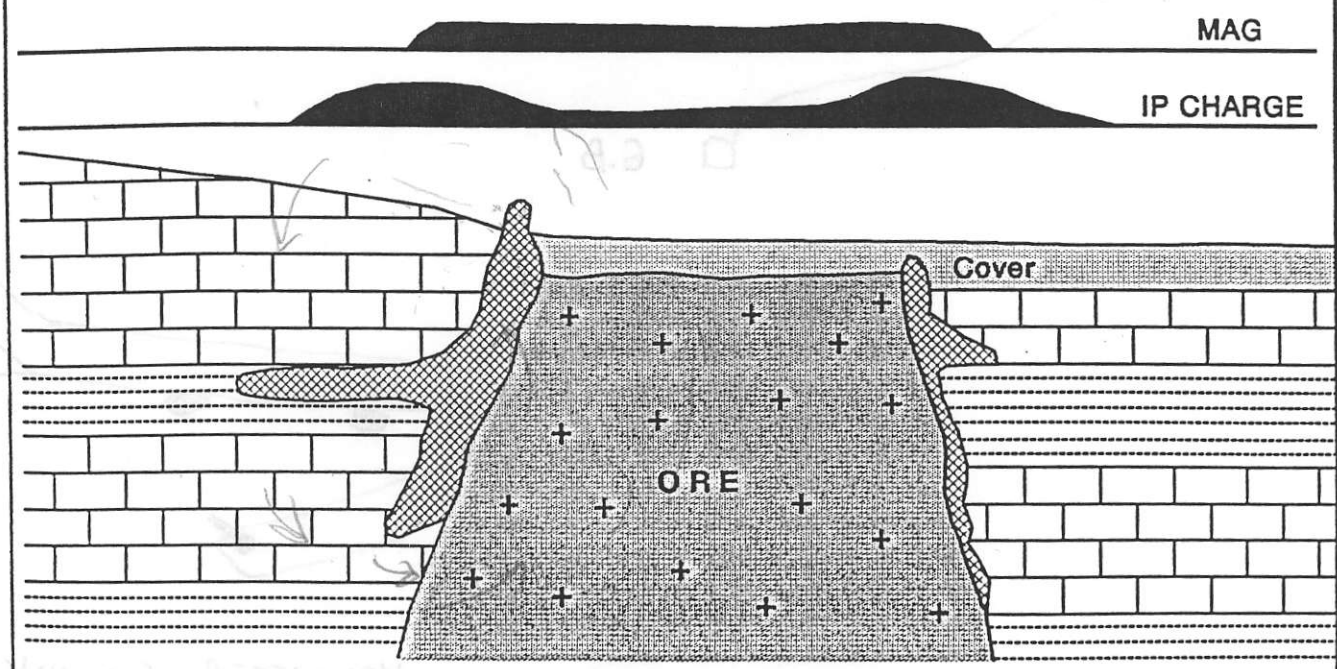
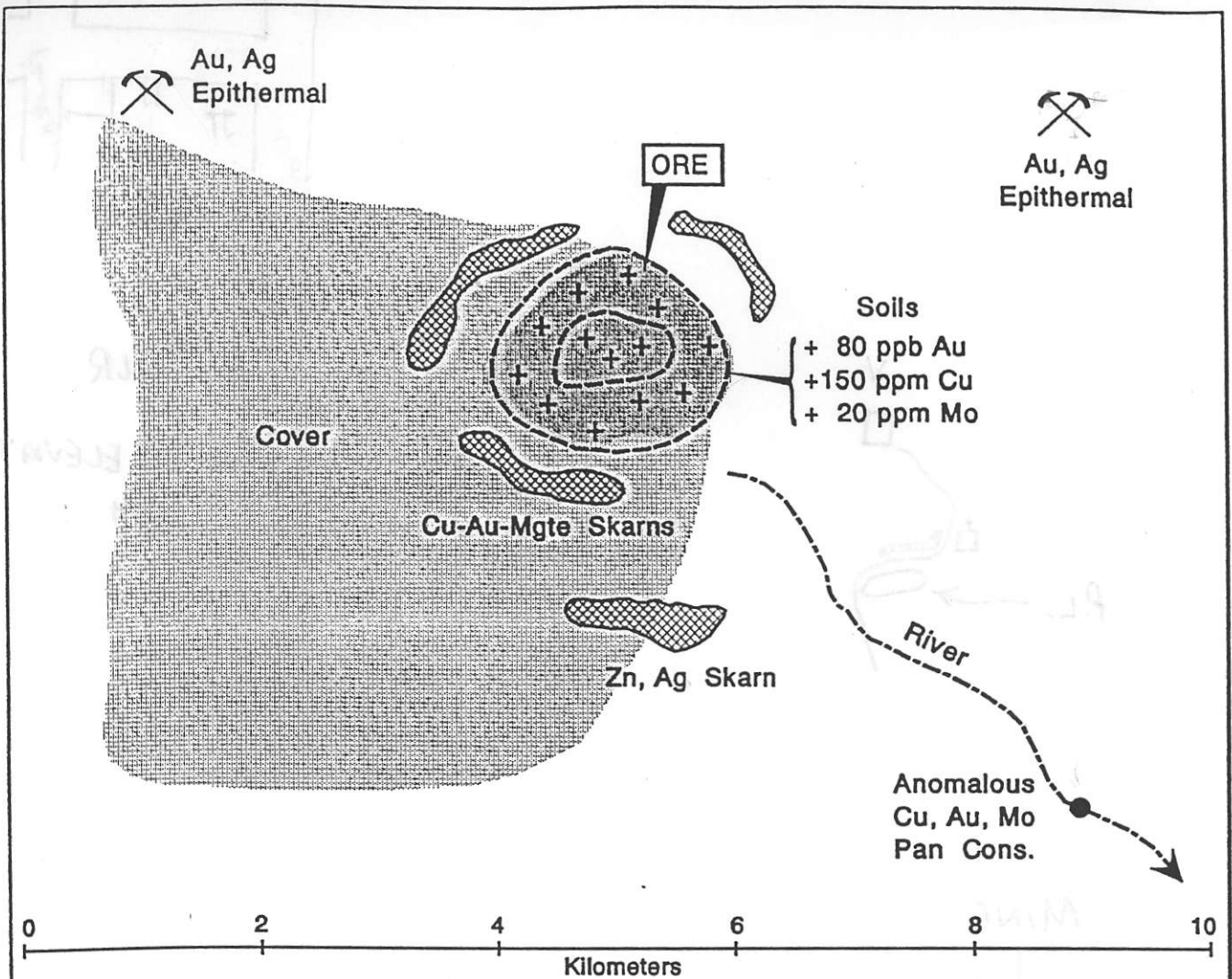

Cu - Au PORPHYRY EXPLORATION MODEL

Epithermal
Au, Ag

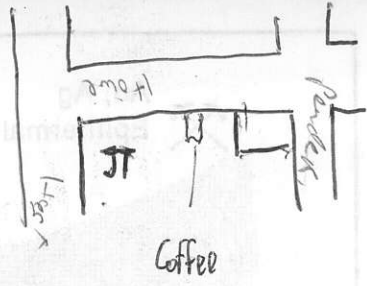

11TH FLR
TOP OF ELEVATOR
16TH



MINE



G.B

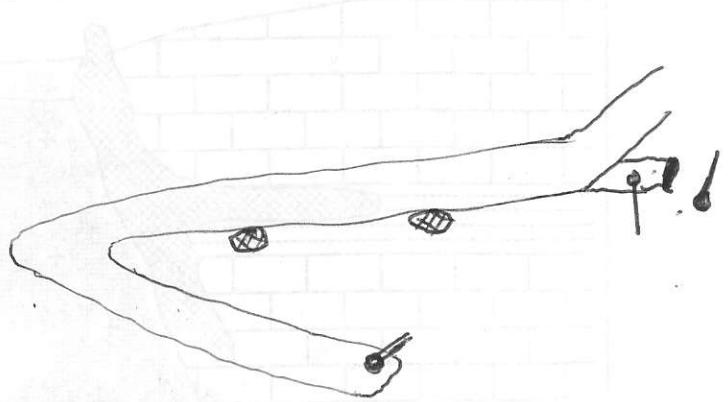

VOLUNTEER SHOWING

Cu-Au PORPHYRY EXPLORATION MODEL