

92G/16

826153

Aug 29/80

Fire Creek, South from LCP

Hela & Fire, North side of Creek

#1392G White schist intense

fol N112E/86S, greasy

talc - scapolite? intense altered

folded post foliation. Schist

contain altered qtz veins

by C651 (hand specimen)

minor py in qtz veins or silic

layers

200 m to inaccessible cliff

#1393G by C647 intense

silic gray 1% diss py moderate

to minor fol

#1394G 70mm barren qtz vein

by C646 5m to the SW

S of C-643 #1395G Intense silic

dark green 2% diss py

#1396G by C-593 intense silic

black calcedonian + py

#1397G by C-591 intense silic

minor black calcedonian 2% diss

py, minor fol

#1398G by C-589 fine grained/

ophanitic black massive with locally
concordant fract calcidony, locally
minor fol.

#1399G by C-590 Intense
fol schist talc rich greasy
N113 E/67N locally Fe^C oxide
on surface qtz vein ||
fol 25mm (barren)
qtz veins || fol throughout
either as lenses or veins
to .5m

#1400G by C589 Qtz
vein with cubic py to
7mm greasy talc rich
schists as host



Chemex Labs Ltd.

Analytical Chemists • Geochemists • Registered Assayers

212 Brooksbank Ave.
North Vancouver, B.C.
Canada V7J 2C1
Phone: (604) 984-0221
Telex: 043-52597

CERTIFICATE OF ANALYSIS

TO : KERR ADDISON MINES LTD.
(ATTN: RAY DUJARDIN)
703 - 1112 W. PENDER ST.
VANCOUVER, B.C.
V6E 2S1

C/O

SAME ADDRESS

CERT. # : A8617588-001-A
INVOICE # : 18617588
DATE : 16-SEP-86
P.O. # : 24562
B-02A-07

ATTN: RAY DUJARDIN CC: ART CLENDENAN ✓

Sample description	Prep code	Cu ppm	Pb ppm	Zn ppm	Ag ppm Aqua R	AS ppm	Hg ppb
- 1392 G	207	20	10	5	0.1	150	30
1393 G	207	15	41	3	0.1	20	100
1394 G	207	8	5	2	0.1	1	40
1395 G	207	287	12	150	0.1	30	110
- 1396 G	207	63	13	16	0.8	30	230
1397 G	207	50	17	10	0.7	60	190
- 1398 G	207	40	57	7	3.8	30	640
- 1399 G	207	66	48	91	1.6	60	630
1400 G	207	65	1	123	1.2	11	200
12998 G	207	--	--	--	--	--	--
12999 G	207	--	--	--	--	--	--
13000 G	207	--	--	--	--	--	--

*Fire Creek
929/116
NORTH SIDE
OF CREEK*

*MOUNT
PIERRE*

Certified by *Hart Bichler*



Chemex Labs Ltd.

Analytical Chemists • Geochemists • Registered Assayers

212 Brooksbank Ave.
North Vancouver, B.C.
Canada V7J 2C1
Phone: (604) 984-0221
Telex: 043-52597

CERTIFICATE OF ANALYSIS

TO : KERR ADDISON MINES LTD.
(ATTN: RAY DUJARDIN)
703 - 1112 W. PENDER ST.
VANCOUVER, B.C.
V6E 2S1

CERT. # : A8617588-001-B
INVOICE # : I8617588
DATE : 16-SEP-86
P.O. # : 24562
B-02A-07

ATTN: RAY DUJARDIN CC: ART CLENDENAN

Sample description	Prep code	Sb ppm	Ba ppm				
1392 G	207	4.0	1160	--	--	--	--
1393 G	207	1.9	1320	--	--	--	--
1394 G	207	0.5	2900	--	--	--	--
1395 G	207	0.8	1180	--	--	--	--
1396 G	207	7.6	60	--	--	--	--
1397 G	207	7.0	80	--	--	--	--
1398 G	207	7.4	2100	--	--	--	--
1399 G	207	13.8	3400	--	--	--	--
1400 G	207	4.4	580	--	--	--	--
12998 G	207	--	--	--	--	--	--
12999 G	207	--	--	--	--	--	--
13000 G	207	--	--	--	--	--	--

Certified by Hart Bichler



Chemex Labs Ltd.

212 Brooksbank Ave.
North Vancouver, B.C.
Canada V7J 2C1

Analytical Chemists • Geochemists • Registered Assayers

Phone: (604) 984-0221
Telex: 043-52597

CERTIFICATE OF ASSAY

TO : KERR ADDISON MINES LTD.
(ATTN: RAY DUJARDIN)
703 - 1112 W. PENDER ST.
VANCOUVER, B.C.
V6E 2S1

CERT. # : A8617588-001-A
INVOICE # : I8617588
DATE : 16-SEP-86
P.O. # : 24562
B-02A-07

ATTN: RAY DUJARDIN CC: ART CLENDENAN

Sample description	Prep code	Au g/tonne					
1392 G	207	0.07	SCHIST	--	--	--	--
1393 G	207	0.21	SCHIST SILICIFIED	--	--	--	--
1394 G	207	<0.07	QTZ VEIN BARREN	--	--	--	--
1395 G	207	0.07	SILICIFIED TUFF	--	--	--	--
- 1396 G	207	1.23	BLACK-CHALCEDONY	--	--	--	--
1397 G	207	0.48	SILICIFIED SCHIST MINOR	--	BLACK CHALCEDONY	--	--
- 1398 G	207	9.60	BLACK-CHALCEDONY	--	1-2 ft thick + vertical	--	--
1399 G	207	0.41	FOLIATED SCHIST	--	--	--	--
1400 G	207	0.34	QTZ VEIN	--	--	--	--
12998 G	207	2.33	QTZ VEIN WITH PYRPH	--	--	--	--
12999 G	207	<0.07	BARREN-QTZ VEIN	--	--	--	--
13000 G	207	56.08	ADIT QTZ-PYRPH VEIN	--	--	--	--

TIRE CREEK

MOUNT PIERCE

W. N. ...
Registered Assayer, Province of British Columbia

VOI rev. 4/85

1733 (I)
LELA
5N 4W

1734 (I)
FIRE
5N 4E

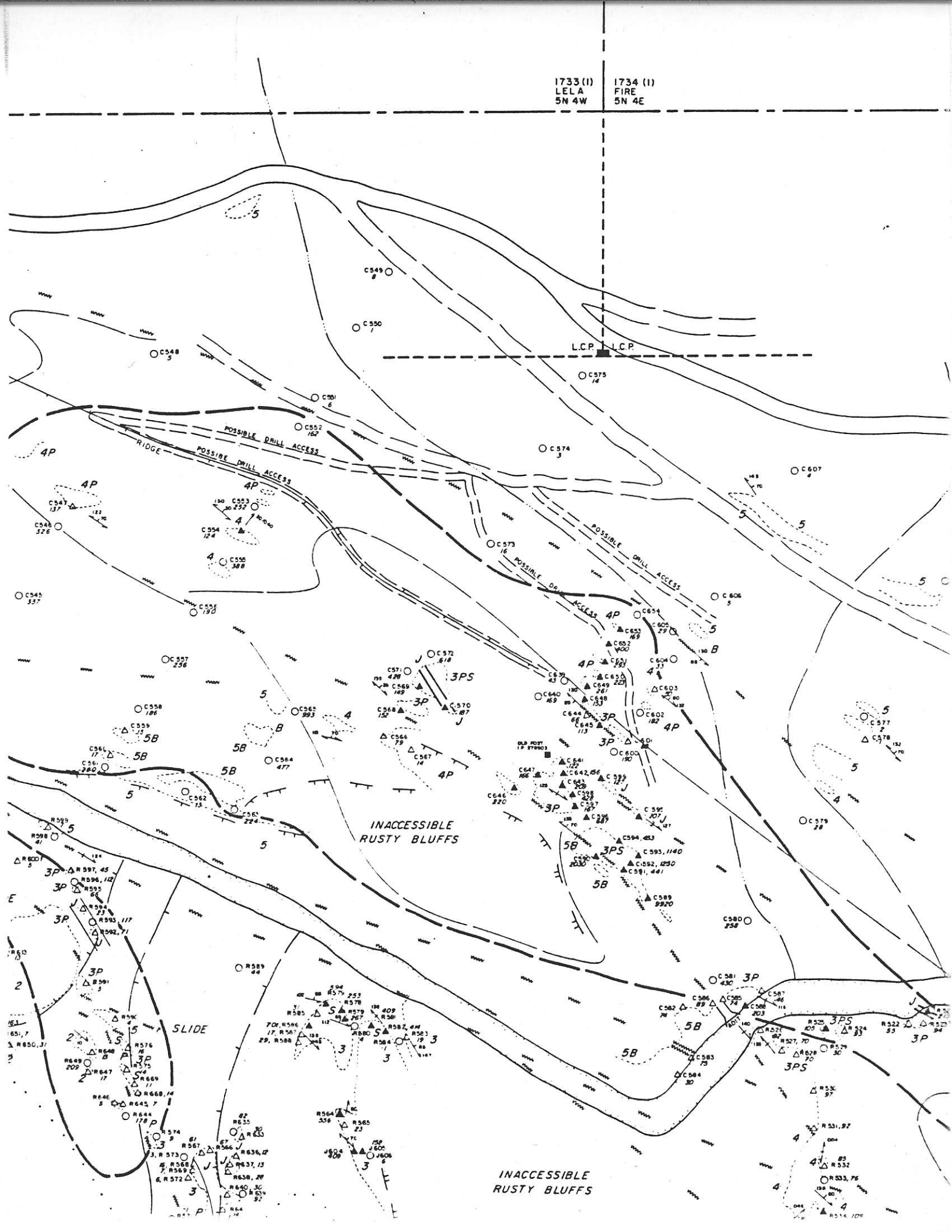

CC to

RAD for info/status.

13 Aug 86

5 Mar 86

PROPERTY NAME: HADES + BRIMSTONE

PROPERTY/PROJECT DATA FORM

Date: 20/2/86

ACTIVE FILE: Y or N

RECOMMENDATION -

CLAIM NAMES: HADES + BRIMSTONE

Recommended: Y or N

LOCATION -

Toronto Approval: Y or N

REGION: N. end Harrison Lake;

Owner Notified: Y or N

PROVINCE/STATE: BC

Report Written: Y or N

N.T.S./Twp.-Rnge 92 G 16 E + W

LEGAL -

Lat/Long: 49° 47' N 122° 14' W

Underway: Y or N

COMMODITY: Au, Ag, Pb, Zn, Cu, As, S

Completed: Y or N

OWNERSHIP -

DATA -

Owner(s): HYCROFT RES. / K. Wayne

Returnable: Y or N

Contact: James E. Yates / ^{Pres} 11/11/84

Returned: Y or N

Tel.No: 683 565 /

File No: _____

Address: #1250-1055 West Georgia St

File Location: _____

Vanc. BC

Monthly Reports: _____

INITIATION -

Other Refs: Hycroft Prospectus of 7 Dec 83
red 4 July 84; GENC Hycroft 17 Feb 86;
BENMARPT. 9783. Not seen.

Initiator: RAD/ABC

Date: 20/2/86 / 20/2/86

Submittal: Y or N

KEY QUESTION(S):

Solicitation: Y or N

① - Is this another JMT
Services make work claim block?

STATUS -

Data Studied: Y or N

Exam planned: Y or N - depends on Yed. Prop still avail Aug 86

Examined on: Aug 17

By: TER BRULAND

② Are values significant in
terms of potential tonnes?

③ Is data available from Hycroft
to view before possible prop
exam. YES MONDAY
10 AM 24 Feb

CAPSULE DESCRIPTION (Incl. legal):

Loc. - 7 km N.W. of N end Harrison Lk., 74 km by rd Nat
Harrison Mills.

Geol - Fire lake volc + sed pendant in Coast Plutonic complex
locally faulted, sheared, sericitic, pyritized, remnant in volc + seds.

Mineral. anomalous Au/Ag - locally 100 to 1950 ppb Au in Brx + soil
avg of all samples in = 20 ppb range, maps of
locations not in prospectus. Ag to 6.1 ppm, As .2

Ownership - 100% by Hycroft - in good standing to 24 Oct '84
as of 18 Feb 83

From H.H.S	59581.2 km	> 6.2	
onto Hwy 7	59587.4 km	> 14.5	- 6.2 km
right by Harrison Mills	59601.9 km	> .2	- 20.7 km
right toward Hemlock Valley	59602.1 km		- 20.9 km
West side H.L. to Winham Logging camp along Liolloet River X Fire creek turn left on old road.		> 94.6	
	59696.7 km	≡	115.5 0.4 1.7 7
		> 1.7 km	
turn around by side road by LCP LELA 8 FIRE	59698.4 km		- 117.2
back to main road	59700.1 km		