

Date: October 19, 1995  
To: File  
From: Peter Daubeny/ Ian Morrison  
Subject: Todd Creek Property NTS 104A4E,W and 104A5E,W

### Introduction, Location and Access

The Todd Creek Property is located in the Skeena Mining Division about 35 km north-northeast of the town of Stewart BC. Access to the property is by helicopter from Stewart. Alternatively, access could be gained by existing road and barge service to the west end of Bowser Lake, followed by a 10 km helicopter ferry to the property. The property consists of 430 claim units that cover approximately 107 square kilometers. The property is currently owned by Geofund of Union Ville, Ontario.

### Geology and Mineralization

Recent geological mapping by the GSC shows the Todd Creek region to be underlain by volcanic and volcanoclastic rocks of the Lower Jurassic Hazelton Group. On the Todd Property these rocks have been variably altered and mineralized as epitomized by at least 12 showings reported to have anomalous gold and base metal values. Included in these showings is the South Zone, currently held by Noranda, on which a deposit of 207,000 tons grading 5.48 Au/t has been outlined. A half day was spent on the property on September 27, 1995. During the visit, Inmet personnel were accompanied by Dave Kennedy of Geofund.

Two showings, the B Zone and the Amarillo Zone, were examined on the ground. The B Zone is exposed in outcrop and trenches and consists of at least two 10 centimeter to 1 meter wide epithermal type quartz-veins bearing chalcopyrite, sphalerite and galena. Sampling by Geofund has reported up to 2.2 g/t Au over a maximum width of 6.5 meters. Also observed in the vicinity of the veins were two breccia dikes consisting of milled volcanic and intrusive looking clasts in a pyritic matrix. These dikes displayed sharp igneous looking contacts that appeared to cross-cut volcanic stratigraphy. The B Zone lies approximately 500 meters north of the Fall Creek Zone. Drilling by Noranda in the Fall Creek Zone returned a number of <sup>ore</sup> grade intersections (e.g. 12.7 g/t Au over 1.25 meters and 3.94 g/t over 7.9 meters). This mineralization is reported to be open along strike and at depth.

The other showing examined was the Amarillo Zone. This zone is evidenced by a large gossan exposed in cliffs at the head of a small creek. This gossan is characterized by volcanic or volcanoclastic sequence bearing disseminated pyrite and displaying strong sericite alteration. Below the gossan, altered basalts and andesites have been cut by barite veins. A random grab sample from the gossan returned 18 ppb Au, 3.4 ppm Ag and low base metal values.

Although the weather on the day of this tour was not bad, low valley fog prevented the examination of the Yellow Bowl Zone and the Ice Creek showings. In the Yellow Bowl Zone anomalous gold (200-500 ppb) combined with copper values have been obtained over widths of up to 6 meters. In addition, chip samples assaying over 1.5 g/t Au and 9.8% Cu over 1 meter and a number of gold/ copper anomalies in stream sediments have been interpreted to indicate a large target area. The Ice Creek Zone is reported to host a quartz stock work and accompanying veining all mineralized with cpy. A previous operator, Oracle Minerals Inc, reported values of up to 32.91 g/t gold in grab samples from outcrop and float from the Ice Creek zone (GCNL # 195, October 12, 1994)

### Conclusions and Recommendations

Wide spaced epithermal quartz-vein systems evidenced in the B Zone exhibit low (< 2.5 g/t) Au values and limited tonnage potential. Barite veining and a large pyritic gossens exhibiting strong sericite alteration evidenced in the Amarillo Zone are intriguing. However, evidence for associated ore grade mineralization should be required before any commitment by this Company be undertaken.

However, in view of the fact that the Stewart Camp hosts a number of past producers and numerous prospects, the Yellow Bowl and Ice Creek Zones maybe worth a second look if we are in the Stewart area again. An arrangement to view core stored on Noranda's South Zone deposit should be obtained prior to such a visit.

LAND DISTRICTS:

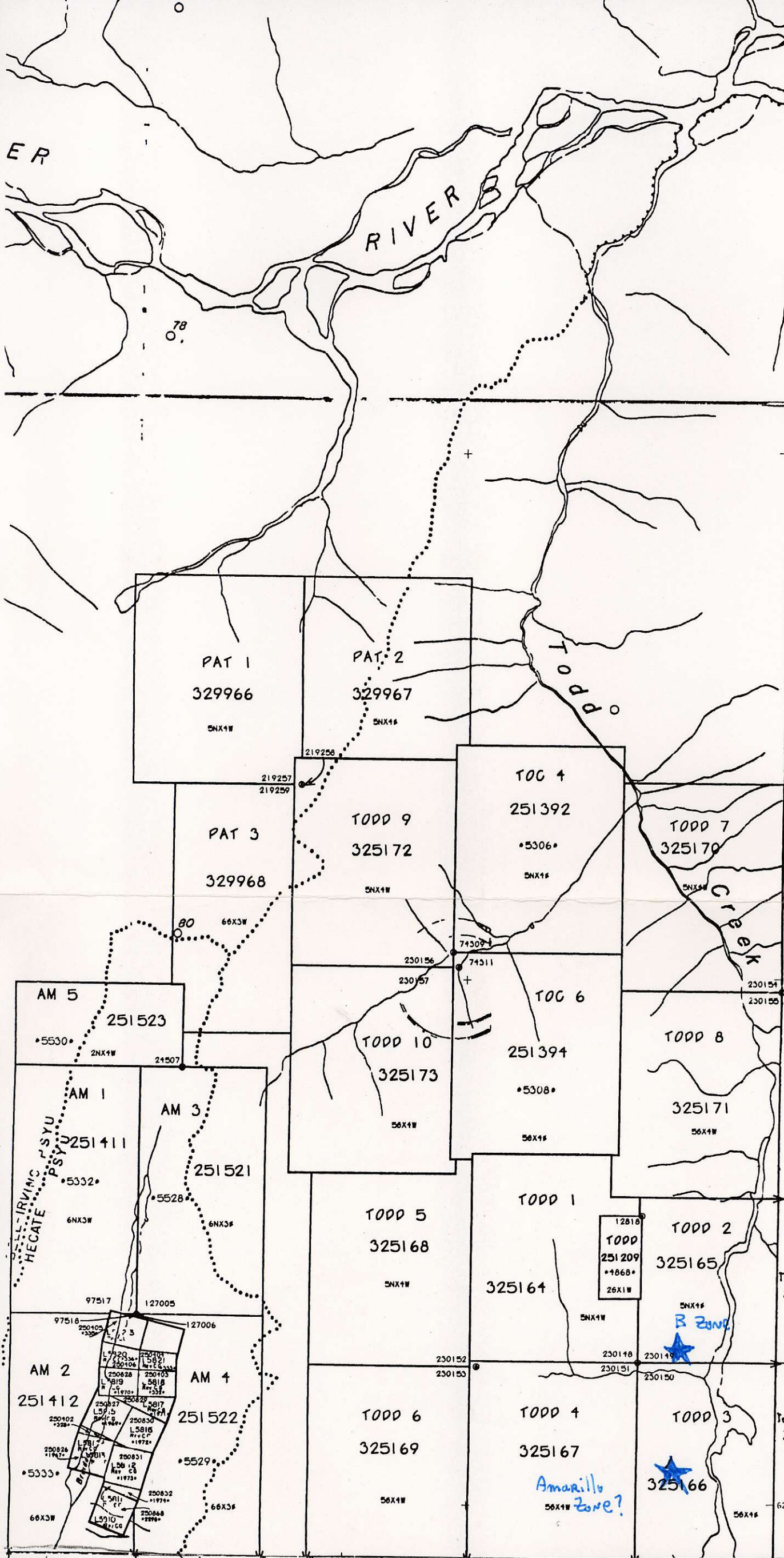

ALIENATIONS

- NO STAKING AREAS
- NO STAKING RESERVES
- PARKS
- ECOLOGICAL RESERVES
- RECREATION AREAS
- INDIAN RESERVES

CONDITIONAL AREAS

- SUBJECT TO CONDITIONS RESERVES
- SECTION 19 RECREATION AREAS
- POST CLAIM AREAS

AREAS SUBJECT TO URANIUM / THORIUM REGULATIONS

MINERAL TENURE

- MINERAL CLAIM
  - MINERAL LEASE
  - INDUSTRIAL MINERAL CLAIM
- |                             |               |
|-----------------------------|---------------|
| CLAIM NAME                  | EXAMPLE       |
| TITLE NUMBER                | 345679        |
| OLD TITLE NUMBER            | 3456          |
| TAG NUMBER                  | 100000        |
| LEGAL POST                  | ⊙             |
| WITNESS POST                | ⊙             |
| FORFEITED TENURE            | C             |
| VERIFIED                    | V&R           |
| SURVEYED                    | 8UR           |
| REVERTED C.G. MINERAL CLAIM | REV CG OR RCG |
| CROWN GRANTED               | C G           |
| OPEN FOR STAKING            | O.F.S.        |

UNIT	2 POST CLAIM	OLD 2 POST CLAIM
1640.42 ft	1640.42 ft	1500 ft
25 ha 61.78 ac	25 ha 61.78 ac	20.90 ha 51.65 ac
500 m	500 m	497.2 m

