

Athelstan-Jackpot  
1991 Mapping

825625

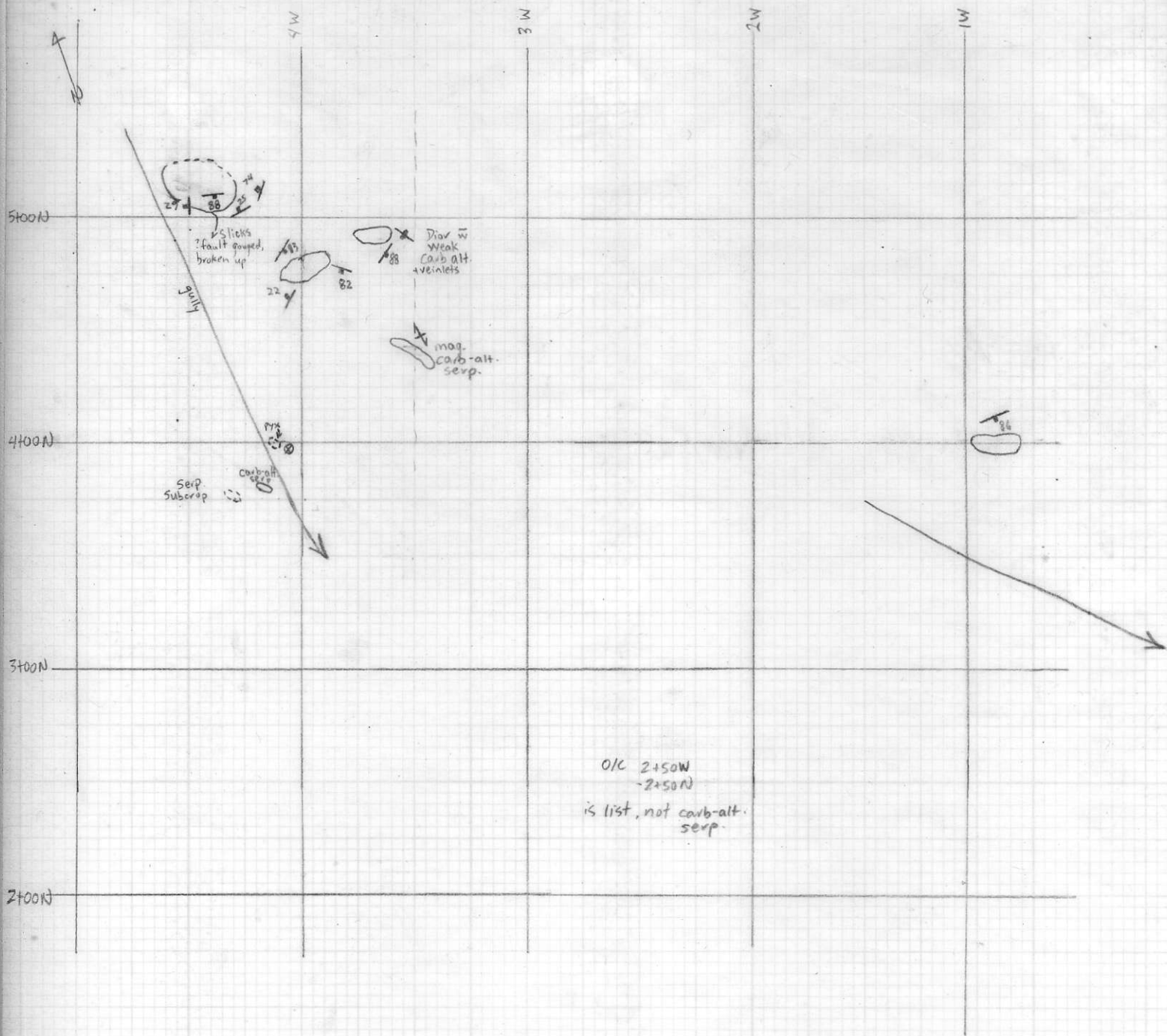

Joint: 199/68 in pyroxenite at 1+50E/1+75N

100  
Qp5

OK 2+50W  
-2+50N  
is list, not carb-alt.  
serp.

LOT 100



Handwritten notes and symbols near the top intersection, including '1/8', '1/2', and '1/4' with arrows pointing in various directions.

11005

2400W

2+50 W  
1+50 S

11005

Handwritten notes and symbols at the bottom left, including '1/8', '1/2', and '1/4' with arrows.

0+50 S

1:100  
05/16/91  
R. Holder  
M. McDowell

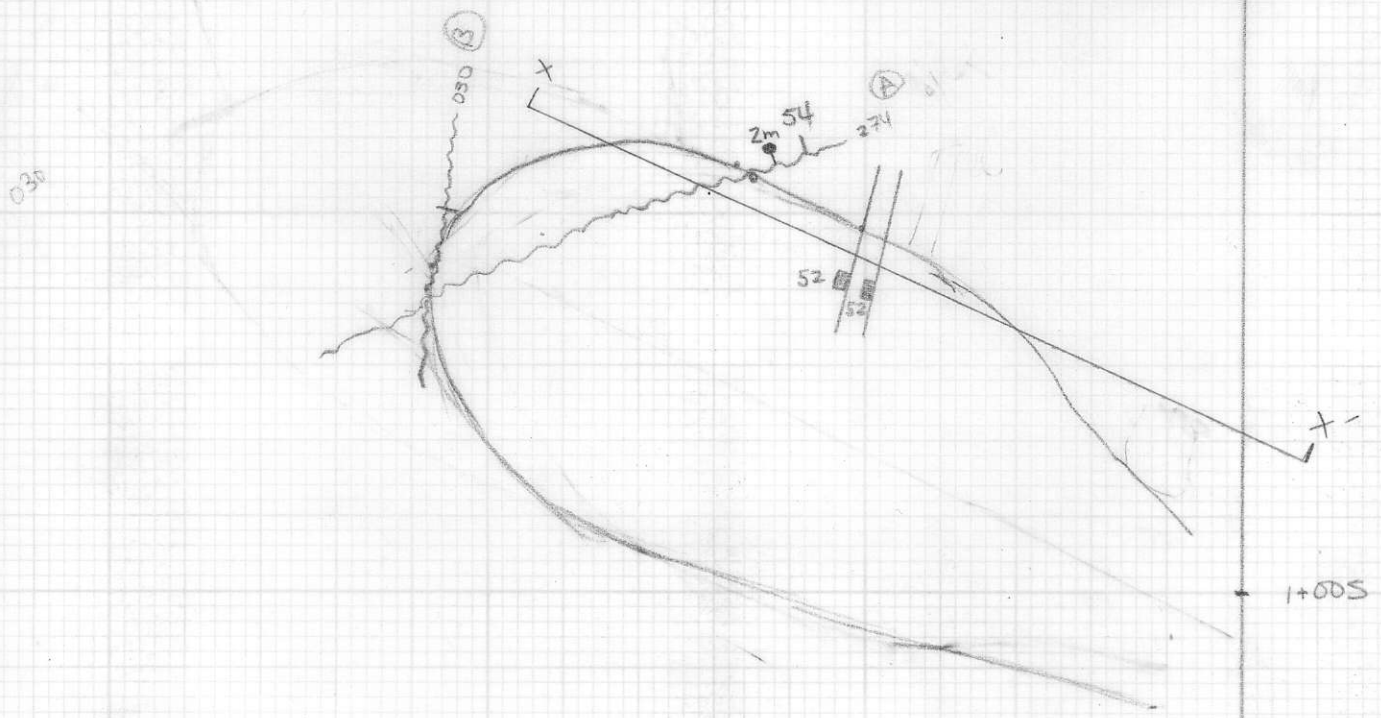

black patches on weather surface

A - 2m displacement, normal fault

(B) younger than (A)

(C) younger than (A), younger than (B)

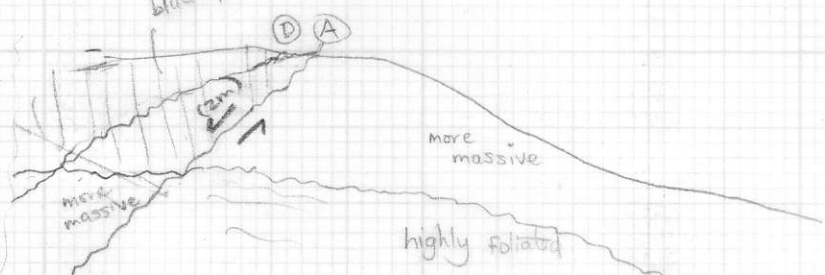





Athelstan

— 3+00N

— 2+50N

— 2+00N

— 1+50N

→ 1+00N

2+00W

1+50W

1+00W

serp  
Carls



1:1000  
05/16/91  
R Holder  
M. McDowell

Athelstan

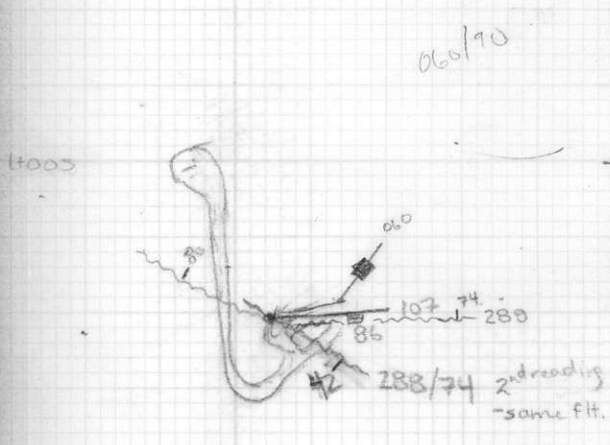
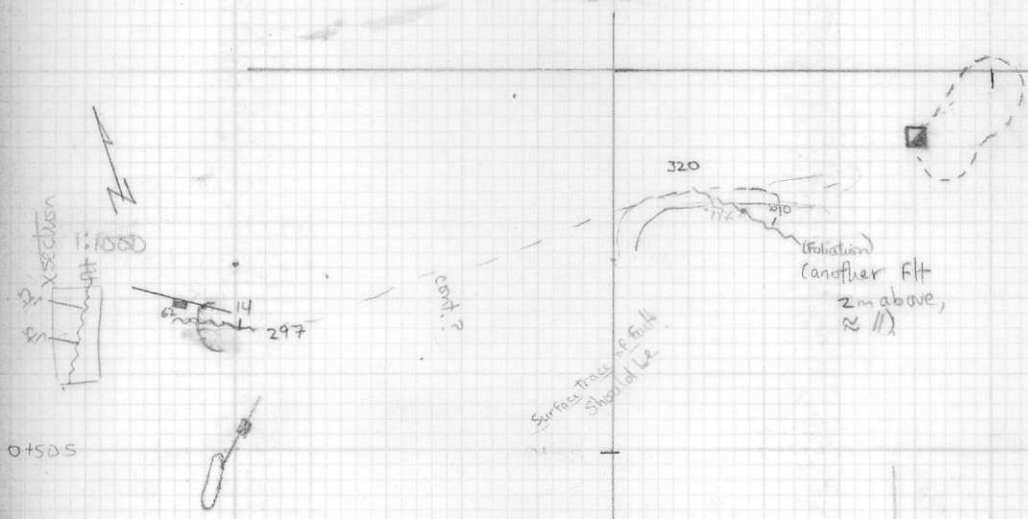

1:1000  
05/16/91  
R. Holder  
w/ M. McDowell

075/32  
320/10

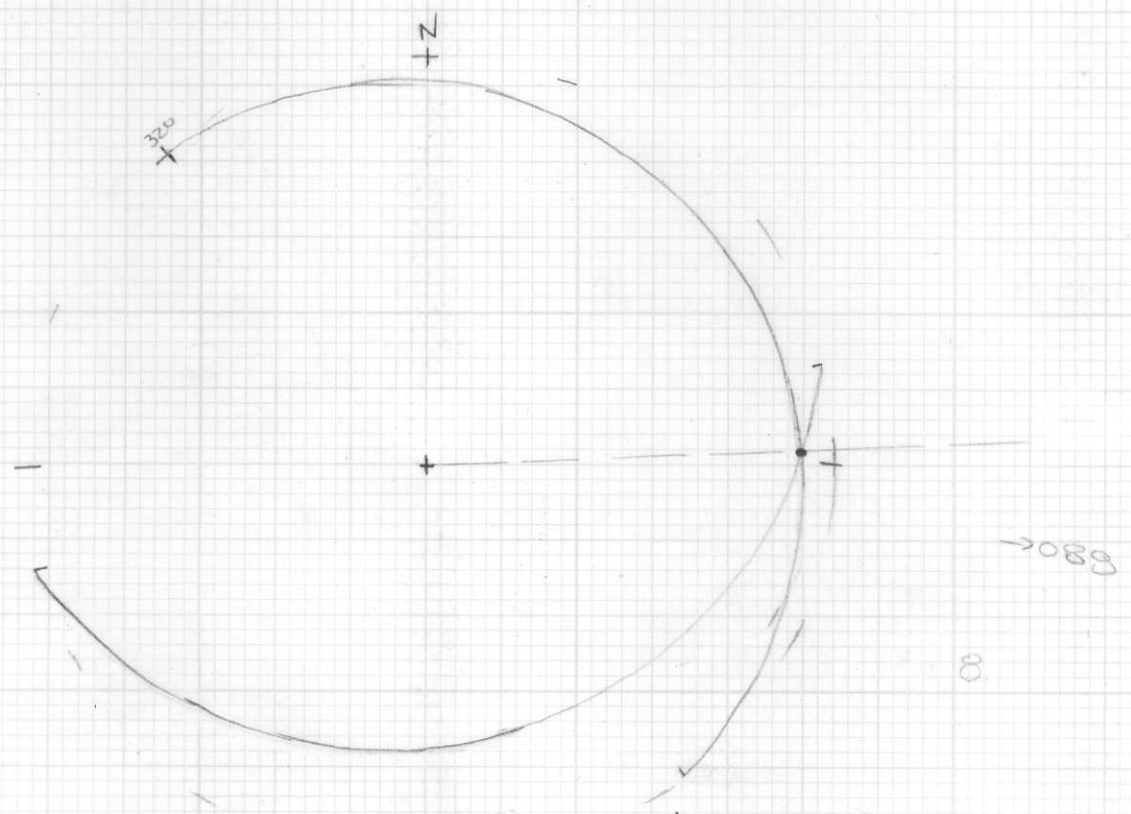

Plunge of  $08^\circ$   
Trend towards 088



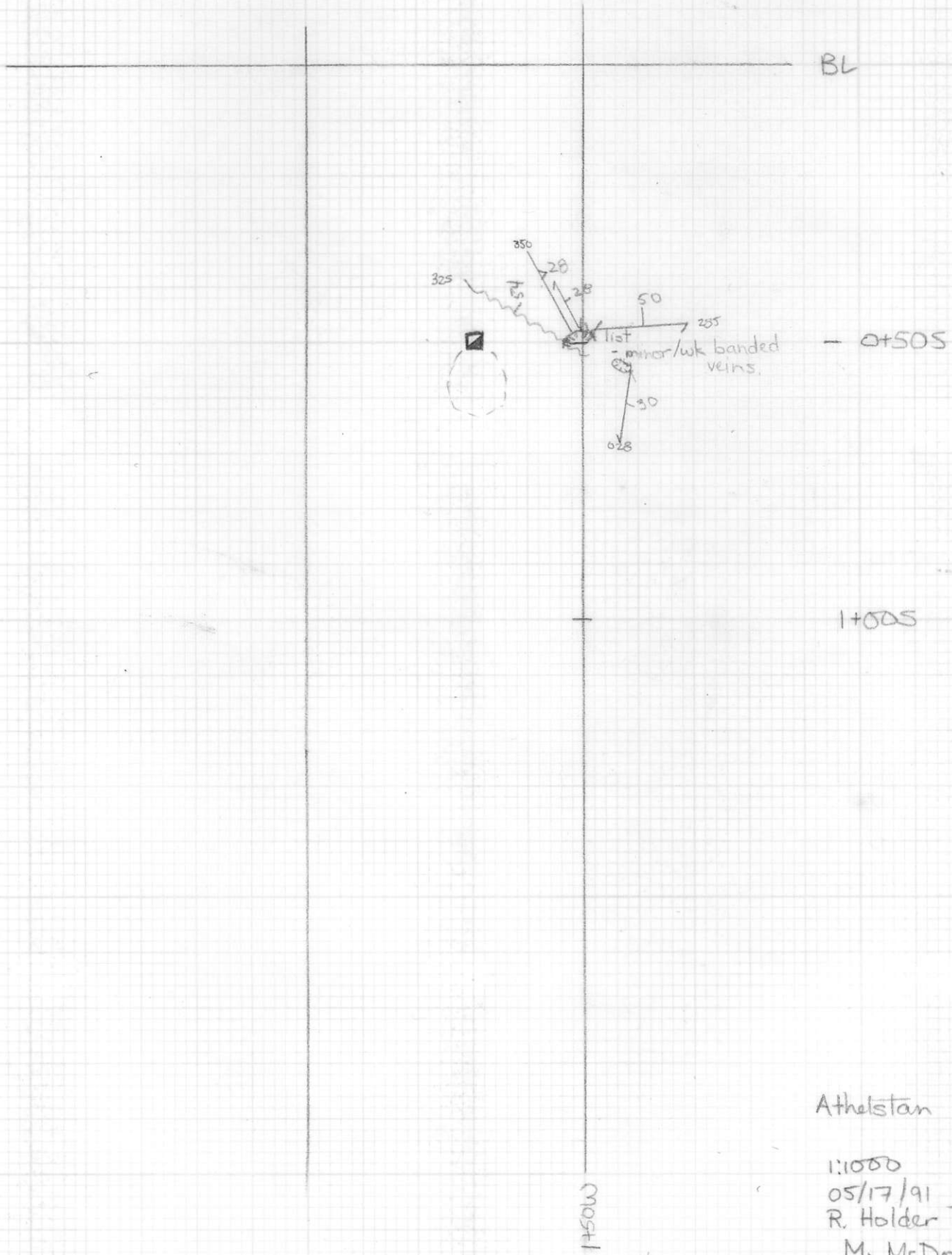

o/c possible  
subcrop  
carb-sep  
began to  
get  
steep

063/60

intr. Schl. alt.  
063  
60

1+505

1+503

H00W

Athelstan

1:1000  
05/17/91

R. Holder  
w M. McDowell

□ ID - wbfhard  
219060  
Post IE  
April 29/91

trench

dump

mag. serp.

mag. serp.

mag. serp.

? h.s. pit

trench  
-wallrack  
fg. serp.

2+00N

1+50N

1+00N

0+50N

0+00N

7+50E

8+00E

BL  
Athelstan  
03/05/91  
1:1000  
M. McDowell

EOL 4775 N



No o/c

4400N



trench

BCS 15228

silic. tuff?

3450N

BCS 15254

dk green-grey  
siliceous, aphanitic  
silic. tuff?

3100N

MS 5x

BCS 15257/8



BCS 15229

siliceous chert/tuff?

2450N

BCS 15256

mag. serp.



h.s.  
f.g., dk green  
siliceous rk tpy  
silic. tuff?

2100N

Athelstan  
03/05/91  
11:000

M. McDowell

7400E

8400E

6+50E

7+00E

7+50E

8+00E

NSZ  
325N  
750E

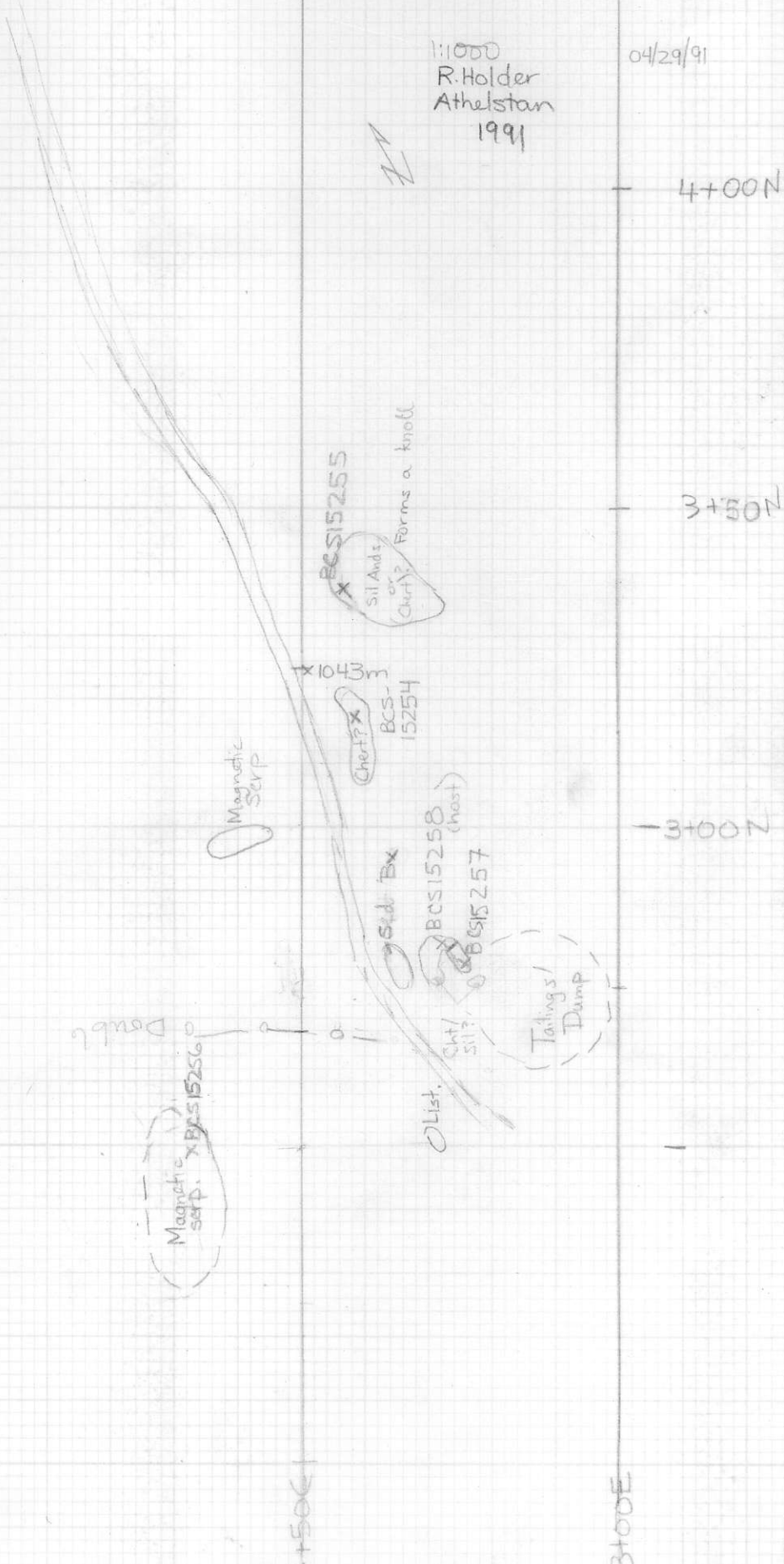

1:1000  
R. Holder  
Athelstan  
1991



6+50E

7+00E

7+50E

8+00E

4+00N

4+50N

5+00N

5+50N

6+00N

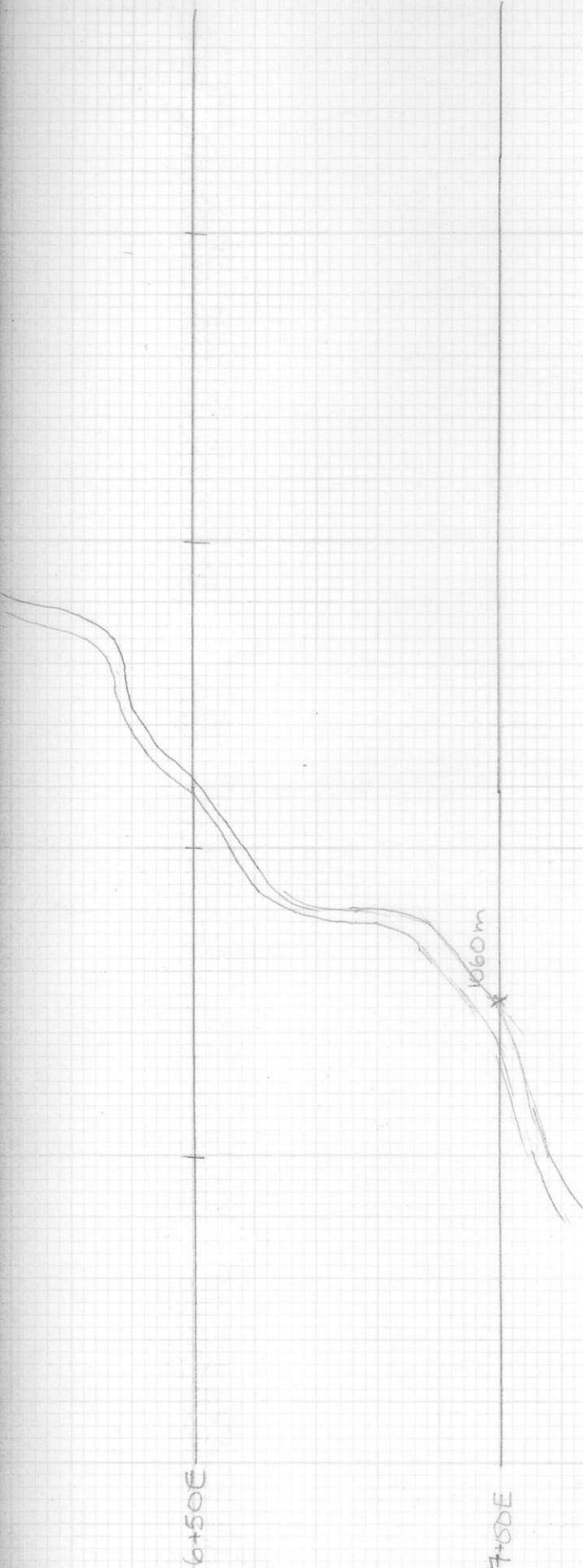



mag. serp.  
-orange  
alt/weath.



2+00 N



mag. serp.

mag. serp. O

1+50 N

pits/adits □ □

trench

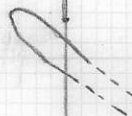

skidder road

1+00 N

□ □ pits

adit



pit  
BCS 15227  
th.s.  
Dior/gabbro



adit

trench

h.s.  
Dior? serp.

0+50 N

6+50 E

trench  
h.s.

7+00 E

0+00 N

BL 0+00N  
Athelstan  
03/05/91  
1:1000

M. McDowell



4+00N

3+50N

3+00N

2+50N

2+00N

8CS15226  
O dior. (alt.)

mag. serp.  
(orange) O

mag. serp. band  
orange-weathering  
strongly altered

6+50 E

7+00 E

BL  
Athelstan  
03/05/91  
1:1000  
M. McDowell



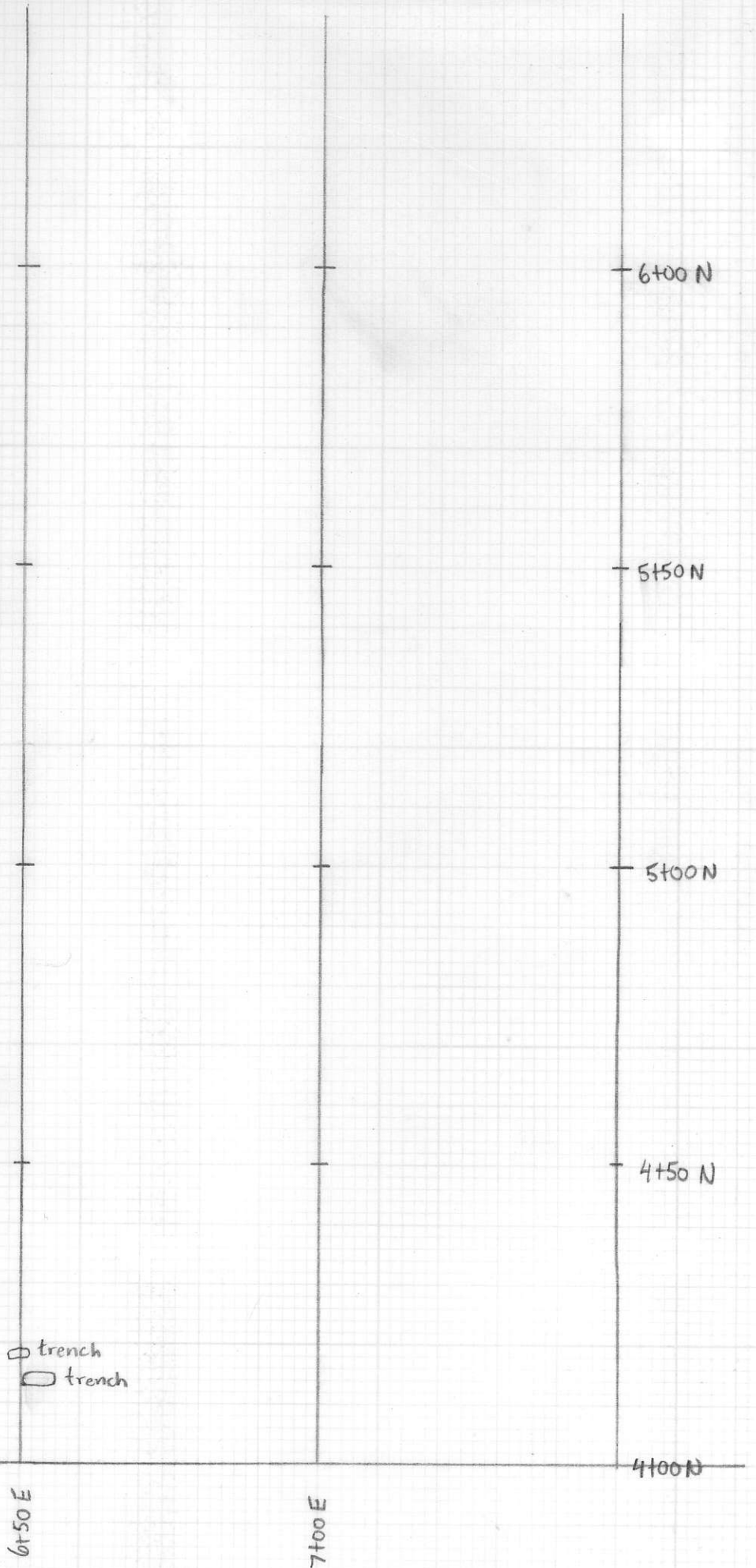

BL  
Athelstan  
03/05/91  
1:1000 M. McDowell

BL  
Athelstan  
03/05/91  
1:1000

M. McDowell

6450 E

700 E

No o/c

EOL

7400 N

6450 N

6100 N



mag. serp. 0

mag. serp.

2+00N

1+50N

1+00N

0+50N



5+50 E

6+00 E

BL  
Athelstan  
03/05/91  
1:1000

M. McDowell

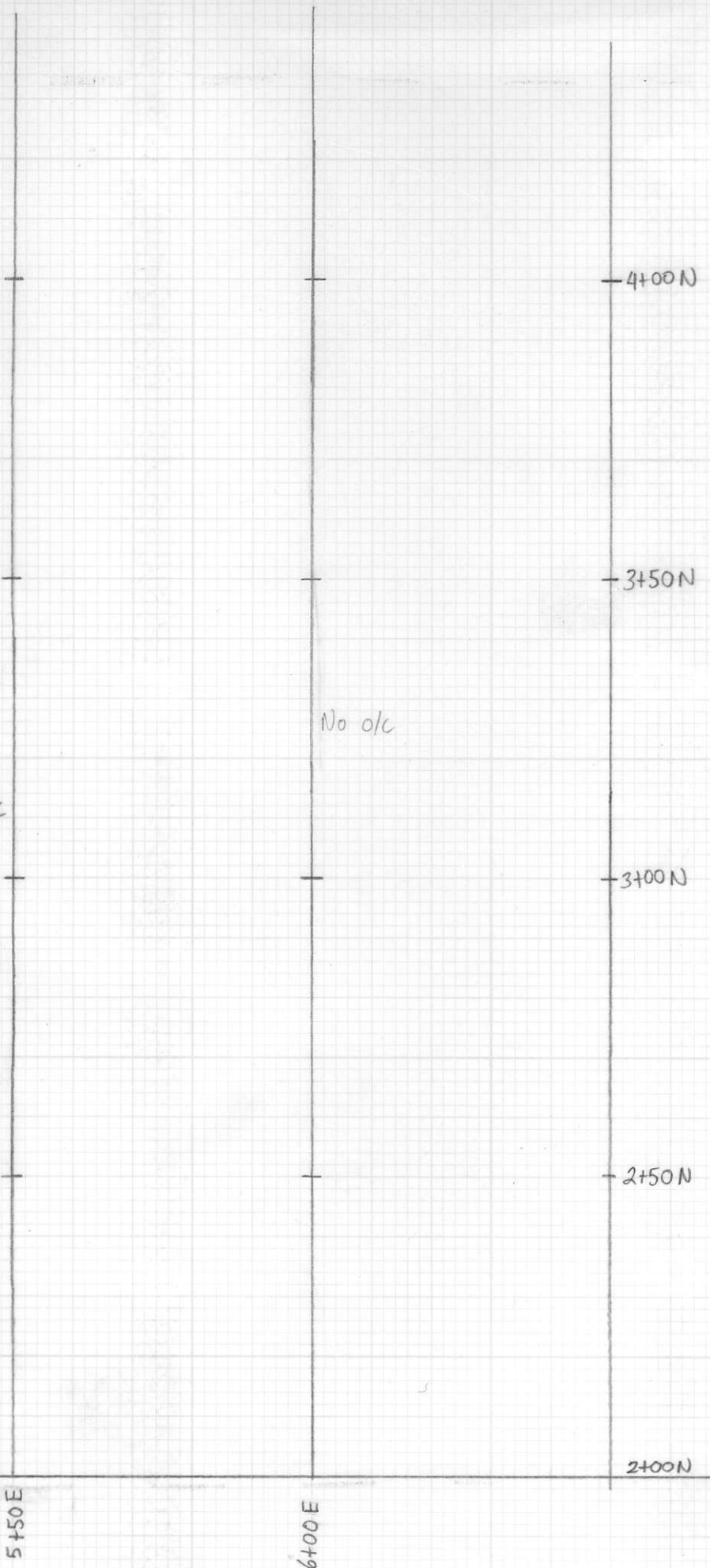

Athelstan  
03/05/91  
1:1000

M. McDowell



Noalc

Noalc

6+00N

5+50N

5+00N

4+50N

4+00N

5+50 E

6+00 E

BL

Athelstan

03/05/91

1:1000

M McDowell

5+00E

5+50E

6+00E

6+50E

4+00N

4+50N

5+00N

5+50N

6+00N

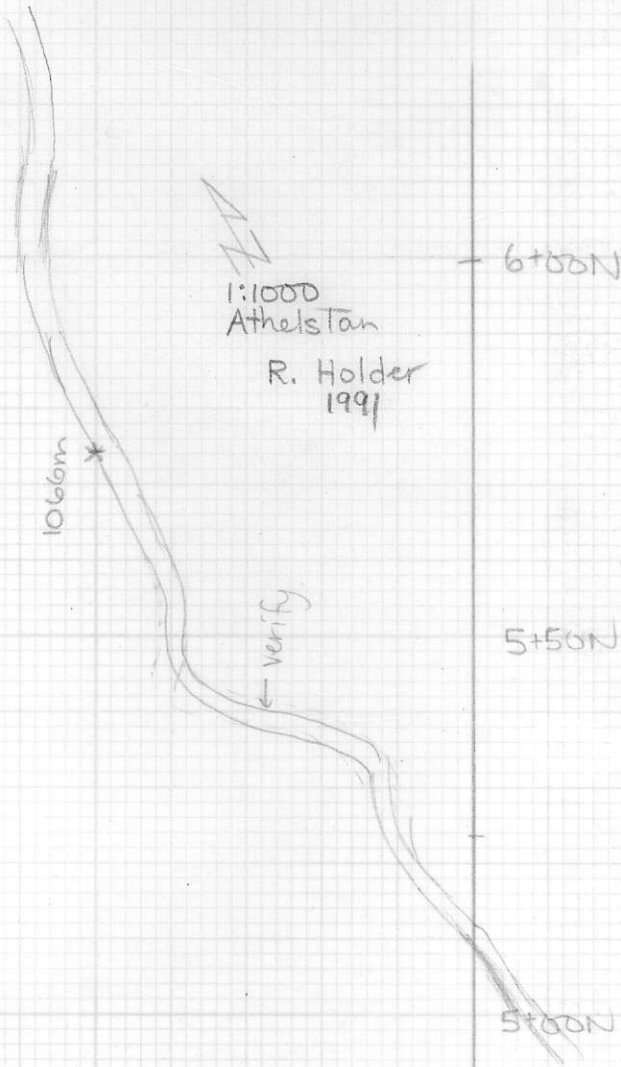



mag. serp  
? boulder ○

EOL

EOL

6+50 N

6+00 N

5+50 E

6+00 E

BL 1991

Athelstan

03/05/91

1:1000

M. McDowell

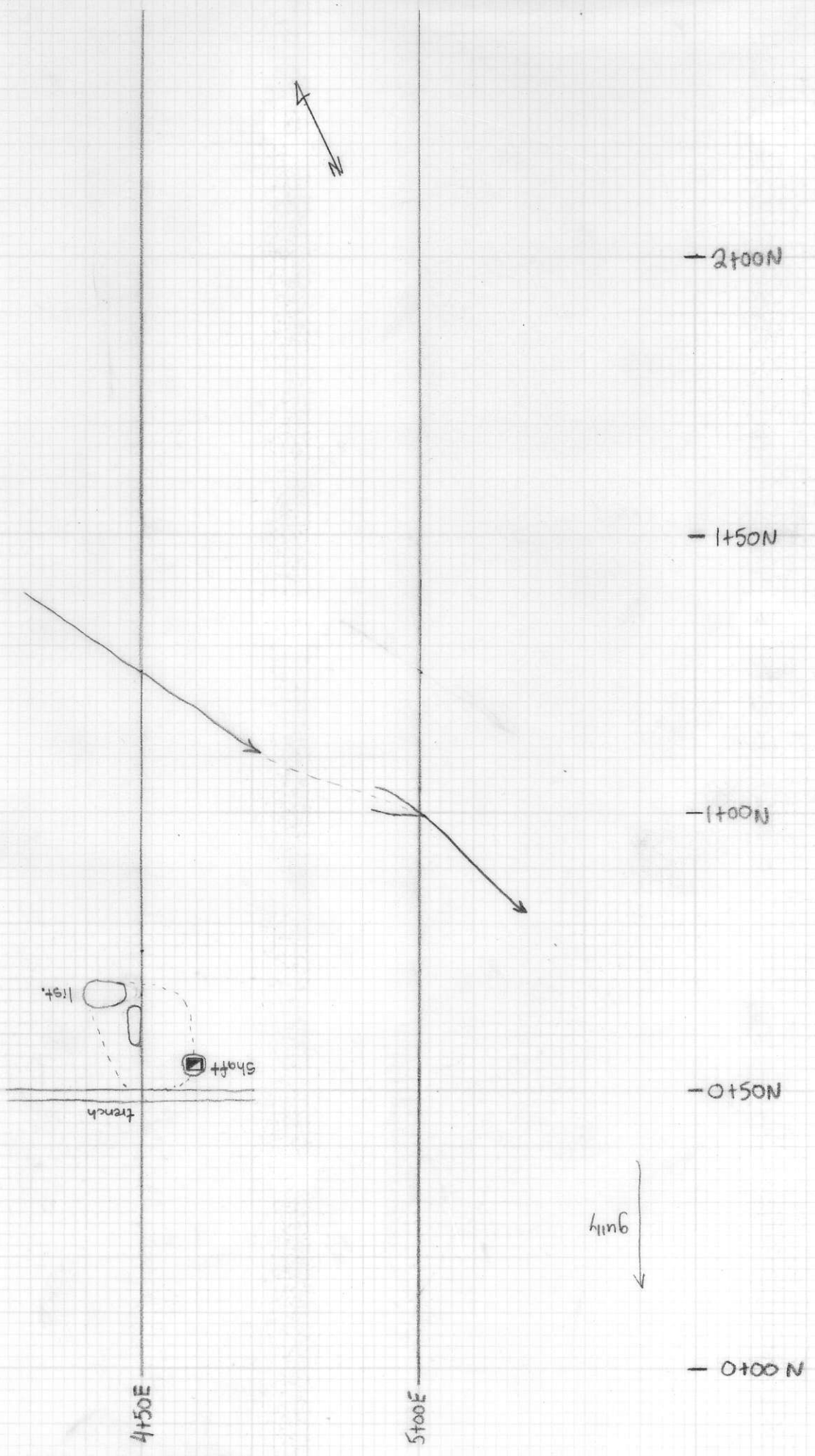

1991  
1:1000  
Athehstan  
M. McDowell





m. sep.

old trench

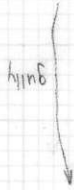

4+50N

5+00E

- 4+00N

- 3+50N

- 3+00N

- 2+50N

- 2+00N

1991  
1:1000  
Athelstan  
M. McDowell



-EOL

□ and.

-6+50N

-6+00N

-5+50N

BCS 15266  
Serp?

-5+00N

-4+50N

4+50 E

5+00 E

-4+00N

1991  
Athelstan  
1:1000  
M. McDowell

Athelstan  
1:1000  
R. Holder  
1991 BL

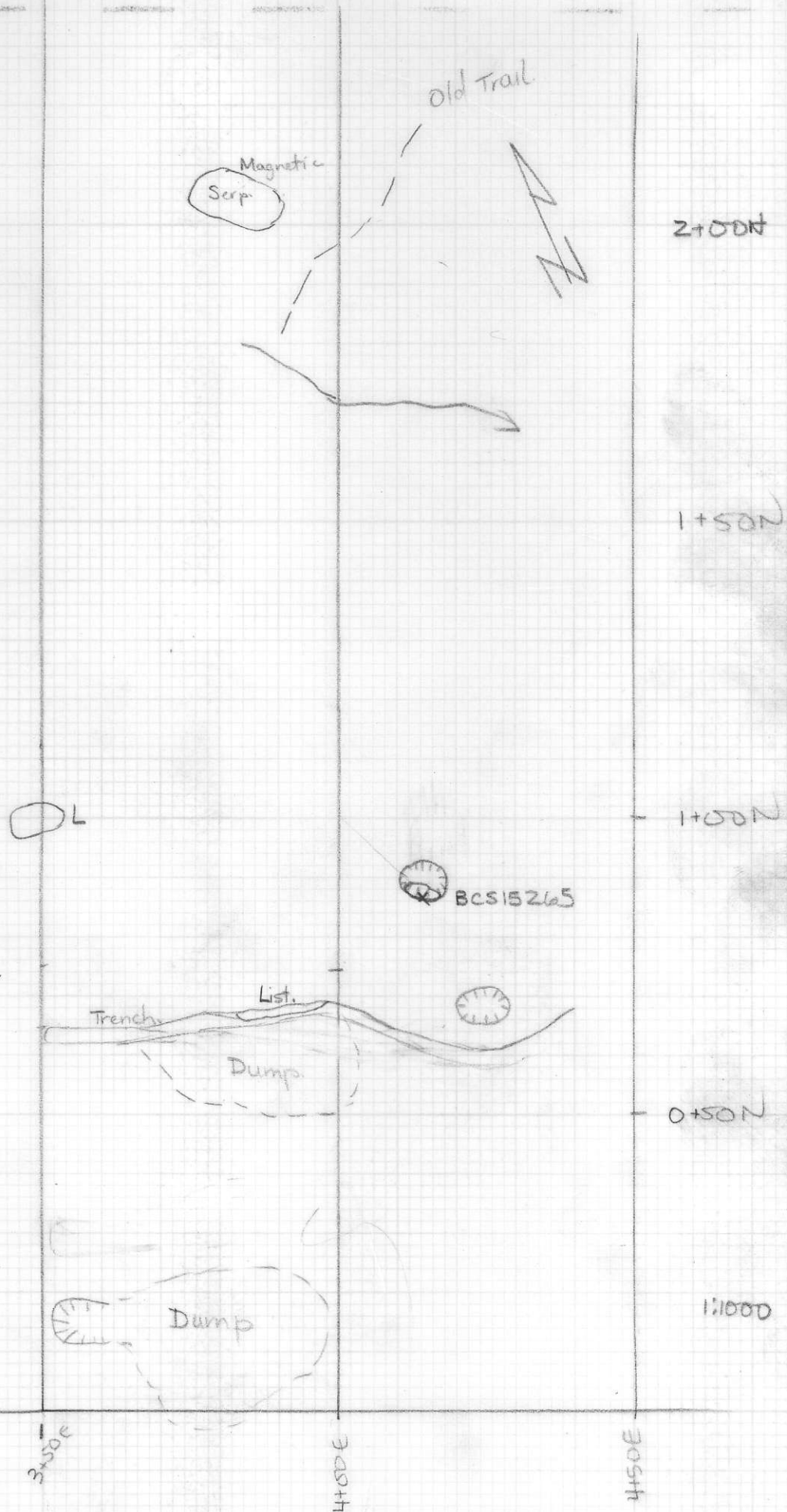



not magnetic  
K-AH?

15264

KAH?  
same  
as  
15264

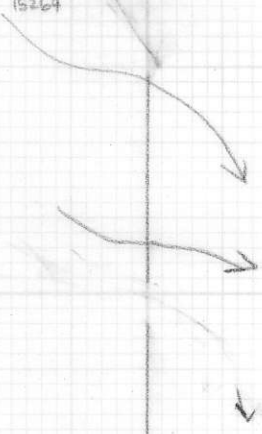

2+50

-2+25

2+00

1+75

1+50

1+25

3+50E

4+00E

Athelstan  
1:1000  
R. Holder  
1991



Athelstan  
1:1000  
R. Holder  
1991

4+00E

- 4+50N

- 3+50N

- 3+00N

Broxena?  
w/ky Magnetite

- 2+50N

- 2+00N

350E  
450N



BCS15259

Athelstan  
R. Holder  
1:1000  
1991

50E  
25N  
-2+00N

Athelstan  
1:1000  
R. Holder  
1991

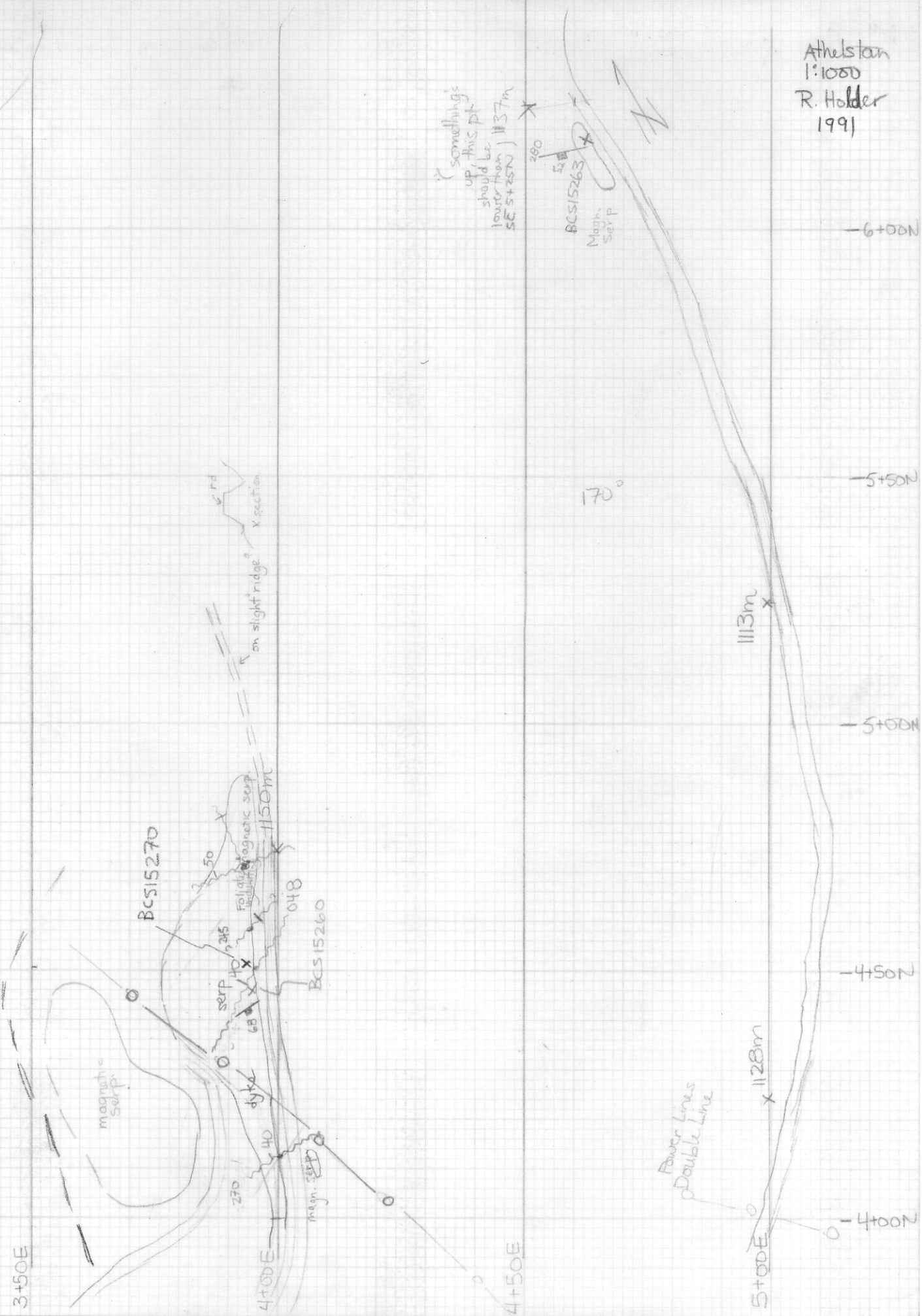

1:1000  
Athelstan  
R. Holder  
1991

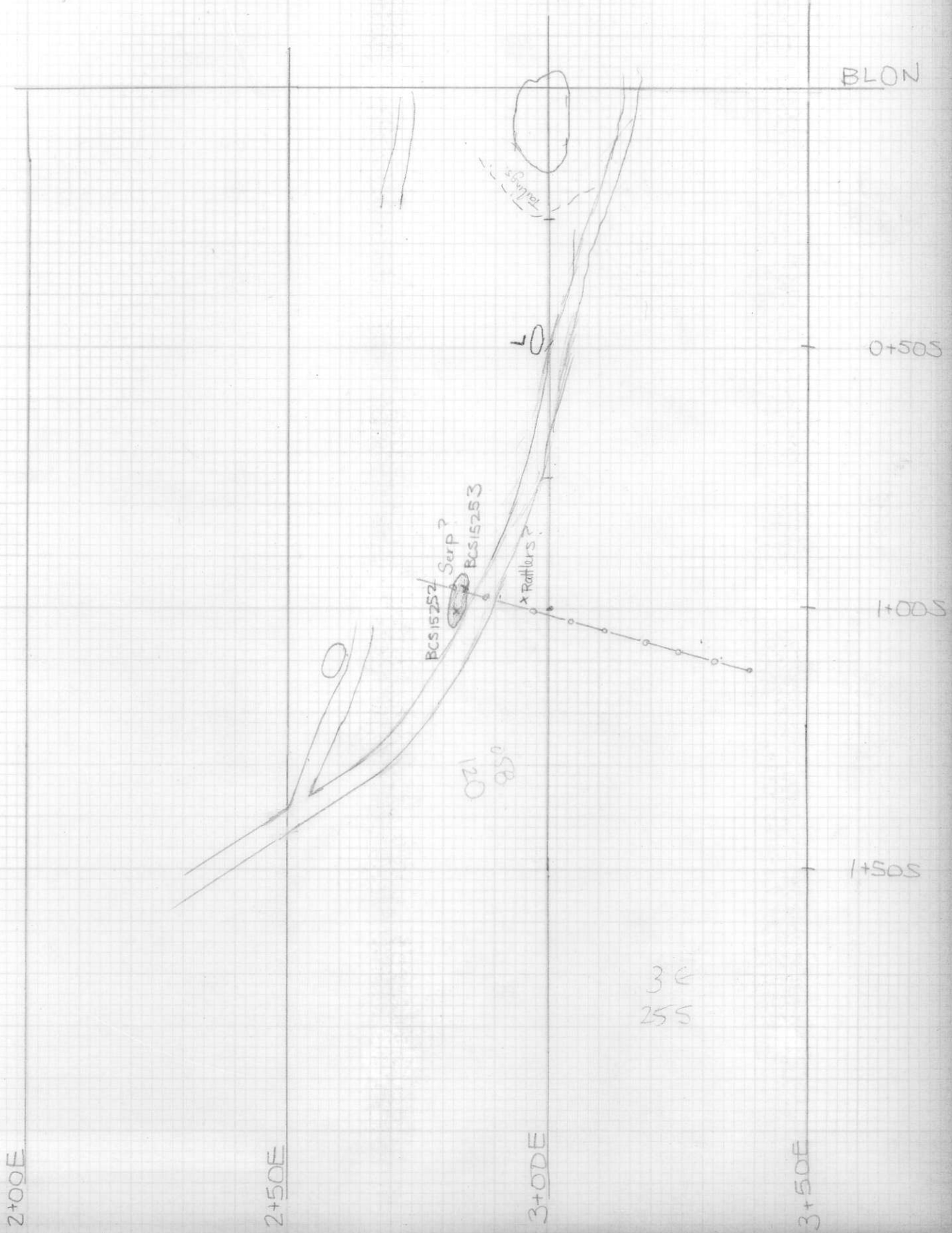



243  
25  
218

road 2210

This line only the OTS&M, 1700N ... should be  
0-50 E, 1700S



2100N

BCS 15273



Rhy/And Flow

1750N

adit  
Serp.

1700N

L/Serp

power line

317 →  
← 328

0  
0  
serp.

310E  
1750S  
LCP

0750N

242  
25  
218

2130  
pits

lost



trench

pit

lost/serp

trench

1:1000  
Athelstan  
M. McDowell

31E 0700

2450E

3400E

3450E

1991

Legend:  
 HS = Hand Sample  
 L = Listwanite

52  
 34

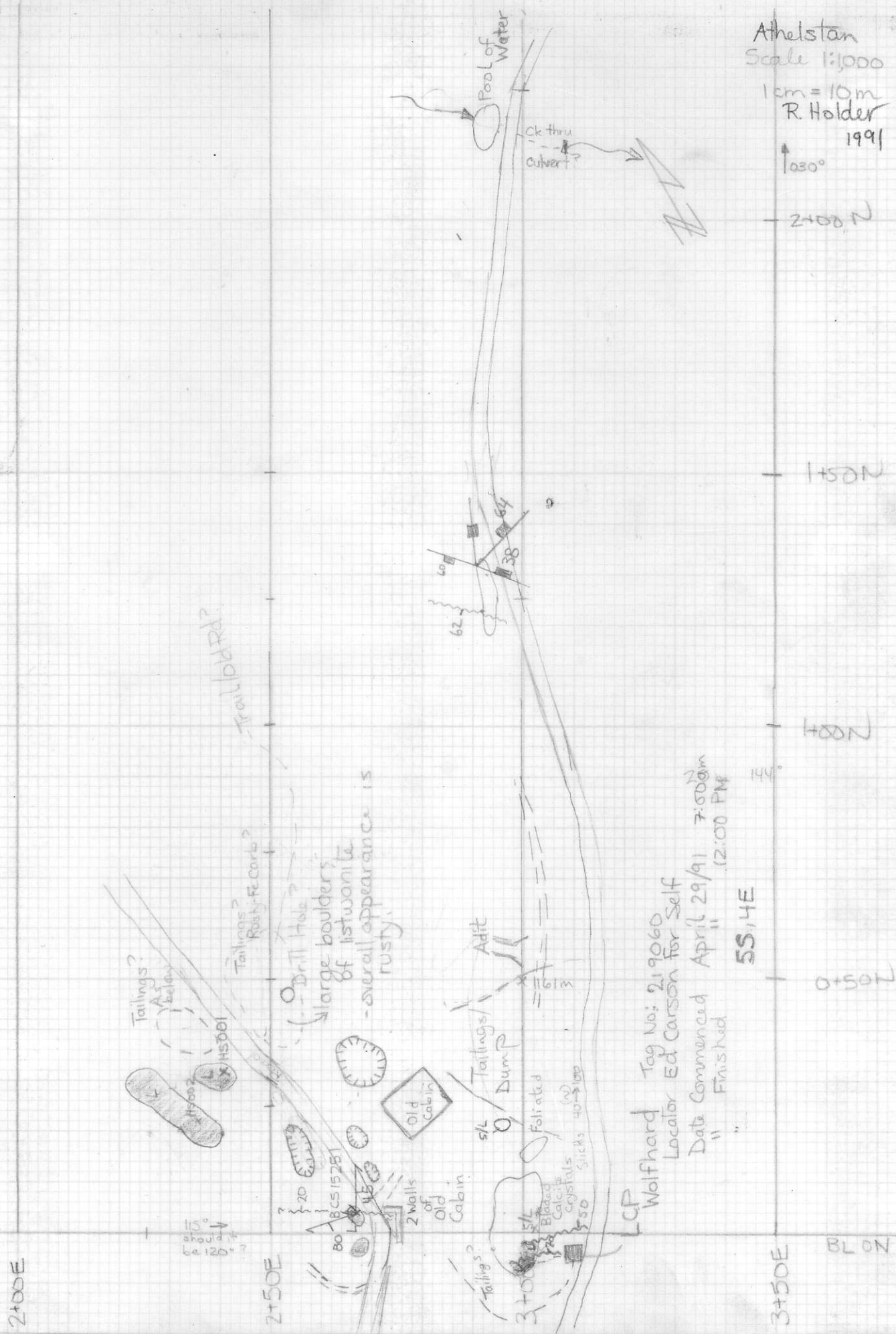

Athelstan  
 Scale 1:1000  
 1cm = 10m  
 R. Holder  
 1991

Wolfhard Tag No: 219060  
 Locator Ed Carson for Self  
 Date Commenced April 29/91 7:00am  
 " " " " 12:00 PM  
 Finished SS, HE

2+00E  
 2+50E  
 3+00E  
 3+50E  
 0+50N  
 1+00N  
 1+50N  
 2+00N



1.10.50  
Athelstan  
1991  
M. McDowell

mag. scrp. ○

mag. scrp. ○

mag. scrp. ○

4450 N

4100 N

3450 N

3000 N

2450 N

2000 N

2750 E

3100 E

3450 E



1:1000  
Athelstan  
R. Holder  
1991

4E 375N

x BCS15269

magnetic  
serp

0 x BCS15261  
Andis?  
Pg Intrusive?

4+00N

3+50N

Magnetic  
Serp  
3+00N

2+50N

2+00N

2+00E

2+50E

3+00E

3+50E

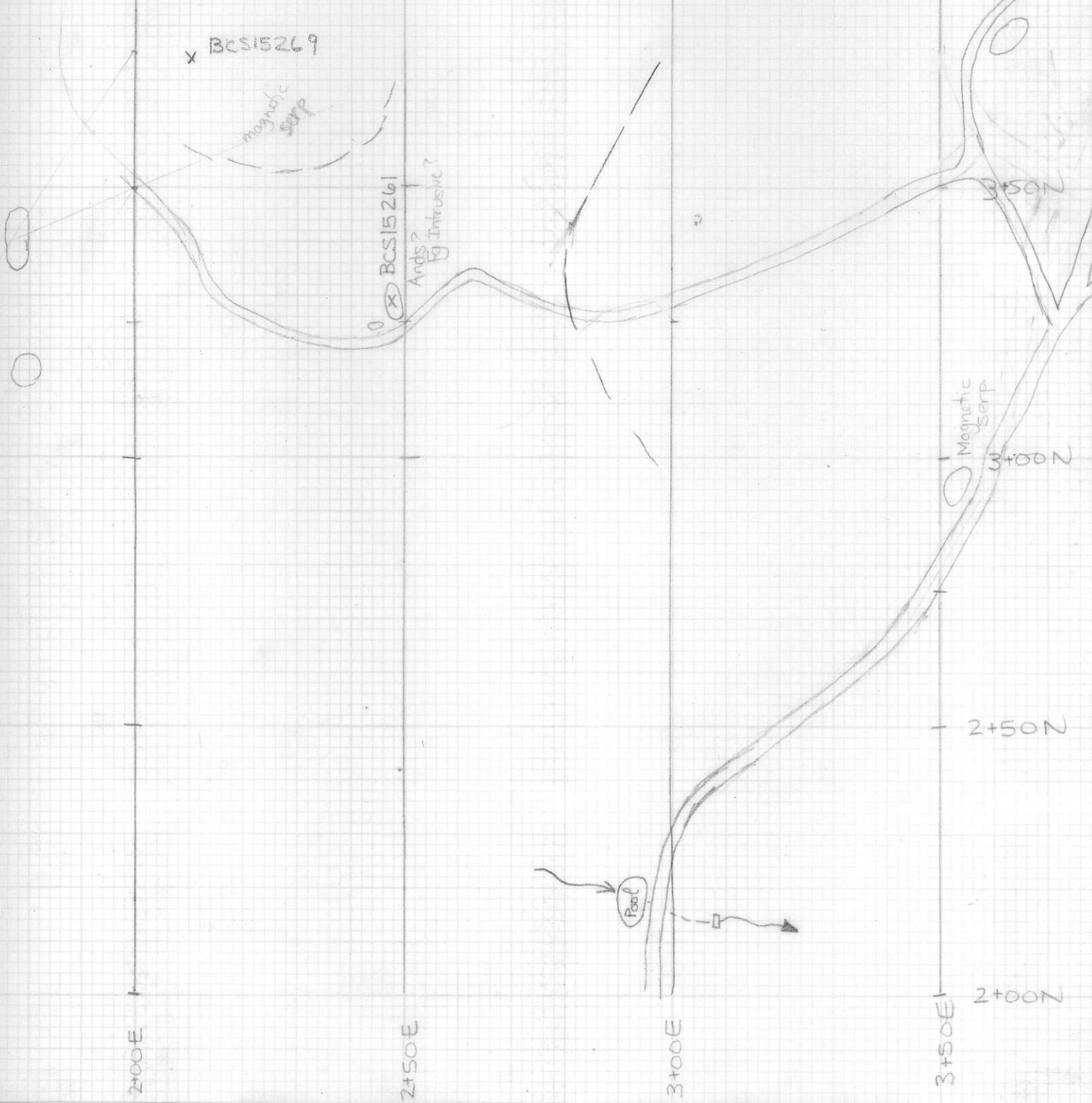

↖  
1:1000  
Athelstan  
1991  
M. McDowell.

- 6450N

road  
↓  
6010

- 6400N

mag.  
serp.  
cliffs

mag.  
serp. ○

○ mag.  
serp.

○ mag.  
serp.

mag.  
serp.

- 5450N

- 5400N

mag-serp

102/275

- 4450N

514E  
514E  
514E

6

2450E

3400E

3450E

2+00E

2+50E

3+00E

3+50E

4+00N

4+50N

5+00N

5+50N

6+00N

  
 1:1000  
 Athelstan  
 R. Holder  
 1991

134 60

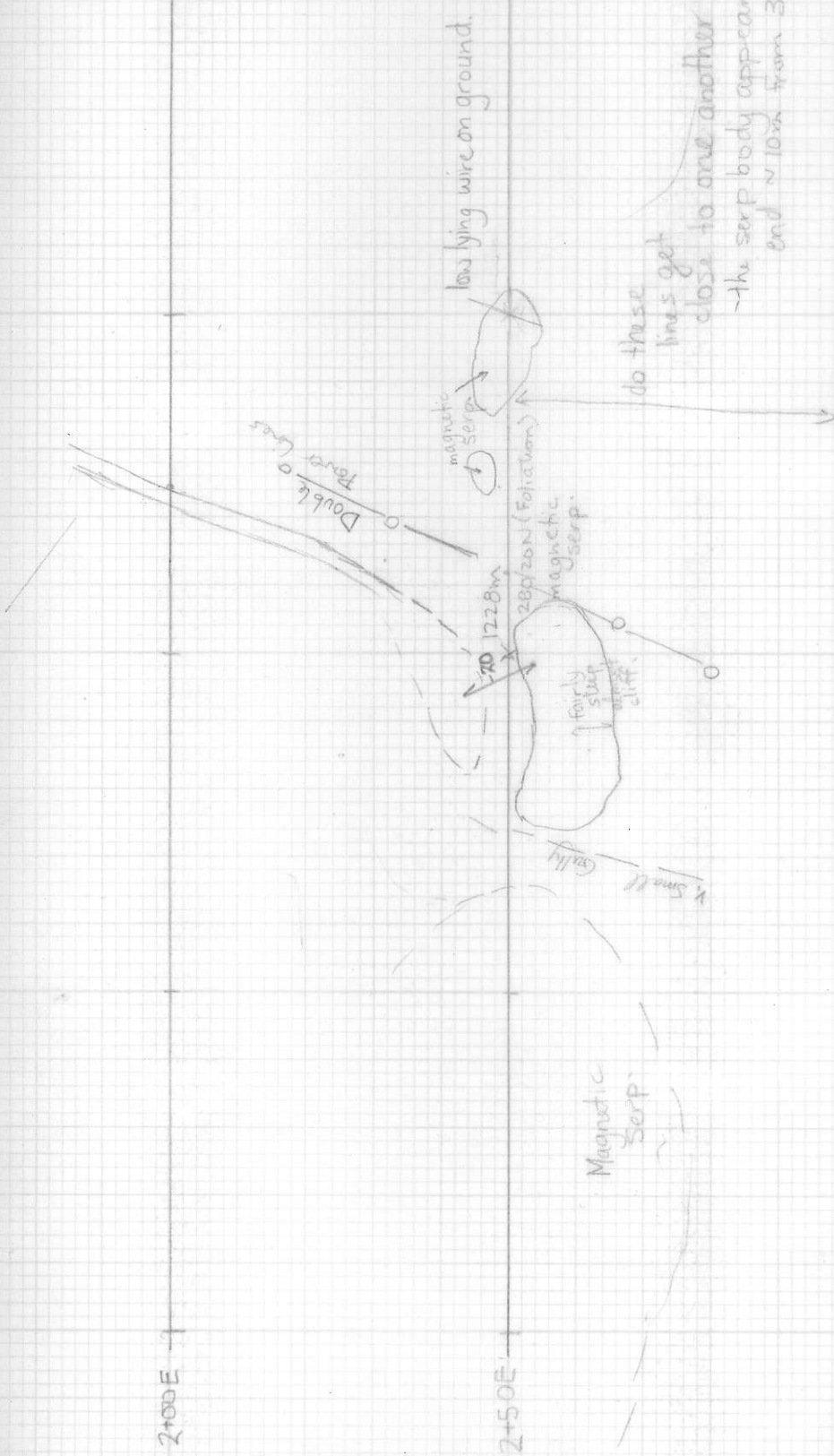

Athelstan  
1:1000  
R. Holder  
1991

2506  
5400N  
1228m

0+50E

1+00E

1+50E

2+00E

2+00N

2+50N

3+00N

3+50N

4+00N

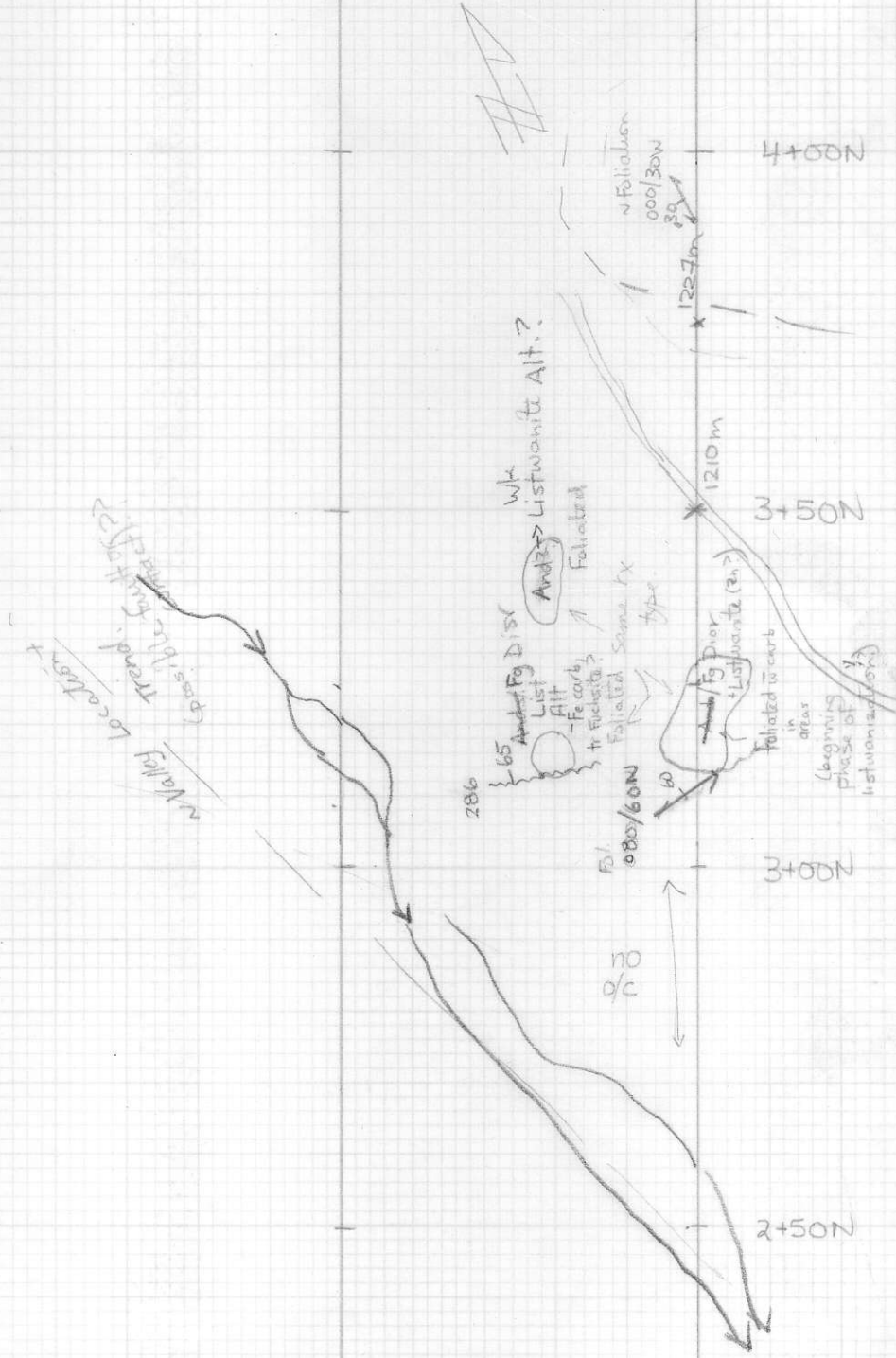

0E, 5+75N

154/40N

0+50E

1+00E

1+50E

2+00E

4+00N

4+50N

5+00N

5+50N

6+00N

Magnetic X  
BGS1526Z  
Serpentinite  
1242m

Magnetic Serpentinite  
1234m

Magnetic Serpentinite  
154  
140

1:1000  
Athelstan  
R. Holder  
1991

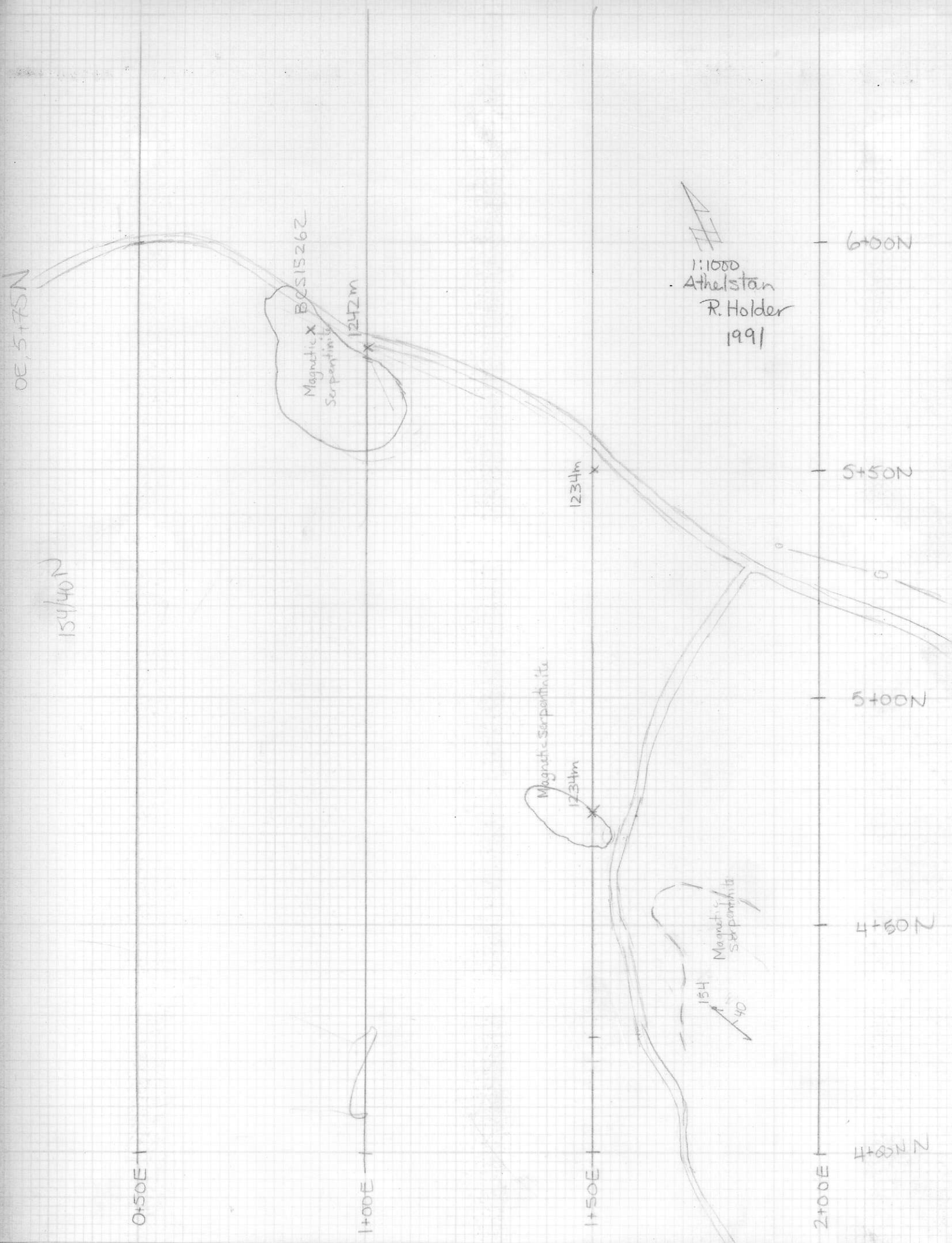





1:1000  
 Athelstan  
 R. Holder  
 1991

1700W

0750W

0700

0730

-1700S

1750S

2700S

Pyroxenite?

BCS15267



small pod intrusive  
 rx - very thin dyke?  
 Tr - 1% Py



1:1000  
Athelstan  
R. Holder  
1991

1400h

6150M

5150

Contact.  
Fit?  
294/405

Intrusive  
And?  
off

Fit  
serp.

off  
Altered Intrusive  
Intrusive - Lots Fsp.

Ands?

- 1+50

- 1+505

- 21005