

SECTION FACING WEST WALL
AT 132.7 E

SECTION 1106° Looking South

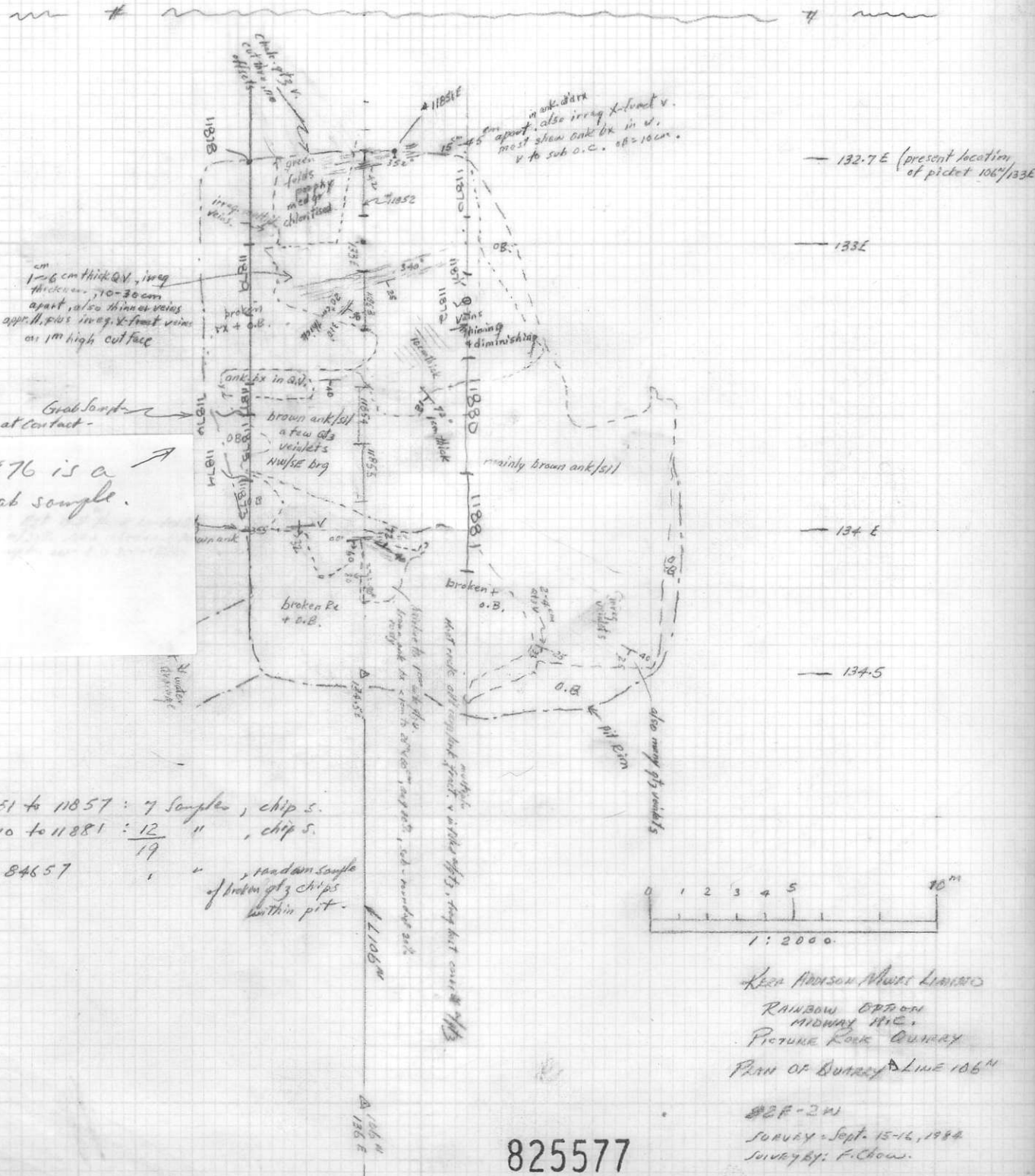

Samples = 11851 to 11857 : 7 samples, chip s.
 Taken 11870 to 11881 : 12 " , chip s.
 19 " , random sample of broken g.l. chips within pit.
 R6 84657

825577

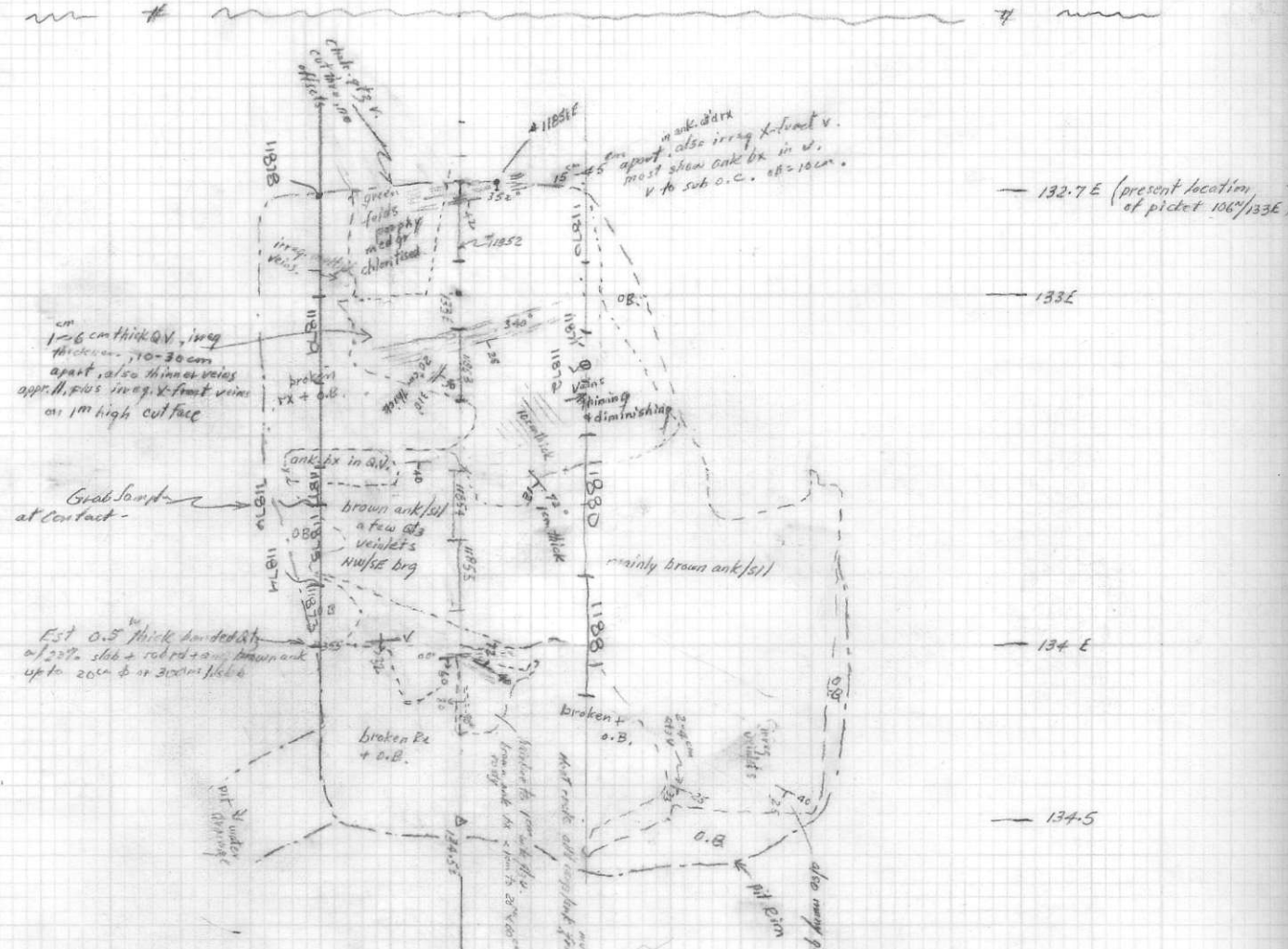
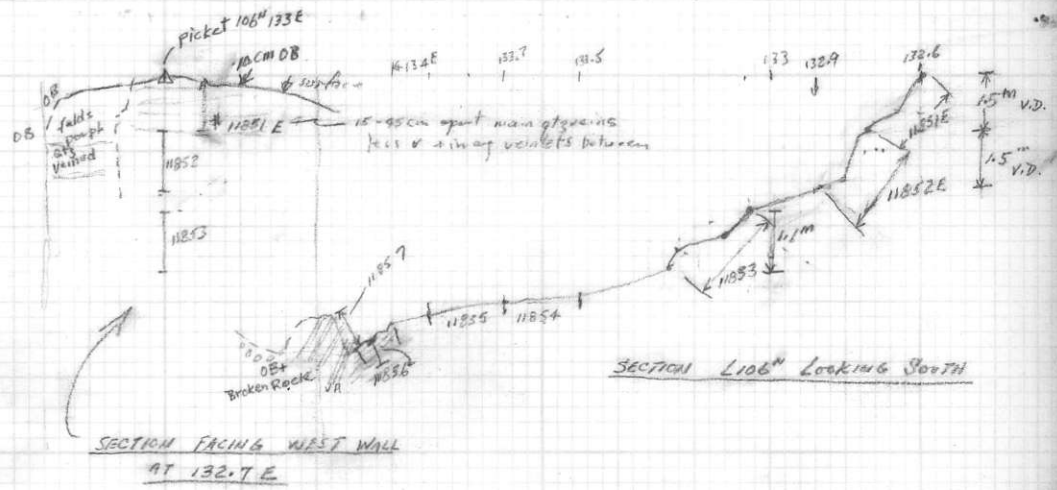

Samples 11851 to 11857 : 7 samples, chip s.
 Taken 11870 to 11881 : 12 " " chip s.
 19 " " random sample
 of broken gtz chips
 within pit.

R6 84657

KERR HADSON MINES LIMITED
 RAINBOW OPTION
 MIDWAY S.P.C.
 PICTURE ROCK QUARRY
 PLAN OF QUARRY LINE 106M

BBF-2W
 SURVEY - Sept. 15-16, 1988
 SURVEY BY: P. Chow.

825577