

Sept. 2/1989

DUSTY MAC
825240

Weather: Rain

Companion: -

Power went out last night, got up half hour late (7:30am).

Beginning to map DM Pit

-already tough.

1:

Andesite FS Porphyry

Rock is light brown. On weath surface, rusty-orange colour. Fresh surface is fine grained/aphanitic with feldspar phenocrysts. Feldspars are 3-5mm, euhedral to subhedral, and white.

2:

Andesite FS Porphyry: Weath Surface is yellow-rust in colour

Fresh surface is a medium grey with white to light green feldspars. The groundmass is fine grained. The feldspar phenos are subhedral to euhedral, 3-5mm. Pods of wk-mod clay alt.

1a: Same as 1 except FS phenocrysts
are 3-7mm and rx is med brown.

3:

DARK GREEN RX - DIFFICULT
TO PULL OUT FEATURES. SOME AREAS
HAVE FELDSPARS (TO ~6mm) SOME
AREAS APPEAR CLASTIC.

∴ PROBABLY INTENSELY CHLORITE
ALT ANDESITE FELDSPAR PORPHYRY
[BRECCIA?].

ALSO, 5-10% QUARTZ PRESENT
PREDOMINANTLY AS VEINSET (5-30mm
WIDTH); NO PREFERRED ORIENTATION

3a:

SIMILAR TO 3; FELDSPARS ARE
SLIGHTLY SMALLER (UP TO ~5mm), AND
V. LITTLE QZ (~1% VEINS), APPEARS
MORE MASSIVE; CHLORITE ALT

2A: MED GREY AND FELDSPAR PORPHYRY
THAT IS QUITE RUSTY ON WEATH
SURFACE. ~1m WIDTH.

1-2% QZ

4: QZ BRECCIA N: 70% CLASTS
~30% MATRIX
MATRIX IS LIGHT GREEN
(CHLORITE). CLASTS ARE ANGULAR
VARYING IN SIZE FROM 0.5cm
TO 10cm. PATCHES WITHIN
ARE DARK GREY/BLACK MATRIX.
QZ CLASTS ARE WHITE TO
MOTTLED WHITE + GREEN, AND
ARE APHANITIC.

5:

WEATHERED SURFACE IS WHITE TO
GREY (CARBONATE) TO WHITE-BLUE COLOUR.
FRESH SURFACE IS MOTTLED WHITE, GREEN,
AND HEMATITIC RED PATCHES.
ALT AND ES POR?

ALTERATION: CHLORITE, CARBONATE (WR)

FROM DISTANCE
UNITS 3+5 SEEM
CONTINUOUS

6: QZ VEIN - MASSIVE

WEATH SURFACE IS A FLAT WHITE,
FRESH SURFACE IS WHITE, FINE GRAINED

7:

WEATH. SURFACE IS WHITE
WITH RUSTY PATCHES. FRESH SURFACE
IS SIMILAR IN COLOUR EXCEPT THERE ARE
YELLOW (LIGHT) PATCHES. QZ VEINING IN
ALT. HOST RX. QZ VEINS ~ 5%. RUST
COLOURING FOLLOWS FRACTURES → POSSIBLE
BRX. WK CLAY ALT + (PATCHES OF
WK CHLORITE ALT ?)

8

BROWN TO GREEN MATRIX QUARTZ BRECCIA

8A

CHLORITIC QZ BRX.

SEPT 3, 1989

WEATHER: GORGEOUS!!! SUNSHINE,
WARM

COMPANIONS: -

CONTINUING MAPPING DUSTY MAC
DIT

DID SOME MARKING OF WALLS (METREAGE)
FIRST.

HAVING PROBLEMS WITH WALL
MARKED UP TO 90m, FOR THE LAST
40m - LEAVE & COME BACK TO IT
LATER.

9: AND FELDSPAR PORPHYRY

WEATH SURFACE IS A MED GREEN W
~10% FELDSPAR PHENOCRYSTS AND ~5%
"NIUGS" (BOXWORK, VESICLES ???). FRESH
SURFACE IS MED BROWN TO MED GREEN
WITH WHITE TO WHITE/LIGHT GREEN FELDSPARS
(~16%) THAT ARE SUBHEDRAL TO EUCEDRAL.
ALSO, ~2% BLACK SPECKS

(SIMILAR TO 2?)

6a:

Qz Vein - MASSIVE, WK GREEN (CHLORITIC)
COLOUR IS MOTTLED WITHIN

10:

DARK GREEN (ANDESITIC? OR STRONG CHLORITIC)
MATRIX \bar{w} QZ CLASTS (10 - 40%)

11:

QZ VEIN? - MASSIVE, YET CONTAINS
SOME BRECCIA FRAGMENTS. - QZ
BRX \bar{w} QZ MATRIX?

10A:

DARK GREEN MATRIX \bar{w} QZ CLASTS THAT
TENDS TO GRADE MORE INTO QZ VEINS
AS MOVE SOUTHWARDS PAST ~7m.

12: ANDESITIC FELDSPAR PORPHYRY

- SIMILAR TO 2 EXCEPT YELLOW-
RUSTY WEATHERING COLOUR IS NOT PRESENT.

FRESH SURFACE IS MED-DARK GREY \bar{w}

WHITE FELDSPAR PHENOCRYSTS (Euhedral-

SUBHEDRAL, 3-6mm)

SEPT. 4, 1989

PICKED LINDA UP AT AIRPORT
(FLIGHT 50 MIN LATE)

FINISHED DM-19 [PRGLOG]

PLOTTED VELVET

FINISHED TRIUMPH PLOTTING

CANNED IN EVENING

(APPLESAUCE + JAM)

SEPT. 5, 1989

CONTINUE MAPPING DM PIT

WEATHER: SUNSHINE, CLOUDS,
COOL WIND

COMPANION: -

13: WEATH SURFACE IS A MED TO
LIGHT BROWN W RUSTY PATCHES
FRESH SURFACE IS MED GREY W
FELDSPAR PHENOCRYSTS. CENTERS
OF SOME FELDSPARS ARE Fe
ALT. WEATH SURFACE LOOKS
'MANGLED'

APPROX EQUIVALENT

12a - WEATH/FRESH SURFACE IS MOTTLED

GREEN/GREY TO LIGHTER + DARKER PATCHES

AFTERNOON - OFFICE

START WORK IN VANCOUVER ON

MONDAY

SEPT 6, 1989

WEATHER: SUNSHINE, COOL

COMPANION: GRAEME

WENT WITH GRAEME ON A
PROPERTY EXAM → POWER

AFTERNOON, WENT OVER TO SEE
NICK ON FERROUX.

QUARTZ MONZONITE → LOOK
UP!

SEPT. 7, 1989

WEATHER: SUNSHINE

COMPANION: -

OFFICE - TRIUMPH
DUSTY MAC FIT → AFTERNOON
FOR ~1HR W/ GRAEME,
DAD, GRAEME'S DAD,
*GRAEME'S DAD'S GIRLFRIEND

SEPT 8, 1989

36

ANDESITE FELDSPAR PORPHYRY
W/ MOD TO STRONG CHLORITE ALT.
CAN SEE FELDSPARS ON WEATH
SURFACE (MORE EASILY THAN FRESH
SURFACE); YELLOW-ORANGE RUSTY
WEATHERING

5a:

WEATH SURFACE IS SILT COVERED
FRESH SURFACE IS LIGHT TO MED
GREEN W WEAK WHITE + BROWN/HEMATITIC
PATCHES, FELDSPARS ARE MODERATELY
TO PULL OUT (MOD 'BLITZED') DIFFICULT
[REPRESENTS WHITE PATCHES]

5b:

SIMILAR TO 5a, EXCEPT ~5%
QZ (QZ VEINY FRAGS + QZ VEINS);
SOME AREAS ARE WEAKLY BRECCIATED.

14:

MOD CHLORITIC ALTERED AND
BRX CONTAINING 3-5% QZ
VEINS, WK SILICIFICATION;
CONTAINS FELSIC FRAGMENTS

8b:

QZ BRX, WHITE, WITH QZ
MATRIX, MINOR CHLORITE

15:

ANDESITE

MASSIVE, PALE GREEN APHANITIC

DOM. ALT → SILICIFICATION

(GRADING INTO QZ VEIN → CHERTY)

ROYANNA HOLDER
 SEPT 5/89

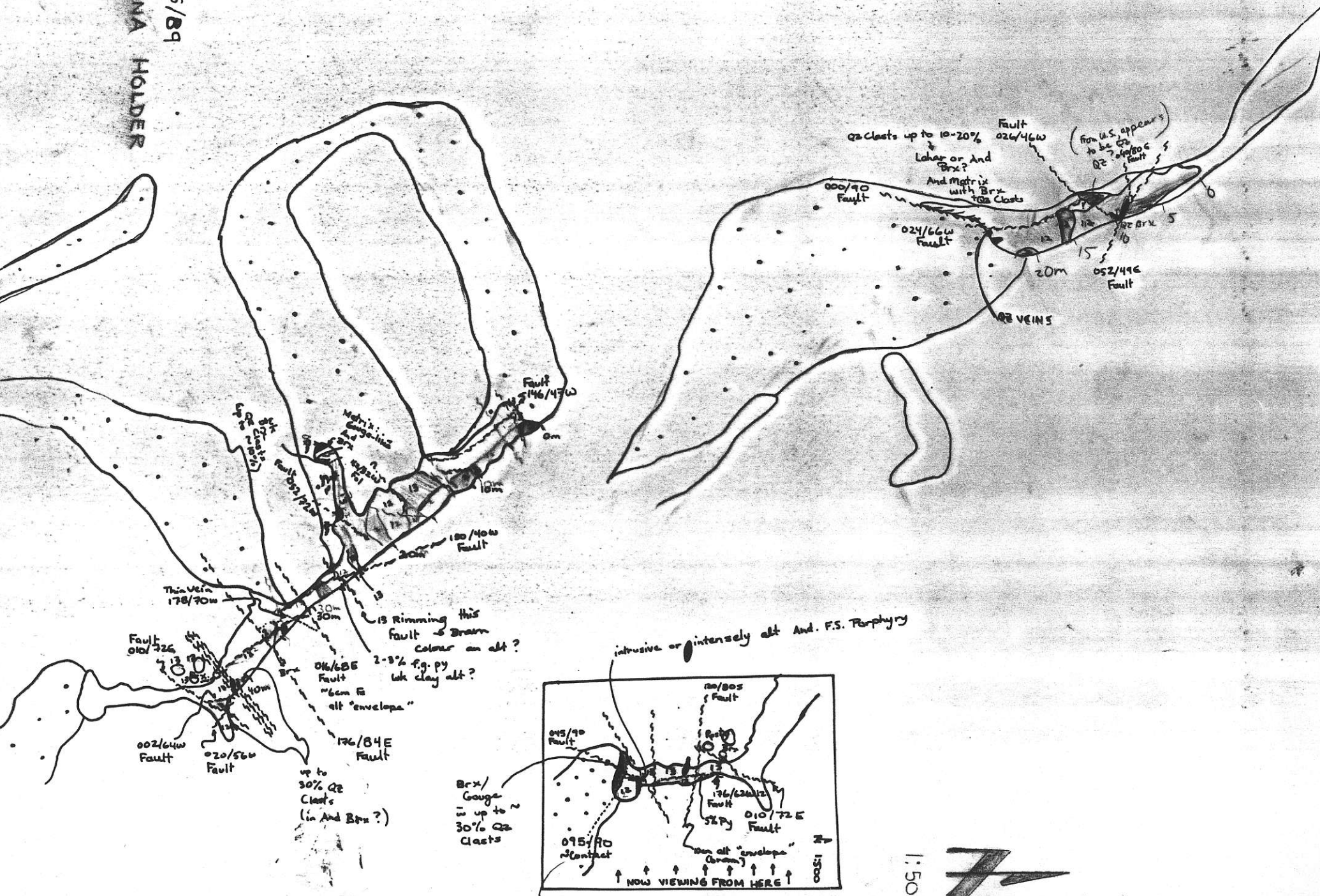

intrusive or intensely alt And. F.S. Porphyry

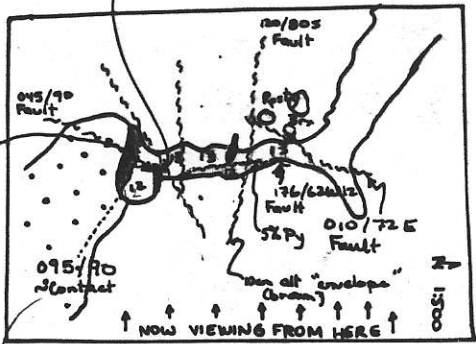

This Qz Brx, using strike of 095° aligns well with Qz Brx at end of top well that Gracie - I did not

1:500



--- : structure

N
1:500

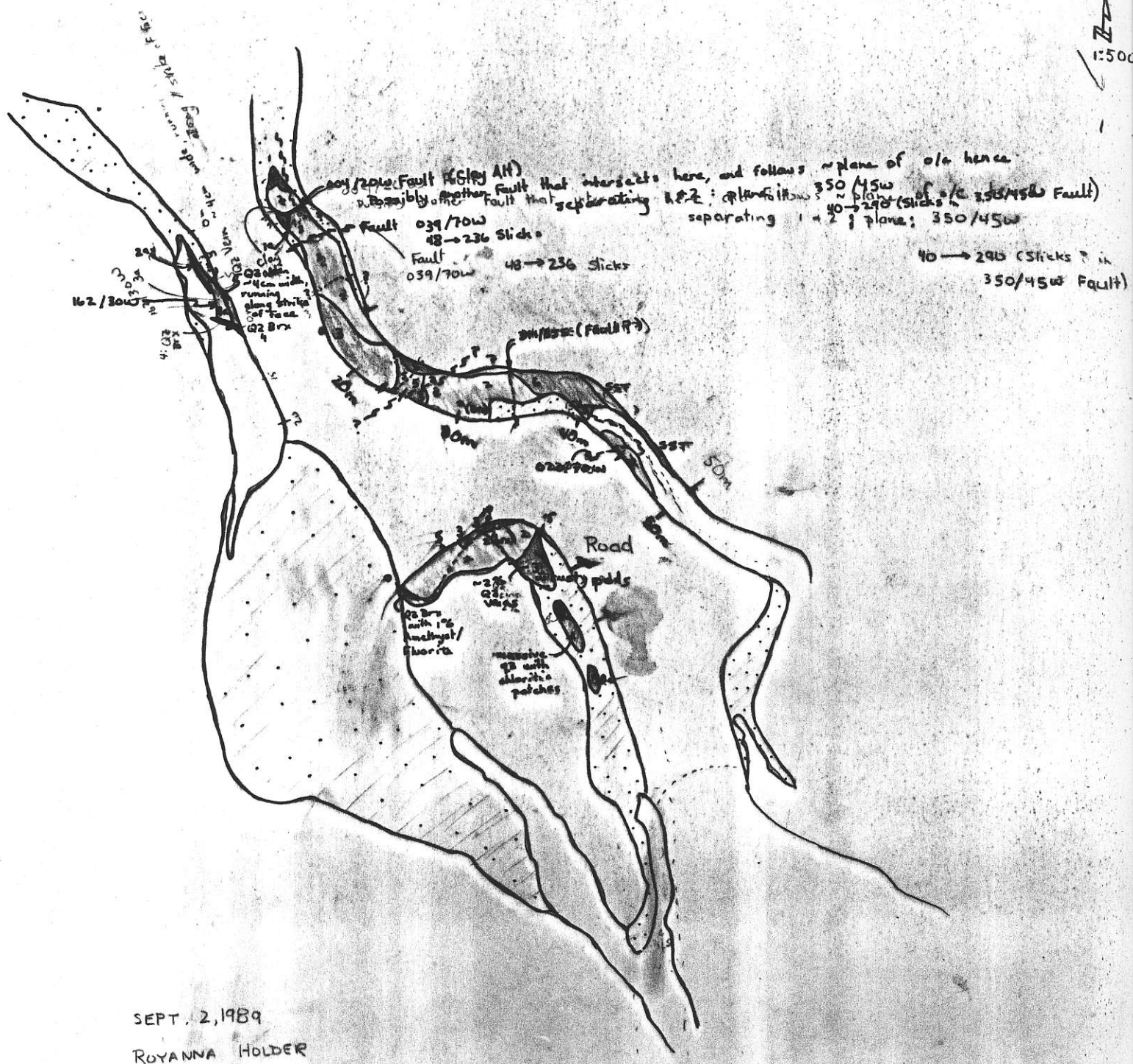

SEPT. 2, 1989
ROYANNA HOLDER

1:500

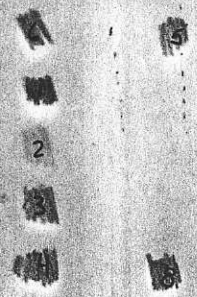

WEATHER: RAIN - MORNING
CLOUDS, SUN,
SHOWERS - AFTER-NOON

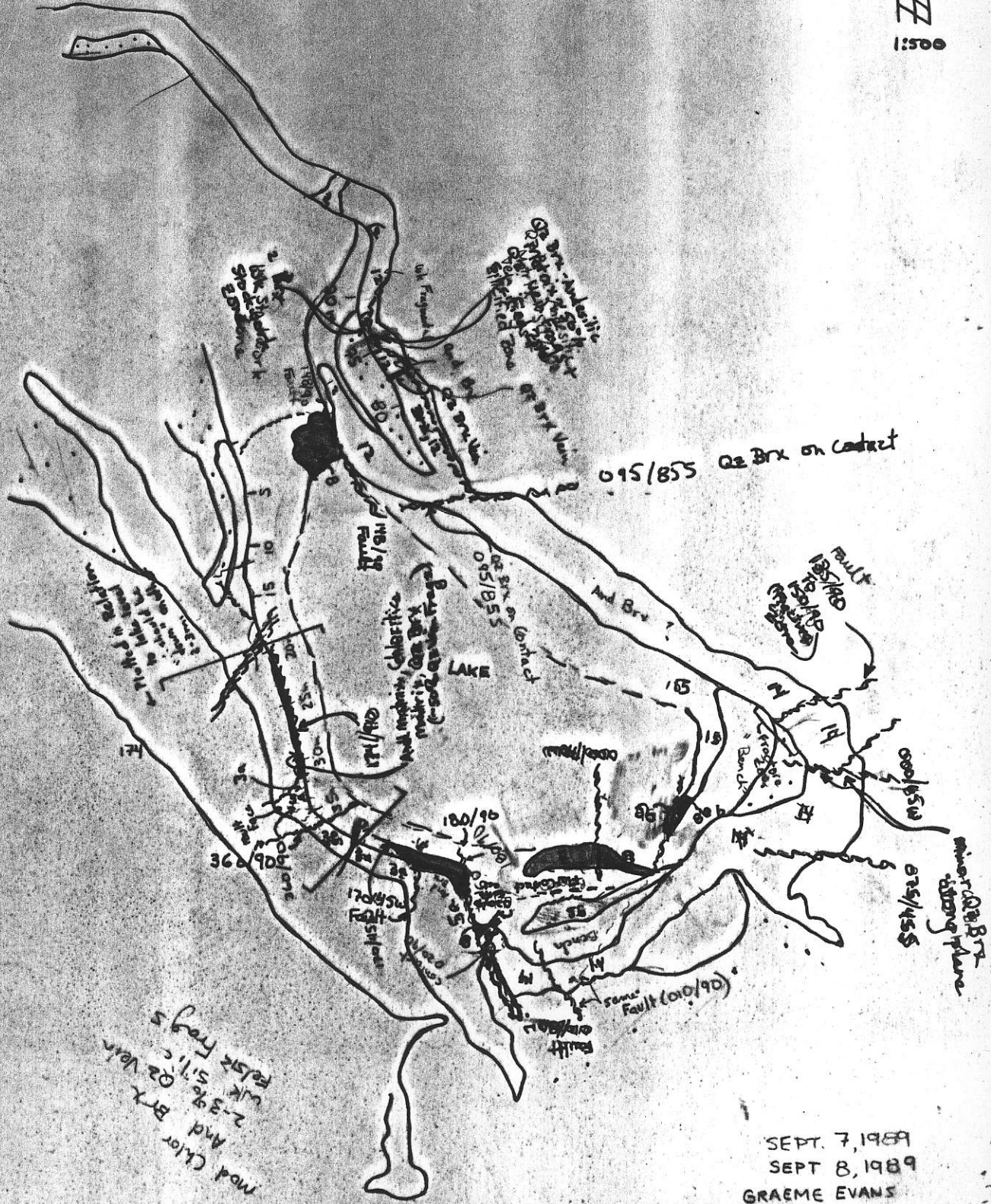

Mod Chlor BTK vein
 And BTK
 2-3% Qz vein
 felsic frags

SEPT. 7, 1989
 SEPT 8, 1989
 GRAEME EVANS
 ROYANNA HOLDER