

825151

ANDREW E. NEVIN CONSULTANTS LTD.
428-470 GRANVILLE ST.
VANCOUVER 2, B.C.

(604) 683-3425

August 2, 1971.

MEMORANDUM TO: Directors,
Dusty Mac Mines Limited (N.P.L.)

Re: McLeese Lake Area Progress Report,
April 15 - August 2, 1971.

From: Andrew E. Nevin, Ph.D., P.Eng.

CLAIMS

Claims MD 1 - 270, in seven separate groups, were staked by Company prospectors in late March and early April and were described, insofar as was known at that time, in my report of April 13, 1971.

Additional claims staked by Company prospectors since that time are MD 301 - 424, which are contiguous with the MD 86 - 112 group on three sides (see Drawing 5), and MB 1 - 200, a contiguous group immediately south of Mitchell Bay on Quesnel Lake (see Drawing 6).

A decision has been made not to record MD 349 - 424, thus the total number of claims will be 518, in eight large groups, (see Drawing 7).

WORK DONE

Geochemical Sampling

Approximately 1,500 soil samples have been taken on claim groups A, B, D, F and G. (Note that the letters A and C have been switched from those in the April 13 Report). The samples were taken of organic-free soil with an auger on 200-foot intervals along lines spaced 400 feet apart. The -80 mesh fraction was run for copper by Crest Laboratories Ltd. using the atomic absorption method. Slightly over 100 of the samples adjudged to be anomalous in copper were run for molybdenum also.

Geochemical results on Group A are shown in Drawing 8. Background is considered to be below 30 or 40 ppm Cu, and samples above 50 ppm are considered clearly anomalous. An irregular anomaly up to 1500 feet wide extends from Line 28E - Station 8N 6000 feet northwest to Line 8W - Station 52N. Several other anomalies of more than one sample also appear. No values are anomalous in several instances, as shown in Drawing 8.

Early geochem lines run on Group G returned several anomalous individual samples. The sampling has been completed, and the samples are in transit.

Groups B, D and F similarly have several one-sample highs, but sampling is still in progress and no pattern has emerged as of yet.

Bulldozer Trenching

Twenty-one trenches of about 8 - 16 feet deep were put in on geochemical anomalies in Group A (see Drawing 8). None of the trenches reached bedrock. They all bottomed in glacial gravels. Trench #18 (16W - 24N) turned up one cobble of azurite-bearing granite which assayed 1.48 per cent copper and 2.0 oz. of silver, and trench #11 (16W - 20N) turned up a jagged boulder of iron carbonate rock which contained weak traces of green copper.

Access to the large anomaly by the bulldozer was blocked by very wet ground at that time.

Copper geochemical results from the bottoms of the trenches are also shown on Drawing 8.

Induced Polarization

Atled Exploration Management Ltd., under the direction of Philip P. Nielsen, has completed a programme of 13 line-miles of I.P. on Group A using a Seigel MK VII unit. They ran lines 32W, 24W, 16W, 8W, 0, 8E, 16E,

and 24E, with most lines extended 3,000 feet north of the geochemical grid (that is, they ran from 14S to 90N).

They found that background is about 4ms and that no significant anomalous responses could be obtained.

Prospecting: Mitchell Bay Claims

The MB 1 - 200 claims were staked on a copper showing south of Mitchell Bay on Quesnel Lake. The rocks are a series of volcanics, specifically, a brecciated rhyolite tuff, a pyroxene andesite, a massive gray basalt, and a hornblende dacite. Two copper occurrences are present. The first, at the initial post of MB 37 and 38, is an old trench about 15 feet long and a few feet high, exposing a rhyolitic rock altered to a garnet-epidote-magnetite-pyrite skarn. Samples from this assayed 0.06 and 0.14 per cent copper. The second showing, 950 feet to the east, is a malachite stain in basalt, one sample of which assayed 0.57 per cent copper. Scattered outcrops of volcanics between the two showings contain strong traces of magnetite and weak traces of very finely disseminated pyrite.

PRELIMINARY CONCLUSIONS

1. Interest in Group A has diminished. The ground was recognized to be gravel-covered and in need of indirect methods. The large geochemical anomaly is so closely coincident with swampy ground, that since no I.P. response could be obtained, it appears that the anomaly may reflect copper fixed by organic material.
(In short, I.P. works well in swamps; soil geochemistry does not.)
2. In general, with reference to the other groups, the clay content of the glacial gravels would not seem to interfere with I.P.
3. The clays are thick enough, however, that they may be impermeable to the geochemistry of the underlying rocks.

CURRENT AND PROPOSED WORK

1. Geochemical sampling is continuing with two prospectors and two casual helpers. New sampling is planned on the other group and will be done on lines spaced 1,000, 1,500 or 3,000 feet apart, depending on conditions, and with stations 300 feet apart.
2. I.P. will be considered for selected areas on the other groups.
3. Photogeologic and ground geologic mapping have been started, supported by petrologic (microscope studies) of some of the intrusive rocks, where there is enough outcrop to make such work worthwhile, in particular, on the G, B-D-F, and Mitchell Bay groups.
4. Percussion or diamond drilling will be considered when sufficient anomalies have been developed to warrant it.

Respectfully submitted,

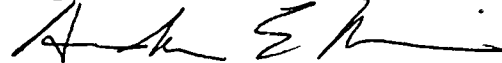



ANDREW E. NEVIN, Ph.D., P.Eng.

ILLUSTRATIONS

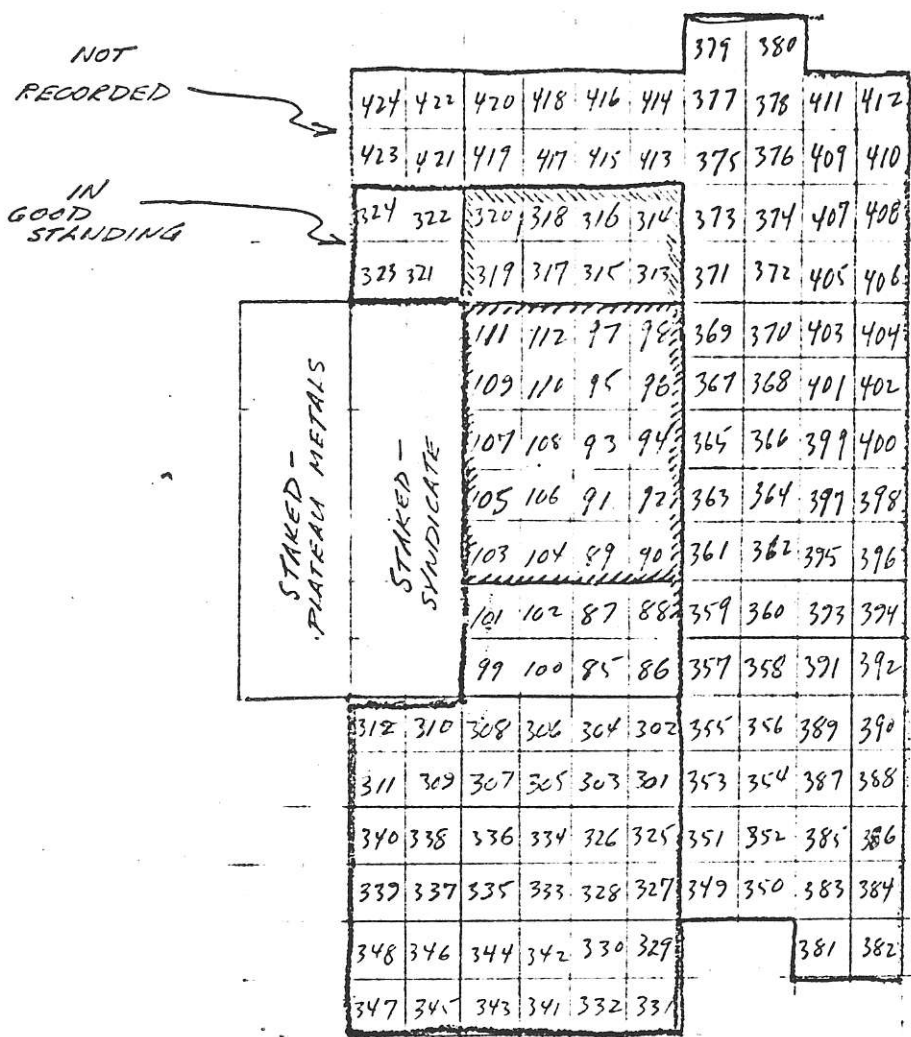
- Drawing 5 Map of Group A, Claims MD 86 - 112 and 301 - 424
- " 6 Map of MB Claims
- " 7 Map of Dusty Mac Claims
- " 8 Geochemistry and Trenches, Group A.



 = Area of geochem grid (Drawing 8)

 = Continuation of 1P North off geochem grid

STAKED - Canadian Superior
 DUSTY MAC MINES LTD. (NPL)
 MAP OF MD 85-112 and 301-424 CLAIMS
 (GROUP A)
 McLEESE LAKE AREA, B.C.

SCALE 1:63,360
 E. BUCK 7/71

DRAWING 5
 AEN.

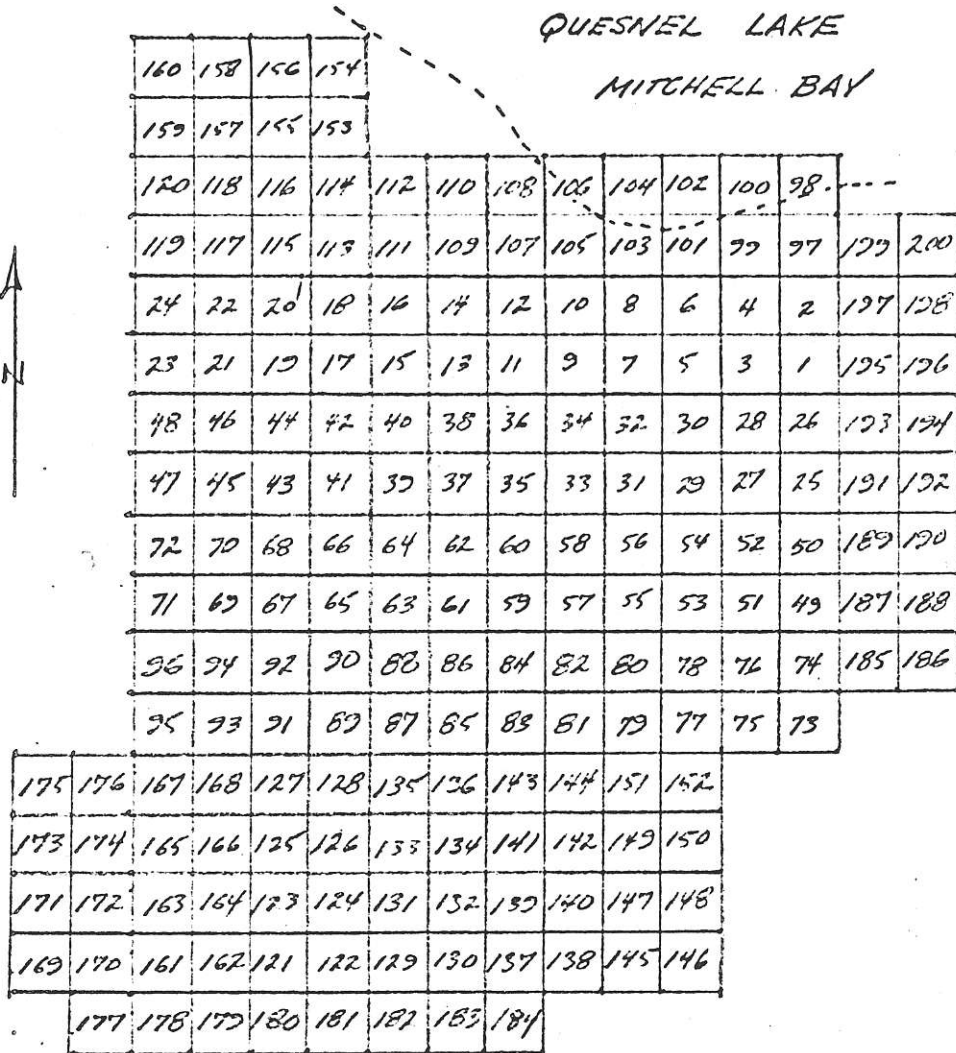

DUSTY MAC MINES LTD. (NPL.)

MAP OF MB1-200 CLAIMS

QUESNEL LAKE AREA, B.C.

E. BUCK 7/71

1" = 5000'

1:60,000

DRAWING 6

A.E.N.

122°00'

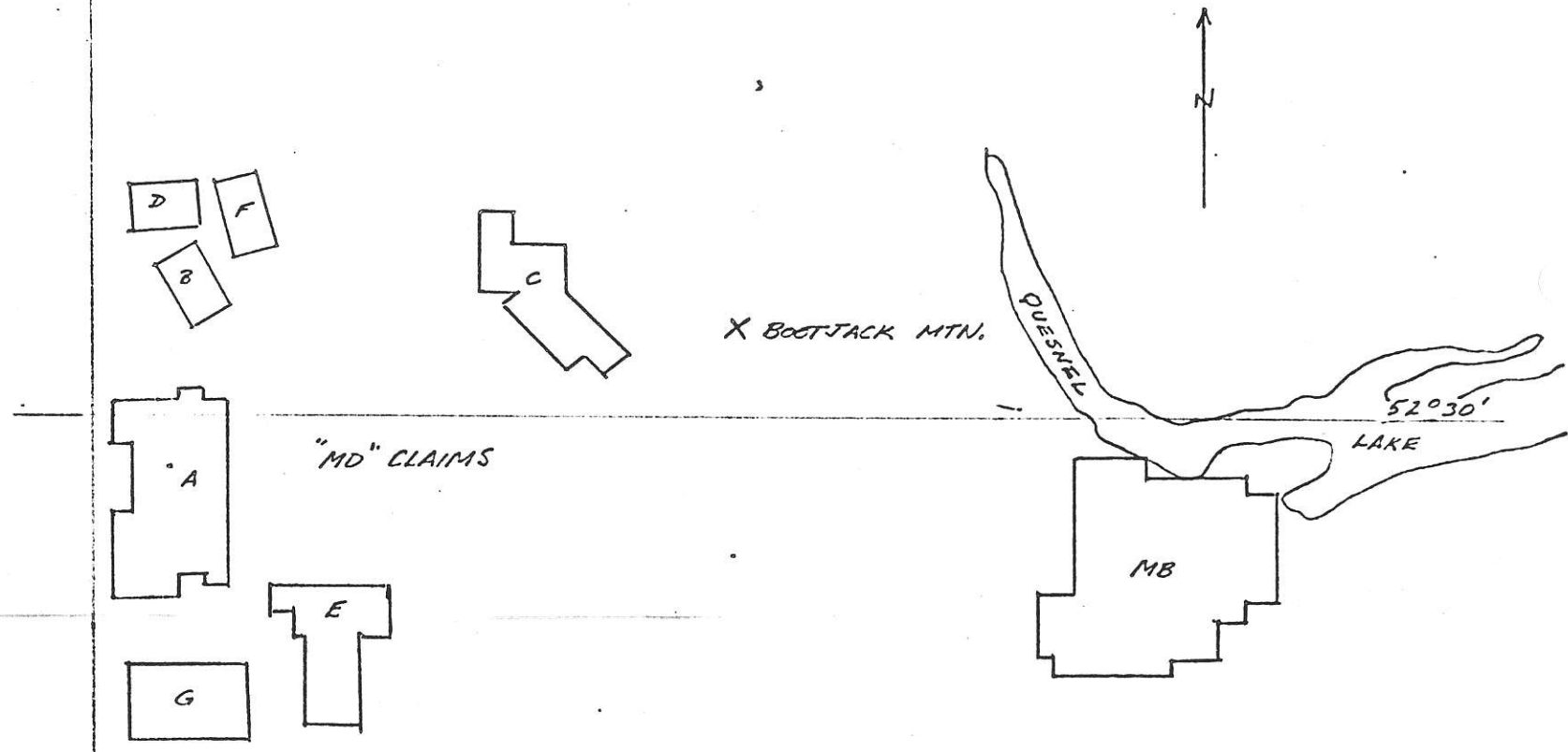

DUSTY MAC MINES LTD.

CLAIMS, CARIBOO M.D.

SCALE 1" = 4 MILES

1: 253,440

DRAWING 7

AEN 7/71

ANDREW E. NEVIN CONSULTANTS LTD.
426-470 GRANVILLE ST.
VANCOUVER 2, B.C.

(604) 683-3425

August 2, 1971. *Rec'd:*

Mr. Carl R. Jonsson,
Dusty Mac Mines Ltd. (N.P.L.)
1710-1177 W. Hastings St.,
VANCOUVER 1, B.C.

Dear Carl:

Re: DUSTY MAC - McLEESE LAKE PROPERTIES

Enclosed are five copies of a progress report on the McLeese Lake claims. If this meets with your approval, I will leave it up to your office to distribute these to the other Directors.

As you know, some of the outside prospecting done by Ernie Buck a month or so ago, appears to be worth following up and we are doing so.

Also, reconnaissance I.P. is due to start August 4 on the P.O.D. Claims in the Tunkwa Lake area of the northern Highland Valley. I will map the geology there on August 3 and 4.

Yours very truly,

ANDREW E. NEVIN CONSULTANTS LTD.



A.E. NEVIN
Ph.D., P.Eng.

AEN:mdc.
Encl.

Carl R. Jonsson

August 9th, 1971

TO: The Directors of:

DUSTY MAC MINES LTD. (N.P.L.)

Re: McLeese Lake Properties

We enclose herewith for your records a copy of the Report dated August 2nd, 1971 submitted to the Company by Andrew E. Nevin with respect to the "MD" and "MB" claims. The Report was submitted to us for approval. I have no objections except with respect to the accuracy of the first paragraph. The first "MD" claims were not, of course, staked by Company prospectors but were staked by prospectors from whom we bought the claims. I would presume that we should continue to follow Mr. Nevin's recommendations about further work by way of continuing the soil sampling and possibly doing further IP work. Please let me have any comments you may have if you do not agree.

Yours truly,

SHULMAN, TUPPER & COMPANY

Per: Carl R. Jonsson

CRJ/jr
copies sent to:
Mr. I. Shulman
Mr. H. Field
Mr. H. Laycraft
Mr. P. Brown
Mr. D. McDonald