

MOSQUITO KING
 Field
 Sheet 824653
 Plateau Project

1:500

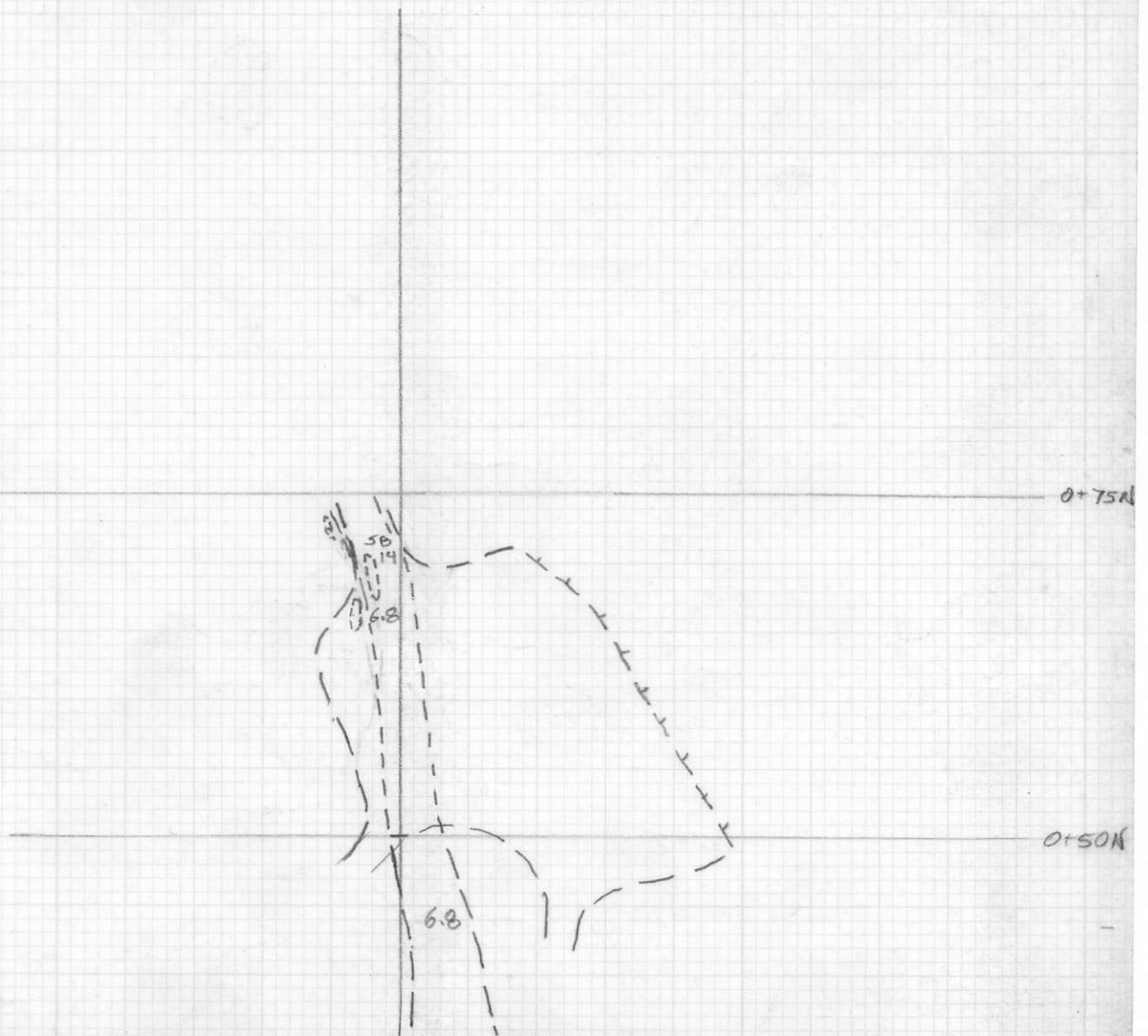

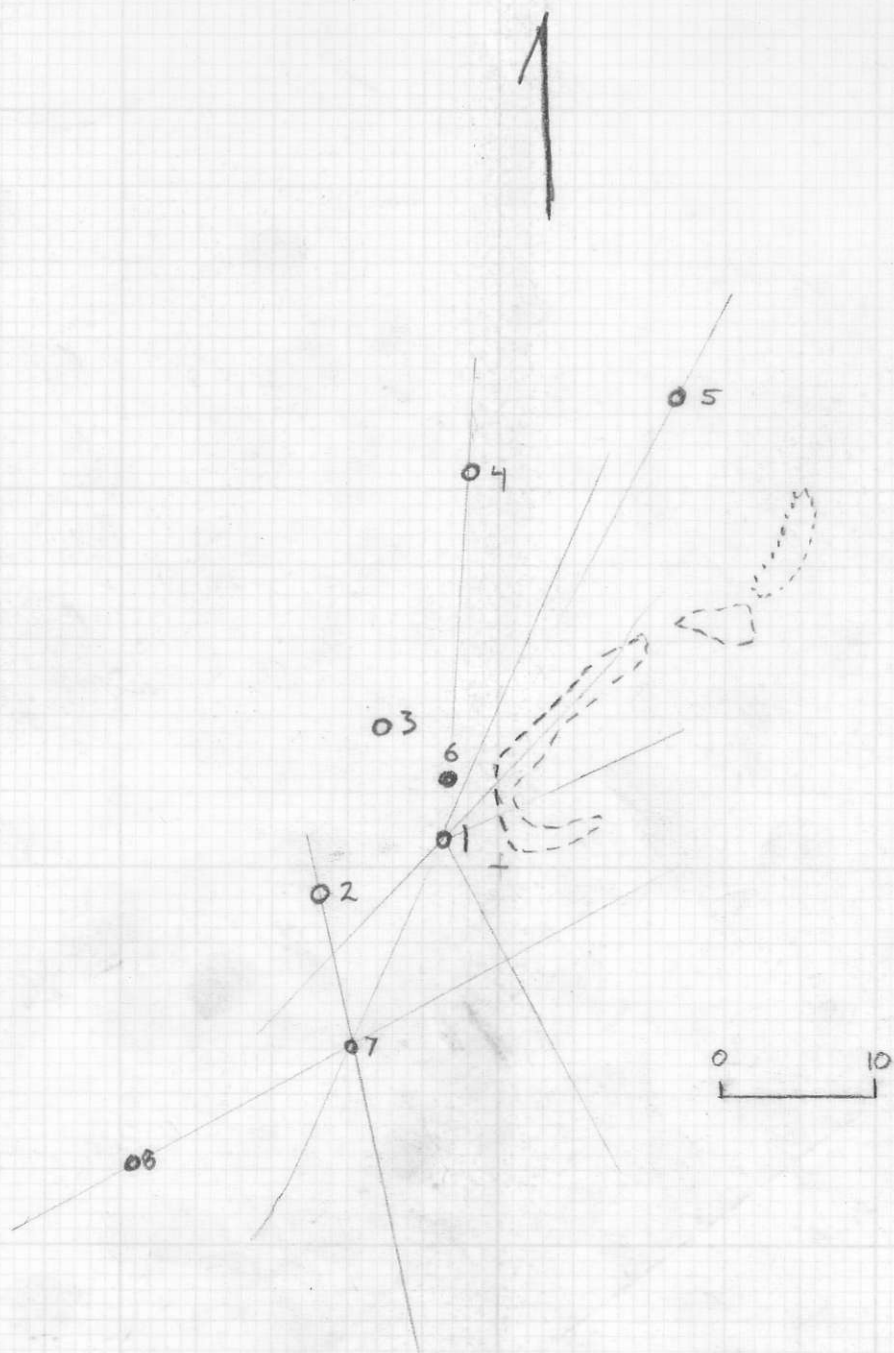

1:500

| | Bearing | Dist |
|---|---------|-------|
| 2 | 065 | 9-10 |
| 3 | 140 | 8 |
| 4 | 005 | 20 |
| 5 | 027 | 32-33 |
| 6 | 000 | 4 |
| 7 | 022 | 15 |
| 8 | 042 | 30 |

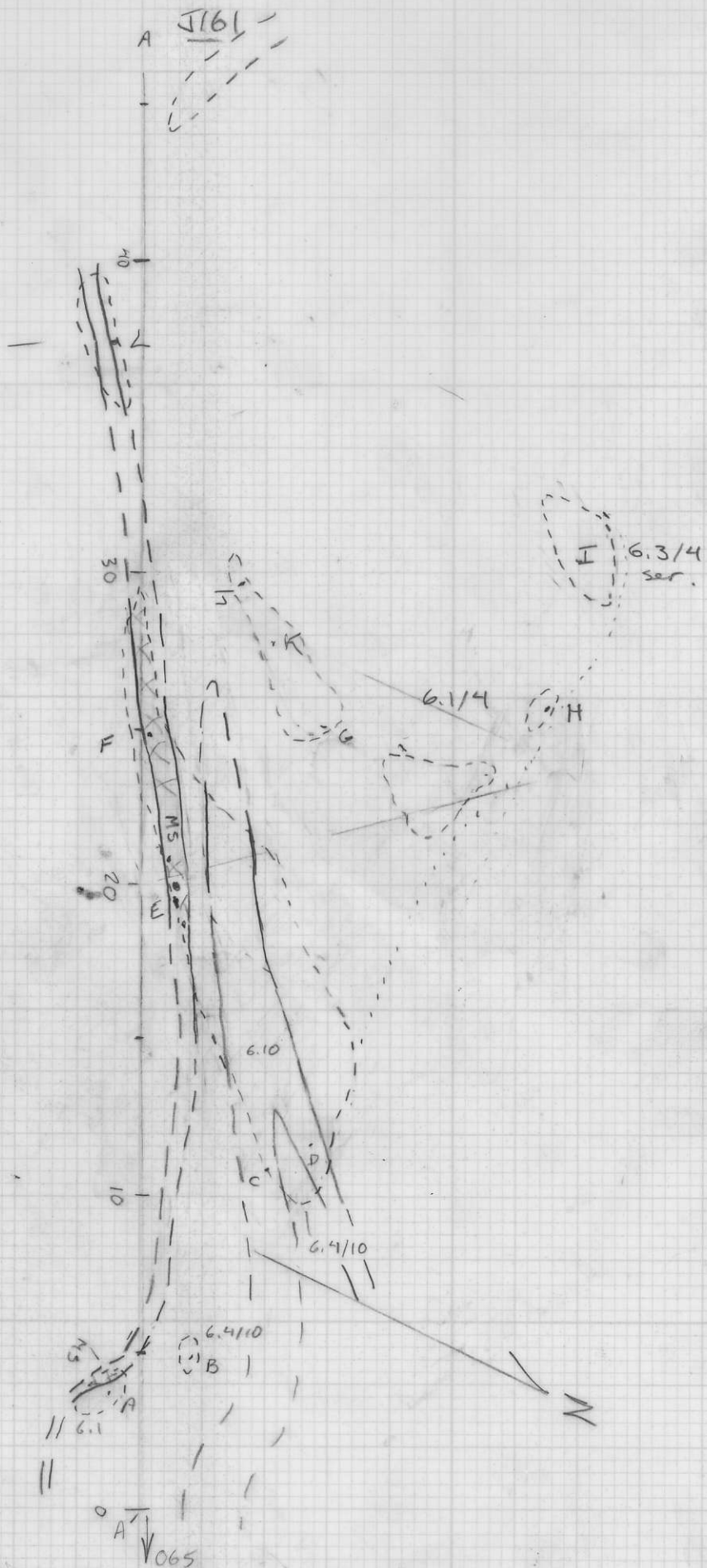

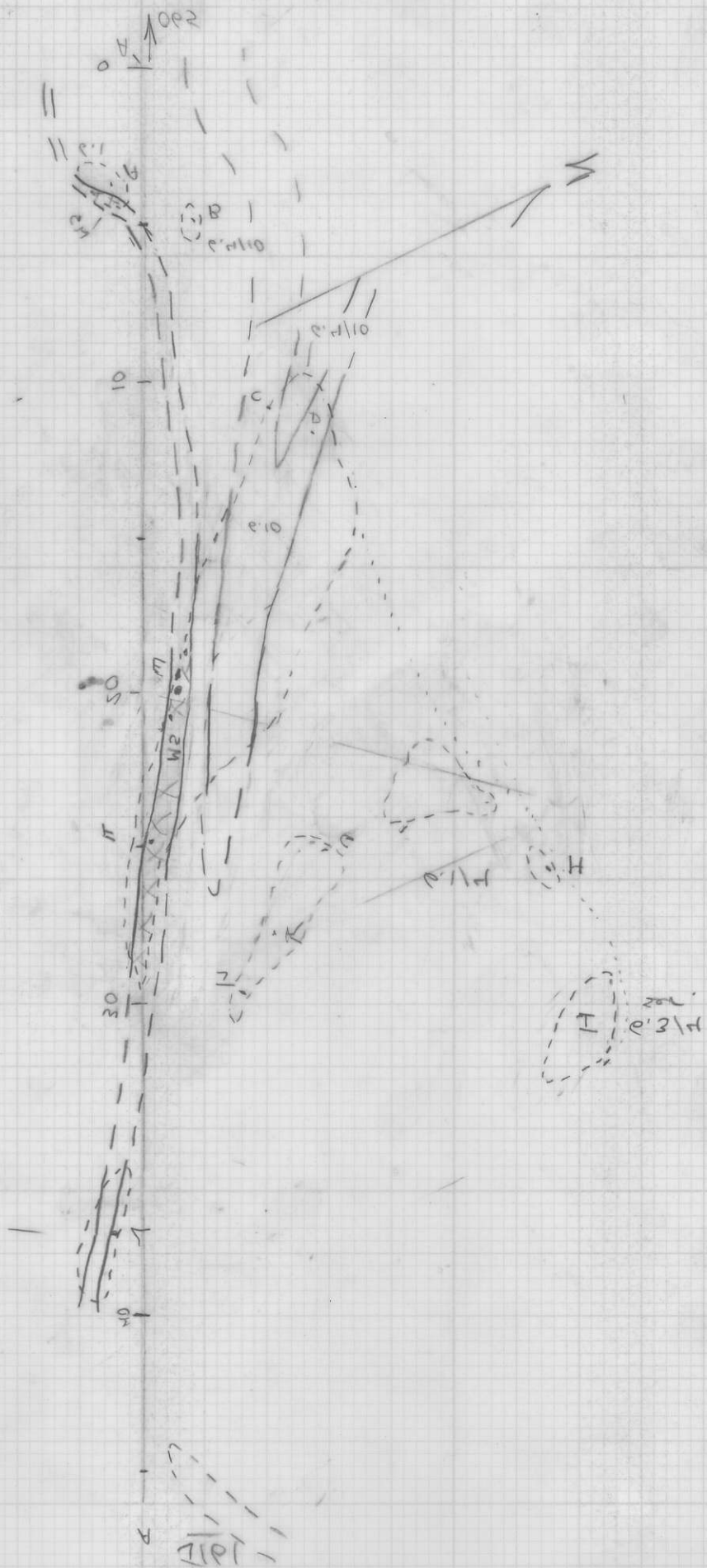

JB1419
Lower
Shewing

Facing 300

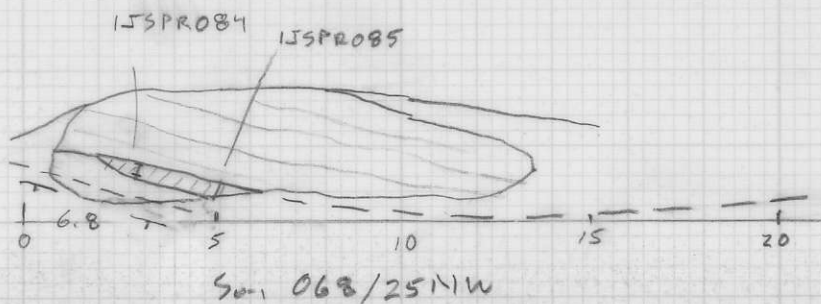

Facing 315

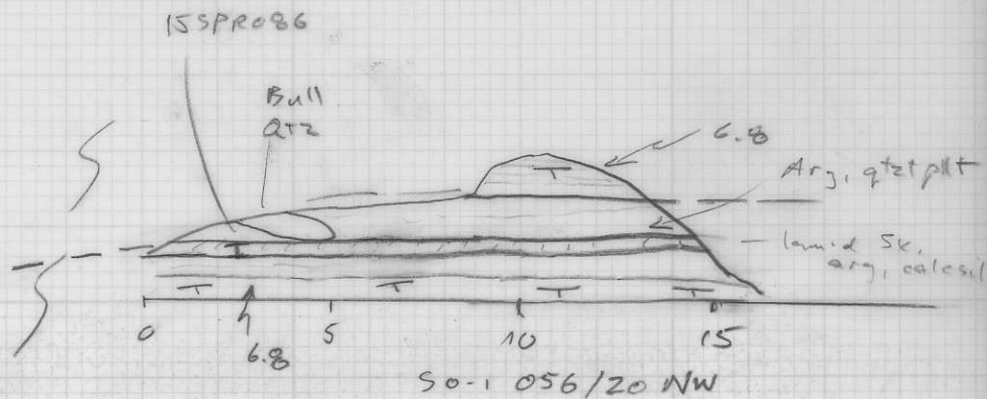

2 Blind
Lower
Stairway

Facing 312

Facing 300

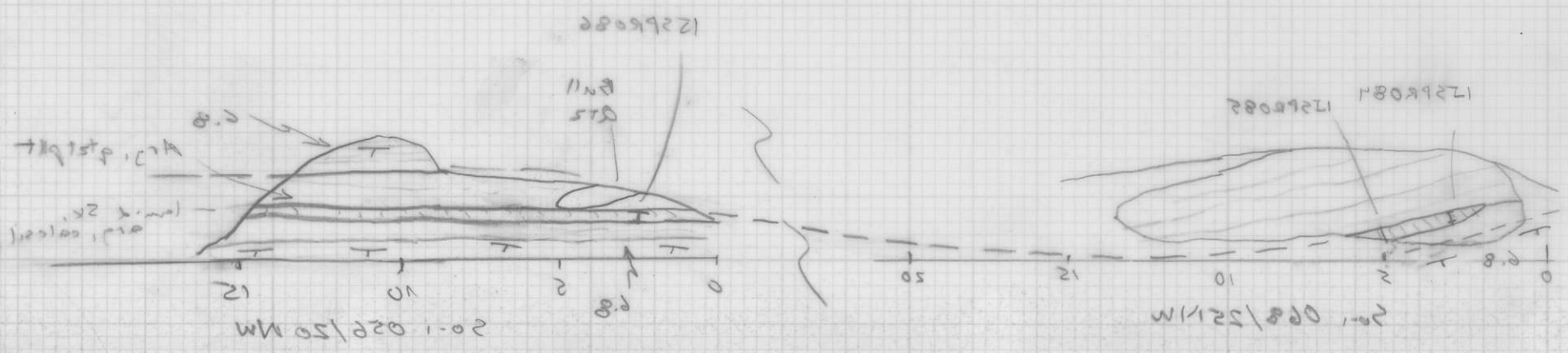

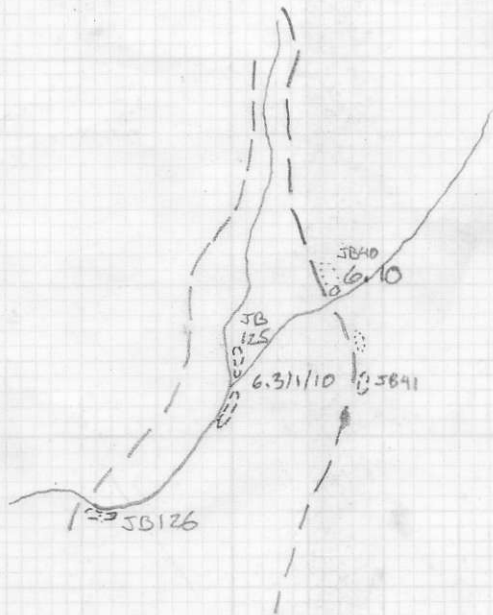

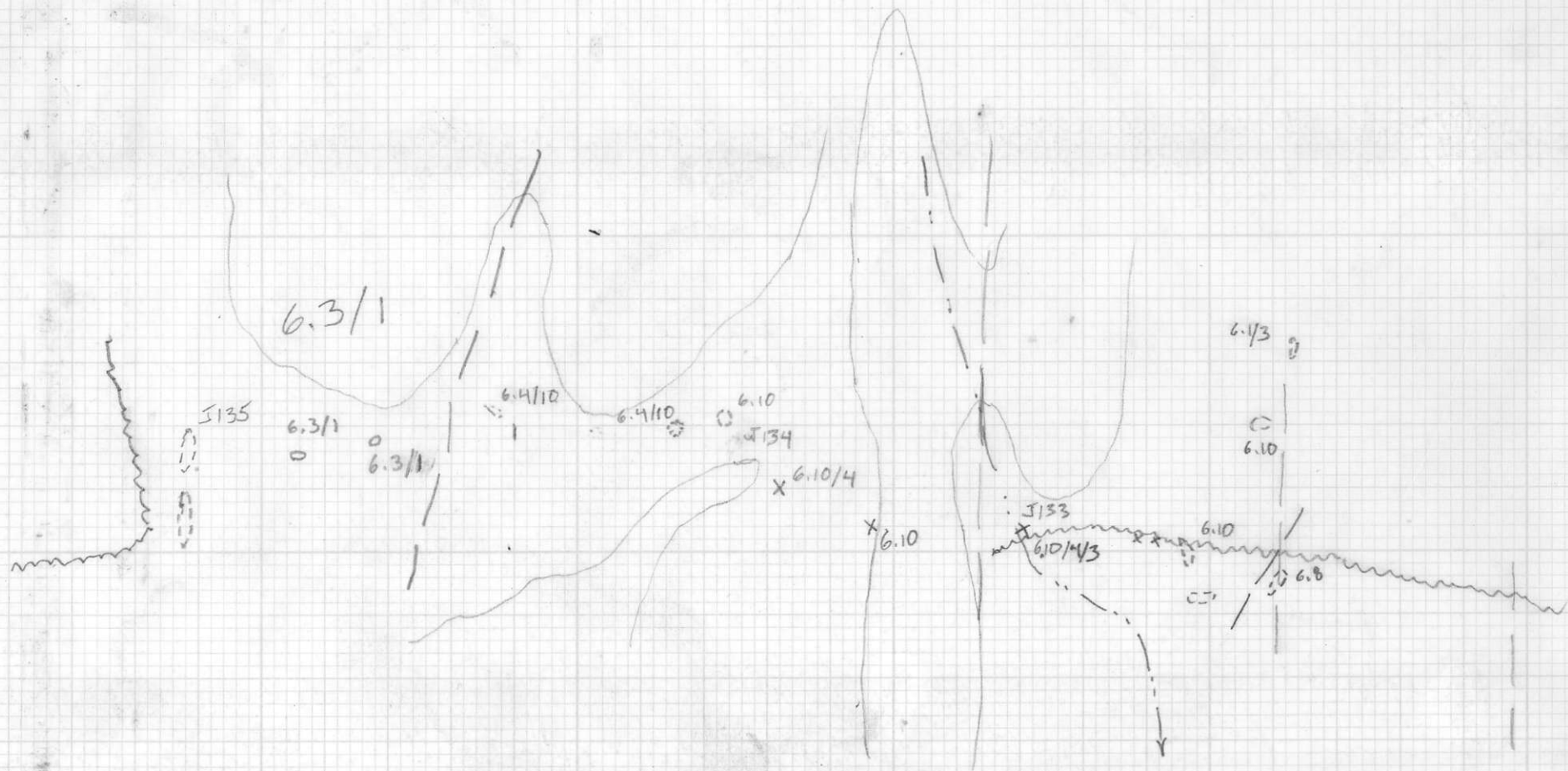

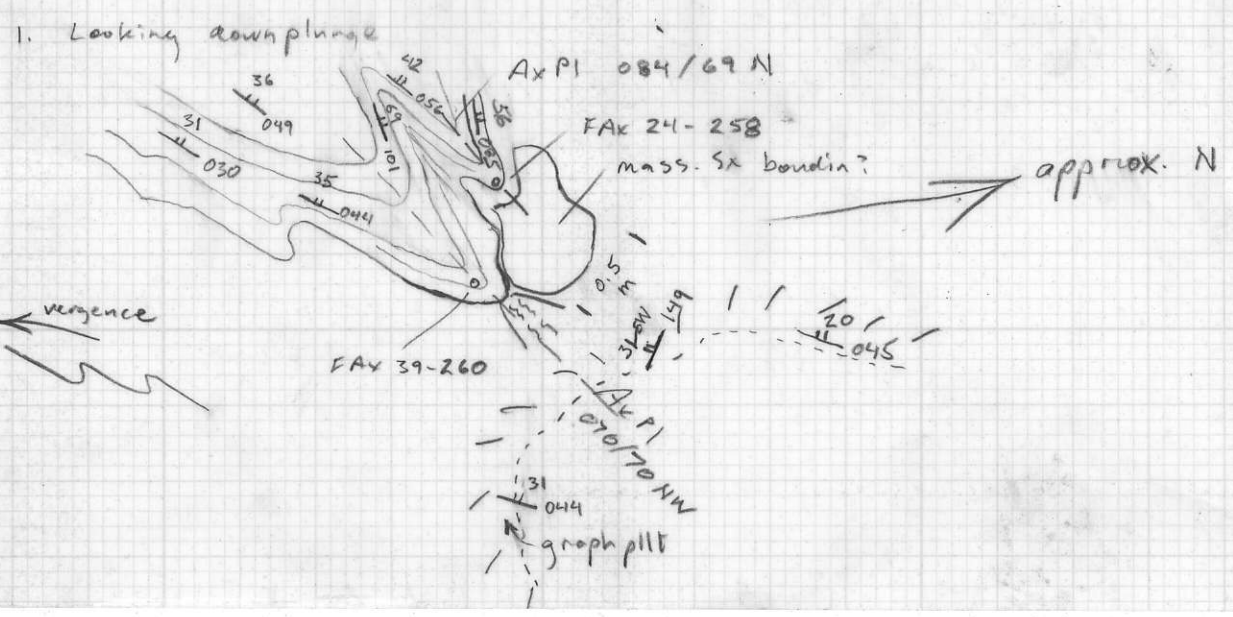

00+0

20+0

0+20

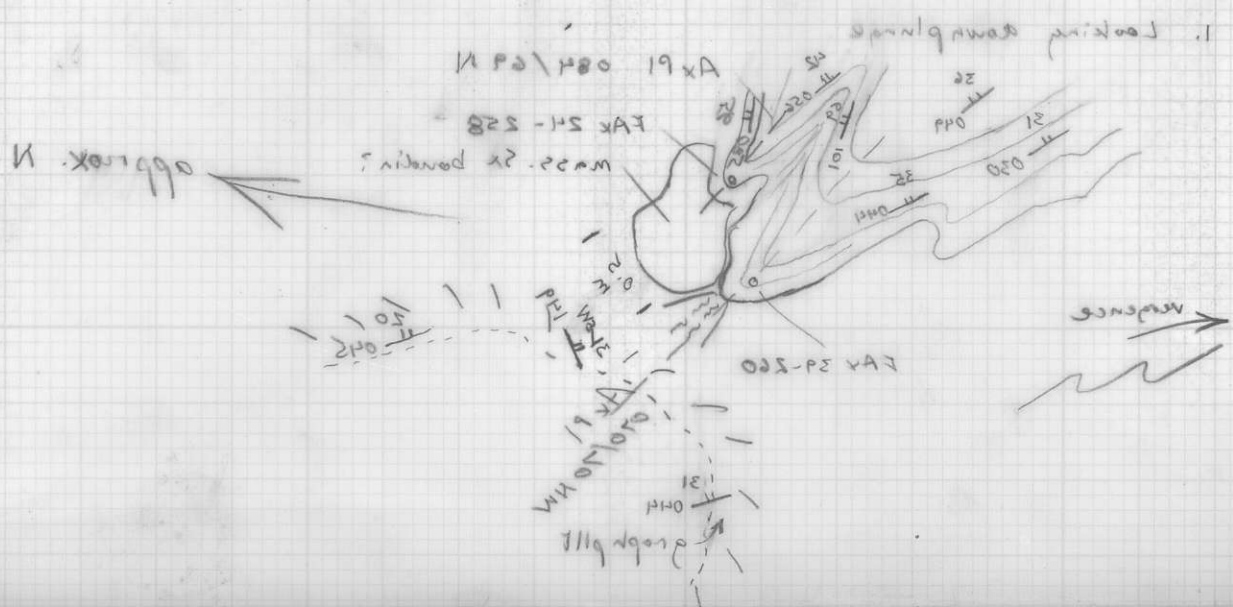
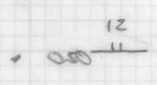

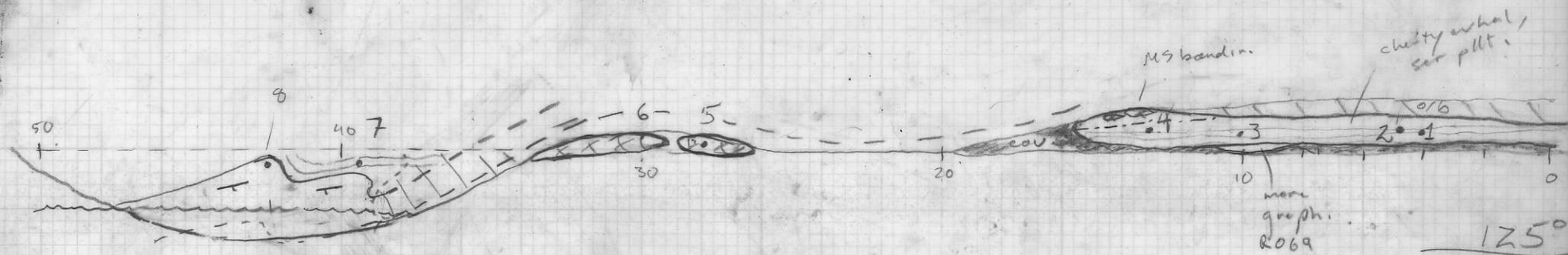

T-12
SW side

125°

30

Mass. Sx 40

19

F3 fld.

arg 1st

50



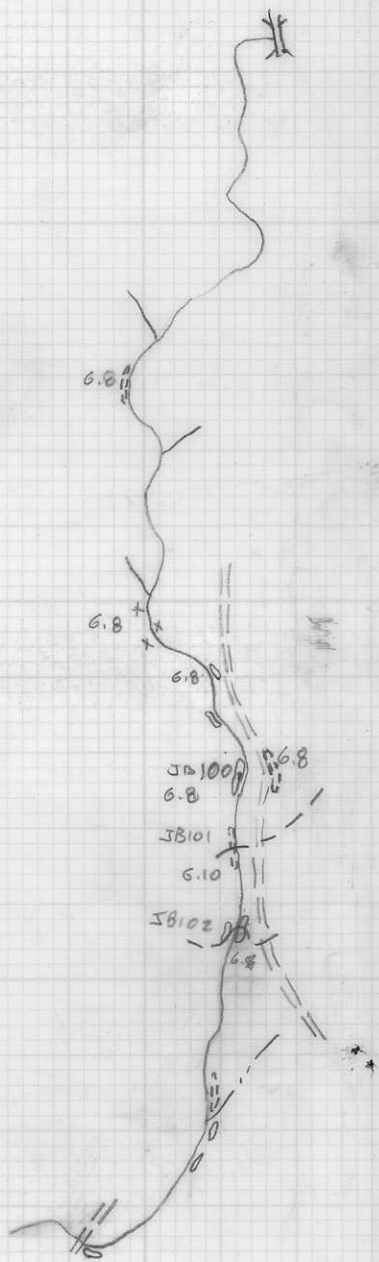

Clearcut block
N. of Spar
1:10,000

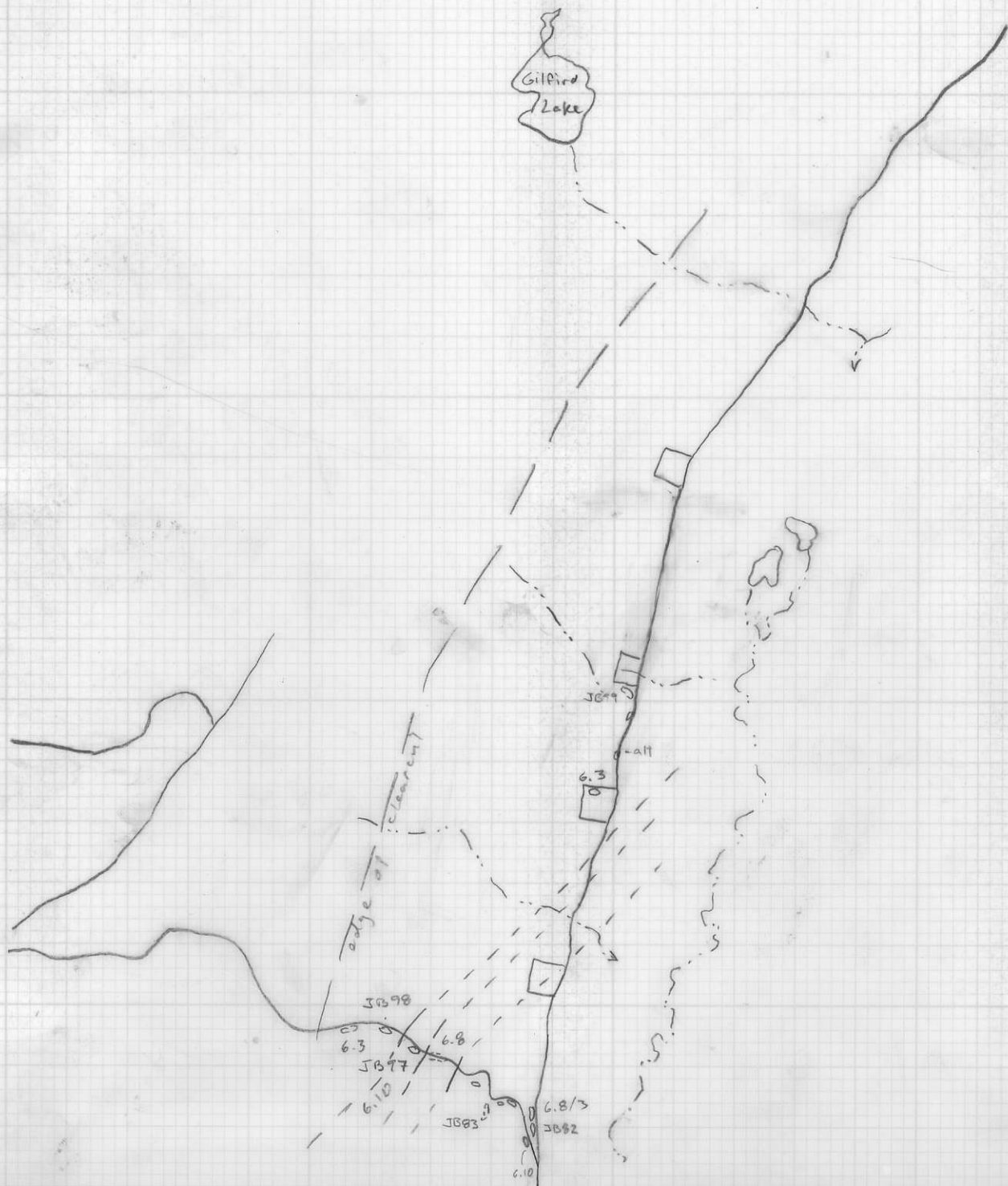



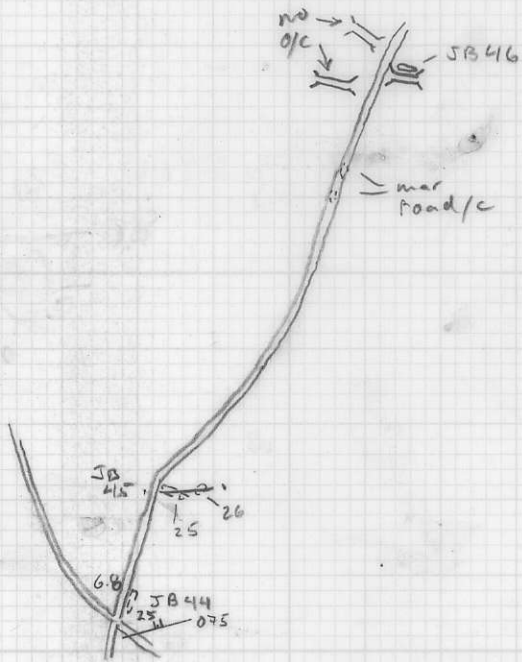

Wside Trench N-3

Trench N-3
Eside

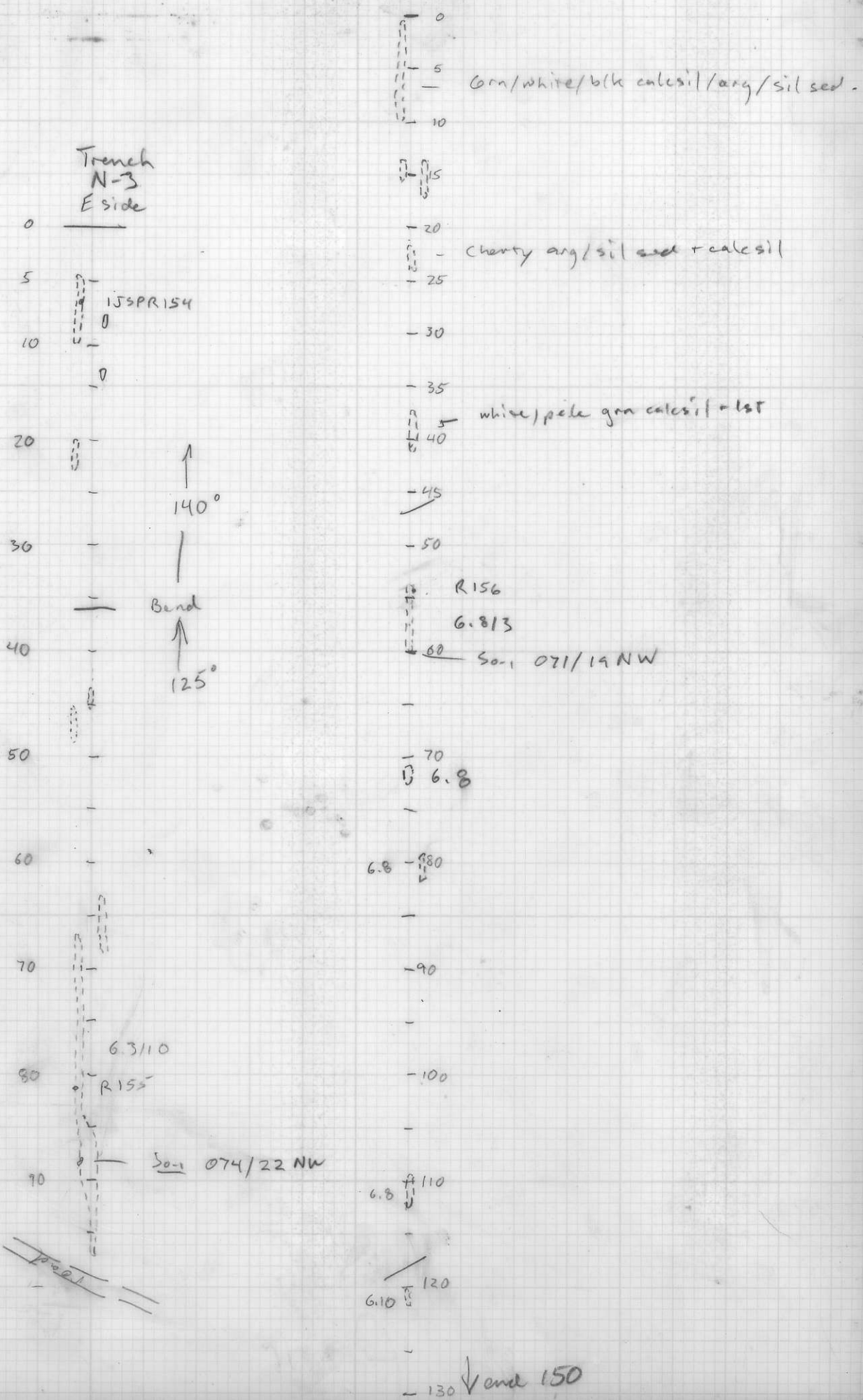

| <u>S_i</u> | <u>F_i fld Axis</u> | <u>F_i AxPI</u> |
|----------------------|-------------------------------|---------------------------|
| 135/48 | 10-129 | 130/50NE |
| 159/40 | | |
| 134/47 | | |
| 131/55 | | |
| 132/46 | | |
| 117/64NE | | |
| 116/55 | | |

NW side
Adams L

| <u>F₃ fld Ax</u> | <u>F₃ AxPI</u> | <u>L_{3c}</u> |
|-----------------------------|---------------------------|-----------------------|
| 18-099 | 109/63 SW | 14-104 |

Looking West

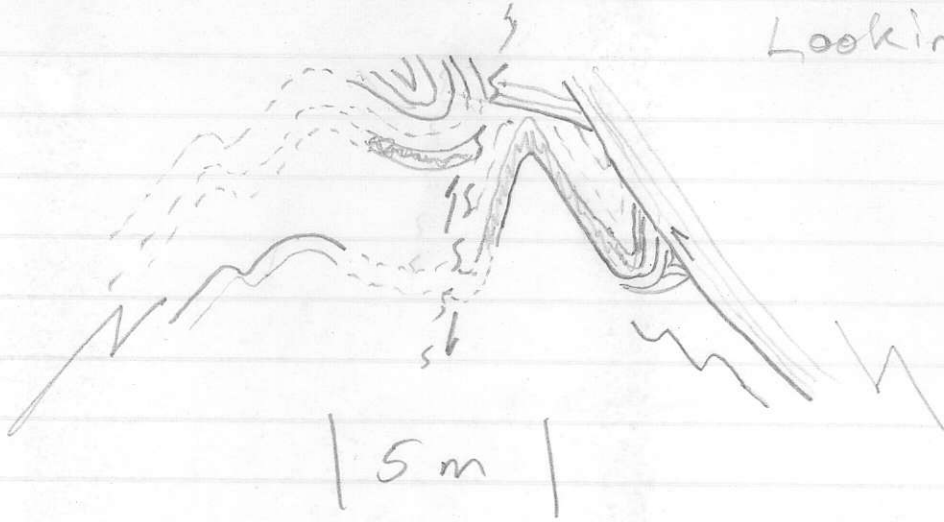

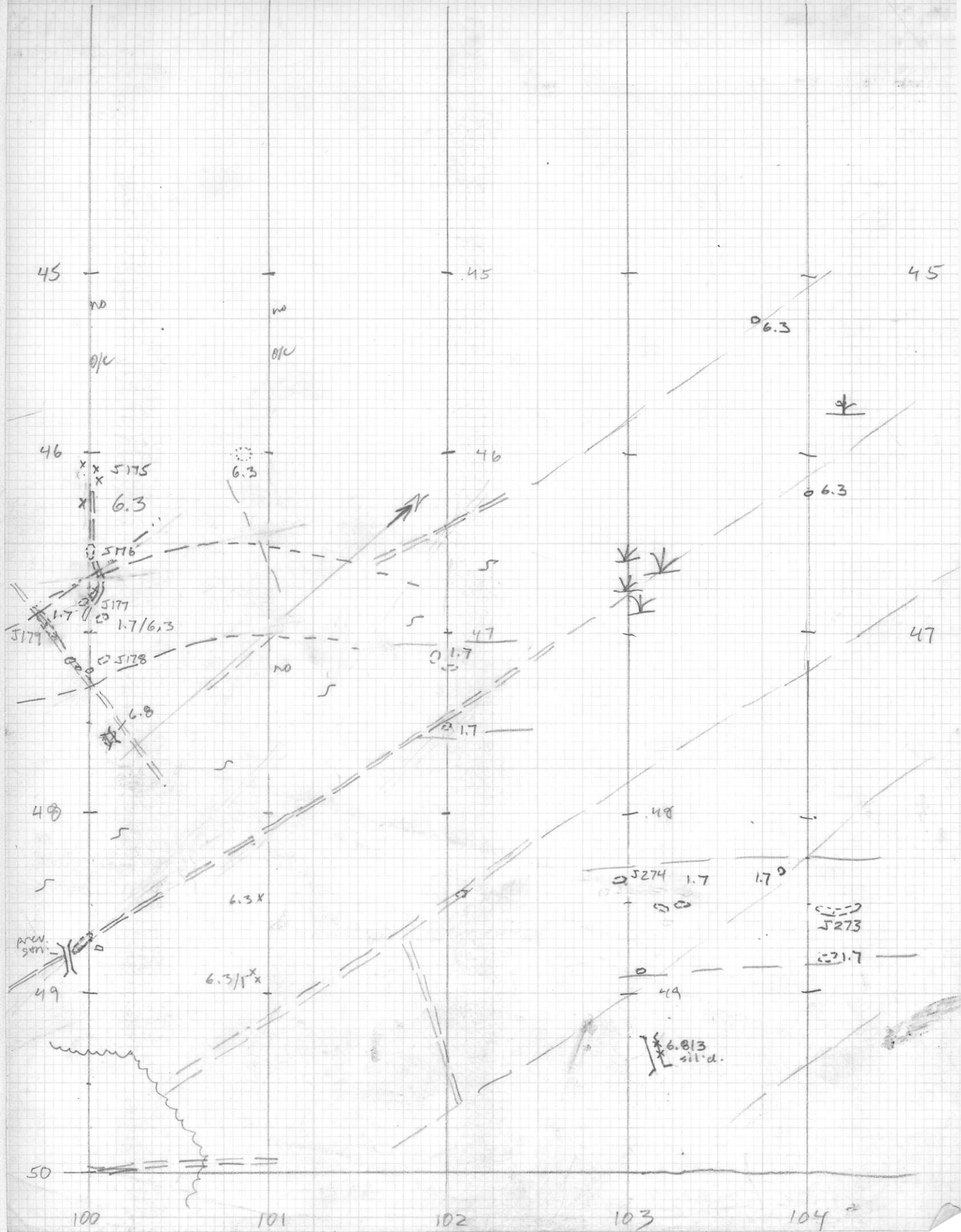

11000

11020
11030

11000

11020

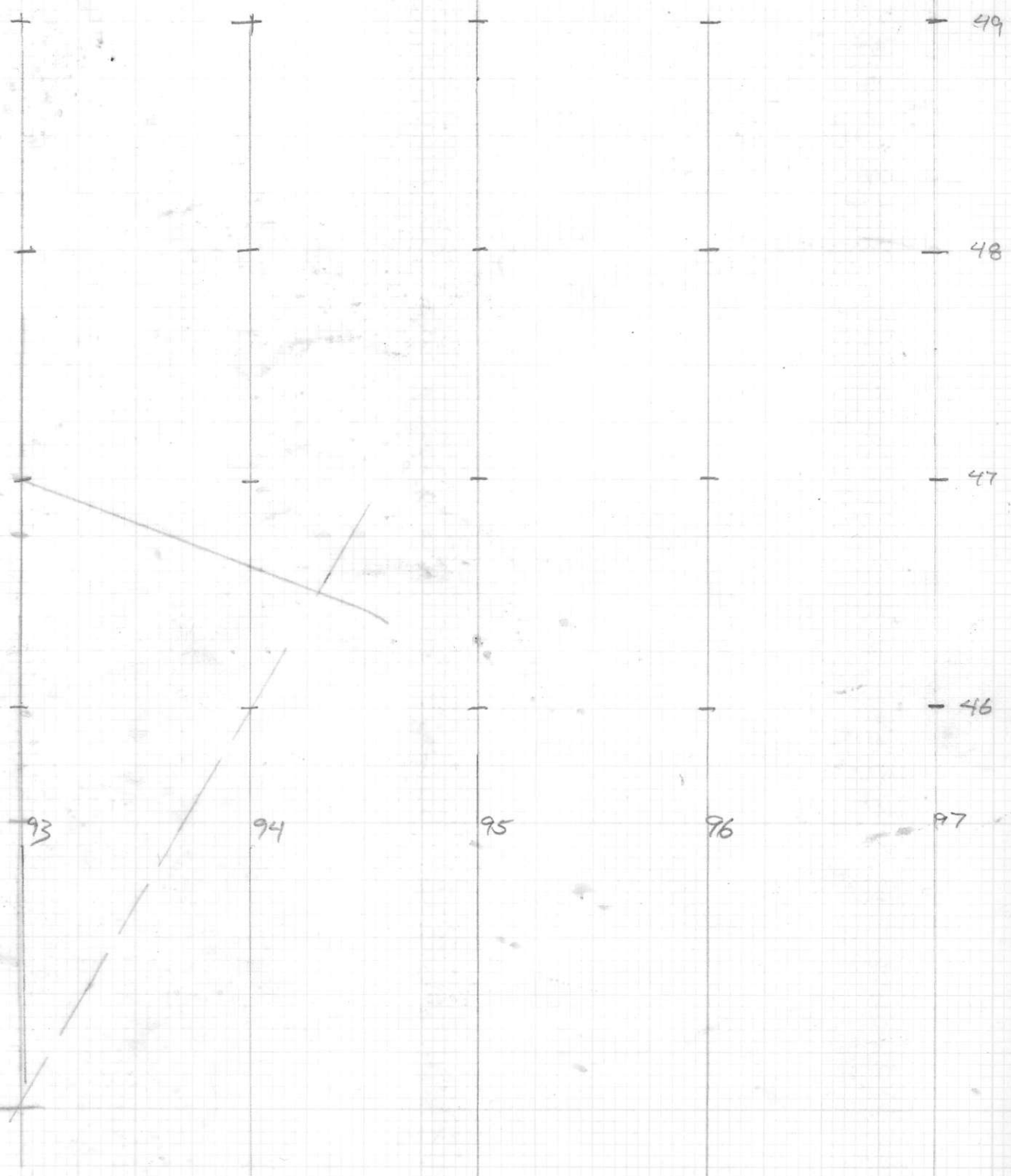

49

48

47

46

45

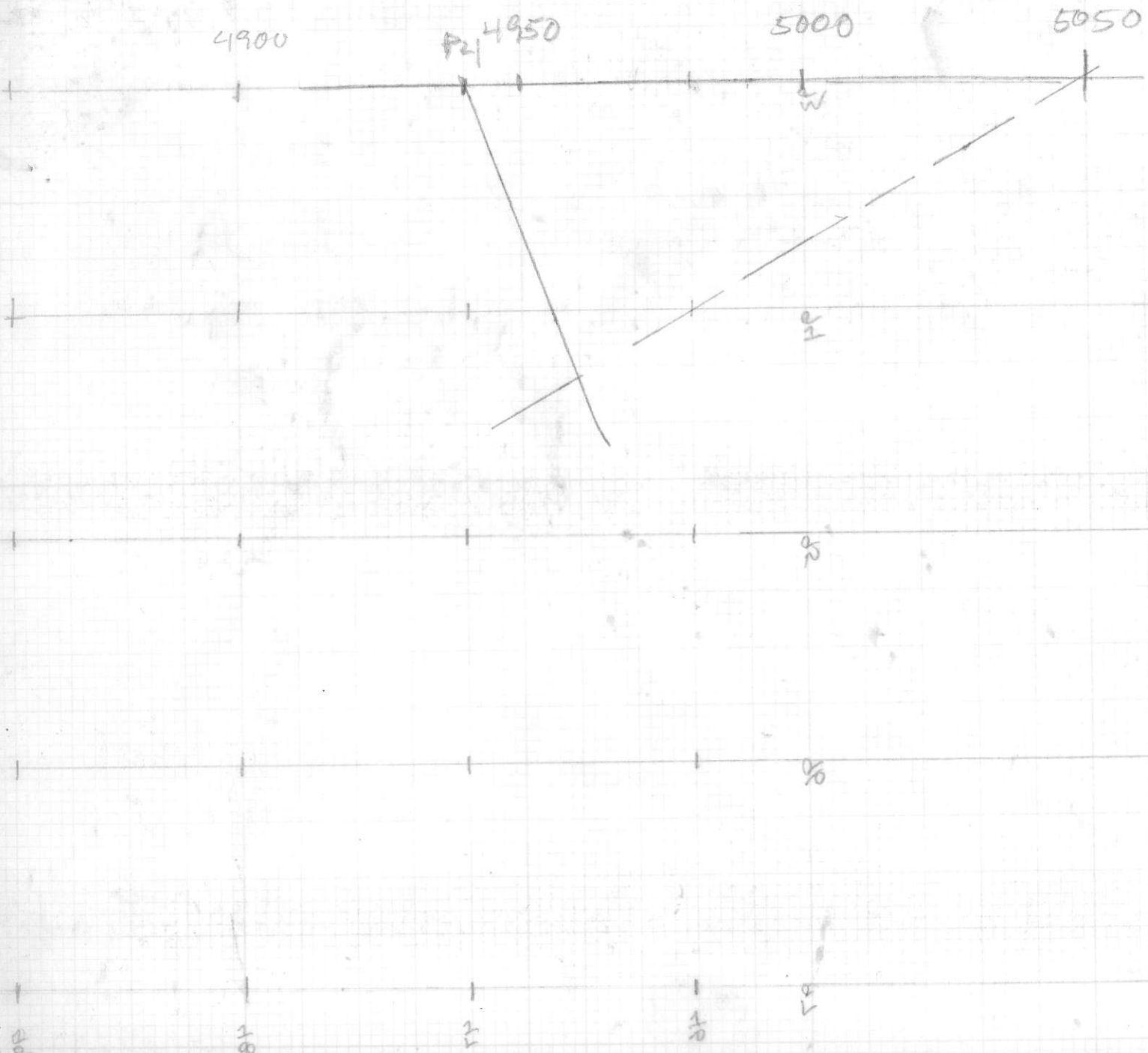

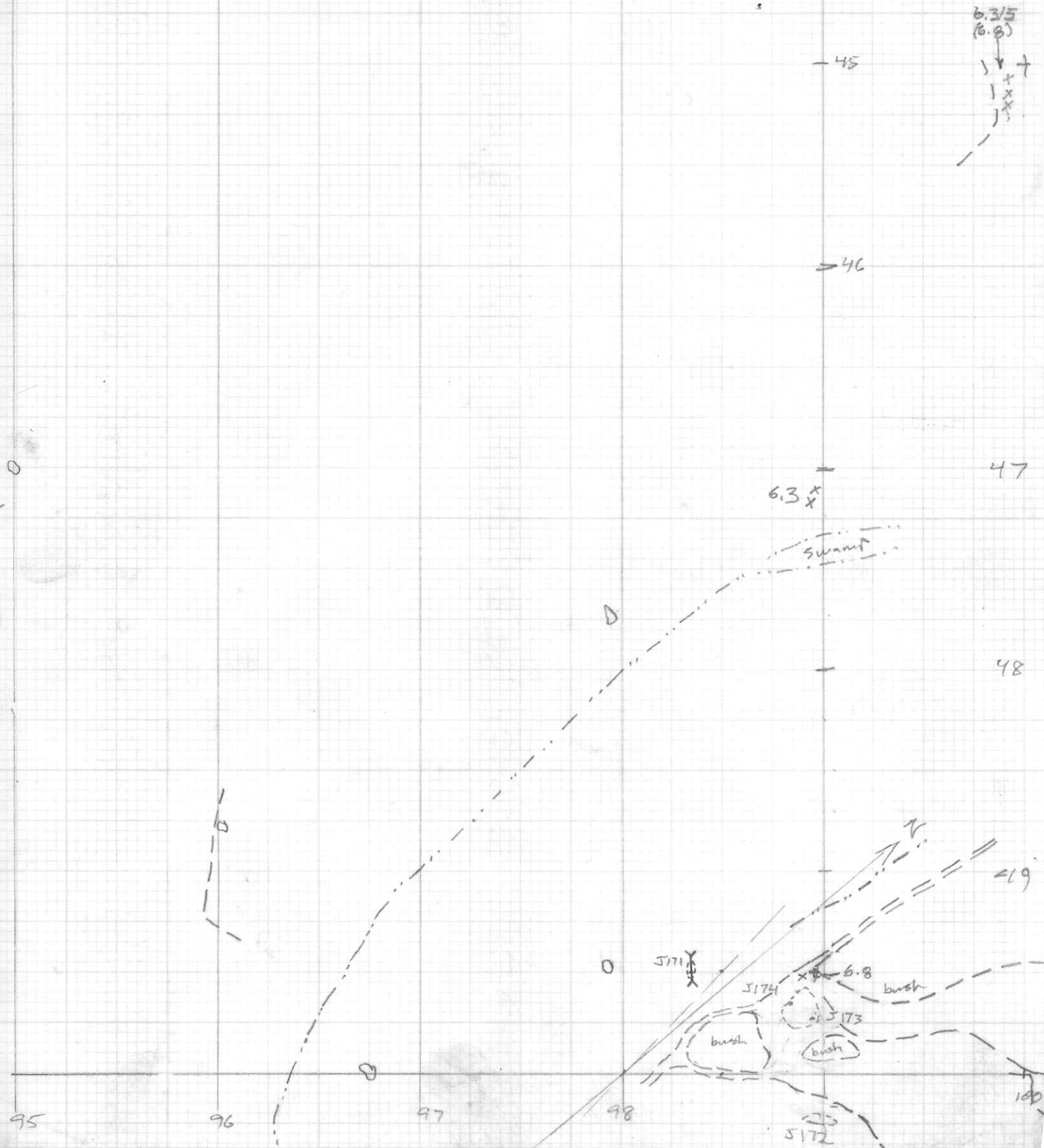

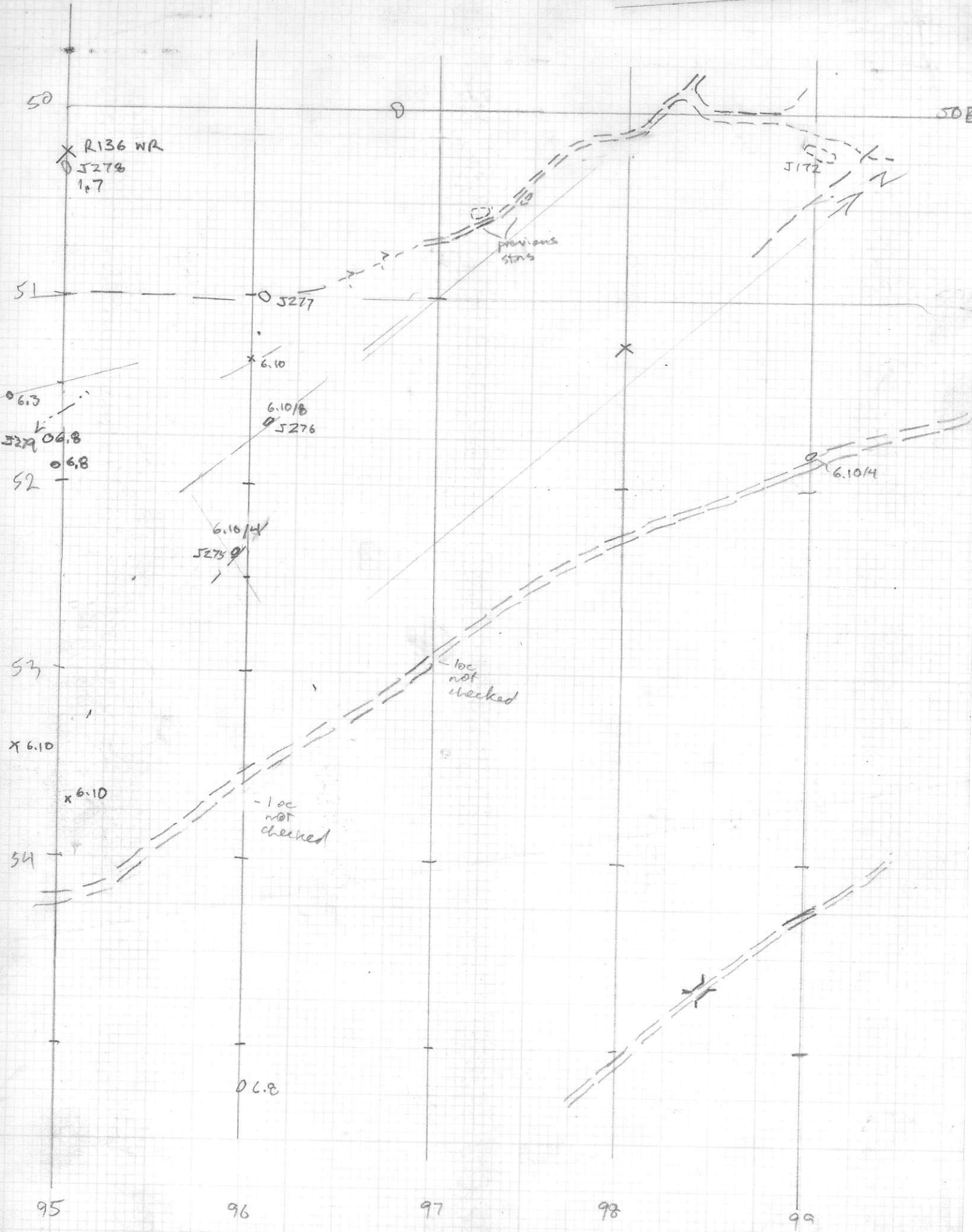

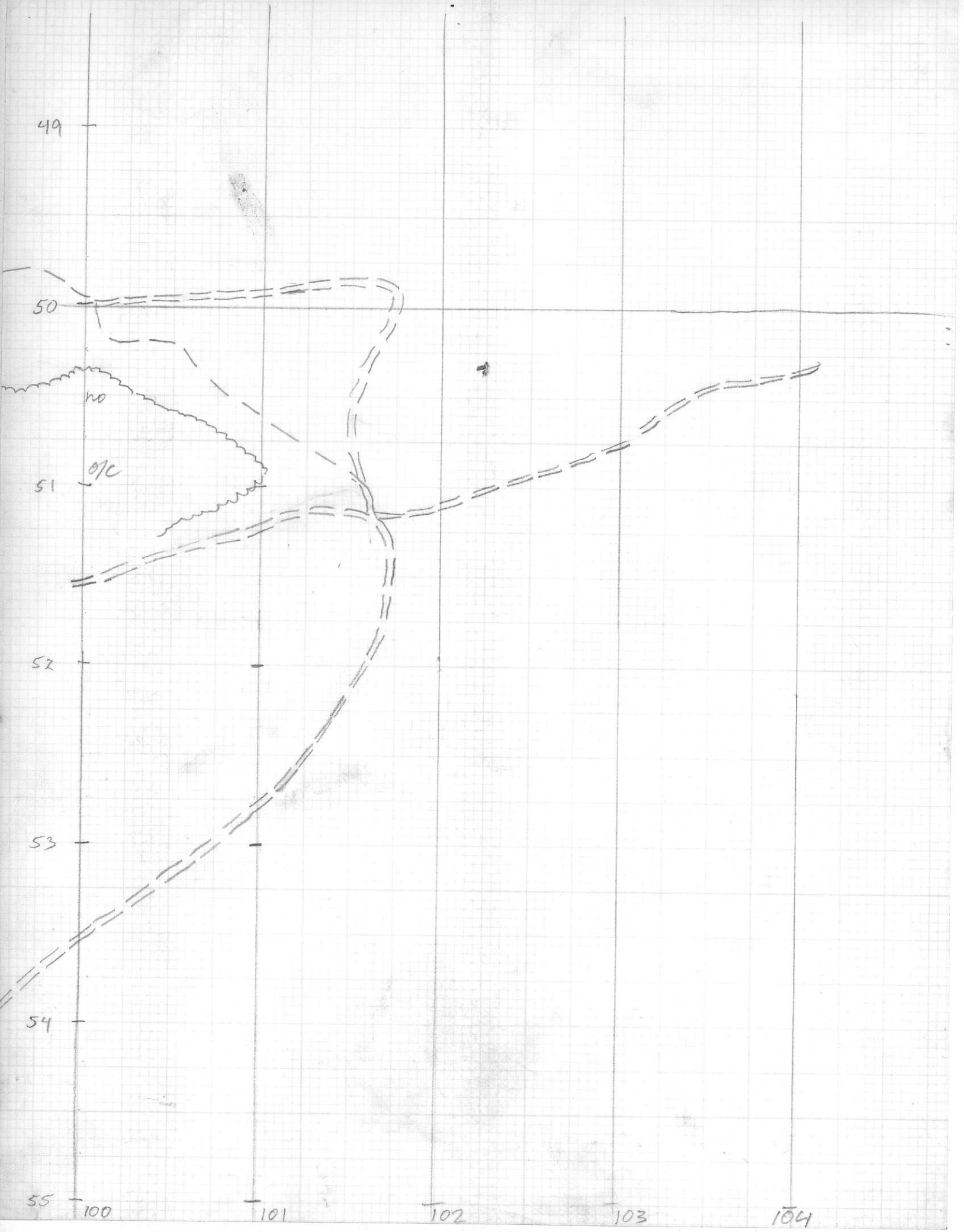

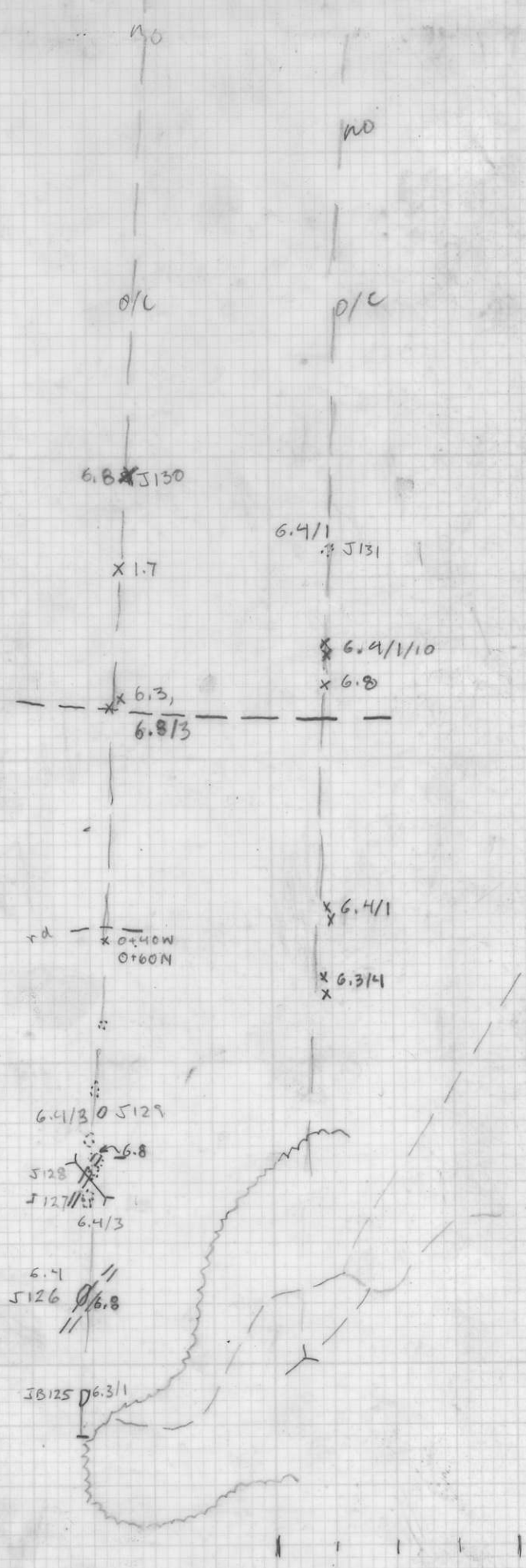
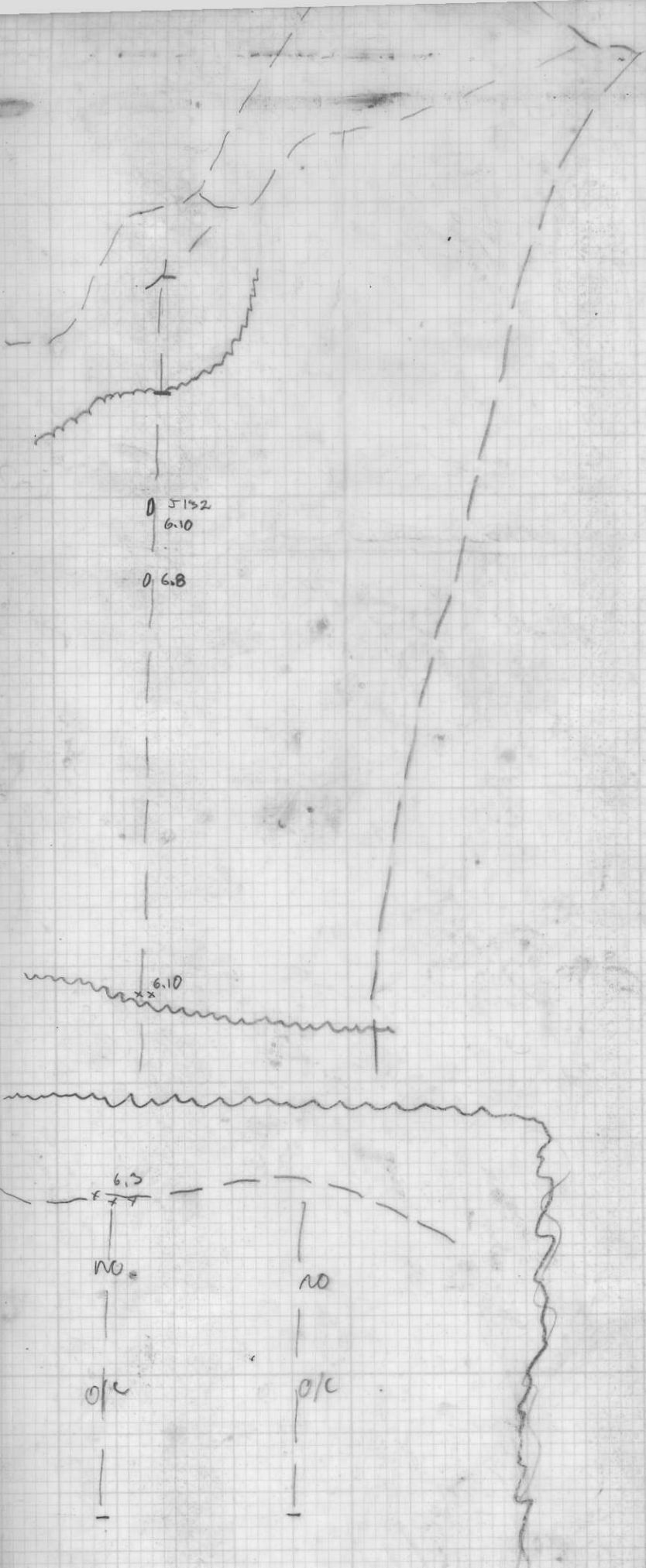

5138
6.6

6.4

6.3/4

6.2/4
0
6.2/4
0
6.2/4
0

17.0
x 6.4/3
0.21

6.2/1.7
0
5.136

3.4
0.24
0

5.137

5.139
0

4.0
0.17
0.250

6.4
x
x

6.3
x
6.8
x

6.4
0

6.4
0

6.4
0

6.4
0

6.4
0

6.4
0

6.4
0

6.4
0

6.4
0

6.4
0

6.4
0

6.4
0

6.4
0

6.4
0

6.4
0

6.4
0

6.4
0

6.4
0

6.4
0

6.8
0.140

6.8

6.8

6.8

6.8

6.8

6.8

6.8

6.8

SPAR GRID 106

107

106

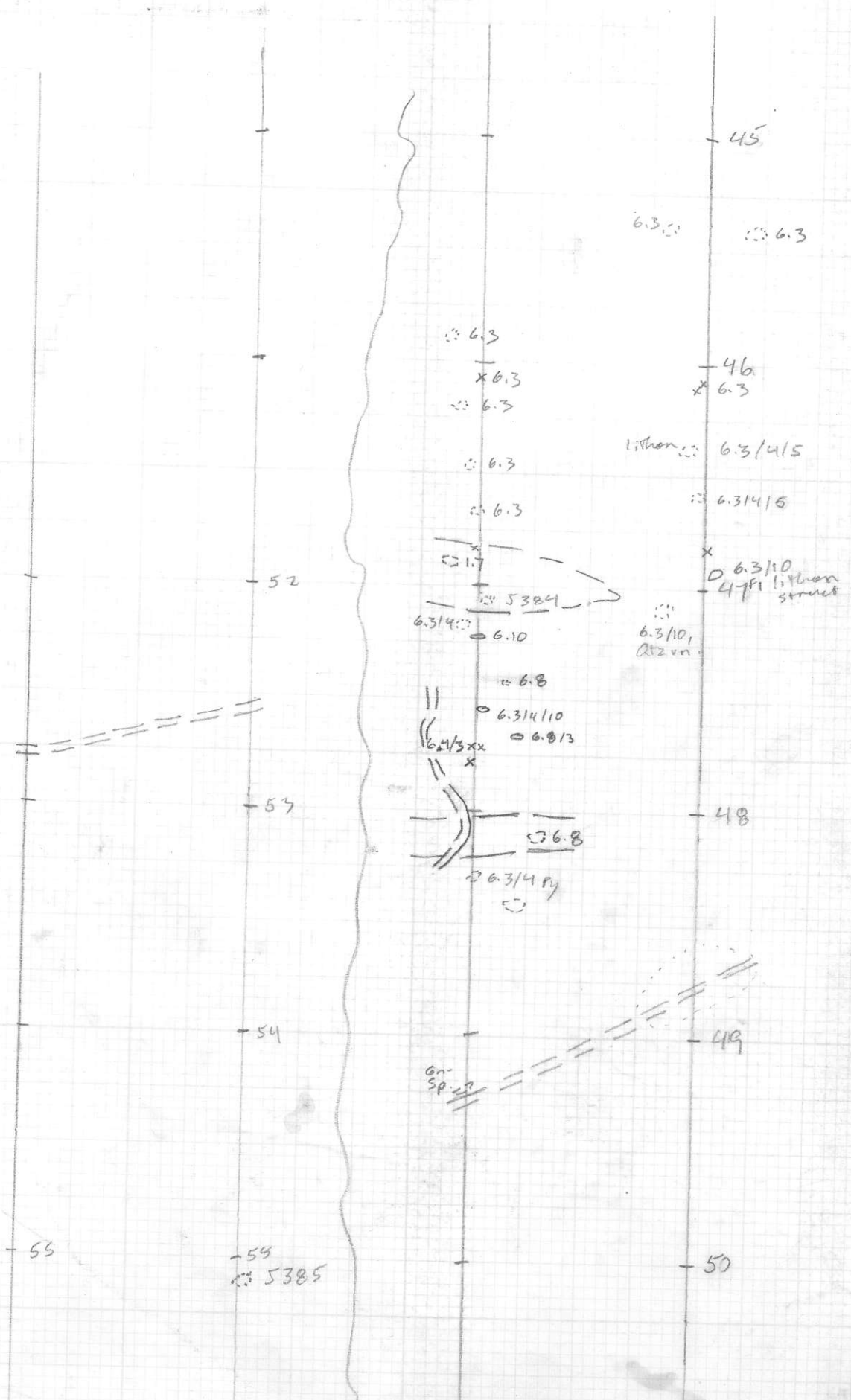

45

6.3

6.3

6.3

x 6.3

6.3

46
x 6.3

6.3

lithon 6.3/4/5

6.3

6.3/4/5

52

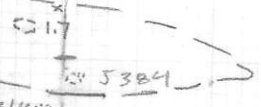

6.3/4
6.10

6.3/10, 6.3/13

x 6.3/10
47 ft lithon structure

6.8

6.3/4/10
6.3/13

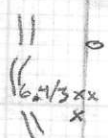

53

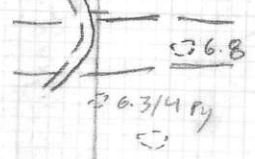

48

54

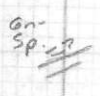

49

55

54
5385

50

SP. 10

from 080 50 m
 P13 095 67 m to showing
 050 36 m to 9925

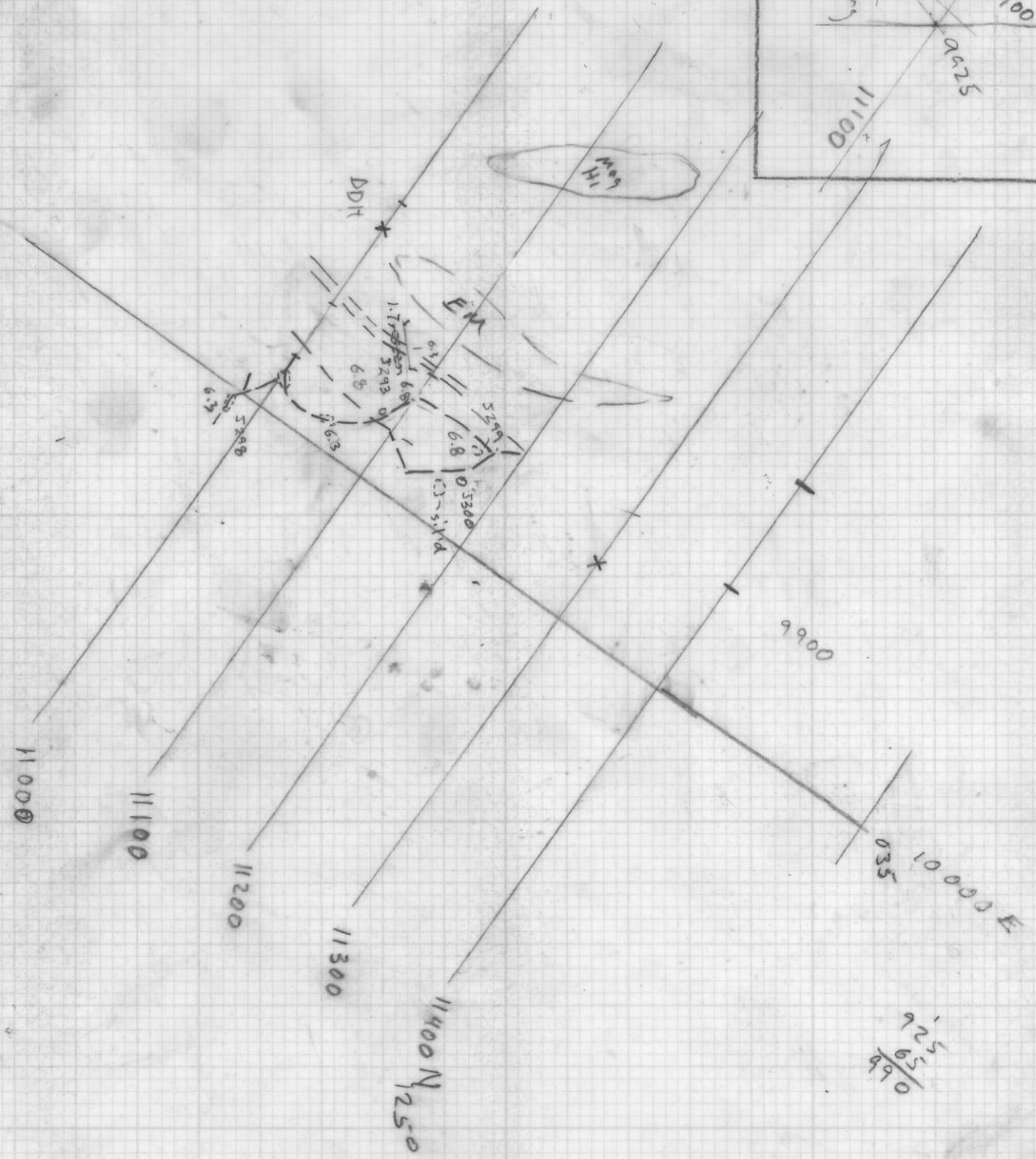
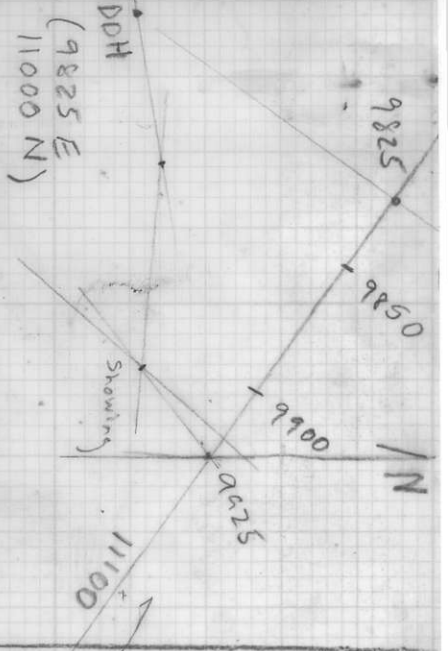

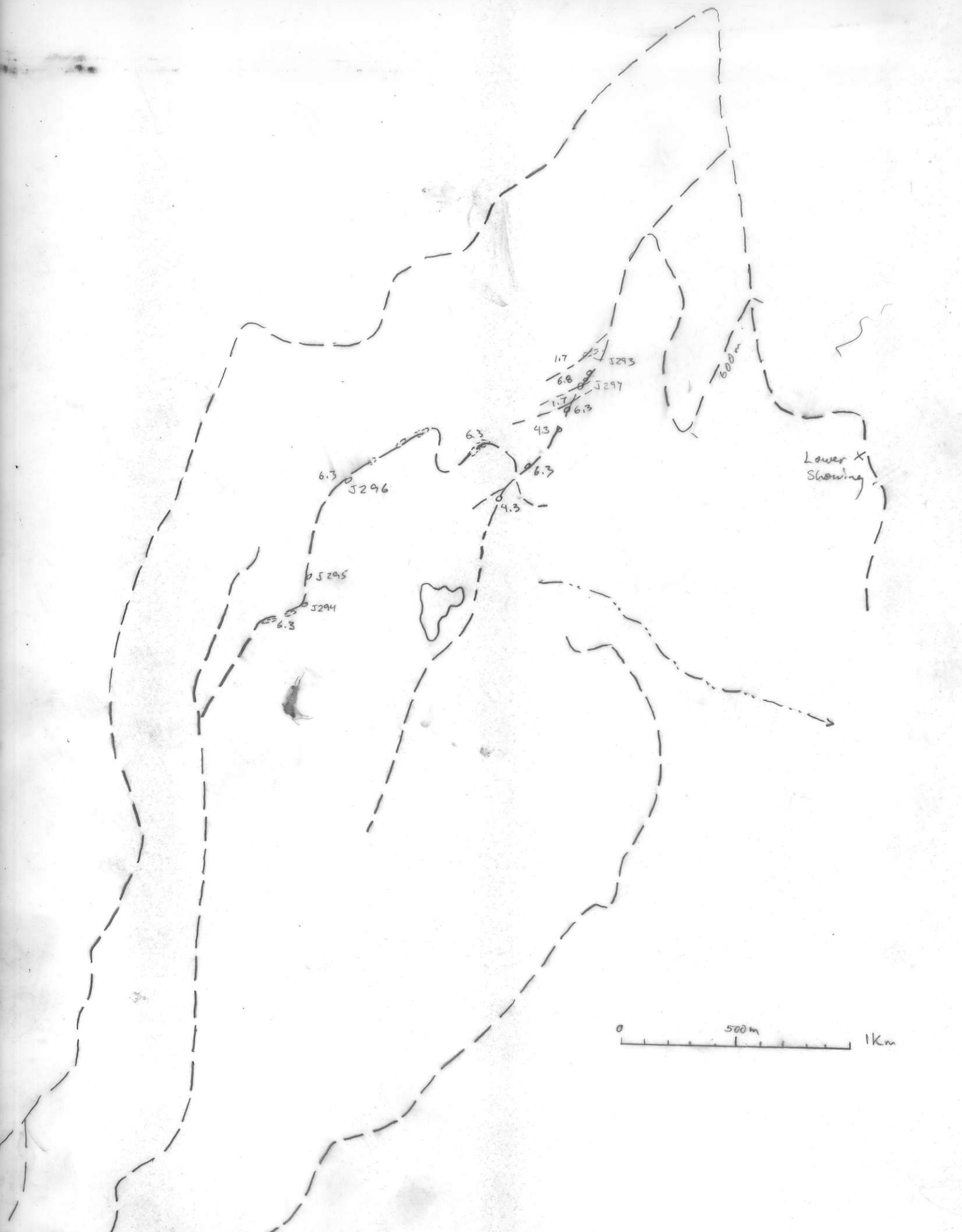

Lower X
Showing

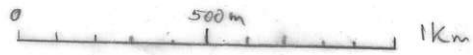

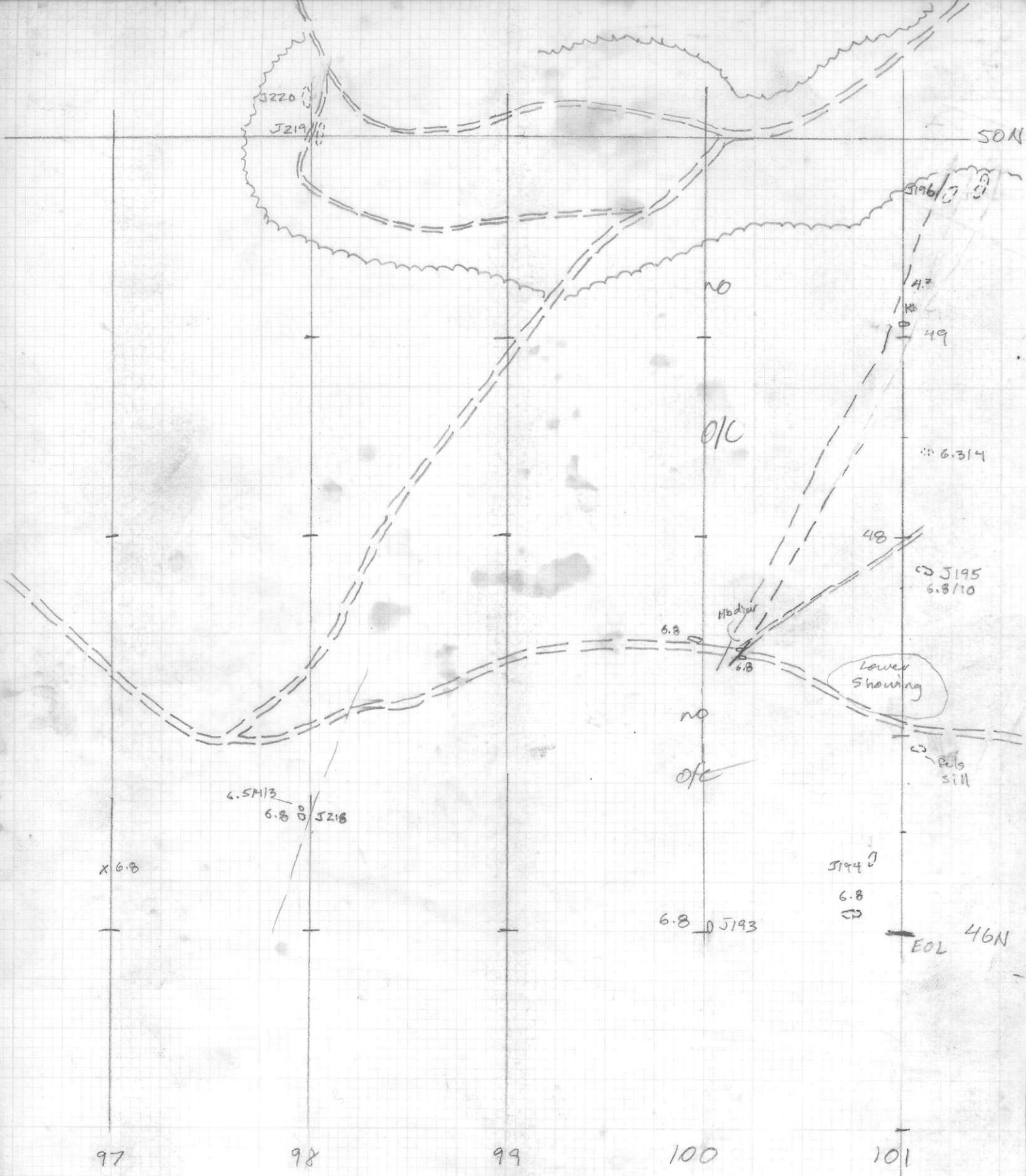

54

54

no

no

no

53

o/c

o/c

o/c

J228
6.8

6.5/3/10
J229

52

52

3+00 E
2+20 N



6.8
J230
6.8/3/5

51

6.3/8/10
J223

6.8
5+80 E
1+60 N

J231

J222
6.8/3

J227
6.10/3/8

J232
6.3/8/10

6.8

6.10, 7.1

6.1 extal
6.4

50

water filled
trench.
no o/c.

no
o/c

6.3
6.8
J233

102

103

104

105

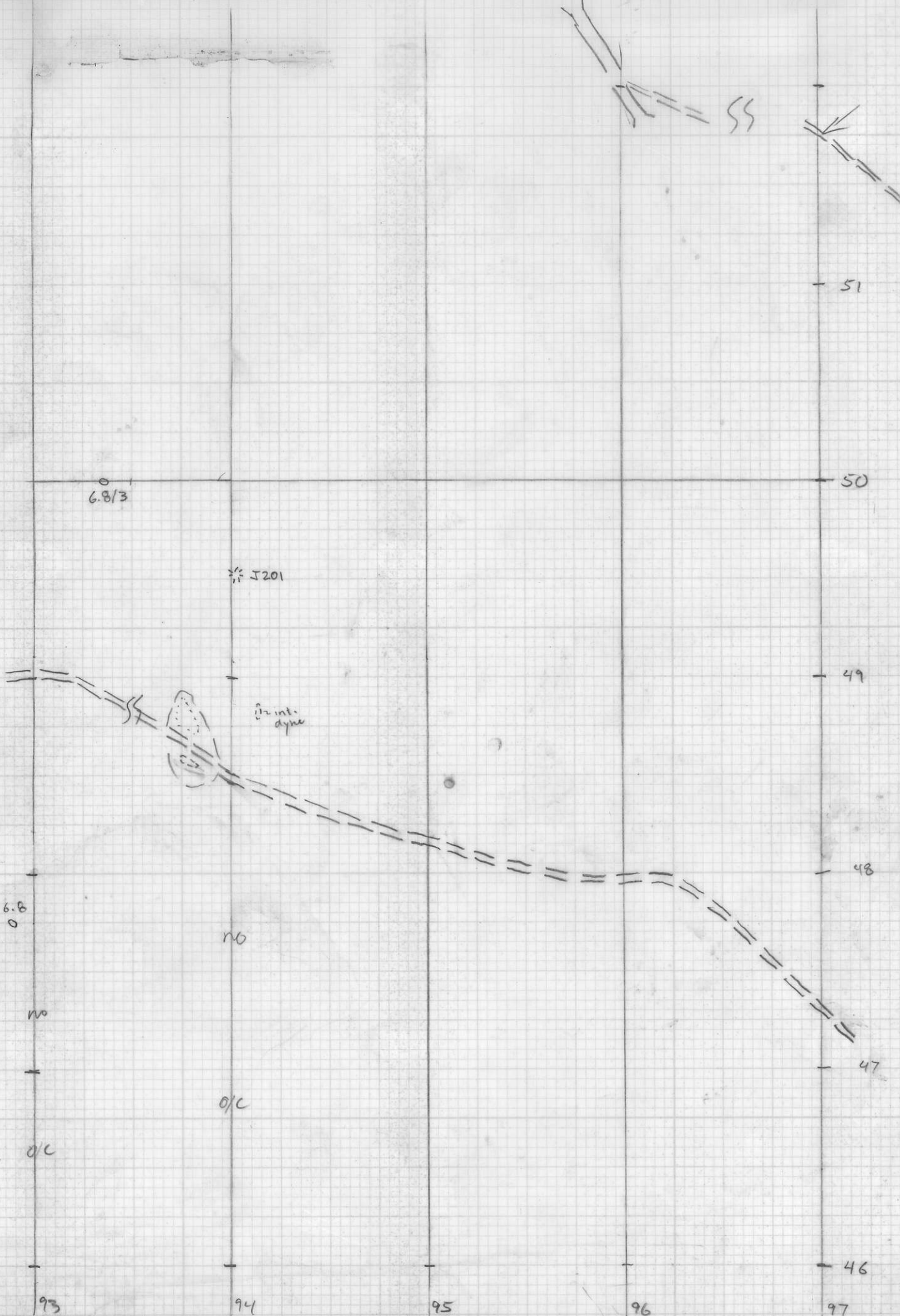
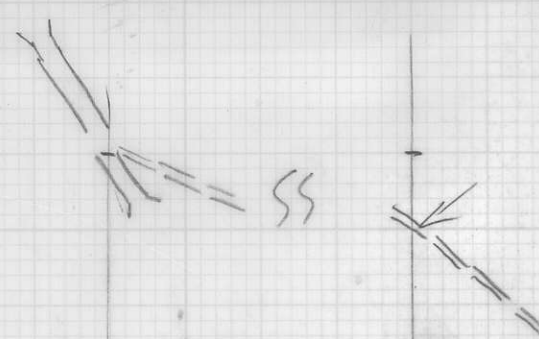

6.8/3

J201

int. dyne

J200 6.8

no

no

o/c

o/c

93

94

95

96

97

51

50

49

48

47

46

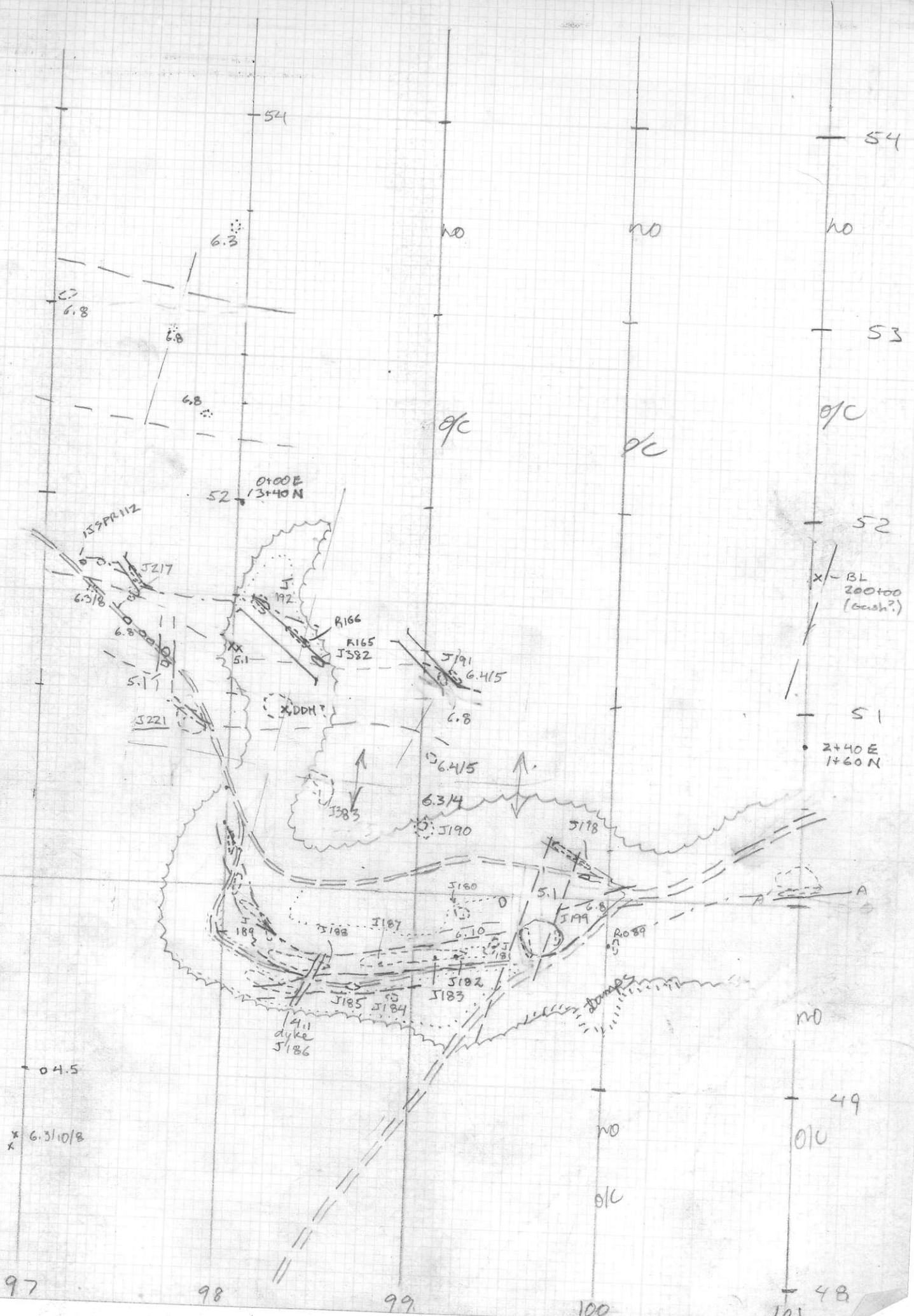

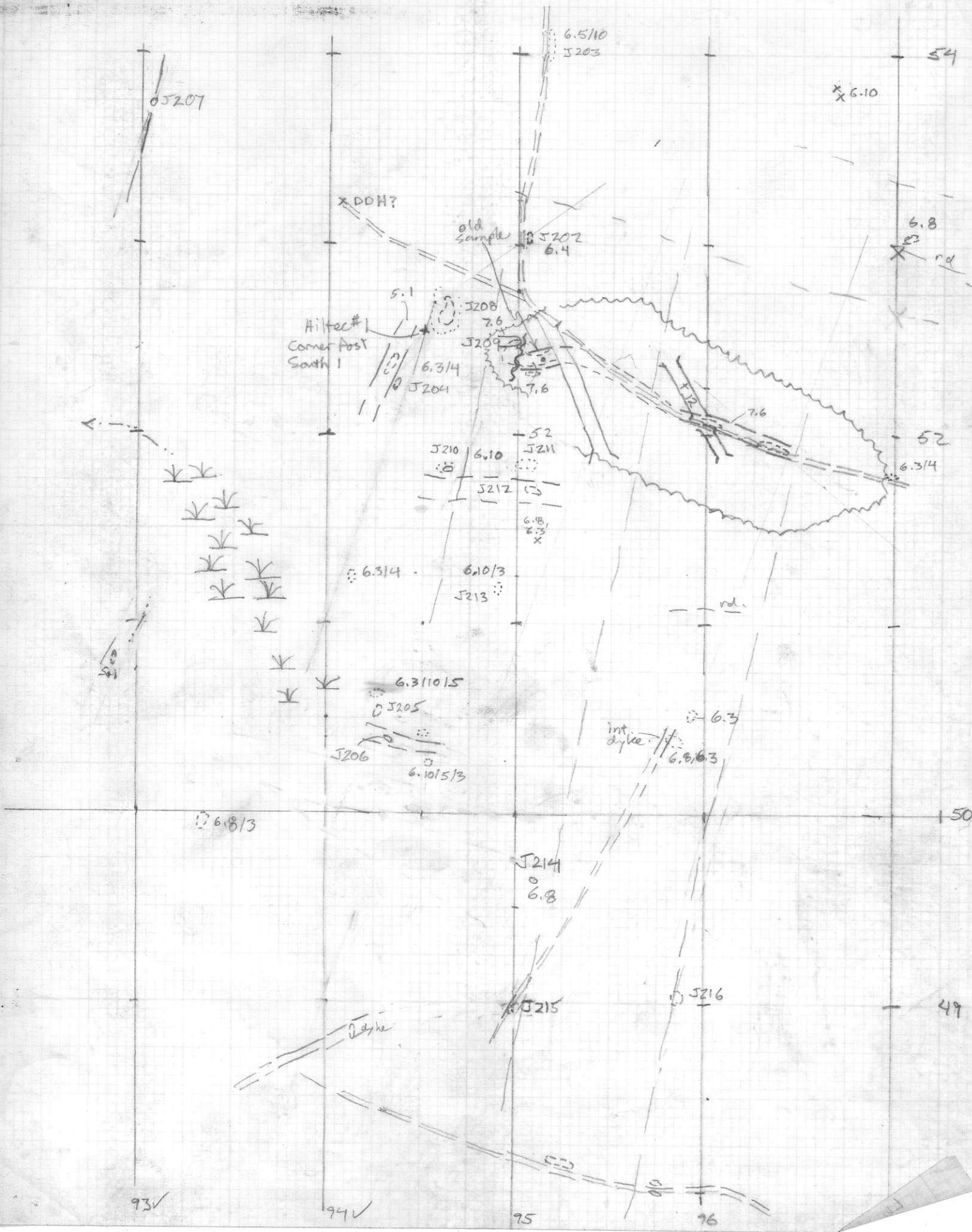

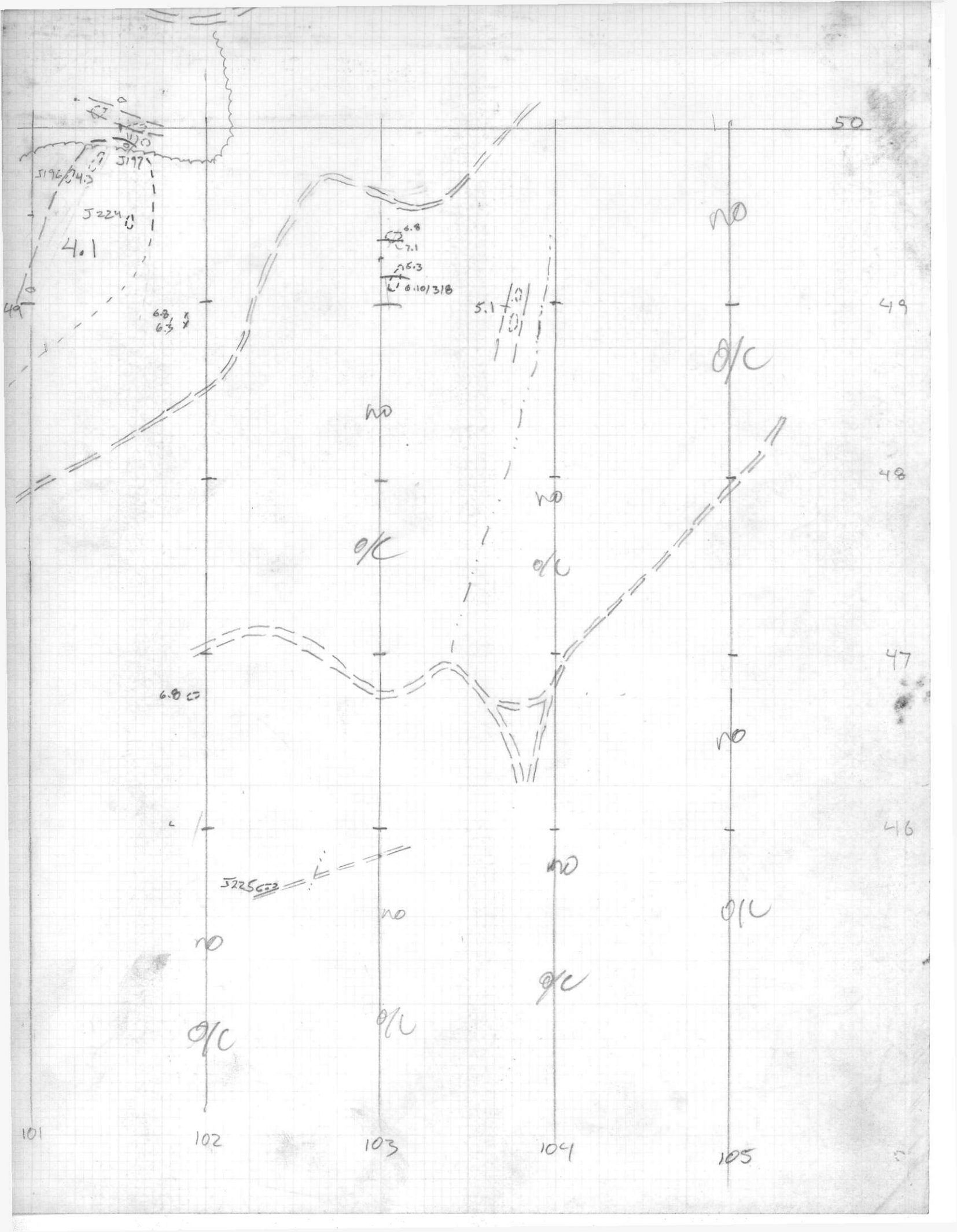

51

ND

DL

+2.7
R124

6.5/4
7.6

J2370
R126

J238
R122

J239 6.3/5/4

J240
R128

x 151+00 E
198+25 N

52

J236
R125

7.6

6.8

R124
J235

6.4/5

4.1

6.4

moves
SE rel.
to line
106

J234
R122, 123

6.10/5/8

6.3/4

6.10/3/8

6.3/8

50

105

106

107

108

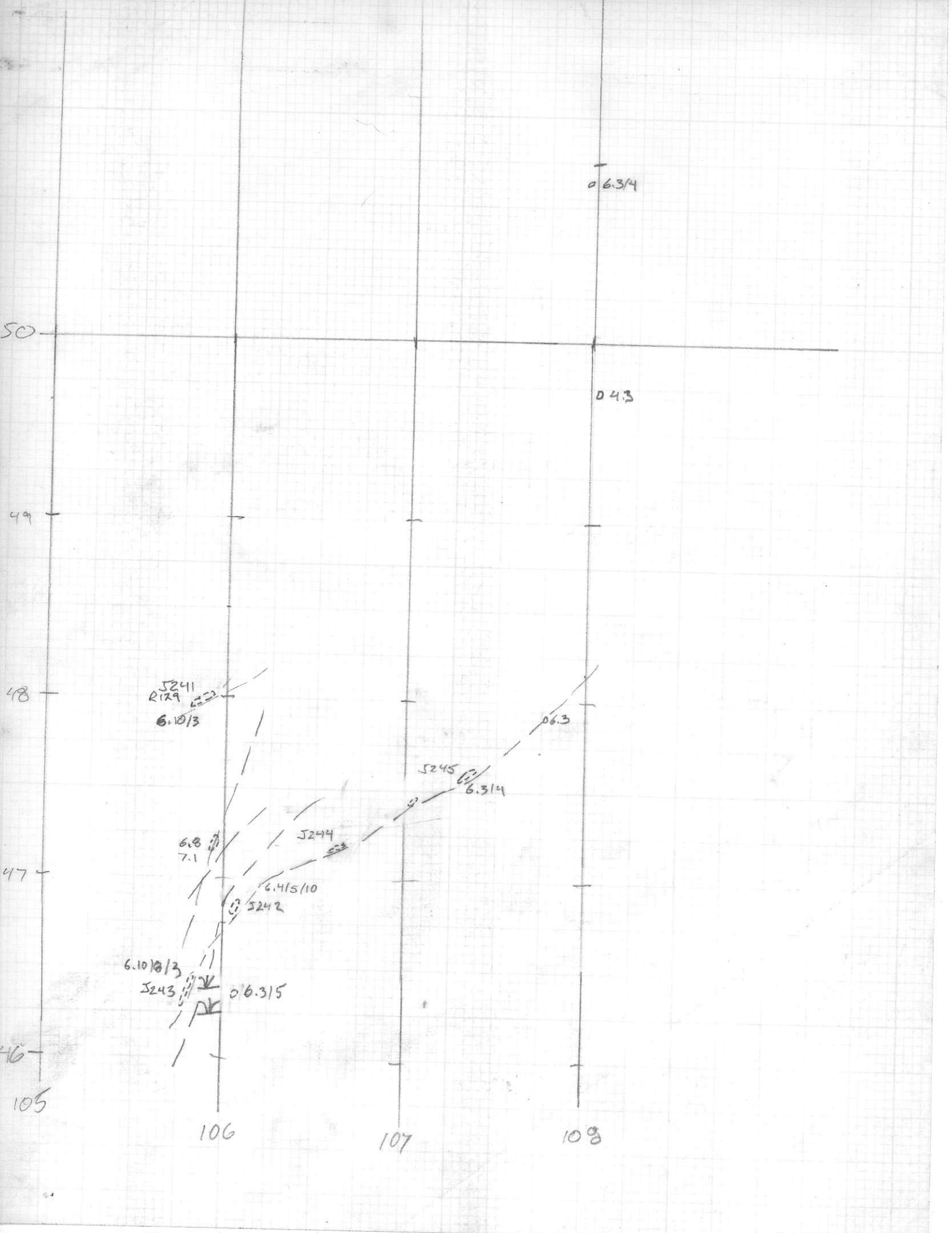

50

49

48

47

46

105

106

107

108

0.6.3/4

0.4.3

J241
R129
6.10/13

6.8
7.1

J244

6.415/10

J242

6.10/13
J243

0.6.315

J245
6.314

0.6.3

