

824450

AQUA BELLA MINERAL SPRING COMPANY LTD.

2411 Lakeshore Road N.E.,

Salmon Arm, British Columbia V1E 3X9

(604) 832-4939

A REPORT ON A PROPOSED OPTION OR JOINT VENTURE OF THE
ADAMS PLATEAU CLAIMS OF AQUA BELLA MINERAL SPRING COMPANY LTD.

March 13, 1990

Cyril C. Kane, CGA, President

SUMMARY

The Adams Plateau Claims of Aqua Bella Mineral Spring Company Ltd. ("Aqua Bella") are situated in a geological environment favorable to base metal and/or precious metal deposits. Earlier brochures have emphasized the base metal potential of the claims while this report is intended to stress the precious metal aspect.

Gold Values - (Map 1)

Fox Claim

Trenching (reference 17) in 1980 of the Fox Claim uncovered mineralization carrying **.152 ozs/t Au.** over 1 meter. See appendix "C-trench #3" for assay report. The area was trenched to test an IP anomaly (which is plotted as "I" on Map 1) from a 1966 survey of Huntco (reference 2). Construction of a logging road nearby had exposed mineralization. Sampling of the trench in 1983 by Noranda obtained a sample assaying **.27 ozs/t Au.** over .5 meters. See appendix "D-1(4003)" & "D-2(4003)" for assay report which is plotted as assay reference 5 on Map 1. See appendix "B-2" for assay of bottom .5 meter of vein. Sampling of the same location in 1989 (reference 112) obtained an assay of **5315 PPB Au.**

Prospecting 500 meters north of the above site during 1985 obtained a grab sample from an exposed vein assaying **.194 ozs/t Au.** See appendix "E" R2 1/85 for assay report. Trenching of this location during 1987 further exposed the vein and a grab sample assayed **.178 ozs/t Au.** See appendix "B-1" for assay report which is plotted as assay reference 2 on Map 1. Sampling of the same location after deepening of the trench in 1989 (reference 112) obtained an assay of **2700 PPB Au.**

Noranda trench #3 (Plotted on Map 1) returned assays up to **1300 PPB Au.** (reference 28). Sampling in 1987 (reference 32) had grab samples assay **.15 ozs/t Au** and **.10 ozs/t Au.**

Airborne geophysical anomalies (reference 24) were located by ground survey (reference 25) and lie southerly and northerly from the gold values. Three airborne low resistivity anomalies (reference 24) are plotted on Map 1 which are coincident with the ground geophysic conductors and IP anomalies (reference 2). **None of the anomalies have been explored.**

Spar Claims

Prospecting of the Spar #1 Mineral Claim discovered an outcrop which has been mined leaving the present adit which is plotted on Map 1. Several tons of ore have been shipped mainly for the silver/lead/zinc content. During 1988, blasting of the adit uncovered galena which appears to be dipping to the south east. (See Appendix "A" for chip sample assay of vein which is plotted as assay reference 4 on Map 1)

About 200 meters west of the above adit, Noranda trenched an area (reference 28) that had gold values in a rock outcrop. The trench established a 7 meter wide mineralized zone with values of Ag, Zn, Pb, and 400 PPM Arsenic and 150 PPB Au. This trench is plotted as trench #2 on Map 1.

Airborne geophysical anomalies (reference 24) were located by ground survey (reference 25) but lie along strike due west of the above trench #2 and to the north east of the adit. An airborne low resistivity anomaly (reference 24) is plotted north west of trench #2 on Map 1 which may be associated with gold values from rock outcrops. **The geophysics indicate a large tightly folded structure with the adit near its hinge.**

Prospecting in 1987 discovered an outcrop carrying up to 27% combined lead/zinc (see appendix "B-3" for assay report plotted as assay reference 1 on Map 1) at the edge of the ground geophysics that extend westerly from trench #2.

Geological mapping (references 40 & 113) support the geophysical ground surveys. A detailed IP Survey (reference 20) was completed over the adit area which supports a south east dip to the structure. Additionally, a diamond drilling program (reference 12) was completed in 1976 in which DDH #76-1 intersected 16 feet of massive sulphide mineralization that assayed .023 ozs/t Au., 18.88% Pb., 8.5% Zn., 0.23% Cu., and 11.12 oz/t Ag. This vertical hole was collared immediately west of the adit. Drilling 4 vertical holes to the SW and NW did not encounter similar mineralization. Angle drilling (reference 19) further SW of the adit is now suspected to have gone under the SE dipping vein exposed in the adit.

Not all the assays completed from the Spar Claims have been assayed for gold. Exploration of the Fox Claim due east of the adit has determined that the sulphides in that area contain appreciable gold. Indications are that the Spar Claim sulphides should be similar. **None of the anomalies near the Spar Claims have been explored.**

TABLE I

The number references are plotted on Map 1

1. Line 16200N Station 7500E - 0.45 ozs/t Silver; 0.006 ozs/t gold; 10.2% lead; 17.0% zinc and 15.5% iron. Grab Sample from lime contact.
2. Between lines 16400N and 16200N at Station 9350E - 2.90 ozs/t silver; 0.178 ozs/t gold; 5.76% lead; 7.64% zinc and 21.2% iron. Grab sample from vein outcrop.
3. Line 16200N Station 9450E - 1.08 ozs/t silver, 0.019 ozs/t gold; 3.16% lead; 9.0% zinc and 4.22% iron. Grab sample from

vein.

4. Floor of adit on Spar #1 Claim - 24.40 ozs/t silver; 0.018 ozs/t gold; 36.61% lead; 8.25% zinc and 14.16% iron. A 3 meter chip sample of vein.
5. Sulphide zone of (3) above - 0.24 ozs/t silver; 0.27 ozs/t gold; 0.12% lead and 2.50% zinc. A .5 meter chip sample.

Gold Values - Map 2 & 6

A1, A2 & Hiltec 1 & 2 Claims

Shipments to the smelter in 1979 (reference 17) indicate that the ore from these claims had better gold values (from .02 ozs/t Au to .07 ozs/t Au) when the iron and arsenic values increased. See appendix "F" & "G" of lots 3 and 6 Smelter Returns.

A test sample of the A1 & A2 sulphide zone processed through a small concentrator returned values of .14 ozs/t Au. See appendix "H" for assay report.

Trenching (reference 17) in 1980 300 meters south of the NE corner along the easterly boundary of the Hiltec 1 & 2 Claim uncovered mineralization carrying .056 ozs/t Au over 1 meter. See appendix C-trench #7 for assay report. A grab sample from the north east corner of the Hiltec 1 & 2 Claim assayed 2935 PPB Au. and 8113 PPM As (private communication from BP Selco). See appendix "B-4" for vein assay.

During 1977 sampling of the sulphide zone (reference 8) near the LCP of the A1 & A2 mineral claims returned a value of .40 ozs/t Au. See appendix I for assay report. This sample was taken near a trench completed in 1980 (reference 17) which assayed .008 ozs/t Au over 1 meter. See appendix "C-trench #10" for assay report.

A grab sample from the NW corner of the A1 Claim assayed 730 PPB Au and 7949 PPM As. (private communication from BP Selco). This sample was taken near a trench completed in 1980 (reference 17) which assayed .008 ozs/t Au over 2 meters. See appendix "C-trench #13" for assay report.

The Placer Leases shown on the Claim Location Map at the junction of Scotch Creek-Sparkle Creek-Bowler Creek have had the following gold production (as reported in B.C. Dept. of Mines Bulletin 40/1980):

| | | |
|--------------|---|-------------------|
| 1886 to 1890 | - | 1,519 ounces Gold |
| 1931 to 1935 | - | 161 ounces Gold |
| 1936 to 1940 | - | 274 ounces Gold |
| 1941 to 1945 | - | 45 ounces Gold |

Gold values are not obtained upstream or downstream from the junctions of Sparkle or Bowler Creeks. The placer leases are

still active and it is believed that 200 ounces of gold is recovered annually.

The headwaters of Sparkle Creek emanates from the A1 & A2 Mineral Claims.

Gold Values - Map 3

BC 2 Mineral Claim

Silt samples taken in Corning Creek (reference 114) which drains southerly along the western boundary of the BC 2 Mineral Claim assayed up to 2200 PPB Au.

Silt samples taken from the headwaters of Bowler Creek (reference 101) which drains easterly from the northern boundary of the BC 2 Mineral Claim assayed up 90 PPB Au.

Massive magnetite along the easterly boundary of the BC 2 Mineral Claim assayed up to .008 ozs/t Au. See appendix "J" for assay report.

The junction of Bowler Creek and Scotch Creek has active Placer Leases believed to be recovering gold annually. The details of the gold values are reported under the A1 & A2 Mineral Claims above.

Gold Values - Map 9

Goldfinger Mineral Claim

The Pisima Grid shown on Map 9 is situated on the north side of the Tsnakin Lime (a large lime dyke) where anomalous gold values have been returned in the silt samples. Geophysics have been encouraging also. This area is similar to the Minnova deposit 20 Km. to the west.

Silver Values - Maps 7 & 8

Red & Jim Mineral Claims

Prospecting of the Jim Claim discovered a showing of high grade galena carrying up to 113.10 ozs/t Ag and .05 ozs/t Au. See appendix "K-25639" for assay report which is plotted as lower showing on map 7. The discovery showing on the Red Claim assays 20.40 ozs/t Ag over a 5.5 feet chip sample. See appendix "K-25642" for assay report.

PROPERTY AND OWNERSHIP

The Adams Plateau Claims of Aqua Bella consist of 222 units containing approximately 13,500 acres situated at Latitude 51 degrees 2 minutes 30 seconds north and Longitude 119 degrees 33 minutes west and are shown on NTS 82M3W & 4E and NTS 82L 13 & 14.

The claims are owned 100% and are summarized as follows:-

| <u>Claim</u> | <u>Units</u> | <u>Record No.</u> | <u>Expiry Date</u> |
|----------------|--------------|-------------------|--------------------|
| Red | 6 | 524 | Sep 16/91 |
| Fir | 3 | 562 | Oct 12/91 |
| Pat | 2 | 596 | Nov 1/90 |
| Jim | 6 | 826 | May 18/91 |
| Don | 2 | 1082 | Nov 3/90 |
| Mike | 6 | 1259 | Jun 28/91 |
| Goldfinger | 6 | 4853 | Oct 17/90 |
| MN 2 | 3 | 5955 | Nov 7/90 |
| MN 3 | 3 | 5956 | Nov 7/90 |
| Zinc 1-6 | 6 | 437 | Jun 28/91 |
| BC 1 | 2 | 539 | Oct 4/90 |
| BC 2 | 16 | 540 | Oct 4/90 |
| BC 4 | 12 | 1086 | Nov 10/90 |
| Fox | 4 | 490 | Aug 24/91 |
| MK 4 | 4 | 568 | Oct 18/90 |
| BC 3 | 16 | 541 | Oct 4/90 |
| AD 1 | 20 | 6538 | Mar 6/91 * |
| AD 18 | 9 | 5250 | Dec 16/90 * |
| Lode III | 16 | 5147 | Nov 28/90 |
| Bee #1 | 4 | 2550 | Apr 22/91 |
| Bee 3-10 Incl. | 8 | 2532-39 Incl. | Apr 21/91 |
| Elk 5 & 8 | 1 | 2179 | Oct 19/90 |
| MK 5 | 4 | 4679 | Aug 11/91 |
| Cat #2 | 2 | 1548 | Nov 15/90 |
| Cat #1 Fr. | 1 | 2272 | Nov 14/90 |
| MK 1 | 20 | 565 | Oct 18/90 |
| MK 2 | 10 | 566 | Oct 18/90 |
| MK 3 | 12 | 567 | Oct 18/90 |
| Hiltec 1 & 2 | 2 | 114 | Oct 22/90 |
| A1 | 1 | 128831 | Nov 13/91 |
| A2 | 1 | 128832 | Nov 13/91 |
| MN 5 | 4 | 6395 | Oct 3/90 |
| Silver King | 4 | 2267 | Nov 14/90 |
| SK 1-4 Incl. | 4 | 2268-71 Incl. | Nov 14/90 |
| Spar #1 | 1 | 127210 | Nov 5/91 ** |
| Spar #2 | 1 | 127211 | Nov 5/91 ** |

All situated in the Adams Plateau Area, Kamloops Mining Division, British Columbia, Canada.

* Subject to a 20% Net Proceeds of Production Royalty of Aqua Bella's equity to Chatwood Resources Ltd. under assignment dated July 28, 1989 of December 1, 1987 Agreement.

** Leased from Quinterra Resources Ltd. by Killick Gold Company Ltd. subject to 3% NSR which can be paid out for \$300,000.00 and the lease is to be assigned to Aqua Bella (or its nominee).

REFERENCES

1. Report of a Geological Survey of Certain Westville Mining

Company claims on the Adams Plateau by C. Riley, P.Eng. dated September 26, 1949.

2. Report on an Induced Polarization (I.P.) Survey on the Adams Plateau property of Giant Metallics Mines Ltd. (NPL) by Hunttec Ltd. dated December, 1966.
3. Report on the Adams Plateau property of Giant Metallics Mines Ltd. (NPL) by MacDonald Consultants Ltd. dated April 1, 1967.
4. Report on an Electromagnetic Survey on the Adams Plateau Claims of Giant Metallics Mines Ltd. (NPL) by C.H. Donaldson, P.Eng., dated July 22, 1970.
5. Report on the Adams Plateau Claims of Giant Metallics Mines Ltd. (NPL) by W.G. Hainsworth, P.Eng., dated May 15, 1973.
6. Report on the Adams Plateau Claims of Orell Copper Mines Ltd. (NPL) by Dr. J.M. Black, P.Eng., Ph.D., dated January 18, 1974.
7. Report on the Spar Mineral Claims of Pamex Mines Ltd. by Gordon Gutrath, Consulting Geologist, dated October, 1976.
8. Report on Prospecting and an EM-16 Survey on the Hiltec 1&2 Mineral Claim by J.A. Hilton, Prospector, dated December 9, 1977.
9. Report on the 1977 Diamond Drilling Program on the Mosquito King Claims, Adams Plateau, of Orell Copper Mines Ltd. (NPL) by Craigmont Mines Ltd., dated August, 1977.
10. Geophysical Report on a Pulse Electromagnetometer Survey on the Mosquito King Claims, Adams Plateau, of Orell Copper Mines Ltd. (NPL) by G.E. White, P.Eng., dated August 29, 1978.
11. Report on the 1978 Diamond Drilling Program on the Mosquito King Claims, Adams Plateau, of Orell Copper Mines Ltd. (NPL) by Craigmont Mines Ltd. dated September 30, 1978.
12. Report on the diamond drilling program during November, 1976 of the Spar #1 Mineral Claim of Pamex Mines Ltd. by Gordon Gutrath, Consulting Geologist, dated January, 1978.
13. Report on the Mosquito King, Bowler Creek, and Lichen Properties of Orell Copper Mines Ltd. by Dr. J.M. Black, P.Eng., Ph.D., dated February 1, 1978.
14. Geological Report Barriere-Adams Plateau Area by V.A. Preto, G.P. McLaren, and P.A. Schiarizza, 1979.
15. Geological Report on the Vein on the A1 and A2 Mineral Claim of Orell Copper Mines Ltd. by Dr. J.M. Black, P.Eng., Ph.D., dated June 21, 1980.

16. Geological Report on the Mosquito King Claims, Adams Plateau, of Orell Resources Ltd., by Brinex Ltd. dated August, 1980.
17. Trench locations and assays 1980 and Net Smelter Return Reports of 1979 Ore Shipments by Orell Resources Ltd.
18. Report on a Geodynamic Model for some Structures within and adjacent to the Okanagan Valley, Southern British Columbia by John V. Ross, dated May 6, 1981.
19. Report on the 1981 Diamond Drilling Program on the Mosquito King-Spar Claims, Adams Plateau, of Orell Resources Ltd. by Dr. J.M. Black, P.Eng., Ph.D., dated April 5, 1982.
20. A Geophysical Report on Induced Polarization (I.P.) Surveys on the Mosquito King and Spar Claims of Orell Resources Ltd. by Peter E. Walcott, P.Eng., dated January, 1982.
21. Report on the Mosquito King and Bowler Creek Claim Groups, Adams Plateau, of Orell Resources Ltd. by Dr. J.M. Black, P.Eng., Ph.D., dated April 15, 1981.
22. Report on the Mosquito King and Bowler Creek Properties by Dr. J.M. Black, P.Eng., Ph.D., dated February 5, 1981.
23. Report on the Mosquito King and Bowler Creek Claim Groups, Adams Plateau, of Orell Resources Ltd. by Dr. J.M. Black, P.Eng., Ph.D., dated June 12, 1983.
24. Report on an Airborne Geophysical Survey of the Adams Plateau Claims of Orell Resources Ltd. by Dighem Limited dated July 17, 1984.
25. Report on Geophysical Surveys on the Mosquito King and Spar Claims of Orell Resources Ltd. by Noranda Exploration Company Ltd. (NPL) dated November, 1984.
26. Report on Pilot Milling and Mining of the Mosquito King Claims, Adams Plateau, of Killick Gold Company Ltd. by Bryan A. Slim, P.Eng., dated July 22, 1985.
27. Report on the Mosquito King Claims, Adams Plateau, of Killick Gold Company Ltd. by J.R. Woodcock, P.Eng., dated July 15, 1985.
28. Report on Geochemical, Geophysical and Trenching Surveys on the Mosquito King and Spar Claims, Adams Plateau, of Killick Gold Company Ltd., by Noranda Exploration Company Ltd. (NPL) dated May, 1986.
29. Geological Report on the Gash Grid, Mosquito King Claims, Adams Plateau, of Killick Gold Company Ltd. by Noranda Exploration Company Ltd.(NPL) dated February 4, 1986.

30. Mineral Bulletin, MR 213, Canadian Mineral Deposits not being mined in 1986, Energy, Mines and Resources Canada, June, 1986.
31. Report on the RS-1 Mineral Claim, Adams Plateau, of Glitter Gold Mines Ltd. by Douglas A. Leishman, P.Eng., dated January 30, 1987.
32. Report on the Mosquito King, Bowler Creek, Silver Lichen, and Pisima Claim Groups, Adams Plateau, of Killick Gold Company Ltd. by Jim McDougall, P.Eng., dated June 19, 1987.
33. Geological Survey of Canada Memoir 68, A Geological Reconnaissance Between Golden and Kamloops, B.C. along the Canadian Pacific Railway by R.A. Daly, 1915.
34. Geological Survey of Canada Memoir 296, Vernon Map Area, British Columbia by A.G. Jones, 1959.
35. Geological Survey of Canada Open File 637, 1969.
36. Geological Survey of Canada Geology Map 143A, Shuswap Lake, R.A. Daly, 1912.
37. Geological Survey of Canada Geology Map 48-1963 Adams Lake.
38. Geological Survey of Canada Open File 1002, 1984.
39. Province of B.C. Preliminary Map 56, Geology of the Adams Plateau-Clearwater Area, 1984.
40. Map of Adams Plateau Regional Geology by Minequest Exploration Associates Ltd., September, 1981.
41. Geological Map, Mosquito King Claims, Adams Plateau, of Orell Copper Mines Ltd.(NPL) by Craigmont Mines Ltd. September, 1977.
42. Geochemical Survey Map-Pb., Mosquito King Claims, Adams Plateau, of Orell Copper Mines Ltd.(NPL) by Craigmont Mines Ltd., September, 1977.
43. Geochemical Survey Map-Cu., Mosquito King Claims, Adams Plateau, of Orell Copper Mines Ltd.(NPL) by Craigmont Mines Ltd., September, 1977.
44. EM-16 Survey Map, Mosquito King Claims, Adams Plateau, of Orell Copper Mines Ltd. (NPL) by Craigmont Mines Ltd., September, 1977.
45. Magnetic Survey Map, Mosquito King Claims, Adams Plateau, of Orell Copper Mines Ltd. (NPL) by Craigmont Mines Ltd., September, 1977.
46. Geochemical Survey Map-Zn., Mosquito King Claims, Adams

Plateau, of Orell Copper Mines Ltd. (NPL) by Craigmont Mines Ltd., September, 1977.

47. Detailed Geology Map, A1 and A2 Claims, Adams Plateau, of Killick Gold Company Ltd. by Killick staff geologist, 1982.
48. Geology Compilation Map of other Geology Maps, Mosquito King Claims, Adams Plateau, of Killick Gold Company Ltd., by Killick Staff Geolbgiests, 1981.
49. Contour Plotting Map and Profiles, CEM (Horizontal Shootback) Survey-5010 Hertz, Mosquito King Claims, Adams Plateau, by Killick Staff Field Personnel, 1981.
50. Contour Plotting Map and Profiles, CEM (Horizontal Shootback) Survey-1830 Hertz, Mosquito King Claims, Adams Plateau, by Killick Staff Field Personnel, 1981.
51. Contour Plotting Map and Profiles, CEM (Horizontal Shootback) Survey-390 Hertz, Mosquito King Claims, Adams Plateau, by Killick Staff Field Personnel, 1981.
52. GP 70 Proton Magnetometer Survey Profile Plotting, Mosquito King Claims, Adams Plateau, of Killick Gold Company Ltd. by Killick Staff Field Personnel, 1981.
53. Profile Plotting Map, CEM (Horizontal Shootback) Survey, Mosquito King Claims, Adams Plateau, of Killick Gold Company Ltd. by Killick Staff Field Personnel, 1981.
54. Replot of '66 Hunttec IP Survey Contours of Apparent Resistivity, Mosquito King Claims, Adams Plateau, of Killick Gold Company Ltd., by Killick Field Personnel, 1981.
55. Replot of '66 Hunttec IP Survey Chargeability, Mosquito King Claims, Adams Plateau, of Killick Gold Company Ltd. by Killick Field Personnel, 1981.
56. Map of Geochemical Silt Results West Sheet Mosquito King Claims, Adams Plateau, of Killick Gold Company Ltd., by Noranda Exploration Company Ltd.(NPL) dated March, 1985.
57. Map of Geochemical Silt Results East Sheet Mosquito King Claims, Adams Plateau, of Killick Gold Company Ltd., by Noranda Exploration Company Ltd. (NPL) dated March, 1985.
58. Report on the AD1 and AD18 Claims, Adams Plateau, of Chatwood Resources Ltd. by James M. Dawson, P.Eng., dated August 21, 1984.
59. Report on Trenching on the AD1 and AD18 Mineral Claims, Adams Plateau, of Chatwood Resources Ltd. by Noranda Exploration Company Ltd.(NPL) dated November, 1986.

60. Report of the 1977 Diamond Drilling Program on the Bowler Creek Claims, Adams Plateau, of Orell Copper Mines Ltd. by Craigmont Mines Ltd. dated September 24, 1977.
61. Report on the 1978 Diamond Drilling Program on the Bowler Creek Claims, Adams Plateau, of Orell Copper Mines Ltd. by Craigmont Mines Ltd. dated September 27, 1978.
62. Report on the 1979 Diamond Drilling Program and Drill Site Geology of the Bowler Creek Claims, Adams Plateau of Orell Resources Ltd. by Dr. J.M. Black, P.Eng., Ph.D., dated June 21, 1980.
63. Report on a CEM (Horizontal Shootback) Survey on the Bowler Creek Claims, Adams Plateau of Orell Resources Ltd. by Dr. J.M. Black, P.Eng., Ph.D., dated April 15, 1983.
64. Report on Soil Geochemistry and Diamond Drilling on the Bowler Creek Claims of Killick Gold Company Ltd. by Noranda Exploration Company Ltd. (NPL) dated December, 1985.
65. Geochemical Survey Map-Cu, Bowler Creek Claims, Adams Plateau of Orell Copper Mines Ltd. (NPL) by Craigmont Mines Ltd., September, 1977.
66. Geochemical Survey Map-Zn, Bowler Creek Claims, Adams Plateau of Orell Copper Mines Ltd. (NPL) by Craigmont Mines Ltd., September, 1977.
67. Geochemical Survey Map-Pb, Bowler Creek Claims, Adams Plateau of Orell Copper Mines Ltd. (NPL) by Craigmont Mines Ltd., September, 1977.
68. EM-16 Survey Map, Bowler Creek Claims, Adams Plateau of Orell Copper Mines Ltd. (NPL) by Craigmont Mines Ltd., September, 1977.
69. Magnetic Survey Map, Bowler Creek Claims, Adams Plateau of Orell Copper Mines Ltd. (NPL) by Craigmont Mines Ltd., September, 1977.
70. Geological Map, Bowler Creek Claims, Adams Plateau of Orell Copper Mines Ltd. (NPL) by Craigmont Mines Ltd., September, 1977.
71. Map of Geology China Creek, Bowler Creek Claims, Adams Plateau of Orell Resources Ltd. by Minequest Exploration Associates Ltd. September, 1981.
72. Map of Geology China Creek-Drill Section A-A, Bowler Creek Claims, Adams Plateau, of Orell Resources Ltd. by Minequest Exploration Associates Ltd. September, 1981.
73. Map of Geology China Creek-Drill Section B-B, Bowler Creek

- Claims, Adams Plateau, of Orell Resources Ltd. by Minequest Exploration Associates Ltd. September, 1981.
74. Map of Geology China Creek-Drill Section C-C, Bowler Creek Claims, Adams Plateau, of Orell Resources Ltd. by Minequest Exploration Associates Ltd. September, 1981.
 75. Contour Plotting Map and Profiles, CEM (Horizontal Shootback) Survey-390 Hertz, Bowler Creek Claims, Adams Plateau of Killick Gold Company Ltd. by Killick Field Personnel, 1981.
 76. Contour Plotting Map and Profiles, CEM (Horizontal Shootback) Survey-1830 Hertz, Bowler Creek Claims, Adams Plateau of Killick Gold Company Ltd. by Killick Field Personnel, 1981.
 77. Contour Plotting Map and Profiles, CEM (Horizontal Shootback) Survey-5010 Hertz, Bowler Creek Claims, Adams Plateau of Killick Gold Company Ltd. by Killick Field Personnel, 1981.
 78. Geology Map, Bowler Creek Claims, Adams Plateau, of Killick Gold Company Ltd. by Killick Field Personnel, 1981.
 79. Contour Map of Magnetometer Survey, Tom Grid, Bowler Creek Claims, Adams Plateau, of Killick Gold Company Ltd. by Noranda Exploration Company Ltd. (NPL) September, 1984.
 80. Map of Contoured Soil Geochemistry-Cu, Tom Grid, Bowler Creek Claims, Adams Plateau, of Killick Gold Company Ltd. by Noranda Exploration Company Ltd. (NPL) September, 1984.
 81. Map of Contoured Soil Geochemistry-Zn, Tom Grid, Bowler Creek Claims, Adams Plateau, of Killick Gold Company Ltd. by Noranda Exploration Company Ltd. (NPL) September, 1984.
 82. Map of Contoured Soil Geochemistry-Ag, Tom Grid, Bowler Creek Claims, Adams Plateau, of Killick Gold Company Ltd. by Noranda Exploration Company Ltd. (NPL) September, 1984.
 83. Map of Contoured Soil Geochemistry-Pb, Tom Grid, Bowler Creek Claims, Adams Plateau, of Killick Gold Company Ltd. by Noranda Exploration Company Ltd. (NPL) September, 1984.
 84. Profile Map of HLEM Survey, Tom Grid, Bowler Creek Claims, Adams Plateau, of Killick Gold Company Ltd. by Noranda Exploration Company Ltd. (NPL) September, 1984.
 85. Map of Contoured Soil Geochemistry-Cu, Dick Grid, Bowler Creek Claims, Adams Plateau, of Killick Gold Company Ltd. by Noranda Exploration Company Ltd. (NPL) September, 1984.
 86. Map of Contoured Soil Geochemistry-Zn, Dick Grid, Bowler Creek Claims, Adams Plateau, of Killick Gold Company Ltd. by Noranda Exploration Company Ltd. (NPL) September, 1984.

87. Map of Contoured Soil Geochemistry-Ag, Dick Grid, Bowler Creek Claims, Adams Plateau, of Killick Gold Company Ltd. by Noranda Exploration Company Ltd. (NPL) September, 1984.
88. Map of Contoured Soil Geochemistry-Pb, Dick Grid, Bowler Creek Claims, Adams Plateau, of Killick Gold Company Ltd. by Noranda Exploration Company Ltd. (NPL) September, 1984.
89. Profile Map of HLEM Survey, Dick Grid, Bowler Creek Claims, Adams Plateau of Killick Gold Company Ltd. by Noranda Exploration Company Ltd. (NPL) September, 1984.
90. Profile Map of VLF Survey, Dick Grid, Bowler Creek Claims, Adams Plateau of Killick Gold Company Ltd. by Npranda Exploration Company Ltd. (NPL) September, 1984.
91. Contour Map of Magnetometer Survey, Dick Grid, Bowler Creek Claims, Adams Plateau of Killick Gold Company Ltd. by Noranda Exploration Company Ltd. (NPL) September, 1984.
92. Map of Contoured Soil Geochemistry-Pb, Harry Grid, Bowler Creek Claims, Adams Plateau of Killick Gold Company Ltd. by Noranda Exploration Company Ltd. (NPL) September, 1984.
93. Map of Contoured Soil Geochemistry-Cu, Harry Grid, Bowler Creek Claims, Adams Plateau of Killick Gold Company Ltd. by Noranda Exploration Company Ltd. (NPL) September, 1984.
94. Map of Contoured Soil Geochemistry-Ag, Harry Grid, Bowler Creek Claims, Adams Plateau of Killick Gold Company Ltd. by Noranda Exploration Company Ltd. (NPL) September, 1984.
95. Map of Contoured Soil Geochemistry-Zn, Harry Grid, Bowler Creek Claims, Adams Plateau of Killick Gold Company Ltd. by Noranda Exploration Company Ltd. (NPL) September, 1984.
96. Profile Map of VLF Survey, Harry Grid, Bowler Creek Claims, Adams Plateau, of Killick Gold Company Ltd. by Noranda Exploration Company Ltd. (NPL) September, 1984.
97. Contour Map of Magnetometer Survey, Harry Grid, Bowler Creek Claims, Adams Plateau of Killick Gold Company Ltd. by Noranda Exploration Company Ltd. (NPL) September, 1984.
98. Profile Map of HLEM Survey, Harry Grid, Bowler Creek Claims, Adams Plateau of Killick Gold Company Ltd. by Noranda Exploration Company Ltd. (NPL) September, 1984.
99. Map of Drill Holes, Trenches and Sample Locations, Bowler Creek Claims, Adams Plateau of Killick Gold Company Ltd. by Noranda Exploration Company Ltd. (NPL) February, 1985.
100. Geology Map, Bowler Creek Claims, Adams Plateau of Killick Gold Company Ltd. by Noranda Exploration Company Ltd. (NPL)

February, 1985.

101. Map of Silt Sample Locations and Results, Bowler Creek Claims, Adams Plateau of Killick Gold Company Ltd. by Noranda Exploration Company Ltd. (NPL) February, 1985.
102. Report on the Red Claim by Dr. J.M. Black, P.Eng., Ph.D., dated October 12, 1976.
103. Geological, Geochemical and Geophysical Report on the Silver Lichen Claims by Dr. J.M. Black, P.Eng., Ph.D., dated June 15, 1979.
104. Geological and Geochemical Report on the Silver Lichen Claims by Dr. J.M. Black, P.Eng., Ph.D., dated June 21, 1980.
105. Report on the Silver Lichen Claims by Dr. J.M. Black, P.Eng., Ph.D., dated April 15, 1981.
106. Report on Geophysical Surveys on the Silver Lichen Claims by Noranda Exploration Company Ltd. (NPL) dated November, 1984.
107. Report on Geochemical and Geophysical Surveys on the Silver Lichen Claims by Noranda Exploration Company Ltd. (NPL) dated December, 1985.
108. Report on an Airborne Geophysical Survey of the Pisima Claims, Adams Plateau, of Camber Exploration Company Ltd., by Dighem Limited, dated July 12, 1984.
109. Report of Geophysical and Geochemical Surveys of the Pisima Claims, Adams Plateau, of Camber Exploration Company Ltd., by Noranda Exploration Company Ltd. (NPL) dated December, 1984.
110. Report on the Pisima Claims, Adams Plateau, of Camber Exploration Company Ltd. by Ted Kennedy, P.Geologist, dated March 1, 1984.
111. Geological Report, Mag Survey, HLEM Survey, Geochemical, Silt Sampling and Rock Sample Report of the Pisima Claims, Adams Plateau, of Camber Exploration Company Ltd. by Noranda Exploration Company Ltd. dated December, 1985.
112. Report on an Examination of the Adams Plateau Property of Aqua Bella Mineral Springs Company Ltd. dated August, 1989 by T.J. Beesley, P.Eng.
113. Geology Map 1982 Spar Claims, Minequest Exploration Associates Ltd.
114. Report on the Tac Mineral Claim, Adams Plateau of Greyrock Holdings Ltd. by Douglas A. Leishman, Consulting Geologist, dated May 15, 1987.

To: KILLICK GOLD COMPANY LTD.

File No. 31544

P.O. Box 3188,

Date July 27, 1988

Salmon Arm, B.C. VOE 2T0

Samples rock chip

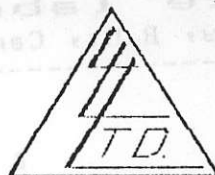

ATTN: Cec Kane

APPENDIX A

Certificate of Assay LORING LABORATORIES LTD.

| SAMPLE NO. | OZ./TON GOLD | OZ./TON SILVER | % Pb | % Zn | % Cu | % Fe | % As |
|------------|--------------|----------------|-------|------|------|-------|------|
| SPAR 1 /88 | .018 | 24.40 | 36.61 | 8.25 | .18 | 14.16 | 1.24 |

"ASSAY ANALYSIS"

I Hereby Certify that the above results are those assays made by me upon the herein described samples....

Shirley Lealey
Assayer

Rejects retained one month.
Pulps retained one month
unless specific arrangements
are made in advance.

Quanta Trace Laboratories Inc.

1401-3700 Gilmore Way, Burnaby, B.C., Canada V5G 4M1

Tel: (604) 438-5226

To: KILLICK GOLD CO. LTD.

W/O: 7576 Page 2
B - 4

B - 1

B - 2

B - 3

| Sample type | Rock | Rock | Rock | Rock |
|-----------------|--|--|--------------------------------------|---------------------------------|
| Identification | ISE SparGrid Line 16400N Stn 9350E | ISE SparGrid L 16200N Stn 9450 E | NW SparGrid L 16200N Stn 7525E | Gash Grid L 15000E 19875N |
| Lab Reference # | 7576-001 | 7576-002 | 7576-003 | 7576-004 |
| Analyzed by | Plasma Emission Spectroscopy (ICAP) | | | |
| Method used | aque regia soluble | aque regia soluble | aque regia soluble | aque regia soluble |
| Aluminum | Al 828. | 5970 | 8050 | 12800 |
| Antimony | Sb 3500 | 3900 | < 20 | 100 |
| Arsenic | As 234000 | 1500 | 310 | 80 |
| Barium | Ba 4.2 | 29.8 | 2.2 | 20.3 |
| Beryllium | Be < 0.2 | < 0.2 | < 0.2 | < 0.2 |
| Boron | B < 2. | < 2. | < 2. | < 2. |
| Cadmium | Cd 31.7 | 279. | 2210 | 172. |
| Calcium | Ca 1700 | 79300 | 52600 | 7290 |
| Chromium | Cr 44.6 | 23.8 | 25.1 | 75.1 |
| Cobalt | Co 27. | 3. | 43. | 31. |
| Copper | Cu 180 | 49. | 837. | 324. |
| Iron | Fe 212000 | 42200 | 155000 | 72500 |
| Lead | Pb 57600 | 31600 | 102000 | 38700 |
| Lithium | Li < 20 | < 20 | < 20 | < 20 |
| Magnesium | Mg 370 | 4630 | 3660 | 1200 |
| Manganese | Mn 1060 | 8700 | 3790 | 2010 |
| Mercury | Hg < 20 | < 20 | < 20 | < 20 |
| Molybdenum | Mo < 6. | < 6. | < 6. | < 6. |
| Nickel | Ni 36.0 | 13. | 7.5 | 30.8 |
| Phosphorus | P 50 | 320 | 250 | 200 |
| Potassium | K 230 | 3060 | 100 | 2570 |
| Selenium | Se < 20 | < 20 | < 20 | < 20 |
| Sodium | Na 510 | 100 | 70 | 900 |
| Strontium | Sr 8.2 | 312. | 82.3 | 109. |
| Thorium | Th < 10. | < 10. | < 10. | < 10. |
| Titanium | Ti 46.8 | 150. | 37.4 | 336. |
| Uranium | U < 60 | < 60 | < 60 | < 60 |
| Vanadium | V 5.8 | 3.9 | 9.3 | 13. |
| Zinc | Zn 7640 | 90000 | 170000 | 44000 |
| Zirconium | Zr 2. | < 2. | 3. | < 2. |
| Results in | PPM | PPM | PPM | PPM |
| Precious Metals | | | | |
| Silver | Ag 2.90 | 1.08 | 0.45 | 1.52 |
| Gold | Au 0.178 | 0.019 | 0.006 | 0.009 |
| Palladium | Pd < 0.0004 | < 0.0004 | < 0.0004 | < 0.0004 |
| Platinum | Pt 0.0006 | 0.0008 | 0.0005 | 0.0008 |
| Rhodium | Rh < 0.001 | < 0.001 | < 0.001 | < 0.001 |
| Results in | oz/T | oz/T | oz/T | oz/T |
| Total Sulfur | %S 17.4 | 9.40 | 25.5 | 9.54 |
| Total Carbon | %C 0.11 | 2.46 | 2.96 | 0.02 |

Assayer: *[Signature]*



KAMLOOPS RESEARCH & ASSAY LABORATORY LTD.

2095 WEST TRANS CANADA HIGHWAY — KAMLOOPS B.C.
V1S 1A7

PHONE: (604) 372-2784 — TELEX: 048-8320

CERTIFICATE OF ASSAY

**B.C. LICENSED ASSAYERS
GEOCHEMICAL ANALYSTS
METALLURGISTS**

APPENDIX C

TO Orell Resources Ltd.
Box 1386
Salmon Arm, B.C. VOE 2T0

Certificate No. K-3334

Date October 28, 1980

I hereby certify that the following are the results of assays made by us upon the herein described _____ samples

| Kral No. | Marked | GOLD | SILVER | Pb | Zn | Cu | | | | |
|----------|-------------------|----------------|----------------|---------|---------|---------|---------|---------|---------|---------|
| | | Ounces Per Ton | Ounces Per Ton | Percent | Percent | Percent | Percent | Percent | Percent | Percent |
| 1 | # 1 Trench | .016 | .39 | .82 | .35 | .02 | | | | |
| 2 | # 2 Trench | .012 | 4.16 | 11.5 | .43 | .13 | | | | |
| 3 | # 3 Trench | .152 | .38 | .72 | 1.65 | .03 | | | | |
| 4 | # 4 Trench | .008 | .98 | 2.27 | 3.23 | .06 | | | | |
| 5 | # 6 Trench | .006 | 3.76 | 5.74 | 16.2 | .01 | | | | |
| 6 | # 7 Trench | .056 | 3.97 | 11.1 | 14.7 | .03 | | | | |
| 7 | # 8 Trench | .006 | 2.03 | 6.52 | 7.8 | .12 | | | | |
| 8 | #10 Trench | .008 | 2.76 | 5.65 | 7.2 | .09 | | | | |
| 9 | #11 Trench | .008 | 1.44 | 2.60 | 8.3 | .07 | | | | |
| 10 | #12 Trench | .010 | 1.61 | 2.81 | 3.4 | .09 | | | | |
| 11 | #13 Trench | .008 | 4.33 | 6.33 | 4.23 | .16 | | | | |
| 12 | Cash Creek Trench | .002 | .34 | .35 | .93 | .07 | | | | |

*SECTION BLACK'S
SEE JIM BLACK'S*

trenches sampled.

NOTE:
Rejects retained three weeks.
Pulps retained three months
unless otherwise arranged.

J. Brown

Registered Assayer, Province of British Columbia



Member
Canadian Testing
Association

KAMLOOPS RESEARCH & ASSAY LABORATORY LTD.

912-1 LAVAL CRESCENT — KAMLOOPS, B.C.
V2C 5P5

PHONE: (604) 372-2784 — TELEX: 048-8320

CERTIFICATE OF ASSAY

B.C. LICENSED ASSAYERS
GEOCHEMICAL ANALYSTS
METALLURGISTS

APPENDIX D-1

TO Noranda Explorations Ltd.

208-156 Victoria Street

Kamloops, B.C. V2C 1Z7

ATTENTION: MR. TOM LEWIS

Certificate No. K-5823

Date September 13, 1983

I hereby certify that the following are the results of assays made by us upon the herein described _____ samples

| Kral No. | Marked | Au | Ag | Pb | Zn | Cu | | | | |
|----------|--------|------------|------------|---------|---------|---------|--|--|--|--|
| | | ounces/ton | ounces/ton | percent | percent | percent | | | | |
| 1 | 4001 | .002 | .60 | .59 | 2.9 | .06 | | | | |
| 2 | 4002 | .002 | .49 | .65 | 1.47 | .04 | | | | |
| 3 | 4003 | .25 | .24 | .12 | 2.5 | .03 | | | | |
| 4 | 4004 | .004 | 1.77 | 2.4 | 8.2 | .01 | | | | |
| 5 | 4005 | L.001 | .22 | .05 | .04 | .04 | | | | |
| 6 | 4006 | L.001 | .55 | .65 | 6.1 | .04 | | | | |
| 7 | 4007 | L.001 | .61 | .14 | 6.1 | .21 | | | | |
| 8 | 4008 | L.001 | .32 | .31 | .74 | .83 | | | | |

L means "Less than"

NOTE:
Rejects retained three weeks.
Pulps retained three months
unless otherwise arranged



KAMLOOPS RESEARCH & ASSAY LABORATORY LTD.

912-1 LAVAL CRESCENT—KAMLOOPS, B.C.
V2C 5P5
PHONE: (604) 372-2784 — TELEX: 048-8320

B.C. LICENSED ASSAYERS
GEOCHEMICAL ANALYSTS
METALLURGISTS

CERTIFICATE OF ASSAY

APPENDIX D-2

TO Noranda Explorations Ltd.
208-156 Victoria Street
Kamloops, B.C. V2C 1Z7

Certificate No. K-5904
Date September 19, 1983

I hereby certify that the following are the results of assays made by us upon the herein described _____ samples

| Kral No. | Marked | Au | | | | | | |
|----------|---|-----------------------|--|--|--|--|--|--|
| 1 | 4003 <i>re run</i> <i>Mosquito King</i> <i>82M/3+4</i> <i>TRENCH #3</i> | ounces/ton .27 | | | | | | |

NOTE:
Rejects retained three weeks.
Pulps retained three months
unless otherwise arranged.



Registered Assayer, Province of British Columbia

Bondar-Clegg & Company Ltd.
 130 Pemberton Ave.
 North Vancouver, B.C.
 Canada V7P 2R5
 Phone: (604) 985-0681
 Telex: 04-352667

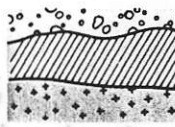

BONDAR-CLEGG

Certificate
 of Analysis

KILLICK GOLD CO. LTD.

APPENDIX E

REPORT: 425-1566

PROJECT: NONE GIVEN

PAGE 1

| SAMPLE NUMBER | ELEMENT UNITS | Au OPT | Ag OPT | Cu PCT | Pb PCT | Zn PCT | FeTot PCT | As PCT |
|---------------|---------------|--------|--------|--------|--------|--------|-----------|--------|
| R2 1/85 | | 0.194 | 0.14 | 0.03 | 0.11 | 0.04 | 18.94 | |
| R2 2/85 | | 0.028 | 0.05 | <0.01 | 0.01 | 0.05 | 32.97 | 0.01 |
| R2 3/85 | | 0.009 | 0.27 | <0.01 | 0.77 | 2.68 | 9.40 | |
| R2 4/85 | | 0.010 | 3.68 | 0.17 | 10.70 | 9.40 | 12.80 | |
| R2 5/85 | | <0.002 | 0.56 | 0.01 | 0.33 | 2.16 | 11.57 | |

LEAD SETTLEMENT-(FINAL)
OUR SERIAL NO. 1516

COMINCO LTD.
TRAIL B.C.

IN ACCOUNT WITH-ORELL COPPER MINES LTD.
BOX 457
SALMON ARM B.C.

12 10 79

APPENDIX F

FOR LEAD ORE - OPEN770 - LOT 3 CAR NO. RECEIVED
2 TRUCK 10 19 79
WEIGHT OF SHIPMENT - LBS. 1.40% MOISTURE

NET WET WT NET DRY WT DRY TONS
63100 62217 31.1085

ASSAYS

| GOLD | SILVER | COPPER | LEAD | ZINC | SULPHUR | SILICA |
|--------------|---------|--------|---------|---------|---------|---------|
| 0.0200 | 5.3000 | 0.1200 | 12.4000 | 9.4000 | 14.6000 | 34.9000 |
| OZ / DRY TON | | % | % | % | % | % |
| ALUMINA | IRON | LIME | ANTHONY | ARSENIC | BISMUTH | |
| 5.0000 | 13.9000 | 2.9000 | 0.0200 | 0.2000 | 0.0100 | |
| % | % | % | % | % | % | |

| QUOTATIONS | QUOT DATE | 11 AV 79 | US EXCHANGE | 17.96000% |
|------------|--------------------|-----------------|------------------------|-----------|
| SILVER | 16.43662 US \$/OZ. | LESS 0.085\$/OZ | NET 19.30364 \$/OZ CAN | |
| LEAD | 55.62300 US C/LB. | LESS 15.40C/LB | NET 50.21290 C/LB CAN | |
| ZINC | 35.38100 US C/LB. | LESS 16.50C/LB | NET 25.23540 C/LB CAN | |

CONTENTS AND VALUE

| METAL | CONTENT | DEDUCTIONS | NET | VALUE |
|------------------------------------|------------|------------|----------------------|---------|
| SILVER | 164.88 OZS | 31.11 | 133.77 OZS \$ | 2582.25 |
| LEAD | 7715 LBS | 622 | 7093 LBS \$ | 3541.60 |
| ZINC | 5848 LBS | 2339 | 3509 LBS \$ | 885.51 |
| | | | TOTAL GROSS VALUE \$ | 7029.36 |
| LESS: BASIC TREATMENT @ 55.00 \$/T | | | 1710.97 | |
| LESS: TREATMENT RATE @ 12.46 \$/T | | | 387.61 \$ | 2098.58 |
| | | | TOTAL NET VALUE \$ | 4930.78 |
| | | | ADVANCED \$ | 3660.00 |
| | | | BALANCE \$ | 1270.78 |

| TREATMENT RATE | LABOUR RATE ADJ | 217.0000 AT \$ | 0.060 | \$ | 13.02 |
|--------------------------------------|-----------------|----------------|-------|-------|-------|
| TRUCK CHARGE | | | | \$ | 4.00 |
| ARSENIC PENALTY | 0.1000 AT \$ | 1.000 | \$ | 0.10 | |
| ALUMINA PENALTY | 4.5000 AT \$ | 0.350 | \$ | 1.58 | |
| MOISTURE PENALTY | 0.0000 AT \$ | 0.000 | \$ | 0.00 | |
| SILICA CREDIT | 34.9000 AT \$ | -17.450 | \$ | -6.09 | |
| LIME CREDIT | 2.9000 AT \$ | -0.050 | \$ | -0.15 | |
| TOTAL TREATMENT RATE | | | \$ | 12.46 | |
| ADDITIONAL ARSENIC PENALTY INDICATED | | | | | |

LEAD SETTLEMENT-(FINAL)
OUR SERIAL NO. 1596

COMINCO LTD
TRAIL B.C.

IN ACCOUNT WITH-ORELL COPPER MINES LTD.
BOX 457
SALMON ARM B.C. V0E 2T0

01 11 80

APPENDIX G

FOR LEAD ORE - OPEN770 - LOT 6 CAR NO. RECEIVED
2 TRUCKS 11 08 79

WEIGHT OF SHIPMENT - LBS. 0.30% MOISTURE

NET WET WT NET DRY WT DRY TONS
67020 66819 33.4095

ASSAYS

| GOLD | SILVER | COPPER | LEAD | ZINC | SULPHUR | SILICA |
|--------------|---------|--------|----------|---------|---------|---------|
| 0.0700 | 8.9500 | 0.1600 | 9.1000 | 7.8000 | 24.7000 | 23.0000 |
| 0Z / DRY TON | | % | % | % | % | % |
| ALUMINA | IRON | LIME | ANTIMONY | ARSENIC | BISMUTH | |
| 1.4000 | 22.2000 | 0.8000 | 0.0200 | 2.3000 | 0.0100 | |
| % | % | % | % | % | % | |

QUOTATIONS QUOT DATE 12 AV 79 US EXCHANGE 16.96000%

| | | | |
|--------|---------------------|-----------------|-------------------------|
| GOLD | 455.08400 US \$/OZ. | LESS 5.00\$/OZ | NET 527.26625 \$/OZ CAN |
| SILVER | 21.57485 US \$/OZ. | LESS 0.085\$/OZ | NET 25.14894 \$/OZ CAN |
| LEAD | 54.62700 US C/LB. | LESS 14.570C/LB | NET 48.92170 C/LB CAN |
| ZINC | 35.38100 US C/LB. | LESS 16.500C/LB | NET 24.88160 C/LB CAN |

CONTENTS AND VALUE

| METAL | CONTENT | DEDUCTIONS | NET | VALUE |
|--------|------------|------------|---------------|---------|
| GOLD | 2.339 OZS | 1.002 | 1.337 OZS \$ | 704.95 |
| SILVER | 299.02 OZS | 33.41 | 265.61 OZS \$ | 6679.81 |
| LEAD | 6081 LBS | 668 | 5413 LBS \$ | 2648.13 |
| ZINC | 5212 LBS | 2085 | 3127 LBS \$ | 778.05 |

| | | |
|------------------------------------|----------------------|----------|
| | TOTAL GROSS VALUE \$ | 10810.94 |
| LESS: BASIC TREATMENT @ 55.00 \$/T | 1837.52 | |
| LESS: TREATMENT RATE @ 16.89 \$/T | 564.29 \$ | 2401.81 |
| | TOTAL NET VALUE \$ | 8409.13 |
| | ADVANCED \$ | 5600.00 |
| | BALANCE \$ | 2809.13 |

TREATMENT RATE

| | | |
|--------------------------------------|-----------------------|----------|
| LABOUR RATE ADJ | 217.0000 AT \$ 0.060 | \$ 13.02 |
| TRUCK CHARGE | | \$ 4.00 |
| ARSENIC PENALTY | 2.2000 AT \$ 1.000 | \$ 2.20 |
| ALUMINA PENALTY | 0.9000 AT \$ 0.350 | \$ 0.32 |
| MOISTURE PENALTY | 0.0000 AT \$ 0.000 | \$ 0.00 |
| SILICA CREDIT | 23.0000 AT \$ -11.500 | \$ -2.65 |
| LIME CREDIT | 0.0000 AT \$ -0.050 | \$ 0.00 |
| TOTAL TREATMENT RATE | | \$ 16.89 |
| ADDITIONAL ARSENIC PENALTY INDICATED | | |

quanta trace laboratories inc.

#401-3700 Gilmore Way, Burnaby, B.C., Canada V5G 4M1

Tel: (604) 438-5226

To: KILLICK GOLD CO. LTD.

W/O: 6574 Page 2

| Sample type | | Concentrate |
|-------------------------------|----------------------------------|-------------|
| Lab Reference # | | 6574-000 |
| Precious Metals by Fire Assay | | |
| Silver | Ag | 1.57 |
| Gold | Au | 0.140 |
| Palladium | Pd | 0.0009 |
| Platinum | Pt | 0.003 |
| Rhodium | Rh | < 0.002 |
| Results in | | oz/T |
| Majors as Oxides | | |
| Silicon | % SiO ₂ | 11.0 |
| Aluminum | % Al ₂ O ₃ | 1.41 |
| Iron | % Fe | 30.8 |
| Calcium | % CaO | 1.03 |
| Magnesium | % MgO | 0.37 |
| Sodium | % Na ₂ O | 0.24 |
| Potassium | % K ₂ O | < 0.1 |
| Barium | % BaO | 0.009 |
| Manganese | % MnO | 0.99 |
| Phosphorus | % P ₂ O ₅ | < 0.1 |
| Strontium | % SrO | 0.008 |
| Titanium | % TiO ₂ | 0.12 |
| Zirconium | % ZrO ₂ | 0.03 |
| Loss on Ignition | | 23.4 |
| Total Oxides % | | 69.8 |
| Total Carbon %C | | 0.42 |
| Total Sulfur %S | | 38.4 |

Remarks: The sample was an Iron Pyrite (FeS) Concentrate carrying some values in Lead, Zinc, Silver and Gold.

Assayer: AKC

Certificate No. K-21109

Date November 21, 1977



Kamloops Research & Assay Laboratory Ltd.

WEST TRANS CANADA HIGHWAY - BOX 946 - KAMLOOPS, B.C. V2C 5N4
TELEPHONE 372-2784

B.C. LICENSED ASSAY,
GEOCHEMICAL ANALYSTS

APPENDIX I

CERTIFICATE OF ASSAY

TO Mr. Allan Hilton,
2236 Greenfield Ave.,
Kamloops, B. C.

Certificate No. K-1489

Date November 5, 1977.

I hereby certify that the following are the results of assays made by us upon the herein described chip samples

| Kral No. | Marked | GOLD | SILVER | Cu | Pb | Zn | | | | |
|--------------------|-------------------|------------------|----------------|---------|---------|---------|------------|---------|---------|---------|
| | | Ounces Per Ton | Ounces Per Ton | Percent | Percent | Percent | Percent | Percent | Percent | Percent |
| 1 | 28263 325 S 915 E | | .17 | .18 | .14 | 1.99 | | | | |
| 2 | 28264 450 S 150 E | Approx. * .40 | 2.13 | .08 | 3.39 | 3.70 | TRENCH #10 | | | |
| * Au not requested | | | | | | | | | | |

Chip samples taken 6' apart

NOTE:

Rejects retained three weeks
Pulps retained three months
unless otherwise arranged.

.....
Registered Assayer, Province of British Columbia

To: Orell Copper Ltd.

REPORT No A28 - 301

PAGE No. 1

BONDAR-CLEGG & COMPANY LTD.

DATE: June 29, 1978

P. O. Box 457
Salmon Arm, B. C.
VOE 2T0

CERTIFICATE OF ASSAY

Samples submitted: June 27, 1978
Results completed: June 29, 1978

APPENDIX J

I hereby certify that the following are the results of assays made by us upon the herein described ore samples.

| MARKED | GOLD | | SILVER | Cu | Pb | Zn | | | | | TOTAL VALUE PER TON (2000 LBS.) |
|---------------------|-------------------|------------------|-------------------|---------|---------|---------|---------|---------|---------|---------|---------------------------------------|
| | Ounces per Ton | Value per Ton | Ounces per Ton | Percent | Percent | Percent | Percent | Percent | Percent | Percent | |
| BOWLER CREEK | | | | | | | | | | | |
| #1 - 78 | <0.002 | | 1.57 | 0.02 | 1.94 | 2.66 | | | | | |
| #2 - 78 | 0.008 | | 0.07 | 0.06 | 0.02 | 0.06 | | | | | |

[Signature]
Registered Assayer, Province of British Columbia

To: Drill Resources Inc.

REPORT NO. 421 - 2000

PAGE No. 1

BONDAR-CLEGG & COMPANY LTD.

DATE: January 6, 1962

Box 3188

Salmon Arm, B.C.

VOE 2T0

CERTIFICATE OF ASSAY

Samples submitted: December 15, 1961

Results completed: January 6, 1962

PROJECT: NOT LISTED

APPENDIX K

I hereby certify that the following are the results of assays made by us upon the herein described rock samples.

| MARKED | GOLD | | SILVER | | Cu | Pb | Zn | | | | |
|-----------------------|----------------|----------------------|----------------|----------------------|---------|---------|---------|---------|---------|---------|---------|
| | Ounces per Ton | Grams per Metric Ton | Ounces per Ton | Grams per Metric Ton | Percent | Percent | Percent | Percent | Percent | Percent | Percent |
| 25639 | 0.050 | | 113.10 | | 0.19 | 59.01 | 2.65 | | | | |
| 25640 | 0.009 | | 129.70 | | 0.09 | 68.63 | 1.90 | | | | |
| 25641 | 0.044 | | 39.90 | | 0.11 | 17.50 | 3.95 | | | | |
| 25642 | 0.013 | | 29.40 | | 0.07 | 10.40 | 3.53 | | | | |
| 25643 | LO.002 | | 0.20 | | 0.01 | 0.11 | 0.04 | | | | |
| 43 - 18 | 0.008 | | 0.03 | | 0.03 | 0.06 | | | | | |
| 47 - 18 | 0.003 | | 1.23 | | 0.03 | 3.88 | | | | | |
| L denotes 'less than' | | | | | | | | | | | |

NOTE:
 Rejects retained three weeks
 Pulps retained three months
 unless otherwise arranged.

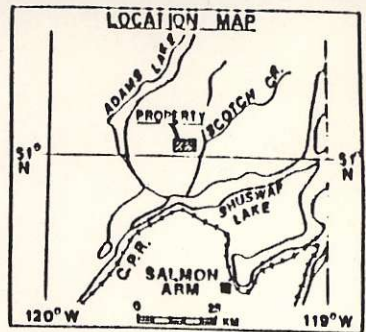
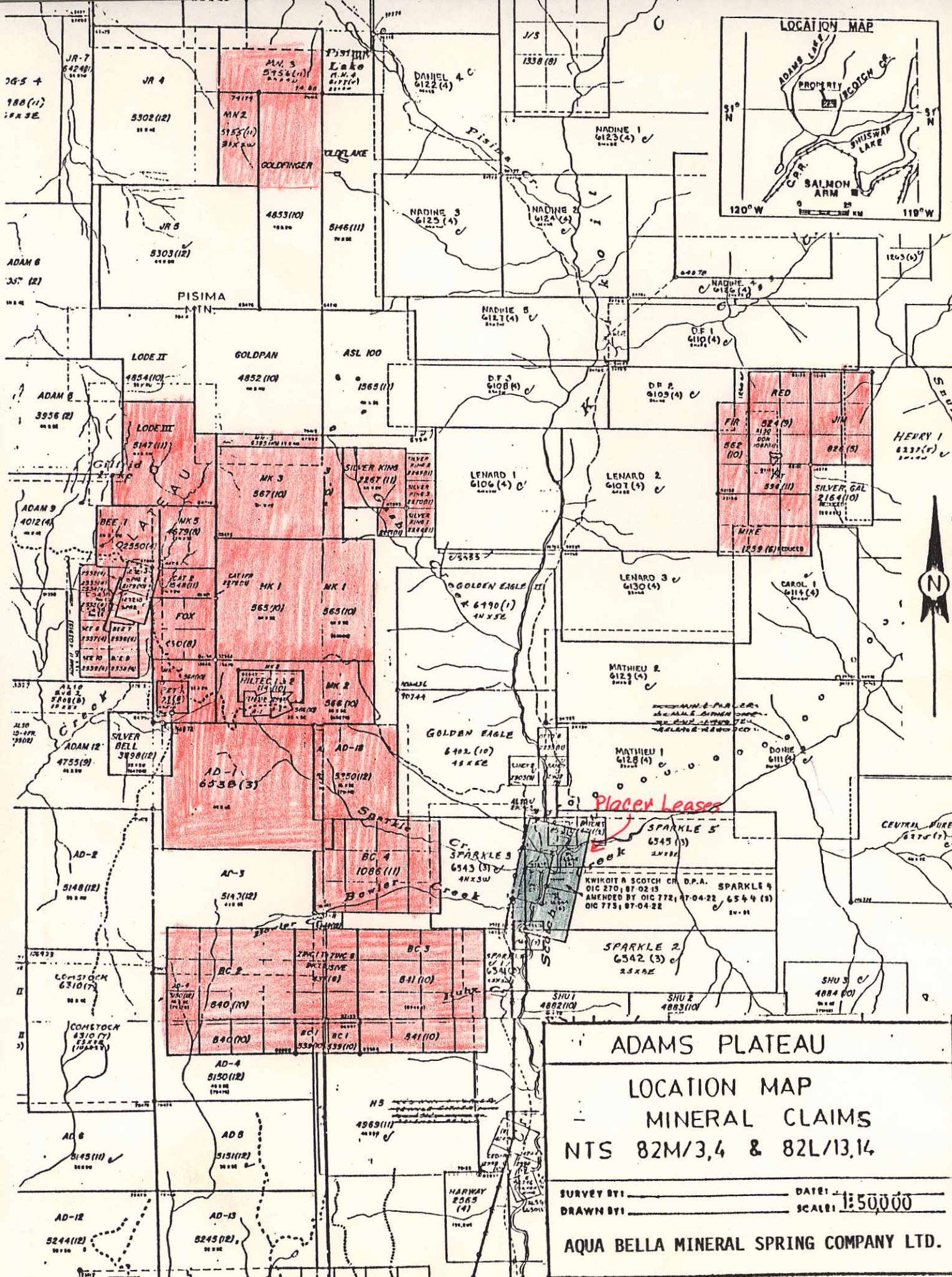

ADAMS PLATEAU

LOCATION MAP

MINERAL CLAIMS

NTS 82M/3,4 & 82L/13,14

SURVEY BY: _____ DATE: _____

DRAWN BY: _____ SCALE: **1:50,000**

AQUA BELLA MINERAL SPRING COMPANY LTD.

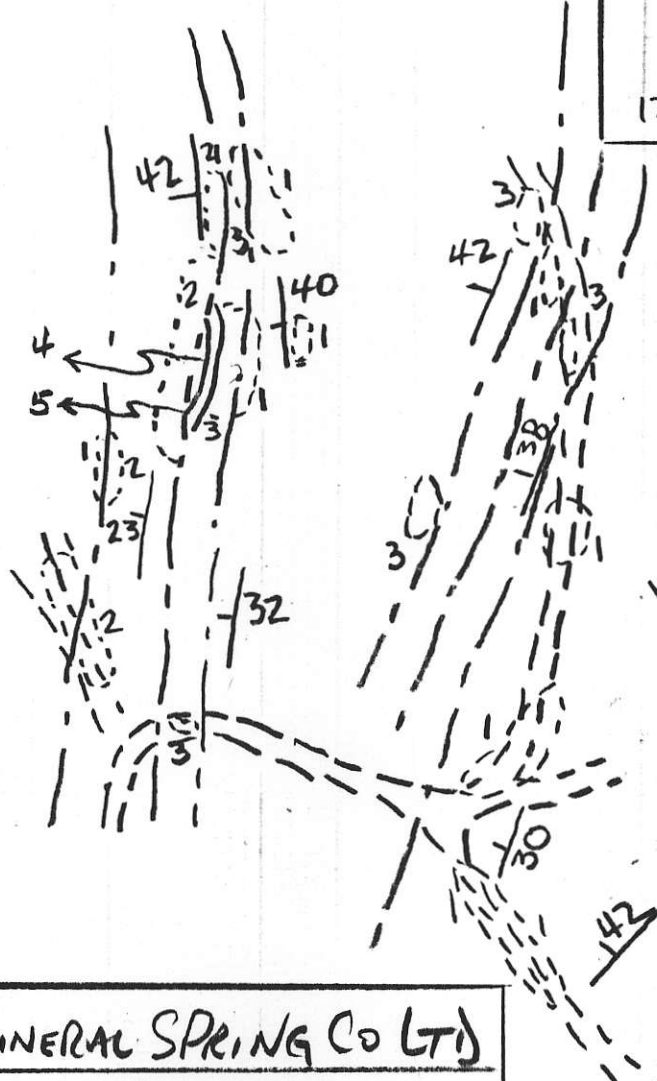
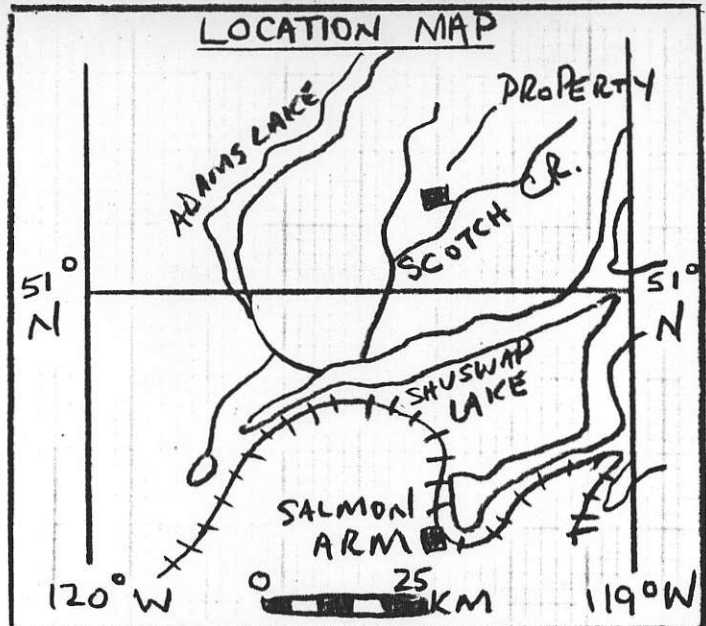

- 1 PHYLITE
- 2 GREENSTONE
- 3 LIMESTONE
- 4 QUARTZ
- 5 SULPHIDE
- CONTACT ASSUMED
- - - DIP & STRIKE
- - - - - OUTCROP
- TRENCH

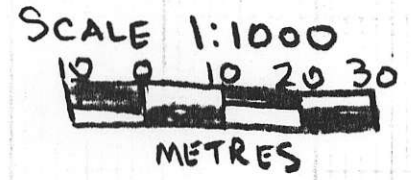

AQUA BELLA MINERAL SPRING CO LTD

SILVER LICHEN GRID

DISCOVERY SHOWING GEOLOGY

PROPOSED OPTION OR JOINT VENTURE

NTS 82M/3W DATE: OCT/89

SCALE 1:1000

MAP 8