

May 19, 1990  
LINES 95N, 96N  
106E - 113E  
1:2500

96N

95N

824289

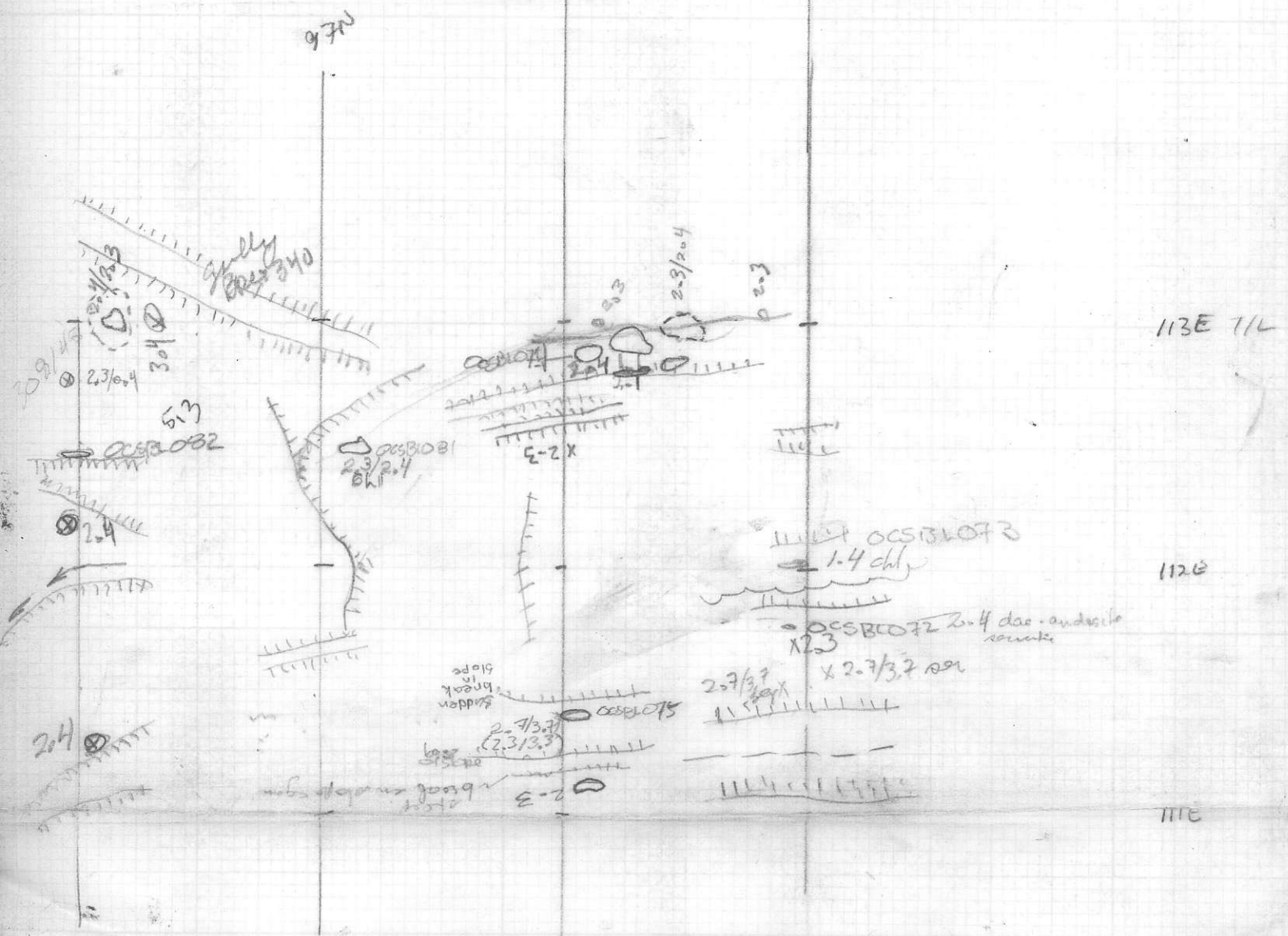



SBS GRID  
 L96N  
 SCALE 1:2500  
 MAY 12/90

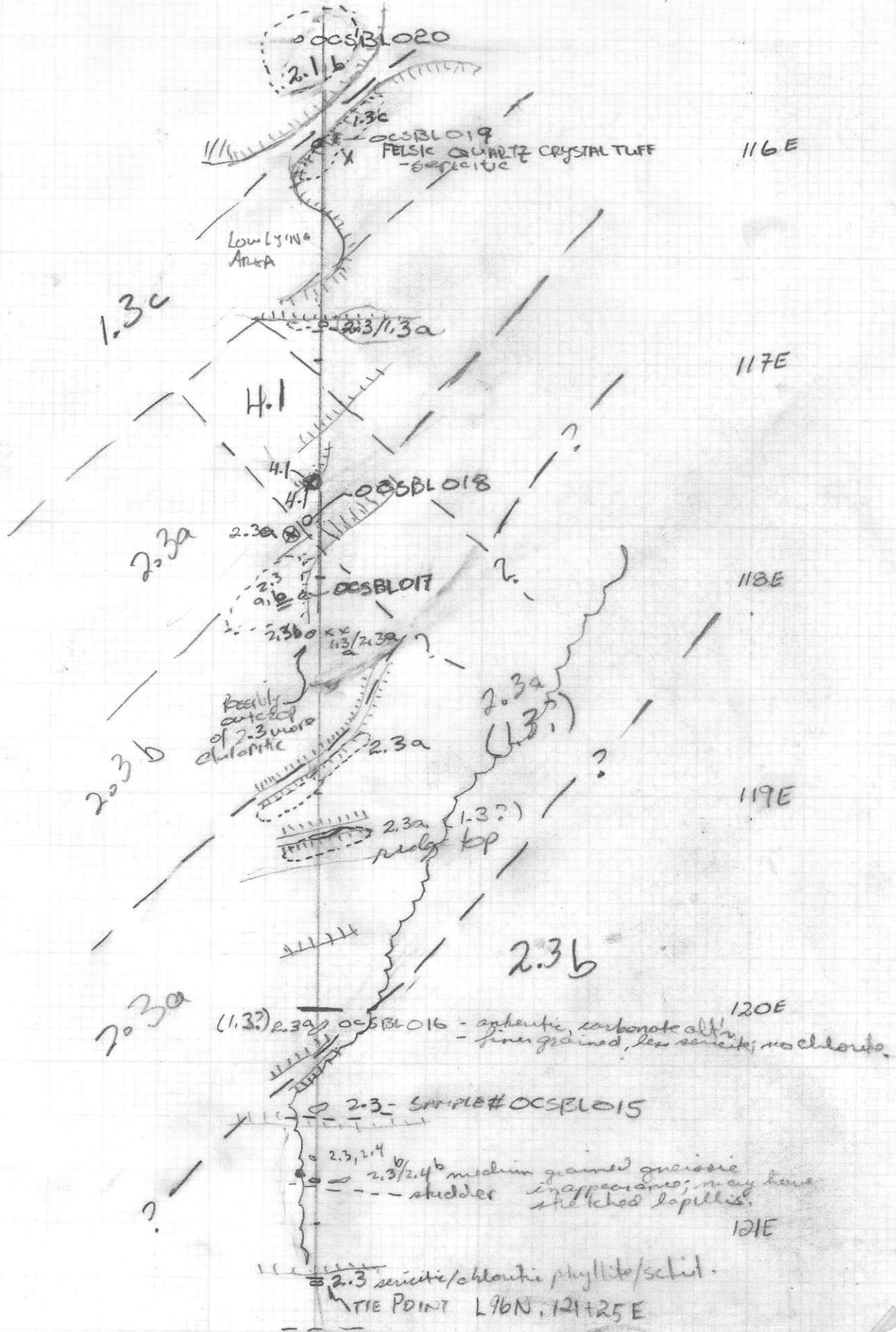

May 23, 1980  
 SBS GRID  
 L101N, 102N  
 112500

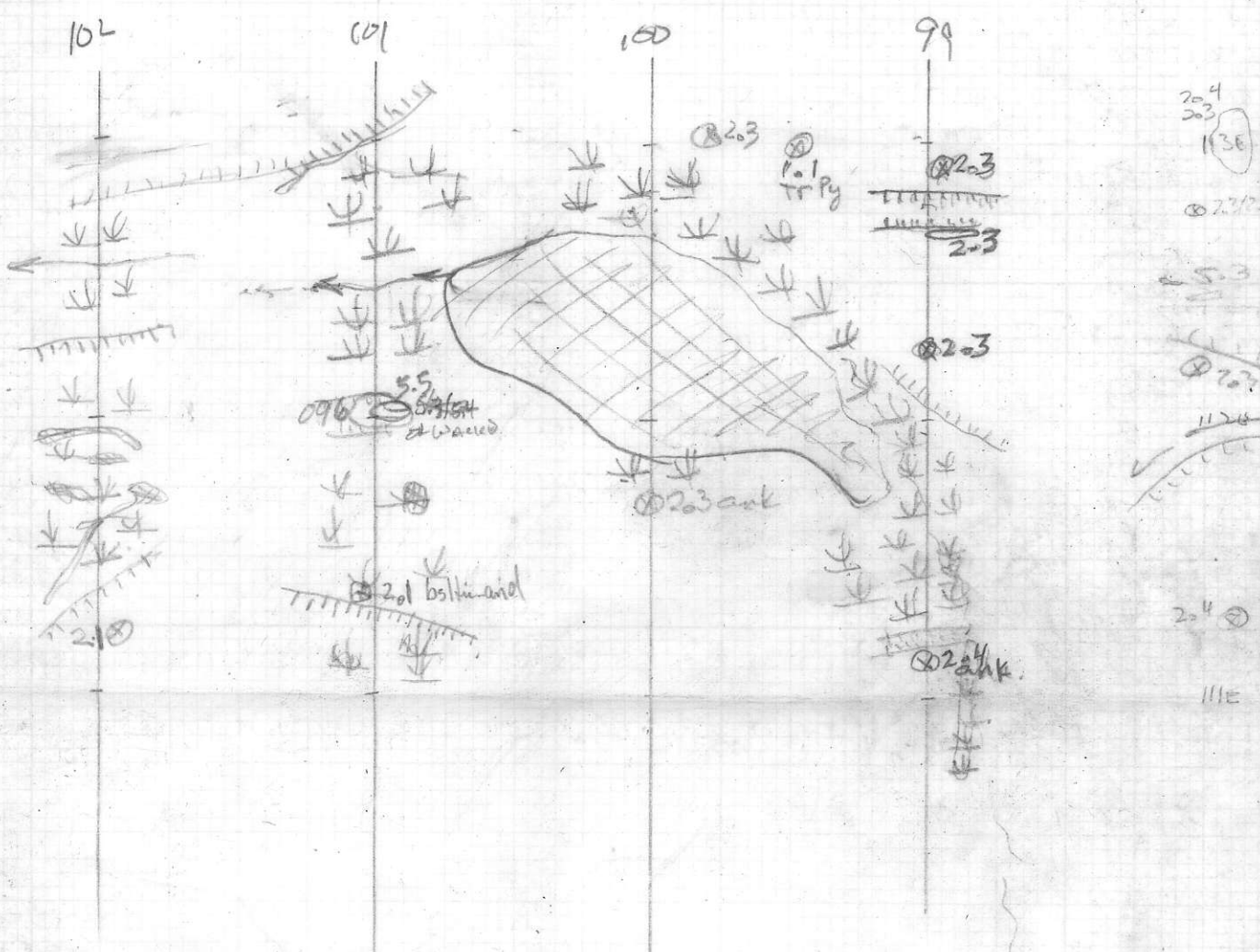

May 23, 1980  
SBS Field  
L 99N, 100N  
1: 2500

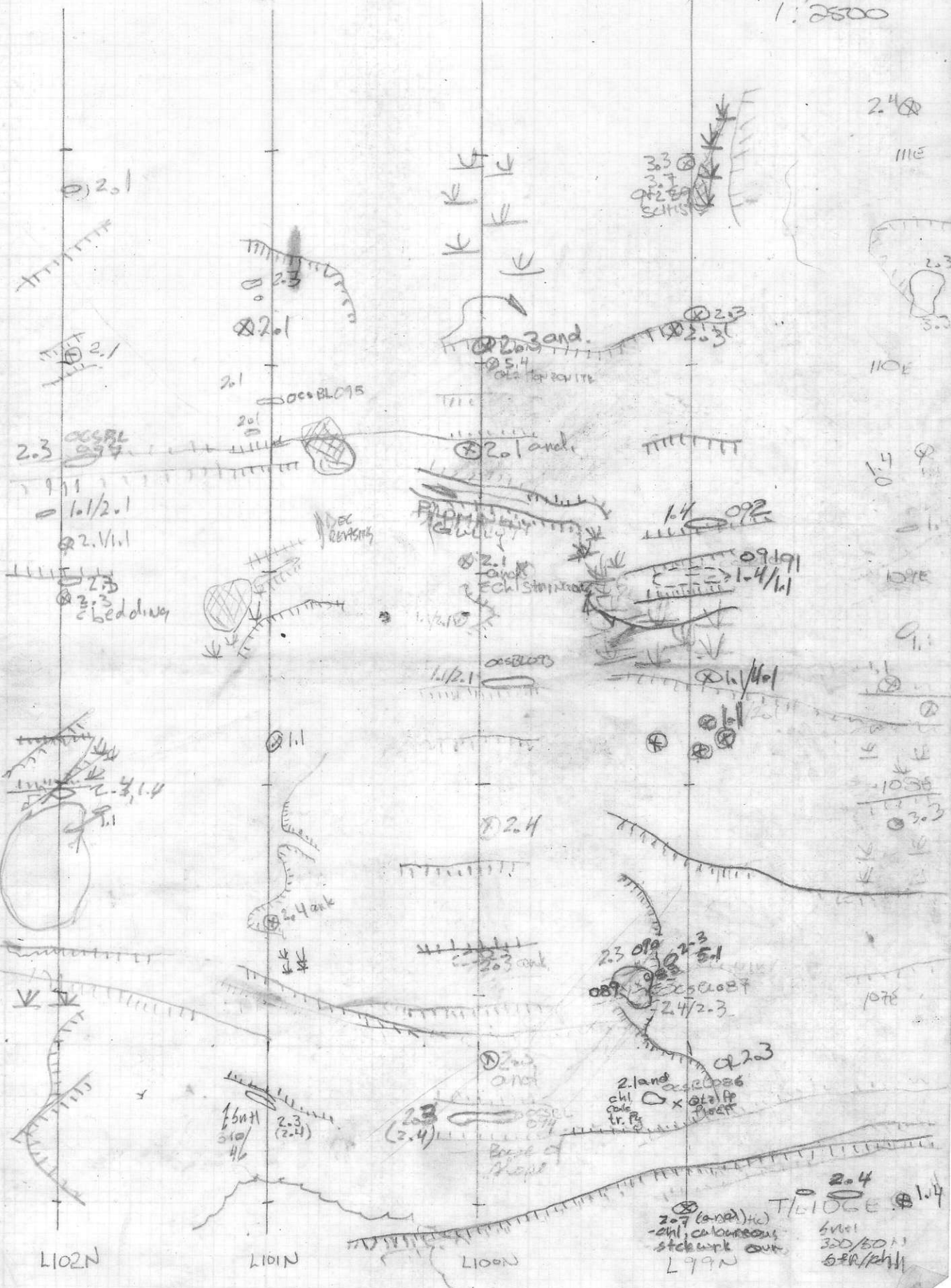

103N  
SPS GUP  
1. 2530

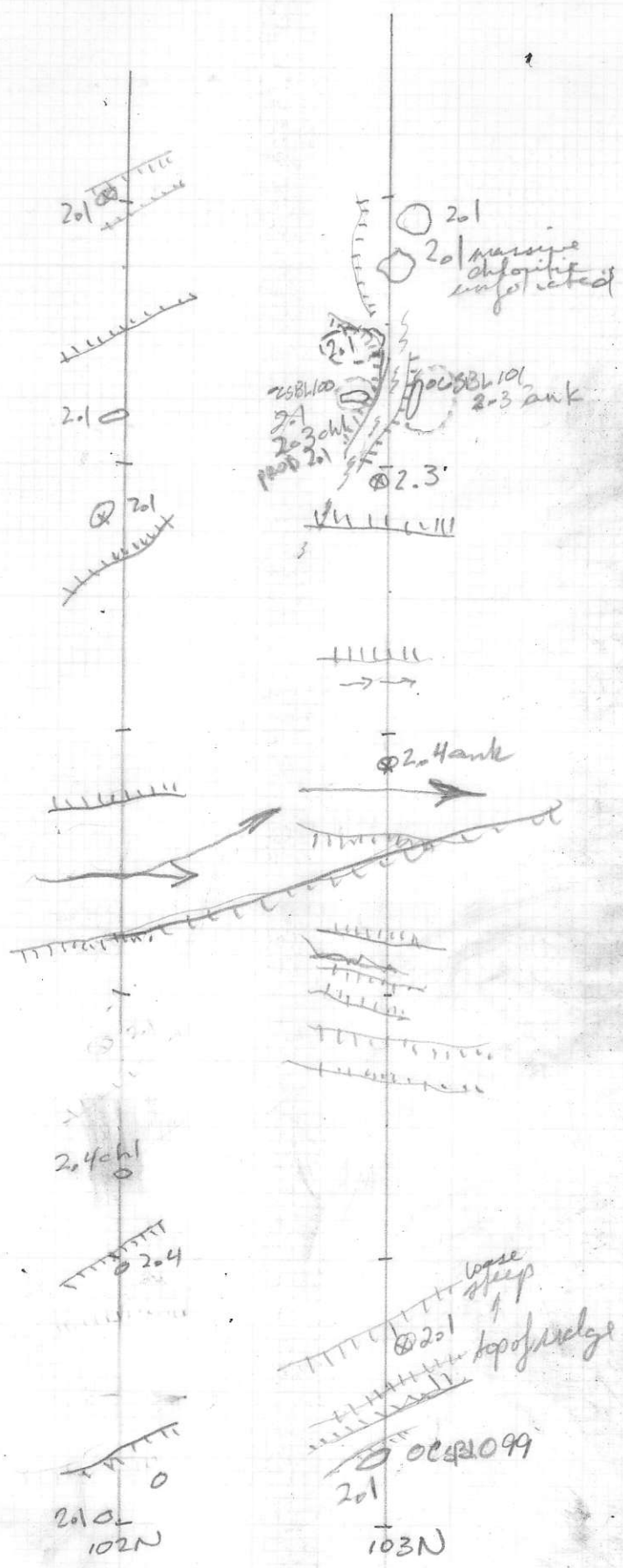

110E

112E

113E

114E

115E

2.1

2.1

2.1

2.1

2.1

2.4chl

2.4

2.1  
102N

2.1  
2.1 massive chloritic unfoliated

2.1  
2.3  
2.3 ank  
2.3

2.3

2.3

2.4ank

2.4

2.4

2.4

worse steep  
top of ridge  
2.1

2.1

2.1

103N

May 26, 11  
SBS GRID  
1103 N  
1:2500

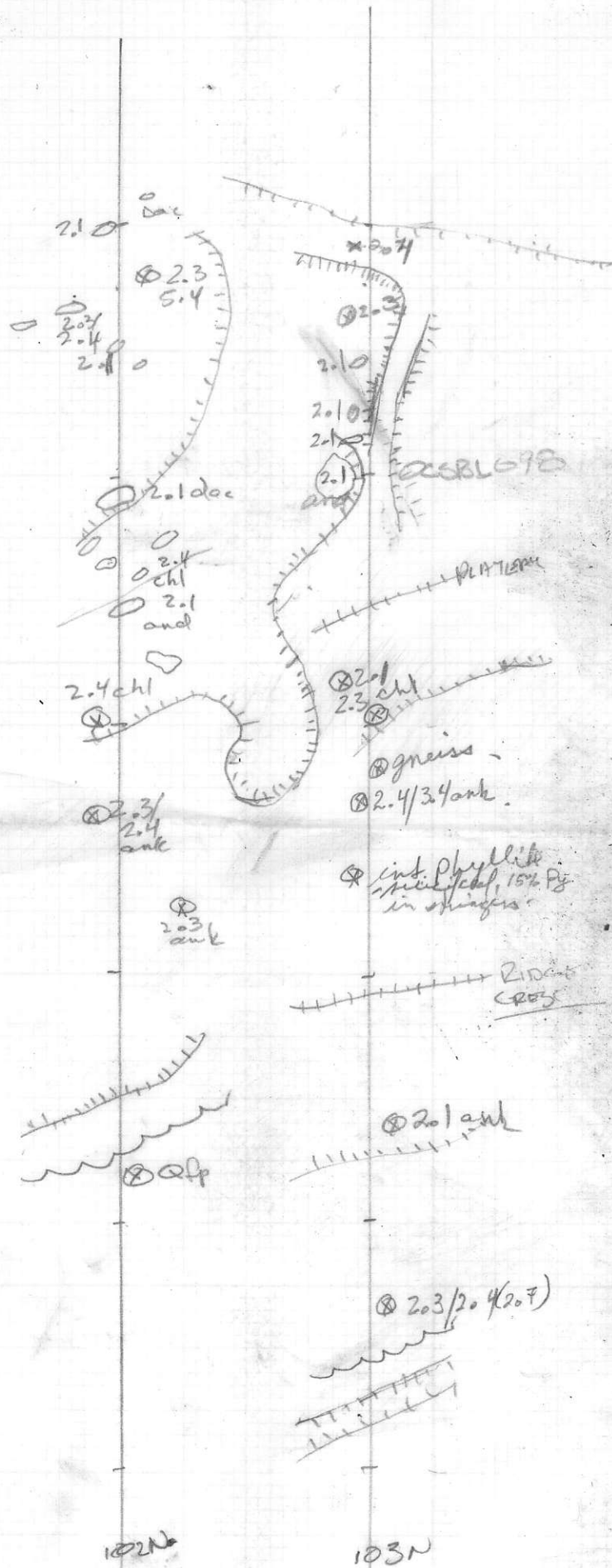

-115E

-116E

-117E

-118E

-119E

-120E

102N

103N

May 26/90  
L103N  
SBSGRN

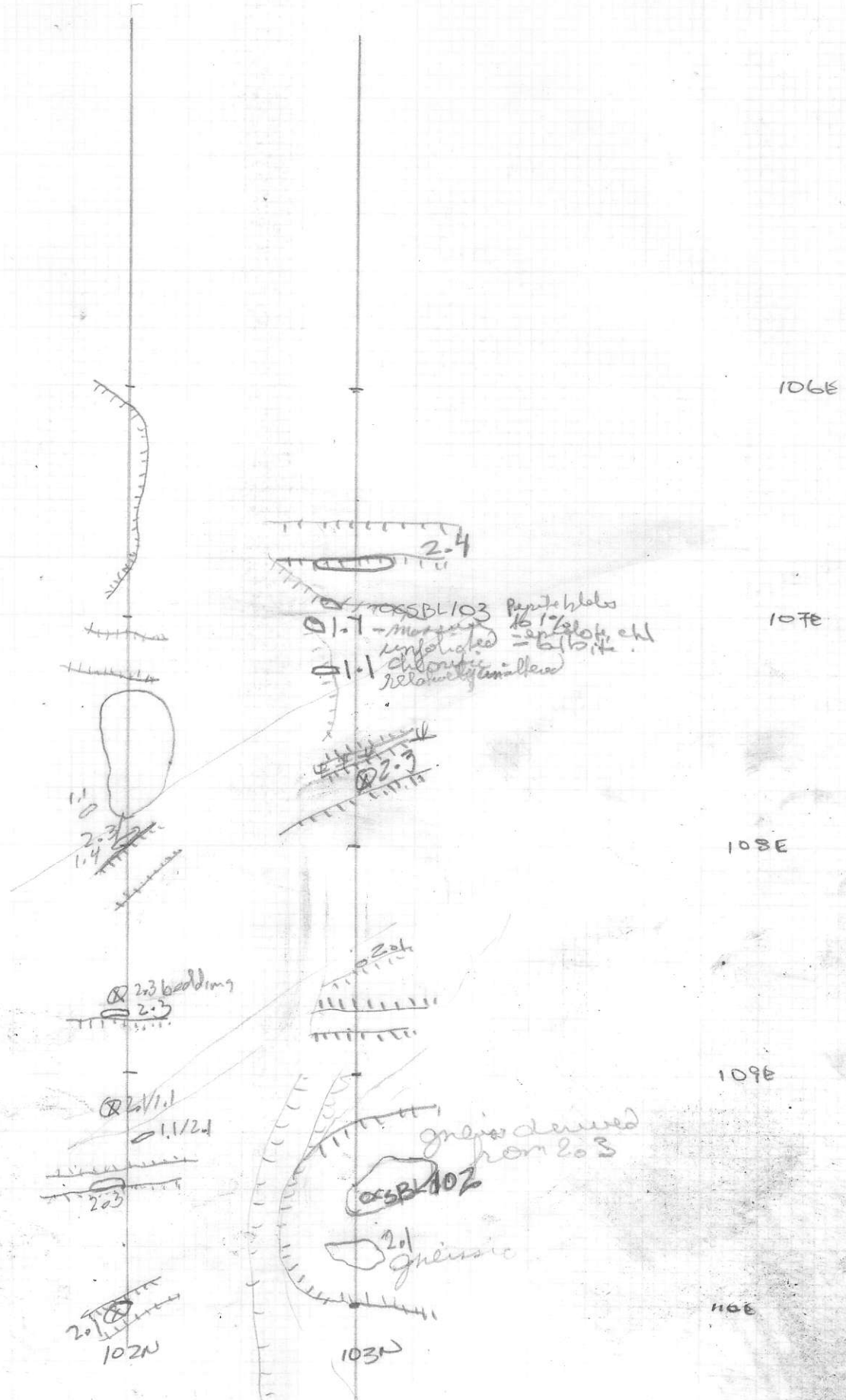



SBS GRID  
L96N  
1:2500  
May 12/90

#2  
DARCY  
672-0169

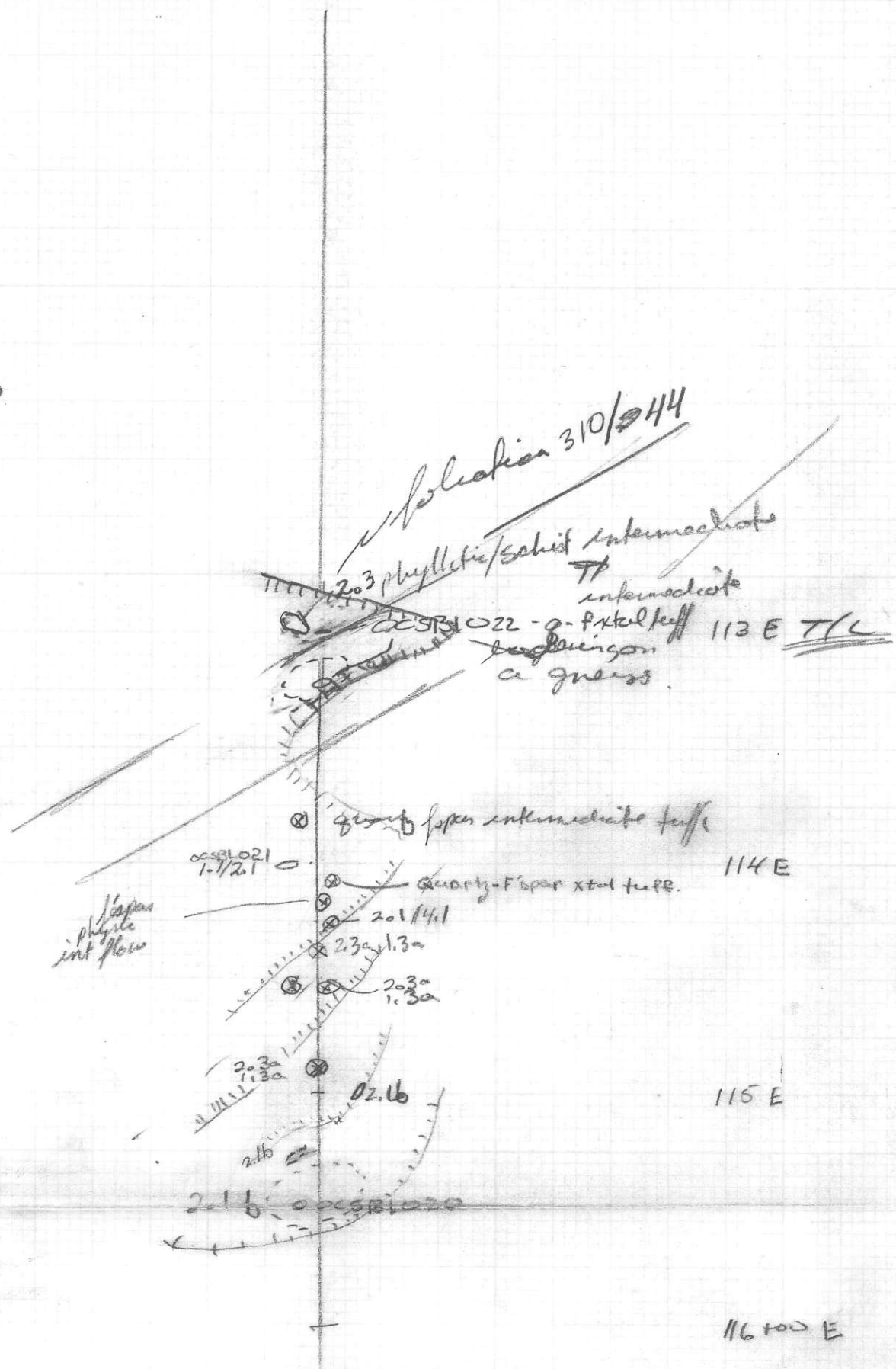

318/52

~~314/23~~  
~~298/33~~

~~320/32~~  
~~352/32~~

205 Lapilli 6/16  
ordina 0

9/30  
207



SB5  
 May 17/90  
 Road Mapping

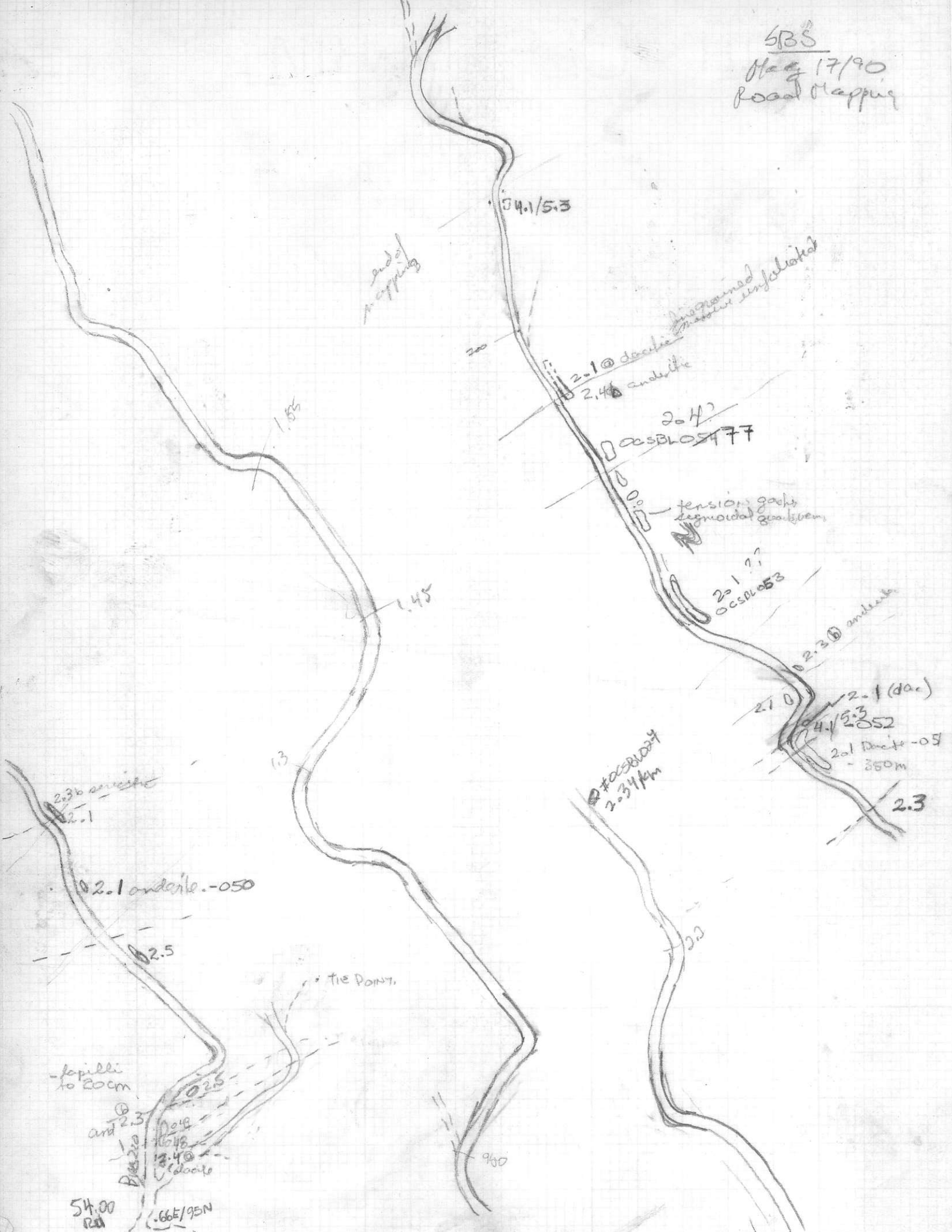



20 -  
8 -  
6 -  
4 -  
2 -  
10 -  
8 -  
6 -  
4 -  
2 -  
0 -

725

3.

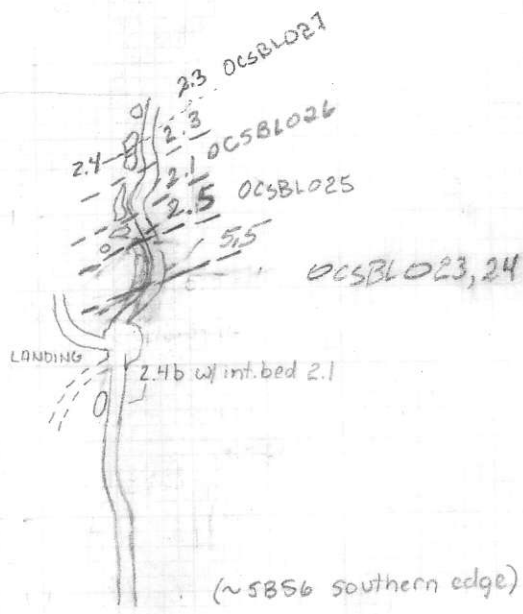

54 0000  
SOUTH END.

