

824261

VICTORY GRID

SAMPLE	NORTH	EAST/WEST	BOX	ALT	MIN
VCL 3001	122+05	21+78 W	1.1		100.2 410
VCL 3002	122+02	21+78 W	1.1	9710	100.3 410
VCL 3003	122+03	21+75 W	1.1		100.2
VCL 3004	122+00	21+75 W	1.1	9710	
VCL 3005	122+30	20+80 W	1.1		410.2
VCL 3006	121+58	20+84 W	1.1	9710	410.2
VCL 3007	121+58	20+84 W			400
VCL 3008	121+00	21+18 W	1.1	9710	410.2

24

Ternary basalt
- subcrop x

15-20

- mature fir stand
- some pine

15

TL 25

23

27100

EOL

x basalt

20

basalt
x subcrop

22

28100

EOL

xx basalt.

20

CLAIM
LINE

21

EOL

135 1450+

134 2100

133 etc.

L133

L134

basalt x
Sub

L133

TL
25

24

23

22

21

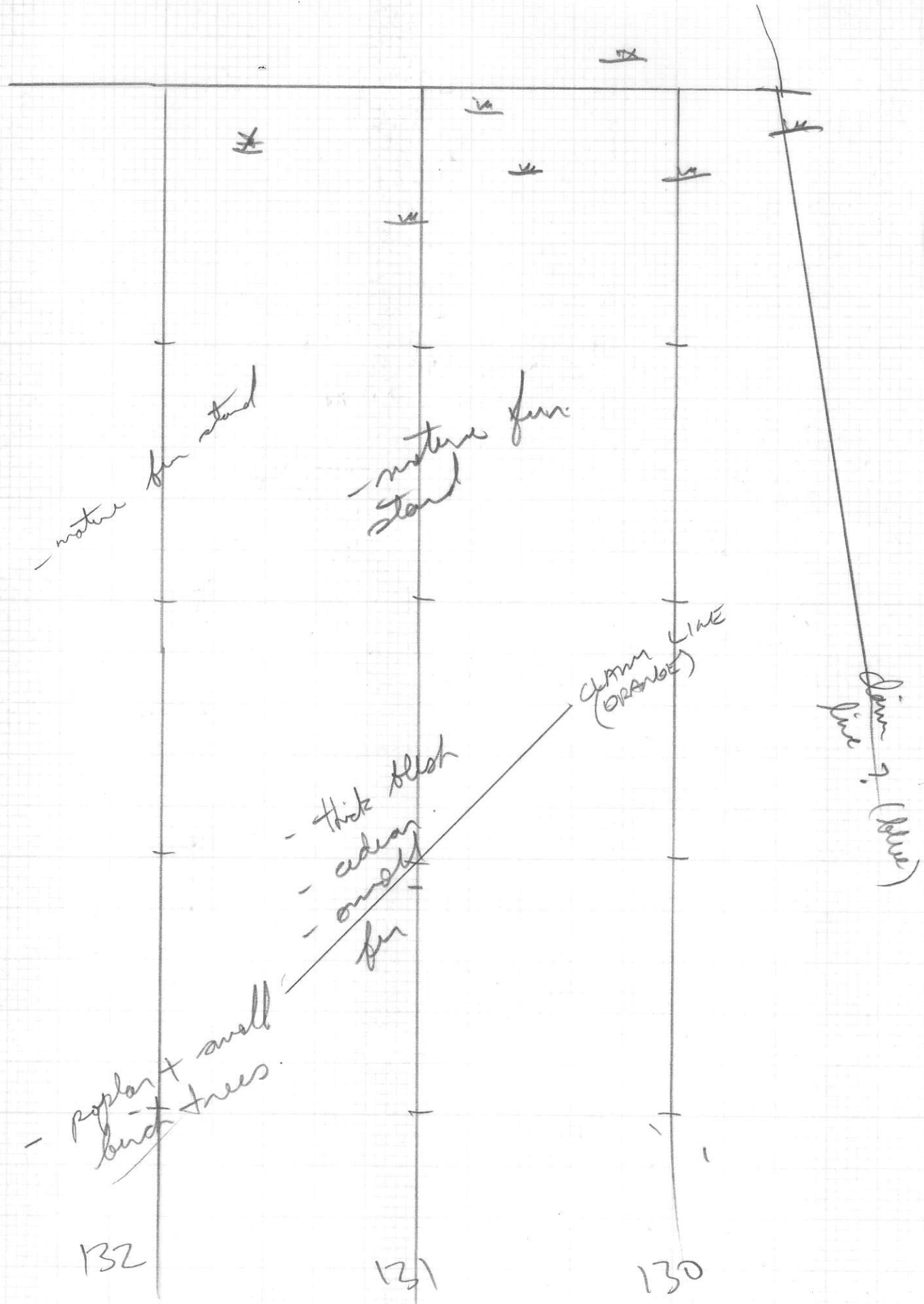

132

131

130

clearing line
(orange)

pine 1 (blue)

poplar + small
birch trees

thick slash
cedar
on old
fir

mature fir
stand

mature fir
stand

21

20

19

18

17

CLANNY
LINE
(ESBO)
PAVE/YELL

106 N
EOL 103 E

small cedar
fence and some poplar

EOL

CLANNY
LINE
(GRANITE)

132

ESBO
LINE

131

VI

VI

VI

VI

EOL

130

7

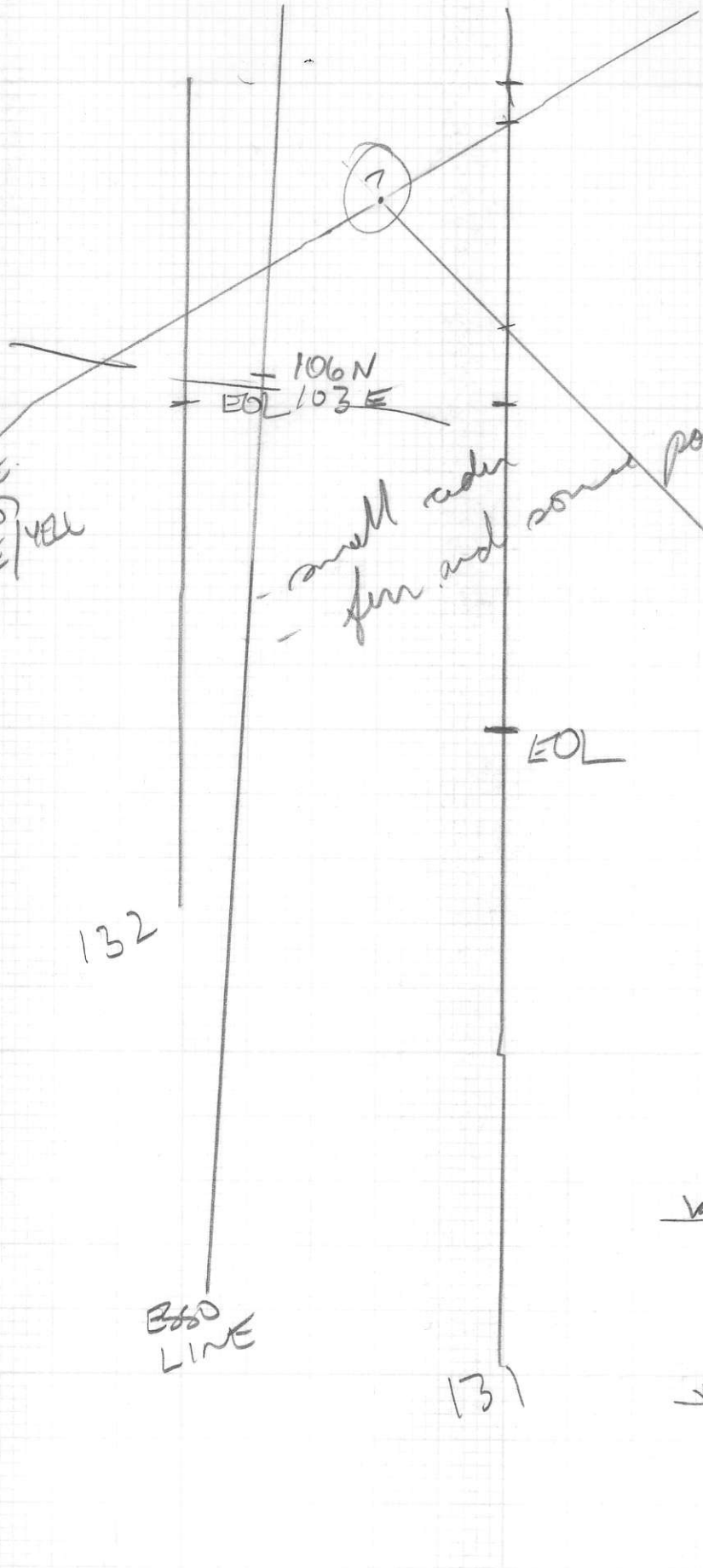

17

EOL
129

notes for stand

16

EOL

RSA
9425



15+75 (34+25)

EOL ?

NOT STATED

15

SURVEY LINE

$$\begin{array}{r}
 25+00 \\
 - 15+75 \\
 \hline
 9+25
 \end{array}$$

$$\begin{array}{r}
 25+00 \\
 + 9+25 \\
 \hline
 34+25
 \end{array}$$

14

13

128

127

21

small
cedar
poplar

~~20~~ Jam
line
(blue / yellow)

19

18

mature
fir
stand

L 102N
10+00E

17

EDL

L 101N
10+??

ESSO
LINE

✓
✓

✓

129

128

127

Summit line (blue)

TV 25

24

23

22

21

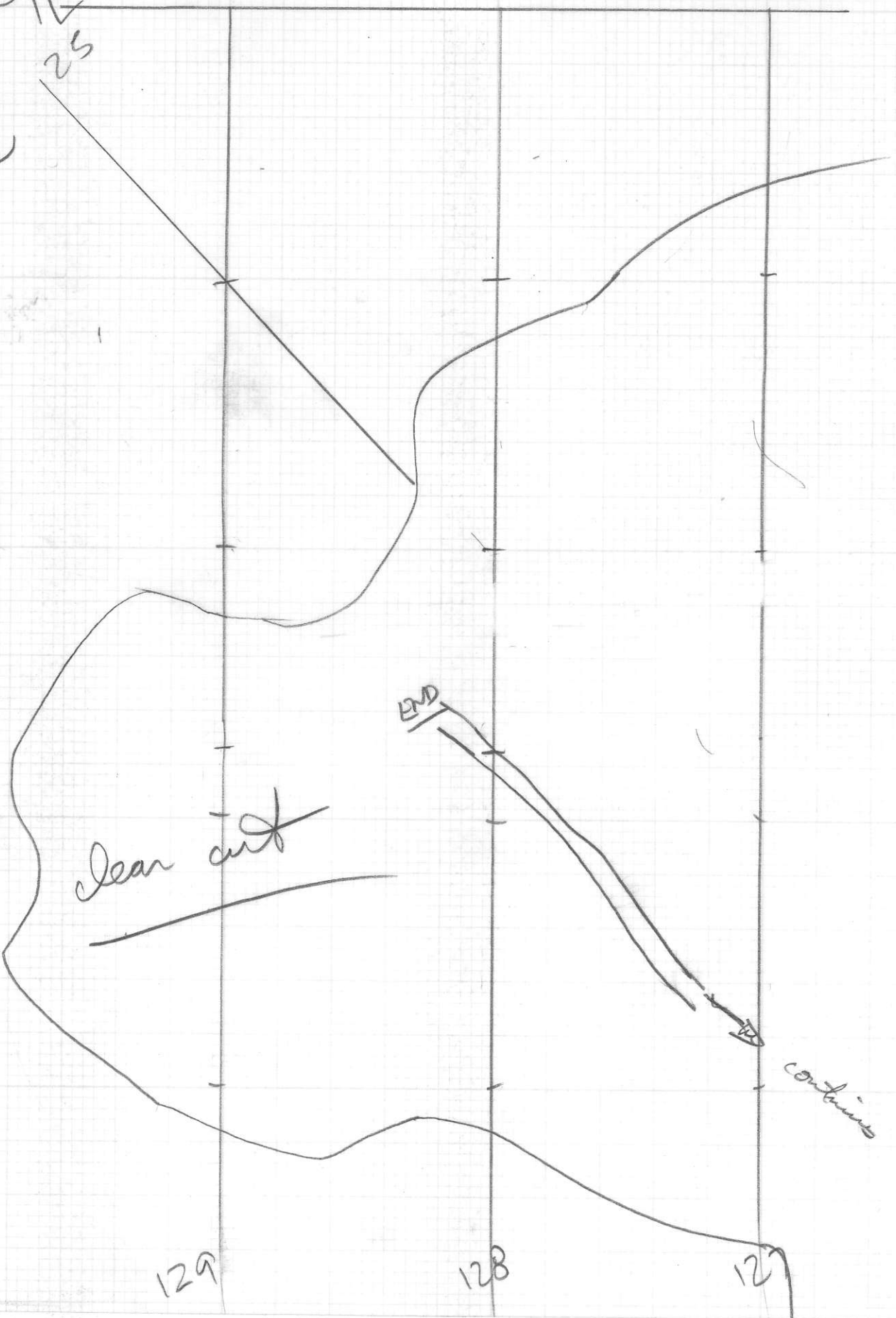

129

128

127

continues

lean cut

END

(CHANGE LINE #'S)

TL
25

L 126
24+25
25+35

L 125

24+15
125+06

24 (26)

clean cut.

23 (27)

22 (28)

21 (29)

127

20+25
19+75

125

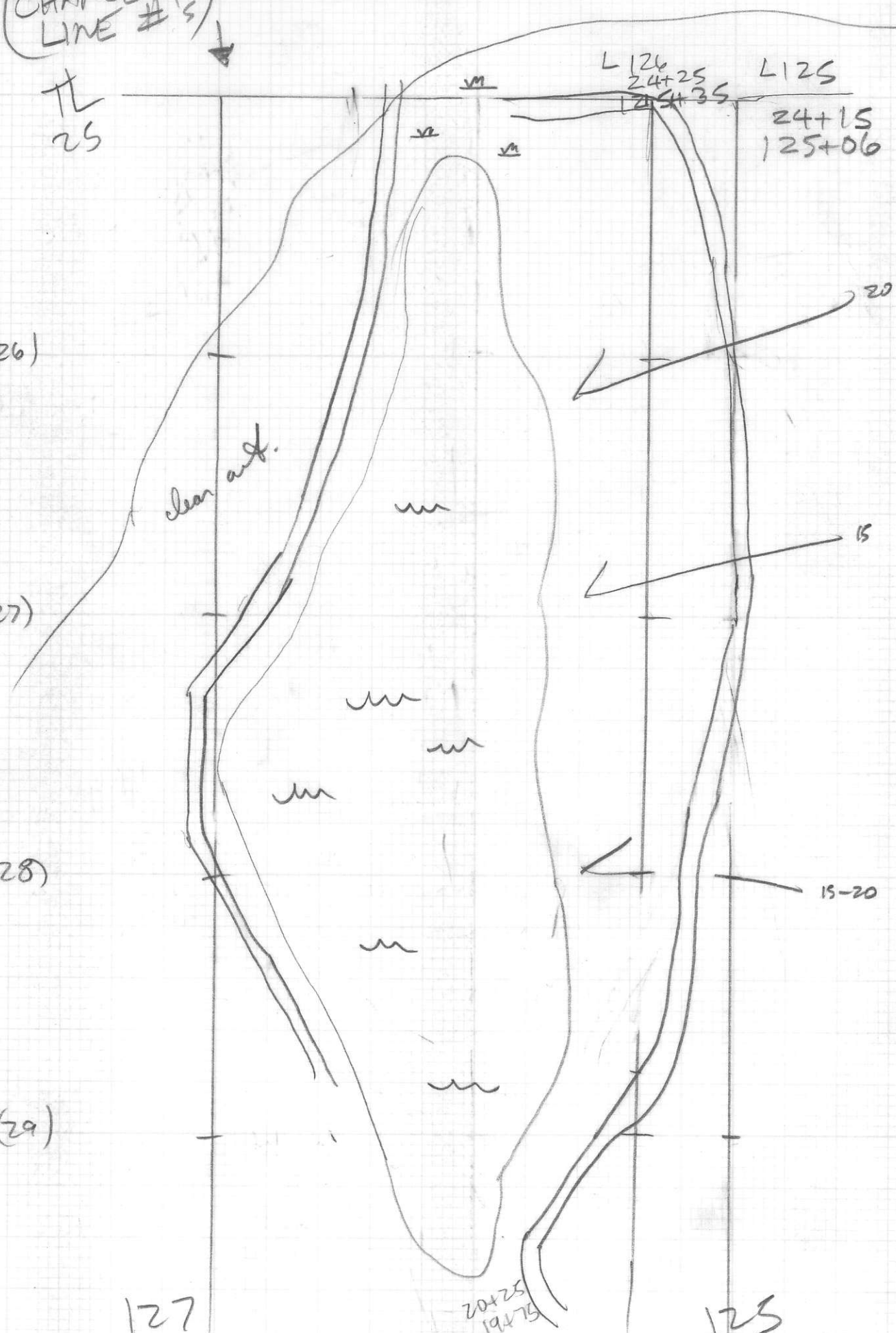

21(29)

20(30)

19(31)

18(32)

17(33)

121

to - history land 125

200

EMOS

cedar swamp

clear cut

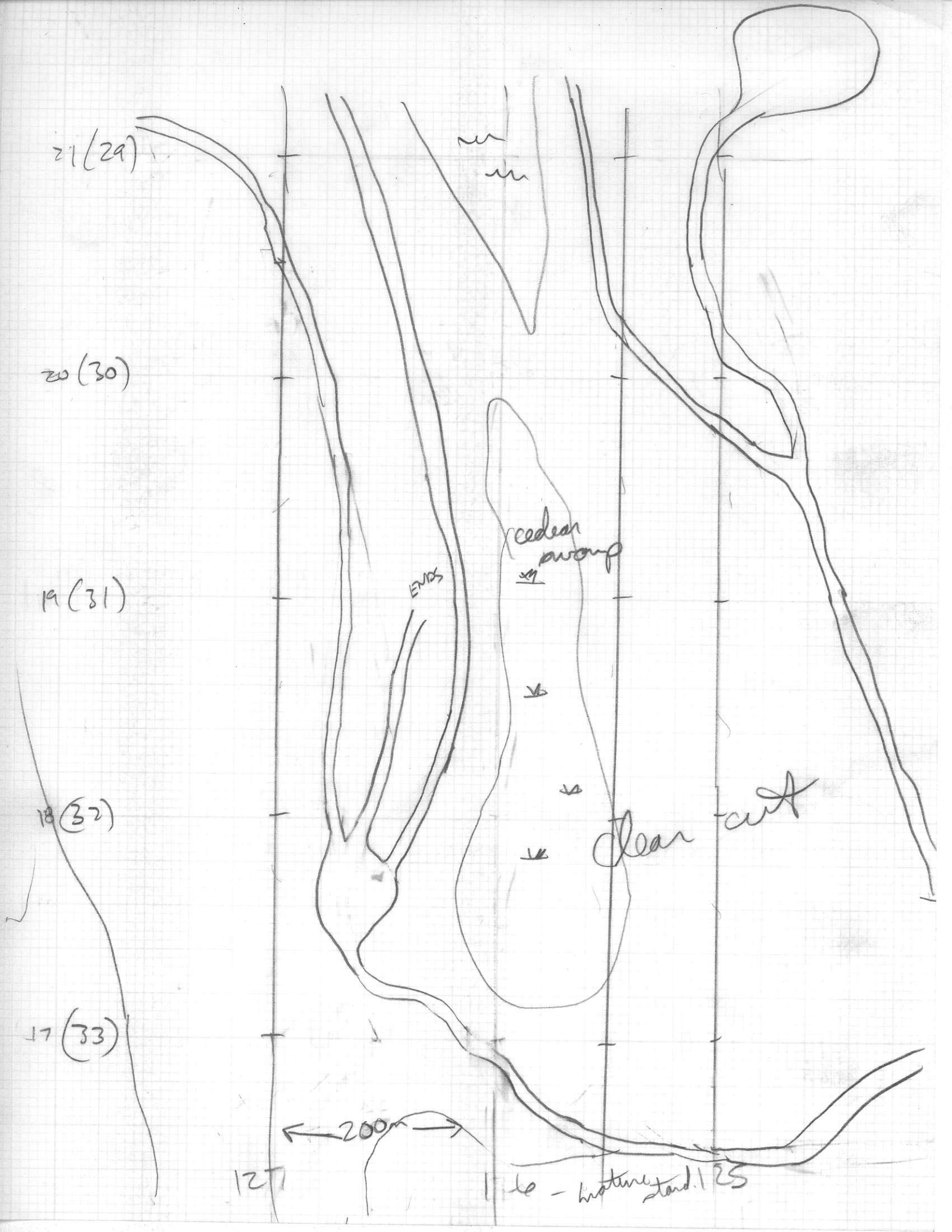

16 (34)

15+75

RSA 9425

SBL # 2
TAG 79216
4W 1N
00 T 24
83

GIL 4

394399 M

INITIAL POST #1
F. PERTERSEN

SEPT/86

15 (35)

DIR TO #2 POST N
" " " 450m
FLEET TO RT 1500

394398 M

FINAL POST #2

GIL 4

F.P.

L100N+
100E

RSA 9472

LESSO LINE

EXTENDED
SLAM
LINE

14 (36)

S22431 m

INT P #1
CANVA 2

J. COLBERT
OCT 23 / 83

DIR # 2-W

" " 457.2m

EXTENDED
LINES?

13 (37)

S22432 m

CANVA # 3

J.C.

OCT 23 / 83

DIR # 2-W

" " 457.2m

FLEET TO LF 457.2m

EXTEND
11+00

124

EX.
12+00

125

121

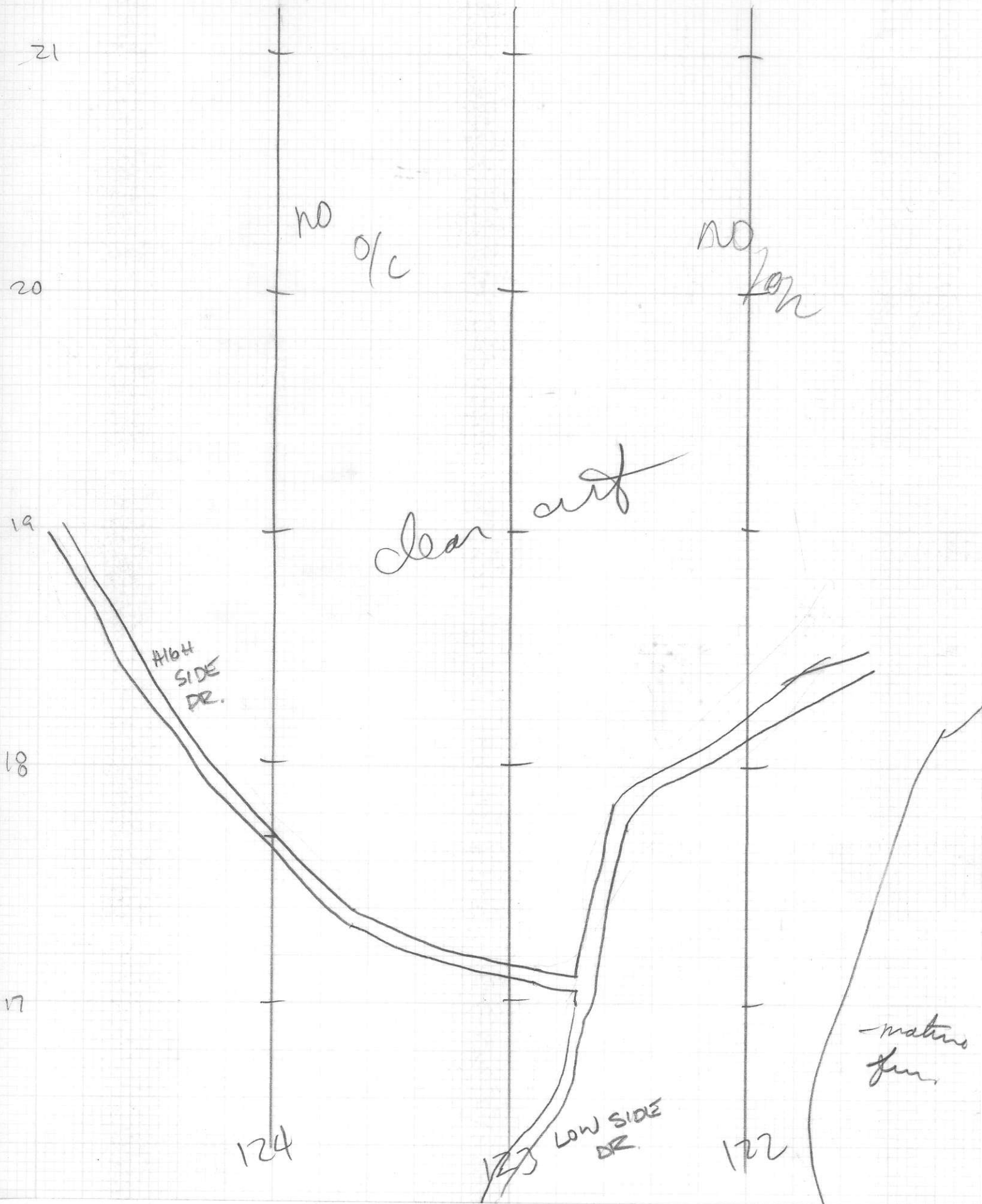

21

20

19

18

17

no
o/c

no
top

clear cut

HIGH
SIDE
DR.

LOW SIDE
DR.

watershed

124

123

122

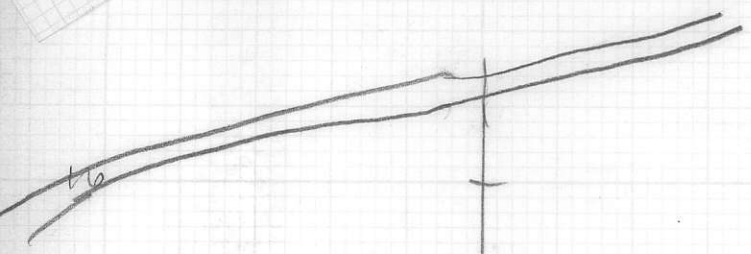

16

— nature for stand

15

EX

14

NO o/c

EX

13

EX

NO

o/c

12

NO o/c

124

123

1122

L25

123+95
24+25

clean cut yards 40m
beyond

122+15
24+35

123+10
24+23

24

23

clean cut

22

mafic float x

- lumps (possibly
small fur (planted)
- small alders

21

80
304

VCL 3002

VCL 3001
- unaltered

- possible lg float
WS-greenish gray
green

20
310

VCL 3003 - rusty
- 3% py
VCL 3004

- dense
- rusty
- 3% py
- v. folded

- unaltered
- some rust staining
- 2 to 5% dis py
- competency varies

From unaltered to chloritic / carb
ratched
- u joint's set \perp to Sol

45
300

VCL 3005

123

340
RUNNER
45°

122
- banded - folded
- intensify
- Fe soaked

124

121+5
24+15

120+10
24+40

118+25
24+20



x
cg sed.
grits

24



23

gradual
slope
5-7%

clean cut

side of
hill
(steep)

NO

0%

- mature

- forest

22

NO

0%

VCL 3008 - some spidgts -
metallic deep
SUMMIT carb. varnishes

21 VCL 3007

- banded matrix flow
- folded

VCL 3006

- gtr carb veins
- 3cm wide
to Coliation
- chaotic alter (Wade to road)

121+00

120+00

119

21

steep side

20

x x rope float

- mature stand for

- mature stand

19

in production

NO

18

NO
O/V

O/V

17

- EX.

EX 16750

121

120

119

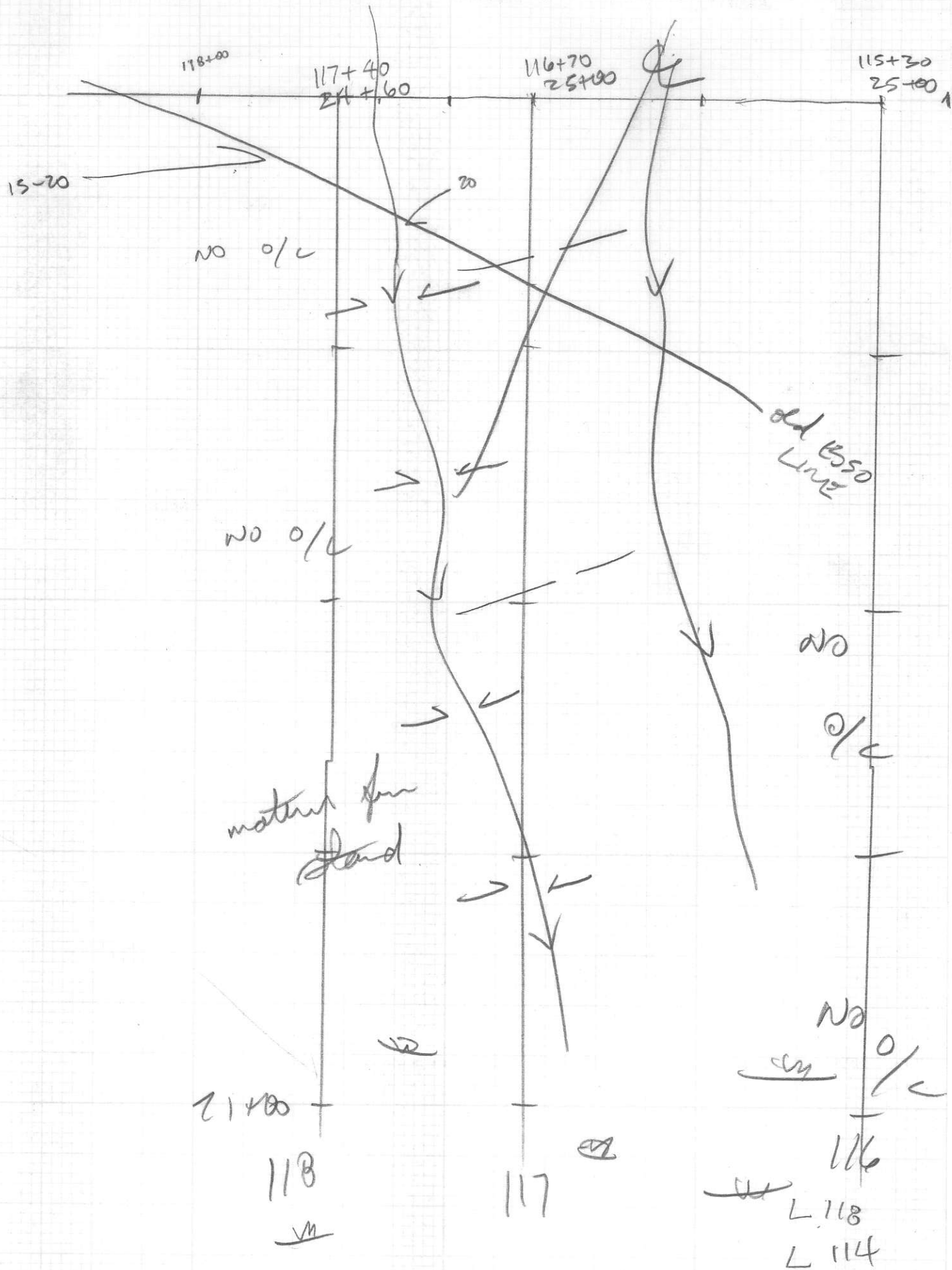

114+80
24+45

113+60
24+50

20-70

70

u

u

u

Cedar swamp

u

u

u

u

115

114

L 98
@ 98
EXTENDED

75m