

10W 11W 12W 13W 14W 15W 16W 17W 18W 19W 20W  
 0 BASE LINE  
 18°53'

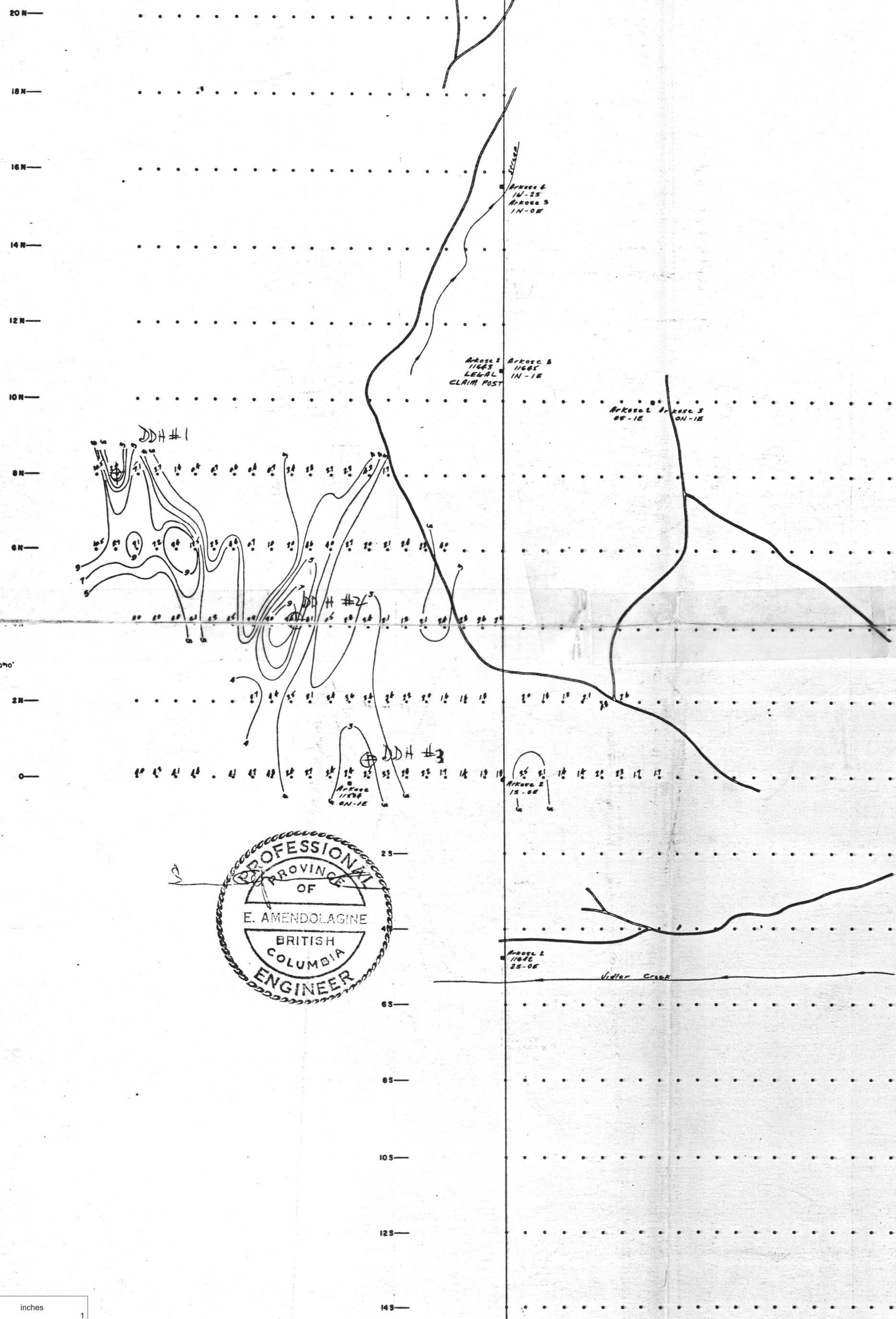

**LEGEND**

- Contour Line, Contour Interval: 3, 4, 5, 7, 9 Milliseconds
- Station
- Outline of Claims
- Claim Post
- Unimproved Road

**INSTRUMENT** MUNTIC 2.5 KW TIME DOMAIN  
 (ca=50 metres)

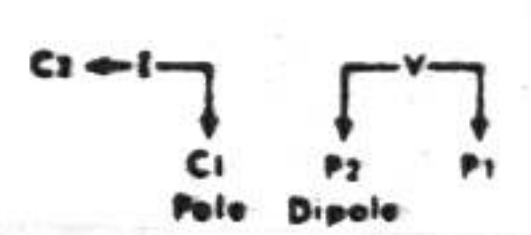

**CHARGEABILITY KEY**

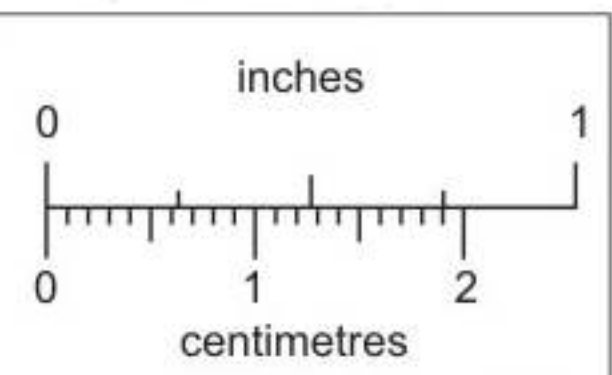
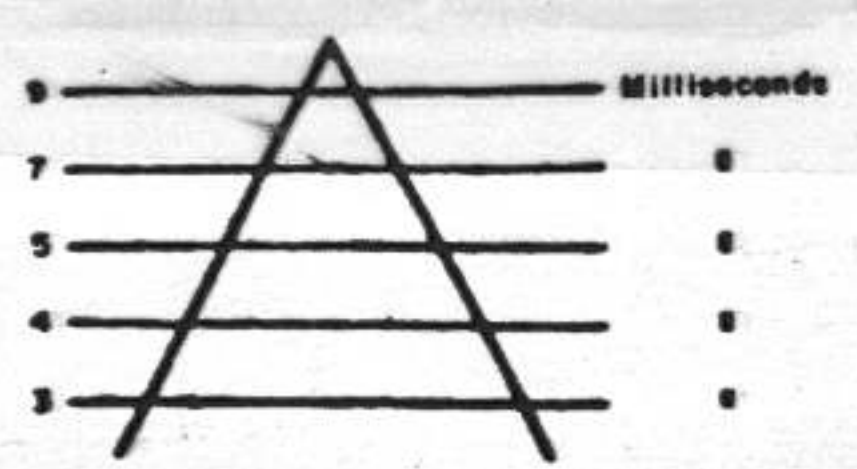

This reference scale bar has been added to the original image. It will scale at the same rate as the image, therefore it can be used as a reference for the original size.

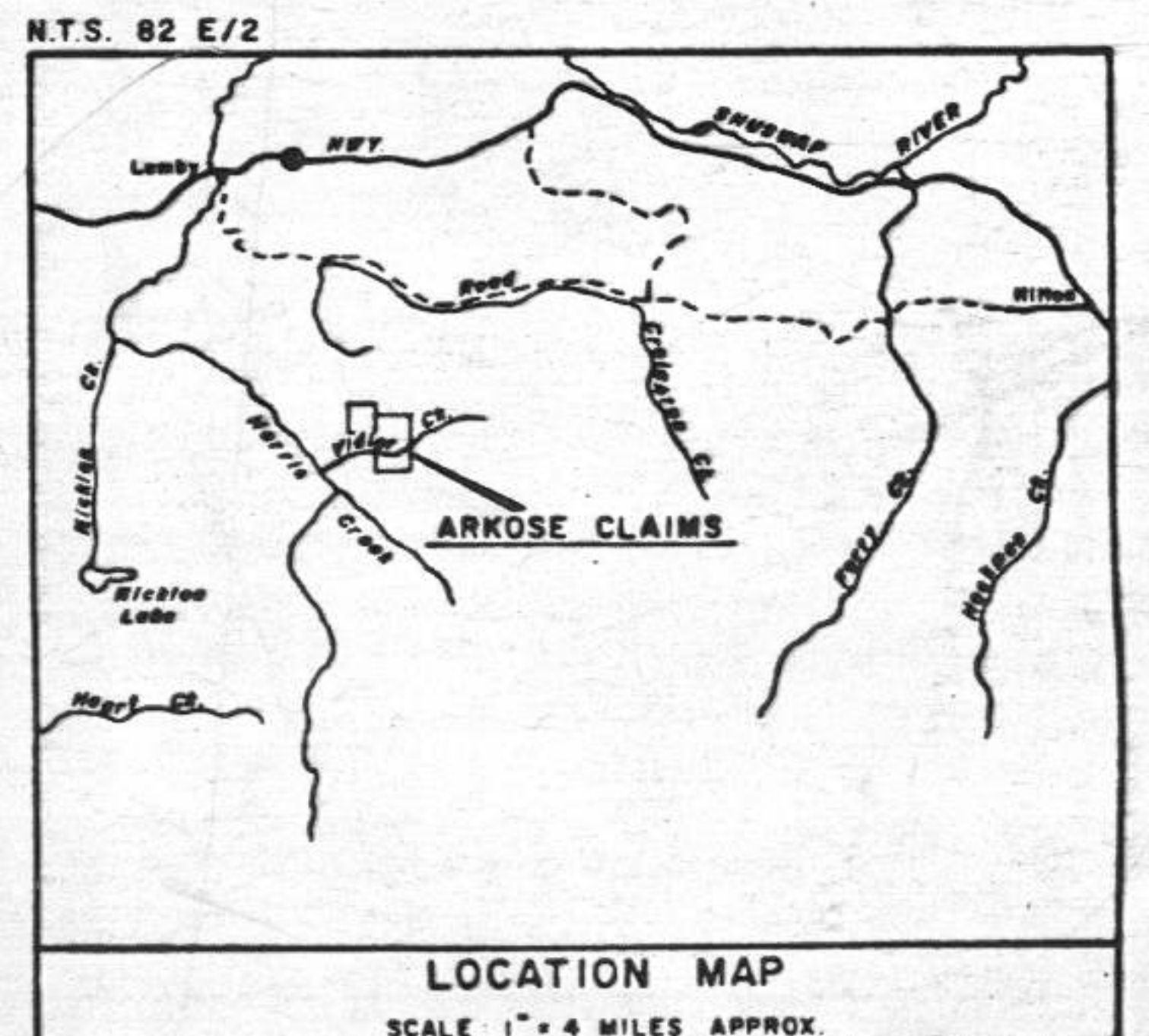

823700

**CHATHAM RESOURCES LTD.**  
 ARKOSE CLAIMS  
 VERNON MINING DIVISION - BRITISH COLUMBIA  
 GEOPHYSICAL MAP  
 INDUCED POLARIZATION  
 PERCENT CHARGEABILITY (Milliseconds)

*Glen E. White*  
 geophysical consulting  
 resources ltd.

INTERPRETED BY: G.E.W.  
 DRAWN BY:  
 CHECKED BY:  
 DATE: JULY 15, 1976  
 FIG. No.: 4

To Accompany Geophysical Report on  
 THE ARKOSE CLAIM GROUP  
 Date: September 10, 1976  
 By GLEN E. WHITE - G.S. Geophysicist