

823650

FEB 17 1994

Jesse Creek Copper MINNOVA

Rex E. Loesby, P.E.

19288 East Hickock Dr., Parker, CO 80134
Tel: (303) 840-7812 Fax: (303) 840-7816

February 15, 1994

Mr. Sam Nunnemaker
Minnova Inc.
740 Freepport Blvd., #101
Sparks, NV 89431

We reviewed & rejected
this propert ~ 3 years
ago. I see nothing new
to change our opinion.
No Av. potential

Dear Sam:

Enclosed is a Property Summary for the Jesse Creek Copper Project near Merritt, British Columbia. This is a large early stage exploration target with the potential to host Highland Valley type porphyry copper and precious metals ore bodies. It is in the same district as the now inactive Craigmont Copper Mine.

As usual, I have a finder agreement with the owner that calls for my fee to be paid by the owner. Please let me know if you would like to investigate this property. Thank you.

Sincerely,

Rex E. Loesby

Post-It™ brand

Fax Transmittal Memo

To Dave Heberlein
Company _____
Location _____
Fax # _____ Telephone # _____
Comments _____

7672 No. of Pages 6
From _____
Company _____
Location _____
Fax # _____
Original Disposition: Destroy Return Call for pickup
Today's Date 2/23 Time 2:30
Dept. Charge _____
Telephone # _____

Attach Document At Line _____

JESSE CREEK COPPER PROJECT

PROPERTY SUMMARY

Prepared by Rex E. Loesby, P. E.

January 1994

While the information contained in this Property Summary has been reviewed and is believed to accurately reflect the reports delivered to Mr. Loesby by the owners of the properties described herein and others, as well as information gathered in conversations with the owners of the properties described herein and others, Mr. Loesby expressly disclaims any and all liability for representations, expressed or implied, contained in, or omissions from, this report or any other written or oral communication transmitted to any interested party in the course of the reader's evaluation of the properties described herein. The reader should rely upon his or her own evaluation of the property and independently verify all of the information presented in this summary report before taking any action with respect to the properties.

NEITHER THIS DOCUMENT NOR ITS DELIVERY TO THE READER SHALL CONSTITUTE OR BE CONSTRUED TO BE AN OFFER TO SELL ANY OF THE SECURITIES OF ANY COMPANY. SUCH AN OFFER CAN ONLY BE MADE BY THE DELIVERY OF AN OFFERING MEMORANDUM BY SUCH COMPANY TO THE PROSPECTIVE INVESTOR.

For information, contact Rex E. Loesby at 1928 R. Hickock Dr., Parker, CO 80134, Tel: 303-840-7812, Fax: 303-840-7816

Property Description: Jesse Creek Copper Project, controlled by Conlon Copper Corporation of Vancouver, British Columbia, consists of 24 mineral claims (11,600 acres, 4700 hectares) located in the Nicola Mining Division, north and west of the town of Merritt, British Columbia. The property is characterized as a large early-stage exploration target with the potential to host Highland Valley type porphyry copper and precious metals ore bodies. The Craigmont Copper Mine is located a few kilometers northwest of the property.

Geology: A wide variety of deposit types are present around Merritt and over 200 mineral occurrences have been documented. Gold/silver bearing quartz veins, polymetallic veins with combinations of copper, lead, zinc, gold and silver, copper/iron skarns, all occur within the district. Much of the Jesse Creek Project area is underlain by Triassic, Nicola Group volcanics (western facies) with calcareous units and local diorite to monzonite intrusives. Good potential exists for Craigmont type Cu-Fe skarn deposits in this environment. The southern part of the property has a Tertiary cover of Princeton Group volcanics and volcanoclastics close to the intersection between the Guichon Creek and Coldwater Faults. An erosional window of Nicola volcanics occurs on the Jean and Paul claims. These rocks host the Copper Belle (Jean claims) and Anaconda showings.

The 1993 geologic work program conducted by Mr. R. C. Wells, a consulting geologist with Kamloops Geological Services, Ltd., involved fairly detailed mapping of a new "Jean" grid covering the northern part of the Nicola window. In this area, mafic Nicola flows and tuffs are intruded by northerly trending feldspar porphyry dikes and stocks. The geological environment is basically a roof zone with hornfelsed (magnetic) andesite to basalt flows and minor tuffs intruded by siliceous to potassic feldspar porphyries of unknown age. Patchy fracture controlled copper mineralization occurs in the hornfelsed volcanics and is associated with carbonate and specular hematite.

The locations of the main mineral occurrences on the property are shown on the attached Figure 5. Brief descriptions of previous exploration on each of these occurrences follows.

a) **Copper Belle (Jean Claim):** Shallow dipping veins and replacements of massive specular hematite, carbonate and blebby chalcopyrite yield narrow widths of one to six percent copper and anomalous silver. This mineralization appears to be related to an altered and copper mineralized feldspar porphyry sill. From 1908 to 1913, a number of hand sorted samples were shipped to the Trail and Tacoma smelters including 47 tons averaging 7.15% copper. Various limited geophysical and geochemical surveys were conducted between 1960 and 1985.

b) **Anaconda (Jean & Bob Claims):** A steeply dipping, northwest trending fracture zone hosts fairly massive specular hematite that locally yields gold values up to 1 gram gold per ton and anomalous copper. Workings in the area are dated pre-1915 with no later work recorded.

c) **Cinderella-Chase (Pete & Pete #2 Claims):** This northerly trending zone of limestone with associated copper skarn zones (local lead & zinc) is over 2 kilometers long. There has been substantial, though poorly documented trenching, stripping, and drilling in a number of areas. Three shallow pits of unknown age occur at the Cinderella copper, lead, & zinc occurrence. Major exploration programs were conducted on the Cinderella-Chase zone by Peele Resources in 1964 and Nippon Mining Corporation in 1965. Peele's program included trenching, soils, magnetic, geological mapping, and a single drill hole. Nippon conducted significant trenching and 12 drill holes. There is very little

available information on these programs and some doubt exists about how many of these holes were actually completed. In 1976, Quintana Minerals completed an exploration program over the entire zone and adjacent areas. In 1979, H. Allen completed a 500 foot hole at the northern end of the Chase zone with disappointing results. A limited number of grab samples were taken from the trenches in the summer of 1992 by Conlon. These samples yield copper values in the 0.2% to 0.75% range.

d) Mike Claims (QZ #2 and QZ #3 Claims): There has been significant trenching in this area exposing a number of copper/iron skarn showings. There is also evidence of a single drill hole. None of the results of this work is available. However, it is possible this work was follow-up to a 1970 magnetic survey by Silver Key Exploration, Ltd.

e) Pumpkin/Val Area (QZ #2, Pete #2, Pete #4 Claims): This area lies between and to the north of the Mike and Cinderella occurrences. A number of old trenches and copper showings occur in this area. Quintana's magnetic survey in 1976 covered much of this but did not extend as far west as the western copper showings. Previous to Quintana, Newvan Resources Ltd. (1972) is reported to have conducted a 17,000 foot trenching program with a total of 1650 feet of drilling in eleven holes on the old Val #5 and #6 claims. Again there is very little available data on this program. Traverses in the area indicate that much of the drilling and trenching occurred along the main northeast magnetic trend on the QZ #2, Pete #2, and Pete #4 claims. As a result of limited work in 1992, Conlon's consulting geologist concluded that the Val 5 and 6 areas had the potential for diorite related copper porphyry mineralization and recommended line cutting, magnetometer and geochemical surveys. Over 16 kilometers of lines were cut over these areas followed by a magnetometer survey. A number of north trending magnetic anomalies were outlined. These correlate with the main anomalies outlined by Quintana's magnetic survey in 1976. Limited ground follow up in 1993 indicated that most of the larger anomalies can be explained by magnetic Nicola andesite and basalt flows. Copper mineralization is associated with fracture zones and small diorite to monzonite intrusions.

History: The Nicola Mining Division has an exploration history dating back to the 1880's. The Craigmont Mine, discovered in 1957, became the single major producer in the Merritt area in 1961. Between 1957 and 1982, it produced a total of 29.3 million tonnes of ore averaging 1.4% copper from surface and underground workings.

The Jesse Creek Project area has a history of copper exploration dating back to the early 1900's. Over thirty exploration and small development programs have been documented on the property. Details on the larger programs by Peele Resources/Nippon (1964-1965), Newvan Resources Ltd. (1972), and Quintana Minerals (1976), are sparse, especially on the location and results from drilling and trenching.

Until recently the claims were held by a number of different individuals and companies. In 1993, Conlon was successful in consolidating all of the holdings into one corporate entity. During the summer of 1993, a limited geologic study of the property was undertaken by Mr. R. C. Wells, a consulting geologist for Kamloops Geological Services, Ltd. Most of the information shown in this report was taken from Mr. Wells report.

Ownership: Conlon Copper Corporation owns 100 percent of the Jesse Creek claims subject to an NSR royalty of 2 percent.

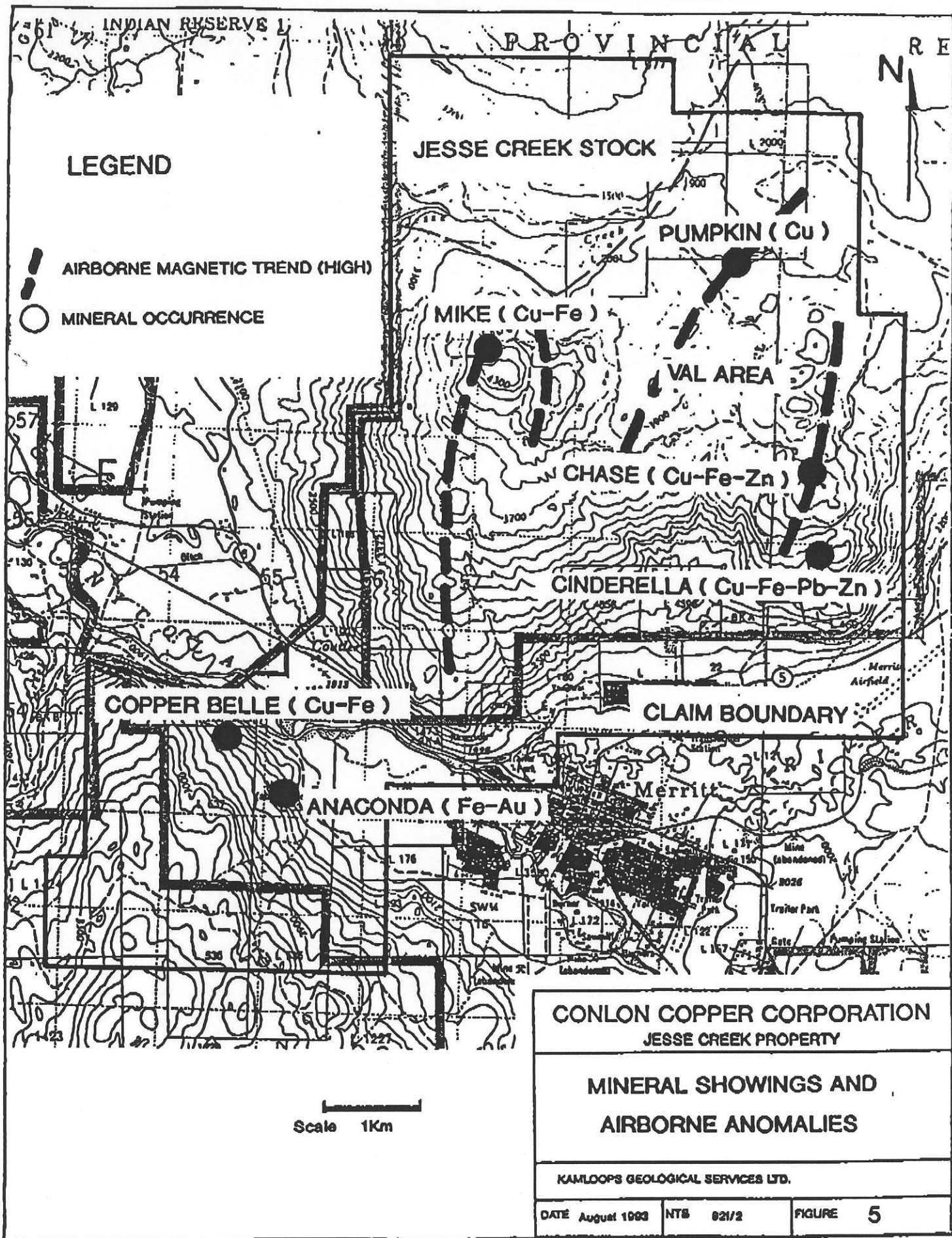

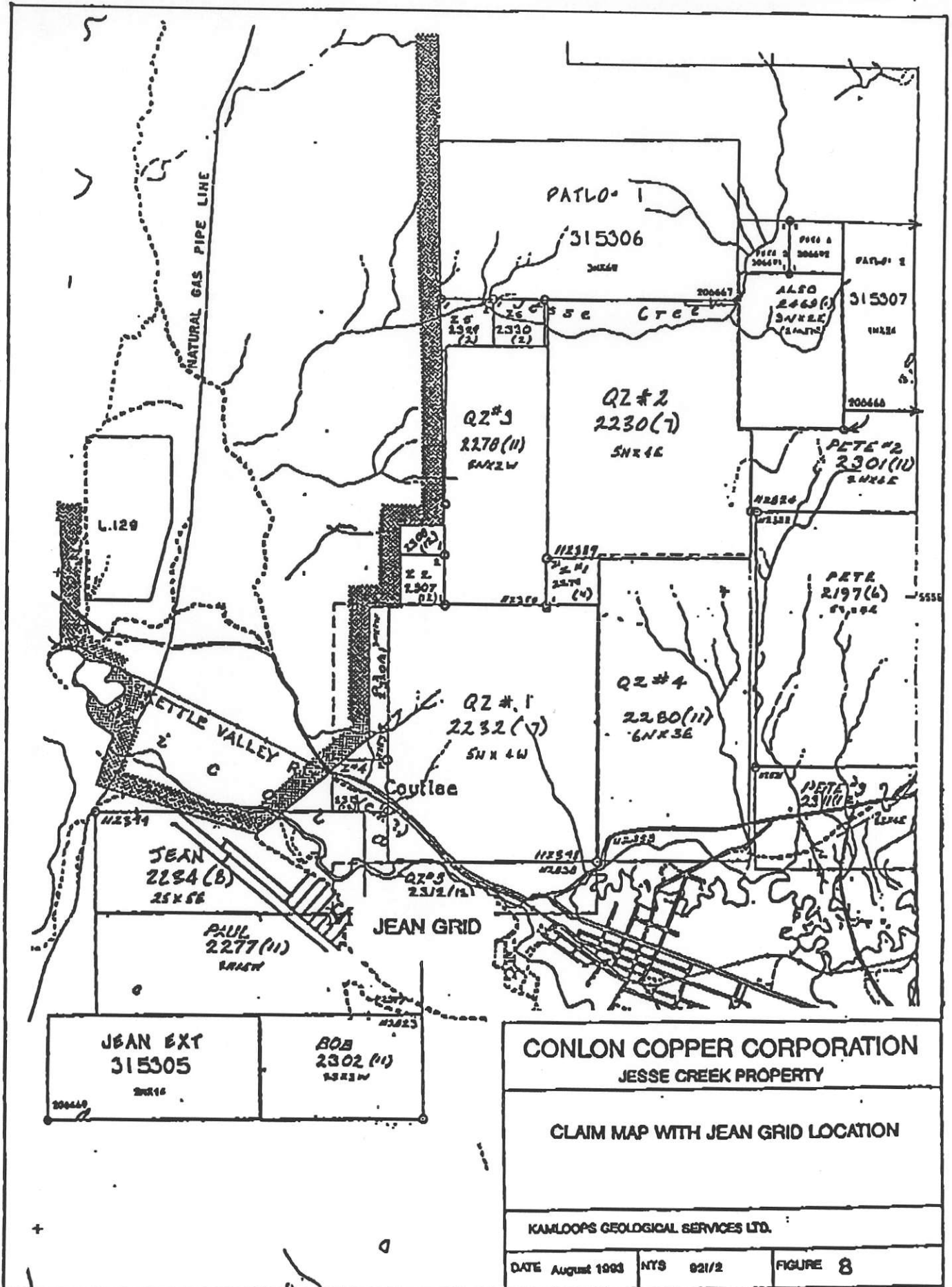

CONLON COPPER CORPORATION
JESSE CREEK PROPERTY

CLAIM MAP WITH JEAN GRID LOCATION

KAMLOOPS GEOLOGICAL SERVICES LTD.

DATE August 1993 NYS 921/2 FIGURE 8