

M82E/4I

SEE MAP 82E/4W

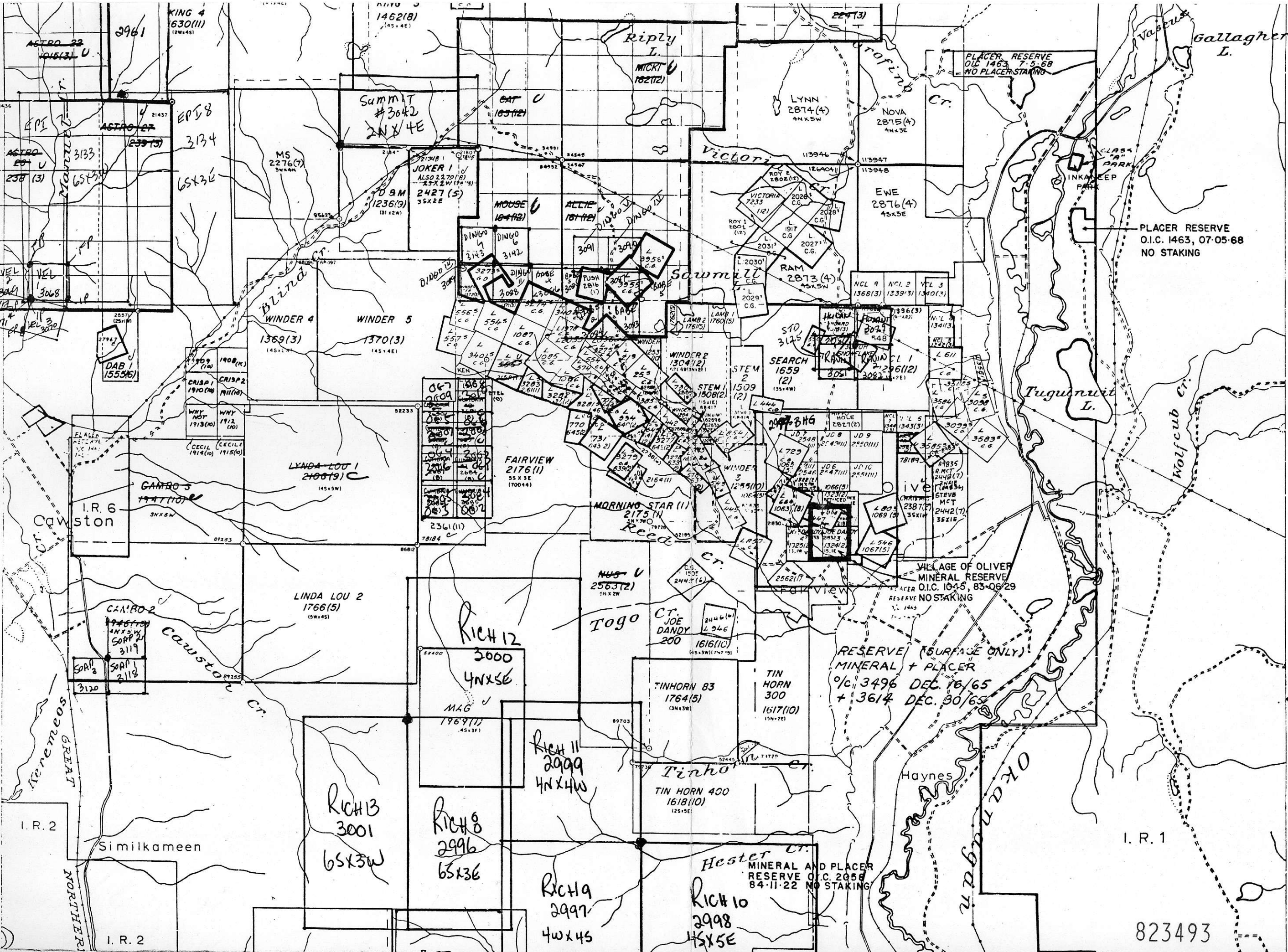

PLACER RESERVE
O.I.C. 1463, 07-05-68
NO STAKING

VILLAGE OF OLIVER
MINERAL RESERVE
O.I.C. 1045, 83-06-29
RESERVE NO STAKING

RESERVE (SURFACE ONLY)
MINERAL + PLACER
%C. 3496 DEC. 16/65
+ 3614 DEC. 30/65

Hester Cr.
MINERAL AND PLACER
RESERVE O.I.C. 2058
84-11-22 NO STAKING

MAP 82E/3

LEGEND
CROWN GRANT
FORFEITED /
VERIFIED LEG.
LEGAL SURV.
LEGAL CORN

823493

TOWEST

Province of British Columbia
Ministry of Energy, Mines and Petroleum Resources

MINERAL CLAIM
MINERAL CLAIM
CORNER POST
POST & TAG NUMBER 8803

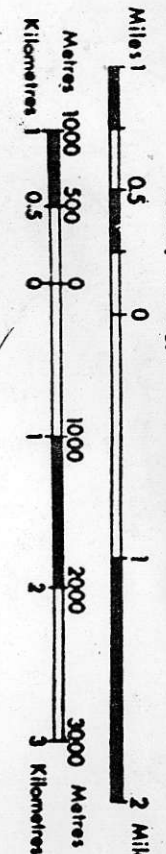

UNLESS VERIFIED OR SURVEYED, THE MAP POSITION OF A
LEGAL CORNER POST IS BASED ON THE LOCATOR'S SKETCH.
FOR FURTHER INFORMATION, APPLY TO THE OFFICE OF THE
MINING DIVISION CONCERNED.
DATE OF MICROFILM: 88.06.30

