

823254

PROPERTY NAME: WILD ROSE

NTS:82E/2W

OWNER: Jeffrey Ciachurski  
 Brenna Resources Ltd.  
 601-626 W Pender St.  
 Vancouver, B.C.  
 685-4170  
 (under option from K. Schindler)

LAT:49 04  
 LONG:118 43

CLAIMS:

Wild Rose Fr (L 1387)	Rec. No. 2447	
Gold Bed (L 1388)	Rec. No. 2448	
Golconda Fr (L 2149)	Rec. No. 552	
Cleveland (L 2150)	Rec. No. 553	
Ace	Rec. No. 558	1-unit
Bell	Rec. No. 557	1-unit
Bitt	Rec. NO. 5037	4-units
Bud Fr	Rec. No. 5036	1-unit

LOCATION AND ACCESS:

The Wild Rose property is located about 4 kilometres southwest of Greenwood. Access to the property is via the Motherlode road from Greenwood, or via the Boltz farm road which leaves the highway at the salt shed near Boundary Falls. The main shaft is located on the west (uphill) side of the road at about the 4 kilometre point. The trenches are located on the west side of the road, about 1 kilometre further along the road.

SUMMARY OF FIELD VISIT:

The Wild Rose property adjoins the Rainbow-Tam O'Shanter claims to the east, situated between the Deadwood and Greyhound faults, near the headwaters of Haas Creek. The claims are underlain by cherts and greenstones of the Permian Knob Hill Group, with minor amounts of chert pebble conglomerate, probably also Permian in age. Numerous old workings expose a narrow massive pyrite-pyrrhotite vein within strongly altered cherts and greenstones. Where seen on surface, the vein trended 145 /70 NE, and averaged about 1 metre in width. Although grades up to 0.78 oz/t Au and oz/t Ag are reported from the vein, the samples collected during the property exam were much lower than this, as detailed below. Recent soil sampling outlined a moderate-strong, well defined, Au-As anomaly, trending along the vein (onto the Rainbow-Tam O'Shanter property). Twelve short diamond drill holes (totalling 521 metres) were drilled in 1986; an additional 10 holes (546 metres) were drilled in 1987 to test the vein both along strike and down dip from the trenches. Where intersected by drilling, the vein averaged about 1 metre in true width and graded about 0.2 oz/t Au.

SAMPLE DESCRIPTIONS AND RESULTS:

SampleNumber	Description	Ag ppm	As ppm	Cu ppm	Au ppb
BCS18476	-mass py/po vein	4.9	3427	756	1040
BCS18477	-mass py/po vein	9.0	386	1696	610
BCS18478	-alt'd cherty gst	1.1	204	156	40
BCS18479	-alt'd cherty gst	4.0	126	184	110
BCS18480	-chert pebble conglom	0.6	44	1060	5

RECOMMENDATIONS:

Mineralization on the Wild Rose property is restricted to a narrow vein of massive pyrite-pyrrhotite. There are no significant gold values in altered wall rock adjacent to the vein. Because of the narrow size and low grade of the system, further work is not recommended.

REFERENCES:

Paxton, J., 1986. the 1986 Wild Rose Exploration Program. Private report for Wild Rose Resources, by Petralith Services Ltd.

Di Spirito, F. and W. Lumley, 1988. Wild Rose Resources Ltd. Report on the Wild Rose Claim Group. Private report by Strato Geological Engineering Ltd.



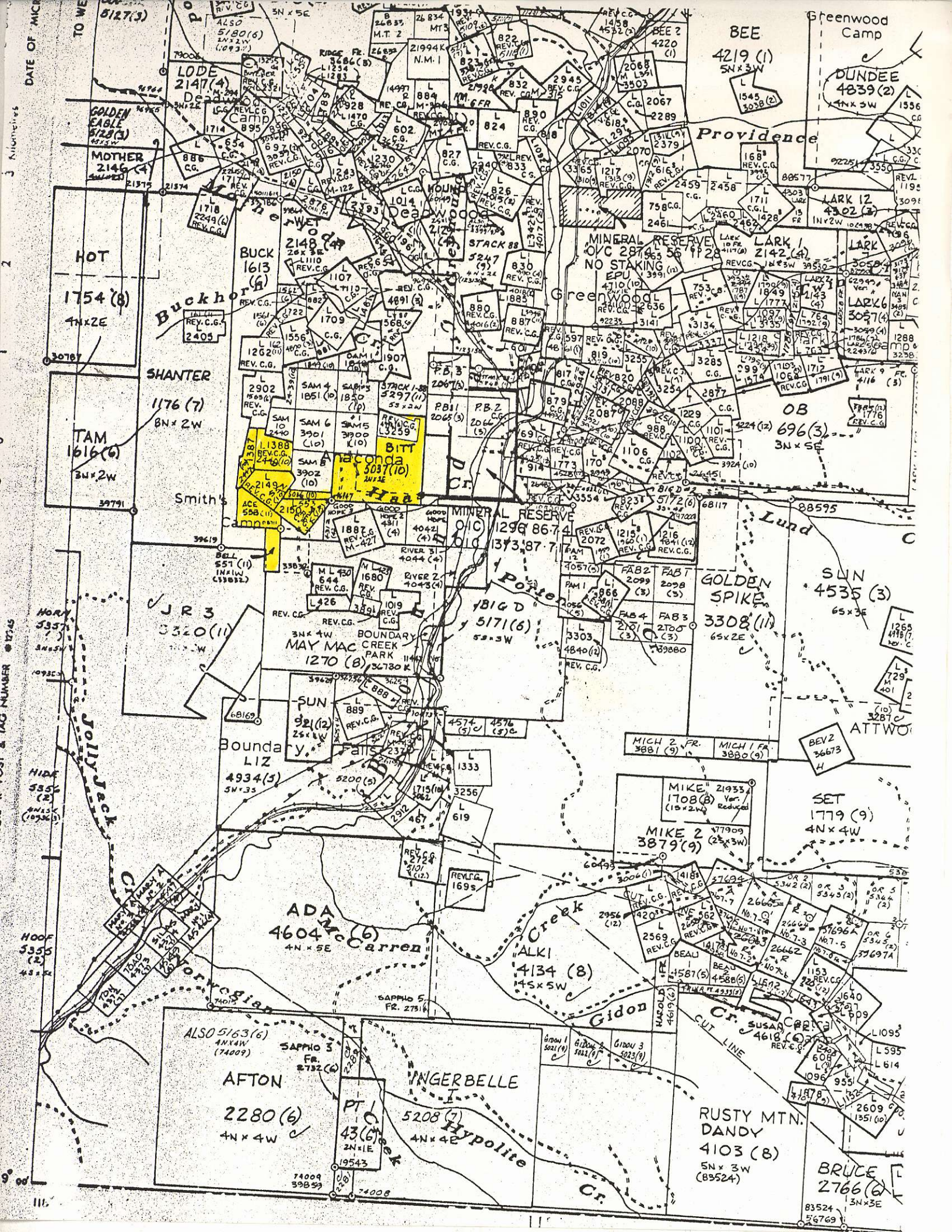

DATE OF MAP  
TO WE

Kilometres  
0  
1  
2  
3  
4  
5  
6  
7  
8  
9  
10

HOOF 5355 (2)  
HIDE 5356 (2)  
HOOF 5355 (2)

