

p-6
 $\frac{58' \times 7'}{11} = 36.9' / \text{H of Length on Cl. ike}$

BLOCK 6
 SECTION 18+15N

* This Block⁽⁶⁾ extends to Block(4)

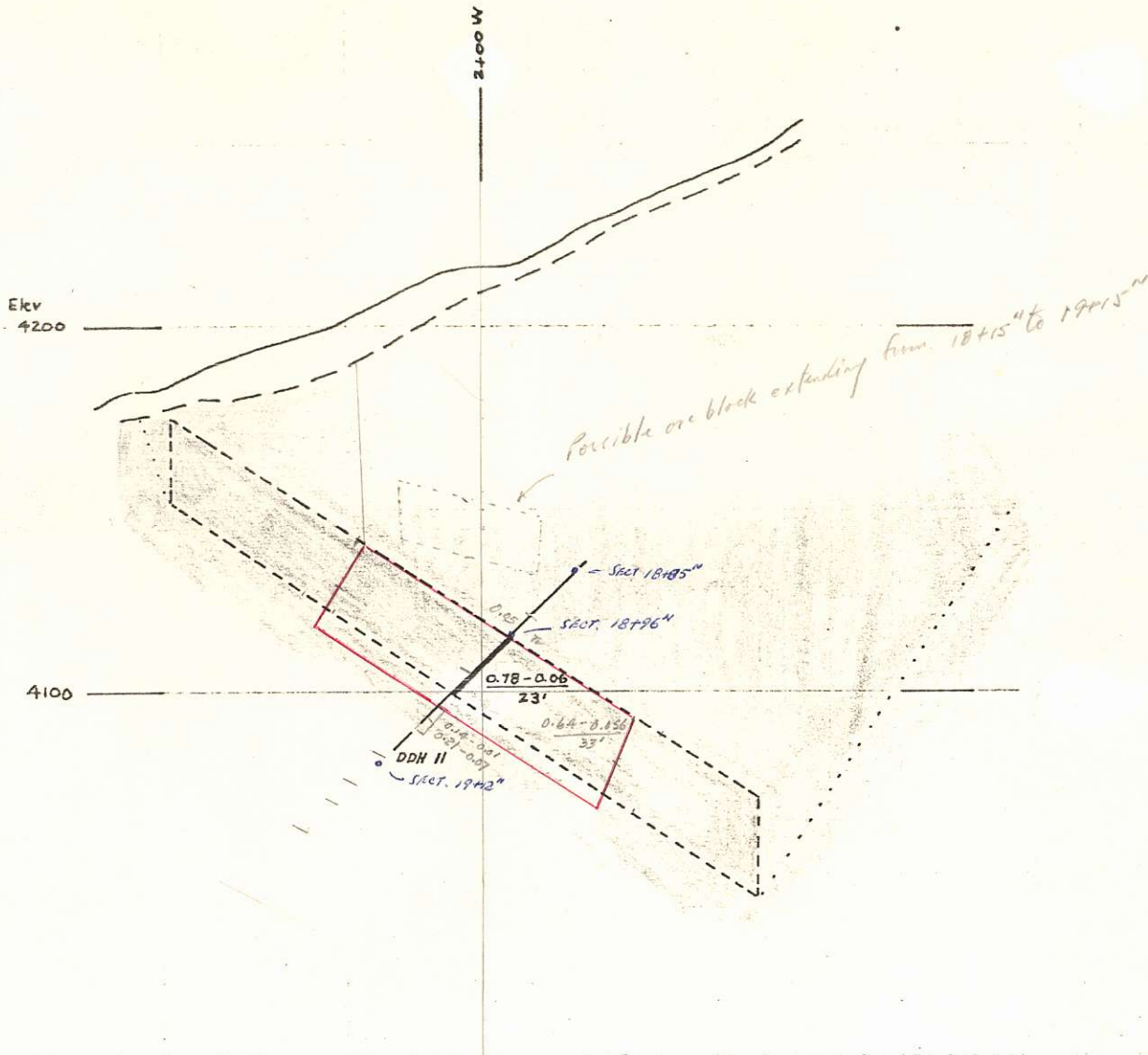

Base Line

DDH-11

$$\frac{91' \times 26}{11} = 215' / \text{ft of L on Strike.}$$

0.64 cu, 0.156 cu.

BLOCK 5
SECTION 18+85 N

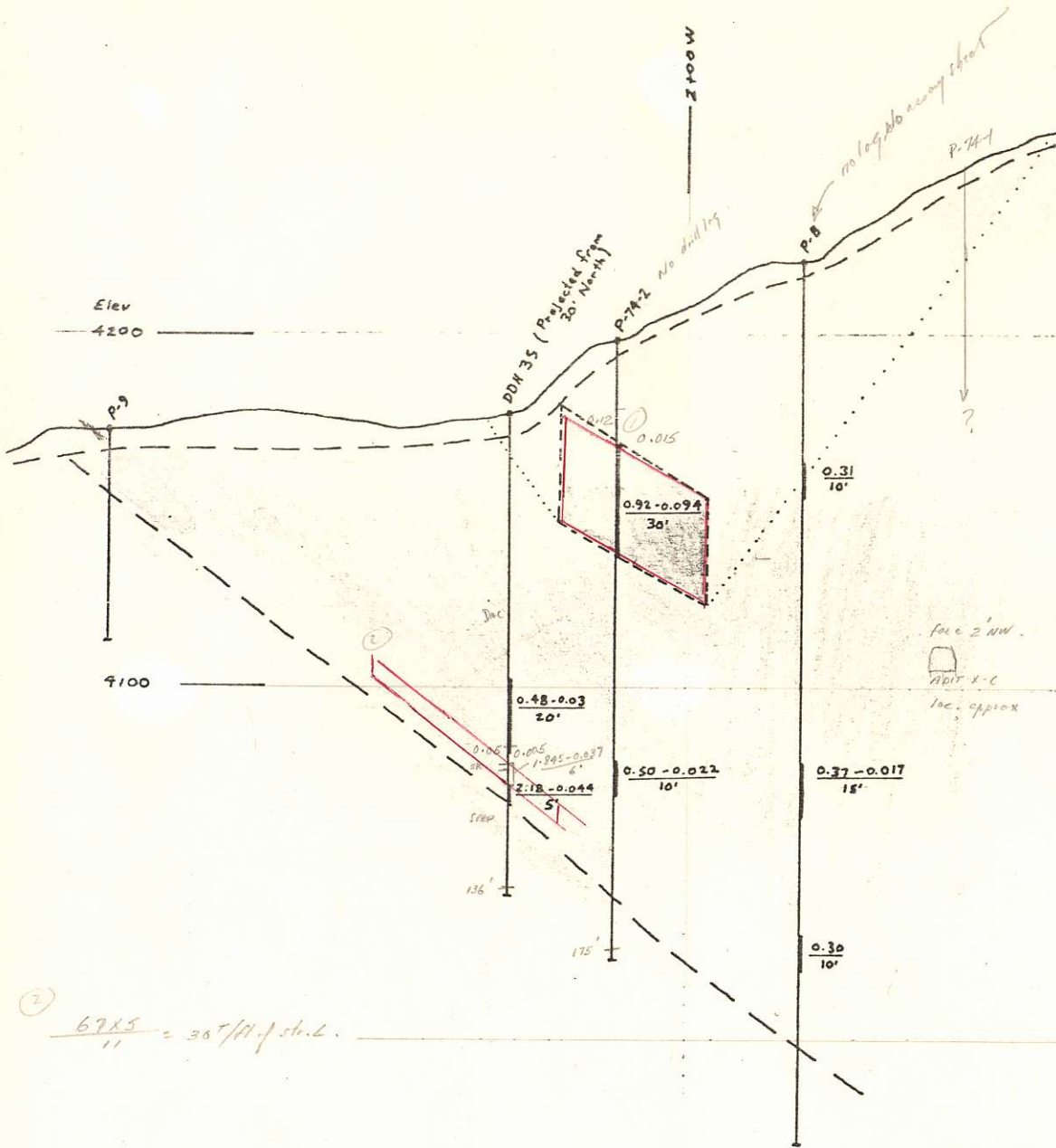

① $\frac{47 \times 26}{11} = 111 \frac{1}{4}$ ft of Str.
from Sect 18+15 → 19+26"

③ from Sect. 19+26" → 19+44"
 $\frac{1}{11} \left[\frac{35128}{2} \left(\frac{26+9}{2} \right) \right] = \frac{1}{11} [31.5 \times 17.5]$
 $= 50 \frac{1}{4}$ ft of L.

② $\frac{6785}{11} = 30 \frac{1}{4}$ ft of sb. L.

BLOCK 4
SECTION 19+15 N

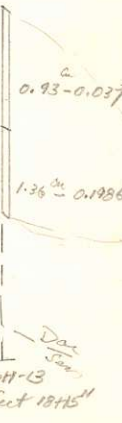

No log, No Arroyo

from Sect 19+44" → 20+00"

VAPER BAND
 $\frac{20 \times 9}{11} = 16 \frac{1}{11}$ ft of L
 $\frac{0.39 + 0.35}{2} = 0.37$ Cu
 $\frac{0.043 + 0.01}{2} = 0.026$ Au

Elev 4200

200W

P-74-8 SECTION 19+75W

DDH 1, 28, 29

$\frac{0.37}{5'}$
 $\frac{0.30}{5'}$
 $\frac{0.50}{5'}$

$\frac{0.32 - 0.024}{64'}$
 $\frac{0.37 - 0.083}{64'}$
 $\frac{0.61 - 0.02}{64'}$

$\frac{0.54 - 0.015}{4'}$

$\frac{0.42 - 0.003}{10'}$

$\frac{0.22 - 0.01}{90'}$

$\frac{0.30 - Tr}{30'}$

4100

LOWER BAND

$\frac{60 \times 12}{11} = 65 \frac{1}{11}$ ft of sm.l.L.

DDH 1

$\frac{0.21 - 0.014}{20'}$
 $\frac{0.19 - 0.02}{20'}$

$\sqrt{449.39'}$
 $14.287.37$

DDH 28

DDH 29

BLOCK 3
SECTION 19+90N

2A
D/C
L
1157.10

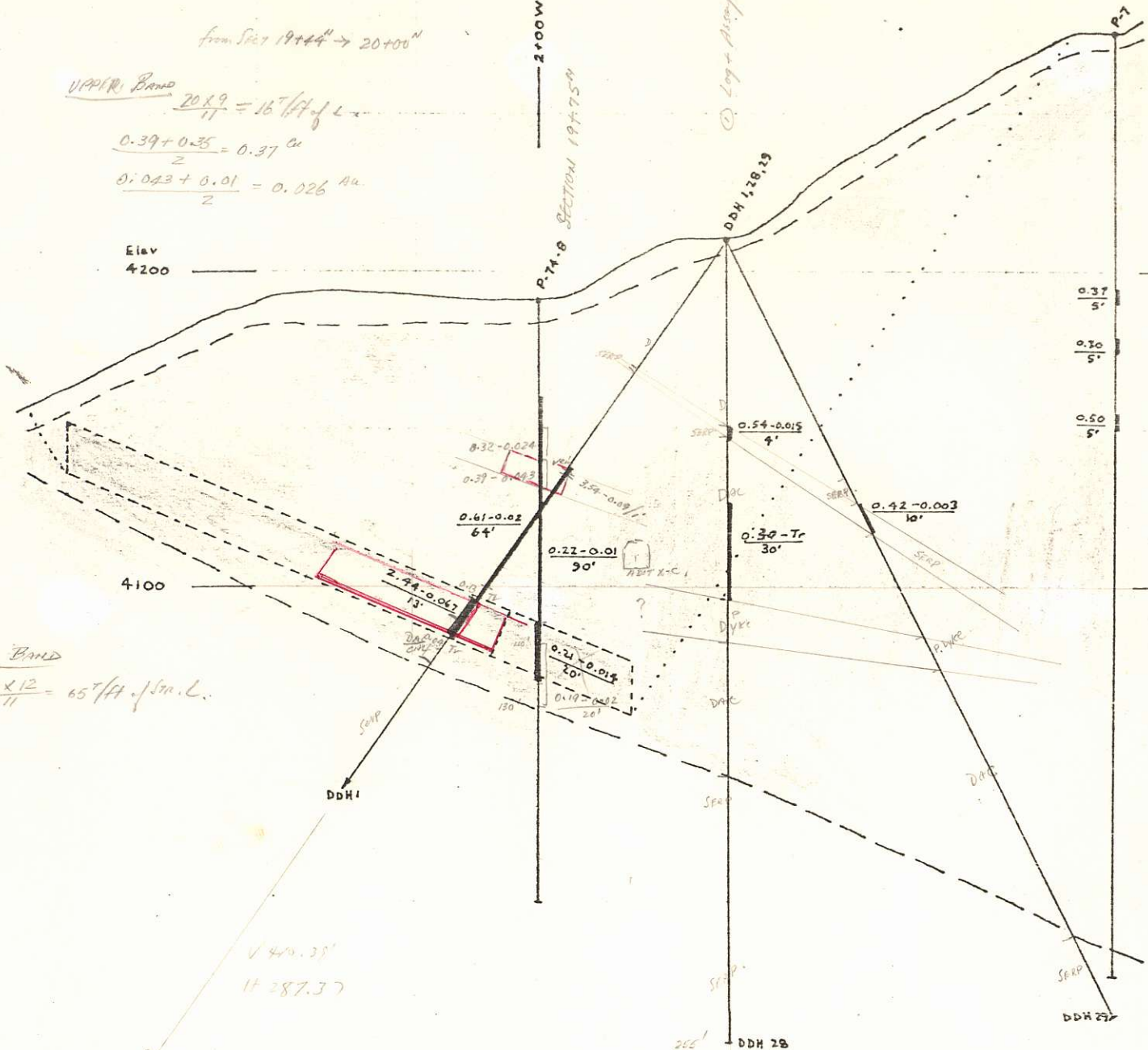

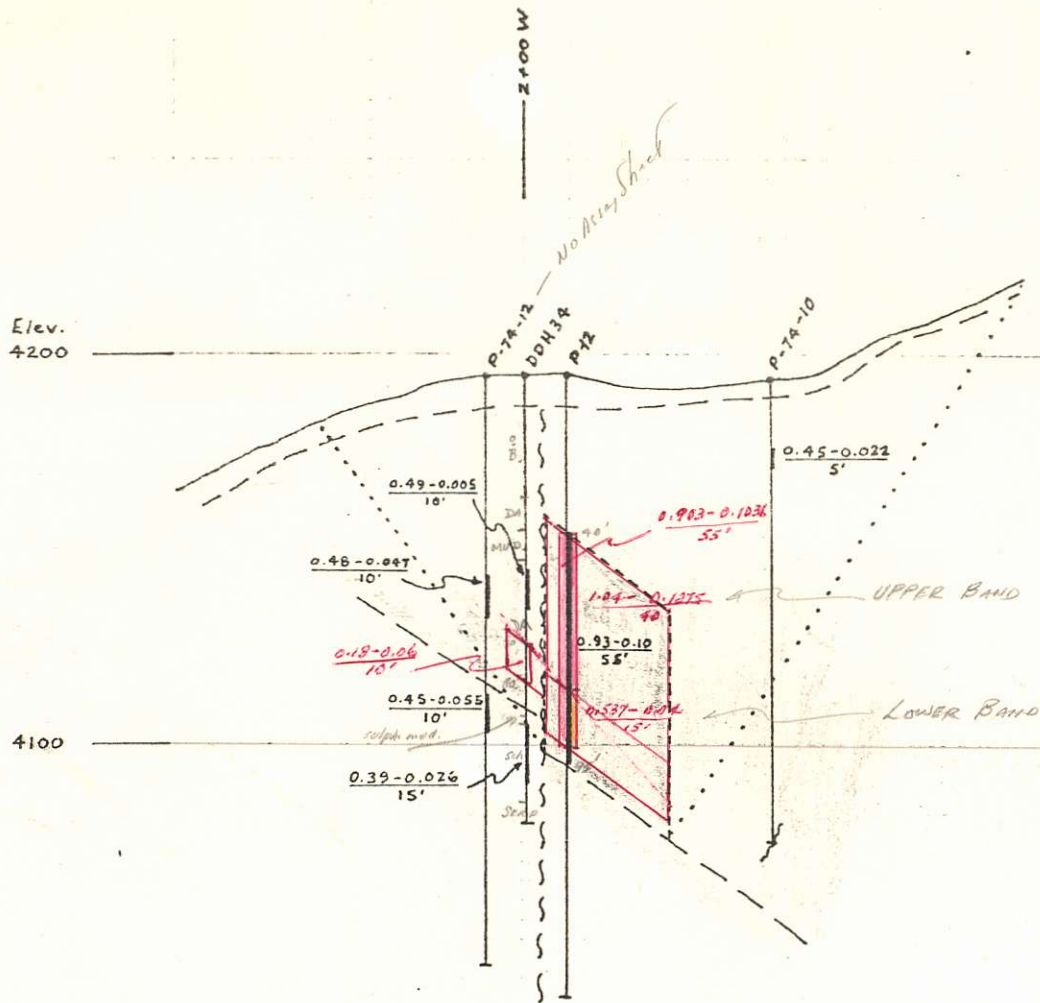

UPPER BAND

$$\frac{(55+43+33+13) \times 9}{4} = 100 \text{ T/H. of } \text{Ar.}$$

LOWER BAND

$$\frac{(55+43+33+13) \times 12}{4} = 39 \text{ T/H. of } \text{L.}$$

BLOCK I
SECTION 20+75 N

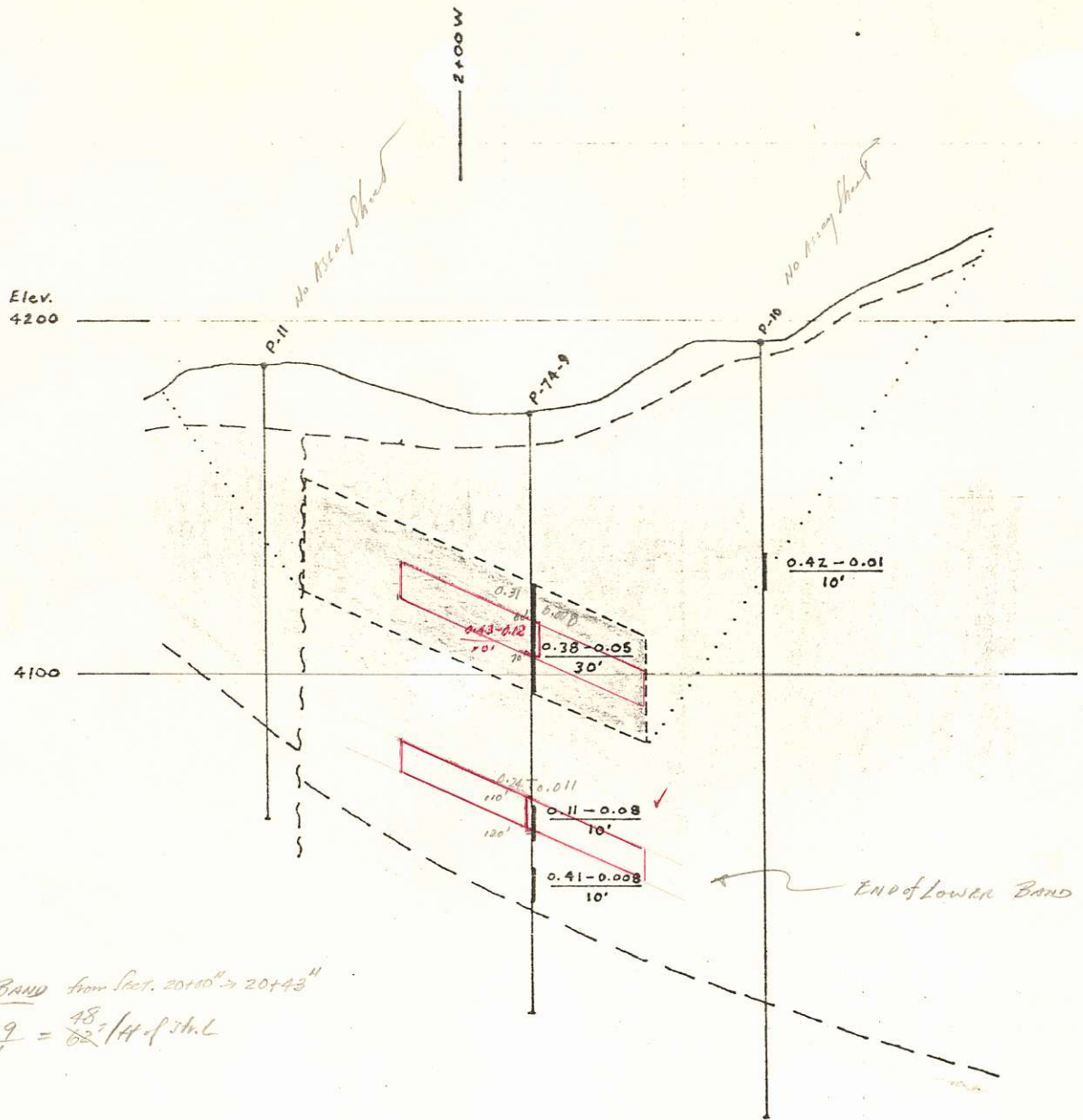

UPPER BAND from Sect. 20+10" to 20+43"
 $\frac{1}{4}(42+65+54+70) \times 9 = \frac{48}{82} \text{ ft. of Str. L.}$

LOWER BAND
 $\frac{48}{82} \text{ ft. of Str. L.}$

BLOCK 2
 SECTION 20+15N