

KENIA 7 CLAIM
 DDH KK 81-1
 Section Looking S50E
 1:1000 AUG. 13, 1981
 HmJ

823115

1500-
1700
25

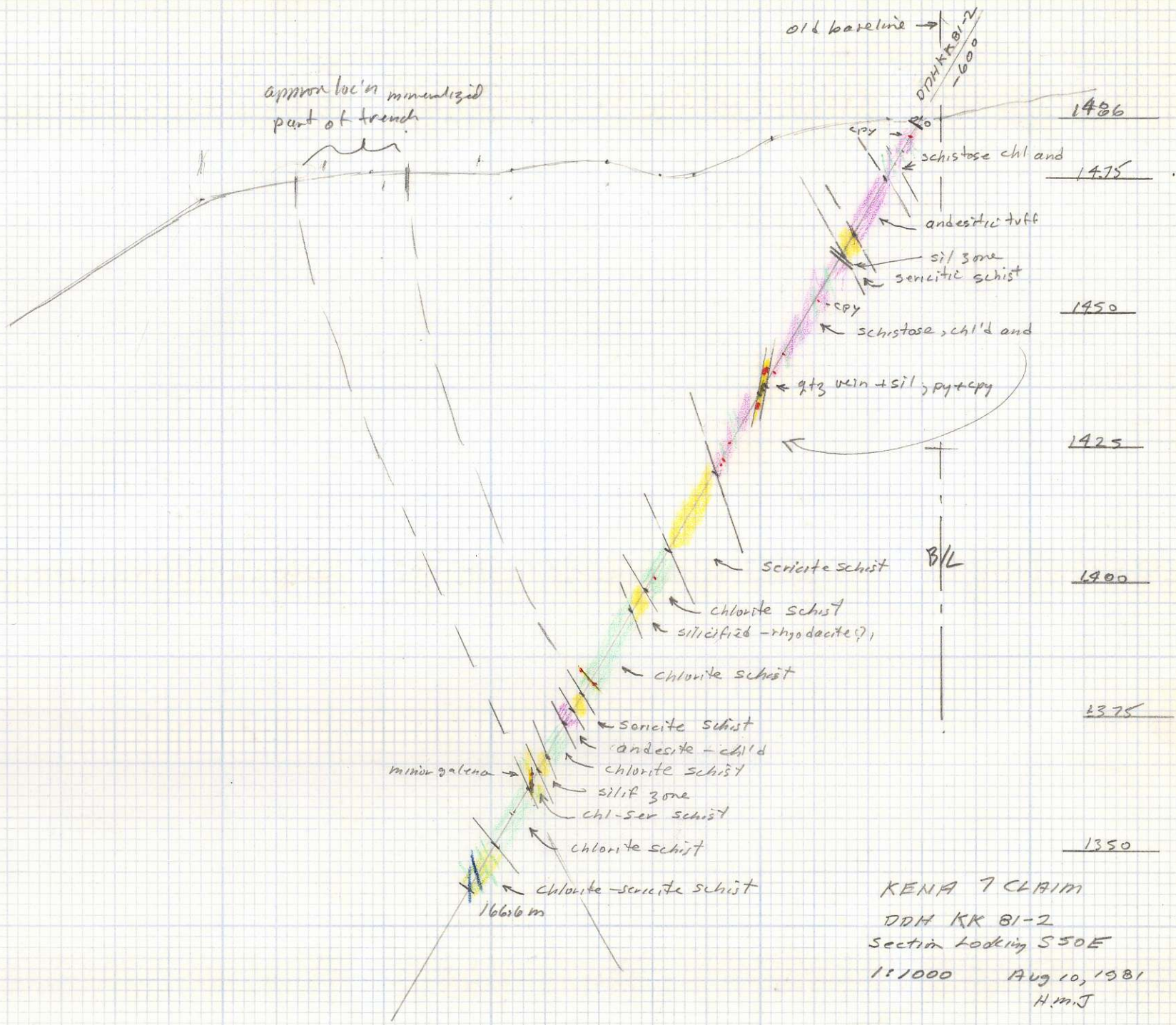

Note - drilled at proposed 81-3 site

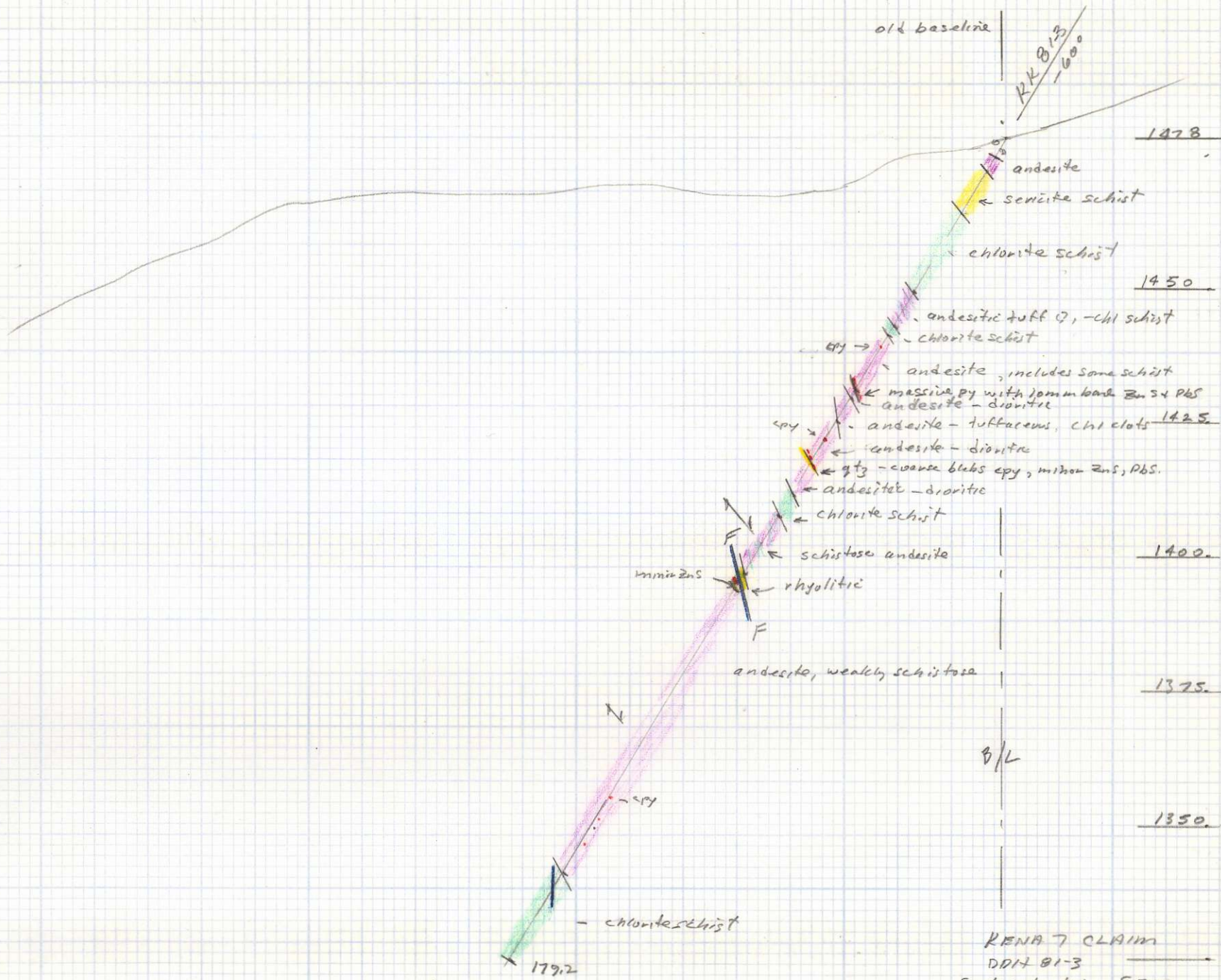

KENA 7 CLAIM
 DDIT 81-3
 Section Looking S50E
 1:1000
 H.M.J.
 Aug 13/81

note - drilled at proposed 81-2 site

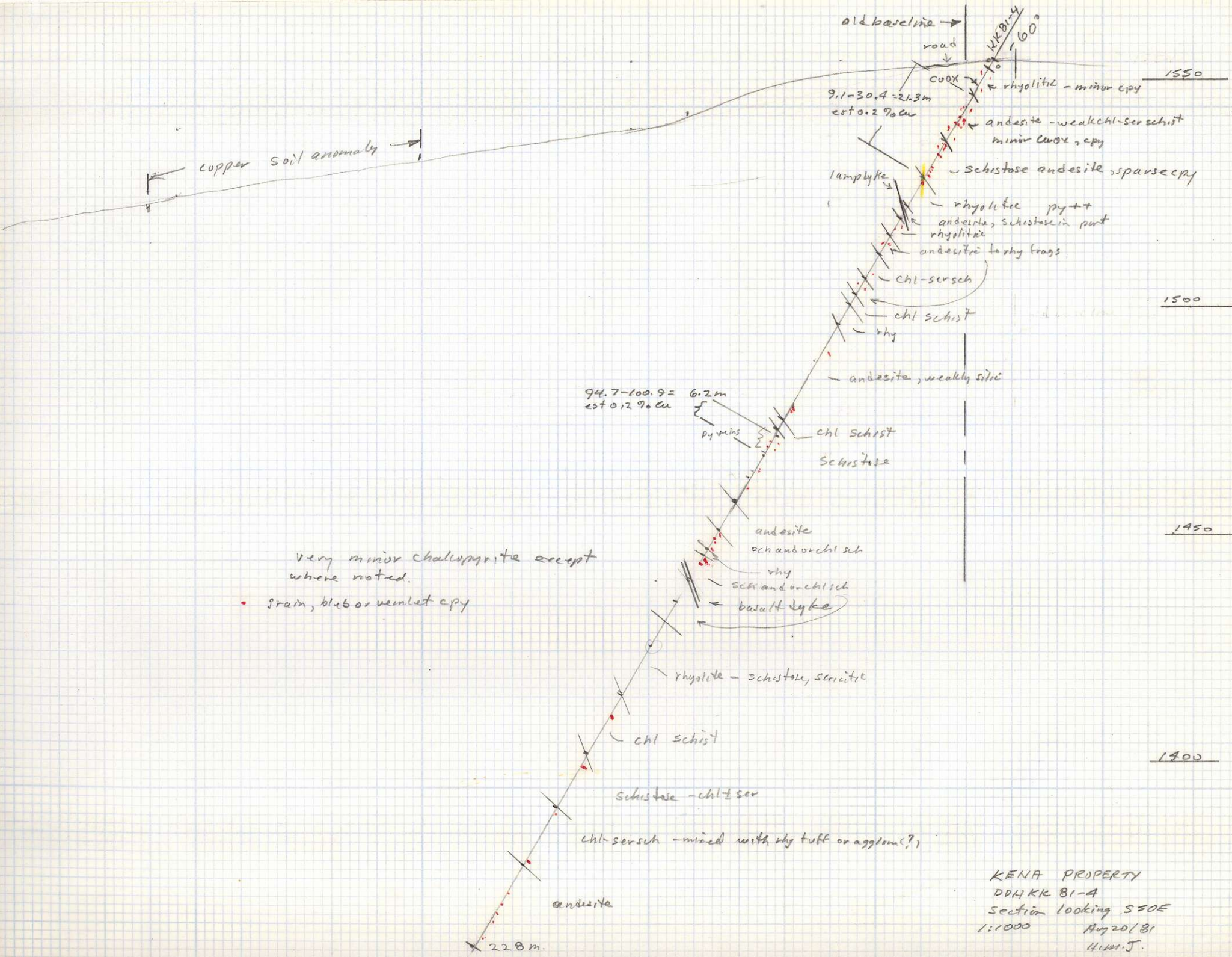

copper soil anomaly →

very minor chalcopyrite except
where noted.

- grain, bleb or veinlet epy

KENA PROPERTY
DDH KK 81-4
Section looking S50E
1:1000 Aug 20/81
H.M.J.

old grid → 9+025

KK 81-5
-910

casing

coarse blebs cpy
andesite
qtz-cal vein
-andesite

1 amphibole dyke

andesite
sericite schist
chl-talc schist
sericite schist

rhyolite
andesite
rhyolitic
andesite

dioritic schist

andesite

copper soil anomaly

very minor cpy throughout entire hole
• grain, blob or veinlet cpy

239

chl sch.

255.4

sericite schist

chl schist

chl-ser schist

239

KENA PROPERTY
DDH KK 81-5
Section looking S50E
1:1000 Aug 23, 1981
H.M.J

253

B-4335 (old grid)

KK 81-6
-51°

2018-2721 = 6.3m
est 0.29Cu

road

1539

Copper soil anomaly

1525

Very minor chalcopyrite
as small grains + blebs, no
concentrations

andesite
andesite - dioritic
fragmental
- chl. schist

1500

andesite
- vein

- rhyolite tuff

malachite fr

1475

speck
COOX

- andesite - epidotized

fine cpy
veinlet

andesite

1450

course cpy

andesite

andesite

1425

Very minor chalcopyrite except
where noted

• grain, blob or veinlet cpy

cpy

151.8 m ?

1400

approx loc'n adpt

KENA PROPERTY
DDH KK 81-6
Section looking S50E
1:1000 Aug 23/81
HmJ

5050
175
4875

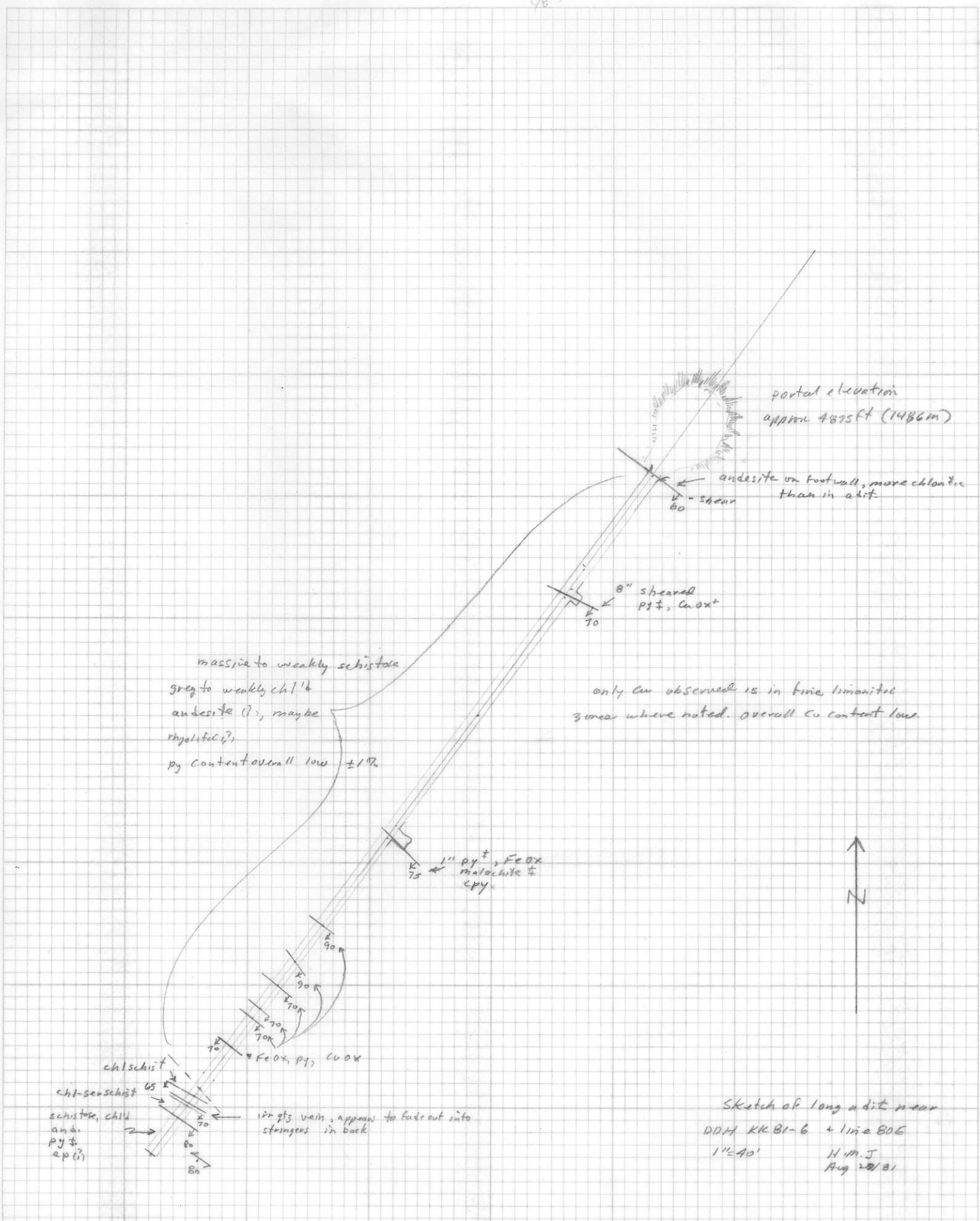

massive to weakly schistose
grey to weakly chl'd
andesite (?), maybe
rhyolitic?
py content overall low ±1%

only Cu observed is in fine limonitic
zone where noted. overall Cu content low

1" py[±], FeOx
malachite to
cpy.

FeOx, py, CuOx

chl schist
chl-sens schist
schistose, chl'd
and
py[±]
ep(?)

ir gtz vein, appears to fade out into
stringers in back

Sketch of long adit near
DDA KK 81-6 + line 806
1"=40'
H.M.J.
Aug 28/01

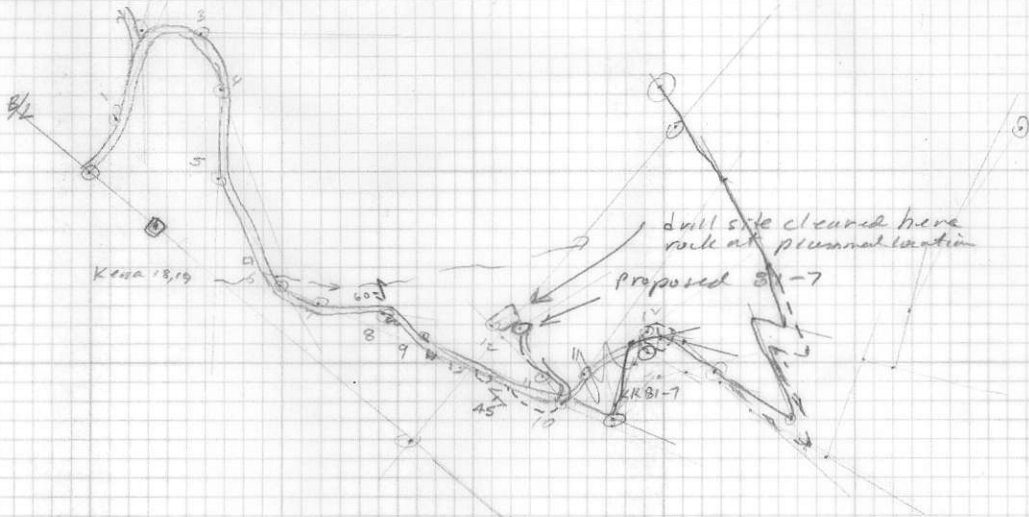

Survey to 81-7
 1:5000 Aug 28/81



Major
N 410
N 300
S 300

CV S30E
chl sch N 30W/50
N 60W/40
S 30W chl sch

SKP = siluric porphyry

Sheet 1
Kann Claims
115000 Sept 4/81

