

NORTHWOOD PULP & TIMBER LTD.

T.S.L. A08588 VAMA VAMA BLOCK

PURDEN C.P. A 3RD. BAND

AREA TECHNICIANS: B vonBliker & C Spicer REVISIONS: Feb 7 1982

UNIT 4	190 Acres	8500 Cunits
UNIT 5	154 "	6300 "
UNIT 6	140 "	5900 "
UNIT 7	145 "	6300 "
UNIT 8	180 "	7900 "

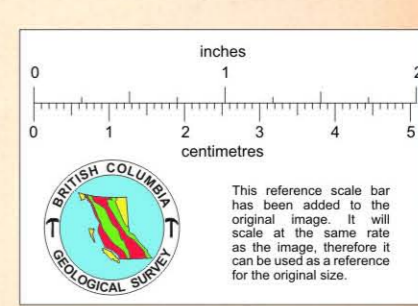
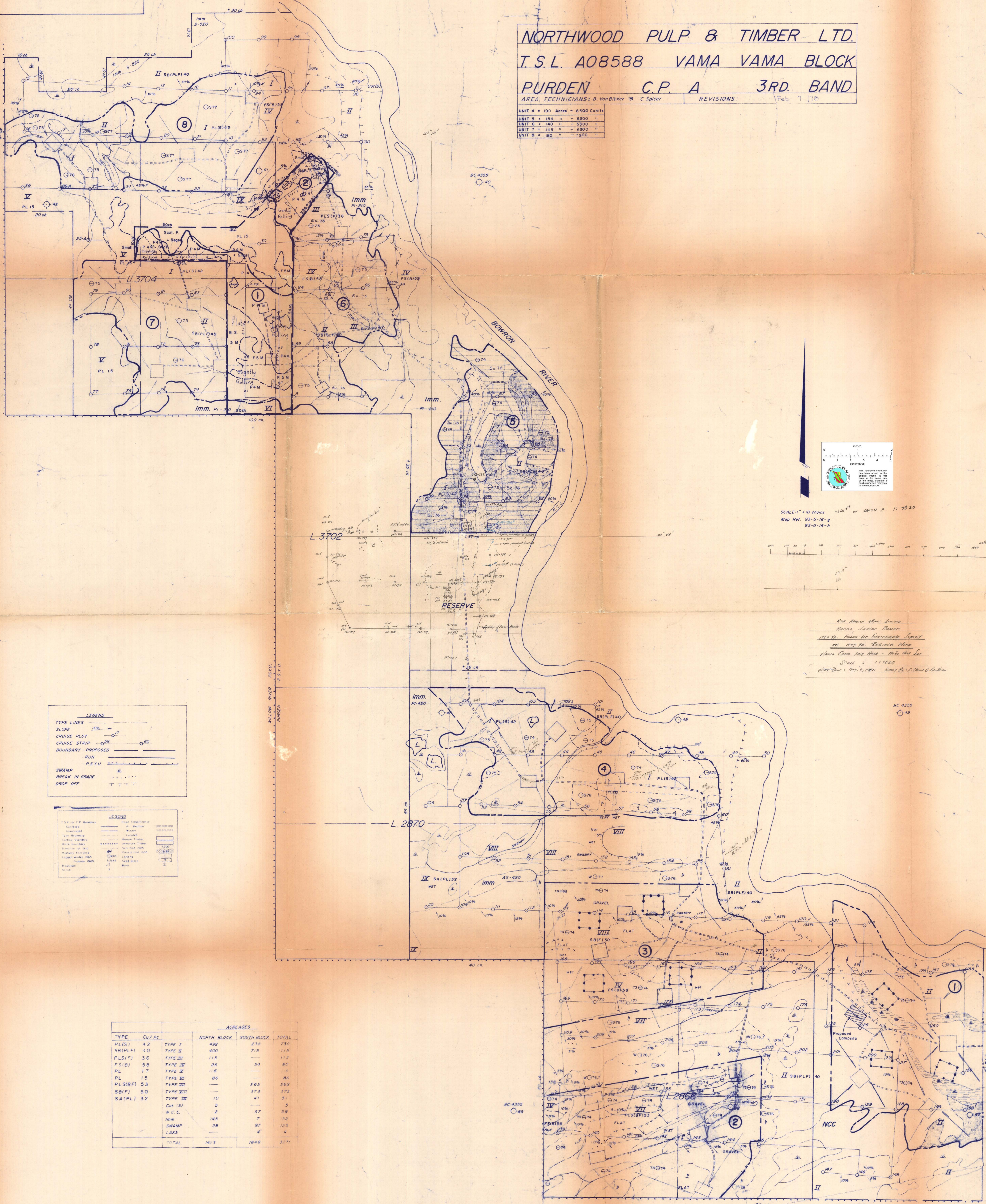

SCALE 1" = 10 Chains = 200' or 609.6m = 1:7620
Map Ref. 93-G-16-g
93-G-16-h

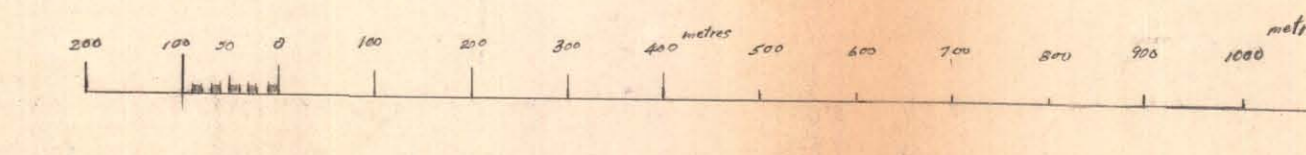

*Area shown above is based on
Metcalf's Survey of 1904
and 1923 V.C. Robinson's Map
of 1923 V.C. Robinson's Map
Wama Creeks East Area - No. 10, 1911
Scale 1:17000
Work Done: Oct. 9, 1960 Survey by E. Chappell & G. G. Galt*

LEGEND

TYPE LINES
 SLOPE ———
 CRUISE PLOT ———
 CRUISE STRIP ———
 BOUNDARY PROPOSED ———
 BOUNDARY RUN ———
 SWAMP ———
 BREAK IN GRADE ———
 DROP OFF ———

LEGEND

1:50 or C.P. Boundary	Wood	Coniferous
2:50 or C.P. Boundary	Water	Swamp
3:50 or C.P. Boundary	Gravel	Swamp
4:50 or C.P. Boundary	Gravel	Swamp
5:50 or C.P. Boundary	Gravel	Swamp
6:50 or C.P. Boundary	Gravel	Swamp
7:50 or C.P. Boundary	Gravel	Swamp
8:50 or C.P. Boundary	Gravel	Swamp
9:50 or C.P. Boundary	Gravel	Swamp
10:50 or C.P. Boundary	Gravel	Swamp

ACRES					
TYPE	CU/AC		NORTH BLOCK	SOUTH BLOCK	TOTAL
PL(S)	4.2	TYPE I	492	230	730
SB(PL)	4.0	TYPE II	400	715	1115
PLS(F)	3.6	TYPE III	113		113
FS(B)	5.8	TYPE IV	26	54	80
PL	1.7	TYPE V	15		15
PL(S)	1.5	TYPE VI	86		86
PLS(B)	5.3	TYPE VII		262	262
SB(F)	5.0	TYPE VIII		173	173
SA(PL)	3.2	TYPE IX	10	41	51
		Cor (S)	5		5
		N.C.C.	2	57	59
		Imm.	145	7	152
		SWAMP	28	97	125
		LAKE		4	4
		TOTAL	1413	1848	3271