

NTS 94 D-2

Bear Lake Cu-Mo Property, B.C.
Quick Sheet

821991

Geology

Porphyry style Cu and Mo mineralization occurs within a small, primarily monzonitic, stock 1,500 m. in length and 500 to 800 meters in width. The stock is of Upper Cretaceous to Tertiary age intruded into Lower Jurassic Hazelton volcanics.

Drill Hole Results

Skyline drill hole 96-14	0.32 % Cu,	0.106 % Mo,	over 121 m. (397 ft.)
Inco drill hole #54303	0.23 % Cu,	0.05 % Mo	over 140.2 m. (460 ft.)
Inco drill hole #54308	0.27 % Cu,	0.06 % Mo,	over 161.8 m. (531 ft.)
Inco drill hole #54304	0.19 % Cu,	0.035 % Mo,	over 147.5 m. (484 ft.)
Skyline drill hole 96-12	0.14 % Cu, 0.025 % Mo, 624 grams Ag., over 2.8 m. (9.2 ft.)		

Except for Skyline drill hole 96-12 all of the above drill holes are located within an area of some 300 m, by 300 m. in size. This zone of mineralization is still open to the east and to the west and to depth. Lower grade drill holes to the south and to the north might still offer encouragement for more tonnage in these directions as well. The assay results from these holes follow.

In a southerly direction from the above mineralized zone

Skyline drill hole 96-13 (100 m. south of drill hole 96-14)

112 m. to 139 m. (27 m.) 0.15 % Cu, 0.023 % Mo.

148 m. to 175 m. (27 m.) 0.13 % Cu, 0.021% Mo.

175 m. to 181 m. (6 m.) 0.28 % Cu, 0.029 % Mo.

181 m. to 185.3 m. (4.3 m) 0.10 % Cu, 0.008 % Mo.

In a northerly direction from the previously discussed mineralized zone.

Inco drill hole #54305 (180 m. north of Inco drill hole #54308)

168.2 m. to 216.7 m. (48.5 m.) 0.135 % Cu, 0.03 % Mo,

Inco drill hole #54306 (380 m. north of Inco drill hole #54308)

71.6 m. to 73.1 m. (1.5 m.) 0.02 % Cu, 0.45 % Mo.

The better grades of mineralization as indicated in the Skyline drill hole 96-14 may well be due to better recoveries resulting from the use of larger diameter core. That is, thin walled BQ versus standard A.

Infrastructure

The claims are located within 3 km. of an operating railroad (B.C. Rail)

The claims are located within 50 km of the B.C. Hydro power line which services the South Kerness copper mine (Royal Oak).

Two airports are located in the vicinity; one at Connelly which is 10 km to the north and another at Driftwood some 40 kms. to the south.

Logging roads come to within 30 kms. of the property.

January 20, 1998

BEAR
(5N)

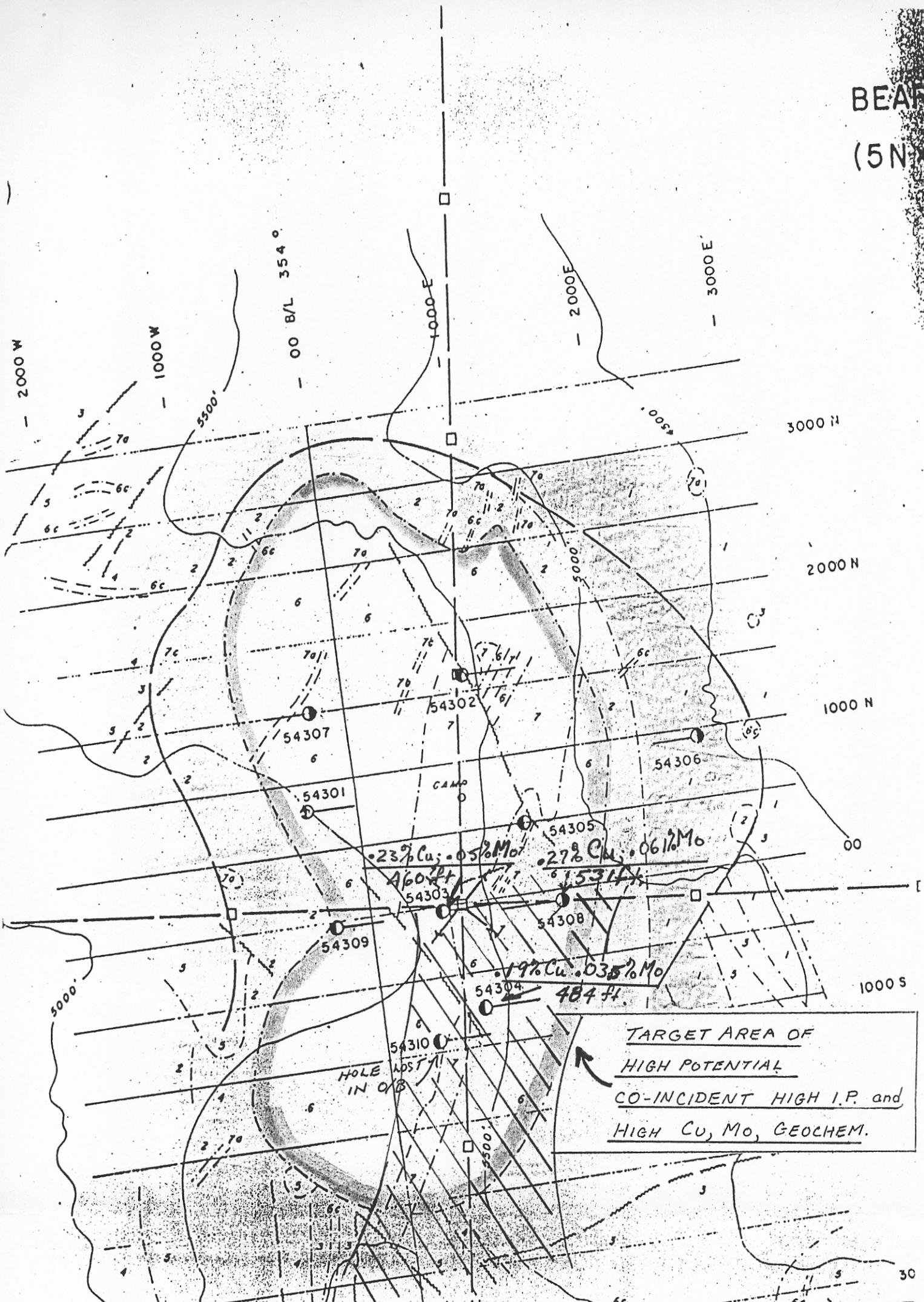

Canadian Nickel Company Limited

Copper Cliff, Ontario
POM 1NO

GEOLOGY MAP

- TERTIARY & UPPER CRET. INTRUSIVES
- JURASSIC HAZELTON VOLCANICS
- TRIASSIC TAKLA BASALTS

SHEET 1
FIGURE 1

Project: BEAR 1-4 CLAIMS

Area: OMINECA MINING DIVISION B.C.

Supervisor: E J DEBICKI

Instrument:

Survey date:

Compiled by: P. PETO, R. ARTHUR

Drawn by: D. WALSH

Date drawn:
May 28, 1982

Revised:
Nov. 19, 1982

Scale: 1 : 10,000

Graphic Scale: 0 100m. 200m. 300m.

N.T.S. 94 D 2W

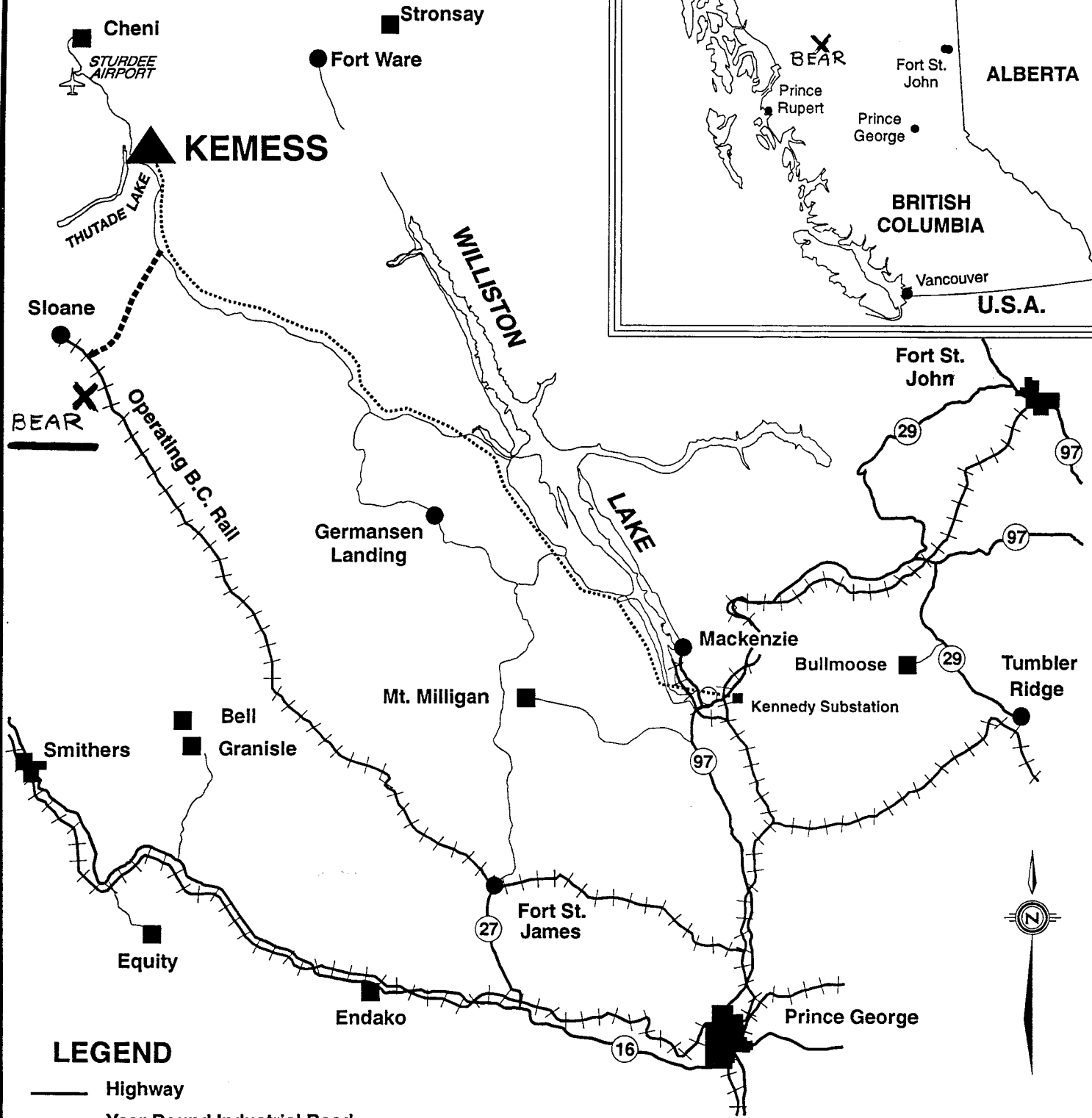
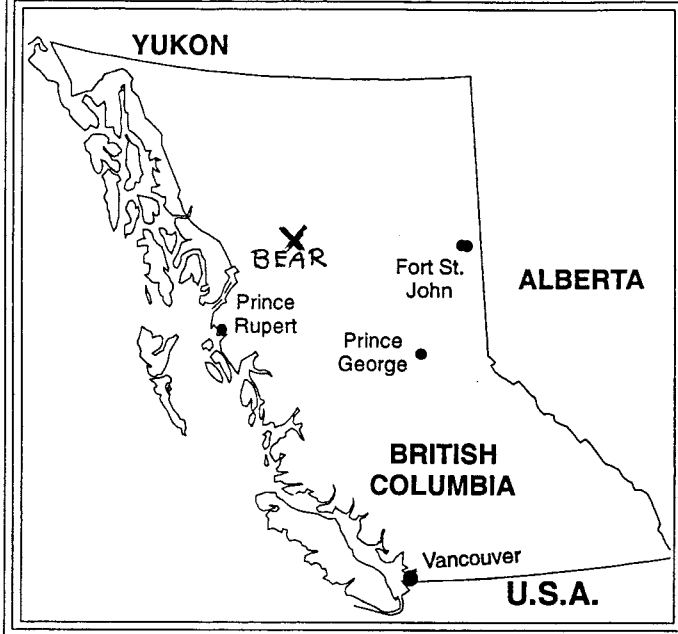

LEGEND

- Highway
- Year Round Industrial Road
- Designed Connector Road
- + + + Railway
- B.C. Hydro-Proposed 230 kV Line
- Mines And Mine Development Projects

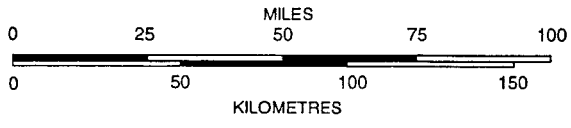

**N. CENTRAL B.C.
INFRASTRUCTURE**

