

821274

BIG 4 PROPERTY
TELKWA PASS
93L/12E

OMINECA M.D.
D. GROOT LOGGING LTD.
SMITHERS, B.C.

D.C. PLEKASH - GEOLOGIST DEC. 1981

B I G 4 P R O P E R T Y

TELKWA PASS AREA

NTS 93L/12E

LATITUDE 54⁰ 33' 30" LONGITUDE 127⁰ 39' 20"

OMINECA MINING DIVISION

D.C. PLECASH - Geologist

July, 1981

D. GROOT LOGGING LTD.

BOX 520

SMITHERS, B.C. V0J 2N0

T A B L E O F C O N T E N T S

| | | |
|------------------------|------|---|
| SUMMARY | PAGE | 3 |
| LOCATION AND ACCESS | PAGE | 4 |
| PROPERTY AND OWNERSHIP | PAGE | 4 |
| REGIONAL GEOLOGY | PAGE | 5 |
| PROPERTY GEOLOGY | PAGE | 5 |
| CONCLUSION | PAGE | 6 |
| QUALIFICATIONS | PAGE | 7 |

FIGURES:

| | | |
|-----------------------------------|-----------|---|
| 1) LOCATION MAP | PAGE | 1 |
| 2) PROPERTY MAP | PAGE | 2 |
| 3) SURFACE PLAN SHOWING 1981 WORK | IN POCKET | |
| 4) GEOLOGY PLAN | IN POCKET | |
| 5) ASSAY PLAN | IN POCKET | |

APPENDICES:

| | |
|------------|------------------------------------|
| APPENDIX A | CLAIM LIST |
| APPENDIX B | COST STATEMENT |
| APPENDIX C | COST BREAKDOWN |
| APPENDIX D | CERTIFICATE OF ASSAY |
| APPENDIX E | ASSAY COST (INVOICE) |
| APPENDIX F | B. DEVINES CONTRACTOR D8CAT |
| APPENDIX G | S. JAYCOX INDUSTRIES LTD. 450 CASE |

H A N G E S

PROVINCIAL

FOREST

MOUNTAINS)

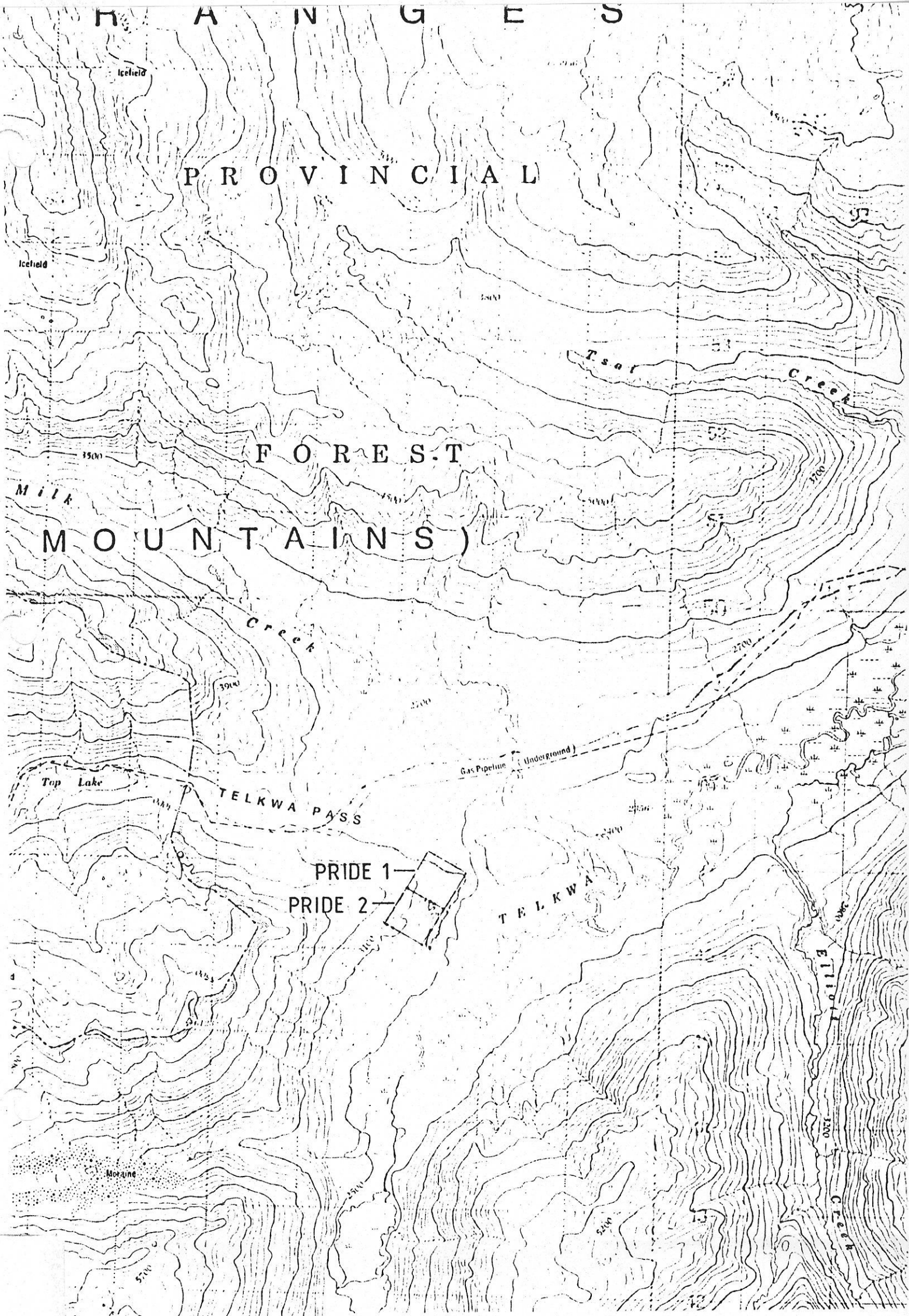

D. GROOT LOGGING LTD.
 BIG 4 PROPERTY
 TELKWA PASS AREA
 PROPERTY MAP

SCALE 1:50000
 DWN. D.C.P.

DATE: JULY 1981
 NTS. 93L/12E

OMINECA M.D. - 93L/12

TELKWA PASS

BIG 4 PROPERTY

SUMMARY:

Between June 25th 1981 and July 10th 1981 the author with a crew of one man, employed by D. GROOT LOGGING LTD. of Smithers, B.C. and a contractor with a D8 Cat Tractor and a contractor with a Case 450 Backhoe on tracks, did work on the Big 4 Property, under option from M. Palumbo of R.R.I. Smithers, B.C.

The D8 Cat Tractor worked twenty hours up-grading the Telkwa Pass road of 14.5km and 3.5km of property road. This was done to allow a 4 X 4 vehicle to drive to the property. The D8 Cat Tractor then worked 27 hours to rebuild the old wagon road so that it was possible to get a backhoe up to the vein system. This was a distance of 11km.

The Case 450 Backhoe worked 48 hours to clean out three areas of interest on the vein system. A total of 568 cubic meters of material was removed by taking 244 Cu.M. from the top area, 278 Cu.M. from the middle area and 46 Cu.M. from the lower area.

The results from the geological mapping and the sampling showed that the mineralized zone is very broken up with traversed faulting having taken place which in turn caused some of the fault blocks to dip the opposite direction than that of the normal local dip structure. With the strikes and dips of the quartz zoning in the top area, and the different strikes and dips of the lower quartz zone, this could indicate the occurrence of an anticline or some local drag folding structure.

The mineralization is very sporadic and there appears to be at least two ages of mineralization from the occurrence of one type of mineralized quartz veining intersecting and intruding a different quartz zone. In many places the vein has not come through the argillites to be exposed on the surface, so a complete look at the vein structure is impossible unless some surface drilling and blasting is done across the structure.

LOCATION AND ACCESS:

The Big 4 Property is situated in west central British Columbia at latitude $54^{\circ} 33' 30''\text{N}$ and longitude $127^{\circ} 39' 20''\text{N}$. The area is about 49km south west of Telkwa, B.C. along the Telkwa Pass road. The claims lay overlooking the Telkwa River Basin and about 5.5km east of Top Lake. The Workings are at an elevation of 858m.

The property road to the workings is about 6.8km long that leaves the Telkwa Pass road in a south east direction and follows the hill contours at a fair grade for about 4km then swings to the south west and up onto the property.

PROPERTY AND OWNERSHIP:

The property is comprised of two mineral claims known as the Pride #1 record No. 31687 and the Pride #2 record No. 31688. These claims are owned by Mike Palumbo, R.R. #1 Smithers, B.C.

REGIONAL GEOLOGY:

The area of interest is found in the coast range intrusives - Mesozoic, Granite, Granodiorite, Quartz Diorite, Shists, Argillites, Tuffs, Breccia Andesites.

PROPERTY GEOLOGY:

The main mineralization occurs in a faulted zone of quartz veins occupying a shear zone. The vein varies in width from 30cm to 305cm. The upper zone strike N 25° E with a 50° dip to the S.E. The middle zone strikes S 20° W with a vertical to a 76° dip to the S.W. and the lower zone strikes N 45° E with a 55° dip to the S.E. The quartz carries some galena, sphalerite, chalcophyrite and pyrites. The host rocks immediately next to the veins are mostly argillites but in the middle zone a small block of quartz digrite appears next to the vein structure. Lower down on the property a small vein was noticed above the Old Wagon road. This had a strike on N 30° W. and a 45° dip to the S.W. This vein is 30cm wide and was assayed for Av.; Ag.; Cu.; Pb.; and ZN. with next to no mineralization present in this sample.

CONCLUSION:

The work on the Big 4 Property that comprised of getting access into the property and cleaning out the main three areas of interest, then washing, mapping and sampling the zones showed that, the property warrants more stripping off of the existing veins towards the north to see if the vein structures come together and form a more continuous zone of mineralization. The mapping shows that the veins are in a zone of much faulting and also could be on a crest of a minor anticline or some drag folding. The mineralization is formed in small pockets and then the overall results of sampling are no where near any viable operation. As of yet diamond drilling would not be the answer to further exploration as the targets are not attractive enough to warrant spending a large sum of money.

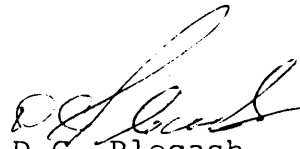

D.C. Plecash

Geologist

CLAIM LIST:

| <u>NAME</u> | <u>RECORD NUMBER</u> | <u>EXPIRY DATE</u> |
|-------------|----------------------|--------------------|
| PRIDE # 1 | 31687 | AUGUST 16, 1982 |
| PRIDE # 2 | 31688 | AUGUST 16, 1982 |

COST STATEMENT

Wages (Including Fringe Benefits)

| | | |
|--------------|---------|-------------|
| M. Chapman | 12 Days | \$ 1,278.00 |
| D.C. Plecash | 15 Days | \$ 2,946.45 |

| | | |
|-------------|--|-----------|
| Assay Costs | | \$ 695.00 |
|-------------|--|-----------|

| | | |
|-------|--------------------|-----------|
| 4 X 4 | 12 Day @ \$35./Day | \$ 420.00 |
|-------|--------------------|-----------|

| | | |
|-----------------------|----------------|-------------|
| B. Devine Contracting | D8 Cat Tractor | \$ 4,230.00 |
|-----------------------|----------------|-------------|

| | | |
|---------------------------|------------------|-------------|
| S. Jaycox Industries Ltd. | 450 Case Backhoe | \$ 1,920.00 |
|---------------------------|------------------|-------------|

Total

\$ 11,489.45

COST BREAKDOWN

TOTAL EXPENDITURES \$ 11,489.45

Road Work Into Property

D8 Cat Work With Swamper

Supervision and 4X4 \$ 5,581.72

Cleaning Off 3 Main Areas

450 Case Backhoe With Swampers

Supervision and 4X4 \$ 3,947.58

Working On Veins

Washing, Mapping, Sampling,

Geologist, Helper and 4X4 \$ 675.86

Assaying

Assay and Freight Cost \$ 695.00

Office Work

Preparing Maps and Reports \$ 589.29

\$ 11,489.45

D.C. PLEKASH
GEOLOGIST



can test ltd.

Invoice

9871

DATE: **July 29/81**

1650 PANDORA STREET, VANCOUVER, B.C. V5L 1L6 • TELEPHONE 254-7278 • TELEX 04-54210

Chemists, Analysts and Consultants in
Racing • Environmental • Food and Drug •
Spectrographic • Gas & Air • Forensic
and General Chemistry

SOLD TO • **D. Groot Logging Ltd.,**
P.O. Box 520,
SMITHERS, B.C.
VOJ 2N0

| OUR ORDER # | CUSTOMER P.O. | UNIT PRICE | AMOUNT |
|--------------------------------------|---------------|------------|------------------|
| 2474E6 | | | |
| To Assaying of Ore Samples | | | |
| 17 - Gold & Silver @ | | 15.00 | 255.00 |
| 15 - Lead @ | | 10.00 | 150.00 |
| 15 - Zinc @ | | 10.00 | 150.00 |
| 2 - Cobalt @ | | 10.00 | 20.00 |
| 15 - Copper @ | | 8.00 | 120.00 |
| | | | \$ 695.00 |
| <i>LOS SAMPLES * 6207 & 6208</i> | | | <i>50.00</i> |
| <i>FREIGHT GREYHOUND DIFF.</i> | | | <i>645.00</i> |
| | | | <i>50.00</i> |
| | | | 695.00 |

E

ACCOUNTS PAYABLE

102

I.D. DEVINS

Date 29/06/81

CODE Telkwa Pass.

Amount PPD
4230.00

(Mining)

PREPARED BY MS

APPROVED _____

Reqs 5
US CAT REMARKS 5 1/2
RATE 90.00 PER HOUR 47 hr
TOTAL 4230.00

No. of Loads or Trips BLINDY ROAD 28 miles

Type of Work TELKWA PASS

OPERATOR'S SIGNATURE
Pd CK # 10785
FOREMAN'S SIGNATURE
July 13/81
SEE-MOORE PRINT - SMITHERS

NO. 802
OK TELKWA PASS
4230.00

F

0.00 *C
 320.00 +
 320.00 +
 320.00 +
 240.00 +
 80.00 +
 320.00 +
 320.00 +
 1,920.00 *

48 hrs @ 40.00/hr

road

JAYCOX

P.O BOX 36

Charge to J
B
S

Loc
 Other Equip

Telkwa
Repair

ACCOUNTS PAYABLE

Inv. # JUNE JULY

I.D. JAYCOX

Date 13/07/81

CODE _____

Amount PPD

1920.00

Mining
Telkwa Pass

PREPARED BY BC

APPROVED MA

| | | | | |
|-----------------------------|------------|--------|--|--|
| Operator <u>[Signature]</u> | Supervisor | TOTALS | | |
| | | | | |

13 Assay

10-15

PROPERTY TENKENT PASS - BIG FOUR PROPERTY.

N.T.S. 934/12E

DATE OCT. 21, 1977

SAMPLE REPORT

| SAMPLE NO. | LOCATION & DESCRIPTION | TYPE | WIDTH | OZ/T | | ASSAYS | | | | SAMPLED BY |
|-------------------------|-------------------------------------------------------------------------|-------|-------|-------|-------|--------|--|--|--|------------|
| | | | | Au | Ag | | | | | |
| -6112 | TRENCH 1: A - Gal. py & chalc. in gdtz | Grab. | | 0.002 | 1.60 | | | | | J.R.F. |
| -6113 | B - Chalc & some py in gdtz. | " | | 0.001 | 0.10 | | | | | " |
| -6114 | C - Massive gal. & chalc. in gdtz | " | | 0.004 | 7.20 | | | | | " |
| -6115 | D - Siliceous gal. in gdtz | " | | 0.002 | 1.30 | | | | | " |
| -6116 | E - Siliceous gal & chalc. in gdtz | " | | 0.003 | 1.20 | | | | | " |
| -6117 | F - Heavy gal & chalc. in gdtz | " | | 0.002 | 42.40 | | | | | " |
| -6118 | G - Siliceous gal & chalc. in gdtz | " | | 0.002 | 0.30 | | | | | " |
| -6119 | H - White gdtz - no sulphides | " | | 0.001 | 0.02 | | | | | " |
| -6120 | TRENCH 2: A - Massive pyrite w/ chalc. gal & sphal. in gdtz - from dump | Grab | | 0.200 | 3.08 | | | | | J.R.F. |
| -6121 | B - White gdtz - no sulphides - from dump | " | | 0.001 | 0.02 | | | | | " |
| -6122 | C - Siliceous chalc. in gdtz. - from dump | " | | 0.001 | 0.42 | | | | | " |
| -6123 | D - Gal. sphal. & py. in gdtz. - from dump. | " | | 0.016 | 0.72 | | | | | " |
| -6124 | Specular hematite with pyrite | " | | 0.010 | 0.12 | | | | | " |
| ASSAY FOR Au, Ag. | | | | | | | | | | |
| RESULTS TO: J.R. FASTER | | | | | | | | | | |

Rossbacher Laboratory

GEOCHEMICAL ANALYSTS & ASSAYERS

2225 S. SPRINGER AVE.,
BURNABY, B. C.,
CANADA
TELEPHONE: 299-6910
AREA CODE: 604

CERTIFICATE OF ASSAY

CERTIFICATE NO. 7185

TO: NORANDA EXPLORATION CO LTD.
1050 Bayle Street,
Vancouver, B.C.

INVOICE NO. 7165

DATE RECEIVED

ATTN: Project # 10-15

DATE ANALYSED Nov. 1977.

| SAMPLE NO.: | oz/t | oz/t |
|-------------|-------|------|
| | Au | Ag |
| J 6112 | 0.002 | 1.60 |
| J 6113 | 0.001 | 0.10 |
| J 6114 | 0.004 | 7.20 |
| J 6115 | 0.002 | 1.30 |
| J 6116 | 0.003 | 1.20 |
| J 6117 | 0.002 | 42.4 |
| J 6118 | 0.002 | 0.30 |
| J 6119 | 0.001 | 0.02 |
| J 6120 | 0.200 | 3.08 |
| J 6121 | 0.001 | 0.02 |
| J 6122 | 0.001 | 0.42 |
| J 6123 | 0.016 | 0.72 |
| J 6124 | 0.010 | 0.12 |

Certified by

H. Rossbacher

12 Bar 1



Province of British Columbia
 Ministry of Energy, Mines and Petroleum Resources
 MINERAL RESOURCES BRANCH-TITLES DIVISION

MINERAL ACT

STATEMENT OF EXPLORATION AND DEVELOPMENT

I, D. C. PLECASH Agent for M. PAJUMBO
D. GROOT LOGGING LTD. (Name)
 Box 520 (Address)
 Smithers, B. C. R. R. # 1 (Address)
 Smithers B. C.
 Valid subsisting F.M.C. No. 179220 Valid subsisting F.M.C. No. ?

STATE THAT

1. I have done, or caused to be done, work on the PRIDE # 1 ; PRIDE # 2 Mineral
 Claim(s)
 Record No.(s) 31687. 31688
 Situate at TELKWA PASS ; Telkwa B. C. in the OMINECA Mining Division,
 to the value of at least \$4000.00 dollars. Work was done from the .25 day
 of JUNE 19 81, to the 15 day of JULY 19 81.

2. The following work was done in the 12 months in which such work is required to be done:

(COMPLETE APPROPRIATE SECTION(S) A, B, C, D, FOLLOWING)

A. PHYSICAL (Trenches, open cuts, adits, pits, shafts, reclamation, and construction of roads and trails)
 (Give details as required by section 13 of regulations.)

| | COST |
|---------------------------------------------------|-------------------|
| Upgraded and repaired 17.7 km. of road 4.6 m wide | \$ 2375.20 |
| Rebuilt 1.1 km. of road 3.8m wide | \$ 3206.52 |
| Cleaned Out Three (3) Zones | |
| Top Zone | \$ 1695.79 |
| Mid Zone | \$ 1932.09 |
| Lower Zone | \$ 319.70 |
| TOTAL PHYSICAL | \$ 9529.30 |

I wish to apply \$ 4000.00 of physical work to the claims listed below.

(State number of years to be applied to each claim, its month of record, and identify each claim by name and record no.)

10 years to PRIDE # 1 Record # 31687 August
10 years to PRIDE # 2 Record # 31688 August

B. PROSPECTING (Details in report submitted as per section 9 of regulations.)
 (The itemized cost statement must be part of the report.)

| COST |
|------|
| |

I wish to apply \$ of this prospecting work to the claims listed below.

(State number of years to be applied to each claim, its month of record, and identify each claim by name and record no.)

| | |
|--------------------------------------------------------------------------------------------------------------------------------------------------------------------------------------------------------------------------------|------------------------------------------------------|
| C. DRILLING (Details in report submitted as per section 8 of regulations.) (The itemized cost statement must be part of the report.) | COST |
| | |
| D. GEOLOGICAL, GEOPHYSICAL, GEOCHEMICAL (Details in report submitted as per section 5, 6, or 7 of regulations.) (The itemized cost statement must be part of the report.) (State type of work in space below.) | Washing; Mapping; Sampling Three (3) Zones \$ 675.86 |
| | Assaying \$ 695.00 |
| | Preparing Report \$ 589.29 |
| | TOTAL OF C AND D \$1960.15 |

Who was the operator (provided the financing)? Name D. GROTT LOGGING LTD.
 Address Box 520
Smithers, B.C. VOJ 2N0

| Portable Assessment Credits (PAC) Withdrawal Request | | AMOUNT |
|---------------------------------------------------------------------------------------------------------------|---------|--------|
| Amount to be withdrawn from owner(s) account(s): | | |
| Name of Owner | | |
| (May be no more than 30 per cent of value of the approved work submitted as assessment work in C and (or) D.) | 1. | |
| | 2. | |
| | 3. | |
| | 4. | |
| TOTAL WITHDRAWAL | | |
| TOTAL OF C AND (OR) D PLUS PAC WITHDRAWAL | | |

I wish to apply \$ of this work to the claims listed below.
 (State number of years to be applied to each claim, its month of record, and identify each claim by name and record no.)

Value of work to be credited to portable assessment credit (PAC) account(s).
 (May only be credited from the approved value of C and (or) D not applied to claims.)

| | | Name | AMOUNT |
|------------------------------------------------------|---------|------|--------|
| In owner(s) name. | 1. | | |
| | 2. | | |
| | 3. | | |
| In operator(s) name (party providing the financing). | 1. | | |
| | 2. | | |
| | 3. | | |

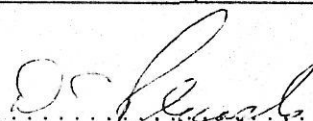
 (Signature of Applicant)

KERR ADDISON MINES LIMITED

SUITE 703 - 1112 WEST PENDER STREET
VANCOUVER, B.C. V6E 2S1
PHONE 682-7401

May 17, 1985

Mr. Mel Chapman,
P.o. Box 852,
Smithers, B.C.

Dear Mel:

Thank you for sending us the data on the Big Four, Grandview (Bell) properties in the Telkwa Pass Area and the assessment report numbers for the Burbridge Lake property near Dome Mtd.

We will plan on examining the Telkwa Pass properties when the snow melts and after researching the Burbridge property we may examine it as well.

Please find enclosed all the data you sent us.

Yours truly,



Art.

A.D. Clendenan
Project Geologist

ADC/lk
Enclosure

Numbers of summit Barbridge Lake
Property

9073

6386

5422

10182

phone between 8 and 9
in the morning

M Chapman

Box 852

Smithers BC

Ph 847-2368

RECEIVED
MAY 17 1985
KELLOGG CO. LTD.
PER

PRIDE 1 M.C.
No. 31687

PRIDE 2 M.C.
No. 31688

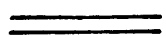
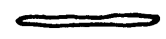
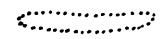
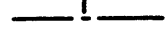

-  DEGRADED ROAD
-  REBUILT ROAD
-  OLD SURFACE CUTS
-  NEW SURFACE CUTS
-  CLAIM BOUNDARY

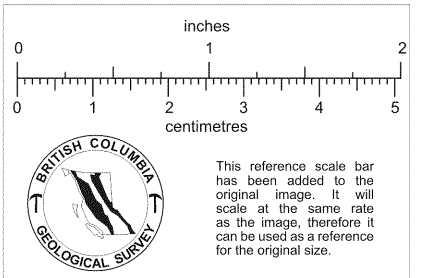

| | |
|------------------------------------------------------------------------|-----------------------|
| D.GROOT LOGGING LTD MINERALS EXPLORATION SMITHERS, B.C. | |
| SURFACE PLAN SHOWING 1981 WORK BIG 4 PROPERTY | |
| SCALE - 1" = 100' | DATE - JULY, 1981 |
| COPY BY - P.HAILLOT | DATE COPY - MAY, 1985 |
| NTS - 93 L 12 E | REVISED - |

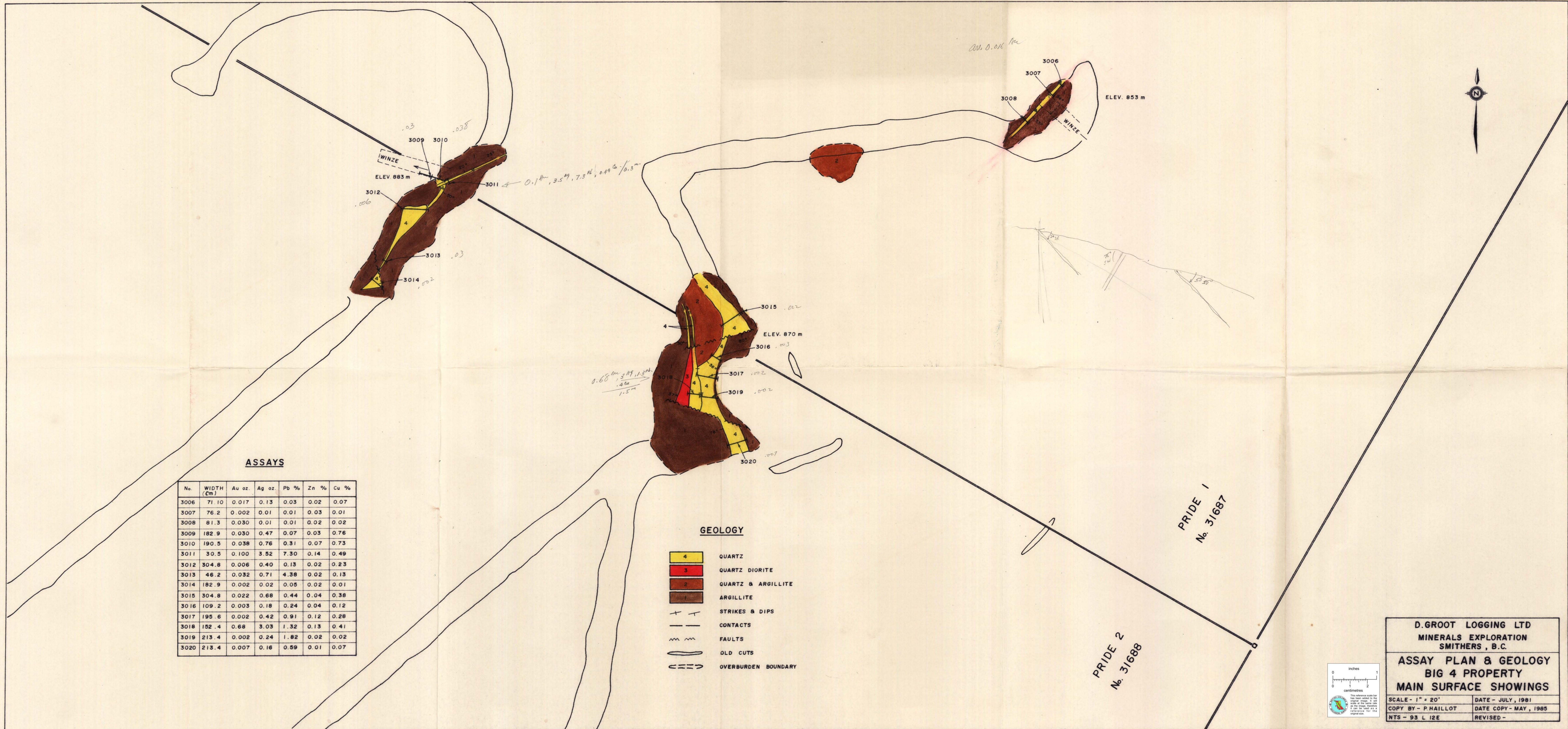

ASSAYS

| No. | WIDTH (m) | Au oz. | Ag oz. | Pb % | Zn % | Cu % |
|------|-----------|--------|--------|------|------|------|
| 3006 | 71.10 | 0.017 | 0.13 | 0.03 | 0.02 | 0.07 |
| 3007 | 76.2 | 0.002 | 0.01 | 0.01 | 0.03 | 0.01 |
| 3008 | 81.3 | 0.030 | 0.01 | 0.01 | 0.02 | 0.02 |
| 3009 | 182.9 | 0.030 | 0.47 | 0.07 | 0.03 | 0.76 |
| 3010 | 190.5 | 0.038 | 0.76 | 0.31 | 0.07 | 0.73 |
| 3011 | 30.5 | 0.100 | 3.52 | 7.30 | 0.14 | 0.49 |
| 3012 | 304.8 | 0.006 | 0.40 | 0.13 | 0.02 | 0.23 |
| 3013 | 46.2 | 0.032 | 0.71 | 4.38 | 0.02 | 0.13 |
| 3014 | 182.9 | 0.002 | 0.02 | 0.05 | 0.02 | 0.01 |
| 3015 | 304.8 | 0.022 | 0.68 | 0.44 | 0.04 | 0.38 |
| 3016 | 109.2 | 0.003 | 0.18 | 0.24 | 0.04 | 0.12 |
| 3017 | 195.6 | 0.002 | 0.42 | 0.91 | 0.12 | 0.28 |
| 3018 | 152.4 | 0.68 | 3.03 | 1.32 | 0.13 | 0.41 |
| 3019 | 213.4 | 0.002 | 0.24 | 1.82 | 0.02 | 0.02 |
| 3020 | 213.4 | 0.007 | 0.16 | 0.59 | 0.01 | 0.07 |

GEOLOGY

- 4 QUARTZ
- 3 QUARTZ DIORITE
- 2 QUARTZ & ARGILLITE
- 1 ARGILLITE
- STRIKES & DIPS
- CONTACTS
- FAULTS
- OLD CUTS
- OVERBURDEN BOUNDARY

D.GROOT LOGGING LTD
MINERALS EXPLORATION
SMITHERS, B.C.

**ASSAY PLAN & GEOLOGY
BIG 4 PROPERTY
MAIN SURFACE SHOWINGS**

| | |
|---------------------|-----------------------|
| SCALE - 1" = 20' | DATE - JULY, 1981 |
| COPY BY - P.HAILLOT | DATE COPY - MAY, 1985 |
| NTS - 93 L 12E | REVISED - |